

STATE OF NORTH CAROLINA  
**DEPARTMENT OF TRANSPORTATION**



CENTRAL BRIDGE MANAGEMENT UNIT

**CONTRACT PROPOSAL**

CONTRACT/WBS NUMBER: DO00065 / 47063.3.1  
ROUTE: US 70 COUNTY: Carteret  
DESCRIPTION: Bridge #33-Repairs to Concrete Caps, Underdeck and Piles  
BID OPENING: 2:00 PM, August 19, 2010

**NOTICE:**

ALL BIDDERS SHALL COMPLY WITH ALL APPLICABLE LAWS REGULATING THE PRACTICE OF GENERAL CONTRACTING AS CONTAINED IN CHAPTER 87 OF THE GENERAL STATUTES OF NORTH CAROLINA WHICH REQUIRES THE BIDDER TO BE LICENSED BY THE N.C. LICENSING BOARD FOR CONTRACTORS WHEN BIDDING ON ANY NON-FEDERAL AID PROJECT WHERE THE BID IS \$30,000 OR MORE, EXCEPT FOR CERTAIN SPECIALTY WORK AS DETERMINED BY THE LICENSING BOARD. BIDDERS SHALL ALSO COMPLY WITH ALL OTHER APPLICABLE LAWS REGULATING THE PRACTICES OF ELECTRICAL, PLUMBING, HEATING AND AIR CONDITIONING AND REFRIGERATION CONTRACTING AS CONTAINED IN CHAPTER 87 OF THE GENERAL STATUTES OF NORTH CAROLINA.

NAME OF BIDDER \_\_\_\_\_

ADDRESS OF BIDDER \_\_\_\_\_

RETURN BIDS TO: **Mr. Rick Nelson, PE**  
**Asst. State Bridge Management Engineer**  
**4809 Beryl Road**  
**Raleigh, NC 27606**

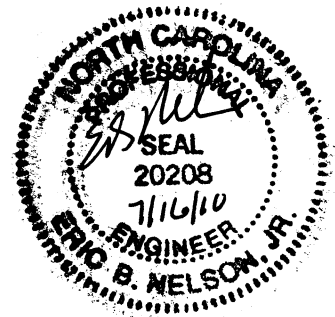

REVISED 8-10-10

**TABLE OF CONTENTS**

<u>DESCRIPTION</u>	<u>PAGE NO.</u>
PRE-QUALIFYING TO BID -----	1
AVAILABILITY OF FUNDS -----	2
PREPARATION AND SUBMISSION OF BIDS -----	2
AWARD OF CONTRACT -----	3
BID BOND OR BID DEPOSIT -----	3
PERFORMANCE BOND AND PAYMENT BOND REQUIREMENTS -----	4
DELIVERY OF BIDS -----	4
GENERAL SPECIAL PROVISIONS -----	6
PROJECT COMMITMENTS MADE THROUGH PERMIT COORDINATION-----	9
PROJECT SPECIAL PROVISIONS -----	11
DISADVANTAGED BUSINESS ENTERPRISES -----	34
BID FORM -----	44
EXECUTION OF CONTRACT-----	45-47
FORM W-9 -----	48
NON-COLLUSION AFFIDAVIT -----	49

APPENDIX:

LOCATION MAP  
FHWA PROVISION REQUIREMENTS

## **PRE-QUALIFYING TO BID**

All prospective Bidders shall be pre-qualified with the Department of Transportation prior to submitting a bid. Contractors who are not pre-qualified may obtain information and forms for pre-qualifying from:

Contractual Services Unit  
State Contractual Services Engineer  
Greg Keel, PE  
Tel: (919) 733-7174  
Fax: (919) 715-7378

All required pre-qualification statements and documents shall be filed with the State Contractual Services Engineer at least two weeks prior to the date of opening bids.

## **PRE-BID CONFERENCE**

**All prospective bidders are to meet for the Pre-Bid Conference, at 2:00 PM, Thursday, August 5, 2010 in the Chief Engineer's Conference Room, 4809 Beryl Road, Raleigh , NC.** This Conference will be conducted by Department personnel for the purpose of providing additional information about the project and to give Bidders an opportunity to ask any questions they may have. **Only bids received from Bidders who have attended and properly registered at the Pre-Bid Conference will be considered.**

No questions concerning the project will be answered by any Department personnel at any time except at the Pre-Bid Conference.

Attendance at the Pre-Bid Conference will not meet the requirements of proper registration unless the individual attending has registered at the Conference in accordance with the following:

1. The individual signs his or her name on the official roster;
2. The individual writes in the name and address of the company he or she represents, and
3. Only one company is shown as being represented by the individual attending.
4. The individual is an officer or permanent employee of the firm they represent.

## **GENERAL SPECIAL PROVISIONS**

### **AVAILABILITY OF FUNDS - TERMINATION OF CONTRACTS**

Payments made on this contract are subject to availability of funds as allocated by the General Assembly. If the General Assembly fails to allocate adequate funds, the Department reserves the right to terminate this contract.

In the event of termination, the Contractor shall be given a written notice of termination at least 60 days before completion of schedule work for which funds are available. In the event of termination, the Contractor shall be paid for the work already performed in accordance with the contract specifications.

### **PREPARATION AND SUBMISSION OF BIDS**

All bids shall be prepared and submitted in accordance with the following listed requirements.

1. The proposal form furnished by the Department shall be used and shall not be taken apart or altered.
2. All entries including signatures shall be written in ink.
3. The amount bid shall be written in figures in the proper place in the proposal form.
4. Changes in any entry shall be made by marking through the entry in ink and making the correct entry adjacent thereto in ink. A representative of the Bidder shall initial the change in ink.
5. The bid shall be properly executed. In order to constitute proper execution, the bid shall show the Contractor's name, address, and Federal Identification Number and shall be signed by an authorized representative. Bids submitted by corporations shall bear the seal of the corporation.
6. The bid shall not contain any unauthorized additions, deletions, or conditional bids.
7. The Bidder shall not add any provision reserving the right to accept or reject an award, or to enter into a contract pursuant to an award.
8. The bid shall be accompanied by a bid bond on the form furnished by the Department or by a bid deposit. The bid bond shall be completely and properly executed in accordance with the requirements of "Bid Bond or Bid Deposit". The bid deposit shall be a certified check or cashiers check in accordance with "Bid Bond or Bid Deposit"
9. The bid shall be placed in a sealed envelope (complete proposal) and shall have been delivered to and received by the Department prior to the time specified in the invitation to bid.

### **REJECTION OF BIDS**

Any bid submitted which fails to comply with any of the requirements contained herein shall be considered irregular and may be rejected.

## **AWARD OF CONTRACT**

The award of the contract, if it be awarded, will be made to the lowest responsible Bidder. The lowest responsible Bidder will be notified that his bid has been accepted and that he has been awarded the contract.

## **BID BOND OR BID DEPOSIT**

Each bid shall be accompanied by a corporate bid bond or a bid deposit of a certified or cashiers check in the amount of at least 5% of the total amount bid for contract. No bid will be considered or accepted unless accompanied by one of the foregoing securities. The bid bond shall be executed by a Corporate Surety licensed to do business in North Carolina and the certified check or cashiers check shall be drawn on a bank or trust company insured by the Federal Deposit Insurance Corporation and made payable to the Department of Transportation in an amount of at least 5% of the total amount bid for the contract. The condition of the bid bond or bid deposit is: the Principal shall not withdraw its bid within 60 days after the opening of the same, and if the contract is awarded to the Principal, the Principal shall within 15 days after the prescribed contract documents are mailed to him for signature, execute such contractual documents as may be required by the terms of the bid and give payment and performance bonds with good and sufficient surety as required for the faithful performance of the contract and for the protection of all persons supplying labor and materials in the prosecution of the work; in the event of the failure of the Principal to enter into such contract and execute such documents as may be required, then the amount of the bid bond shall be immediately paid to the Department as liquidated damages or, in the case of a bid deposit, the deposit shall be forfeited to the Department.

When a bid is secured by a bid bond, the bid bond shall be on the form furnished by the Department. The bid bond shall be executed by both the Bidder and a Corporate Surety licensed under the laws of North Carolina to write such bonds.

The execution by the Bidder shall be in the same manner as required under "Preparation and Submission of Bids" for the proper execution of the bid. The execution by the Corporate Surety shall be the same as is provided for under "Preparation and Submission of Bids" for the execution of the bid by a corporation. The seal of the Corporate Surety shall be affixed to the bid bond. The bid bond form furnished is for execution of the Corporate Surety by a General Agent or Attorney in Fact. A certified copy of the Power of Attorney shall be attached if the bid bond is executed by a General Agent or Attorney in Fact. The Power of Attorney shall contain a certification that the Power of Attorney is still in full effect as of the date of the execution of the bid bond by the General Agent or Attorney in Fact. If the bid bond is executed by the Corporate Surety by the President, Vice President, or Assistant Vice President, and attested to by the Secretary or Assistant Secretary, then the bid bond form furnished shall be modified for such execution, instead of execution by the Attorney in Fact or the General Agent.

When a bid is secured by a bid deposit (certified check or cashiers check), the execution of a bid bond will not be required.

All bid bonds will be retained by the Department until the contract is executed by the successful Bidder, after which all such bid bonds will be returned to the Bidder or the Surety.

**PERFORMANCE BOND AND PAYMENT BOND REQUIREMENTS**

Bonds will not be required by the Department if the awarded amount of the contract is less than Three Hundred Thousand Dollars (\$300,000.), otherwise, the following shall apply:

- (A) The successful Bidder, at the time of the execution of the contract, shall provide a contract performance bond in the amount of one hundred percent (100%) of the contract amount, conditioned upon the faithful performance of the contract in accordance with the plans, specifications and conditions of the contract. Such bond shall be solely for the protection of the contracting body which awarded the contract.
- (B) The successful Bidder, at the time of the execution of the contract, shall provide a contract payment bond in the amount of one hundred percent (100%) of the contract amount, conditioned upon the prompt payment for all labor or materials for which a contractor or sub-contractor is liable. The payment bond shall be solely for the protection of the persons furnishing materials or performing labor for which a contractor or subcontractor is liable.

The performance bond and the payment bond shall be executed by one or more surety companies legally authorized to do business in the State of North Carolina and become effective upon the awarding of the construction contract.

Before an award is made, the apparent low bidder will be notified in writing to submit to the Purchasing Section, a performance bond and payment bond, each in the amount of 100% of the contract.

**DELIVERY OF BIDS**

All bids (complete proposal) shall be placed in a sealed envelope having the name and address of the Bidder, and the Statement on the outside of the envelope:

“Bid for State Highway Project No. BK-5127”

If delivered by mail, the sealed envelope shall be placed in another sealed envelope and the outer envelope addressed to:

N. C. DEPARTMENT OF TRANSPORTATION  
BRIDGE MAINTENANCE UNIT  
4809 BERYL ROAD  
RALEIGH, NC 27606

ATTENTION: Mr. Rick Nelson

The outer envelope shall also bear the statement:

“BID FOR STATE HIGHWAY PROJECT NO. BK-5127”

If delivered in person, the sealed envelope shall be delivered to the office of North Carolina Department of Transportation, Bridge Maintenance Unit, 4809 Beryl Road, Raleigh, NC 27606. All bids shall be delivered prior to the time specified in the invitation to bid. Bids received after 2:00 PM, August 19, 2010, will not be accepted.

## **GENERAL PROJECT SPECIAL PROVISIONS**

### **SCOPE OF WORK**

#### **Location and Description of Bridge**

Carteret County Bridge No. 33 is located on US 70 over the North River, near Bettie NC. The bridge was built in 1959 and is approximately 1,028 long and consists of 47 spans of reinforced concrete deck slabs approximately 22' in length. The clear roadway width is 28' and the average daily traffic is approximately 9400 vehicles per day.

#### **Description of Work**

This work shall consist of furnishing all labor, materials and equipment to make repairs to deteriorated concrete caps, underdeck and piles; including shotcrete repairs to caps and underdeck, encapsulating existing 12" square concrete piles with fiberglass reinforced polymer pile jackets with a pumped epoxy grout fill material; and installing reinforced concrete jackets on existing 12" square concrete piles as shown in the contract documents and plans. Contractor shall provide all necessary access; boats, barges, scaffolding, ladders, etc.; provide all traffic control (both vehicular and navigational); coordinate all navigation channel work with the US Coast Guard; provide all staging area, material storage, boat storage and boat access; provide environmental controls to limit loss of materials into water and air; sawing and chipping equipment, and cleaning equipment; and all else necessary to complete the work.

The contractor shall be responsible for fulfilling all requirements of the NCDOT Standard Specifications for Roads and Structures dated July 2006, except as otherwise specified herein.

### **CONTRACT TIME AND LIQUIDATED DAMAGES**

The date of availability for this contract is September 13, 2010.

The completion date for this contract is June 9, 2011.

The liquidated damages for this contract time are Five Hundred Dollars (\$500.00) per calendar day. After award of the project, the Contractor shall notify the Engineer of his expected date for beginning work. Should the Contractor desire to revise this date, he shall notify the Engineer in writing at least thirty (30) days prior to the revised date.

At the pre-construction conference, the Contractor shall declare his expected date for beginning work.

### **INTERMEDIATE CONTRACT TIME NO. 1 AND LIQUIDATED DAMAGES**

The Contractor shall complete the required work of installing, maintaining, and removing the traffic control devices for lane closures and restoring traffic to the existing traffic pattern. The Contractor shall not narrow or close a lane of traffic on any roadway during the following time restrictions:

US 70:            From 6:00 AM to 8:30 AM Monday thru Friday



In addition, the Contractor shall not close or narrow a lane of traffic on any roadway, detain/or alter the traffic flow on or during holidays, holiday weekends, special events, or any other time when traffic is unusually heavy, including the following schedules:

**HOLIDAY AND HOLIDAY WEEKEND LANE CLOSURE RESTRICTIONS:**

1. For **unexpected occurrence** that creates unusually high traffic volumes, as directed by the Engineer.
2. For **New Year's Day**, between the hours of 6:00 pm December 31st to 6:00 am January 2nd. If New Year's Day is on Friday, Saturday, Sunday or Monday, then until 6:00 am the following Tuesday.
3. For **Easter**, between the hours of 6:00 pm Thursday and 6:00 am Monday.
4. For **Memorial Day**, between the hours of 6:00 pm Friday and 6:00 am Tuesday.
5. For **Independence Day**, between the hours of 6:00 pm the day before Independence Day and 6:00 am the day after Independence Day. If Independence Day is on a Friday, Saturday, Sunday or Monday, then between the hours of 6:00 pm the Thursday before Independence Day and 6:00 am the Tuesday after Independence Day.
6. For **Labor Day**, between the hours of 6:00 pm Friday and 6:00 am Tuesday.
7. For **Thanksgiving Day**, between the hours of 6:00 pm Tuesday and 6:00 am Monday.
8. For **Christmas**, between the hours of 6:00 pm the Friday before the week of Christmas Day and 6:00 am the following Tuesday after the week of Christmas Day.
9. For the Core Sound Decoy Festival event, between the hours of 3:00 pm the day before the festival and 6:00 am the Monday after the festival.

Holidays and holiday weekends shall include New Years, Easter, Memorial Day, Independence Day, Labor Day, Thanksgiving, and Christmas. The Contractor shall schedule his work so that lane closures are not required during these periods, unless otherwise directed by the Engineer.

The time of availability for this intermediate contract time shall be the time the Contractor begins to install all traffic control devices for daytime and nighttime lane closures according to the time restrictions listed above.

The completion time for this intermediate contract time shall be the time the Contractor is required to complete the removal of traffic control devices required for daytime and nighttime lane closures according to the time restrictions stated above and restore traffic to the existing pattern.

The liquidated damages are Two Hundred Fifty Dollars (\$250.00) per 15 minute period.

## **CONSTRUCTION METHODS**

The contractor shall perform all construction activities in accordance with the applicable requirements of the NCDOT Standard Specifications for Roads and Structures dated July 2006, except as otherwise specified herein.

## **SITE INVESTIGATION AND REPRESENTATION**

The Contractor acknowledges that he has satisfied himself as to the nature of the work, and general and local conditions; particularly those bearing on transportation, availability of labor, State Regulations for safety and security of property, roads, and facilities required for the prosecution of the work, and all matters which can in any way affect the work, or cost thereof, under this contract. Any failure by the Contractor to acquaint himself with all the available information concerning these conditions will not relieve him from the responsibility for estimating properly the difficulty or cost of successfully performing the work.

## **CONTROL OF EROSION, SILT AND POLLUTION**

Control of erosion, siltation, and pollution shall meet the requirements of Section 107-13 of the Standard Specifications for Roads and Structures dated July 2006.

The Contractor may, at his option, submit an alternate plan and sequence by submitting 3 copies of the proposed alternate to the Engineer for approval. Approval must be obtained before construction is started on the alternate plan.

In the event an erosion and sedimentation control plan is not followed or properly maintained, all other work shall be suspended until corrections are made.

## **MATERIALS AND TESTING**

The Engineer reserves the right to perform all sampling and testing in accordance with Section 106 of the Standard Specifications and the Department's "Material and Tests Manual". All material must be approved by the Engineer prior to being used.

## **TRAFFIC CONTROL**

Provide all traffic control devices necessary to complete this project in accordance with the Traffic Control Plans and the US Coast Guard requirements for waterway traffic. The Contractor shall, at the direction of the Engineer, modify the traffic control devices and traffic handling plan to adequately handle traffic through the worksite.

## **INDEMNIFICATION**

The Contractor shall indemnify, defend and save harmless, the State, the Department, and all of its officers, agents and employees from all damages, suits, actions or claims brought of any injuries or damages sustained by any person or property on account of the Contractor's

operations in connection with the contract. It is specifically understood and agreed that this indemnification agreement does not cover or indemnify the Department for its own negligence, breach of contract, equipment failure, or other circumstance of operation beyond the control of the Contractor. The Contractor shall be responsible for and indemnify and save the Department harmless for any and all damages to its property caused by the negligence of the Contractor, its employees or agents in carrying out this contract.

### **COMPENSATION**

The Department agrees to pay the Contractor the total project bid cost including any bid item overruns, minus any liquidated damages, when he has satisfactorily completed the scheduled work described herein.

### **ADDITIONAL COMPENSATION and/or EXTENSION OF COMPLETION DATE**

Any claims for additional compensation and/or extensions of the completion date shall be submitted to the State Bridge Management Engineer with detailed justification within thirty (30) days after receipt of final invoice payment. The failure on the part of the Contractor to submit the claim(s) within thirty (30) days shall be a bar to recovery.

### **BASIS OF PAYMENT**

Monthly partial payments will be made in accordance with Section 109-4 of the NCDOT Standard Specifications dated July 2006.

### **WORK PROCEDURES AND ASSIGNMENTS**

#### **Engineer**

The Engineer for this project shall be the State Bridge Management Engineer, thru the issuing of the purchase order. Thereafter the Engineer shall be the Division 2 Engineer, Division of Highways, North Carolina Department of Transportation, acting directly or through his duly authorized representatives.

#### **Authority of the Engineer**

The Engineer will decide all questions which may arise as to the quality and acceptability of work performed and as to the rate of progress of the work; all questions which may arise as to the interpretation of the contract; and all questions as to the acceptable fulfillment of the contract on the part of the Contractor. His decision shall be final and he shall have executive authority to enforce and make effective such decisions and orders as the Contractor fails to carry out promptly.

#### **Contractor Supervision**

The Contractor shall have a responsible Supervisor for the purpose of supervising, scheduling and coordinating this contract with the Engineer.

#### **Availability**

Provisions shall be made so that a Supervisor can be contacted at any time during the work day during the length of the contract and during nights and weekends for the duration of the road closure.

### **COMPETITIVE PROPOSALS**

Pursuant to the provisions of G.S. 143-54 under penalty of perjury, the signer of this proposal certifies this proposal has not been arrived at collusively nor otherwise in violation of Federal or North Carolina Anti-Trust Laws. All proposals must be signed by the owner or an officer of the firm.

### **ACCEPTANCE AND REJECTION**

The right is reserved by the Contracting Agency to accept or reject all proposals or to waive any informality in the proposals.

### **PROJECT COMMITMENTS MADE THROUGH PERMIT COORDINATION**

1. There is no in water work moratorium for this project.
2. No Division of Coastal Management (DCM) permit is required for the proposed work. The DCM Representative, Stephen Lane, has been notified of the proposed work.
3. A Nationwide Permit 3 and 25 will be required for this project. The project will also be subject to any applicable conditions under Section 3 of the Wilmington District Regional Conditions for Nationwide Permits.
4. No Division of Water Quality permit is required. The project is subject to any applicable conditions per Water Quality Certification #3687. The Division of Water Quality representative, Garcy Ward, has been notified of the proposed work.
5. A turbidity curtain shall be used during any bottom disturbance activities that would result from installing pile jackets below the mud line.

## **PROJECT SPECIAL PROVISIONS**

### **COORDINATION WITH THE U. S. COAST GUARD**

(SPECIAL)

The Contractor will not be allowed to begin any work associated with the channel span until a proposed work plan has been approved by the United States Coast Guard. The Contractor shall submit his proposed work plan to the Resident Engineer for forwarding to the Coast Guard for approval. These plans shall be submitted to the Engineer a minimum of one (1) month prior to the date the Contractor plans on beginning his operations in the channel span. The proposed work plan shall detail the change in vertical clearance for the channel span during the Contractor's time of operation in this area; detail the work to be performed and how said work will be performed; detail schedules (including begin and end dates) for the work on the channel span; and any other information that will help describe the work to the Coast Guard and assist in putting together the required Notice to Mariners that will be broadcast during the channel span work.

At no time during work will the waterway be closed or narrowed to navigation without prior approval from the Coast Guard. The contractor is required to maintain close and regular contact with the Coast Guard, Sector North Carolina to keep them informed to activities in the waterway with Steve Lyons at (252)-247-4525 or email [Stephen.w.lyons2@uscg.mil](mailto:Stephen.w.lyons2@uscg.mil). Also must contact the 5<sup>th</sup> Coast Guard District with Bill Brazier at (757) 398-6422 or email at [Bill.H.Brazier@uscg.mil](mailto:Bill.H.Brazier@uscg.mil).

All waterway narrowing or closures shall be requested in writing and shall be received by the District Commander of the Coast Guard at least 30 days in advance of the closure so that the appropriate marine notifications can be made.

All work shall be conducted so that free navigation of the waterway is not unreasonably interfered with and the present navigable depths are not impaired. Timely notice of any and all events that affect navigation shall be given to the District Commander during the work on the moveable span. The channel shall be promptly cleared of all obstructions placed therein or caused by the contractor.

### **SECURING OF VESSELS**

(10-12-01)

Secure vessels in accordance with Section 107 of the Standard Specifications and the following provision:

When utilizing barges, tugboats or other vessels, take all necessary precautions to ensure that such vessels are securely anchored or moored when not in active operation. Take all necessary measures to ensure that the vessels are operated in a manner that avoids damage to or unnecessary contact with bridges and other highway structures and attachments. If severe weather conditions are anticipated, or should be anticipated through reasonable monitoring of weather forecasts, take additional measures to protect bridges and other highway structures and attachments from extreme conditions. The Contractor is strictly liable for damages to any bridge or other highway structure or attachment caused by a vessel owned or controlled by the

Contractor. The Contractor is also liable to third parties for property damages and loss of revenue caused by vessels under the Contractor's control.

**WORK IN, OVER OR ADJACENT TO NAVIGABLE WATERS:** (SPECIAL)

All work in, over, or adjacent to navigable waters shall be in accordance with the special provisions and conditions contained in the permits obtained by the Department from the U.S. Coast Guard, U.S. Army Corps of Engineers, or other authority having jurisdiction. The work shall have no adverse effect on navigation of the waterway including traffic flow, navigational depths, and horizontal and vertical clearances without approval from the authorities granting the permits.

The Contractor shall prepare drawings necessary to obtain any permits which may be required for his operations which are not included in the Department's permit including but not limited to excavation and dumping, constructing wharves, piers, ramps, and other structures connecting to bank or shore, and drawings for constructing falsework, cofferdams, sheeting, temporary bridges, and any other construction within the waterway. Submittals shall show locations of such work with respect to the navigational opening. The Contractor shall coordinate the submittal of drawings with the Engineer.

All construction shall progress and be maintained in a safe and timely manner. Temporary construction facilities shall be removed completely and promptly upon discontinuation of their useful purpose

The Contractor shall immediately notify the appropriate authorities and take corrective measures as needed when any situation occurs that imposes a threat to the public. He shall also immediately correct any acts or occurrences that contradict or violate any requirements in the plans, special provisions, or permits when corrective measures can be performed in a safe manner. The Contractor shall notify the appropriate authorities when such corrective measures cannot be performed in a safe manner.

All costs incurred by the Contractor in complying with the above requirements shall be included in the prices bid for the various pay items and no additional payment will be made.

**SUBMITTAL OF WORKING DRAWINGS** SPECIAL

**General**

Submit working drawings in accordance with Article 105-2 of the *Standard Specifications* and this provision. For this provision, "submittals" refers to only those listed in this provision. The list of submittals contained herein does not represent a complete list of required submittals for the project. Submittals are only necessary for those items as required by the contract. **Make submittals that are not specifically noted in this provision directly to the Resident Engineer.**

If a submittal contains variations from plan details or specifications or significantly affects project cost, field construction or operations, discuss the submittal with and submit all copies to the Resident Engineer. State the reason for the proposed variation in the submittal. To minimize review time, make sure all submittals are complete when initially submitted. Provide a contact

name and information with each submittal. Direct any questions regarding submittal requirements to the Resident Engineer or State Bridge Management Unit.

In order to facilitate in-plant inspection by NCDOT and approval of working drawings, provide the name, address and telephone number of the facility where fabrication will actually be done if different than shown on the title block of the submitted working drawings. This includes, but is not limited to, precast concrete items, prestressed concrete items and fabricated steel or aluminum items.

**Addresses and Contacts**

Mail submittals to:

Mr. Rick Nelson, PE  
 Asst. State Bridge Management Engineer  
 NC Dept. of Transportation  
 State Bridge Management Unit  
 4809 Beryl Drive  
 Raleigh, NC 27606  
 Fax: 919.733.2348  
 Ph: 919.733.4362  
 Email: enelson@ncdot.gov

Furnish one complete copy of each submittal, including all attachments, to the Resident Engineer. At the same time, submit the number of hard copies shown below of the same complete submittal directly to the State Bridge Management Unit and/or the Structure Design Unit.

The table below covers “Structure Submittals”. The Resident Engineer will receive review comments and drawing markups for these submittals from the State Bridge Management Unit.

Unless otherwise required, submit one set of supporting calculations to either the State Bridge Management Unit or Structure Design Unit unless both units require submittal copies in which case submit a set of supporting calculations to each unit. Provide additional copies of any submittal as directed by the Engineer.

**STRUCTURE SUBMITTALS**

Submittal	Copies Required by SBMU	Copies Required by Structure Design Unit	Contract Reference Requiring Submittal <sup>1</sup>
Falsework & Forms <sup>2</sup> (substructure)	5	0	Article 420-3 & “Falsework and Formwork”
Falsework & Forms (superstructure)	5	0	Article 420-3 & “Falsework and Formwork”
Placement of Equipment on Structures (cranes, blasting/painting equip., etc.)	5	0	Article 420-20
Painting Platforms and Containment	5	0	SP

## **FALSEWORK AND FORMWORK**

(8-4-09)

### **Description**

Use this Special Provision as a guide to develop temporary works submittals required by the Standard Specifications or other provisions; no additional submittals are required herein. Such temporary works include, but are not limited to, falsework and formwork.

Falsework is any temporary construction used to support the permanent structure until it becomes self-supporting. Formwork is the temporary structure or mold used to retain plastic or fluid concrete in its designated shape until it hardens. Access scaffolding is a temporary structure that functions as a work platform that supports construction personnel, materials, and tools, but is not intended to support the structure. Scaffolding systems that are used to temporarily support permanent structures (as opposed to functioning as work platforms) are considered to be falsework under the definitions given. Shoring is a component of falsework such as horizontal, vertical, or inclined support members. Where the term “temporary works” is used, it includes all of the temporary facilities used in bridge construction that do not become part of the permanent structure.

Design and construct safe and adequate temporary works that will support all loads imposed and provide the necessary rigidity to achieve the lines and grades shown on the plans in the final structure.

### **Materials**

Select materials suitable for temporary works; however, select materials that also ensure the safety and quality required by the design assumptions. The Engineer has authority to reject material on the basis of its condition, inappropriate use, safety, or nonconformance with the plans. Clearly identify allowable loads or stresses for all materials or manufactured devices on the plans. Revise the plan and notify the Engineer if any change to materials or material strengths is required.

### **Design Requirements**

#### **Working Drawings:**

Provide working drawings for items as specified in the contract, or as required by the Engineer, with design calculations and supporting data in sufficient detail to permit a structural and safety review of the proposed design of the temporary work.

When concrete placement is involved, include data such as the drawings of proposed sequence, rate of placement, direction of placement, and location of all construction joints. Submit the number of copies as called for by the contract.

When required, have the drawings and calculations prepared under the guidance of, and sealed by, a North Carolina Registered Professional Engineer who is knowledgeable in temporary works design.

Design falsework and formwork requiring submittals in accordance with the 1995 AASHTO Guide Design Specifications for Bridge Temporary Works except as noted herein.



**Wind Loads:**

Table 2.2 of Article 2.2.5.1 is modified to include wind velocities up to 110 mph (177 km/hr). In addition, Table 2.2A is included to provide the maximum wind speeds by county in North Carolina.

**Table 2.2 - Wind Pressure Values**

Height Zone feet (m) above ground	Pressure, lb/ft <sup>2</sup> (kPa) for Indicated Wind Velocity, mph (km/hr)				
	70 (112.7)	80 (128.7)	90 (144.8)	100 (160.9)	110 (177.0)
0 to 30 (0 to 9.1)	15 (0.72)	20 (0.96)	25 (1.20)	30 (1.44)	35 (1.68)
30 to 50 (9.1 to 15.2)	20 (0.96)	25 (1.20)	30 (1.44)	35 (1.68)	40 (1.92)
50 to 100 (15.2 to 30.5)	25 (1.20)	30 (1.44)	35 (1.68)	40 (1.92)	45 (2.15)
over 100 (30.5)	30 (1.44)	35 (1.68)	40 (1.92)	45 (2.15)	50 (2.39)

**Time of Removal:**

The following requirements replace those of Article 3.4.8.2.

Do not remove forms until the concrete has attained strengths required in Article 420-16 of the Standard Specifications and these Special Provisions.

Do not remove forms until the concrete has sufficient strength to prevent damage to the surface.

**Table 2.2A - Steady State Maximum Wind Speeds by Counties in North Carolina**

COUNTY	25 YR (mph) (km/hr)	COUNTY	25 YR (mph) (km/hr)	COUNTY	25 YR (mph) (km/hr)
Alamance	70 (112.7)	Franklin	70 (112.7)	Pamlico	100 (160.9)
Alexander	70 (112.7)	Gaston	70 (112.7)	Pasquotank	100 (160.9)
Alleghany	70 (112.7)	Gates	90 (144.8)	Pender	100 (160.9)
Anson	70 (112.7)	Graham	80 (128.7)	Perquimans	100 (160.9)
Ashe	70 (112.7)	Granville	70 (112.7)	Person	70 (112.7)
Avery	70 (112.7)	Greene	80 (128.7)	Pitt	90 (144.8)
Beaufort	100 (160.9)	Guilford	70 (112.7)	Polk	80 (128.7)
Bertie	90 (144.8)	Halifax	80 (128.7)	Randolph	70 (112.7)
Bladen	90 (144.8)	Harnett	70 (112.7)	Richmond	70 (112.7)
Brunswick	100 (160.9)	Haywood	80 (128.7)	Robeson	80 (128.7)
Buncombe	80 (128.7)	Henderson	80 (128.7)	Rockingham	70 (112.7)
Burke	70 (112.7)	Hertford	90 (144.8)	Rowan	70 (112.7)
Cabarrus	70 (112.7)	Hoke	70 (112.7)	Rutherford	70 (112.7)
Caldwell	70 (112.7)	Hyde	110 (177.0)	Sampson	90 (144.8)
Camden	100 (160.9)	Iredell	70 (112.7)	Scotland	70 (112.7)
Carteret	110 (177.0)	Jackson	80 (128.7)	Stanley	70 (112.7)
Caswell	70 (112.7)	Johnston	80 (128.7)	Stokes	70 (112.7)
Catawba	70 (112.7)	Jones	100 (160.9)	Surry	70 (112.7)
Cherokee	80 (128.7)	Lee	70 (112.7)	Swain	80 (128.7)
Chatham	70 (112.7)	Lenoir	90 (144.8)	Transylvania	80 (128.7)
Chowan	90 (144.8)	Lincoln	70 (112.7)	Tyrell	100 (160.9)
Clay	80 (128.7)	Macon	80 (128.7)	Union	70 (112.7)
Cleveland	70 (112.7)	Madison	80 (128.7)	Vance	70 (112.7)
Columbus	90 (144.8)	Martin	90 (144.8)	Wake	70 (112.7)
Craven	100 (160.9)	McDowell	70 (112.7)	Warren	70 (112.7)
Cumberland	80 (128.7)	Mecklenburg	70 (112.7)	Washington	100 (160.9)
Currituck	100 (160.9)	Mitchell	70 (112.7)	Watauga	70 (112.7)
Dare	110 (177.0)	Montgomery	70(112.7)	Wayne	80 (128.7)
Davidson	70 (112.7)	Moore	70 (112.7)	Wilkes	70 (112.7)
Davie	70 (112.7)	Nash	80 (128.7)	Wilson	80 (128.7)
Duplin	90 (144.8)	New Hanover	100 (160.9)	Yadkin	70 (112.7)
Durham	70 (112.7)	Northampton	80 (128.7)	Yancey	70 (112.7)
Edgecombe	80 (128.7)	Onslow	100 (160.9)		
Forsyth	70 (112.7)	Orange	70 (112.7)		

Note on the working drawings any anchorages, connectors, inserts, steel sleeves or other such devices used as part of the falsework or formwork that remains in the permanent structure. If the plan notes indicate that the structure contains the necessary corrosion protection required for a Corrosive Site, epoxy coat, galvanize, metallize or otherwise protect these devices as directed by the Engineer. Any coating required by the Engineer will be considered incidental to the various pay items requiring temporary works.

## **Review and Approval**

The Engineer is responsible for the review and approval of temporary works' drawings. Submit the working drawings sufficiently in advance of proposed use to allow for their review, revision (if needed), and approval without delay to the work.

Do not start construction of any temporary work for which working drawings are required until the drawings have been approved. Such approval does not relieve the Contractor of the responsibility for the accuracy and adequacy of the working drawings.

The time period for review of the working drawings does not begin until complete drawings and design calculations, when required, are received by the Engineer.

On the drawings, show all information necessary to allow the design of any component to be checked independently as determined by the Engineer.

If requested by the Engineer, submit with the working drawings manufacturer's catalog data listing the weight of all construction equipment that will be supported on the temporary work. Show anticipated total settlements and/or deflections of falsework and forms on the working drawings. Include falsework footing settlements, joint take-up, and deflection of beams or girders. Falsework hangers that support concentrated loads and are installed at the edge of thin top flange concrete girders (such as bulb tee girders) shall be spaced so as not to exceed 75% of the manufacturer's stated safe working load. Use of dual leg hangers (such as Meadow Burke HF-42 and HF-43) are not allowed. Design the falsework and forms supporting deck slabs and overhangs on girder bridges so that there will be no differential settlement between the girders and the deck forms during placement of deck concrete.

## **Construction Requirements**

All requirements of Section 420 of the Standard Specifications apply.

Construct temporary works in conformance with the approved working drawings. Ensure that the quality of materials and workmanship employed is consistent with that assumed in the design of the temporary works. Do not weld falsework members to any portion of the permanent structure unless approved. Show any welding to the permanent structure on the approved construction drawings.

Provide tell-tales attached to the forms and extending to the ground, or other means, for accurate measurement of falsework settlement. Make sure that the anticipated compressive settlement and/or deflection of falsework does not exceed 1 inch (25 mm). For cast-in-place concrete structures, make sure that the calculated deflection of falsework flexural members does not exceed 1/240 of their span regardless of whether or not the deflection is compensated by camber strips.

## **Maintenance and Inspection:**

Inspect and maintain the temporary work in an acceptable condition throughout the period of its use. Certify that the manufactured devices have been maintained in a condition to allow them to safely carry their rated loads. Clearly mark each piece so that its capacity can be readily determined at the job site.

Perform an in-depth inspection of an applicable portion(s) of the temporary works, in the presence of the Engineer, not more than 24 hours prior to the beginning of each concrete placement. Inspect other temporary works at least once a month to ensure that they are functioning properly. Have a North Carolina Registered Professional Engineer inspect the cofferdams, shoring, sheathing, support of excavation structures, and support systems for load tests prior to loading.

Foundations:

Determine the safe bearing capacity of the foundation material on which the supports for temporary works rest. If required by the Engineer, conduct load tests to verify proposed bearing capacity values that are marginal or in other high-risk situations.

The use of the foundation support values shown on the contract plans of the permanent structure is permitted if the foundations are on the same level and on the same soil as those of the permanent structure.

Allow for adequate site drainage or soil protection to prevent soil saturation and washout of the soil supporting the temporary works supports.

If piles are used, the estimation of capacities and later confirmation during construction using standard procedures based on the driving characteristics of the pile is permitted. If preferred, use load tests to confirm the estimated capacities; or, if required by the Engineer conduct load tests to verify bearing capacity values that are marginal or in other high risk situations.

The Engineer reviews and approves the proposed pile and soil bearing capacities.

**Removal**

Unless otherwise permitted, remove and keep all temporary works upon completion of the work. Do not disturb or otherwise damage the finished work.

Remove temporary works in conformance with the contract documents. Remove them in such a manner as to permit the structure to uniformly and gradually take the stresses due to its own weight.

**Method of Measurement**

Unless otherwise specified, temporary works will not be directly measured.

**Basis of Payment**

Payment at the contract unit prices for the various pay items requiring temporary works will be full compensation for the above falsework and formwork.

**ADHESIVELY ANCHORED ANCHOR BOLTS OR DOWELS**

(6-11-07)

**General**

Installation and Testing of Adhesively anchored anchor bolts and dowels shall be in accordance with Section 420-13, 420-21 and 1081-1 of the Standard Specifications except as modified in this provision.

## **Installation**

Installation of the adhesive anchors shall be in accordance with manufacturer's recommendations and shall occur when the concrete is above 40 degrees Fahrenheit and has reached its 28 day strength.

The anchors shall be installed before the adhesive's initial set ('gel time').

## **Field Testing**

Replace the third paragraph of Section 420-13 (C) with the following:

“In the presence of the Engineer, field test the anchor bolt or dowel in accordance with the test level shown on the plans and the following:.

Level One Field testing: Test a minimum of 1 anchor but not less than 10% of all anchors to 50% of the yield load shown on the plans. If less than 60 anchors are to be installed, install and test the required number of anchors prior to installing the remaining anchors. If more than 60 anchors are to be installed, test the first 6 anchors prior to installing the remaining anchors, then test 10% of the number in excess of 60 anchors.

Level Two Field testing: Test a minimum of 2 anchors but not less than 10% of the all anchors to 80% of the yield load shown on the plans. If less than 60 anchors are to be installed, install and test the required number of anchors prior to installing the remaining anchors. If more than 60 anchors are to be installed, test the first 6 anchors prior to installing the remaining anchors, then test 10% of the number in excess of 60 anchors.

Testing should begin only after the Manufacturer's recommended cure time has been reached. For testing, apply and hold the test load for three minutes. If the jack experiences any drop in gage reading, the test must be restarted. For the anchor to be deemed satisfactory, the test load must be held for three minutes with no movement or drop in gage reading.”

## **Removal and Replacement of Failed Test specimens:**

Remove all anchors and dowels that fail the field test without damage to the surrounding concrete. Redrill holes to remove adhesive bonding material residue and clean the hole in accordance with specifications. For reinstalling replacement anchors or dowels, follow the same procedures as new installations. Do not reuse failed anchors or dowels unless approved by the Engineer.

## **Usage**

The use of adhesive anchors for overhead installments is not permitted without written permission from the Engineer.

## **Basis of Payment**

No separate measurement or payment will be made for furnishing, installing, and testing anchor bolts/dowels. Payment at the contract unit prices for the various pay items will be full compensation for all materials, equipment, tools, labor, and incidentals necessary to complete the work.

**Description**

Work includes removal of concrete in spalled areas of the existing caps and underdeck areas in reasonably close conformity with the lines, depth, and details shown on the plans, described herein and as established by the Engineer. This work also includes straightening, cleaning, and replacement of reinforcing steel, dowelling new reinforcing steel, removing all loose materials, removing and disposing of debris, applying repair material, and protecting adjacent areas of the bridge and environment from material leakage. The repair material and methods shall be as described below unless otherwise noted in the plans or provisions.

The location and extent of repairs shown on the plans described herein are general in nature. The Engineer determines the exact extent of removal in the field based on an evaluation of the condition of the exposed surfaces.

Repair, to the Engineer's satisfaction, any portion of the structure that is damaged from construction operations. No extra payment is provided for these repairs.

**Shotcrete Repairs****Shotcrete**

Qualification of Shotcrete Contractor

*Shotcrete Contractors are not acceptable as a Prime Contractor or Subcontractor unless all of following requirements are met:*

The Shotcrete Contractor furnishes proof that his or her company has a minimum of 5 years experience in shotcrete repair work on jobs of similar size and character.

The Shotcrete Contractor furnishes five references who were responsible for supervision of similar projects and testifies to the successful completion of these projects. Include name, address, and telephone number. Prior to starting work, the Contractor's nozzlemen are required to pass a test demonstrating their competence. This test is conducted at the job site and approximates actual working conditions as near as possible. For test requirements, see ACI 506.3R, Chapters 2.5 and 3. Only workmanship demonstration is tested.

**General**

When shotcreting, meet all requirements of ACI 506.2, published by the American Concrete Institute, Detroit, Michigan, except as modified by the requirements of this Special Provision.

Prior to beginning any repair work, provide a sufficiently sized temporary work platform at each repair location as required. Design steel members meeting the requirements of the American Institute of Steel Construction Manual. Design timber members in accordance with the "National Design Specification for Stress-Grade Lumber and Its Fastenings" of the National Forest Products Association. Submit the platform structure design for review and approval. Do not install the platform until the design is approved. Do not drill holes into the superstructure. When the platform is removed, remove all anchorages made in the substructure and repair the substructure at no additional cost to the Department.

**Material**

Use materials conforming to the requirements of the applicable sections of the Standard Specifications and the following provisions:

Use Type II Cement. Replace ten percent by weight of the cement with silica fume. Do not use admixtures without approval.

Produce shotcrete cores with a compressive strength of 5000 psi (34.5 MPa) at 28 days. The provisions of ACI 506.2, Section 1.6.3.3, Paragraph 2, do not apply.

Submit the shotcrete mix design, including the source of the material, to the Engineer for acceptance before using it.

Use size 2S or 2MS fine aggregate unless otherwise approved.

### **Finish**

Slightly build up and trim the shotcrete surface to the final surface by cutting with the leading edge of a sharp trowel. Use a rubber float to float any imperfections. Limit work on the finished surface to correcting imperfections caused by trowel cutting.

### **Testing**

Each day shotcreting takes place, have each nozzleman shoot one 18" x 18" x 3" (460 mm x 460 mm x 75 mm) Test Panel. Shoot the panel in the same position as the repair work that is being done. The panel demonstrates whether the shotcrete is being properly applied and furnishes cores for testing compressive strength. Drill three 3" (76 mm) diameter cores from each test panel and also drill cores from the repair areas as directed by the Engineer. Do not take cores from repaired areas until the shotcrete has cured for 7 days. Drill a core that penetrates into the existing substructure concrete at least 2 inches (50 mm). These cores are inspected for delaminations and sand pockets and tested for bond strength and/or compressive strength. If a core taken from a repaired area indicates unsatisfactory application or performance of the shotcrete, take additional cores from the applicable repair area(s) for additional evaluation and testing as directed by the Engineer. No extra payment is provided for drilling extra cores. Patch all core holes in the repaired substructure units to the satisfaction of the Engineer.

All material, sample, and core testing is done by the Materials and Tests Unit of North Carolina Department of Transportation.

### **Mixture**

Mix the shotcrete in the proportions of one part of portland cement to four parts of sand, and as directed by the Engineer.

Measure this mixture by volume in the dry loose state. Check batching equipment daily or at the discretion of the Engineer.

### Repair Method and Operations

Prior to starting the repair operation, delineate all surfaces and areas assumed to be deteriorated by visually examining and by sounding the concrete surface with a hammer or any other alternative approved method. The Engineer is the sole judge in determining the limits of deterioration.

Remove all deteriorated concrete to sound concrete with a 17 lb (7.7 kg) (maximum) pneumatic hammer with points that do not exceed the width of the shank or with hand picks or chisels as directed by the Engineer. Do not cut or remove the existing reinforcing steel. Do not remove more existing concrete than required to expose the surface of the sound concrete. Unless specifically directed by the Engineer, do not remove concrete deeper than 6 inches (150 mm) or deeper than 1 inch (25 mm) below the reinforcing steel.

If sound concrete is encountered before existing reinforcing steel is exposed, prepare and repair the surface without removing any more concrete. However, if the reinforcing steel is wholly or partially exposed, remove the deteriorated and/or sound concrete to a minimum clearance of 1 inch (25 mm) all around the reinforcing steel.

Sandblast all exposed concrete surfaces and existing reinforcing steel in repair areas to remove all debris, loose concrete, loose mortar, rust, scale, etc. Use a wire brush to clean all exposed reinforcing steel surfaces facing away from the sandblast nozzle to remove all dust and loose particles.

All material removed becomes the Contractor's. Use an approved method to dispose of the material.

Restore all repaired members, including chamfered edges, as close as practicable to their original "As Built" dimensions and configuration. Provide a minimum of 2" (50 mm) shotcrete cover over reinforcing steel exposed during repair. Finish the shotcrete by cutting the surface to final grade with the leading edge of a trowel.

Provide welded wire fabric at each repair area larger than 1 ft<sup>2</sup> (0.1 m<sup>2</sup>). Provide a minimum 2" x 2" (50 mm x 50 mm) - 12 gage galvanized welded wire fabric. Rigidly secure the welded wire fabric to existing steel or to 3/16" (4.76 mm) minimum diameter adequately spaced galvanized hook fasteners to prevent sagging. Encase the welded wire fabric in shotcrete to a minimum depth of 1½ inches (38 mm).

If preferred, use steel or synthetic fiber reinforcement as an alternate to welded wire fabric. Work only with experienced personnel. Always work under the direction of an experienced superintendent. The superintendent is required to show a certified experience record indicating at least 5 years experience on work of similar type. No nozzleman is deemed experienced unless they have worked on several other jobs similar to that specified herein and have passed the required pre-qualification test listed in this Special Provision.

Before applying the shotcrete to the surface, thoroughly clean the surface of all dirt, grease, oil or foreign matter, and remove all loose or weakened material.



Wash the roughened existing concrete surface with fresh potable water and an air blast, or with a “stiff” hose stream of fresh water until all loosened materials and salt water spray are removed. Perform this operation 30 minutes to 1 hour prior to applying the shotcrete. Maximum time allowed between removal of deteriorated concrete and shotcrete application is 5 days. If the time allowance is exceeded it will be necessary to prepare the surface again using the methods described above before shotcrete can be applied.

Apply shotcrete in layers. The properties of the applied shotcrete determine the proper thickness of each layer or lift.

If a work stoppage longer than 2 hours takes place on any shotcrete layer prior to the time it has been built up to required thickness, thoroughly wash the surface with a fresh water stream and air hose as outlined previously, prior to continuing with the remaining shotcrete course. Do not apply shotcrete to a dry surface.

Have the nozzleman hold the nozzle 3 – 4 feet (0.9 to 1.2 m) from the surface being covered in a position that ensures the stream of flowing material strikes at approximately right angles to the surface being covered without excessive impact. Have the nozzleman control the water content so it never exceeds 3½ gallons (13.25 liters) per sack of cement. Direct the nozzlemen to maintain the water at a practicable minimum, dependent on weather conditions, so that the mix properly adheres. Control water content so that it does not become high enough to cause the mix to sag or fall from vertical or inclined surfaces, or to separate in horizontal layers.

Use shooting strips or guide wires that do not entrap rebound sand to bring the finished work to approximate shape. Use guide wires to provide a positive means of checking the total thickness of the shotcrete applied. Remove the guide wires prior to the final finish coat.

Blow or rake off sand that rebounds and does not fall clear of the work, or which collects in pockets in the work, to avoid leaving sand pockets in the shotcrete. Do not reuse rebound material in the work.

Apply shotcrete only when the air temperature is at least 40°F (4°C) and rising, but less than 95°F (35°C). Do not apply shotcrete to frosted surfaces. Maintain shotcrete at a minimum temperature of 40°F (4°C) for 3 days.

### **Testing Shotcrete Surfaces**

Immediately after bringing shotcrete surfaces to final thickness, thoroughly check them for sags, bridging, and other deficiencies. Approximately 3 days after completing the final shotcrete placement, thoroughly test it again with a hammer. At this time, the shotcrete should have sufficient strength for all sound sections to ring sharply. Remove and replace any unsound portions of the work found during this 3 day old inspection period, or at any other time prior to the final inspection of the work. No additional compensation is provided for removal and replacement of concrete during or after the 3 day old inspection.

### **Curing**

Begin curing as soon as the finished shotcrete surface withstands the curing operation without damage in accordance with Section 3.7 of ACI 506.2.

**Measurement and Payment**

*Deck and Cap Repair* will be measured and paid for at the contract unit price bid per cubic foot and will be full compensation for removal, containment and disposal off-site of unsound concrete including the cost of materials, labor, tools, equipment and incidentals necessary to accomplish removal. Depth will be measured from a place at the original outside concrete face. The Contractor and Engineer will measure repair quantities after removal of unsound concrete and before application of repair material. Such payment will also include the cost of sandblasting, surface cleaning and preparation, cleaning of reinforcing steel, cost of temporary work platform, testing of the soundness of the exposed concrete surface, furnishing and installation of repair mortar material, curing and sampling of concrete, and protection/cleaning of adjacent areas from splatter or leakage.

*Reinforcing Steel* that is required for the repairs will be in accordance with Section 425 of the *Standard Specifications*.

Payment will be made under:

<b>Pay Item</b>	<b>Pay Unit</b>
Deck and Cap Repair	Cubic Feet

**PILE ENCAPSULATION**

**SPECIAL**

**Description**

The work specified in this section consists of surface preparation of the pile, placement of a translucent, fiberglass reinforced plastic (FRP) jacket around the pile and injecting a water insensitive epoxy grout into the space between the jacket and the pile. The epoxy grout is batched, mixed and pumped by equipment, expressly designed for that purpose.

**Materials**

FRP Outer Jacket

The FRP Outer Jacket shall be Translucent FRP Jacket, as described in this section. For a submission to be approved it must meet ALL requirements of this section and approved by the engineer prior to the bid.

The translucent outer jacket shall be a marine grade laminate of fiberglass reinforced plastic (FRP), constructed of layers of woven roving and mat. Construction by the spray-up process, using a chopper gun, is not acceptable. The glass content shall be sufficient to meet the strength requirements found in Section 3.1.6, herein, but shall not be less than 30% of the laminate. An Ultra-Violet (UV) screening ingredient shall be integrally bound within the polyester matrix.

The strength and thickness of the outer jacket shall be as required to provide adequate strength and rigidity to withstand the forces and stresses it may be subjected to during handling, installation and the injection of epoxy grout, but shall not be less than 1/8 inch (3 mm) thick.

The outer jacket shall be translucent to the extent that the progression of epoxy grout inside the jacket during injection can be visually monitored from outside the jacket.

The outer jacket shall be equipped with 1" NPT injection ports, spaced at intervals not to exceed five (5) feet, along its entire length. The injection ports shall be positioned on alternately opposite sides of the jacket to allow for more even distribution of grout. The injection ports shall be of all-polymer construction and be fitted into the jacket wall prior to jacket installation, except in special situations, approved by the engineer, where a port may be added to accommodate an unanticipated jobsite condition.

The outer jacket shall have a sufficient number of polymer stand-offs, adhered to its inside surface, to maintain a minimum space between the pile and the jacket of 3/8 inch (9.5 mm). When loss of pile section exists, it may be necessary to use adjustable stand-offs to keep the outer jacket in proper alignment with the pile. At an adjustable stand-off location, a polymer boss shall be adhered to the inside surface of the jacket to provide adequate thread length to accommodate the adjustable polymer screw.

The outer jacket material, exclusive of polymer stand-offs and injection ports, shall possess the following minimum physical properties.

1. Ultimate Tensile Strength per ASTM D-638: 10,000 PSI
2. IZOD Impact Strength per ASTM D-256: 15 ft-lbf/inch. (Notched Sample)
3. Barcol Hardness per ASTM D-2583: 30
4. Water Absorption per ASTM D-570: 1% Maximum
5. Ultra Violet (UV) Stability as demonstrated by Accelerated Weathering Tests per ASTM G-23: Samples of outer jacket subjected to 500 hour exposure in Twin Carbon Arc Weather-ometer (ASTM G-23, Type D) operated at 145 degrees F., shall not exhibit any chipping, flaking or peeling. Said test to be conducted in twenty (20) minute cycles, consisting of seventeen (17) minutes of arc light and three (3) minutes of water spray, throughout the 500 hour test duration.

The outer jacket shall be fabricated in sections. Each section shall not contain more than two (2) longitudinal joints. Sections of jacket may be placed one above the other and joined together with transverse joints. All joints in the outer jacket shall meet the following minimum requirements:

1. All joints shall have sufficient strength to assure that they will not open or separate when subjected to installation stresses, sea forces and epoxy grout injection pressures.
2. The longitudinal joint design shall be of overlapping configuration and shall allow for minor field adjustment to pile size. The design of all joints shall ensure that a minimum 3/8 inch annulus between jacket and pile is maintained.
3. Transverse joints (if any) shall be of overlapping configuration.

The lower end of each outer jacket shall be provided with a molded upset cavity to properly receive and contain a bottom seal gasket.

### Epoxy Grout

The Epoxy Grout must meet ALL requirements of this section and approved by the engineer prior to the bid.

The epoxy grout shall be a manufactured, prepackaged, solvent-free, underwater curing, three component product, consisting of epoxy resin (component A), epoxy hardener (component B) and graded dry silica aggregate (component C). The ratio of the epoxy components A and B (collectively called the binder) shall be 1:1 by volume. The A and B components shall be of sharply contrasting colors, as supplied to the project, to minimize error in field proportioning and to assist in evaluating thoroughness of mixing. The grout shall be proportioned to meet the handling and placement requirements of this specification and the ratio of the filler to binder shall not exceed 3.5:1, by weight.

The mixed epoxy grout shall exhibit the following characteristics in the plastic state:

1. Viscosity of filled resin and filled curing agent shall be such that it may be pumped without segregation and be inject able into the space between the jacket and the pile without causing distortion or rupture of the jacket. The viscosity shall also be such that the blended grout completely fills the space between jacket and pile without voids and be reasonably self-leveling, once placed within the jacket.
2. The gel time or "Pot Life" of the blended grout shall be suitable for proper placement without voids, and allow sufficient time for reasonable self leveling within the jacket, yet in no case shall exceed 65 minutes after blending at a control temperature of 77 degrees F. (This requirement minimizes the possibility of the filler settling out of the liquid components.)
3. The blended grout shall be uniform in color and not contain any pockets or streaks of the original component colors.

The catalyzed Epoxy Grout, after curing under water, shall possess the following minimum physical properties in the hardened state.

1. 7 Day Compressive Strength per ASTM C-579: 7,000 PSI
2. 7 day Tensile Strength per ASTM C-307: 2,000 PSI
3. 7 day Bond/Shear Strength per ASTM C-882: 150 PSI
4. Shrinkage after 7 day's cure per ASTM C-531: 0.07% (Maximum)
5. Water Absorption after 7 day's cure per ASTM C-413: 0.45% (Maximum)

#### Marine Epoxy Pastes

The epoxy paste used to adhere the outer jacket seams and bottom seal gaskets, shall be a two component epoxy compound, capable of being applied underwater. The ratio of resin component to hardener component shall be 1:1 by volume and each component shall be of sharply contrasting color (e.g. black and white) to the other, to assist in evaluating the thoroughness of jobsite mixing.

The epoxy paste used to finish the tops of the encapsulations and to seal any in-situ bond test locations, shall be a non-sag, two component epoxy compound, capable of being applied underwater. The ratio of resin component to hardener component shall be 1:1 by volume and each component shall be of sharply contrasting color (e.g. black and white) to the other, to assist in evaluating the thoroughness of jobsite mixing.

Epoxy Grout Hose Lubricant shall be approved by the manufacturer of the epoxy grout manufacturer. The lubricant must be an epoxy diluent, compatible with the chemistry of the epoxy grout used.

### **Equipment**

The epoxy grout to be injected into the outer jackets shall be proportioned, mixed and pumped with equipment expressly designed for that purpose. The equipment shall be capable of delivering mixed grout into the jackets at the rate of 2 GPM or greater.

### Temperature Control Equipment

When ambient and/or water temperatures are expected to fall below 70 degrees F., a source of heated water, such as a diver's water heater, shall be provided. The heated water shall be directed into water jackets surrounding the epoxy grout hoppers and injection hose(s). This equipment shall be capable of delivering a sufficient amount of heated water to maintain grout viscosity suitable for proper grout placement.

### **Materials Handling and Storage**

Handling and storage of pile encapsulation materials shall strictly conform to the manufacturer's recommendations. A list of minimum handling and storage requirements follows:

#### Outer Jackets

Outer jackets shall be shipped in closed containers or covered with tarpaulins to prevent contamination by dirt or road films. Outer jackets shall be properly stored at the jobsite to minimize distortion and to prevent contamination by foot traffic and blown debris. If storage at project is to exceed 30 days, shaded storage shall be provided.

#### Epoxy Grout Components

The silica aggregate component of the epoxy grout shall be properly packaged and labeled to indicate point of origin and manufacturer's lot number. The aggregate shall be stored to assure that it is thoroughly dry when mixed in the epoxy grout.

All liquid epoxy components to be used in the work shall be delivered to the jobsite in tightly sealed unopened containers, clearly labeled to indicate:

Name of manufacturer.

Manufacturer's product name and component designation.

Manufacturer's lot number and "Use before" date.

ANSI (American National Standards institute) hazardous material rating and handling precautions.

Epoxy liquid epoxy components shall be stored in a covered, well ventilated space. The storage temperature of the liquid components shall not exceed 120 degrees F nor be less than 40 degrees F at any time after receipt by the contractor. (See Epoxy Grout Preparation)

Containers containing liquid epoxy components shall always be sealed and air tight from time of receipt by contractor until entering the proportioning and blending process. When containers are opened for sampling or other purposes and containers remain partially filled, their lids will be

tightly closed to prevent contamination by moisture or other substances. After the seal has been broken on a container, its contents must be used within seven (7) days or removed from the project.

All project personnel handling the epoxy grout or its liquid components shall be properly alerted to the Epoxy Safety Requirements supplied by the manufacturer. A Material Safety Data Sheet (MSDS) shall be supplied with each shipment of liquid epoxy materials.

### **Submittals**

Submit shop drawings and calculations to the Engineer for approval prior to start of fabrication. Submittal shall include:

1. Top and bottom elevations relative to project datum of each outer jacket to be installed.
2. Details and locations of typical longitudinal and transverse joints in the outer jackets, including a description of the joint sealing method(s).
3. Details of fixed and/or adjustable stand-offs and their location on the outer jackets.
4. Detail of typical outer jacket bottom seal.
5. Location and details of temporary bracing and outer jacket support required during placement and curing of epoxy grout.
6. Details of injection ports or other access points into outer jacket to facilitate placement of epoxy grout.
7. Details of installation sequence to be used to place the epoxy grout in the space between jacket and pile.
8. Detail of final finishing of epoxy grout at the top of the encapsulation.
9. Details of permanent closure of all injection ports and test locations in the outer jacket to be accomplished after epoxy grout placement is complete.

### **Material Certification**

For materials to be used, the Supplier shall furnish a certificate to the Engineer attesting that the materials meet all the requirements contained herein and that they conform in all respects to the materials subjected to the tests required. Copies of current test reports shall be attached to the certificate. No test report for tests made more than one year prior to shipment will be accepted for the form material.

### **Construction Methods**

#### Pile Cleaning

Prior to application of the encapsulation process, all pile surfaces shall be thoroughly cleaned of marine growth, oil, grease, mud, rust, broken concrete, micro-organisms and any other deleterious material which might prevent proper bonding between the epoxy grout and the pile. Pile cleaning may be accomplished by grit blasting, water blasting, or by powered rotary abraders, and shall meet the satisfaction of the Engineer.

In environments where active marine growth occurs, it may be necessary to perform the pile cleaning in two (2) phases. In such environments, the first phase shall consist of removing marine growth, oil, grease, rust, broken concrete, etc., and shall occur not more than seven (7)

days prior to the encapsulation. The second phase shall be a final surface preparation, removing all remaining deleterious substances including micro-organisms and shall occur not more than 48 hours prior to the placement of the epoxy grout in the outer pile jacket.

#### Outer Jacket Assembly

Only jackets with pre-fitted injection ports (by the contractor) are to be used.

The entire inside surface of the jacket shall be lightly grit blasted by the contractor to remove any bond breaking residue that may be present.

All fixed stand-offs or adjustable stand-off bosses shall be affixed to the jacket by the contractor in accordance with approved shop drawings. Maximum spacing between fixed stand-offs shall be 18" in the longitudinal direction and 12" in the transverse direction.

Jacket assembly and positioning around the pile shall be performed by the contractor in such a manner as to assure that no damage to stand-offs and/or set screws occurs and that there will be no detrimental movement of the joints while joint adhesive is curing.

Both the longitudinal and transverse seams, if any, shall be sealed by the contractor with marine epoxy paste as described above and fastened with 3/16" diameter stainless steel rivets. The spacing between individual fasteners shall not exceed 5".

The jacket shall be supported by temporary bracing or other means supplied by the contractor to assure that it will not move or distort during the epoxy grout placement and curing period and that the minimum annular space of 3/8 inch between pile and jacket is maintained throughout the entire encapsulation.

The contractor shall install a gasket to prevent the epoxy grout from leaving the bottom of the jacket during the injection process. The gasket shall be fitted into the molded cavity at the lower end of the jacket and adhered in place with marine epoxy paste. Any gasket material used in the bottom seal shall be contained within the molded cavity and shall not extend up into the jacket above the cavity.

#### Epoxy Grout Preparation

Proportioning and mixing of the epoxy grout shall be accomplished with equipment expressly designed for that purpose and shall be performed in a suitable work area within hose distance of the piles to be encapsulated.

Proportioning of the silica aggregate and the liquid epoxy components shall be performed in strict accordance with the manufacturer's recommendations, with particular regard to temperature control. When ambient and/or water temperatures are expected to fall below 70 degrees F., the day's supply of grout filler and liquid components shall be pre-heated to above 80 degrees F., but never greater than 120 degrees F., prior to being introduced into the grout handling equipment. In no case shall open flame be used in direct contact with the equipment or the epoxy components.

#### Epoxy Grout Placement (Injection)

Before the injection process begins, at least 2 gallons of an approved grout hose lubricant shall be placed in each grout hopper. This lubricant shall be pumped through the entire system to coat all wetted surfaces of the hopper(s), pump(s) and hoses. When the lubricant level has reached the bottom of the hopper(s), it may be immediately followed by the epoxy grout and the remaining lubricant "chased" out of the hoses. All lubricant, that is not intermixed with the epoxy grout, may be collected at the downstream end of the hoses for re-use.

The premixed, aggregate filled epoxy grout shall be pumped through hoses to the jacket injection ports. If the plural component method of grout handling is used, the separate aggregate filled components shall be pumped through separate hoses to the mixer/blender assembly, where the components are then thoroughly blended and catalyzed, just prior to entering the pile jacket.

Grout injection shall begin at the bottom injection port. As the grout appears at the next higher port, and it has been determined that the space between the pile and the jacket is filled to that port, the lower port shall be capped off and the injection begun at the next higher port where the grout appeared. This process is repeated from port to port until the grout reaches the top of the jacket. NOTE: If project experience indicates that the grout can be injected from a lower port, past the next higher port or ports, without difficulty or undo stress on the jacket, the higher port or ports may be plugged and bypassed. The plugs shall be 1" NPT, Schedule 40, PVC, CPVC or Polypropylene.

At the contractor's option, he may inject a short lift of grout (six inches to 1 foot in height) into the bottom-most port and allow it to cure before proceeding with subsequent lifts. If this practice is used, the jackets shall be fitted with an additional injection port to coincide with the top of the first lift. Subsequent lifts of grout will follow the above procedures.

The injection process shall be continuous, except for brief interruptions when the injector is moved from port to port, and the speed of the injection process shall be controlled to prevent entrapment of water or air in the grout cavity being filled.

The maximum permissible voids in the epoxy grout within the jackets shall not exceed 0.01 square foot per one (1) square foot of encapsulation area. Any voids larger than two (2) inches in diameter shall be repaired by the contractor, using an approved method, at no expense to the owner.

#### Final Finishing and Inspection of the Completed Encapsulation

After the grouting process is completed and the grout has sufficiently cured, all temporary support for the jacket shall be removed.

The exposed epoxy grout at the top of each encapsulation shall be finished with the marine epoxy paste using the method shown in the approved shop drawings.

#### **Measurement and Payment**

*Pile Encapsulation* will be measured and paid for at the contract unit price bid per linear foot of encased pile and will be full compensation for removal, containment and disposal off-site of unsound concrete including the cost of materials, labor, tools, equipment and incidentals necessary to accomplish removal; shop drawings, cleaning the pile, jacket installation,



falsework; furnishing and placement of epoxy grout including pumping equipment, pollution control, turbidity curtains, and all else required to repair deteriorated piles using pile encapsulation.

Payment will be made under:

<b>Pay Item</b>	<b>Pay Unit</b>
Pile Encapsulation	Linear Feet

**PILE JACKETS**

**SPECIAL**

**Description**

This specification establishes the minimum requirements for furnishing installing permanent outer pile forms, standoffs, steel reinforcement bands and steel bracing collars for the installation of pile jackets for pile repair. It is intended to ensure that the supplier’s forms and installation/reinforcing details shall allow the forms to be filled with concrete without failure, and provide durable, corrosion resistant pile protection.

**Materials**

Forms:

The form shall be fabricated from fiberglass and polyester resins, or other inert materials that are compatible with Portland cement and produce a form with equal levels of corrosion resistance and durability. The inside face of the forms shall have a texture equal to that provided by sandblasting, and shall have no bond inhibiting agents in contact with cementitious materials. Forms shall include polymer standoffs of sufficient number and spacing to maintain a minimum space of 2” between the reinforcing steel and the jacket. Provide forms with dimensions in accordance with the sizing chart shown in the plans. For pumped applications provide ports in accordance with the plans. The minimum allowable thickness of the forms is 1/8”. Upon opening to place around a pile, the form shall be capable of returning to its original shape without assistance or damage. It shall have an interlocking joint along one side, which will permit the form to be assembled and sealed in place around the pile. Contractor shall submit form details to the Engineer for approval prior to beginning work.

Transverse joints (if any) shall be of overlapping configuration.

The material furnished must meet the following physical property requirements:

- (a) Water Absorption (ASTM-D570) ..... 1% Maximum
- (b) Ultimate Tensile Strength (ASTM-D638)\* ..... 9,000 psi Minimum
- (c) Flexural Strength (ASTM-D796)\* ..... 16,000 psi Minimum
- (d) Flexural Modulus of Elasticity (ASTM-D790) ..... 700,000 psi Minimum
- (e) Barcol Hardness (ASTM-D2583) ..... 30 – 40
- (f) Color ..... Similar to Federal Color Standard 595 Number 36622 – the color shall be integral in the form material.

- (g) Accelerated Weathering ... The fabricated form material shall be subjected to a 500 hour exposure test in a Twin-Carbon-ARC-Weather-Ometer (ASTM G-23, Type D) at an operating temperature of 145°F. Said test to be made at twenty minute cycles consisting of seventeen minutes of light and three minutes of water spray plus light. At the end of the exposure test the exposed samples shall not show any chipping, flaking or peeling. The test panels shall be prepared from the materials meeting the physical property requirements above, and they shall be in accordance with the manufacturer's recommendations.

“\*”= On original specimen whose flat surfaces are not machined to disturb the fiberglass.

#### Epoxy Gel Sealant

Use an approved marine epoxy gel to adhere the outer jacket seams. The epoxy paste must be a two component epoxy compound, capable of being applied underwater. The ratio of resin component to hardener component is 1:1 by volume. To assist in evaluating the thoroughness of job site mixing, each component must be of sharply contrasting color.

#### Concrete

Concrete shall meet the requirements of the *Standard Specs* for Class A Concrete. Use a pea gravel mix suitable for pumped applications. An anti-washout admixture may be used for in water applications. Concrete mix design shall be submitted for approval prior to beginning work.

#### Reinforcement Bands

Provide reinforcement bands similar to that shown in the plans. The bands shall be reusable, and shall be equipped with quick release fasteners.

Submit details and calculations showing design loads and the placement of the bands on the pile form necessary to reinforce the form against failure from the concrete pressure, or any other loading the form may experience, including its use on battered piles.

#### Steel Bracing Collar

For forms to be supported on temporary falsework provide a steel bracing collar which will reinforce the bottom of the form and allow connection to the falsework.

### **Construction Methods**

Prior to jacket installation, remove all deteriorated concrete and thoroughly clean pile of marine growth, oil, grease, mud, rust, and any other deleterious material which might prevent proper bonding between the concrete and the pile. Accomplish pile preparation and cleaning by chipping, grit blasting, high pressure water blasting, or by divers using powered rotary abraders. Any method that produces the quality of cleaning necessary to meet the bond requirements of this specification may be considered. When necessary, perform the pile cleaning in 2 phases where active marine growth occurs. In the first phase, a maximum of 7 days before the encapsulation, remove marine growth, oil, grease, rust, and broken concrete, etc. In the second phase, a maximum of 48 hrs before placement of concrete in the outer pile jacket, perform a final surface preparation, removing all remaining deleterious substances including micro-organisms.

Place the jacket assembly and position it around the pile in such a manner as to assure that no damage to stand-offs and rebar cage occur. Ensure there will be no detrimental movement of the joints while joint adhesive is curing. The placement of the jacket is to be determined by the location of the affected pile and in accordance with the contract drawings.

Seal the longitudinal and transverse seams, if any, with marine epoxy paste as described above.

Place concrete using a pump or tremie. Free fall placement of concrete will not be allowed if any part of the jacket is submerged below water. For above water applications free fall placement will only be allowed for jacket lengths up to 10'. Cope the top of the repair to drain water.

No tainted water above pH 9.0 will be allowed to discharge from the work site. Monitoring of pH levels inside and outside of the jacket is required during the pumping operation. Perimeter monitoring site should be no more than 10 ft down flow from the work area. If the pH of the water within the jacket exceeds then pump to a container and hold until the pH level returns to 9.0.

Concrete shall attain a minimum strength of 3000 psi prior to removing form work.

### **Submittals**

Submit shop drawings and calculations to the Engineer for approval prior to start of fabrication. Submittal shall include form dimensions, standoffs, pump ports (where applicable), reinforcing cage installation, reinforcement bands, collars, temporary falsework, methods to seal the form, form installation, and sequence of concrete placement.

### **Material Certification**

For materials to be used, the Supplier shall furnish a certificate to the Engineer attesting that the materials meet all the requirements contained herein and that they conform in all respects to the materials subjected to the tests required. Copies of current test reports shall be attached to the certificate. No test report for tests made more than one year prior to shipment will be accepted for the form material.

### **Measurement and Payment**

*Concrete Pile Jackets* will be measured and paid for at the contract unit price bid per linear foot of concrete encased pile jacket and will be full compensation for removal, containment and disposal off-site of unsound concrete including the cost of materials, labor, tools, equipment and incidentals necessary to accomplish removal; cleaning the pile, furnishing and installation of reinforcement, jacket installation, falsework; furnishing and placement of concrete including pumping equipment, pH monitoring, pollution control, turbidity curtains, and all else required to repair existing deteriorated concrete piles using pile jackets.

Payment will be made under:

#### **Pay Item**

Concrete Pile Jackets

#### **Pay Unit**

Linear Feet

## **STRUCTURAL STEEL REPAIR**

SPECIAL

### **Scope of Work**

Work to repair structural steel includes replacement of the sub cap for the existing crutch bent at Bent 40.

### **Measurement and Payment**

*Structural Steel Repair, Approx. Lbs.* will be measured and paid for at the unit price per pound bid for structural steel repairs and shall be full compensation for all materials, fabrication, bolting, welding, painting (shop and field), equipment, tools, labor, and incidentals incorporated in the completed and accepted work.

Payment will be made under:

#### **Pay Item**

Structural Steel Repair, Approx. Lbs.

#### **Pay Unit**

Pound

## **DISADVANTAGED BUSINESS ENTERPRISE (POC AND MUNICIPALITIES):**

(10-16-07)(Rev 10-20-09)

SP1G62

### **Policy**

It is the policy of the North Carolina Department of Transportation that Disadvantaged Business Enterprises (DBEs) as defined in *49 CFR Part 26* shall have the equal opportunity to compete fairly for and to participate in the performance of contracts financed in whole or in part by Federal Funds.

### **Obligation**

The Contractor, subcontractor, and sub-recipient shall not discriminate on the basis of race, religion, color, national origin, age, disability or sex in the performance of this contract. The Contractor shall comply with applicable requirements of *49 CFR Part 26* in the award and administration of federally assisted contracts. Failure by the Contractor to comply with these requirements is a material breach of this contract, which may result in the termination of this contract or such other remedy, as the Department deems necessary.

### **Definitions**

*Commitment* - The approved DBE participation submitted by the prime contractor during the bidding process.

*Committed DBE* - Any DBE listed on the DBE commitment list approved by the Department at the time of bid submission or any DBE utilized as a replacement for a DBE firm listed on the commitment list.

*Department* - North Carolina Department of Transportation

*Municipality* - The entity letting the contract, when this provision refers to the Department or DOT, it shall mean municipality, if applicable.

*Disadvantaged Business Enterprise (DBE)* – A firm certified as a Disadvantage Business Enterprise through the North Carolina Unified Certification Program.

*Goal* - The DBE participation specified herein

*Letter of Intent* – Written documentation of the bidder/offeror’s commitment to use a DBE subcontractor and confirmation from the DBE that it is participating in the contract.

*Manufacturer* - A firm that operates or maintains a factory or establishment that produces on the premises the materials or supplies obtained by the Contractor.

*Regular Dealer* - A firm that owns, operates, or maintains a store, warehouse, or other establishment in which the materials or supplies required for the performance of the contract are bought, kept in stock, and regularly sold to the public in the usual course of business. A regular dealer engages in, as its principal business and in its own name, the purchase and sale or lease of the products in question. A regular dealer in such bulk items as steel, cement, gravel, stone, and petroleum products need not keep such products in stock, if it owns or operates distribution equipment. Brokers and packagers are not regarded as manufacturers or regular dealers within the meaning of this section.

*Form RS-1-D* - Form for subcontracts involving DBE subcontractors attesting to the agreed upon unit prices and extensions for the affected contract items.

*North Carolina Unified Certification Program* - A program that provides comprehensive information to applicants for certification, such that an applicant is required to apply only once for a DBE certification that will be honored by all recipients of USDOT funds in the state and not limited to the Department of Transportation only. The Certification Program is in accordance with *49 CFR Part 26*.

*Standard Specifications* – The general term comprising all directions, provisions, and requirements contained or referred to in the *North Carolina Department of Transportation Standard Specifications for Roads and Structures* and any subsequent revisions or additions to such book that are issued under the title *Supplemental Specifications*.

*USDOT* - United States Department of Transportation, including the Office of the Secretary, the Federal Highway Administration (FHWA), the Federal Transit Administration (FTA), and the Federal Aviation Administration (FAA).

**Contract Goal**

The following goal for participation by Disadvantaged Business Enterprises is established for this contract:

Disadvantaged Business Enterprises **(0)** %

- (A)** *If the goal is more than zero*, the Contractor shall exercise all necessary and reasonable steps to ensure that Disadvantaged Business Enterprises participate in at least the percent of the contract as set forth above as the goal.

- (B) *If the goal is zero*, the Contractor shall continue to recruit the DBEs and report the use of DBEs during the construction of the project. A good faith effort will not be required with a zero goal.

### **Contract Requirement**

The approved DBE participation submitted by the Contractor shall be the **Contract Requirement**.

### **Certified Transportation Firms Directory**

Real-time information about firms doing business with the Department and firms that are certified through North Carolina's Unified Certification Program is available in the Directory of Transportation Firms. The Directory can be accessed by the link on the Department's homepage or by entering <https://apps.dot.state.nc.us/vendor/directory> in the address bar of your web browser. Only firms identified as DBE certified in the Directory can be utilized to meet the contract goals.

The listing of an individual firm in the Department's directory shall not be construed as an endorsement of the firm's capability to perform certain work.

### **Listing of DBE Subcontractors in Contract**

Only those DBE firms with current certification are acceptable for listing in the bidder's submittal of DBE participation. The Contractor shall indicate the following required information:

- (A) *If the goal is more than zero* bidders, at the time the bid proposal is submitted, shall submit a listing of DBE participation on the appropriate form (or facsimile thereof) contained elsewhere in the contract documents in order for the bid to be considered responsive. Bidders shall indicate the total dollar value of the DBE participation for the contract. If the bidder has no DBE participation, they shall indicate this on the form "Listing of DBE Subcontractors" by entering the word or number zero. This form shall be completed in its entirety. **Blank forms will not be deemed to represent zero participation.** Bids submitted that do not have DBE participation indicated on the appropriate form will not be read publicly during the opening of bids. The Department will not consider these bids for award and the proposal will be returned to the bidder.
- (B) *If the goal is zero*, bidders at the time the bid proposal is submitted, shall enter the word "zero" or number "0" or if there is participation, add the value on the "Listing of DBE Subcontractors" (or facsimile thereof) contained elsewhere in the contract documents.

### **Written Documentation – Letter of Intent**

The bidder shall submit written documentation of the bidder/offeror's commitment to use a DBE subcontractor whose participation it submits to meet a contract goal and written confirmation from each DBE, listed in the proposal, indicating their participation in the contract. This documentation shall be submitted on the Department's form titled "Letter of Intent to Perform as a Subcontractor". This letter of intent form is available at:

<http://www.ncdot.org/doh/preconstruct/ps/contracts/letterofintent.pdf>. It shall be received in the office of the (Officer/Engineer) no later than (Time of Day) of the (No. of Days) calendar day following opening of bids.

If the bidder fails to submit the letter of intent from each committed DBE listed in the proposal indicating their participation in the contract, the DBE participation will not count toward meeting the goal.

### **Counting DBE Participation Toward Meeting DBE Goal of Zero or More**

- (A) If a firm is determined to be an eligible DBE firm, the total dollar value of the participation by the DBE will be counted toward the contract requirement. The total dollar value of participation by a certified DBE will be based upon the value of work actually performed by the DBE and the actual payments to DBE firms by the Contractor.
- (B) When a DBE performs as a participant in a joint venture, the Contractor may count toward its DBE goal a portion of the total value of participation with the DBE in the joint venture, that portion of the total dollar value being a distinct clearly defined portion of work that the DBE performs with its forces.
- (C)
  - (1) The Contractor may count toward its DBE requirement only expenditures to DBEs that perform a commercially useful function in the work of a contract. A DBE performs a commercially useful function when it is responsible for execution of the work of the contract and is carrying out its responsibilities by actually performing, managing, and supervising the work involved. To perform a commercially useful function, the DBE shall also be responsible with respect to materials and supplies used on the contract, for negotiating price, determining quality and quantity, ordering the material and installing (where applicable) and paying for the material itself. To determine whether a DBE is performing a commercially useful function, the Department (Insert Municipality Name and delete Department, if applicable) will evaluate the amount of work subcontracted, industry practices, whether the amount the firm is to be paid under the contract is commensurate with the work it is actually performing and the DBE credit claimed for its performance of the work, and other relevant factors.
  - (2) A DBE may enter into subcontracts. Work that a DBE subcontracts to another DBE firm may be counted toward the contract requirement. Work that a DBE subcontracts to a non-DBE firm does not count toward the contract requirement. If a DBE contractor or subcontractor subcontracts a significantly greater portion of the work of the contract than would be expected on the basis of standard industry practices, the DBE shall be presumed not to be performing a commercially useful function. The DBE may present evidence to rebut this presumption to the Department (Insert Municipality Name and delete Department, if applicable) for commercially useful functions. The Department's (Insert Municipality Name and delete Department, if applicable) decision on the rebuttal of this presumption is subject to review by the Federal Highway Administration but is not administratively appealable to USDOT.
  - (3) The following factors will be used to determine if a DBE trucking firm is performing a commercially useful function.

- (a) The DBE shall be responsible for the management and supervision of the entire trucking operation for which it is responsible on a particular contract, and there shall not be a contrived arrangement for the purpose of meeting DBE goals.
  - (b) The DBE shall itself own and operate at least one fully licensed, insured, and operational truck used on the contract.
  - (c) The DBE receives credit for the total value of the transportation services it provides on the contract using trucks it owns, insures, and operates using drivers it employs.
  - (d) The DBE may lease trucks from another DBE firm, including an owner-operator who is certified as a DBE. The DBE who leases trucks from another DBE receives credit for the total value of the transportation services the lessee DBE provides on the contract.
  - (e) The DBE may also lease trucks from a non-DBE firm, including from an owner-operator. The DBE who leases trucks from a non-DBE is entitled to credit for the total value of transportation services provided by non-DBE lessees not to exceed the value of transportation services provided by DBE-owned trucks on the contract. Additional participation by non-DBE lessees receives credit only for the fee or commission it receives as a result of the lease arrangement.
  - (f) For purposes of this paragraph, a lease shall indicate that the DBE has exclusive use of and control over the truck. This does not preclude the leased truck from working for others during the term of the lease with the consent of the DBE, so long as the lease gives the DBE absolute priority for use of the leased truck. Leased trucks shall display the name and identification number of the DBE.
- (D)** A contractor may count toward its DBE requirement 60 percent of its expenditures for materials and supplies required to complete the contract and obtained from DBE regular dealer and 100 percent of such expenditures to a DBE manufacturer.
- (E)** A contractor may count toward its DBE requirement the following expenditures to DBE firms that are not manufacturers or regular dealers:
- (1) The fees or commissions charged by a DBE firm for providing a bona fide service, such as professional, technical, consultant, or managerial services, or for providing bonds or insurance specifically required for the performance of a DOT-assisted contract, provided the fees or commissions are determined to be reasonable and not excessive as compared with fees and commissions customarily allowed for similar services.
  - (2) The fees or commissions charged for assistance in the procurement of the materials and supplies, or for transportation charges for the delivery of materials or supplies required on a job site (but not the cost of the materials and supplies themselves), provided the fees are not from a manufacturer or regular dealer and provided the fees are determined to be



reasonable and not excessive as compared with fees customarily allowed for similar services.

### **Good Faith Effort for Projects with Goals More Than Zero**

If the DBE participation submitted in the bid by the apparent lowest responsive bidder does not meet or exceed the DBE contract goal, the apparent lowest responsive bidder shall submit to the Department (Officer/Engineer) documentation of its good faith efforts made to reach the contract goal. One complete set and 9 copies of this information shall be received in the office of the (Officer/Engineer) no later than (Time of Day) of the (No. of Days) calendar day following opening of bids. Where the information submitted includes repetitious solicitation letters it will be acceptable to submit a representative letter along with a distribution list of the firms that were solicited. Documentation of DBE quotations shall be a part of the good faith effort submittal as necessary to demonstrate compliance with the factors listed below which the Department (Insert Municipality Name and delete Department, if applicable) considers in judging good faith efforts. This documentation may include written subcontractor quotations, telephone log notations of verbal quotations, or other types of quotation documentation.

The following factors will be used to determine if the bidder has made adequate good faith effort:

- (A) Whether the bidder attended any pre-bid meetings that were scheduled by the Department (Insert Municipality Name and delete Department, if applicable) to inform DBEs of subcontracting opportunities.
- (B) Whether the bidder provided solicitations through all reasonable and available means (e.g. advertising in newspapers owned and targeted to the Disadvantaged) at least 10 calendar days prior to bid opening. Whether the bidder provided written notice to all DBEs listed in the NCDOT Directory of Transportation Firms, within the Divisions and surrounding Divisions where the project is located, that specialize in the areas of work (as noted in the DBE Directory) that the bidder will be subletting.
- (C) Whether the bidder followed up initial solicitations of interests by contacting DBEs to determine with certainty whether they were interested. If a reasonable amount of DBEs within the targeted Divisions do not provide an intent to quote or no DBEs specialize in the subcontracted areas, the bidder shall notify DBEs outside of the targeted Divisions that specialize in the subcontracted areas, and contact the State Contractor Utilization Engineer in the Contractual Services Unit (Insert Municipality Name and delete Department title, if applicable) to give notification of the bidder's inability to get DBE quotes.
- (D) Whether the bidder selected portions of the work to be performed by DBEs in order to increase the likelihood of meeting the contract goals. This includes, where appropriate, breaking out contract work items into economically feasible units to facilitate DBE participation, even when the bidder might otherwise perform these work items with its own forces.
- (E) Whether the bidder provided interested DBEs with adequate and timely information about the plans, specifications and requirements of the contract.

- (F) Whether the bidder negotiated in good faith with interested DBEs without rejecting them as unqualified without sound reasons based on a thorough investigation of their capabilities. Any rejection should be noted in writing with a description as to why an agreement could not be reached.
- (G) Whether quotations were received from interested DBE firms but rejected as unacceptable without sound reasons why the quotations were considered unacceptable. The fact that the DBE firms quotation for the work is not the lowest quotation received will not in itself be considered as a sound reason for rejecting the quotation as unacceptable. The fact that the bidder has the ability and/or desire to perform the contract work with its own forces will not be considered as sound reason for rejecting a DBE quote. Nothing in this provision shall be construed to require the bidder to accept unreasonable quotes in order to satisfy contract goals.
- (H) Whether the bidder specifically negotiated with subcontractors to assume part of the responsibility to meet the contract DBE goal when the work to be sublet includes potential for DBE participation.
- (I) Whether the bidder made any efforts and/or offered assistance to interested DBEs in obtaining the necessary equipment, supplies, materials, insurance, and/or bonding to satisfy the work requirements in the bid proposal.
- (J) Any other evidence that the bidder submits which show that the bidder has made reasonable good faith efforts to meet the contract goal.

If a bidder is the apparent lowest responsive bidder on more than one project within the same letting located in the same geographic area of the state, as a part of the good faith effort the Department (Insert Municipality Name and delete Department, if applicable) will consider allowing the bidder to combine the DBE participation as long as the DBE overall goal value of the combined projects is achieved.

If the Department (Insert Municipality Name and delete Department, if applicable) does not award the contract to the apparent lowest responsive bidder, the Department (Insert Municipality Name and delete Department, if applicable) reserves the right to award the contract to the next lowest responsive bidder that can satisfy the Department (Insert Municipality Name and delete Department, if applicable) that the contract goal can be met or that adequate good faith efforts have been made to meet the goal.

### **DBE Replacement**

The Contractor shall not terminate a committed DBE subcontractor for convenience or perform the work with its own forces or those of an affiliate. If the Contractor fails to demonstrate reasonable efforts to replace a committed DBE firm that does not perform as intended with another committed DBE firm or completes the work with its own forces without the Engineer's (Insert Title and delete Engineer, if applicable) approval, the Contractor may be disqualified from further bidding for a period of up to 6 months.

The Contractor shall comply with the following for replacement of committed DBE.

**(A) Performance Related Replacement**

When a DBE is terminated or fails to complete its work on the contract for any reason, the Contractor shall take all necessary, reasonable steps to replace the DBE subcontractor with another DBE subcontractor to perform at least the same amount of work as the DBE that was terminated. The Contractor is encouraged to first attempt to find another DBE firm to do the same work as the DBE that was being terminated.

To demonstrate necessary, reasonable good faith efforts, the Contractor shall document the steps they have taken to replace any DBE subcontractor who is unable to perform successfully with another DBE subcontractor. Such documentation shall include but not be limited to the following:

- (1) Copies of written notification to DBEs that their interest is solicited in subcontracting the work defaulted by the previous DBE subcontractor or in subcontracting other items of work in the contract.
- (2) Efforts to negotiate with DBEs for specific subbids including, at a minimum:
  - (a) The names, addresses, and telephone numbers of DBEs who were contacted.
  - (b) A description of the information provided to DBEs regarding the plans and specifications for portions of the work to be performed.
- (3) For each DBE contacted but rejected as unqualified, the reasons for the Contractor's conclusion.
- (4) Efforts made to assist the DBEs contacted, if needed, in obtaining bonding or insurance required by the Contractor.

**(B) Decertification Replacement**

- (1) When a committed DBE is decertified by the Department (Insert Municipality Name and delete Department, if applicable) after a Request for Subcontract has been received by the Department (Insert Municipality Name and delete Department, if applicable), the Department (Insert Municipality Name and delete Department, if applicable) will not require the Prime Contractor to solicit replacement DBE participation equal to the remaining work to be performed by the decertified firm. The participation equal to the remaining work performed by the decertified firm will count toward the contract requirement.
- (2) When a committed DBE is decertified prior to the Department (Insert Municipality Name and delete Department, if applicable) receiving a Request for Subcontract for the named DBE firm, the Prime Contractor shall take all necessary and reasonable steps to replace the DBE subcontractor with another DBE subcontractor to perform at least the same amount of work to meet the contract goal or demonstrate that it has made a good faith effort to do so.

### **Changes in the Work**

When the Engineer makes changes that result in the reduction or elimination of work to be performed by a committed DBE, the Contractor will not be required to seek additional participation. When the Engineer makes changes that result in additional work to be performed by a DBE based upon the Contractor's commitment, the DBE shall participate in additional work to the same extent as the DBE participated in the original contract work.

When the Engineer makes changes that result in extra work, which has more than a minimal impact on the contract amount, the Contractor shall seek additional participation by DBEs unless otherwise approved by the Engineer.

When the Engineer makes changes that result in an alteration of plans or details of construction and a portion or all of work had been expected to be performed by a committed DBE, the Contractor shall seek participation by DBEs unless otherwise approved by the Engineer.

When the Contractor requests changes in the work that result in the reduction or elimination of work that the Contractor committed to be performed by a DBE, the Contractor shall seek additional participation by DBEs equal to the reduced DBE participation caused by the changes.

### **Reports**

All requests for subcontracts involving DBE subcontractors shall be accompanied by a certification executed by both the Prime Contractor and the DBE subcontractor attesting to the agreed upon unit prices and extensions for the affected contract items. This information shall be submitted on the Department Form RS-1-D, located at:

<http://www.ncdot.org/doh/forms/files/FORMRS-1-D.doc> unless otherwise approved by the Engineer (Insert Municipality Name and delete Engineer, if applicable). The Department (Insert Municipality Name and delete Department, if applicable) reserves the right to require copies of actual subcontract agreements involving DBE subcontractors.

Within 30 (Enter No. of Days) calendar days of entering into an agreement with a DBE for materials, supplies or services, not otherwise documented by a Request for Subcontract as specified above, the Contractor shall furnish the Engineer a copy of the agreement. The documentation should also indicate the percentage (60% or 100%) of expenditures claimed for DBE credit.

All certifications will be considered a part of the project records, and consequently will be subject to penalties under Federal Law associated with falsifications of records related to projects.

### **Reporting Disadvantaged Business Enterprise Participation**

(A) The Contractor shall provide the Engineer with an accounting of payments made to Disadvantaged Business Enterprise firms, including material suppliers, contractors at all levels (prime, subcontractor, or second tier subcontractor). This accounting shall be furnished to the Engineer for any given month by the end of the following month. Failure to submit this information accordingly may result in the following action:

- (1) Withholding of money due in the next partial pay estimate; or

- (2) Removal of an approved contractor from the prequalified bidders' list or the removal of other entities from the approved subcontractors list. (Municipality may add to, change or delete this section.)
  
- (B) The Contractor shall report the accounting of payments on the Department's DBE Subcontractor Payment Information Form DBE-IS, which is available at: <http://www.ncdot.org/doh/forms/files/DBE-IS.xls>. This shall be reported to the (Officer/Engineer).
  
- (C) Contractors reporting transportation services provided by non-DBE lessees shall evaluate the value of services provided during the month of the reporting period only.

Prior to payment of the final estimate, the Contractor shall furnish an accounting of total payment to each DBE. A responsible fiscal officer of the payee contractor, subcontractor, or second tier subcontractor who can attest to the date and amounts of the payments shall certify that the accounting is correct.

While each contractor (prime, subcontractor, 2nd tier subcontractor) is responsible for accurate accounting of payments to DBEs, it shall be the prime contractor's responsibility to report all monthly and final payment information in the correct reporting manner.

Because Federal Funding is being used to fund this project, failure on the part of the Contractor to submit the required information in the time frame specified may result in the disqualification of that contractor and any affiliate companies from further bidding until the required information is submitted.

Because Federal Funding is being used to fund this project, failure on the part of any subcontractor to submit the required information in the time frame specified may result in the disqualification of that contractor and any affiliate companies from working on any Federal or State project until the required information is submitted.

### **Failure to Meet Contract Requirements**

Failure to meet contract requirements in accordance with Article 102-16(J) of the *Standard Specifications* may be cause to disqualify the Contractor.

**ITEMIZED PROPOSAL FOR PROJECT NO. BK-5127**

The Contractor agrees to provide the services outlined in this proposal for the following fixed price:

Line No.	Item No.	Sec #	Unit Bid Price	Quantity	Unit Cost	Amount
1	0001000000-N	800	MOBILIZATION	LS	LS	
2	4405000000-E	1110	PORTABLE WORK ZONE SIGNS	116 SF		
3	4420000000-N	1120	CHANGEABLE MESSAGE SIGNS	2 EA		
4	4435000000-N	1135	CONES	70 EA		
5	4455000000-N	1150	FLAGGER (BY DAY)	100 DAY		
6	8217000000-E	425	REINFORCING STEEL	200 LBS		
7	8280000000-E	440	STRUCTURAL STEEL, APPROX. LBS.	815 LBS		
8	8882000000-E	SP	GENERIC STRUCTURE ITEM DECK AND CAP REPAIR	253 CF		
9	8867000000-E	SP	GENERIC STRUCTURE ITEM CONCRETE PILE JACKETS	104 LF		
10	8867000000-E	SP	GENERIC STRUCTURE ITEM PILE ENCAPSULATION	357 LF		
<b>TOTAL AMOUNT OF BID FOR ENTIRE PROJECT</b>						

CONTRACTOR \_\_\_\_\_

ADDRESS \_\_\_\_\_

Contractor's License Number \_\_\_\_\_

Authorized Agent \_\_\_\_\_ Title \_\_\_\_\_

Signature \_\_\_\_\_ Date \_\_\_\_\_

Witness \_\_\_\_\_ Title \_\_\_\_\_

Signature \_\_\_\_\_ Date \_\_\_\_\_

**ACCEPTANCE OF PROPOSAL**

AGENCY: NC DEPARTMENT OF TRANSPORTATION CITY AND STATE, RALEIGH, NC

BY: \_\_\_\_\_, STATE BRIDGE MANAGEMENT ENGINEER  
(SIGNATURE)

Contract Number \_\_\_\_\_

County \_\_\_\_\_

**EXECUTION OF CONTRACT**  
**NONCOLLUSION AFFIDAVIT AND DEBARMENT CERTIFICATION**

The Contractor being duly sworn, solemnly swears (or affirms) that neither he, nor any official, agent or employee has entered into any agreement, participated in any collusion, or otherwise taken any action which is in restraint of free competitive bidding in connection with this Contract, and that the Contractor intends to do the work with his own bonafide employees or subcontractors and did not bid for the benefit of another contractor.

By submitting this Execution of Contract, Non-Collusion affidavit and Debarment Certification, the Contractor is certifying his status under penalty of perjury under the laws of the United States in accordance with the Debarment Certification attached, provided that the Debarment Certification also includes any required statements concerning exceptions that are applicable.

**SIGNATURE OF CONTRACTOR**

\_\_\_\_\_  
(Full name of Corporation)

\_\_\_\_\_  
(Address as Prequalified)

Attest \_\_\_\_\_  
(Secretary)      (Assistant Secretary)  
*Select appropriate title*

By \_\_\_\_\_  
(President)(Vice President) (Asst. Vice President)  
*Select appropriate title*

\_\_\_\_\_  
Print Signer's Name

\_\_\_\_\_  
Print Signer's Name

**CORPORATE SEAL**

**NOTE - AFFIDAVIT MUST BE NOTARIZED**

Subscribed and sworn to before me this the  
\_\_\_\_ day of \_\_\_\_\_, 20 \_\_\_\_.

\_\_\_\_\_  
(Signature of Notary Public)

**NOTARY SEAL:**

of \_\_\_\_\_ County.

State of \_\_\_\_\_.

My Commission Expires: \_\_\_\_\_

Contract Number \_\_\_\_\_

County \_\_\_\_\_

## **DEBARMENT CERTIFICATION OF CONTRACTOR**

### Conditions for certification:

1. The Contractor shall provide immediate written notice to the Department if at any time the Contractor learns that its certification was erroneous when submitted his debarment certification or explanation that is on file with the Department, or has become erroneous because of changed circumstances.
  
2. The terms *covered transaction, debarred, suspended, ineligible, lower tier covered transaction, participant, person, primary covered transaction, principal, proposal, and voluntarily excluded*, as used in this provision, have the meanings set out in the Definitions and Coverage sections of the rules implementing *Executive Order 12549*. A copy of the Federal Rules requiring this certification and detailing the definitions and coverages may be obtained from the Contract Officer of the Department.
  
3. The Contractor agrees by submitting this form, that he will not knowingly enter into any lower tier covered transaction with a person who is debarred, suspended, declared ineligible, or voluntarily excluded from participation in NCDOT contracts, unless authorized by the Department.
  
4. For Federal Aid projects, the Contractor further agrees that by submitting this form he will include the *Federal-Aid Provision titled Required Contract Provisions Federal-Aid Construction Contract (Form FHWA PR 1273)* provided by the Department, without subsequent modification, in all lower tier covered transactions.
  
5. The Contractor may rely upon a certification of a participant in a lower tier covered transaction that it is not debarred, suspended, ineligible, or voluntarily excluded from the covered transaction, unless he knows that the certification is erroneous. The Contractor may decide the method and frequency by which he will determine the eligibility of his subcontractors.
  
6. Nothing contained in the foregoing shall be construed to require establishment of a system of records in order to render in good faith the certification required by this provision. The knowledge and information of a participant is not required to exceed that which is normally possessed by a prudent person in the ordinary course of business dealings.
  
7. Except as authorized in paragraph 3 herein, the Department may terminate any contract if the Contractor knowingly enters into a lower tier covered transaction with a person who is suspended, debarred, ineligible, or voluntarily excluded from participation in this transaction, in addition to other remedies available by the Federal Government.



Contract Number \_\_\_\_\_

County \_\_\_\_\_

**DEBARMENT CERTIFICATION**

The Contractor certifies to the best of its knowledge and belief, that he and his principals:

- a. Are not presently debarred, suspended, proposed for debarment, declared ineligible, or voluntarily excluded from covered transactions by any Federal department or agency;
  
- b. Have not within a three-year period preceding this proposal been convicted of or had a civil judgment rendered against them for commission of fraud or a criminal offense in connection with obtaining, attempting to obtain, or performing a public (Federal, State or local) transaction or contract under a public transaction; violation of Federal or State antitrust statutes or commission of embezzlement, theft, forgery, bribery, falsification or destruction of records; making false statements; or receiving stolen property;
  
- c. Are not presently indicted for or otherwise criminally or civilly charged by a governmental entity (Federal, State or local) with commission of any of the offenses enumerated in paragraph b. of this certification; and
  
- d. Have not within a three-year period preceding this proposal had one or more public transactions (Federal, State or local) terminated for cause or default.
  
- e. If status changes, will submit a revised Debarment Certification immediately.

If the Contractor cannot certify that he is not debarred, he shall provide an explanation with this submittal. An explanation will not necessarily result in denial of participation in a contract.

Failure to submit a non-collusion affidavit and debarment certification will result in the Contractor's bid being considered non-responsive.

Check here if an explanation is attached to this certification.

**SUBSTITUTE FORM W-9  
VENDOR REGISTRATION FORM  
NORTH CAROLINA DEPARTMENT OF TRANSPORTATION**

Pursuant to Internal Revenue Service (IRS) Regulations, vendors must furnish their Taxpayer Identification Number (TIN) to the State. If this number is not provided, you may be subject to a 20% withholding on each payment. To avoid this 20% withholding and to insure that accurate tax information is reported to the Internal Revenue Service and the State, please use this form to provide the requested information exactly as it appears on file with the IRS.

**INDIVIDUAL AND SOLE PROPRIETOR: ENTER NAME AS SHOWN ON SOCIAL SECURITY CARD**

CORPORATION OR PARTNERSHIP : ENTER YOUR LEGAL BUSINESS NAME

**NAME:** \_\_\_\_\_

**MAILING ADDRESS: STREET/PO BOX:** \_\_\_\_\_

**CITY, STATE, ZIP:** \_\_\_\_\_

**DBA / TRADE NAME (IF APPLICABLE):** \_\_\_\_\_

- |   |   |
|---|---|
| <input type="checkbox"/> INDIVIDUAL (use Social Security No.) | <input type="checkbox"/> SOLE PROPRIETER (use SS No. or Fed ID No.) |
| <input type="checkbox"/> CORPORATION (use Federal ID No.)     | <input type="checkbox"/> PARTNERSHIP (use Federal ID No.)           |
| <input type="checkbox"/> ESTATE/TRUST (use Federal ID no.)    | <input type="checkbox"/> STATE OR LOCAL GOVT. (use Federal ID No.)  |
| <input type="checkbox"/> OTHER / SPECIFY _____                |   |

**SOCIAL SECURITY NO.** \_\_\_\_ - \_\_\_\_ - \_\_\_\_ (Social Security #)

**OR**

**FED.EMPLOYER IDENTIFICATION NO.** \_\_\_\_ - \_\_\_\_ - \_\_\_\_ (Employer Identification #)

COMPLETE THIS SECTION IF PAYMENTS ARE MADE TO AN ADDRESS OTHER THAN THE ONE LISTED ABOVE:

**REMIT TO ADDRESS: STREET / PO BOX:** \_\_\_\_\_  
**CITY, STATE, ZIP:** \_\_\_\_\_

Participation in this section is voluntary. You are not required to complete this section to become a registered vendor. The information below will in no way affect the vendor registration process and its sole purpose is to collect statistical data on those vendors doing business with NCDOT. If you choose to participate, circle the answer that best fits your firm's group definition.

What is your firm's ethnicity? (Prefer Not To Answer, African American, Native American, Caucasian American, Asian American, Hispanic American, Asian-Indian \_\_\_\_\_ )

**What is your firm's gender?** (Prefer Not to Answer, Male, Female) **Disabled-Owned Business?** (Prefer Not to Answer, Yes, No)

**IRS Certification**

Under penalties of perjury, I certify that:

- The number shown on this form is my correct taxpayer identification and
- I am not subject to backup withholding because: (a) I am exempt from backup withholding, or (b) I have not been notified by the IRS that I am subject to backup withholding as a result of a failure to report all interest or dividends, or (c) the IRS has notified me that I am no longer subject to backup withholding, and
- I am a U.S. person (including a U.S. resident alien).

The IRS does not require your consent to any provision of this document other than the certifications required to avoid backup withholding. For complete certification instructions please see IRS FORM W-9 at <http://www.irs.gov/pub/irs-pdf/fw9.pdf>.

\_\_\_\_\_  
**NAME (Print or Type)**

\_\_\_\_\_  
**TITLE (Print or Type)**

\_\_\_\_\_  
**SIGNATURE**

\_\_\_\_\_  
**DATE**

\_\_\_\_\_  
**PHONE NUMBER**

# NON COLLUSION AFFIDAVIT

(To Be Executed and Returned with Quotation)

The person executing this bid solemnly swears (or affirms) that neither he, nor any official, agent, or employee of the bidder has entered into any agreement, restraint of free competitive bidding in connection with this bid.

**NAME OF CONTRACTOR** \_\_\_\_\_

**SIGNATURE OF CONTRACTOR** \_\_\_\_\_

***NOTE - AFFIDAVIT MUST BE NOTARIZED***

Subscribed and sworn to me this the \_\_\_\_\_  
Day of \_\_\_\_\_, 20 \_\_\_\_.

**NOTARY SEAL**

\_\_\_\_\_  
(SIGNATURE OF NOTARY PUBLIC)

Of \_\_\_\_\_ County.

State of \_\_\_\_\_.

My Commission Expires: \_\_\_\_\_.

# APPENDIX

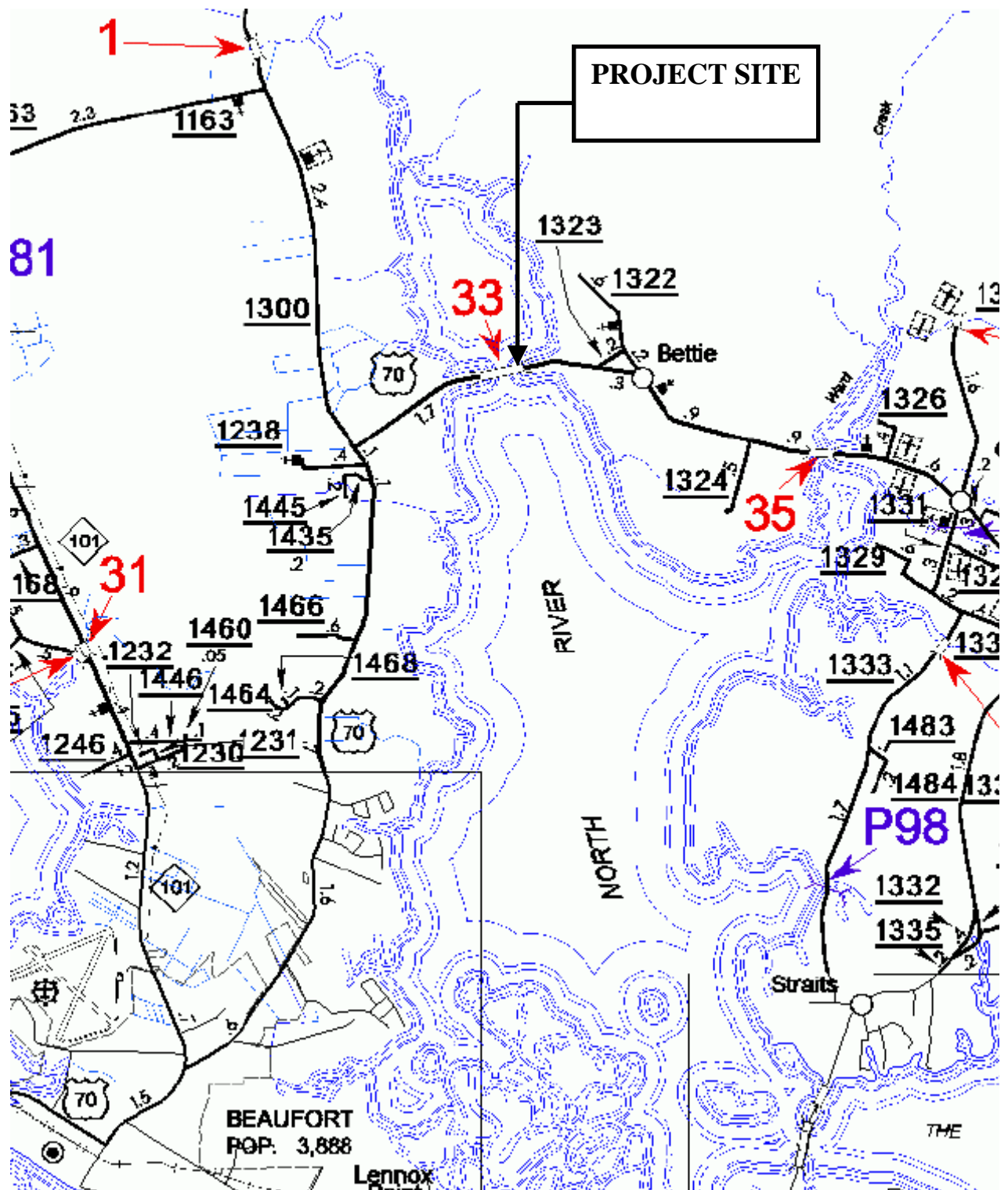

# FHWA PROVISION REQUIREMENTS

## U.S. DEPARTMENT OF TRANSPORTATION HOTLINE:

(11-22-94)

SP1 G100

To report bid rigging activities call: **1-800-424-9071**

The U.S. Department of Transportation (DOT) operates the above toll-free *hotline* Monday through Friday, 8:00 a.m. to 5:00 p.m. eastern time. Anyone with knowledge of possible bid rigging, bidder collusion, or other fraudulent activities should use the *hotline* to report such activities.

The *hotline* is part of the DOT's continuing effort to identify and investigate highway construction contract fraud and abuse is operated under the direction of the DOT Inspector General. All information will be treated confidentially and caller anonymity will be respected.

## SUBMISSION OF RECORDS - FEDERAL-AID PROJECTS:

(7-17-07)

SP1 G103

The Contractor's attention is directed to the Standard Special Provision entitled *Required Contract Provisions-Federal-Aid Construction Contracts* contained elsewhere in this proposal.

This project is located on a roadway classified as a local road or rural minor collector, therefore the requirements of Paragraph IV - Payment of Predetermined Minimum Wage and Paragraph V - Statements and Payrolls are exempt from this contract.

## CERTIFICATION FOR FEDERAL-AID CONTRACTS:

(3-21-90)

SP1 G85

The prospective participant certifies, by signing and submitting this bid or proposal, to the best of his or her knowledge and belief, that:

- (1) No Federal appropriated funds have been paid or will be paid, by or on behalf of the undersigned, to any person for influencing or attempting to influence an officer or employee of any Federal agency, a Member of Congress, an officer or employee of Congress, or an employee of a Member of Congress in connection with the awarding of any Federal contract, the making of any Federal grant, the making of any Federal loan, the entering into of any cooperative agreement, and the extension, continuation, renewal, amendment, or modification of any Federal contract, grant, loan, or cooperative agreement.
- (2) If any funds other than Federal appropriated funds have been paid or will be paid to any person for influencing or attempting to influence an officer or employee of any Federal agency, a Member of Congress, an officer or employee of Congress, or an employee of a Member of Congress in connection with this Federal contract, grant, loan, or cooperative agreement, the undersigned shall complete and submit Standard Form-LLL, *Disclosure Form to Report Lobbying*, in accordance with its instructions.

This certification is a material representation of fact upon which reliance was placed when this transaction was made or entered into. Submission of this certification is a prerequisite for making or entering into this transaction imposed by *Section 1352, Title 31, U.S. Code*. Any person who fails to file the required certification shall be subject to a civil penalty of not less than \$10,000 and not more than \$100,000 for each such failure.

The prospective participant also agrees by submitting his or her bid or proposal that he or she shall require that the language of this certification be included in all lower tier subcontracts, which exceed \$100,000 and that all such subrecipients shall certify and disclose accordingly.

## STANDARD SPECIAL PROVISION

### ERRATA

(7-15-08)

Z-4

Revise the *Standard Specifications for Roads and Structures July 2006* on all projects as follows:

#### **Division 1**

- ❑ Page 1-1, replace AREA - American Railway Engineering Association with *American Railway Engineering and Maintenance of Way Association*.
- ❑ Page 1-7, remove –L- in middle of page after INVITATION TO BID and before LABORATORY.
- ❑ Page 1-25, 102-16(R), move 2nd paragraph to left margin. It is not a part of this subarticle, but part of the entire article.

#### **Division 2**

- ❑ Page 2-9, Subarticle 225-1(C), 1<sup>st</sup> paragraph, 2<sup>nd</sup> line, last word, add a “d” to make the word grade become *graded*.
- ❑ Page 2-15, Subarticle 226-3, 5th paragraph, first line, replace the word *in* with the word *is*.
- ❑ Page 2-23, Subarticle 235-4(B)(9), at the end of the sentence, replace finished greater with finished *grade*.
- ❑ Page 2-28, Article 260-3, First paragraph, second line, remove the word *foot*.

#### **Division 3**

- ❑ Page 3-13, Article 340-4, Second paragraph, change Flowable Backfill to Flowable *Fill*

#### **Division 4**

- ❑ Page 4-70, 442-13(B) Second sentence, change SSPC Guide 6I to SSPC Guide **6**.
- ❑ Pages 4-72, 4-74, 4-76, at the top of the page, substitute the heading Section 452 with Section **450**.
- ❑ Page 4-79, at the top of the page, substitute the heading Section 450 with Section **452**
- ❑ Page 4-80, change 452-7 to 452-**6** at the top of the page.
- ❑ Page 4-80, change Pay Item \_\_\_Steel Pile Retaining Walls, to *Sheet* Pile Retaining Walls.
- ❑ Page 4-88, 462-4, Title, Replace last word Measurement with the word **PAYMENT**

#### **Division 5**

- ❑ Page 5-8, Article 501-15 Measurement and Payment, delete the 4th paragraph that begins The quantity of lime, measured as provided ...

#### **Division 6**

- ❑ Page 6-3, Article 600-9, 2nd Paragraph on this page, replace 818-5 with 818-**4**.
- ❑ Pages 6-30 and 31, Subarticle 610-3(A)(13) Move 2 paragraphs from the margin to the right under the number (13).
- ❑ Page 6-43, Article 610-8, 4th paragraph, remove the first *the*
- ❑ Page 6-44, 2nd full paragraph, 1<sup>st</sup> sentence, delete the first *and* and add *transverse* just before cross-slope control.
- ❑ Page 6-51, at the top of the page, add **610-14** on the same line, and just before the heading MAINTENANCE.
- ❑ Page 6-53, Article 620-4 sixth paragraph, second line; the word that should be *which*.
- ❑ Page 6-66, title, Replace EXISTNG with **EXISTING**
- ❑ Page 6-66, Article 657-1, Description, first sentence, replace PS/AR (hot-poured rubber asphalt with *hot applied joint sealer*.

- ❑ Page 6-66, Article 657-2, replace PS/AR (Hot-Poured Rubber Asphalt with the following:

Item	Section
<b>Hot Applied Joint Sealer</b>	<b>1028-2</b>

- ❑ Page 6-67, at the top of the page, substitute the heading Section 654 with Section **657**.
- ❑ Page 6-67, Article 657-3 Construction Methods, 2nd paragraph, replace PS/AR sealant with **hot applied joint sealer**.
- ❑ Page 6-71, 660-9(B)(1), Replace the first sentence of the first paragraph with the following:

**Using the quantities shown in Table 660-1, apply asphalt material to the existing surface followed by an application of No. 78 M or lightweight aggregate.**

- ❑ Page 6-89; Add a period at the end of the last sentence at the bottom of the page.
- ❑ Page 6-90, Article 663-5, first paragraph, first sentence, change 50oF to **50°F**; third paragraph, fourth sentence change 325oF to **325°F**.

#### **Division 7**

- ❑ Page 7-12, at the top of the page, substitute the heading Section 710 with Section **700**.
- ❑ Page 7-15, Article 710-9, 4th paragraph, last line, change 710-11(B) to **710-10(B)**.

#### **Division 8**

- ❑ Page 8-13, Article 808-3, 4th Paragraph, third line, replace Eexcavation with **Excavation**
- ❑ Page 8-35, Article 848-2, Item: Replace Cncrete with **Concrete**

#### **Division 9**

- ❑ Page 9-2, add **901-3** just before CONSTRUCTION METHODS

#### **Division 10**

- ❑ Page 10-12, near bottom of page add **(C)** before Proportioning and Mixing of Modified Compositions, which should be bold type.
- ❑ Page 10-28, at the top of the page, substitute Section 100**6** for 1005.
- ❑ Page 10-54, Subarticle 1018-2A), First line, substitute **(B)** for II, third line, substitute **(B)(2)** for II-b.
- ❑ Pages 10-56, 10-58, 10-60 at the top of the page, substitute Section 1018 with Section **1020**.
- ❑ Page 10-84, Table 1042-1, Class 2, Maximum, change from 23r to **23**.
- ❑ Page 10-84, Article 1042-2 Testing, last sentence, replace the word alterations with the word **cycles**.
- ❑ Page 10-100, Table 1056-1, replace on the line for Trapezoidal Tear Strength:

Type 1	Type 2	Type 3		Type 4
		Class A	Class B	Soil Stabilization
<b>45 lb</b>	<b>75 lb</b>	--	--	<b>75 lb</b>

- ❑ Page 10-116, Subarticle 1070-10, first paragraph, second sentence, add **or** just before cold-forged sleeve.
- ❑ Pages 10-136 through 10-147, at the top of the page, substitute Section 1074 with Section **1072**.



- ❑ Page 10-157, Article 1077-11, first paragraph, change the reference from Subarticle 420-18(B) to Subarticle 420-17(B).
- ❑ Page 10-211, at the top of the page, substitute Section 1081 with Section **1082**.
- ❑ Page 10-229, add **1088-6 BLANK** on the line above 1088-7 TUBULAR MARKERS.
- ❑ Page 10-244, add **1089-10 BLANK** and **1089-11 BLANK** on the lines just above 1089-12 FLAGGER.
- ❑ Page 10-272, delete Article 1098-6 in its entirety. Renumber Articles 1098-7 through 1098-17 as Articles 1098-6 through 1098-16 consecutively.

#### **Division 12**

- ❑ Page 12-21 Add **1266-2** just before the heading MATERIALS.

#### **Division 15**

- ❑ Page 15-2 add **1500-4** just before the heading WEEKEND, NIGHT AND HOLIDAY WORK.
- ❑ Page 15-4, Subarticle 1505-3(A)(2), replace the 2nd line with the following: *Provide shielding or shoring as required under Section 150 or as required elsewhere in the contract.*
- ❑ Page 15-5, add **1505-6** on the same line and just before the heading MEASUREMENT AND PAYMENT. (Remove the period after PAYMENT.)
- ❑ Page 15-6, Article 1505-6(3), delete *in Section 1175* and replace it with *elsewhere in the contract*.
- ❑ Page 15-8, add **1510-4** on the same line and just before the heading MEASUREMENT AND PAYMENT.
- ❑ Page 15-10, substitute **BLANK** for CONSTRUCTION REQUIREMENTS on the same line and just before 1515-4.
- ❑ Page 15-10, substitute **CONSTRUCTION REQUIREMENTS** for General Requirements
- ❑ Page 15-10, Article 1515-4, add **(D)** just before the bolded Fire Hydrants.
- ❑ Page 15-13, Article 1520-3, 8th paragraph, add *pipe* after diameter.
- ❑ Page 15-22, add **1540-3** on the same line and just before the heading CONSTRUCTION REQUIREMENTS.
- ❑ Page 15-28, Replace 1550-6 METHOD OF MEASUREMENT with **MEASUREMENT AND PAYMENT**.

#### **Division 16**

- ❑ Page 16-12, Subarticle 1632-1(C) ¼ Inch hardware cloth, change the minimum width from 24 inches to 48 inches.

#### **Division 17**

- ❑ Page 17-19, Subarticle 1725-2 Material, Second paragraph, change Article 1098-7 to 1098-8
- ❑ Page 17-20, Subarticle 1726-2 Material, Second paragraph, change Article 1098-8 to 1098-9

**END**

**STANDARD SPECIAL PROVISION**

**MINORITY AND FEMALE EMPLOYMENT REQUIREMENTS**

Z-7

NOTICE OF REQUIREMENTS FOR AFFIRMATIVE ACTION TO ENSURE EQUAL EMPLOYMENT OPPORTUNITY  
(EXECUTIVE NUMBER 11246)

1. The goals and timetables for minority and female participation, expressed in percentage terms for the Contractor's aggregate workforce in each trade on all construction work in the covered area, see as shown on the attached sheet entitled "Employment Goals for Minority and Female participation".

These goals are applicable to all the Contractor's construction work (whether or not it is Federal or federally assisted) performed in the covered area. If the Contractor performs construction work in a geographical area located outside of the covered area, it shall apply the goals established for such geographical area where the work is actually performed. With regard to this second area, the Contractor also is subject to the goals for both its federally involved and nonfederally involved construction.

The Contractor's compliance with the Executive Order and the regulations in *41 CFR Part 60-4* shall be based on its implementation of the Equal Opportunity Clause, specific affirmative action obligations required by the specifications set forth in *41 CFR 60-4.3(a)*, and its effort to meet the goals. The hours of minority and female employment and training must be substantially uniform throughout the length of the contract, and in each trade and the Contractor shall make a good faith effort to employ minorities and women evenly on each of its projects. The transfer of minority or female employees or trainees from Contractor to Contractor or from project to project or the sole purpose of meeting the Contractor's goals shall be a violation of the contract, the executive Order and the regulations in *41 CFR Part 60-4*. Compliance with the goals will be measured against the total work hours performed.

2. As used in this Notice and in the contract resulting from this solicitation, the "covered area" is the county or counties shown on the cover sheet of the proposal form and contract.

**EMPLOYMENT GOALS FOR MINORITY  
AND FEMALE PARTICIPATION**

Economic Areas

**Area 023 29.7%**

Bertie County  
Camden County  
Chowan County  
Gates County  
Hertford County  
Pasquotank County  
Perquimans County

**Area 024 31.7%**

Beaufort County  
Carteret County  
Craven County  
Dare County  
Edgecombe County  
Green County  
Halifax County  
Hyde County  
Jones County

**Area 026 33.5%**

Bladen County  
Hoke County  
Richmond County  
Robeson County  
Sampson County  
Scotland County

**Area 027 24.7%**

Chatham County  
Franklin County  
Granville County  
Harnett County  
Johnston County  
Lee County  
Person County  
Vance County  
Warren County

**Area 029 15.7%**

Alexander County  
Anson County  
Burke County  
Cabarrus County  
Caldwell County  
Catawba County  
Cleveland County  
Iredell County  
Lincoln County  
Polk County  
Rowan County  
Rutherford County  
Stanly County

**Area 0480 8.5%**

Buncombe County  
Madison County

Lenoir County  
Martin County  
Nash County  
Northampton County  
Pamlico County  
Pitt County  
Tyrrell County  
Washington County  
Wayne County  
Wilson County

**Area 025 23.5%**

Columbus County  
Duplin County  
Onslow County  
Pender County

**SMSA Areas**

**Area 5720 26.6%**

Currituck County

**Area 9200 20.7%**

Brunswick County  
New Hanover County

**Area 2560 24.2%**

Cumberland County

**Area 028 15.5%**

Alleghany County  
Ashe County  
Caswell County  
Davie County  
Montgomery County  
Moore County  
Rockingham County  
Surry County  
Watauga County  
Wilkes County

**Area 030 6.3%**

Avery County  
Cherokee County  
Clay County  
Graham County  
Haywood County  
Henderson County  
Jackson County  
McDowell County  
Macon County  
Mitchell County  
Swain County  
Transylvania County  
Yancey County

**Area 6640 22.8%**

Durham County  
Orange County  
Wake County

**Area 1300 16.2%**

Alamance County

**Area 3120 16.4%**

Davidson County  
Forsyth County  
Guilford County  
Randolph County  
Stokes County  
Yadkin County

**Area 1520 18.3%**

Gaston County  
Mecklenburg County  
Union County

---

**Goals for Female**

**Participation in Each Trade**

(Statewide) 6.9%

## STANDARD SPECIAL PROVISION

### REQUIRED CONTRACT PROVISIONS FEDERAL - AID CONSTRUCTION CONTRACTS

FHWA - 1273 Electronic Version - March 10, 1994

Z-8

- I. General
- II. Nondiscrimination
- III. Nonsegregated Facilities
- IV. Payment of Predetermined Minimum Wage
- V. Statements and Payrolls
- VI. Record of Materials, Supplies, and Labor
- VII. Subletting or Assigning the Contract
- VIII. Safety: Accident Prevention
- IX. False Statements Concerning Highway Project
- X. Implementation of Clean Air Act and Federal Water Pollution Control Act
- XI. Certification Regarding Debarment, Suspension, Ineligibility, and Voluntary Exclusion
- XII. Certification Regarding Use of Contract Funds for lobbying

#### ATTACHMENTS

- A. Employment Preference for Appalachian Contracts (included in Appalachian contracts only)

#### I. GENERAL

- 1. These contract provisions shall apply to all work performed on the contract by the contractor's own organization and with the assistance of workers under the contractor's immediate superintendent and to all work performed on the contract by piecework, station work, or by subcontract.
- 2. Except as otherwise provided for in each section, the contractor shall insert in each subcontract all of the stipulations contained in these Required Contract Provisions, and further require their inclusion in any lower tier subcontract or purchase order that may in turn be made. The Required Contract Provisions shall not be incorporated by reference in any case. The prime contractor shall be responsible for compliance by any subcontractor or lower tier subcontractor with these Required Contract Provisions.
- 3. A breach of any of the stipulations contained in these Required Contract Provisions shall be sufficient grounds for termination of the contract.
- 4. A breach of the following clauses of the Required Contract Provisions may also be grounds for debarment as provided in 29 CFR 5.12:
  - Section I, paragraph 2;
  - Section IV, paragraphs 1, 2, 3, 4, and 7;
  - Section V, paragraphs 1 and 2a through 2g.
- 5. Disputes arising out of the labor standards provisions of Section IV (except paragraph 5) and Section V of these Required Contract Provisions shall not be subject to the general disputes clause of this contract. Such disputes shall be resolved in accordance with the procedures of the U.S. Department of Labor (DOL) as set forth in 29 CFR 5, 6, and 7. Disputes within the meaning of this clause include disputes between the contractor (or any of its subcontractors) and the contracting agency, the DOL, or the contractor's employees or their representatives.
- 6. **Selection of Labor:** During the performance of this contract, the contractor shall not:
  - a. discriminate against labor from any other State, possession, or territory of the United States (except for employment preference for Appalachian contracts, when applicable, as specified in Attachment A), or
  - b. employ convict labor for any purpose within the limits of the project unless it is labor performed by convicts who are on parole, supervised release, or probation.

#### II. NONDISCRIMINATION

(Applicable to all Federal-aid construction contracts and to all related subcontracts of \$10,000 or more.)

- 1. **Equal Employment Opportunity:** Equal employment opportunity (EEO) requirements not to discriminate and to take affirmative action to assure equal opportunity as set forth under laws, executive orders, rules, regulations (28 CFR 35, 29 CFR 1630 and 41 CFR 60) and orders of the Secretary of Labor as modified by the provisions prescribed herein, and imposed pursuant to 23 U.S.C. 140 shall constitute the EEO and specific affirmative action standards for the contractor's project activities under this contract. The Equal Opportunity Construction Contract Specifications set forth under 41 CFR 60-4.3 and the provisions of the American Disabilities Act of 1990 (42 U.S.C. 12101 *et seq.*) set forth under 28 CFR 35 and 29 CFR 1630 are incorporated by reference in this contract. In the execution of this contract, the contractor agrees to comply with the following minimum specific requirement activities of EEO:
  - a. The contractor will work with the State highway agency (SHA) and the Federal Government in carrying out EEO obligations and in their review of his/her activities under the contract.
  - b. The contractor will accept as his operating policy the following statement:

"It is the policy of this Company to assure that applicants are employed, and that employees are treated during employment, without regard to their race, religion, sex, color, national origin, age or disability. Such action shall include: employment, upgrading, demotion, or transfer; recruitment or recruitment advertising; layoff or termination; rates of pay or other forms of compensation; and selection for training, including apprenticeship, preapprenticeship, and/or on-the-job training."
- 2. **EEO Officer:** The contractor will designate and make known to the SHA contracting officers an EEO Officer who will have the responsibility for and must be capable of effectively administering and promoting an active contractor program of EEO and who must be assigned adequate authority and responsibility to do so.

3. **Dissemination of Policy:** All members of the contractor's staff who are to hire, supervise, promote, and discharge employees, or who recommend such action, or who are substantially involved in such action, will be made fully cognizant of, and will implement, the contractor's EEO policy and contractual will be taken as a minimum:
  - a. Periodic meetings of supervisory and personnel office employees will be conducted before the start of work and then not less often than once every six months, at which time the contractor's EEO policy and its implementation will be reviewed and explained. The meetings will be conducted by the EEO Officer.
  - b. All new supervisory or personnel office employees will be given a thorough indoctrination by the EEO Officer, covering all major aspects of the contractor's EEO obligations within thirty days following their reporting for duty with the contractor.
  - c. All personnel who are engaged in direct recruitment for the project will be instructed by the EEO Officer in the contractor's procedures for locating and hiring minority group employees.
  - d. Notices and posters setting forth the contractor's EEO policy will be placed in areas readily accessible to employees, applicants for employment and potential employees.
  - e. The contractor's EEO policy and the procedures to implement such policy will be brought to the attention of employees by means of meetings, employee handbooks, or other appropriate means.
4. **Recruitment:** When advertising for employees, the contractor will include in all advertisements for employees the notation: "An Equal Opportunity Employer." All such advertisements will be placed in publications having a large circulation among minority groups in the area from which the project work force would normally be derived.
  - a. The contractor will, unless precluded by a valid bargaining agreement, conduct systematic and direct recruitment through public and private employee referral sources likely to yield qualified minority group applicants. To meet this requirement, the contractor will identify sources of potential minority group employees, and establish with such identified sources procedures whereby minority group applicants may be referred to the contractor for employment consideration.
  - b. In the event the contractor has a valid bargaining agreement providing for exclusive hiring hall referrals, he is expected to observe the provisions of that agreement to the extent that the system permits the contractor's compliance with EEO contract provisions. (The DOL has held that where implementation of such agreements have the effect of discriminating against minorities or women, or obligates the contractor to do the same, such implementation violates Executive Order 11246, as amended.)
  - c. The contractor will encourage his present employees to refer minority group applicants for employment. Information and procedures with regard to referring minority group applicants will be discussed with employees.
5. **Personnel Actions:** Wages, working conditions, and employee benefits shall be established and administered, and personnel actions of every type, including hiring, upgrading, promotion, transfer, demotion, layoff, and termination, shall be taken without regard to race, color, religion, sex, national origin, age or disability. The following procedures shall be followed:
  - a. The contractor will conduct periodic inspections of project sites to insure that working conditions and employee facilities do not indicate discriminatory treatment of project site personnel.
  - b. The contractor will periodically evaluate the spread of wages paid within each classification to determine any evidence of discriminatory wage practices.
  - c. The contractor will periodically review selected personnel actions in depth to determine whether there is evidence of discrimination. Where evidence is found, the contractor will promptly take corrective action. If the review indicates that the discrimination may extend beyond the actions reviewed, such corrective action shall include all affected persons.
  - d. The contractor will promptly investigate all complaints of alleged discrimination made to the contractor in connection with his obligations under this contract, will attempt to resolve such complaints, and will take appropriate corrective action within a reasonable time. If the investigation indicates that the discrimination may affect persons other than the complainant, such corrective action shall include such other persons. Upon completion of each investigation, the contractor will inform every complainant of all of his avenues of appeal.
6. **Training and Promotion:**
  - a. The contractor will assist in locating, qualifying, and increasing the skills of minority group and women employees, and applicants for employment.
  - b. Consistent with the contractor's work force requirements and as permissible under Federal and State regulations, the contractor shall make full use of training programs, i.e., apprenticeship, and on-the-job training programs for the geographical area of contract performance. Where feasible, 25 percent of apprentices or trainees in each occupation shall be in their first year of apprenticeship or training. In the event a special provision for training is provided under this contract, this subparagraph will be superseded as indicated in the special provision.
  - c. The contractor will advise employees and applicants for employment of available training programs and entrance requirements for each.
  - d. The contractor will periodically review the training and promotion potential of minority group and women employees and will encourage eligible employees to apply for such training and promotion.
7. **Unions:** If the contractor relies in whole or in part upon unions as a source of employees, the contractor will use his/her best efforts to obtain the cooperation of such unions to increase opportunities for minority groups and women within the unions, and to effect referrals by such unions of minority and female employees. Actions by the contractor either directly or through a contractor's association acting as agent will include the procedures set forth below:
  - a. The contractor will use best efforts to develop, in cooperation with the unions, joint training programs aimed toward qualifying more minority group members and women for membership in the unions and increasing the skills of minority group employees and women so that they may qualify for higher paying employment.
  - b. The contractor will use best efforts to incorporate an EEO clause into each union agreement to the end that such union will be contractually bound to refer applicants without regard to their race, color, religion, sex, national origin, age or disability.
  - c. The contractor is to obtain information as to the referral practices and policies of the labor union except that to the extent such information is within the exclusive possession of the labor union and such labor union refuses to furnish such information to the contractor, the contractor shall so certify to the SHA and shall set forth what efforts have been made to obtain such information.
  - d. In the event the union is unable to provide the contractor with a reasonable flow of minority and women referrals within the time limit set forth in the collective bargaining agreement, the contractor will, through independent recruitment efforts, fill the employment vacancies without regard to race, color, religion, sex, national origin, age or disability; making full efforts to obtain qualified and/or qualifiable minority group persons and women. (The DOL has held that it shall be no excuse that the union with which the contractor has a collective bargaining agreement providing for exclusive referral failed to refer minority employees.) In the event the union referral practice prevents the contractor

from meeting the obligations pursuant to Executive Order 11246, as amended, and these special provisions, such contractor shall immediately notify the SHA.

8. **Selection of Subcontractors, Procurement of Materials and Leasing of Equipment:** The contractor shall not discriminate on the grounds of race, color, religion, sex, national origin, age or disability in the selection and retention of subcontractors, including procurement of materials and leases of equipment.
  - a. The contractor shall notify all potential subcontractors and suppliers of his/her EEO obligations under this contract.
  - b. Disadvantaged business enterprises (DBE), as defined in 49 CFR 23, shall have equal opportunity to compete for and perform subcontracts which the contractor enters into pursuant to this contract. The contractor will use his best efforts to solicit bids from and to utilize DBE subcontractors or subcontractors with meaningful minority group and female representation among their employees. Contractors shall obtain lists of DBE construction firms from SHA personnel.
  - c. The contractor will use his best efforts to ensure subcontractor compliance with their EEO obligations.
9. **Records and Reports:** The contractor shall keep such records as necessary to document compliance with the EEO requirements. Such records shall be retained for a period of three years following completion of the contract work and shall be available at reasonable times and places for inspection by authorized representatives of the SHA and the FHWA.
  - a. The records kept by the contractor shall document the following:
    1. The number of minority and non-minority group members and women employed in each work classification on the project;
    2. The progress and efforts being made in cooperation with unions, when applicable, to increase employment opportunities for minorities and women;
    3. The progress and efforts being made in locating, hiring, training, qualifying, and upgrading minority and female employees; and
    4. The progress and efforts being made in securing the services of DBE subcontractors or subcontractors with meaningful minority and female representation among their employees.
  - b. The contractors will submit an annual report to the SHA each July for the duration of the project, indicating the number of minority, women, and non-minority group employees currently engaged in each work classification required by the contract work. This information is to be reported on Form FHWA-1391. If on-the job training is being required by special provision, the contractor will be required to collect and report training data.

### III. NONSEGREGATED FACILITIES

(Applicable to all Federal-aid construction contracts and to all related subcontracts of \$10,000 or more.)

- a. By submission of this bid, the execution of this contract or subcontract, or the consummation of this material supply agreement or purchase order, as appropriate, the bidder, Federal-aid construction contractor, subcontractor, material supplier, or vendor, as appropriate, certifies that the firm does not maintain or provide for its employees any segregated facilities at any of its establishments, and that the firm does not permit its employees to perform their services at any location, under its control, where segregated facilities are maintained. The firm agrees that a breach of this certification is a violation of the EEO provisions of this contract. The firm further certifies that no employee will be denied access to adequate facilities on the basis of sex or disability.
- b. As used in this certification, the term "segregated facilities" means any waiting rooms, work areas, restrooms and washrooms, restaurants and other eating areas, timeclocks, locker rooms, and other storage or dressing areas, parking lots, drinking fountains, recreation or entertainment areas, transportation, and housing facilities provided for employees which are segregated by explicit directive, or are, in fact, segregated on the basis of race, color, religion, national origin, age or disability, because of habit, local custom, or otherwise. The only exception will be for the disabled when the demands for accessibility override (e.g. disabled parking).
- c. The contractor agrees that it has obtained or will obtain identical certification from proposed subcontractors or material suppliers prior to award of subcontracts or consummation of material supply agreements of \$10,000 or more and that it will retain such certifications in its files.

### IV. PAYMENT OF PREDETERMINED MINIMUM WAGE

(Applicable to all Federal-aid construction contracts exceeding \$2,000 and to all related subcontracts, except for projects located on roadways classified as local roads or rural minor collectors, which are exempt.)

1. **General:**
  - a. All mechanics and laborers employed or working upon the site of the work will be paid unconditionally and not less often than once a week and without subsequent deduction or rebate on any account [except such payroll deductions as are permitted by regulations (29 CFR 3) issued by the Secretary of Labor under the Copeland Act (40 U.S.C. 276c)] the full amounts of wages and bona fide fringe benefits (or cash equivalents thereof) due at time of payment. The payment shall be computed at wage rates not less than those contained in the wage determination of the Secretary of Labor (hereinafter "the wage determination") which is attached hereto and made a part hereof, regardless of any contractual relationship which may be alleged to exist between the contractor or its subcontractors and such laborers and mechanics. The wage determination (including any additional classifications and wage rates conformed under paragraph 2 of this Section IV and the DOL poster (WH-1321) or Form FHWA-1495) shall be posted at all times by the contractor and its subcontractors at the site of the work in a prominent and accessible place where it can be easily seen by the workers. For the purpose of this Section, contributions made or costs reasonably anticipated for bona fide fringe benefits under Section 1(b)(2) of the Davis-Bacon Act (40 U.S.C. 276a) on behalf of laborers or mechanics are considered wages paid to such laborers or mechanics, subject to the provisions of Section IV, paragraph 3b, hereof. Also, for the purpose of this Section, regular contributions made or costs incurred for more than a weekly period (but not less often than quarterly) under plans, funds, or programs, which cover the particular weekly period, are deemed to be constructively made or incurred during such weekly period. Such laborers and mechanics shall be paid the appropriate wage rate and fringe benefits on the wage determination for the classification of work actually performed, without regard to skill, except as provided in paragraphs 4 and 5 of this Section IV.
  - b. Laborers or mechanics performing work in more than one classification may be compensated at the rate specified for each classification for the time actually worked therein, provided, that the employer's payroll records accurately set forth the time spent in each classification in which work is performed.
  - c. All rulings and interpretations of the Davis-Bacon Act and related acts contained in 29 CFR 1, 3, and 5 are herein incorporated by reference in this contract.

2. **Classification:**
  - a. The SHA contracting officer shall require that any class of laborers or mechanics employed under the contract, which is not listed in the wage determination, shall be classified in conformance with the wage determination.
  - b. The contracting officer shall approve an additional classification, wage rate and fringe benefits only when the following criteria have been met:
    1. the work to be performed by the additional classification requested is not performed by a classification in the wage determination;
    2. the additional classification is utilized in the area by the construction industry;
    3. the proposed wage rate, including any bona fide fringe benefits, bears a reasonable relationship to the wage rates contained in the wage determination; and
    4. with respect to helpers, when such a classification prevails in the area in which the work is performed.
  - c. If the contractor or subcontractors, as appropriate, the laborers and mechanics (if known) to be employed in the additional classification or their representatives, and the contracting officer agree on the classification and wage rate (including the amount designated for fringe benefits where appropriate), a report of the action taken shall be sent by the contracting officer to the DOL, Administrator of the Wage and Hour Division, Employment Standards Administration, Washington, D.C. 20210. The Wage and Hour Administrator, or an authorized representative, will approve, modify, or disapprove every additional classification action within 30 days of receipt and so advise the contracting officer or will notify the contracting officer within the 30-day period that additional time is necessary.
  - d. In the event the contractor or subcontractors, as appropriate, the laborers or mechanics to be employed in the additional classification or their representatives, and the contracting officer do not agree on the proposed classification and wage rate (including the amount designated for fringe benefits, where appropriate), the contracting officer shall refer the questions, including the views of all interested parties and the recommendation of the contracting officer, to the Wage and Hour Administrator for determination. Said Administrator, or an authorized representative, will issue a determination within 30 days of receipt and so advise the contracting officer or will notify the contracting officer within the 30-day period that additional time is necessary.
  - e. The wage rate (including fringe benefits where appropriate) determined pursuant to paragraph 2c or 2d of this Section IV shall be paid to all workers performing work in the additional classification from the first day on which work is performed in the classification.
3. **Payment of Fringe Benefits:**
  - a. Whenever the minimum wage rate prescribed in the contract for a class of laborers or mechanics includes a fringe benefit which is not expressed as an hourly rate, the contractor or subcontractors, as appropriate, shall either pay the benefit as stated in the wage determination or shall pay another bona fide fringe benefit or an hourly case equivalent thereof.
  - b. If the contractor or subcontractor, as appropriate, does not make payments to a trustee or other third person, he/she may consider as a part of the wages of any laborer or mechanic the amount of any costs reasonably anticipated in providing bona fide fringe benefits under a plan or program, provided, that the Secretary of Labor has found, upon the written request of the contractor, that the applicable standards of the Davis-Bacon Act have been met. The Secretary of Labor may require the contractor to set aside in a separate account assets for the meeting of obligations under the plan or program.
4. **Apprentices and Trainees (Programs of U.S. DOL) and Helpers:**
  - a. Apprentices:
    1. Apprentices will be permitted to work at less than the predetermined rate for the work they performed when they are employed pursuant to and individually registered in a bona fide apprenticeship program registered with the DOL, Employment and Training Administration, Bureau of Apprenticeship and Training, or with a State apprenticeship agency recognized by the Bureau, or if a person is employed in his/her first 90 days of probationary employment as an apprentice in such an apprenticeship program, who is not individually registered in the program, but who has been certified by the Bureau of Apprenticeship and Training or a State apprenticeship agency (where appropriate) to be eligible for probationary employment as an apprentice.
    2. The allowable ratio of apprentices to journeyman-level employees on the job site in any craft classification shall not be greater than the ratio permitted to the contractor as to the entire work force under the registered program. Any employee listed on a payroll at an apprentice wage rate, who is not registered or otherwise employed as stated above, shall be paid not less than the applicable wage rate listed in the wage determination for the classification of work actually performed. In addition, any apprentice performing work on the job site in excess of the ratio permitted under the registered program shall be paid not less than the applicable wage rate on the wage determination for the work actually performed. Where a contractor or subcontractor is performing construction on a project in a locality other than that in which its program is registered, the ratios and wage rates (expressed in percentages of the journeyman-level hourly rate) specified in the contractor's or subcontractor's registered program shall be observed.
    3. Every apprentice must be paid at not less than the rate specified in the registered program for the apprentice's level of progress, expressed as a percentage of the journeyman-level hourly rate specified in the applicable wage determination. Apprentices shall be paid fringe benefits in accordance with the provisions of the apprenticeship program. If the apprenticeship program does not specify fringe benefits, apprentices must be paid the full amount of fringe benefits listed on the wage determination for the applicable classification. If the Administrator for the Wage and Hour Division determines that a different practice prevails for the applicable apprentice classification, fringes shall be paid in accordance with that determination.
    4. In the event the Bureau of Apprenticeship and Training, or a State apprenticeship agency recognized by the Bureau, withdraws approval of an apprenticeship program, the contractor or subcontractor will no longer be permitted to utilize apprentices at less than the applicable predetermined rate for the comparable work performed by regular employees until an acceptable program is approved.
  - b. Trainees:
    1. Except as provided in 29 CFR 5.16, trainees will not be permitted to work at less than the predetermined rate for the work performed unless they are employed pursuant to and individually registered in a program which has received prior approval, evidenced by formal certification by the DOL, Employment and Training Administration.
    2. The ratio of trainees to journeyman-level employees on the job site shall not be greater than permitted under the plan approved by the Employment and Training Administration. Any employee listed on the payroll at a trainee rate who is not registered and participating in a training plan approved by the Employment and Training Administration shall be paid not less than the applicable wage rate on the wage determination for the classification of work actually performed. In addition, any trainee

- performing work on the job site in excess of the ratio permitted under the registered program shall be paid not less than the applicable wage rate on the wage determination for the work actually performed.
3. Every trainee must be paid at not less than the rate specified in the approved program for his/her level of progress, expressed as a percentage of the journeyman-level hourly rate specified in the applicable wage determination. Trainees shall be paid fringe benefits in accordance with the provisions of the trainee program. If the trainee program does not mention fringe benefits, trainees shall be paid the full amount of fringe benefits listed on the wage determination unless the Administrator of the Wage and Hour Division determines that there is an apprenticeship program associated with the corresponding journeyman-level wage rate on the wage determination which provides for less than full fringe benefits for apprentices, in which case such trainees shall receive the same fringe benefits as apprentices.
  4. In the event the Employment and Training Administration withdraws approval of a training program, the contractor or subcontractor will no longer be permitted to utilize trainees at less than the applicable predetermined rate for the work performed until an acceptable program is approved.
- c. **Helpers:**  
Helpers will be permitted to work on a project if the helper classification is specified and defined on the applicable wage determination or is approved pursuant to the conformance procedure set forth in Section IV.2. Any worker listed on a payroll at a helper wage rate, who is not a helper under an approved definition, shall be paid not less than the applicable wage rate on the wage determination for the classification of work actually performed.
5. **Apprentices and Trainees (Programs of the U.S. DOT):**  
Apprentices and trainees working under apprenticeship and skill training programs which have been certified by the Secretary of Transportation as promoting EEO in connection with Federal-aid highway construction programs are not subject to the requirements of paragraph 4 of this Section IV. The straight time hourly wage rates for apprentices and trainees under such programs will be established by the particular programs. The ratio of apprentices and trainees to journeymen shall not be greater than permitted by the terms of the particular program.
  6. **Withholding:**  
The SHA shall upon its own action or upon written request of an authorized representative of the DOL withhold, or cause to be withheld, from the contractor or subcontractor under this contract or any other Federal contract with the same prime contractor, or any other Federally-assisted contract subject to Davis-Bacon prevailing wage requirements which is held by the same prime contractor, as much of the accrued payments or advances as may be considered necessary to pay laborers and mechanics, including apprentices, trainees, and helpers, employed by the contractor or any subcontractor the full amount of wages required by the contract. In the event of failure to pay any laborer or mechanic, including any apprentice, trainee, or helper, employed or working on the site of the work, all or part of the wages required by the contract, the SHA contracting officer may, after written notice to the contractor, take such action as may be necessary to cause the suspension of any further payment, advance, or guarantee of funds until such violations have ceased.
  7. **Overtime Requirements:**  
No contractor or subcontractor contracting for any part of the contract work which may require or involve the employment of laborers, mechanics, watchmen, or guards (including apprentices, trainees, and helpers described in paragraphs 4 and 5 above) shall require or permit any laborer, mechanic, watchman, or guard in any workweek in which he/she is employed on such work, to work in excess of 40 hours in such workweek unless such laborer, mechanic, watchman, or guard receives compensation at a rate not less than one-and-one-half times his/her basic rate of pay for all hours worked in excess of 40 hours in such workweek.
  8. **Violation:**  
**Liability for Unpaid Wages; Liquidated Damages:** In the event of any violation of the clause set forth in paragraph 7 above, the contractor and any subcontractor responsible thereof shall be liable to the affected employee for his/her unpaid wages. In addition, such contractor and subcontractor shall be liable to the United States (in the case of work done under contract for the District of Columbia or a territory, to such District or to such territory) for liquidated damages. Such liquidated damages shall be computed with respect to each individual laborer, mechanic, watchman, or guard employed in violation of the clause set forth in paragraph 7, in the sum of \$10 for each calendar day on which such employee was required or permitted to work in excess of the standard work week of 40 hours without payment of the overtime wages required by the clause set forth in paragraph 7.
  9. **Withholding for Unpaid Wages and Liquidated Damages:**  
The SHA shall upon its own action or upon written request of any authorized representative of the DOL withhold, or cause to be withheld, from any monies payable on account of work performed by the contractor or subcontractor under any such contract or any other Federal contract with the same prime contractor, or any other Federally-assisted contract subject to the Contract Work Hours and Safety Standards Act, which is held by the same prime contractor, such sums as may be determined to be necessary to satisfy any liabilities of such contractor or subcontractor for unpaid wages and liquidated damages as provided in the clause set forth in paragraph 8 above.

## V. STATEMENTS AND PAYROLLS

(Applicable to all Federal-aid construction contracts exceeding \$2,000 and to all related subcontracts, except for projects located on roadways classified as local roads or rural collectors, which are exempt.)

1. **Compliance with Copeland Regulations (29 CFR 3):**  
The contractor shall comply with the Copeland Regulations of the Secretary of Labor which are herein incorporated by reference.
2. **Payrolls and Payroll Records:**
  - a. Payrolls and basic records relating thereto shall be maintained by the contractor and each subcontractor during the course of the work and preserved for a period of 3 years from the date of completion of the contract for all laborers, mechanics, apprentices, trainees, watchmen, helpers, and guards working at the site of the work.
  - b. The payroll records shall contain the name, social security number, and address of each such employee; his or her correct classification; hourly rates of wages paid (including rates of contributions or costs anticipated for bona fide fringe benefits or cash equivalent thereof the types described in Section 1(b)(2)(B) of the Davis Bacon Act); daily and weekly number of hours worked; deductions made; and actual wages paid. In addition, for Appalachian contracts, the payroll records shall contain a notation indicating whether the employee does, or does not, normally reside in the labor area as defined in Attachment A, paragraph 1. Whenever the Secretary of Labor, pursuant to Section IV, paragraph 3b, has found that the wages of any laborer or mechanic include the amount of any costs reasonably anticipated in providing



benefits under a plan or program described in Section 1(b)(2)(B) of the Davis Bacon Act, the contractor and each subcontractor shall maintain records which show that the commitment to provide such benefits is enforceable, that the plan or program is financially responsible, that the plan or program has been communicated in writing to the laborers or mechanics affected, and show the cost anticipated or the actual cost incurred in providing benefits. Contractors or subcontractors employing apprentices or trainees under approved programs shall maintain written evidence of the registration of apprentices and trainees, and ratios and wage rates prescribed in the applicable programs.

- c. Each contractor and subcontractor shall furnish, each week in which any contract work is performed, to the SHA resident engineer a payroll of wages paid each of its employees (including apprentices, trainees, and helpers, described in Section IV, paragraphs 4 and 5, and watchmen and guards engaged on work during the preceding weekly payroll period). The payroll submitted shall set out accurately and completely all of the information required to be maintained under paragraph 2b of this Section V. This information may be submitted in any form desired. Optional Form WH-347 is available for this purpose and may be purchased from the Superintendent of Documents (Federal stock number 029-005-0014-1), U.S. Government Printing Office, Washington, D.C. 20402. The prime contractor is responsible for the submission of copies of payrolls by all subcontractors.
- d. Each payroll submitted shall be accompanied by a "Statement of Compliance," signed by the contractor or subcontractor or his/her agent who pays or supervises the payment of the persons employed under the contract and shall certify the following:
  1. that the payroll for the payroll period contains the information required to be maintained under paragraph 2b of this Section V and that such information is correct and complete;
  2. that such laborer or mechanic (including each helper, apprentice, and trainee) employed on the contract during the payroll period has been paid the full weekly wages earned, without rebate, either directly or indirectly, and that no deductions have been made either directly or indirectly from the full wages earned, other than permissible deductions as set forth in the Regulations, 29 CFR 3;
  3. that each laborer or mechanic has been paid not less than the applicable wage rate and fringe benefits or cash equivalent for the classification of work performed, as specified in the applicable wage determination incorporated into the contract.
- e. The weekly submission of a properly executed certification set forth on the reverse side of Optional Form WH-347 shall satisfy the requirement for submission of the "Statement of Compliance" required by paragraph 2d of this Section V.
- f. The falsification of any of the above certifications may subject the contractor to civil or criminal prosecution under 18 U.S.C. 1001 and 31 U.S.C. 231.
- g. The contractor or subcontractor shall make the records required under paragraph 2b of this Section V available for inspection, copying, or transcription by authorized representatives of the SHA, the FHWA, or the DOL, and shall permit such representatives to interview employees during working hours on the job. If the contractor or subcontractor fails to submit the required records or to make them available, the SHA, the FHWA, the DOL, or all may, after written notice to the contractor, sponsor, applicant, or owner, take such actions as may be necessary to cause the suspension of any further payment, advance, or guarantee of funds. Furthermore, failure to submit the required records upon request or to make such records available may be grounds for debarment action pursuant to 29 CFR 5.12.

#### **VI. RECORD OF MATERIALS, SUPPLIES AND LABOR THIS SECTION DELETED JUNE 4, 2007.**

#### **VII. SUBLETTING OR ASSIGNING THE CONTRACT**

1. The contractor shall perform with its own organization contract work amounting to not less than 30 percent (or a greater percentage if specified elsewhere in the contract) of the total original contract price, excluding any specialty items designated by the State. Specialty items may be performed by subcontract and the amount of any such specialty items performed may be deducted from the total original contract price before computing the amount of work required to be performed by the contractor's own organization (23 CFR 635).
  - a. "Its own organization" shall be construed to include only workers employed and paid directly by the prime contractor and equipment owned or rented by the prime contractor, with or without operators. Such term does not include employees or equipment of a subcontractor, assignee, or agent of the prime contractor.
  - b. "Specialty Items" shall be construed to be limited to work that requires highly specialized knowledge, abilities, or equipment not ordinarily available in the type of contracting organizations qualified and expected to bid on the contract as a whole and in general are to be limited to minor components of the overall contract.
2. The contract amount upon which the requirements set forth in paragraph 1 of Section VII is computed includes the cost of material and manufactured products which are to be purchased or produced by the contractor under the contract provisions.
3. The contractor shall furnish (a) a competent superintendent or supervisor who is employed by the firm, has full authority to direct performance of the work in accordance with the contract requirements, and is in charge of all construction operations (regardless of who performs the work) and (b) such other of its own organizational resources (supervision, management, and engineering services) as the SHA contracting officer determines is necessary to assure the performance of the contract.
4. No portion of the contract shall be sublet, assigned or otherwise disposed of except with the written consent of the SHA contracting officer, or authorized representative, and such consent when given shall not be construed to relieve the contractor of any responsibility for the fulfillment of the contract. Written consent will be given only after the SHA has assured that each subcontract is evidenced in writing and that it contains all pertinent provisions and requirements of the prime contract.

#### **VIII. SAFETY: ACCIDENT PREVENTION**

1. In the performance of this contract the contractor shall comply with all applicable Federal, State, and local laws governing safety, health, and sanitation (23 CFR 635). The contractor shall provide all safeguards, safety devices and protective equipment and take any other needed actions as it determines, or as the SHA contracting officer may determine, to be reasonably necessary to protect the life and health of employees on the job and the safety of the public and to protect property in connection with the performance of the work covered by the contract.
2. It is a condition of this contract, and shall be made a condition of each subcontract, which the contractor enters into pursuant to this contract, that the contractor and any subcontractor shall not permit any employee, in performance of the contract, to work in surroundings or under conditions which are unsanitary, hazardous or dangerous to his/her health or safety, as determined under construction safety and health standards (29 CFR

1926) promulgated by the Secretary of Labor, in accordance with Section 107 of the Contract Work Hours and Safety Standards Act (40 U.S.C. 333).

3. Pursuant to 29 CFR 1926.3, it is a condition of this contract that the Secretary of Labor or authorized representative thereof, shall have right of entry to any site of contract performance to inspect or investigate the matter of compliance with the construction safety and health standards and to carry out the duties of the Secretary under Section 107 of the Contract Work Hours and Safety Standards Act (40 U.S.C. 333).

## **IX. FALSE STATEMENTS CONCERNING HIGHWAY PROJECTS**

In order to assure high quality and durable construction in conformity with approved plans and specifications and a high degree of reliability on statements and representations made by engineers, contractors, suppliers, and workers on Federal-aid highway projects, it is essential that all persons concerned with the project perform their functions as carefully, thoroughly, and honestly as possible. Willful falsification, distortion, or misrepresentation with respect to any facts related to the project is a violation of Federal law. To prevent any misunderstanding regarding the seriousness of these and similar acts, the following notice shall be posted on each Federal-aid highway project (23 CFR 635) in one or more places where it is readily available to all persons concerned with the project:

### **NOTICE TO ALL PERSONNEL ENGAGED ON FEDERAL-AID HIGHWAY PROJECTS**

18 U.S.C. 1020 reads as follows:

*"Whoever, being an officer, agent, or employee of the United States, or of any State or Territory, or whoever, whether a person, association, firm, or corporation, knowingly makes any false statement, false representation, or false report as to the character, quality, quantity, or cost of the material used or to be used, or the quantity or quality of the work performed or to be performed, or the cost thereof in connection with the submission of plans, maps, specifications, contracts, or costs of construction on any highway or related project submitted for approval to the Secretary of Transportation; or*

*Whoever knowingly makes any false statement, false representation, false report or false claim with respect to the character, quality, quantity, or cost of any work performed or to be performed, or materials furnished or to be furnished, in connection with the construction of any highway or related project approved by the Secretary of Transportation; or*

*Whoever knowingly makes any false statement or false representation as to material fact in any statement, certificate, or report submitted pursuant to provisions of the Federal-aid Roads Act approved July 1, 1916, (39 Stat. 355), as amended and supplemented;*

*Shall be fined not more than \$10,000 or imprisoned not more than 5 years or both."*

## **X. IMPLEMENTATION OF CLEAN AIR ACT AND FEDERAL WATER POLLUTION CONTROL ACT**

(Applicable to all Federal-aid construction contracts and to all related subcontracts of \$100,000 or more.)

By submission of this bid or the execution of this contract, or subcontract, as appropriate, the bidder, Federal-aid construction contractor, or subcontractor, as appropriate, will be deemed to have stipulated as follows:

1. That any facility that is or will be utilized in the performance of this contract, unless such contract is exempt under the Clean Air Act, as amended (42 U.S.C. 1857 *et seq.*, as amended by Pub.L. 91-604), and under the Federal Water Pollution Control Act, as amended (33 U.S.C. 1251 *et seq.*, as amended by Pub.L. 92-500), Executive Order 11738, and regulations in implementation thereof (40 CFR 15) is not listed, on the date of contract award, on the U.S. Environmental Protection Agency (EPA) List of Violating Facilities pursuant to 40 CFR 15.20.
2. That the firm agrees to comply and remain in compliance with all the requirements of Section 114 of the Clean Air Act and Section 308 of the Federal Water Pollution Control Act and all regulations and guidelines listed thereunder.
3. That the firm shall promptly notify the SHA of the receipt of any communication from the Director, Office of Federal Activities, EPA, indicating that a facility that is or will be utilized for the contract is under consideration to be listed on the EPA List of Violating Facilities.
4. That the firm agrees to include or cause to be included the requirements of paragraph 1 through 4 of this Section X in every nonexempt subcontract, and further agrees to take such action as the government may direct as a means of enforcing such requirements.

## **XI. CERTIFICATION REGARDING DEBARMENT, SUSPENSION, INELIGIBILITY AND VOLUNTARY EXCLUSION**

### **1. Instructions for Certification - Primary Covered Transactions:**

(Applicable to all Federal-aid contracts - 49 CFR 29)

- a. By signing and submitting this proposal, the prospective primary participant is providing the certification set out below.
- b. The inability of a person to provide the certification set out below will not necessarily result in denial of participation in this covered transaction. The prospective participant shall submit an explanation of why it cannot provide the certification set out below. The certification or explanation will be considered in connection with the department or agency's determination whether to enter into this transaction. However, failure of the prospective primary participant to furnish a certification or an explanation shall disqualify such a person from participation in this transaction.
- c. The certification in this clause is a material representation of fact upon which reliance was placed when the department or agency determined to enter into this transaction. If it is later determined that the prospective primary participant knowingly rendered an erroneous certification, in addition to other remedies available to the Federal Government, the department or agency may terminate this transaction for cause of default.
- d. The prospective primary participant shall provide immediate written notice to the department or agency to whom this proposal is submitted if any time the prospective primary participant learns that its certification was erroneous when submitted or has become erroneous by reason of changed circumstances.
- e. The terms "covered transaction," "debarred," "suspended," "ineligible," "lower tier covered transaction," "participant," "person," "primary covered transaction," "principal," "proposal," and "voluntarily excluded," as used in this clause, have the meanings set out in the Definitions

and Coverage sections of rules implementing Executive Order 12549. You may contact the department or agency to which this proposal is submitted for assistance in obtaining a copy of those regulations.

- f. The prospective primary participant agrees by submitting this proposal that, should the proposed covered transaction be entered into, it shall not knowingly enter into any lower tier covered transaction with a person who is debarred, suspended, declared ineligible, or voluntarily excluded from participation in this covered transaction, unless authorized by the department or agency entering into this transaction.
- g. The prospective primary participant further agrees by submitting this proposal that it will include the clause titled "Certification Regarding Debarment, Suspension, Ineligibility and Voluntary Exclusion-Lower Tier Covered Transaction," provided by the department or agency entering into this covered transaction, without modification, in all lower tier covered transactions and in all solicitations for lower tier covered transactions.
- h. A participant in a covered transaction may rely upon a certification of a prospective participant in a lower tier covered transaction that is not debarred, suspended, ineligible, or voluntarily excluded from the covered transaction, unless it knows that the certification is erroneous. A participant may decide the method and frequency by which it determines the eligibility of its principals. Each participant may, but is not required to, check the nonprocurement portion of the "Lists of Parties Excluded From Federal Procurement or Nonprocurement Programs" (Nonprocurement List) which is compiled by the General Services Administration.
- i. Nothing contained in the foregoing shall be construed to require establishment of a system of records in order to render in good faith the certification required by this clause. The knowledge and information of participant is not required to exceed that which is normally possessed by a prudent person in the ordinary course of business dealings.
- j. Except for transactions authorized under paragraph f of these instructions, if a participant in a covered transaction knowingly enters into a lower tier covered transaction with a person who is suspended, debarred, ineligible, or voluntarily excluded from participation in this transaction, in addition to other remedies available to the Federal Government, the department or agency may terminate this transaction for cause or default.

\* \* \* \* \*

#### **Certification Regarding Debarment, Suspension, Ineligibility and Voluntary Exclusion--Primary Covered Transactions**

1. The prospective primary participant certifies to the best of its knowledge and belief, that it and its principals:
  - a. Are not presently debarred, suspended, proposed for debarment, declared ineligible, or voluntarily excluded from covered transactions by any Federal department or agency;
  - b. Have not within a 3-year period preceding this proposal been convicted of or had a civil judgment rendered against them for commission of fraud or a criminal offense in connection with obtaining, attempting to obtain, or performing a public (Federal, State or local) transaction or contract under a public transaction; violation of Federal or State antitrust statutes or commission of embezzlement, theft, forgery, bribery, falsification or destruction of records, making false statements, or receiving stolen property;
  - c. Are not presently indicted for or otherwise criminally or civilly charged by a governmental entity (Federal, State or local) with commission of any of the offenses enumerated in paragraph 1b of this certification; and
  - d. Have not within a 3-year period preceding this application/proposal had one or more public transactions (Federal, State or local) terminated for cause or default.
2. Where the prospective primary participant is unable to certify to any of the statements in this certification, such prospective participant shall attach an explanation to this proposal.

\* \* \* \* \*

#### **2. Instructions for Certification - Lower Tier Covered Transactions:**

(Applicable to all subcontracts, purchase orders and other lower tier transactions of \$25,000 or more - 49 CFR 29)

- a. By signing and submitting this proposal, the prospective lower tier is providing the certification set out below.
- b. The certification in this clause is a material representation of fact upon which reliance was placed when this transaction was entered into. If it is later determined that the prospective lower tier participant knowingly rendered an erroneous certification, in addition to other remedies available to the Federal Government, the department, or agency with which this transaction originated may pursue available remedies, including suspension and/or debarment.
- c. The prospective lower tier participant shall provide immediate written notice to the person to which this proposal is submitted if at any time the prospective lower tier participant learns that its certification was erroneous by reason of changed circumstances.
- d. The terms "covered transaction," "debarred," "suspended," "ineligible," "primary covered transaction," "participant," "person," "principal," "proposal," and "voluntarily excluded," as used in this clause, have the meanings set out in the Definitions and Coverage sections of rules implementing Executive Order 12549. You may contact the person to which this proposal is submitted for assistance in obtaining a copy of those regulations.
- e. The prospective lower tier participant agrees by submitting this proposal that, should the proposed covered transaction be entered into, it shall not knowingly enter into any lower tier covered transaction with a person who is debarred, suspended, declared ineligible, or voluntarily excluded from participation in this covered transaction, unless authorized by the department or agency with which this transaction originated.
- f. The prospective lower tier participant further agrees by submitting this proposal that it will include this clause titled "Certification Regarding Debarment, Suspension, Ineligibility and Voluntary Exclusion-Lower Tier Covered Transaction," without modification, in all lower tier covered transactions and in all solicitations for lower tier covered transactions.
- g. A participant in a covered transaction may rely upon a certification of a prospective participant in a lower tier covered transaction that is not debarred, suspended, ineligible, or voluntarily excluded from the covered transaction, unless it knows that the certification is erroneous. A participant may decide the method and frequency by which it determines the eligibility of its principals. Each participant may, but is not required to, check the Nonprocurement List.
- h. Nothing contained in the foregoing shall be construed to require establishment of a system of records in order to render in good faith the certification required by this clause. The knowledge and information of participant is not required to exceed that which is normally possessed by a prudent person in the ordinary course of business dealings.

- i. Except for transactions authorized under paragraph e of these instructions, if a participant in a covered transaction knowingly enters into a lower tier covered transaction with a person who is suspended, debarred, ineligible, or voluntarily excluded from participation in this transaction, in addition to other remedies available to the Federal Government, the department or agency with which this transaction originated may pursue available remedies, including suspension and/or debarment.

\* \* \* \* \*

**Certification Regarding Debarment, Suspension, Ineligibility and Voluntary Exclusion--Lower Tier Covered Transactions:**

1. The prospective lower tier participant certifies, by submission of this proposal, that neither it nor its principals is presently debarred, suspended, proposed for debarment, declared ineligible, or voluntarily excluded from participation in this transaction by any Federal department or agency.
2. Where the prospective lower tier participant is unable to certify to any of the statements in this certification, such prospective participant shall attach an explanation to this proposal.

\* \* \* \* \*

**XII. CERTIFICATION REGARDING USE OF CONTRACT FUNDS FOR LOBBYING**

(Applicable to all Federal-aid construction contracts and to all related subcontracts which exceed \$100,000 - 49 CFR 20)

1. The prospective participant certifies, by signing and submitting this bid or proposal, to the best of his or her knowledge and belief, that:
  - a. No Federal appropriated funds have been paid or will be paid, by or on behalf of the undersigned, to any person for influencing or attempting to influence an officer or employee of any Federal agency, a Member of Congress, an officer or employee of Congress, or an employee of a Member of Congress in connection with the awarding of any Federal contract, the making of any Federal grant, the making of any Federal loan, the entering into of any cooperative agreement, and the extension, continuation, renewal, amendment, or modification of any Federal contract, grant, loan, or cooperative agreement.
  - b. If any funds other than Federal appropriated funds have been paid or will be paid to any person for influencing or attempting to influence an officer or employee of any Federal agency, a Member of Congress, an officer or employee of Congress, or an employee of a Member of Congress in connection with this Federal contract, grant, loan, or cooperative agreement, the undersigned shall complete and submit Standard Form-LLL, "Disclosure Form to Report Lobbying," in accordance with its instructions.
2. This certification is a material representation of fact upon which reliance was placed when this transaction was made or entered into. Submission of this certification is a prerequisite for making or entering into this transaction imposed by 31 U.S.C. 1352. Any person who fails to file the required certification shall be subject to a civil penalty of not less than \$10,000 and not more than \$100,000 for each such failure.
3. The prospective participant also agrees by submitting his or her bid or proposal that he or she shall require that the language of this certification be included in all lower tier subcontracts, which exceed \$100,000 and that all such recipients shall certify and disclose accordingly.

**STANDARD SPECIAL PROVISION**

**ON-THE-JOB TRAINING:**

(10-16-07) (Rev 7-21-09)

Z-10

**Description**

The North Carolina Department of Transportation will administer a custom version of the Federal On-the-Job Training (OJT) Program, commonly referred to as the Alternate OJT Program. All contractors (existing and newcomers) will be automatically placed in the Alternate Program. Standard OJT requirements typically associated with individual projects will no longer be applied at the project level. Instead, these requirements will be applicable on an annual basis for each contractor administered by the OJT Program Manager.

On the Job Training shall meet the requirements of 23 CFR 230.107 (b), 23 USC – Section 140, this provision and the On-the-Job Training Program Manual.

The Alternate OJT Program will allow a contractor to train employees on Federal, State and privately funded projects located in North Carolina. However, priority shall be given to training employees on NCDOT Federal-Aid funded projects.

**Minorities and Women**

Developing, training and upgrading of minorities and women toward journeyman level status is a primary objective of this special training provision. Accordingly, the Contractor shall make every effort to enroll minority and women as trainees to the extent that such persons are available within a reasonable area of recruitment. This training commitment is not intended, and shall not be used, to discriminate against any applicant for training, whether a member of a minority group or not.

**Assigning Training Goals**

The Department, through the OJT Program Manager, will assign training goals for a calendar year based on the contractors' past three years' activity and the contractors' anticipated upcoming year's activity with the Department. At the beginning of each year, all contractors eligible will be contacted by the Department to determine the number of trainees that will be assigned for the upcoming calendar year. At that time the Contractor shall enter into an agreement with the Department to provide a self-imposed on-the-job training program for the calendar year. This agreement will include a specific number of annual training goals agreed to by both parties. The number of training assignments may range from 1 to 15 per contractor per calendar year. The Contractor shall sign an agreement to fulfill their annual goal for the year. A sample agreement is available at [www.ncdot.org/business/ocs/ojt/](http://www.ncdot.org/business/ocs/ojt/).

**Training Classifications**

The Contractor shall provide on-the-job training aimed at developing full journeyman level workers in the construction craft/operator positions. Preference shall be given to providing training in the following skilled work classifications:

Equipment Operators	Office Engineers
Truck Drivers	Estimators
Carpenters	Iron / Reinforcing Steel Workers
Concrete Finishers	Mechanics
Pipe Layers	Welders

The Department has established common training classifications and their respective training requirements that may be used by the contractors. However, the classifications established are not all-inclusive. Where the training is oriented toward construction applications, training will be allowed in lower-level management positions such as office engineers and estimators. Contractors shall submit new classifications for specific job functions that their employees are performing. The Department will review and recommend for acceptance to FHWA the new classifications proposed by contractors, if applicable. New classifications shall meet the following requirements:

Proposed training classifications are reasonable and realistic based on the job skill classification needs, and

The number of training hours specified in the training classification is consistent with common practices and provides enough time for the trainee to obtain journeyman level status.

The Contractor may allow trainees to be trained by a subcontractor provided that the Contractor retains primary responsibility for meeting the training and this provision is made applicable to the subcontract. However, only the Contractor will receive credit towards the annual goal for the trainee.

Where feasible, 25 percent of apprentices or trainees in each occupation shall be in their first year of apprenticeship or training. The number of trainees shall be distributed among the work classifications on the basis of the contractor's needs and the availability of journeymen in the various classifications within a reasonable area of recruitment.

No employee shall be employed as a trainee in any classification in which they have successfully completed a training course leading to journeyman level status or in which they have been employed as a journeyman.

### **Records and Reports**

The Contractor shall maintain enrollment, monthly and completion reports documenting company compliance under these contract documents. These documents and any other information as requested shall be submitted to the OJT Program Manager.

Upon completion and graduation of the program, the Contractor shall provide each trainee with a certification Certificate showing the type and length of training satisfactorily completed.

### **Trainee Interviews**

All trainees enrolled in the program will receive an initial and Trainee/Post graduate interview conducted by the OJT program staff.

### **Trainee Wages**

Contractors shall compensate trainees on a graduating pay scale based upon a percentage of the prevailing minimum journeyman wages (Davis-Bacon Act). Minimum pay shall be as follows:

60 percent	of the journeyman wage for the first half of the training period
75 percent	of the journeyman wage for the third quarter of the training period
90 percent	of the journeyman wage for the last quarter of the training period

In no instance shall a trainee be paid less than the local minimum wage. The Contractor shall adhere to the minimum hourly wage rate that will satisfy both the NC Department of Labor (NCDOL) and the Department.

### **Achieving or Failing to Meet Training Goals**

The Contractor will be credited for each trainee employed by him on the contract work who is currently enrolled or becomes enrolled in an approved program and who receives training for at least 50 percent of the specific program requirement. Trainees will be allowed to be transferred between projects if required by the Contractor's scheduled workload to meet training goals.

If a contractor fails to attain their training assignments for the calendar year, they may be taken off the NCDOT's Bidders List.

### **Measurement and Payment**

No compensation will be made for providing required training in accordance with these contract documents.

**STANDARD SPECIAL PROVISION**

**GENERAL DECISION NC20080010 10/23/2009 NC10**

Z-11

Date: October 23, 2009  
 General Decision Number NC20080010 10/23/2009  
 Superseded General Decision No. NC20070010  
 State: North Carolina  
 Construction Type: HIGHWAY

**COUNTIES:**

Alleghany	Granville	Pasquotank
Anson	Greene	Pender
Ashe	Halifax	Perquimans
Avery	Harnett	Person
Beaufort	Haywood	Pitt
Bertie	Henderson	Polk
Bladen	Hertford	Richmond
Brunswick	Hoke	Robeson
Caldwell	Hyde	Rockingham
Camden	Iredell	Rutherford
Carteret	Jackson	Sampson
Caswell	Johnston	Scotland
Chatham	Jones	Stanly
Cherokee	Lee	Surry
Chowan	Lenoir	Swain
Clay	Macon	Transylvania
Cleveland	Madison	Tyrrell
Columbus	Martin	Vance
Craven	McDowell	Warren
Currituck	Mitchell	Washington
Dare	Montgomery	Watauga
Duplin	Moore	Wayne
Edgecombe	Nash	Wilkes
Gates	Northampton	Wilson
Graham	Pamlico	Yancey

HIGHWAY CONSTRUCTION PROJECTS (does not include tunnels, building structures in rest area projects, railroad construction, and bascule, suspension, and spandrel arch bridges, bridges designed for commercial navigation, and bridges involving marine construction, and other major bridges).

Modification Number	Publication Date
0	2/08/2008
1	7/25/2008
2	7/24/2009
3	10/23/2009

SUNC1990-002 02/12/1990

	Rates	Fringes
CARPENTER	7.71	
CONCRETE FINISHER	7.64	
IRONWORKER (Reinforcing)	9.27	
LABORER		

General	7.25	
Asphalt Raker	7.25	
Form Setter (Road)	7.25	
Mason (Brick, Block, Stone)	7.76	
Pipe Layer	7.25	
Power Tool Operator	7.25	
<b>POWER EQUIPMENT OPERATORS</b>		
Asphalt Distributor	7.25	
Asphalt Paver	7.25	
Bulldozer	7.25	
Bulldozer (utility)	7.25	
Concrete Finishing Machine	9.48	
Concrete Grinder	8.13	
Crane, Backhoe, Shovel, & Dragline (Over 1 yd.)	8.53	
Crane, Backhoe, Shovel, & Dragline (1 yd. & under)	7.25	
Drill Operator	7.65	
Grade Checker	7.25	
Grease person	7.25	
Hydroseeder	7.25	
Loader	7.25	
Mechanic	8.27	
Milling Machine	8.00	
Motor Grader (Fine Grade)	8.01	
Motor Grader (Rough Grade)	7.42	
Oiler	7.25	
Piledriver	11.00	
Roller (Finish)	7.25	
Roller (Rough)	7.25	
Scraper	7.25	
Screed Asphalt	7.25	
Stone Spreader	7.25	
Stripping Machine Operator	7.25	
Subgrade Machine	9.00	
Sweeper	7.25	
Tractor (utility)	7.25	
<b>TRUCK DRIVERS</b>		
Single Rear Axle Trucks	7.25	
Multi Rear Axle Trucks	7.25	
Heavy Duty trucks	7.25	
Welder	9.07	

Welders – Receive rate prescribed for craft performing operation to which welding is incidental.

Unlisted classifications needed for work not included within the scope of the classifications listed may be added after award only as provided in the labor standards contract clauses (29 CFR 5.5(a)(1)(ii)).

In the listing above, the "SU" designation means that rates listed under that identifier do not reflect collectively bargained wage and fringe benefit rates. Other designations indicate unions whose rates have been determined to be prevailing.

#### WAGE DETERMINATION APPEALS PROCESS



1.) Has there been an initial decision in the matter? This can be:

- \* an existing published wage determination
- \* a survey underlying a wage determination
- \* a Wage and Hour Division letter setting forth a position on a wage determination matter
- \* a conformance (additional classification and rate) ruling

On survey related matters, initial contact, including requests for summaries of surveys, should be with the Wage and Hour Regional Office for the area in which the survey was conducted because those Regional Offices have responsibility for the Davis-Bacon survey program. If the response from this initial contact is not satisfactory, then the process described in 2.) and 3.) should be followed.

With regard to any other matter not yet ripe for the formal process described here, initial contact should be with the Branch of Construction Wage Determinations. Write to:

Branch of Construction Wage Determinations  
Wage and Hour Division  
U. S. Department of Labor  
200 Constitution Avenue, N.W.  
Washington, D.C. 20210

2.) If the answer to the question in 1.) is yes, then an interested party (those affected by the action) can request review and reconsideration from the Wage and Hour Administrator (See 29 CFR Part 1.8 and 29 CFR Part 7). Write to:

Wage and Hour Administrator  
U.S. Department of Labor  
200 Constitution Avenue, N.W.  
Washington, D.C. 20210

The request should be accompanied by a full statement of the interested party's position and by any information (wage payment data, project description, area practice material, etc.) that the requestor considers relevant to the issue.

3.) If the decision of the Administrator is not favorable, an interested party may appeal directly to the Administrative Review Board (formerly the Wage Appeals Board). Write to:

Administrative Review Board  
U. S. Department of Labor  
200 Constitution Avenue, N.W.  
Washington, D.C. 20210

4.) All decisions by the Administrative Review Board are final.

END OF GENERAL DECISION

**STANDARD SPECIAL PROVISION**

**GENERAL DECISION NC20080011 10/23/2009 NC11**

Z-12

Date: October 23, 2009  
General Decision Number NC20080011 10/23/2009  
Superseded General Decision No. NC20070011  
State: North Carolina  
Construction Type: HIGHWAY

**COUNTIES:**

Alamance	Durham	Orange
Alexander	Forsyth	Randolph
Buncombe	Franklin	Rowan
Burke	Gaston	Stokes
Cabarrus	Guilford	Union
Catawba	Lincoln	Wake
Cumberland	Mecklenburg	Yadkin
Davidson	New Hanover	
Davie	Onslow	

HIGHWAY CONSTRUCTION PROJECTS (does not include tunnels, building structures in rest area projects, railroad construction, and, bascule, suspension and spandrel arch bridges, bridges designed for commercial navigation, and bridges involving marine construction, and other major bridges).

Modification Number	Publication Date
0	02/08/2008
1	07/25/2008
2	07/24/2009
3	10/23/2009

SUNC1990-014 02/12/1990

	Rates	Fringes
CARPENTER	7.63	
CONCRETE FINISHER	7.52	
ELECTRICIAN	10.26	
IRONWORKERS (reinforcing)	9.76	
LABORER		
General	7.25	
Asphalt Lay Down Person	7.25	
Asphalt Raker	7.25	
Form Setter (road)	8.57	
Mason (brick, block, stone)	7.44	
Pipe Layer	7.25	
Power Tool Operator	8.28	

POWER EQUIPMENT OPERATORS		
Asphalt Distributor	7.25	
Asphalt Paver	7.47	
Bulldozer	7.33	
Bulldozer (utility)	7.25	
Concrete Curb Machine	7.25	
Concrete Finishing Machine	7.85	
Concrete Paver	7.25	
Crane, Backhoe, Shovel & Dragline (over 1 yd)	8.16	
Crane, Backhoe, Shovel & Dragline(1 yd and under)	7.25	
Drill Operator	7.34	
Grade Checker	7.25	
Gradeall	8.38	
Grease Person	7.25	
Loader	7.25	
Mechanic	8.47	
Motor Grader (Fine Grade)	8.04	
Motor Grader(Rough Grade)	7.68	
Oiler	7.25	
Roller (Finisher)	7.25	
Roller (Rough)	7.25	
Scraper	7.25	
Screed Asphalt	7.25	
Stone Spreader	7.25	
Stripping Machine Operator	7.25	
Subgrade Machine	7.25	
Sweeper	7.25	
Tractor (Utility)	7.25	

TRUCK DRIVERS		
Trucks – Single Rear Axle	7.25	
Trucks – Multi Rear Axle	7.25	
Trucks – Heavy Duty	9.47	

WELDERS – Receive rate prescribed for craft performing operation to which welding is incidental.

Unlisted classifications needed for work not included within the scope of the classifications listed may be added after award only as provided in the labor standards contract clauses (29 CFR 5.5(a)(1)(ii)).

In the listing above, the "SU" designation means that rates listed under that identifier do not reflect collectively bargained wage and fringe benefit rates. Other designations indicate unions whose rates have been determined to be prevailing.

**WAGE DETERMINATION APPEALS PROCESS**

1.) Has there been an initial decision in the matter? This can be:

- \* an existing published wage determination
- \* a survey underlying a wage determination
- \* a Wage and Hour Division letter setting forth a position on a wage determination matter
- \* a conformance (additional classification and rate) ruling

On survey related matters, initial contact, including requests for summaries of surveys, should be with the Wage and Hour Regional Office for the area in which the survey was conducted because those Regional Offices have responsibility for the Davis-Bacon survey program. If the response from this initial contact is not satisfactory, then the process described in 2.) and 3.) should be followed.

With regard to any other matter not yet ripe for the formal process described here, initial contact should be with the Branch of Construction Wage Determinations. Write to:

Branch of Construction Wage Determinations  
Wage and Hour Division  
U. S. Department of Labor  
200 Constitution Avenue, N.W.  
Washington, D.C. 20210

2.) If the answer to the question in 1.) is yes, then an interested party (those affected by the action) can request review and reconsideration from the Wage and Hour Administrator (See 29 CFR Part 1.8 and 29 CFR Part 7). Write to:

Wage and Hour Administrator  
U.S. Department of Labor  
200 Constitution Avenue, N.W.  
Washington, D.C. 20210

The request should be accompanied by a full statement of the interested party's position and by any information (wage payment data, project description, area practice material, etc.) that the requestor considers relevant to the issue.

3.) If the decision of the Administrator is not favorable, an interested party may appeal directly to the Administrative Review Board (formerly the Wage Appeals Board). Write to:

Administrative Review Board  
U. S. Department of Labor  
200 Constitution Avenue, N.W.  
Washington, D.C. 20210

4.) All decisions by the Administrative Review Board are final.

END OF GENERAL DECISION