

BK-5101R

CONTRACT NO. D000074

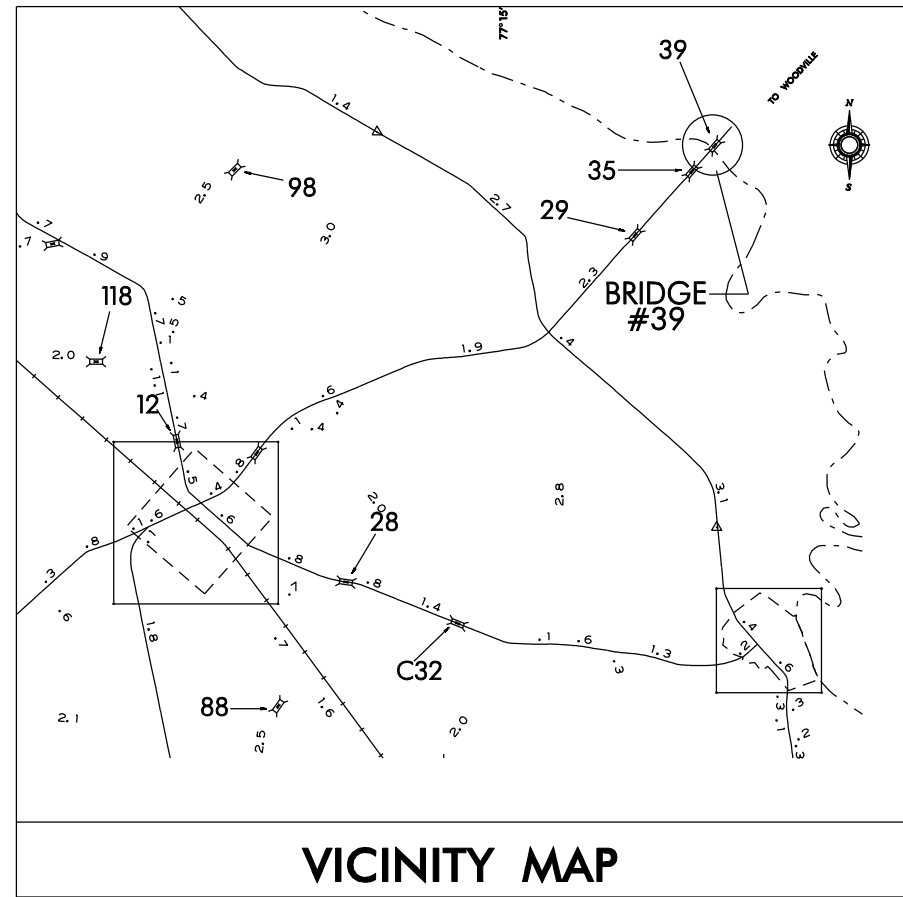

STATE OF NORTH CAROLINA
DIVISION OF HIGHWAYS

MARTIN COUNTY

LOCATION: BRIDGE #39, ON NC11, ACROSS ROANOKE RIVER

TYPE OF WORK: BRIDGE DECK PRESERVATION

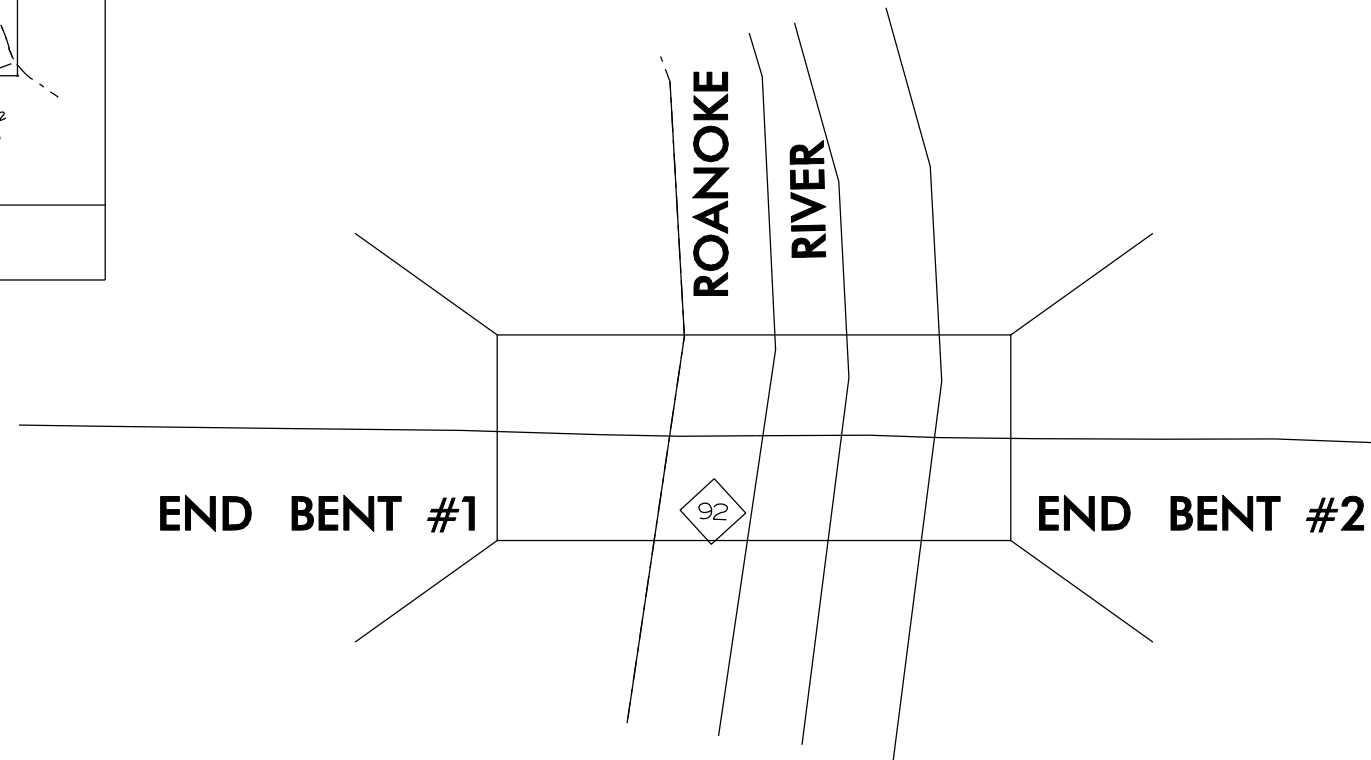

STATE	STATE PROJECT REFERENCE NO.	SHEET NO.	TOTAL SHEETS
N.C.	BK-5101R	1	6
STATE PROJ. NO.	F.A. PROJ. NO.	DESCRIPTION	
42579.1.1	BRSTP-0011(19)	P.E.	
42579.3.16	BRSTP-0011(19)	CONST	

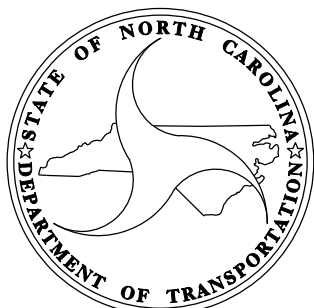

DESIGN DATA

ADT 2005 = 4300
ADT 2025 = 8600

PROJECT LENGTH

LENGTH STRUCTURE PROJECT = 0.097 MILE

Prepared In the Office of:

BRIDGE MANAGEMENT UNIT

NORTH CAROLINA DEPARTMENT OF TRANSPORTATION

2006 STANDARD SPECIFICATIONS

LETTING DATE:
AUGUST 19, 2010

DAN HOLDERMAN, PE
STATE BRIDGE
MANAGEMENT ENGINEER

MIKE SUMMERS
BRIDGE MANAGEMENT
PROJECT MANAGER

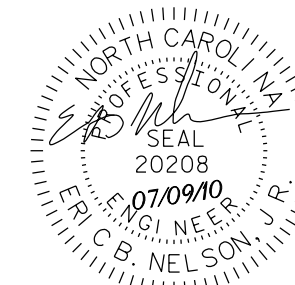

DESIGN ENGINEER

NOTES

- FOR OVERLAY OF BRIDGE DECKS WITH LATEX MODIFIED CONCRETE-VERY EARLY STRENGTH, SEE SPECIAL PROVISIONS.
- SEE SPECIAL PROVISIONS FOR SURFACE PREPARATION.
- FOR HYDRO-DEMOLITION, SEE SPECIAL PROVISIONS .
- THE CONTRACTOR MUST COLLECT, TREAT AND DISPOSE OF RUN -OFF WATER FROM THE HYDRO- DEMOLITION PROCESS, SEE SPECIAL PROVISIONS.
- THE BOUNDARIES OF AREAS IDENTIFIED FOR CLASS III SURFACE PREPARATION ARE APPROXIMATE. THE CONTRACTOR SHALL PROVIDE A METHOD OF HANDLING UNEXPECTED BLOW THROUGH OF DECK. SEE DETAIL.
- FOR EVAZOTE JOINT SEALS, SEE SPECIAL PROVISIONS.

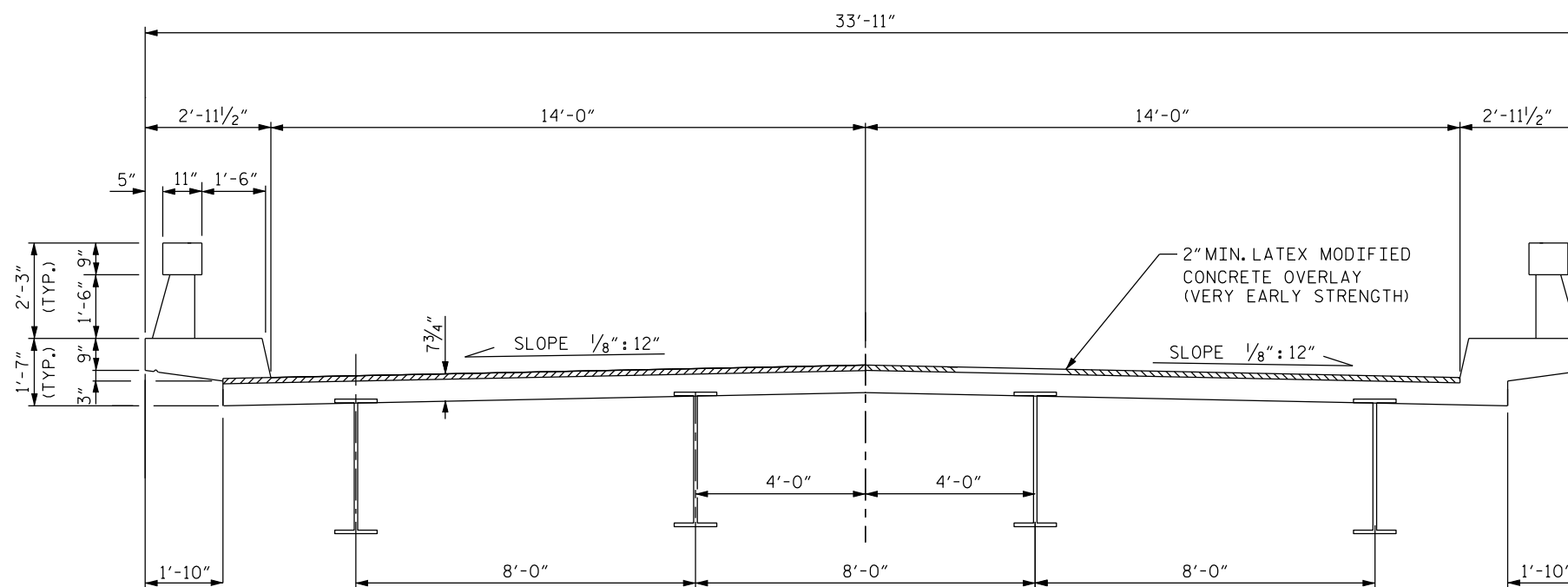

TYPICAL SECTION -(SPANS "A", "C" & "H" 36" I-BEAM)

TOTAL BILL OF MATERIAL

* DECK SCARIFICATION	* CLASS I SURFACE PREPARATION	* CLASS II SURFACE PREPARATION	* CLASS III SURFACE PREPARATION	HYDRO-DEMOLITION	LATEX MODIFIED CONC.- VERY EARLY STR.	PLACING & FINISHING LATEX MODIFIED CONC.-VERY EARLY STR.	CLASS AA CONCRETE	EVAZOTE JOINT SEALS	GROOVING BRIDGE FLOOR	ASPHALT CONCRETE SURFACE COURSE TYPE SF 9.5A
SQ.YDS.	SQ.YDS.	SQ.YDS.	SQ.YDS.	SQ.YDS.	C.Y.	SQ.YDS.	C.Y.	LUMP SUM	SQ. FT.	TONS
1891	1549	31	0	1580	91	1580	0	LUMP SUM	14,220	34

* QUANTITY SHOWN IS FOR INFORMATION ONLY.
 * INCLUDES APPROACH MILLING.

PROJECT NO. BK-5101R
 COUNTY: MARTIN
 STATION: N/A
 BRIDGE NO. 39

STATE OF NORTH CAROLINA
 DEPARTMENT OF TRANSPORTATION
 RALEIGH
 TYPICAL SECTIONS OF
 BRIDGE No. 39 ON
 NC 11 OVER
 ROANOKE RIVER

REVISIONS						SHEET NO.
NO.	BY	DATE	NO.	BY	DATE	TOTAL SHEETS
1			3			6
2			4			

DRAWN BY : S. T. SANDOR DATE : APR./2010
 CHECKED BY : A. ASTER DATE : APR./2010

← TO US93

TO WOODWILL →

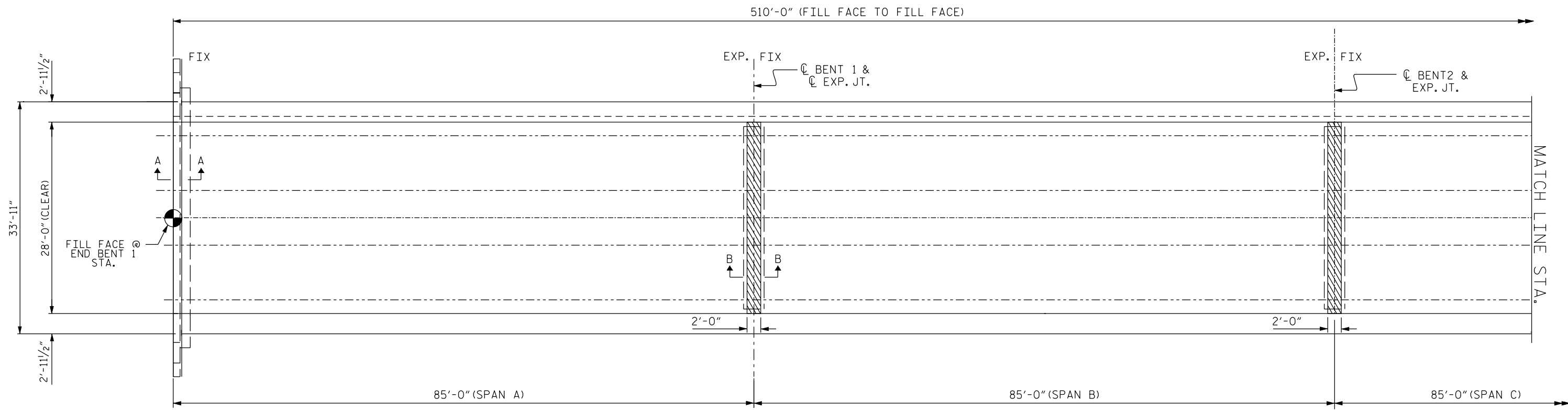
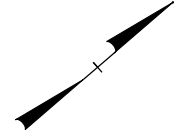

PLAN VIEW OF BRIDGE

- APPROX. AREA: CLASS II REPAIR
- SPALLS
- APPROX. TEST BORING LOCATION

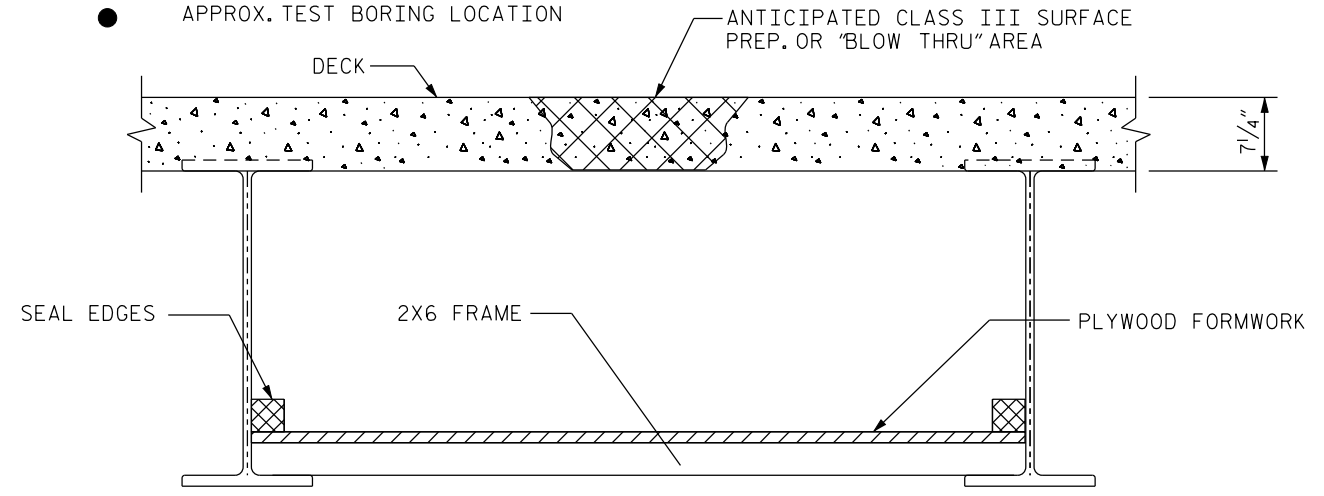

TYP. "BLOW THRU" CONTAINMENT AND FORMWORK

A METHOD TO CAPTURE WATER AND DEBRIS FROM BLOW THRU DURING HYDRO-DEMOLITION SHALL BE INSTALLED IN AREAS INDICATED AS CLASS III SURFACE PREPARATION.

SUBMIT DETAILS OF PROPOSED FORMWORK FOR APPROVAL PRIOR TO BEGINNING WORK.

COST FOR INSTALLING AND REMOVING FORMWORK SHALL BE INCIDENTAL TO THE PRICE PER SQ. YARD OF HYDRO-DEMOLITION.

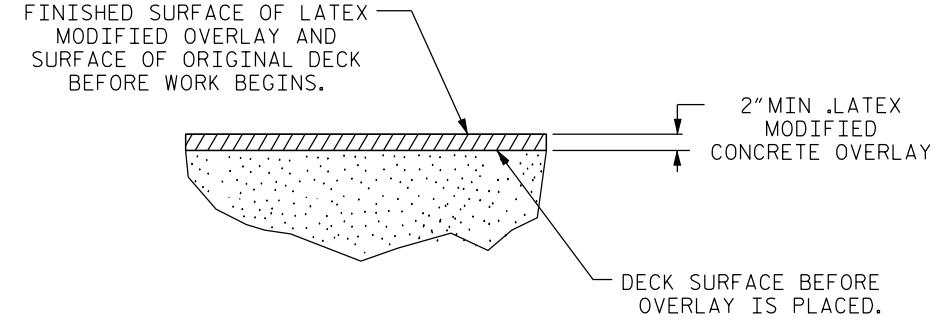

DETAIL FOR LATEX MODIFIED CONCRETE OVERLAY

PROJECT NO. BK-5101R
 COUNTY: MARTIN
 STATION: N/A
 DECK REHAB BRIDGE NO. 39

STATE OF NORTH CAROLINA
 DEPARTMENT OF TRANSPORTATION
 RALEIGH
 PLAN VIEW OF BRIDGE
 #39 ON NC 11 ACROSS
 ROANOKE RIVER
 28'-0" CLEAR ROADWAY (90°-00' SKEW)

REVISIONS						SHEET NO. 3
NO.	BY	DATE	NO.	BY	DATE	
1			3			TOTAL SHEETS 6
2			4			

DRAWN BY : S. T. SANDOR DATE : APR./2010
 CHECKED BY : A. ABRAHA DATE : APR./2010



TO US93

TO WOODWILL

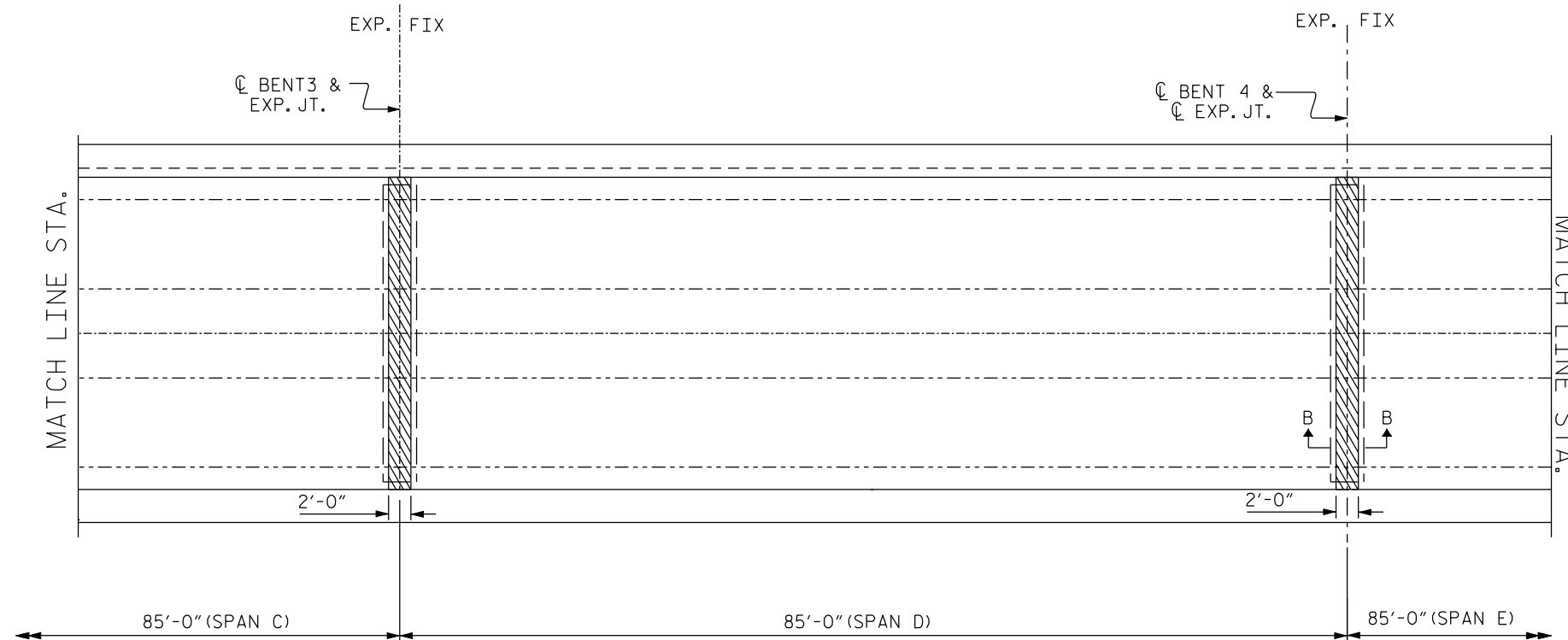
510'-0" (FILL FACE TO FILL FACE)



PLAN VIEW OF BRIDGE

-  APPROX. AREA: CLASS II REPAIR
-  SPALLS
-  APPROX. TEST BORING LOCATION

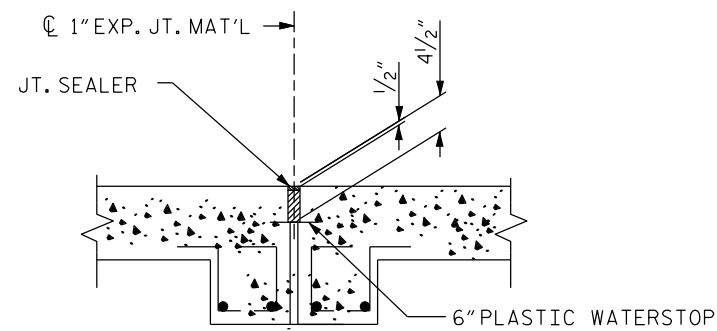

SECTION B-B
(EXISTING JOINT)

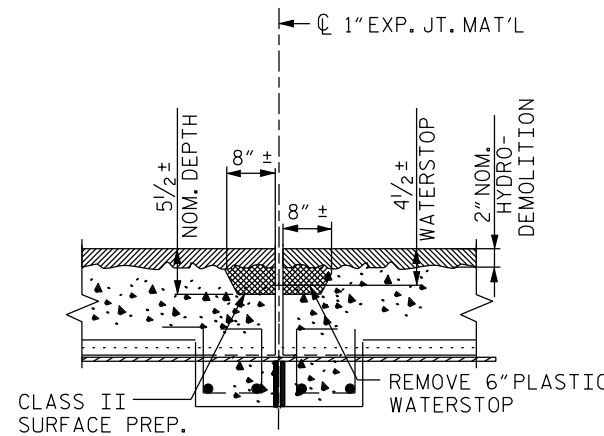

MINIMUM EXISTING JOINT DEMOLITION
(FOR SECTION B-B)

NOTE: RETAIN ALL EXISTING REINF. STEEL. CLEAN AND REPAIR AS REQ'D.

PROJECT NO. BK-5101R
 COUNTY: MARTIN
 STATION: N/A
 DECK REHAB BRIDGE NO. 39

STATE OF NORTH CAROLINA
 DEPARTMENT OF TRANSPORTATION
 RALEIGH

PLAN VIEW OF BRIDGE
 #39 ON NC 11 ACROSS
 ROANOKE RIVER
 28'-0" CLEAR ROADWAY (90°-00' SKEW)

REVISIONS						SHEET NO.
NO.	BY	DATE	NO.	BY	DATE	TOTAL SHEETS
1			3			4
2			4			6

DRAWN BY : S. T. SANDOR DATE : APR./2010
 CHECKED BY : A. ABRAHA DATE : APR./2010

*****SYSTEMTIME*****

*****USERNAME*****

*****DGN*****

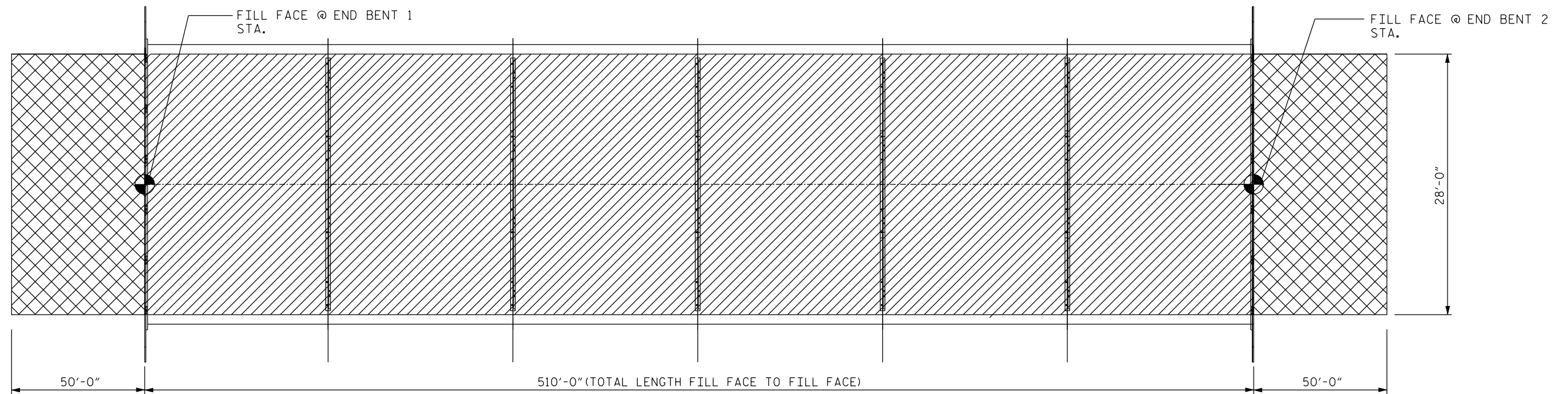

C1 PROPOSED APPROX. 2" MIN. ASPHALT CONCRETE SURFACE COURSE, TYPE SF9.5A, AT AN AVERAGE RATE OF 110 LBS. PER SQ. YD. PER 1" DEPTH TO BE PLACED IN LAYERS NOT LESS THAN 1" IN DEPTH OR GREATER THAN 1 1/2" IN DEPTH

PLAN

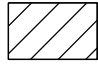
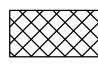
 DECK SCARICATION AND HYDRODEMOLITION
 APPROACH MILLING

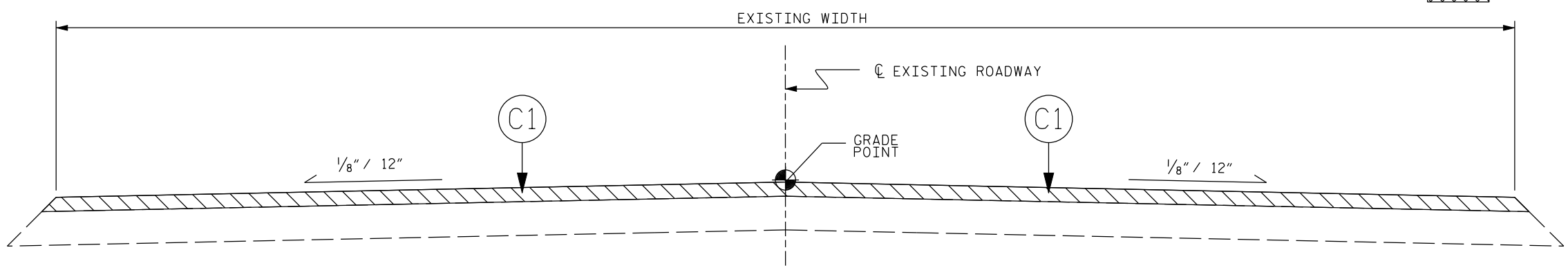

TYPICAL ROADWAY SECTION

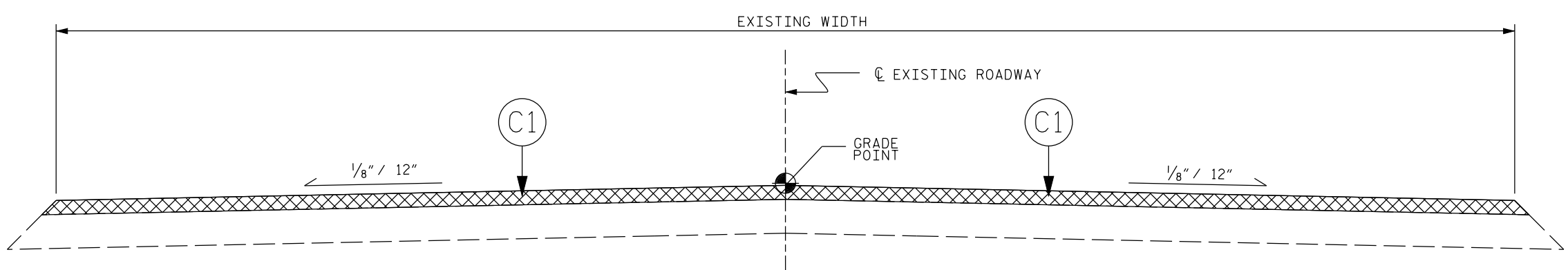

TYPICAL ROADWAY MILLING SECTION

(MILL TO 2" DEPTH)

PROJECT NO. BK-5101R
 COUNTY: MARTIN
 STATION: N/A
 DECK REHAB BRIDGE NO. 39

STATE OF NORTH CAROLINA
 DEPARTMENT OF TRANSPORTATION
 RALEIGH

TYPICAL ROADWAY SECTION
 AND MILLING DETAILS
 28'-0" CLEAR ROADWAY-(90°-00' SKEW)

REVISIONS						SHEET NO.
NO.	BY	DATE	NO.	BY	DATE	TOTAL SHEETS
1			3			6
2			4			6

DRAWN BY : S. T. SANDOR DATE : APR./2010
 CHECKED BY : A. ABRAHA DATE : APR./2010