



STATE OF NORTH CAROLINA  
DEPARTMENT OF TRANSPORTATION

BEVERLY PERDUE  
GOVERNOR

EUGENE CONTI  
SECRETARY

August 16, 2010

MEMORANDUM TO: Mr. C. E. Lassiter, Jr., PE  
Division Two Engineer

FROM: Philip S. Harris, III, P.E., Unit Head   
Natural Environment Unit  
Project Development and Environmental Analysis Branch

SUBJECT: Craven County, US Improvement in Brigeton; T.I.P. Number R-3403; Federal  
Aid Project No. STPNHF); WBS No. 34538.1.1

Attached is the U.S. Army Corps of Engineers Section 404 Nationwide Permit Number 14, N.C. Division of Water Quality Section 401 General Water Quality Certification, and Riparian Buffer Authorization for the above referenced project. All environmental permits have been received for the construction of this project.

A copy of this permit package will be posted on the NCDOT website at:  
<http://www.ncdot.gov/doh/preconstruct/pe/neu/permit.html>

PSH/gyb

Attachment

Cc: W/attachment  
Mr. Randy Garriss, P.E. State Contract Officer  
Mr. Jay B. Johnson, Division Environmental Officer  
Andy Blankenship, NCDOT Roadside Environmental Unit

Cc: W/o attachment (see website for attachments)  
Mr. Majed Alghandour, P. E., Programming and TIP  
Mr. Jay Bennett, P.E., Roadway Design  
Dr. David Chang, P.E., Hydraulics  
Mr. Art McMillan, P.E., Highway Design  
Mr. Tom Koch, P.E., Structure Design  
Mr. Dewayne Sykes, P.E., Utilities Unit  
Mr. Mark Staley, Roadside Environmental  
Mr. John F. Sullivan, FHWA  
Mr. Ron Hancock, P.E., State Roadway Construction Engineer  
Mr. Mike Robinson, P.E., State Bridge Construction Engineer  
Ms. Beth Harmon, EEP  
Mr. Rob Hanson, P.E., PDEA Eastern Region Unit Head

## PROJECT COMMITMENTS

Craven County  
US 17 Improvement in Bridgeton  
Federal Aid Project STPNHF-17(24)  
WBS No. 34538.1.1  
TIP No. R-3403

### **Commitments Developed Through Planning**

#### ***PDEA, Program Development, & Roadway Design***

NCDOT will coordinate with the Town of Bridgeton on the matter of providing sidewalks from Mills Street to the Norfolk Southern Railway crossing on US 17.

*NCDOT Pedestrian Guidelines will be implemented.*

**The following two commitments pertain to R-3403B only.**

#### ***PDEA, Program Development, & Roadway Design***

NCDOT proposes to replace the bridge over Little Swift Creek. In an effort to enhance the environment and gain the mitigation credits, NCDOT will negotiate with the US Army Corps of Engineers (USACE) and the NC Department of Environment and Natural Resources (NCDENR), Division of Water Quality (DWQ) and consider replacing the bridge over Little Swift Creek with a structure(s) longer than the existing, and removing the existing fill on the bridge's approaches.

*This environmental commitment was discussed at a recent merger team meeting, the purpose of which was to select the LEDPA and the bridging alternative over Little Swift Creek.*

#### ***PDEA, Roadway Design, Division 2 Construction***

The Stream Crossing Guidelines for Anadromous Fish Passage, dated May 12, 1977, provides guidance to the NCDOT to ensure that replacement of existing stream crossing structures will not impede the movement of anadromous fish. These guidelines will be implemented for all of the stream crossings on this project.

*NCDOT will ensure these guidelines are followed in the design and construction stages.*

### **Commitments Developed Through Permitting**

Note: The attached Section 404 permit, 401 Water Quality Certification, and the Neuse River Riparian Buffer Certification applies only to R-3403 AA and AB.

## ***PDEA***

Compensatory mitigation for impacts to 0.96 acres of wetlands is required. We understand that you have chosen to perform compensatory mitigation for impacts to wetlands through the North Carolina Ecosystem Enhancement Program (EEP) and that EEP has agreed to implement the mitigation for this project. EEP has indicated in a letter dated November 13, 2008, that they will assume responsibility for satisfying the federal Clean Water Act compensatory mitigation requirements for the above-referenced project, in accordance with the Tri-Party MOA signed on July 22, 2003 and the Dual-Party MOA signed on April 12, 2004.

Compensatory mitigation for 226 linear feet of impacts to streams is required. We understand that you have chosen to perform compensatory mitigation for impacts to streams through the North Carolina Ecosystem Enhancement Program (EEP) and that EEP has agreed to implement the mitigation for this project. EEP has indicated in a letter dated November 13, 2008, that they will assume responsibility for satisfying the federal Clean Water Act compensatory mitigation requirements for the above-referenced project, in accordance with the Tri-Party MOA signed on July 22, 2003 and the Dual-Party MOA signed on April 12, 2004.

Compensatory mitigation for impacts to 3,662 square feet of protected riparian buffers in Zone 1 and 4,445 square feet of protected riparian buffers in Zone 2, a total of 8,107 square feet, shall be required. We understand that you have chosen to perform compensatory mitigation for impacts to protected buffers through use of the North Carolina Ecosystem Enhancement Program (EEP). Mitigation for unavoidable impacts to Neuse Riparian Buffers shall be provided in the Neuse River Basin and done in accordance with 15A NCAC 2B. EEP has indicated in a letter dated November 13, 2008, that they will assume responsibility for satisfying the federal Clean Water Act compensatory mitigation requirements for the above-referenced project, in accordance with the Tri-Party MOA signed on July 22, 2003 and the Dual-Party MOA signed on April 12, 2004.

## ***Division 2 Construction***

Mechanized clearing shall not be used for the purpose of clearing vegetation in relocating overhead power lines within jurisdictional wetlands.

## ***PDEA, Division 2 Construction***

When final design plans are completed for R-3403 Section B, a 401 Water Quality Certification, and a Neuse River Riparian Buffer Certification shall be submitted with five copies and fees to the NC Division of Water Quality and a separate Section 404 permit application shall be submitted to the USACE. Final designs shall reflect all appropriate avoidance, minimizations, and mitigation for impacts to wetlands, streams, and other surface waters and buffers. No construction activities that impact any wetlands, streams, surface waters, or buffers located in R-3403 Section B shall begin until after permittee applies for, and receives, a Section 404 permit, a 401 Water Quality Certification and a Neuse River Riparian Buffer Certification from the NC Division of Water Quality and the USACE.

U.S. ARMY CORPS OF ENGINEERS  
WILMINGTON DISTRICT

Action ID. 201001225

County: Craven

USGS Quad: NC-Askin

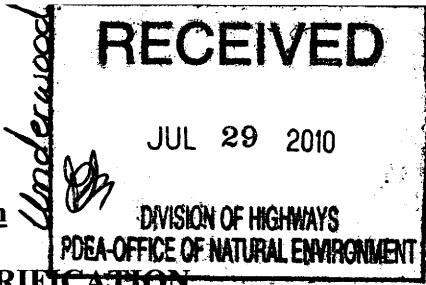

**GENERAL PERMIT (REGIONAL AND NATIONWIDE) VERIFICATION**

Property Owner / Authorized Agent: NCDOT / Gregory Thorpe

Address: PDEA

1598 Mail Service Center

Raleigh, North Carolina 27699-1598

Telephone No.: 919-431-2000

Size and location of property (water body, road name/number, town, etc.): TIP R-3403 AA: Improvements to US17 from Mills Street to Norfolk and Southern Railway in Bridgeton, Craven County, North Carolina.

Description of projects area and activity: Expansion of US 17 to a four-lane facility will result in permanent Section 404 wetland impacts at two sites in Section AA. Wetland impacts involve 0.09 acres of permanent fill and 0.08 acres of mechanized clearing. NCDOT will mitigate for 0.17 acres of non-riparian wetland impact at a 2:1 ratio (0.34 acres) using NCEEP.

Applicable Law:  Section 404 (Clean Water Act, 33 USC 1344)  
 Section 10 (Rivers and Harbors Act, 33 USC 403)

Authorization: Regional General Permit Number: \_\_\_\_\_  
Nationwide Permit Number: NW 14

Your work is authorized by the above referenced permit provided it is accomplished in strict accordance with the attached conditions and your submitted plans. Any violation of the attached conditions or deviation from your submitted plans may subject the permittee to a stop work order, a restoration order and/or appropriate legal action.

This verification is valid until the NWP is modified, reissued, or revoked. All of the existing NWPs are scheduled to be modified, reissued, or revoked prior to March 18, 2012. It is incumbent upon you to remain informed of changes to the NWPs. We will issue a public notice when the NWPs are reissued. Furthermore, if you commence or are under contract to commence this activity before the date that the relevant nationwide permit is modified or revoked, you will have twelve (12) months from the date of the modification or revocation of the NWP to complete the activity under the present terms and conditions of this nationwide permit.

Activities subject to Section 404 (as indicated above) may also require an individual Section 401 Water Quality Certification. You should contact the NC Division of Water Quality (telephone (919) 733-1786) to determine Section 401 requirements.

For activities occurring within the twenty coastal counties subject to regulation under the Coastal Area Management Act (CAMA), prior to beginning work you must contact the N.C. Division of Coastal Management in Morehead City, NC, at (252) 808-2808.

This Department of the Army verification does not relieve the permittee of the responsibility to obtain any other required Federal, State or local approvals/permits.

If there are any questions regarding this verification, any of the conditions of the Permit, or the Corps of Engineers regulatory program, please contact Tom Steffens at (910)-251-4615.

Corps Regulatory Official [Signature] TH STEFFENS Date: 07/26/2010

Expiration Date of Verification: 03/18/2012

The Wilmington District is committed to providing the highest level of support to the public. To help us ensure we continue to do so, please complete the Customer Satisfaction Survey located at our website at <http://regulatory.usacesurvev.com/> to complete the survey online.

**Determination of Jurisdiction:**

- Based on preliminary information, there appear to be waters of the US including wetlands within the above described project area. This preliminary determination is not an appealable action under the Regulatory Program Administrative Appeal Process (Reference 33 CFR Part 331).
- There are Navigable Waters of the United States within the above described project area subject to the permit requirements of Section 10 of the Rivers and Harbors Act and Section 404 of the Clean Water Act. Unless there is a change in the law or our published regulations, this determination may be relied upon for a period not to exceed five years from the date of this notification.
- There are waters of the US and/or wetlands within the above described project area subject to the permit requirements of Section 404 of the Clean Water Act (CWA)(33 USC § 1344). Unless there is a change in the law or our published regulations, this determination may be relied upon for a period not to exceed five years from the date of this notification.
- The jurisdictional areas within the above described project area have been identified under a previous action. Please reference jurisdictional determination issued 01/29/2009. Action ID 200900217

Basis of Jurisdictional Determination: \_\_\_\_\_

**Appeals Information (This information applies only to approved jurisdictional determinations.)**

Attached to this verification is an approved jurisdictional determination. If you are not in agreement with that approved jurisdictional determination, you can make an administrative appeal under 33 CFR 331. Enclosed you will find a Notification of Appeal Process (NAP) fact sheet and request for appeal (RFA) form. If you request to appeal this determination you must submit a completed RFA form to the following address:

District Engineer, Wilmington Regulatory Division  
Attn: Tom Steffens, Project Manager,  
Washington Regulatory Field Office  
Post Office Box 1000  
Washington, North Carolina 27889

In order for an RFA to be accepted by the Corps, the Corps must determine that it is complete, that it meets the criteria for appeal under 33 CFR part 331.5, and that it has been received by the District Office within 60 days of the date of the NAP. Should you decide to submit an RFA form, it must be received at the above address by 9/26/2010.

**\*\*It is not necessary to submit an RFA form to the District Office if you do not object to the determination in this correspondence.\*\***

Corps Regulatory Official:  T. STEFFENS

Date 07/26/2010

Expiration Date 03/18/2012

**SURVEY PLATS, FIELD SKETCH, WETLAND DELINEATION FORMS, PROJECT PLANS, ETC., MUST BE ATTACHED TO THE FILE COPY OF THIS FORM, IF REQUIRED OR AVAILABLE.**

Copy Furnished:  
RG-W

Action ID Number: 2010-01225

County: Craven

Permittee: NCDOT

Date Verification Issued: 07/26/2010

Project Manager: Tom Steffens

Upon completion of the activity authorized by this permit and any mitigation required by the permit, sign this certification and return it to the following address:

US ARMY CORPS OF ENGINEERS  
WILMINGTON DISTRICT  
WILMINGTON REGULATORY FIELD OFFICE  
POST OFFICE BOX 1890  
WILMINGTON, NORTH CAROLINA 28402-1890

Please note that your permitted activity is subject to a compliance inspection by a U. S. Army Corps of Engineers representative. If you fail to comply with this permit you are subject to permit suspension, modification, or revocation.

I hereby certify that the work authorized by the above referenced permit has been completed in accordance with the terms and condition of the said permit, and required mitigation was completed in accordance with the permit conditions.

\_\_\_\_\_  
Signature of Permittee

\_\_\_\_\_  
Date



North Carolina Department of Environment and Natural Resources

Division of Water Quality  
 Coleen H. Sullins  
 Director

Beverly Eaves Perdue  
 Governor

Dee Freeman  
 Secretary

June 30, 2010  
 Craven County  
 DWQ Project No. 20081808 v.2  
 Improvements to US 17  
 TIP No. R-3403A

**APPROVAL of 401 WATER QUALITY CERTIFICATION, NEUSE BUFFER AUTHORIZATION, and ISOLATED WETLANDS PERMIT Pursuant to IWGP100000 with ADDITIONAL CONDITIONS (Revised)**

Dr. Gregory J. Thorpe, Manager  
 Planning & Environmental Branch  
 N.C. Department of Transportation  
 1548 Mail Service Center  
 Raleigh, North Carolina, 27699-1548

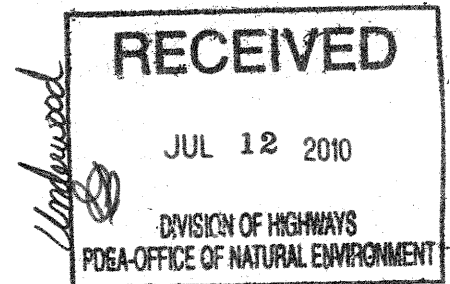

Dear Dr. Thorpe:

You have our approval, in accordance with the conditions listed below, for the following stream and wetland impacts for the purpose of improving US 17 in Bridgeton from Mills Street to north of SR 1433 (Antioch Road) in Craven County.

This modified 401 Water Quality Certification is to address your request to add a section of curb and gutter to your project, which resulted in a decrease of wetland impacts in Section AA of the project from 0.27 acres to 0.17 acres; a decrease in impacts of 0.10 acres. **This authorization does not allow additional impacts to streams, Neuse River Basin riparian buffers, or isolated wetlands.**

**Stream Impacts in the Neuse River Basin**

Site	Permanent Fill in Intermittent Stream (linear ft)	Temporary Fill in Intermittent Stream (linear ft)	Permanent Fill in Perennial Stream (linear ft)	Temporary Fill in Perennial Stream (linear ft)	Total Stream Impact (linear ft)	Stream Impacts Requiring Mitigation (linear ft)
<b>SECTION AB</b>						
1 (B1)	0	0	72	80	152	0
2 (B2)	0	0	0	0	0	0
3 (B3)	0	0	105	61	166	0
5 (B5)	0	0	0	0	0	0
7 (B7)	0	0	0	0	0	0
8 (155+48-L-) (B8)	0	0	155	77	232	155
8 (13+48-Y13-) (B8)	0	0	111	18	129	111
9 (B9)	0	0	0	0	0	0
<b>Total</b>	<b>0</b>	<b>0</b>	<b>443</b>	<b>236</b>	<b>679</b>	<b>266</b>
<b>SECTION B</b>						
<b>Total</b>	<b>0</b>	<b>0</b>	<b>0</b>	<b>0</b>	<b>0</b>	<b>0</b>
<b>Project Total</b>	<b>0</b>	<b>0</b>	<b>443</b>	<b>236</b>	<b>679</b>	<b>266</b>
<b>Additional Impacts Authorized</b>	<b>0</b>	<b>0</b>	<b>0</b>	<b>0</b>	<b>0</b>	<b>0</b>

**Total Stream Impact for Project: 679 linear feet.**

Transportation and Permitting Unit  
 1650 Mail Service Center, Raleigh, North Carolina 27699-1650  
 Location: 2321 Crabtree Blvd., Raleigh, North Carolina 27604  
 Phone: 919-733-1786 \ FAX: 919-733-6893  
 Internet: <http://h2o.enr.state.nc.us/ncwetlands/>



**Wetland Impacts in the Neuse River Basin**

Site	Fill (perm.) (ac)	Fill (temp.) (ac)	Excavation (ac)	Mechanized Clearing (ac)	Hand Clearing (ac)	Total Wetland Impact (ac)
<b>ORIGINAL IMPACTS APPROVED</b>						
<b>SECTION AA</b>						
1 (A1)	0.02	0	0	0.02	0	0.04
2 (A2)	0.14	0	0	0.09	0	0.23
<b>Total</b>	<b>0.16</b>	<b>0</b>	<b>0</b>	<b>0.11</b>	<b>0</b>	<b>0.27</b>
<b>SECTION AB</b>						
1 (B1)	0.05	0	0	0	0.07	0.12
3 (B3)	0.09	0	<0.01	0	0.07	0.17
5 (B5)	0.04	0	0	0	0.09	0.13
7 (B7)	0.48	0	0	0	0.05	0.53
8 (155+48-L-) (B8)	0	0	0	0	0	0
8 (13+48-Y13-) (B8)	0	0	0	0	0	0
<b>Total</b>	<b>0.66</b>	<b>0.00</b>	<b>0.01</b>	<b>0.00</b>	<b>0.28</b>	<b>0.95</b>
<b>SECTION B</b>						
<b>Total</b>	<b>0</b>	<b>0</b>	<b>0</b>	<b>0</b>	<b>0</b>	<b>0</b>
<b>Project Total</b>	<b>0.82</b>	<b>0</b>	<b>0.01</b>	<b>0.11</b>	<b>0.28</b>	<b>1.22</b>
<b>IMPACTS APPROVED WITH THIS MODIFICATION</b>						
<b>SECTION AA</b>						
1 (A1)	0.02	0	0	0.01	0	0.03
2 (A2)	0.06	0	0	0.08	0	0.14
<b>Total</b>	<b>0.08</b>	<b>0</b>	<b>0</b>	<b>0.09</b>	<b>0</b>	<b>0.17</b>
<b>SECTION AB</b>						
1 (B1)	0.05	0	0	0	0.07	0.12
3 (B3)	0.09	0	<0.01	0	0.07	0.17
5 (B5)	0.04	0	0	0	0.09	0.13
7 (B7)	0.48	0	0	0	0.05	0.53
8 (155+48-L-) (B8)	0	0	0	0	0	0
8 (13+48-Y13-) (B8)	0	0	0	0	0	0
<b>Total</b>	<b>0.66</b>	<b>0.00</b>	<b>0.01</b>	<b>0.00</b>	<b>0.28</b>	<b>0.95</b>
<b>SECTION B</b>						
<b>Total</b>	<b>0</b>	<b>0</b>	<b>0</b>	<b>0</b>	<b>0</b>	<b>0</b>
<b>Additional Impacts Authorized</b>	<b>0.74</b>	<b>0.00</b>	<b>0.01</b>	<b>0.09</b>	<b>0.28</b>	<b>1.12</b>
<b>Difference</b>	<b>-0.08</b>	<b>0.00</b>	<b>0.00</b>	<b>-0.02</b>	<b>0.00</b>	<b>-0.10</b>

**Total Jurisdictional Wetland Impact for Project: 1.12 acres.**

**Isolated Wetland Impacts in the Neuse River Basin**

Site	Fill (ac)	Fill (temporary) (ac)	Excavation (ac)	Mechanized Clearing (ac)	Hand Clearing (ac)	Total Wetland Impact (ac)
<b>SECTION AB</b>						
2 (B2)	0.02	0	0	0	0.06	0.08
9 (B9)	0.11	0	0	0	0.02	0.13
<b>Total</b>	<b>0.13</b>	<b>0</b>	<b>0</b>	<b>0</b>	<b>0.08</b>	<b>0.21</b>
<b>SECTION B</b>						
<b>Total</b>	<b>0</b>	<b>0</b>	<b>0</b>	<b>0</b>	<b>0</b>	<b>0</b>
<b>Project Total</b>	<b>0.13</b>	<b>0</b>	<b>0</b>	<b>0</b>	<b>0.08</b>	<b>0.21</b>
<b>Additional Impacts Authorized</b>	<b>0.00</b>	<b>0.00</b>	<b>0.00</b>	<b>0.00</b>	<b>0.00</b>	<b>0.00</b>

**Total Isolated Wetland Impact for Project: 0.21 acres.**



**Neuse River Riparian Buffer Impacts**

Site	Zone 1 Impact (ft <sup>2</sup> )	minus Wetlands in Zone 1 (ft <sup>2</sup> )	= Zone 1 Buffers (not WL) (ft <sup>2</sup> )	Zone 1 Buffer Mitigation Required (3:1 ratio)	Zone 2 Impact (ft)	minus Wetlands in Zone 2 (ft <sup>2</sup> )	= Zone 2 Buffers (not WL) (ft <sup>2</sup> )	Zone 2 Buffer Mitigation Required (1.5:1 ratio)	Total Area Requiring Mitigation (ft <sup>2</sup> )	Total Mitigation Required (ft <sup>2</sup> )
<b>SECTION A B</b>										
1 (B1)	7,913	2,747	5,166	N/A*	4,846	1,145	3,701	N/A*	N/A*	0.00
3 (B3)	8,264	4,602	3,662	10,986	5,126	681	4,445	6,668	8,107	17,654
<b>Total</b>	<b>16,177</b>	<b>7,349</b>	<b>8,828</b>	<b>10,986</b>	<b>9,972</b>	<b>1,826</b>	<b>8,146</b>	<b>6,668</b>	<b>8,107</b>	<b>17,654</b>
<b>SECTION B</b>										
<b>Total</b>	<b>0</b>	<b>0</b>	<b>0</b>	<b>0</b>	<b>0</b>	<b>0</b>	<b>0</b>	<b>0</b>	<b>0</b>	<b>0</b>
<b>Project Total</b>	<b>16,177</b>	<b>7,349</b>	<b>8,828</b>	<b>10,986</b>	<b>9,972</b>	<b>1,826</b>	<b>8,146</b>	<b>6,668</b>	<b>8,107</b>	<b>17,654</b>
<b>Add. Impacts Auth.</b>	<b>0</b>	<b>0</b>	<b>0</b>	<b>0</b>	<b>0</b>	<b>0</b>	<b>0</b>	<b>0</b>	<b>0</b>	<b>0</b>

\* n/a = Total for Site is less than 1/3 acre and 150 linear feet of impact, no mitigation required

**Total Buffer Impact for Project: 26,149 square feet.**

The application provides adequate assurance that the discharge of fill material into the waters of the Neuse River Basin in conjunction with the proposed development will not result in a violation of applicable Water Quality Standards and discharge guidelines. Therefore, the State of North Carolina certifies that this activity will not violate the applicable portions of Sections 301, 302, 303, 306, 307 of PL 92-500 and PL 95-217 if conducted in accordance with the application and conditions hereinafter set forth.

This approval is valid solely for the purpose and design described in your original application dated received December 10, 2008 and the modification (unless modified below) dated received June 16, 2010. Should your project change, you must notify the DWQ and submit a new application. If the property is sold, the new owner must be given a copy of this Certification and approval letter, and is thereby responsible for complying with all the conditions. If total wetland fills for this project (now or in the future) exceed one acre, or of total impacts to streams (now or in the future) exceed 150 linear feet, compensatory mitigation may be required as described in 15A NCAC 2H .0506 (h) (6) and (7). For this approval to remain valid, you must adhere to the conditions listed in the attached certification.

**Conditions of Certification:**

1. All other conditions written into previous Water Quality Certifications issued January 12, 2009 for this project still apply.

If you do not accept any of the conditions of this certification, you may ask for an adjudicatory hearing. You must act within 60 days of the date that you receive this letter. To ask for a hearing, send a written petition that conforms to Chapter 150B of the North Carolina General Statutes to the Office of Administrative Hearings, 6714 Mail Service Center, Raleigh, N.C. 27699. This certification and its conditions are final and binding unless you ask for a hearing. This letter completes the review of the Division of Water Quality under Section 401 of the Clean Water Act. If you have any questions, please contact David Wainwright at (919)715-3415.

Sincerely,



Coleen Sullins

cc: Wilmington US Army Corp District Office  
Jay Johnson, Division 2 Environmental Officer  
Tom Steffens, US Army Corps of Engineers, Washington Field Office  
Chris Militscher, Environmental Protection Agency  
Travis Wilson, NC Wildlife Resources Commission (electronic)  
Steve Sollod, Division of Coastal Management  
Garcy Ward, DWQ Washington Regional Office  
File Copy

## Additional Special Conditions

Action I.D. # SAW-2010-01225 - NCDOT, US Hwy 17, Widening and improvements.  
TIP-R-3403 AA.

- a) The permittee shall require its contractors and/or agents to comply with the terms and conditions of this permit in the construction and maintenance of this project, and shall provide each of its contractors and/or agents associated with the construction or maintenance of this project, with a copy of this permit. A copy of this permit, including all conditions and any Corps approved modifications, shall be available at the project site during construction and maintenance of this project.
- b) Any violation of these conditions or violations of Section 404 of the Clean Water Act or Section 10 of the Rivers and Harbors Act must be reported in writing to the Wilmington District, U.S. Army Corps of Engineers, within 24 hours of the violation.
- c) Compensatory mitigation for the unavoidable impacts to 0.17 acres of non-riparian wetlands associated with the construction of the US Hwy17 Improvements (TIP Number R-3403, Section AA) shall be provided by the North Carolina Ecosystem Enhancement Program (NCEEP), as outlined in the letter dated October 20, 2009, from William D. Gilmore, NCEEP Director. Pursuant to the Tri-Party Memorandum of Agreement (MOA) between the NC Department of Environment and Natural Resources (NCDENR), the NC Department of Transportation (NCDOT) and the US Army Corps of Engineers (USACE) executed on March 8, 2007, and in accordance with Section X of Amendment No. 2 to the MOA, the permittee shall make payment to the NCEEP in the amount determined by the NCEEP, sufficient to perform the restoration of .34 acres of non-Riparian wetlands in the Neuse River Basin, Cataloging Unit (03020204).
- d) Failure to institute and carry out the details of special conditions a - d, above, may result in a directive to cease all ongoing and permitted work within waters and/or wetlands associated with TIP No. R-3403 Section AA, or such other remedy as the District Engineer or his authorized representatives may seek.



STATE	STATE PROJECT REFERENCE NO.	SHEET NO.	TOTAL SHEETS
N.C.	R-3403AA	1	
STATE PROJ. NO.	F.A. PROJ. NO.	DESCRIPTION	
34538.1.1	STPNHF-17(24)	PE	
34538.2.2	STPNHF-17(47)	RW, UTIL	
34538.3.5	STPNHF-17(74)	CONST.	

Revised 6/14/10  
 Permit Drawing  
 Sheet 2 of 13  
**ENGLISH**

**WETLAND/STREAM IMPACTS**

STATE OF NORTH CAROLINA  
 DIVISION OF HIGHWAYS  
**CRAVEN COUNTY**

LOCATION: US 17 FROM MILLS STREET  
 TO NORFOLK & SOUTHERN RAILROAD

TYPE OF WORK: GRADING, PAVING, AND DRAINAGE

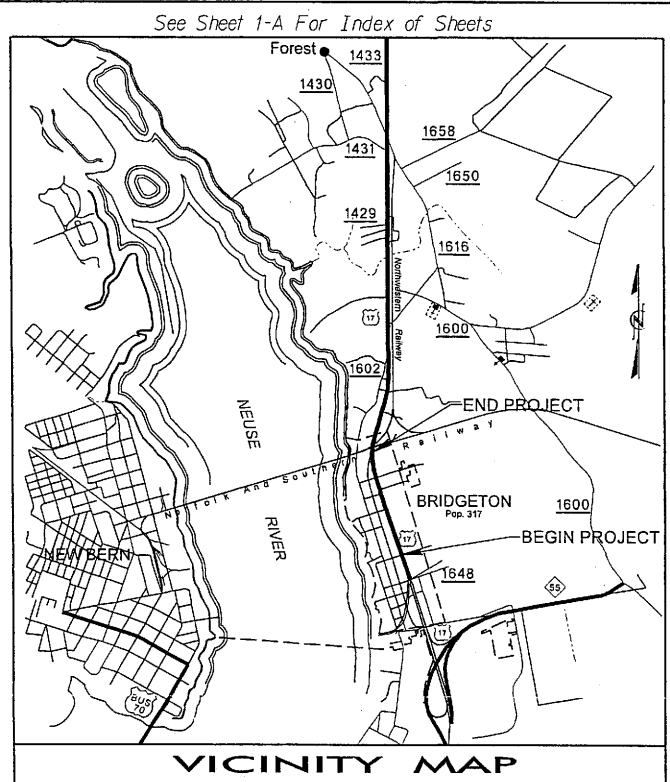

VICINITY MAP  
 This Project is within the Municipal Boundaries of Bridgeton

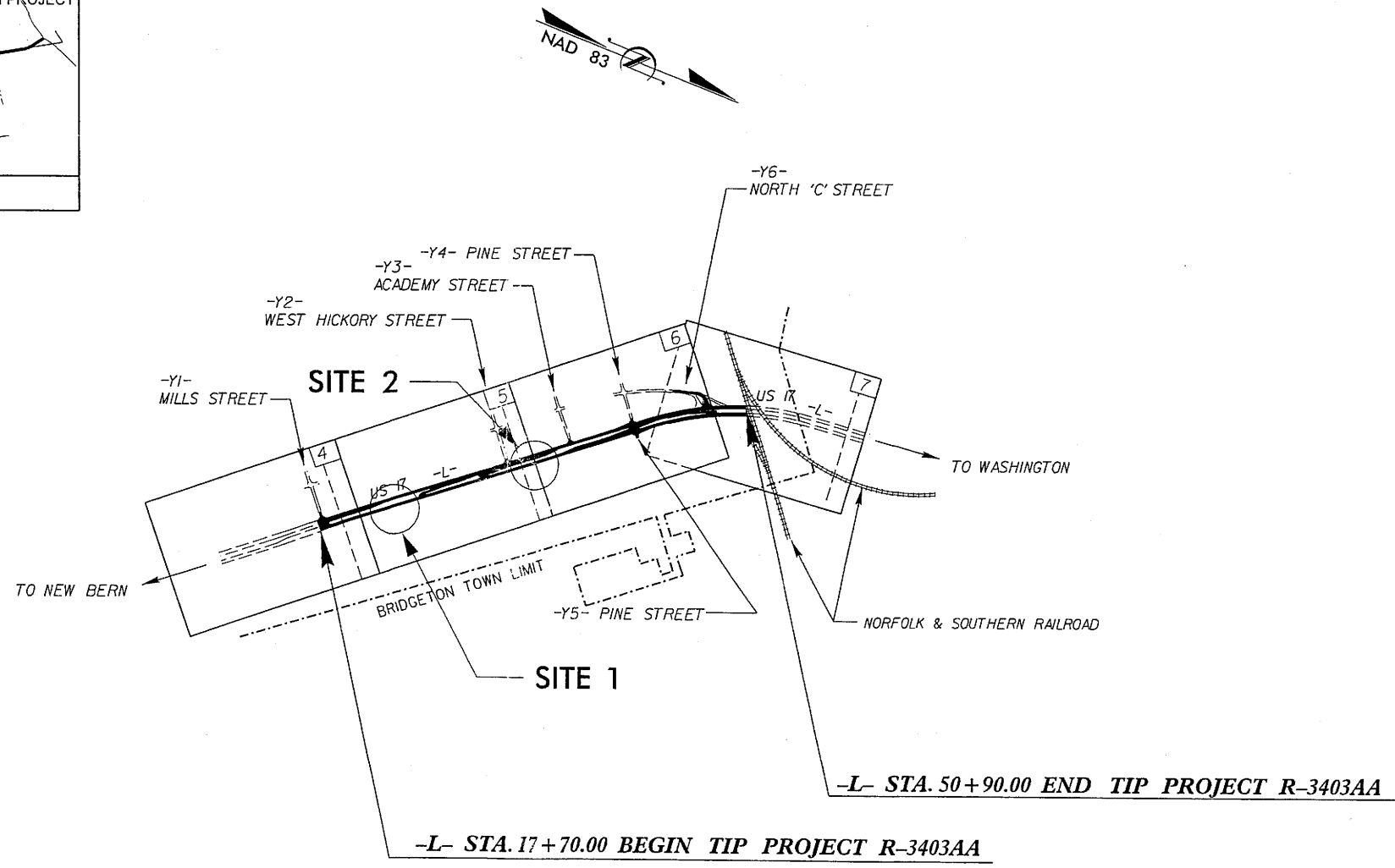

TIP PROJECT: R-3403AA

CONTRACT: C201877

\$\$\$\$\$SYTIME\$\$\$\$\$  
 \$\$\$DGN\$\$\$\$\$  
 \$\$\$JSERNAME\$\$\$\$\$

PRELIMINARY PLANS  
 DO NOT USE FOR CONSTRUCTION

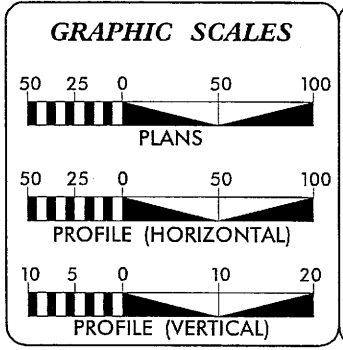

**DESIGN DATA**

ADT 2010 = 16,920
ADT 2030 = 27,705
DHV = 11 %
D = 60 %
T = 10 % *
V = 50 MPH
* TTST 5% DUAL 5%
FUNC CLASS = ARTERIAL
STATEWIDE TIER

**PROJECT LENGTH**

TOTAL LENGTH OF TIP PROJECT R-3403AA	= 0.629 MILES
--------------------------------------	---------------

Prepared in the Office of:  
**DIVISION OF HIGHWAYS**  
 1000 Birch Ridge Dr., Raleigh NC, 27610

2006 STANDARD SPECIFICATIONS	
RIGHT OF WAY DATE: March 22, 2005	G.E. BREW, PE PROJECT ENGINEER
LETTING DATE: September 21, 2010	E. MORRISON PROJECT DESIGN ENGINEER

**HYDRAULICS ENGINEER**

SIGNATURE: \_\_\_\_\_ P.E.

**ROADWAY DESIGN ENGINEER**

SIGNATURE: \_\_\_\_\_ P.E.

DIVISION OF HIGHWAYS  
 STATE OF NORTH CAROLINA

STATE HIGHWAY DESIGN ENGINEER



B/17/99  
REVISIONS  
MATCHLINE STA. 20+00.00  
15'  
MATCHLINE STA. 34+00.00

PROJECT REFERENCE NO.		SHEET NO.	
R-3403AA		5	
RW SHEET NO.		HYDRAULICS ENGINEER	
ROADWAY DESIGN ENGINEER		HYDRAULICS ENGINEER	
<b>PRELIMINARY PLANS</b> DO NOT USE FOR CONSTRUCTION			

Revised 6/14/10  
Permit Drawing  
Sheet 4 of 13

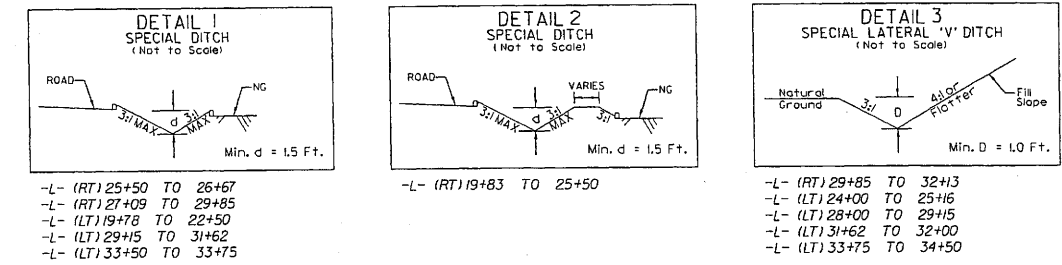

SCF = SPECIAL CONCRETE FLUME  
NOTE: DRIVE PIPES TO BE RAISED 3-INCHES ABOVE DITCH LINE THROUGHOUT PROJECT

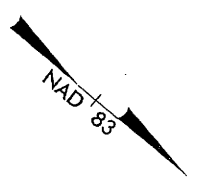
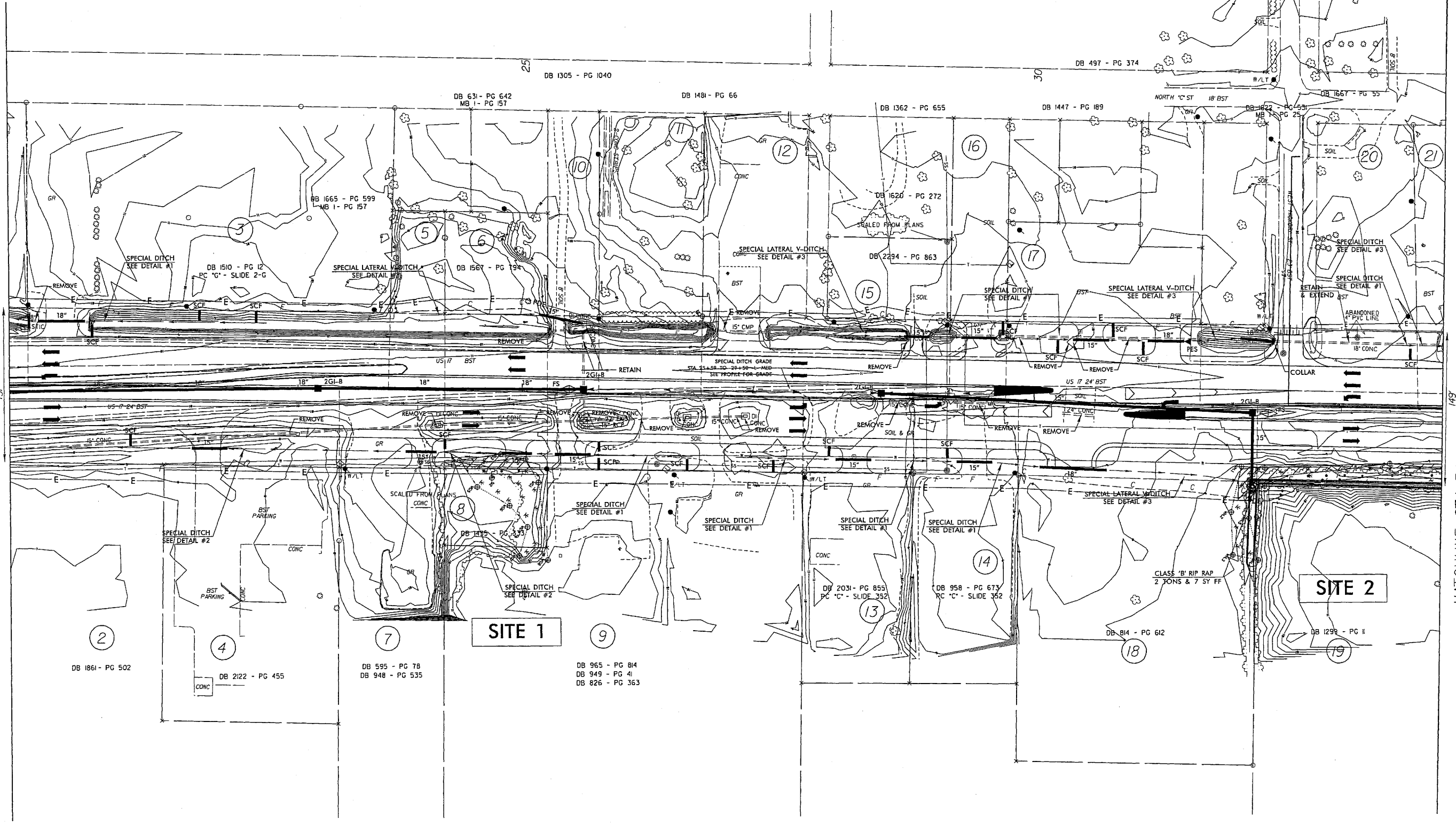
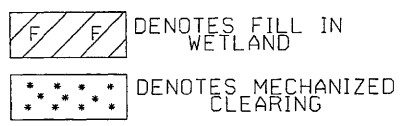

8/17/99

PROJECT REFERENCE NO. R-3403AA	SHEET NO. 6
R/W SHEET NO.	HYDRAULICS ENGINEER
ROADWAY DESIGN ENGINEER	

PRELIMINARY PLANS  
DO NOT USE FOR CONSTRUCTION

Revised 6/14/10  
Permit Drawing  
Sheet 5 of 13

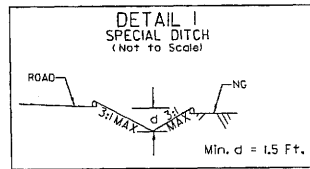

-L- (RT) 38+00 TO 41+50  
-L- (RT) 45+23 TO 46+50

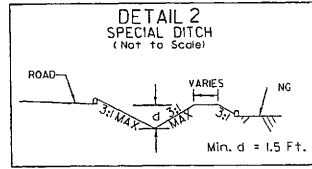

-L- (RT) 42+85 TO 44+00

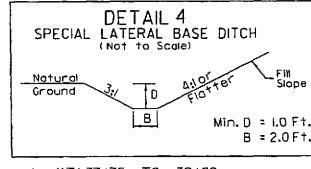

-L- (LT) 37+75 TO 39+66  
-L- (LT) 39+67 TO 44+00

SCF = SPECIAL CONCRETE FLUME  
NOTE-DRIVE PIPES TO BE RAISED 3-INCHES ABOVE DITCH LINE THROUGHOUT PROJECT

[Hatched Box] DENOTES FILL IN WETLAND

[Dotted Box] DENOTES MECHANIZED CLEARING

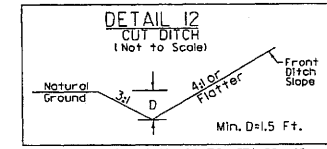

-Y6- LT FROM STA. 11+00 TO STA. 12+40  
-Y6- RT FROM STA. 13+50 TO STA. 15+50  
-Y6- RT FROM STA. 11+40 TO STA. 15+00

SEE SHEET NO.5  
MATCHLINE STA. 34+00.00 149'

SEE SHEET NO.7  
MATCHLINE STA. 47+00.00 172'

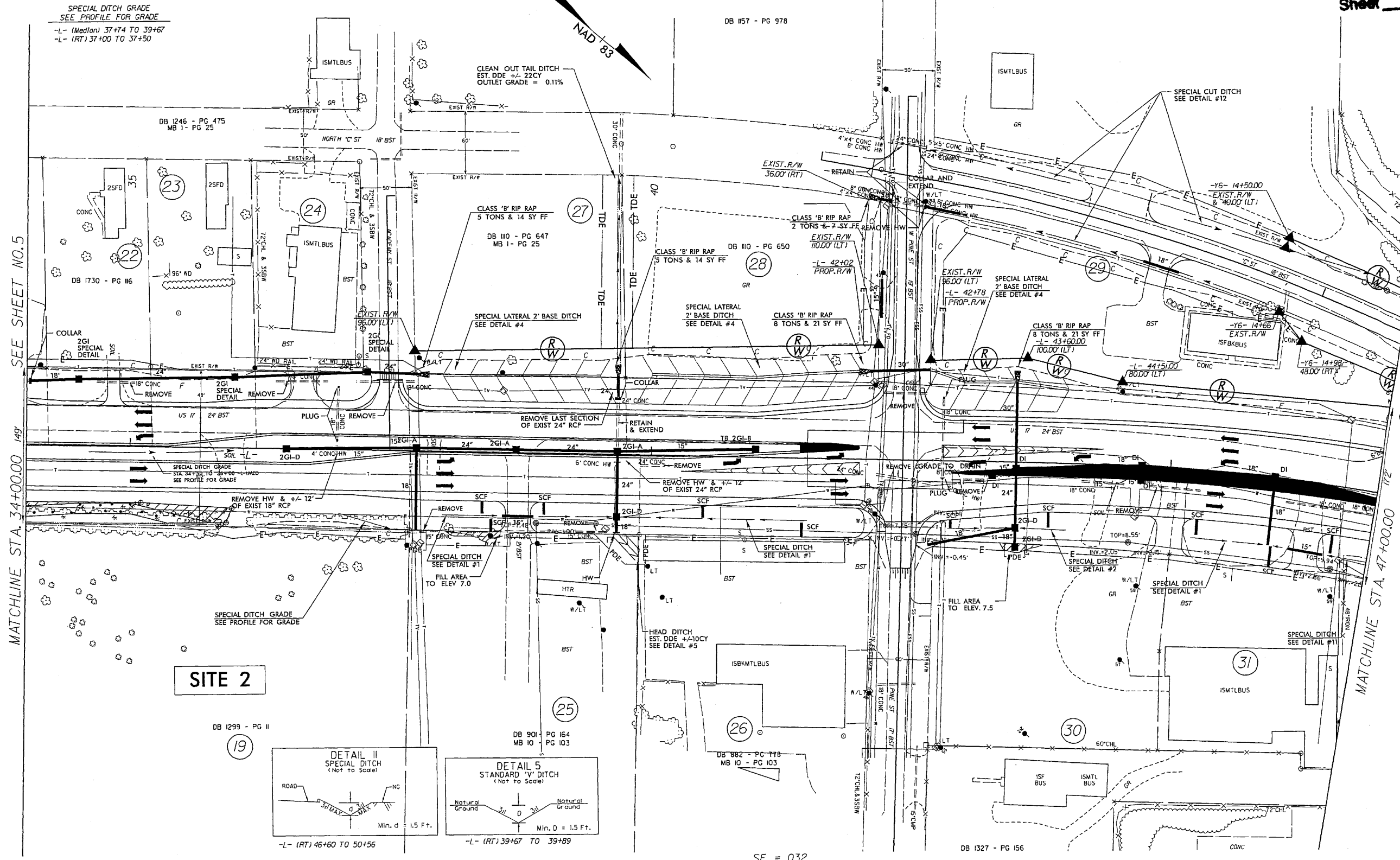

SE = 032  
RUNOFF = 80'

REVISIONS



Revised 6/14/10  
 Permit Drawing  
 Sheet 6 of 13

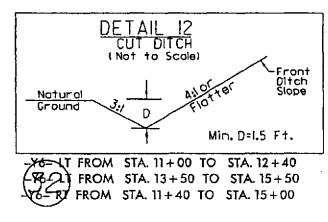
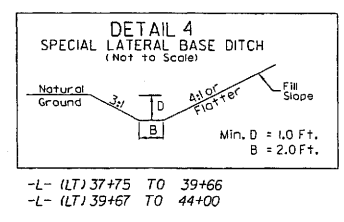
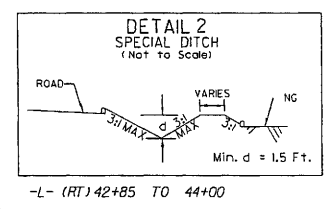
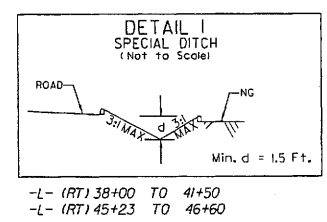

SCF = SPECIAL CONCRETE FLUME  
 NOTE: DRIVE PIPES TO BE RAISED 3-INCHES ABOVE DITCH LINE THROUGHOUT PROJECT

DENOTES FILL IN WETLAND  
 DENOTES MECHANIZED CLEARING

REVISIONS

SEE SHEET NO. 5

MATCHLINE STA. 34+00.00

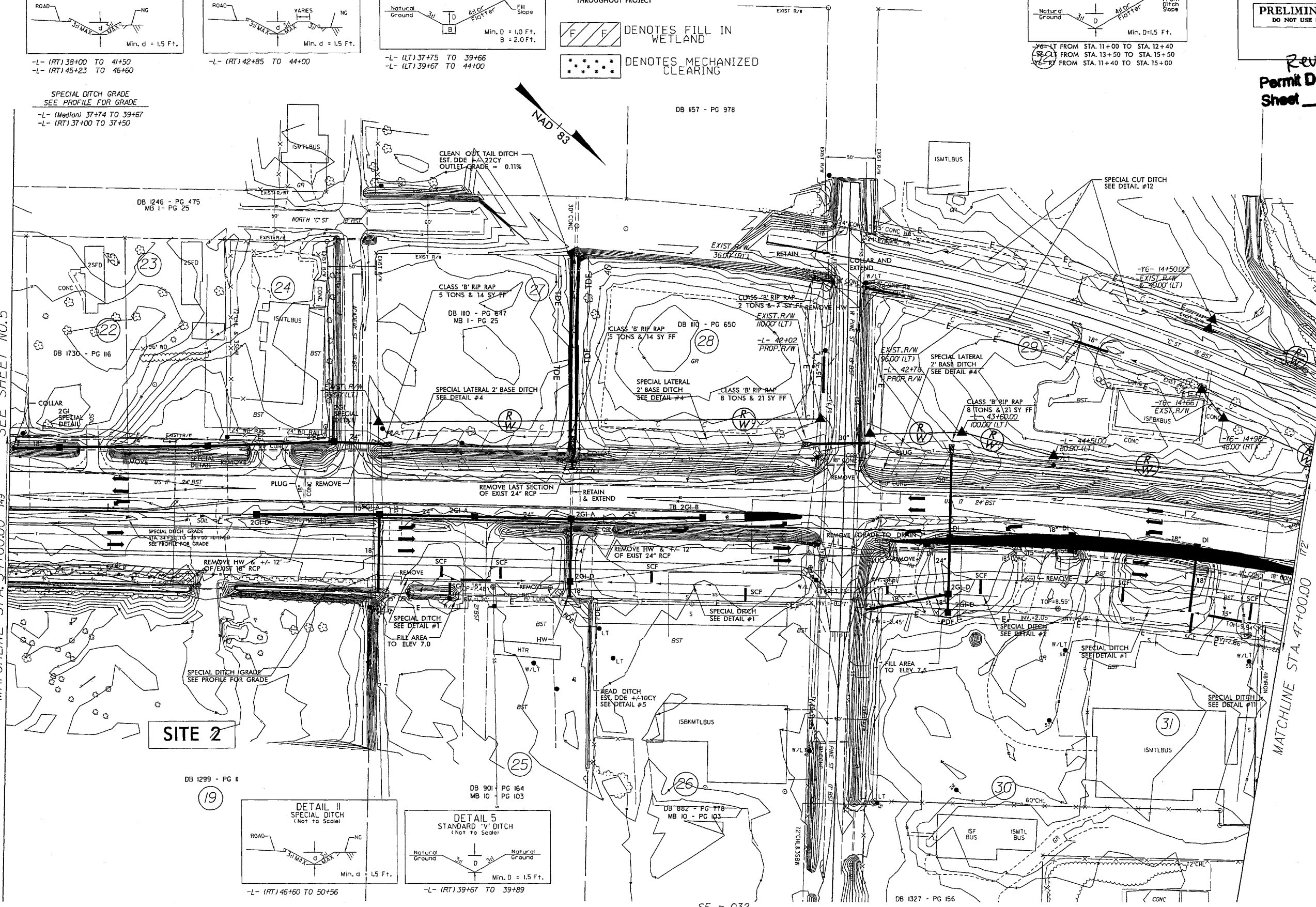

**SITE 2**

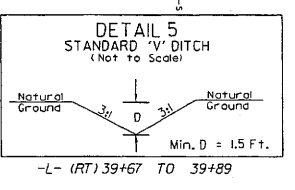
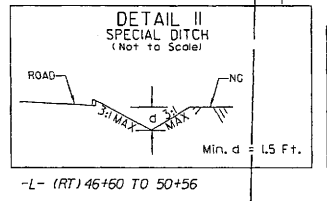

SEE SHEET NO. 7

MATCHLINE STA. 47+00.00



8/23/99



PROJ. REFERENCE NO. R-3403AA SHEET NO. X-3

Revised 6/14/10  
Permit Drawing  
Sheet 9 of 13

UNDERCUT  
EXCAVATION

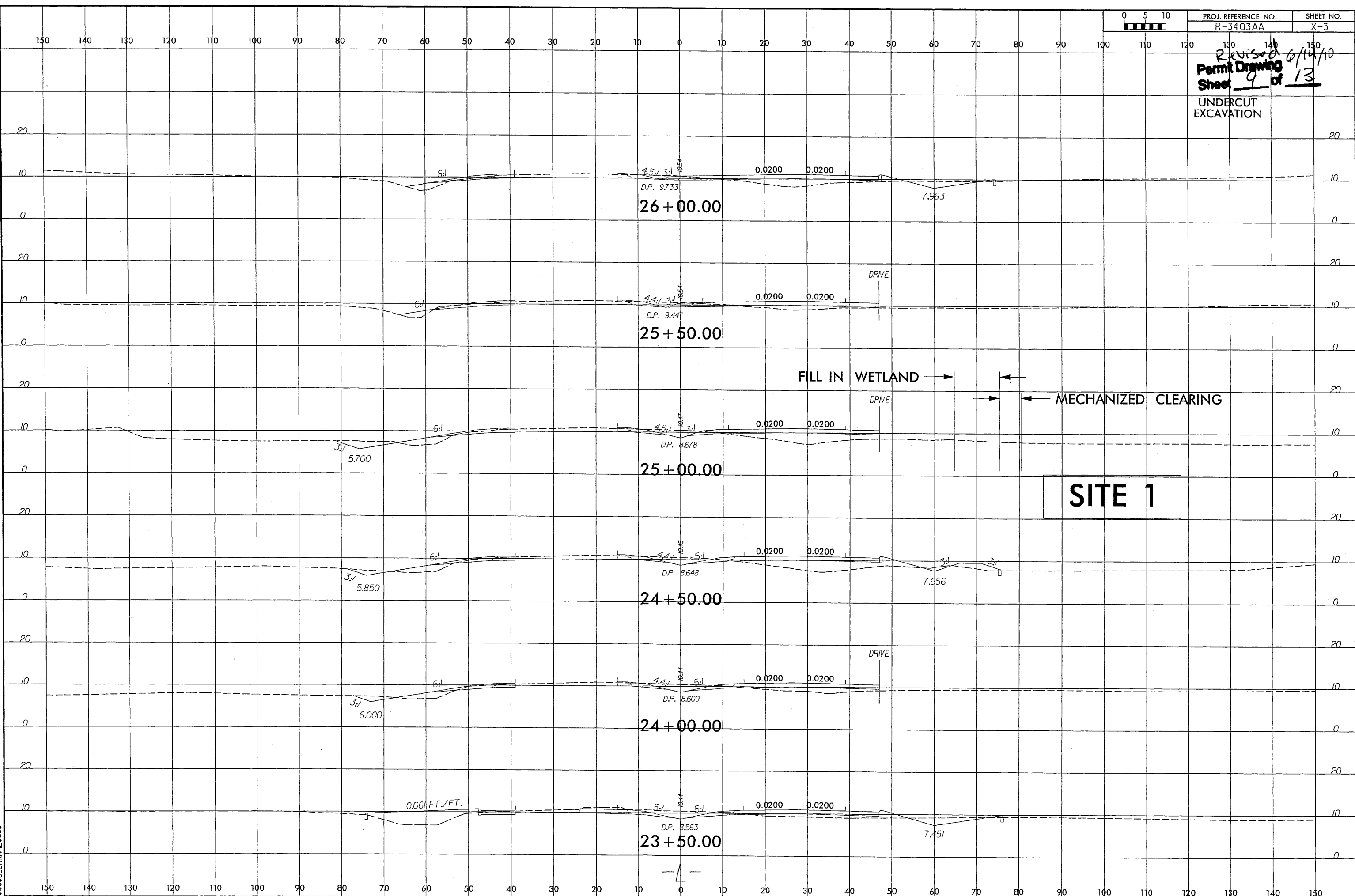

SITE 1

\*\*\*\*\* SYSTEME \*\*\*\*\*  
\*\*\*\*\* SITE NAME \*\*\*\*\*  
\*\*\*\*\* PROJECT NAME \*\*\*\*\*

8/23/99

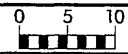

PROJ. REFERENCE NO. R-3403AA SHEET NO. X-6

Revised 6/14/10  
Permit Drawing  
Sheet 10 of 13

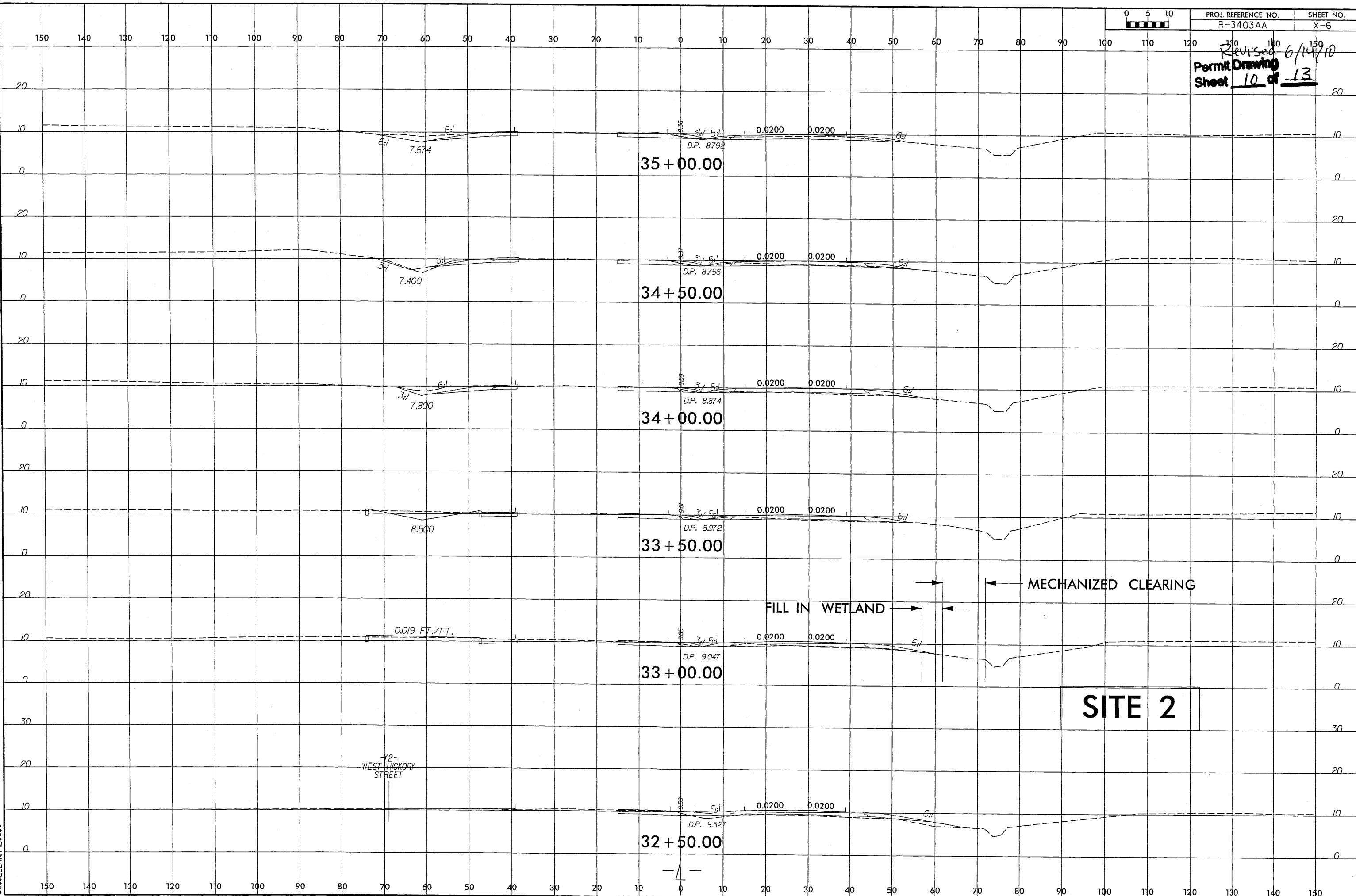

SYSTEM CONDITION SHALL BE MAINTAINED

-Y2-  
WEST HICKORY  
STREET

35 + 00.00

34 + 50.00

34 + 00.00

33 + 50.00

33 + 00.00

32 + 50.00

FILL IN WETLAND

MECHANIZED CLEARING

SITE 2

0.019 FT./FT.

7.574

7.400

7.800

8.500

D.P. 8.792

D.P. 8.756

D.P. 8.874

D.P. 8.972

D.P. 9.047

D.P. 9.527

0.0200 0.0200

0.0200 0.0200

0.0200 0.0200

0.0200 0.0200

0.0200 0.0200

0.0200 0.0200

-4-

PROPERTY OWNERS  
NAMES AND ADDRESSES

PARCEL NO.	NAMES	ADDRESSES
8	WARD, MARTHA S. AND WILLIAM F. JR	P.O. BOX 1428 NEW BERN, NC 28563
19	DONOFRIO, CARMEN V	1540 OCEAN AVE. UNIT 22 RUMSON, NJ 07760
	HARBORSIDE 17 PARTNERS LLC	2404 N. RIO GRANDE AVE. ORLANDO, FL 32804

WETLAND / STREAM  
IMPACTS

NCDOT  
DIVISION OF HIGHWAYS  
CRAVEN COUNTY  
PROJECT: 34538.1.1 (R-3403AA)  
WIDENING OF US 17 FROM  
MILLS STREET TO NORFOLK  
AND SOUTHERN RAILROAD  
SHEET OF 6/2/10

6/14/10 Revised Permit Drawing  
Sheet 13A of 12

**WETLAND PERMIT IMPACT SUMMARY**

Site No.	Station (From/To)	Structure Size / Type	WETLAND IMPACTS					SURFACE WATER IMPACTS									
			Permanent Fill In Wetlands (ac)	Temp. Fill In Wetlands (ac)	Excavation in Wetlands (ac)	Mechanized Clearing in Wetlands (ac)	Hand Clearing in Wetlands (ac)	Permanent SW impacts (ac)	Temp. SW impacts (ac)	Existing Channel Impacts Permanent (ft)	Existing Channel Impacts Temp. (ft)	Natural Stream Design (ft)					
1	24+39 to 24+84 -L-	Fill	0.02			0.01											
2	32+00 to 36+00 -L-	Fill	0.06			0.08											
<b>TOTALS:</b>			<b>0.08</b>			<b>0.08</b>											

NC DEPARTMENT OF TRANSPORTATION  
DIVISION OF HIGHWAYS

CRAVEN COUNTY  
WBS - 34538.1.1 (R-3403AA)

SHEET 6/18/2010

*Revised 6/14/10*  
**Permit Drawing**  
**Sheet 13 of 13**