

STATE OF NORTH CAROLINA  
DEPARTMENT OF TRANSPORTATION

MICHAEL F. EASLEY  
GOVERNOR

LYNDO TIPPETT  
SECRETARY

December 1, 2006

MEMORANDUM TO: Mr. Jon G. Nance, PE  
Division Five Engineer

FROM: Philip S. Harris, III, P.E., Unit Head *Philip S. Harris, III*  
Natural Environment Unit  
Project Development and Environmental Analysis Branch

SUBJECT: Wake County, Replace Bridge No.255 over an Unnamed  
Tributary to Swift Creek; T.I.P. Number B-4299; State  
Project 8.2408401

Attached is the DWQ 401 Water Quality Certification and the Neuse Buffer Authorization for the above referenced project. All environmental permits have been received.

PSH/gyb

Attachment

Cc:

Mr. Majed Alghandour, P. E., Programming and TIP  
Mr. Jay Bennett, P.E., Roadway Design  
Dr. David Chang, P.E., Hydraulics  
Mr. Randy Garris, P.E. State Contract Officer  
Mr. Art McMillan, P.E., Highway Design  
Mr. Greg Perfetti, P.E., Structure Design  
Mr. Mark Staley, Roadside Environmental  
Mr. John F. Sullivan, FHWA  
Mr. Eric Midkiff, P.E., PDEA Central Region Unit Head  
Mr. Chris Murray, Division Environmental Officer

# PROJECT COMMITMENTS

**Wake County  
Replacement of Bridge No. 255 over  
an Unnamed Tributary to Swift Creek  
State Project 8.2408401  
WBS No. 33636.1.1  
TIP No. B-4299**

In addition to the NCDOT's Guidelines for Best Management Practices for the Protection of Surface Waters, NCDOT's Guidelines for Best Management Practices for Bridge Demolition and Removal, and Neuse Buffer Certification Conditions, the following special commitments have been agreed to by NCDOT:

## **Commitments Developed Through Project Development and Design**

### ***Project Development & Environmental Analysis and Roadway Design Unit***

The Neuse River Riparian Buffer Rules will be implemented during the design, construction, and maintenance of the project.

## **Commitments Developed Through Neuse Buffer Certification**

No new special conditions are contained in the Neuse Buffer Certification. All standard conditions apply.

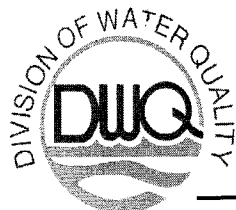

November 9, 2006  
 Wake County  
 DWQ Project No. 20061671  
 Bridge 255 on SR 1006  
 TIP No. B-4299

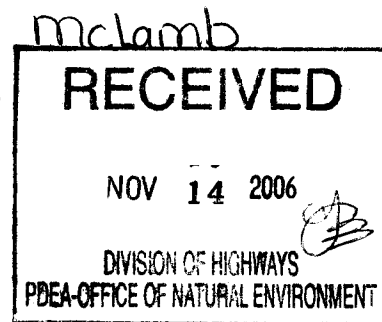

**APPROVAL of NEUSE BUFFER AUTHORIZATION with ADDITIONAL CONDITIONS**

Dr. Gregory J. Thorpe, Ph.D.  
 NCDOT, Project Development and Environmental Analysis  
 1598 Mail Service Center  
 Raleigh, NC 27699-1598

Dear Dr. Thorpe:

You have our approval, in accordance with the conditions listed below, for the following impacts for the purpose of replacing Bridge 255 in Wake County:

**Neuse Riparian Buffer Impacts**

Site	Zone 1 Impact (sq ft)	minus Wetlands in Zone 1 (sq ft)	= Zone 1 Buffers (not wetlands) (sq ft)	Zone 1 Buffer Mitigation Required (using 3:1 ratio)	Zone 2 Impact (sq ft)	minus Wetlands in Zone 2 (sq ft)	= Zone 2 Buffers (not wetlands) (sq ft)	Zone 2 Buffer Mitigation Required (using 1.5:1 ratio)
1	6,286	0	6,286	N/A	3,065	0	3,065	N/A
<b>Totals</b>	<b>6,286</b>	<b>0</b>	<b>6,286</b>	<b>0</b>	<b>3,065</b>	<b>0</b>	<b>3,065</b>	<b>0</b>

\* n/a = Total for Site is less than 1/3 acre and 150 linear feet of impact, no mitigation required

**Total Buffer Impact for Project: 9,351 square feet.**

The project shall be constructed in accordance with your application dated received October 24, 2006. After reviewing your application, we have decided that these impacts are covered by the Neuse Riparian Buffer Rules (15A NCAC 2B.0233). In addition, you should acquire any other federal, state or local permits before you proceed with your project including (but not limited to) Sediment and Erosion Control, Non-Discharge and Water Supply Watershed regulations. This approval will expire after five years from the issue date.

This approval is valid solely for the purpose and design described in your application (unless modified below). Should your project change, you must notify the DWQ and submit a new application. If the property is sold, the new owner must be given a copy of this Certification and approval letter, and is thereby responsible for complying with all the conditions. If total wetland fills for this project (now or in the future) exceed one acre, or of total impacts to streams (now or in the future) exceed 150 linear feet, compensatory mitigation may be required as described in 15A NCAC 2H .0506 (h) (6) and (7). For this approval to remain valid, you must adhere to the conditions listed in the attached certification.



**Conditions of Certification:**

1. Strict adherence to the most recent version of NCDOT's Best Management Practices For Bridge Demolition and Removal approved by the US Army Corps of Engineers is a condition of the 401 Water Quality Certification.
2. Bridge deck drains should not discharge directly into the stream. Stormwater should be directed across the bridge and pre-treated through site-appropriate means (grassed swales, pre-formed scour holes, vegetated buffers, etc.) before entering the stream. Please refer to the most current version of *Stormwater Best Management Practices*.
3. All stormwater runoff shall be directed as sheetflow through stream buffers at nonerosive velocities, unless otherwise approved by this certification.
4. All riparian buffers impacted by the placement of temporary fill or clearing activities shall be restored to the preconstruction contours and revegetated. Maintained buffers shall be permanently revegetated with non-woody species by the end of the growing season following completion of construction. For the purpose of this condition, maintained buffer areas are defined as areas within the transportation corridor that will be subject to regular DOT maintenance activities including mowing. The area with non-maintained buffers shall be permanently revegetated, with native woody species before the next growing season following completion of construction.
5. Pursuant to NCAC15A 2B.0233(6), sediment and erosion control devices shall not be placed in Zone 1 of any Neuse Buffer without prior approval by the NCDWQ. At this time, the NCDWQ has approved no sediment and erosion control devices in Zone 1, outside of the approved project impacts, anywhere on this project. Moreover, sediment and erosion control devices shall be allowed in Zone 2 of the buffers provided that Zone 1 is not compromised and that discharge is released as diffuse flow.
6. If concrete is used during construction, a dry work area should be maintained to prevent direct contact between curing concrete and stream water. Water that inadvertently contacts uncured concrete should not be discharged to surface waters due to the potential for elevated pH and possible aquatic life and fish kills.
7. During the construction of the project, no staging of equipment of any kind is permitted in waters of the U.S., or protected riparian buffers.
8. The dimension, pattern and profile of the stream above and below the crossing should not be modified. Disturbed floodplains and streams should be restored to natural geomorphic conditions.
9. Any rip-rap placed for stream stabilization shall be placed in stream channels in such a manner that it does not impede aquatic life passage.
10. Heavy equipment shall be operated from the banks rather than in the stream channel in order to minimize sedimentation and reduce the introduction of other pollutants into the stream.
11. All mechanized equipment operated near surface waters must be regularly inspected and maintained to prevent contamination of stream waters from fuels, lubricants, hydraulic fluids, or other toxic materials.
12. No rock, sand or other materials shall be dredged from the stream channel except where authorized by this certification.
13. Discharging hydroseed mixtures and washing out hydroseeders and other equipment in or adjacent to surface waters is prohibited.



14. The permittee and its authorized agents shall conduct its activities in a manner consistent with State water quality standards (including any requirements resulting from compliance with §303(d) of the Clean Water Act) and any other appropriate requirements of State and Federal law. If DWQ determines that such standards or laws are not being met (including the failure to sustain a designated or achieved use) or that State or federal law is being violated, or that further conditions are necessary to assure compliance, DWQ may reevaluate and modify this certification.

15. A copy of this Certification shall be posted on the construction site at all times. In addition, the Water Quality Certification and all subsequent modifications, if any, shall be maintained with the Division Engineer and the on-site project manager.

16. The outside buffer, wetland or water boundary located within the construction corridor approved by this authorization shall be clearly marked by highly visible fencing prior to any land disturbing activities. Impacts to areas within the fencing are prohibited unless otherwise authorized by this certification.

17. Upon completion of the project, the NCDOT Division Engineer shall complete and return the enclosed "Certification of Completion Form" to notify DWQ when all work included in the Certification has been completed.

18. Native riparian vegetation must be reestablished within the construction limits of the project by the end of the growing season following completion of construction.

19. There shall be no excavation from, or waste disposal into, jurisdictional wetlands or waters associated with this certification without appropriate modification. Should waste or borrow sites be located in wetlands or streams, compensatory mitigation will be required since that is a direct impact from road construction activities.

20. Erosion and sediment control practices must be in full compliance with all specifications governing the proper design, installation and operation and maintenance of such Best Management Practices in order to protect surface waters standards:

- a. The erosion and sediment control measures for the project must be designed, installed, operated, and maintained in accordance with the most recent version of the *North Carolina Sediment and Erosion Control Planning and Design Manual*.
- b. The design, installation, operation, and maintenance of the sediment and erosion control measures must be such that they equal, or exceed, the requirements specified in the most recent version of the *North Carolina Sediment and Erosion Control Manual*. The devices shall be maintained on all construction sites, borrow sites, and waste pile (spoil) projects, including contractor-owned or leased borrow pits associated with the project.
- c. For borrow pit sites, the erosion and sediment control measures must be designed, installed, operated, and maintained in accordance with the most recent version of the *North Carolina Surface Mining Manual*.
- d. The reclamation measures and implementation must comply with the reclamation in accordance with the requirements of the Sedimentation Pollution Control Act.

21. Sediment and erosion control measures shall not be placed in wetlands or waters unless otherwise approved by this Certification. If placement of sediment and erosion control devices in wetlands and waters is unavoidable, they shall be removed and the natural grade restored upon completion of the project.



Michael F. Easley, Governor  
William G. Ross Jr., Secretary  
North Carolina Department of Environment and Natural Resources

Alan W. Klimek, P.E. Director  
Division of Water Quality

If you do not accept any of the conditions of this certification, you may ask for an adjudicatory hearing. You must act within 60 days of the date that you receive this letter. To ask for a hearing, send a written petition that conforms to Chapter 150B of the North Carolina General Statutes to the Office of Administrative Hearings, 6714 Mail Service Center, Raleigh, N.C. 27699. This certification and its conditions are final and binding unless you ask for a hearing. This letter completes the review of the Division of Water Quality under Section 401 of the Clean Water Act. If you have any questions, please contact Rob Ridings at (919) 733-9817.

Sincerely,

A handwritten signature in cursive script, appearing to read "Alan W. Klimek".

Alan W. Klimek, P.E.

Attachment (Certificate of Completion form)

cc: Chris Murray, Division 5 Environmental Officer  
Eric Alsmeyer, US Army Corps of Engineers, Raleigh Field Office  
Travis Wilson, NC Wildlife Resources Commission  
DWQ Raleigh Regional copy  
File Copy



DWQ Project No.: \_\_\_\_\_ County: \_\_\_\_\_

Applicant: \_\_\_\_\_

Project Name: \_\_\_\_\_

Date of Issuance of Water Quality Certification: \_\_\_\_\_

**Certificate of Completion**

Upon completion of all work approved within the 401 Water Quality Certification or applicable Buffer Rules, and any subsequent modifications, the applicant is required to return this certificate to the 401 Transportation Permitting Unit, North Carolina Division of Water Quality, 1650 Mail Service Center, Raleigh, NC, 27699-1650. This form may be returned to DWQ by the applicant, the applicant's authorized agent, or the project engineer. It is not necessary to send certificates from all of these.

**Applicant's Certification**

I, \_\_\_\_\_, hereby state that, to the best of my abilities, due care and diligence was used in the observation of the construction such that the construction was observed to be built within substantial compliance and intent of the 401 Water Quality Certification and Buffer Rules, the approved plans and specifications, and other supporting materials.

Signature: \_\_\_\_\_ Date: \_\_\_\_\_

**Agent's Certification**

I, \_\_\_\_\_, hereby state that, to the best of my abilities, due care and diligence was used in the observation of the construction such that the construction was observed to be built within substantial compliance and intent of the 401 Water Quality Certification and Buffer Rules, the approved plans and specifications, and other supporting materials.

Signature: \_\_\_\_\_ Date: \_\_\_\_\_

**Engineer's Certification**

\_\_\_\_\_ Partial \_\_\_\_\_ Final

I, \_\_\_\_\_, as a duly registered Professional Engineer in the State of North Carolina, having been authorized to observe (periodically, weekly, full time) the construction of the project, for the Permittee hereby state that, to the best of my abilities, due care and diligence was used in the observation of the construction such that the construction was observed to be built within substantial compliance and intent of the 401 Water Quality Certification and Buffer Rules, the approved plans and specifications, and other supporting materials.

Signature \_\_\_\_\_ Registration No. \_\_\_\_\_

Date \_\_\_\_\_

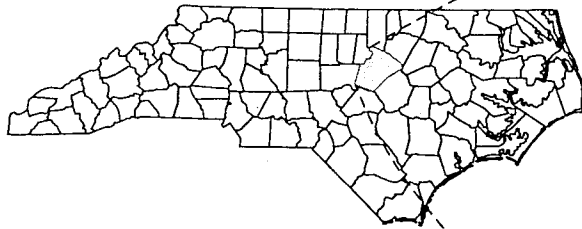

SEE INSET BELOW

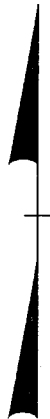
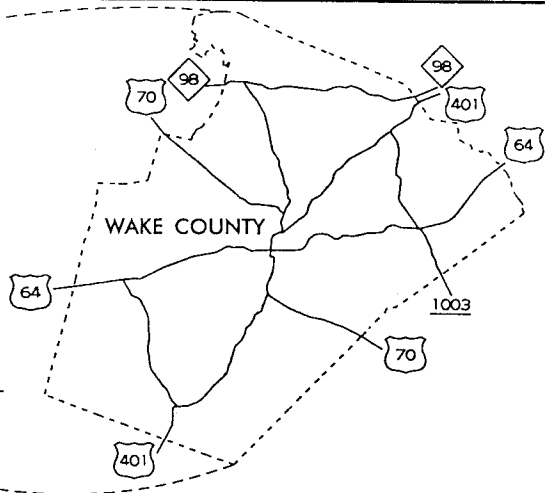

WAKE COUNTY

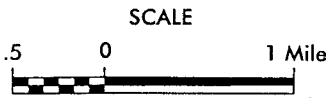
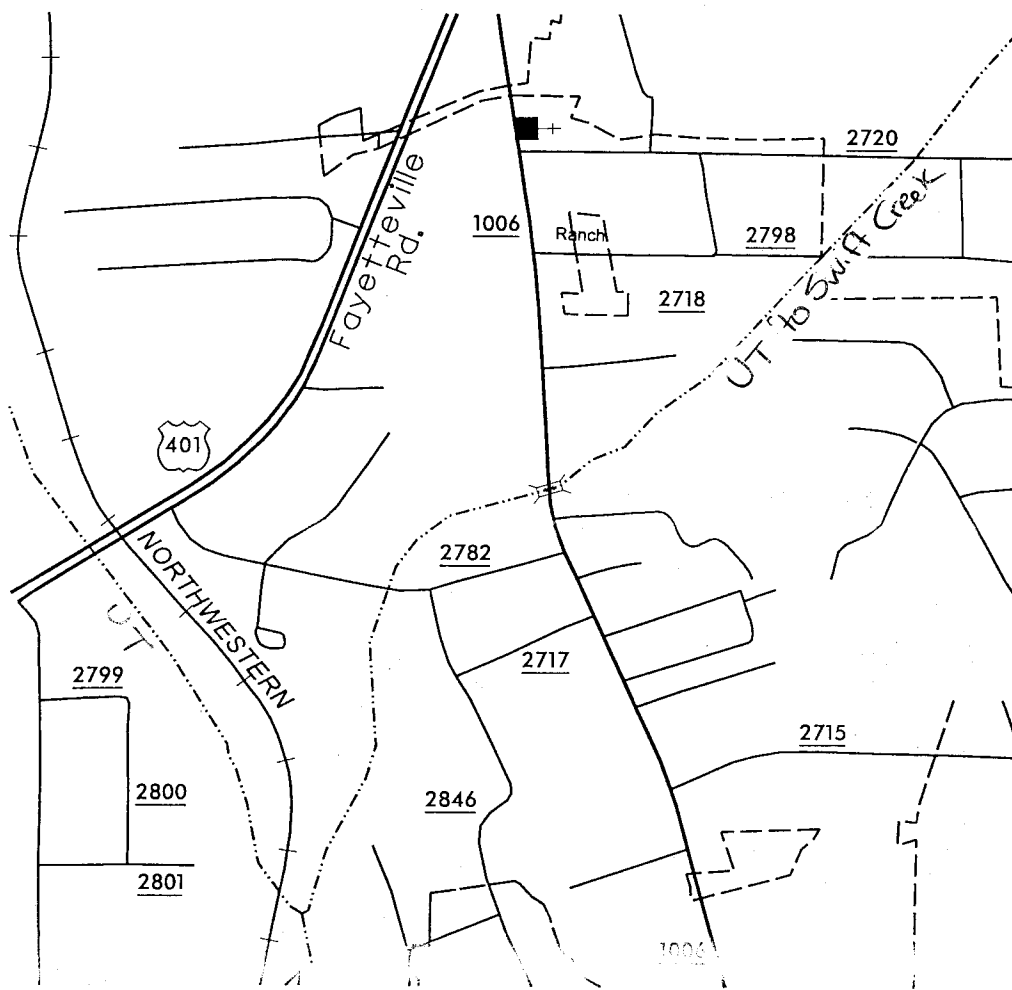

N.C. DEPT. OF TRANSPORTATION  
DIVISION OF HIGHWAYS  
WAKE COUNTY

PROJECT: 33636.1.1 (B-4299)  
BRIDGE NO. 255 OVER  
UT to Swift Creek  
ON SR 1006

SHEET 1 OF 3

01 / 27 / 05



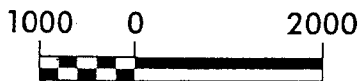

N.C. DEPT. OF TRANSPORTATION  
 DIVISION OF HIGHWAYS  
 WAKE COUNTY  
 PROJECT: 33636.1.1 (B-4299)  
 BRIDGE NO. 255 OVER  
 UT to Sw. Ft Creek  
 ON SR 1006  
 SHEET 2 OF 8

01 / 27 / 05

# LEGEND

---WLB--- WETLAND BOUNDARY

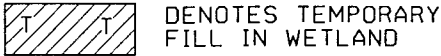
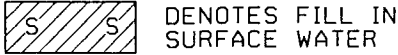
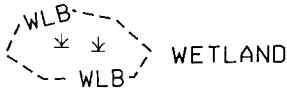

— BZ — RIPARIAN BUFFER ZONE

← ← FLOW DIRECTION

— TB — TOP OF BANK

--- WE --- EDGE OF WATER

--- C --- PROP. LIMIT OF CUT

--- F --- PROP. LIMIT OF FILL

▲ PROP. RIGHT OF WAY

--- NG --- NATURAL GROUND

--- PL --- PROPERTY LINE

— TDE — TEMP. DRAINAGE EASEMENT

— PDE — PERMANENT DRAINAGE EASEMENT

--- EAB --- EXIST. ENDANGERED ANIMAL BOUNDARY

--- EPB --- PLANT BOUNDARY

--- ∇ --- WATER SURFACE

X X X LIVE STAKES  
X X

BOULDER

--- COIR FIBER ROLLS

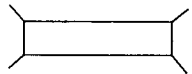
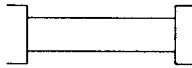

(DASHED LINES DENOTE EXISTING STRUCTURES)

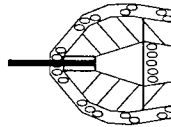
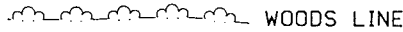

**N.C. DEPT. OF TRANSPORTATION  
DIVISION OF HIGHWAYS**

**WAKE COUNTY**

**PROJECT: 33636.1.1 (B-4299)**

**BRIDGE NO. 255 OVER**

*UT to Swift Creek*

ON SR 1006

SHEET 3 OF 8

01 / 27 / 05

Project No. 33636.1.1 (B-4299)

**Property Owner List**

Parcel Number	Name	Address
2	John Henry Battz	5500 Old Stage Road Raleigh, NC 27603
5	Richard D. Abernathy	5616 Old Stage Road Raleigh, NC 27603
6	George F. Horton	5412 Old Stage Road Raleigh, NC 27603

N.C. DEPT. OF TRANSPORTATION  
DIVISION OF HIGHWAYS

WAKE COUNTY

PROJECT: 33636.1.1 (B-4299)

BRIDGE NO. 255 OVER

*UT to Swift Creek*

ON SR 1006

SHEET 4 OF 8

01 / 27 / 05



REVISIONS
5-8-06 -ADDITION OF RIGHT-OF-WAY PROPERTY TIES

PROJECT REFERENCE NO. B-4299	SHEET NO. 4
RW SHEET NO.	
ROADWAY DESIGN ENGINEER NORTH CAROLINA PROFESSIONAL SEAL 27771 MATTHEW B. COPPLE	HYDRAULICS ENGINEER NORTH CAROLINA PROFESSIONAL SEAL 18442 RICHARD LEON BOLLINGER, JR.

Sheet 4 of 3

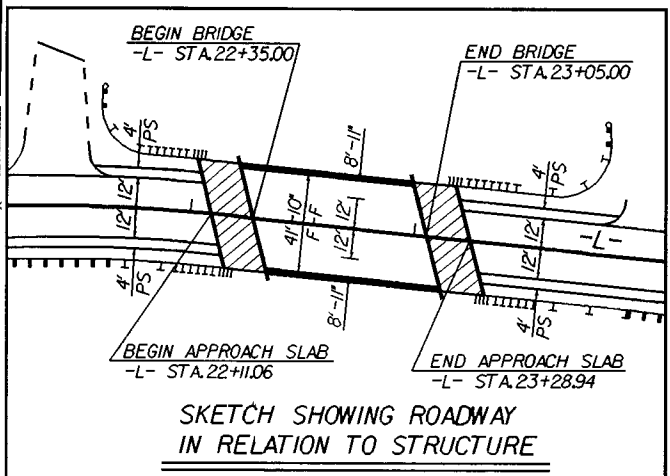
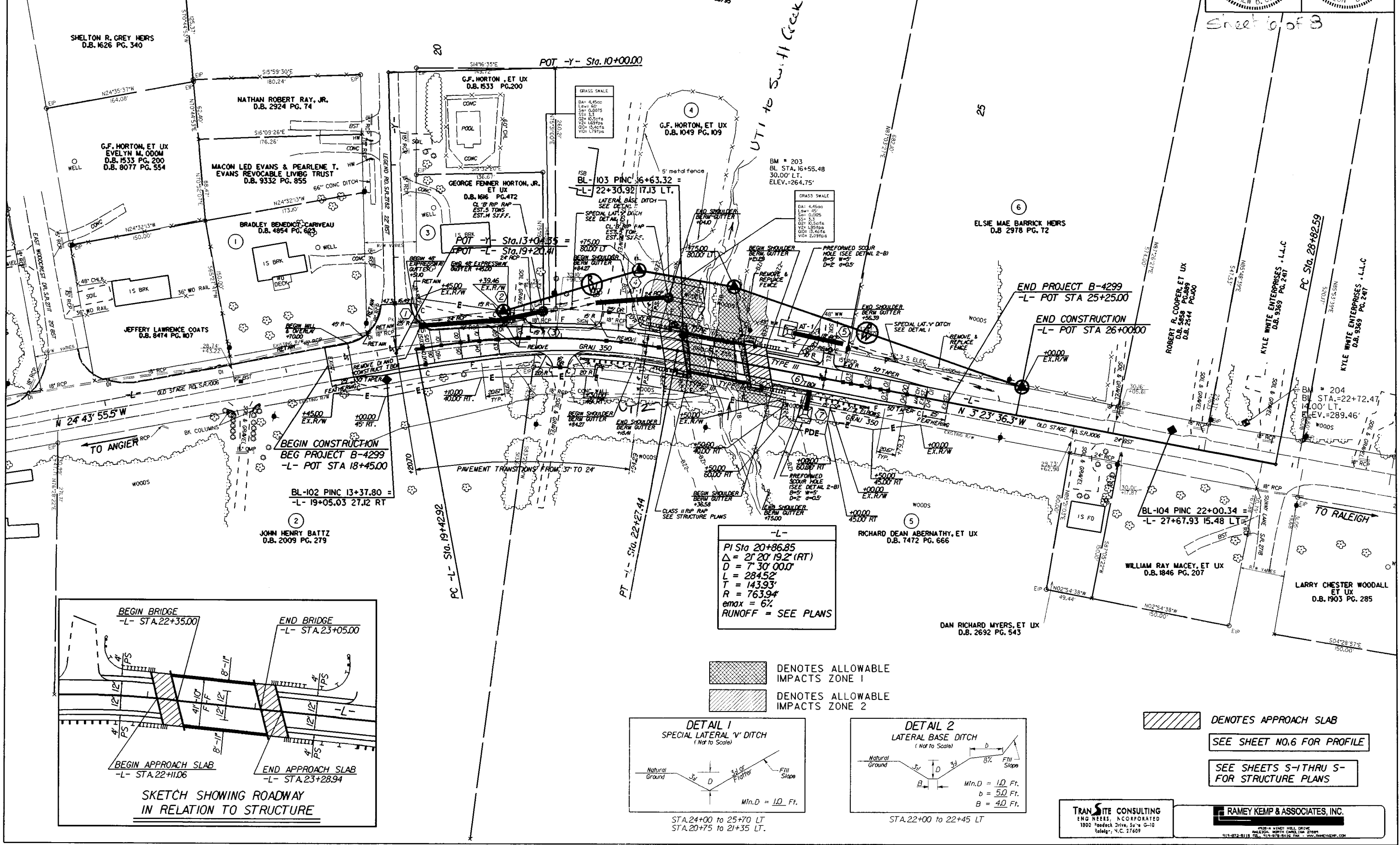

**-L-**  
 PI Sta 20+86.85  
 $\Delta = 21' 20" 19.2" (RT)$   
 $D = 7' 30" 00.0"$   
 $L = 284.52'$   
 $T = 143.93'$   
 $R = 763.94'$   
 $e_{max} = 6\%$   
 RUNOFF = SEE PLANS

- DENOTES ALLOWABLE IMPACTS ZONE 1
- DENOTES ALLOWABLE IMPACTS ZONE 2

- DENOTES APPROACH SLAB
- SEE SHEET NO. 6 FOR PROFILE
- SEE SHEETS S-1 THRU S-4 FOR STRUCTURE PLANS

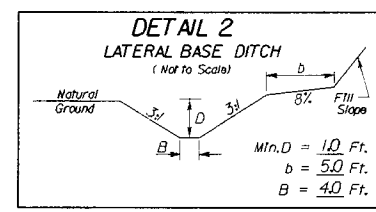
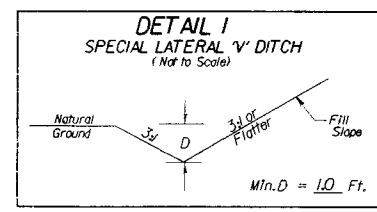

**TRANSITE CONSULTING**  
 ENG'NEERS, INCORPORATED  
 1800 Foodock Drive, Suite G-10  
 Raleigh, N.C. 27609

**RAMEY KEMP & ASSOCIATES, INC.**  
 4504 WINDY HILL DRIVE  
 RALEIGH, NORTH CAROLINA 27609  
 313-872-8111 FAX: 313-872-2432 WWW: WWW.RAMEYKEMP.COM

REVISIONS
5-8-06 -ADDITION OF RIGHT-OF-WAY PROPERTY TIES

PROJECT REFERENCE NO. B-4299	SHEET NO. 4
R/W SHEET NO.	
ROADWAY DESIGN ENGINEER NORTH CAROLINA PROFESSIONAL SEAL 27171 MATTHEW B. COPPE	HYDRAULICS ENGINEER NORTH CAROLINA PROFESSIONAL SEAL 18442 ROBERT LEON BOLLINGER, JR.

Sheet 4 of 3

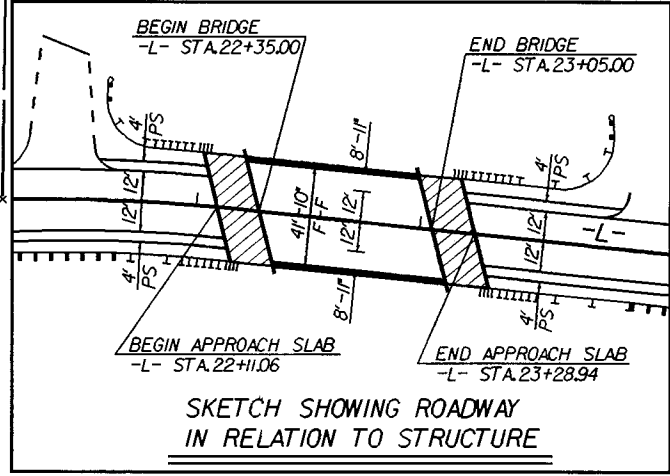
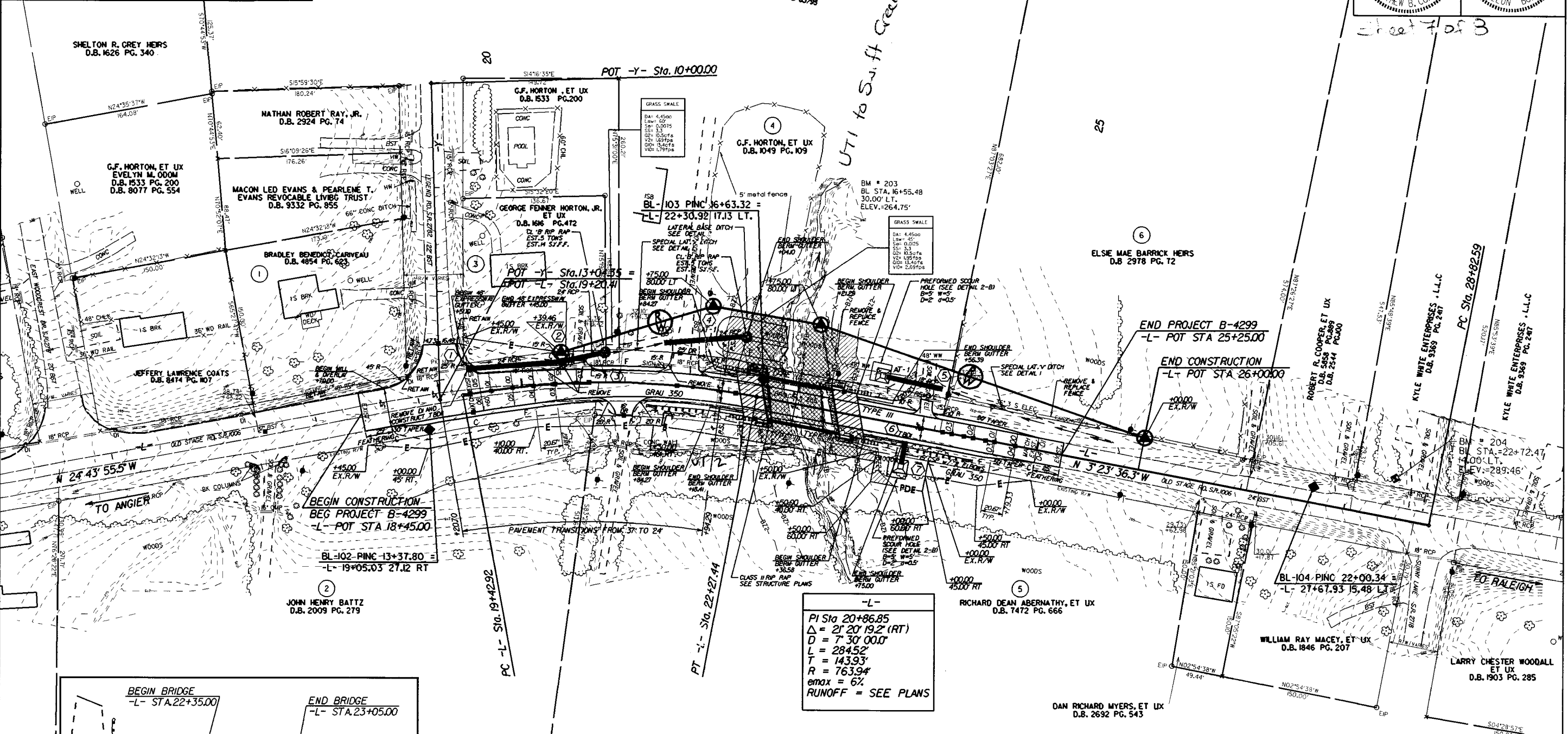

-L-  
PI Sta 20+86.85  
 $\Delta = 21' 20'' 19.2'' (RT)$   
 $D = 7' 30'' 00.0''$   
 $L = 284.52'$   
 $T = 143.93'$   
 $R = 763.94'$   
 $e_{max} = 6\%$   
RUNOFF = SEE PLANS

- DENOTES ALLOWABLE IMPACTS ZONE 1
- DENOTES ALLOWABLE IMPACTS ZONE 2
- DENOTES APPROACH SLAB

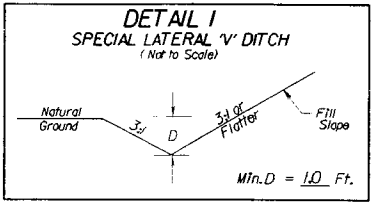

STA. 24+00 to 25+70 LT  
STA. 20+75 to 21+35 LT.

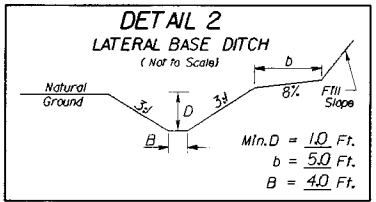

STA. 22+00 to 22+45 LT

SEE SHEET NO. 6 FOR PROFILE

SEE SHEETS S-1 THRU S-4 FOR STRUCTURE PLANS

TRANSITE CONSULTING  
ENGINEERS, INCORPORATED  
1800 Woodcock Drive, Suite 50-10  
Raleigh, N.C. 27609

RAMEY KEMP & ASSOCIATES, INC.  
1000 W. WOOD HILL DRIVE  
RALEIGH, NORTH CAROLINA 27607  
311-872-5115 TEL. 311-878-8426 FAX 311-872-5111

DITCH LEGEND  
----- DITCH GRADE LT

B.M.\*203 ELEV. = 264.75  
RR SPIKE IN BASE OF  
42" SWEET GUM  
30.00' LT. OF -BL- STA. 16+55.48

B.M.\*204 ELEV. = 289.46  
RR SPIKE IN BASE OF  
14" SWEET GUM  
14.00' LT. OF -BL- STA. 22+72.47

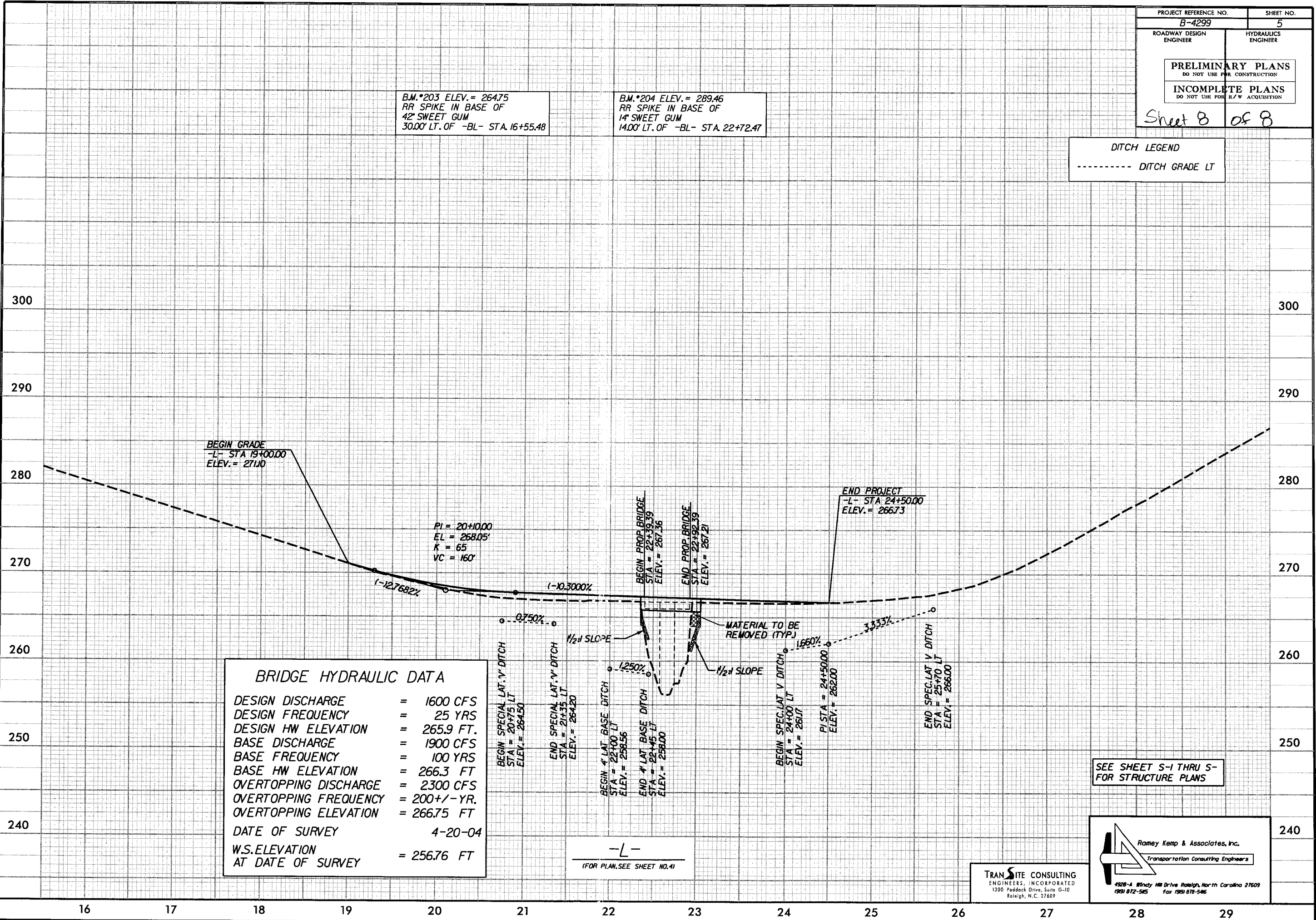

BRIDGE HYDRAULIC DATA	
DESIGN DISCHARGE	= 1600 CFS
DESIGN FREQUENCY	= 25 YRS
DESIGN HW ELEVATION	= 265.9 FT.
BASE DISCHARGE	= 1900 CFS
BASE FREQUENCY	= 100 YRS
BASE HW ELEVATION	= 266.3 FT
OVERTOPPING DISCHARGE	= 2300 CFS
OVERTOPPING FREQUENCY	= 200 +/- YR.
OVERTOPPING ELEVATION	= 266.75 FT
DATE OF SURVEY	4-20-04
W.S.ELEVATION AT DATE OF SURVEY	= 256.76 FT

SEE SHEET S-1 THRU S-  
FOR STRUCTURE PLANS

TRANSITE CONSULTING  
ENGINEERS, INCORPORATED  
1300 Paddeck Drive, Suite G-10  
Raleigh, N.C. 27609

Ramey Kemp & Associates, Inc.  
Transportation Consulting Engineers  
4528-A W. Windy Hill Drive Raleigh, North Carolina 27609  
(919) 872-5415 Fax (919) 878-5485

1  
2  
3  
4  
5  
6  
7  
8  
9  
10  
11  
12  
13  
14  
15  
16  
17  
18  
19  
20  
21  
22  
23  
24  
25  
26  
27  
28  
29  
30  
31  
32  
33  
34  
35  
36  
37  
38  
39  
40  
41  
42  
43  
44  
45  
46  
47  
48  
49  
50  
51  
52  
53  
54  
55  
56  
57  
58  
59  
60  
61  
62  
63  
64  
65  
66  
67  
68  
69  
70  
71  
72  
73  
74  
75  
76  
77  
78  
79  
80  
81  
82  
83  
84  
85  
86  
87  
88  
89  
90  
91  
92  
93  
94  
95  
96  
97  
98  
99  
100  
101  
102  
103  
104  
105  
106  
107  
108  
109  
110  
111  
112  
113  
114  
115  
116  
117  
118  
119  
120  
121  
122  
123  
124  
125  
126  
127  
128  
129  
130  
131  
132  
133  
134  
135  
136  
137  
138  
139  
140  
141  
142  
143  
144  
145  
146  
147  
148  
149  
150  
151  
152  
153  
154  
155  
156  
157  
158  
159  
160  
161  
162  
163  
164  
165  
166  
167  
168  
169  
170  
171  
172  
173  
174  
175  
176  
177  
178  
179  
180  
181  
182  
183  
184  
185  
186  
187  
188  
189  
190  
191  
192  
193  
194  
195  
196  
197  
198  
199  
200  
201  
202  
203  
204  
205  
206  
207  
208  
209  
210  
211  
212  
213  
214  
215  
216  
217  
218  
219  
220  
221  
222  
223  
224  
225  
226  
227  
228  
229  
230  
231  
232  
233  
234  
235  
236  
237  
238  
239  
240  
241  
242  
243  
244  
245  
246  
247  
248  
249  
250  
251  
252  
253  
254  
255  
256  
257  
258  
259  
260  
261  
262  
263  
264  
265  
266  
267  
268  
269  
270  
271  
272  
273  
274  
275  
276  
277  
278  
279  
280  
281  
282  
283  
284  
285  
286  
287  
288  
289  
290  
291  
292  
293  
294  
295  
296  
297  
298  
299  
300  
301  
302  
303  
304  
305  
306  
307  
308  
309  
310  
311  
312  
313  
314  
315  
316  
317  
318  
319  
320  
321  
322  
323  
324  
325  
326  
327  
328  
329  
330  
331  
332  
333  
334  
335  
336  
337  
338  
339  
340  
341  
342  
343  
344  
345  
346  
347  
348  
349  
350  
351  
352  
353  
354  
355  
356  
357  
358  
359  
360  
361  
362  
363  
364  
365  
366  
367  
368  
369  
370  
371  
372  
373  
374  
375  
376  
377  
378  
379  
380  
381  
382  
383  
384  
385  
386  
387  
388  
389  
390  
391  
392  
393  
394  
395  
396  
397  
398  
399  
400  
401  
402  
403  
404  
405  
406  
407  
408  
409  
410  
411  
412  
413  
414  
415  
416  
417  
418  
419  
420  
421  
422  
423  
424  
425  
426  
427  
428  
429  
430  
431  
432  
433  
434  
435  
436  
437  
438  
439  
440  
441  
442  
443  
444  
445  
446  
447  
448  
449  
450  
451  
452  
453  
454  
455  
456  
457  
458  
459  
460  
461  
462  
463  
464  
465  
466  
467  
468  
469  
470  
471  
472  
473  
474  
475  
476  
477  
478  
479  
480  
481  
482  
483  
484  
485  
486  
487  
488  
489  
490  
491  
492  
493  
494  
495  
496  
497  
498  
499  
500  
501  
502  
503  
504  
505  
506  
507  
508  
509  
510  
511  
512  
513  
514  
515  
516  
517  
518  
519  
520  
521  
522  
523  
524  
525  
526  
527  
528  
529  
530  
531  
532  
533  
534  
535  
536  
537  
538  
539  
540  
541  
542  
543  
544  
545  
546  
547  
548  
549  
550  
551  
552  
553  
554  
555  
556  
557  
558  
559  
560  
561  
562  
563  
564  
565  
566  
567  
568  
569  
570  
571  
572  
573  
574  
575  
576  
577  
578  
579  
580  
581  
582  
583  
584  
585  
586  
587  
588  
589  
590  
591  
592  
593  
594  
595  
596  
597  
598  
599  
600  
601  
602  
603  
604  
605  
606  
607  
608  
609  
610  
611  
612  
613  
614  
615  
616  
617  
618  
619  
620  
621  
622  
623  
624  
625  
626  
627  
628  
629  
630  
631  
632  
633  
634  
635  
636  
637  
638  
639  
640  
641  
642  
643  
644  
645  
646  
647  
648  
649  
650  
651  
652  
653  
654  
655  
656  
657  
658  
659  
660  
661  
662  
663  
664  
665  
666  
667  
668  
669  
670  
671  
672  
673  
674  
675  
676  
677  
678  
679  
680  
681  
682  
683  
684  
685  
686  
687  
688  
689  
690  
691  
692  
693  
694  
695  
696  
697  
698  
699  
700  
701  
702  
703  
704  
705  
706  
707  
708  
709  
710  
711  
712  
713  
714  
715  
716  
717  
718  
719  
720  
721  
722  
723  
724  
725  
726  
727  
728  
729  
730  
731  
732  
733  
734  
735  
736  
737  
738  
739  
740  
741  
742  
743  
744  
745  
746  
747  
748  
749  
750  
751  
752  
753  
754  
755  
756  
757  
758  
759  
760  
761  
762  
763  
764  
765  
766  
767  
768  
769  
770  
771  
772  
773  
774  
775  
776  
777  
778  
779  
780  
781  
782  
783  
784  
785  
786  
787  
788  
789  
790  
791  
792  
793  
794  
795  
796  
797  
798  
799  
800  
801  
802  
803  
804  
805  
806  
807  
808  
809  
810  
811  
812  
813  
814  
815  
816  
817  
818  
819  
820  
821  
822  
823  
824  
825  
826  
827  
828  
829  
830  
831  
832  
833  
834  
835  
836  
837  
838  
839  
840  
841  
842  
843  
844  
845  
846  
847  
848  
849  
850  
851  
852  
853  
854  
855  
856  
857  
858  
859  
860  
861  
862  
863  
864  
865  
866  
867  
868  
869  
870  
871  
872  
873  
874  
875  
876  
877  
878  
879  
880  
881  
882  
883  
884  
885  
886  
887  
888  
889  
890  
891  
892  
893  
894  
895  
896  
897  
898  
899  
900  
901  
902  
903  
904  
905  
906  
907  
908  
909  
910  
911  
912  
913  
914  
915  
916  
917  
918  
919  
920  
921  
922  
923  
924  
925  
926  
927  
928  
929  
930  
931  
932  
933  
934  
935  
936  
937  
938  
939  
940  
941  
942  
943  
944  
945  
946  
947  
948  
949  
950  
951  
952  
953  
954  
955  
956  
957  
958  
959  
960  
961  
962  
963  
964  
965  
966  
967  
968  
969  
970  
971  
972  
973  
974  
975  
976  
977  
978  
979  
980  
981  
982  
983  
984  
985  
986  
987  
988  
989  
990  
991  
992  
993  
994  
995  
996  
997  
998  
999  
1000

-L-  
(FOR PLAN, SEE SHEET NO. 4)