



STATE OF NORTH CAROLINA
DEPARTMENT OF TRANSPORTATION

JOSH STEIN
GOVERNOR

J.R. "JOEY" HOPKINS
SECRETARY

August 27, 2025

MEMORANDUM TO: Becca Gallas, P.E.
Division 5 Engineer

FROM: Alan Shapiro, P.E.
NCTA Chief Engineer

SUBJECT: Triangle Expressway Southeast Extension (Complete 540) from NC 55 Bypass in Apex to US 64/264 (I-87) in Knightdale, Wake and Johnston Counties; Federal Aid No. STP-0540(19), STP-0540(20), and STP-0540(21); WBS Nos. 37673.1.TA1, 35516.1.TA1, and 35517.1.TA1; STIP Project Nos. R-2721, R-2828, and R-2829

DocuSigned by:

Alan Shapiro

B149124683BD45D...

Attached are the modified US Army Corps of Engineers (USACE) Phased Section 404 Individual Permit, NC Division of Water Resources (NCDWR) Section 401 Individual Water Quality Certification, Neuse Riparian Buffer Authorization, and Non-404 Jurisdictional Wetlands and Waters Permit for the construction of the Triangle Expressway Southeast Extension (Complete 540) from NC 55 Bypass in Apex to US 64/264 (I-87) in Knightdale, Wake and Johnston Counties. STIP Nos. R- 2721, R-2828, and R-2829. ***The changes are based on the August 19, 2025 revision submittal for the R-2829A section of the project, related to design modifications to the bridge end bent over Bushy Branch.*** Subject to any requisite permit modifications, all environmental permits have been received for the construction of the final design sections of this project.

A copy of this permit package is posted on the NCDOT website at:

<https://xfer.services.ncdot.gov/pdea/PermIssued>

cc: w/o attachment (see website for attachments)
Mr. Ron Davenport, P.E. Contracts Management
Mr. Clarence Coleman, P.E., FHWA
Mrs. Heather Montague, Division 5
Mr. Mark Craig, P.E., Division 5
Mr. Boyd Tharrington, P.E., Deputy Chief Engineer
Mr. Bill Martin, P.E., Programming and TIP
Mr. Timothy Ritacco, Utilities Unit
Mr. Matt Lauffer, P.E., Hydraulics Unit
Mr. David Snoke, P.E., Structures Management Unit
Mr. Mark Staley, Roadside Environmental
Mr. John Jamison, Environmental Policy Unit
Ms. Beth Harmon, NCDMS
Ms. Deanna Riffey, Natural Environment Unit-Environmental Coordination & Permitting

Mailing Address:
NC DEPARTMENT OF TRANSPORTATION
TURNPIKE AUTHORITY
1599 MAIL SERVICE CENTER
RALEIGH, NC 27699-1599

Telephone: (919) 707-2700
Fax: (919) 715-5511
Customer Service: 1-877-368-4968

Website: www.ncdot.gov

Location:
2501 AERIAL CENTER PARKWAY
SUITE 200
MORRISVILLE, NC 27560



DEPARTMENT OF THE ARMY
U.S. ARMY CORPS OF ENGINEERS, WILMINGTON DISTRICT
RALEIGH FIELD OFFICE
3331 HERITAGE TRADE DRIVE SUITE 105
WAKE FOREST NC 27587

August 26, 2025

Regulatory Program

Alan Shapiro, P.E.
Chief Engineer
North Carolina Turnpike Authority
1599 Mail Service Center
Raleigh, NC 27699-1599

Dear Mr. Shapiro:

Reference the Department of the Army permit issued to the North Carolina Department of Transportation (NCDOT) on October 24, 2019, and subsequently modified, to authorize the discharge of fill material into waters of the United States, for construction of the Triangle Expressway Southeast Extension (Complete 540) from NC 55 Bypass in Apex to US 64/264 (1-87) in Knightdale, Wake and Johnston Counties. Sections included within this permit are R-2721, R-2828, and R-2829.

Also, please reference your August 19, 2025 letter, requesting modification of the permit to authorize a change of impacts at Site 3 for R-2829, Section A. A low contour area was identified within wetland WFN(2), adjacent to the bridge end bents at Bushy Branch. To address this condition, the end bent slopes design was revised to a 1.5:1 slope, extending beyond the original mechanized clearing and permanent fill limits. The modification requests the following wetland impacts at Site 3:

- Permanent wetland fill: 0.184 ac (previously 0.176 ac)
- Temporary wetland fill: 0.706 acre (previously 0.716 acre)
- Mechanized clearing in wetlands: 0.037 acre (previously 0.034 acre)

No additional impacts to streams or riparian buffers will occur at this location.

8.789: Adding error - ALSMEYER.ERIC.C.1087624486 Digitally signed by ALSMEYER.ERIC.C.1087624486
Date: 2025.08.26 14:02:14 -0400

The modified total waters of the U.S. impacts, including wetland, for the R-2829A section are now ~~8.585~~ acres of wetlands (6.413 acres of permanent wetland loss impacts (fill and excavation), 0.710 acre mechanized clearing in wetlands, 0.756 acre temporary wetland impacts, and 0.910 acre non-404 hand clearing in wetlands), 10,517 linear feet (lf) of tributaries (8,444 lf of permanent loss, 882 lf of bank/structure stabilization and 1,191 lf of temporary stream impacts), and 3.49 acres of permanent pond impacts.

The Corps has completed the evaluation of your request and has determined that it is appropriate and reasonable, and that no public notice is required for this modification. Therefore, the permit is modified as requested and as shown on the enclosed R-2829A Mod Permit Drawings, Sheets 10, 11, 12, 99, and 103 of 103, submittal August 19, 2025.

Additional compensatory mitigation of 0.02 acre wetland credits, is required, in accordance with the provisions outlined on the attached Compensatory Mitigation Responsibility Transfer Form.

The special conditions for the permit are also enclosed, and have not changed from the revised Special Conditions provided with the December 13, 2024 modification. The revised permit expiration date remains December 31, 2029.

NOTE: This revised modification letter replaces the previous modification dated August 21, 2025.

Should you have any questions, contact Mr. Eric Alsmeyer, via email at Eric.C.Alsmeier@usace.army.mil or by telephone at (919) 817-1570. Please take a moment to complete our customer satisfaction survey located at <https://regulatory.ops.usace.army.mil/customer-service-survey/>.

Sincerely,

A handwritten signature in black ink that reads "M. Scott Jones". The signature is written in a cursive, flowing style.

M. Scott Jones, PWS
WRDA / Transportation Branch Chief
USACE Wilmington District

Enclosures

cc: Jennifer Harris, NC Turnpike Authority (via ext-jhharris1@ncdot.gov)
Deanna Riffey, NCDOT (via driffey@ncdot.gov)

JOSH STEIN
Governor

D. REID WILSON
Secretary

RICHARD E. ROGERS, JR.
Director



August 20, 2025

Alan Shapiro, P.E., Chief Engineer
North Carolina Turnpike Authority
1578 Mail Service Center
Raleigh, NC 27699
awshapiro@ncdot.gov

Subject: MODIFICATION of 401 Water Quality Certification Pursuant to Section 401 of the Federal Clean Water Act with ADDITIONAL CONDITIONS for Proposed construction of the Triangle Expressway Southeast Extension (NC 540) in Wake & Johnston Counties, Federal Aid Project No. 050047, State Project No. 35517.3.TA1, TIP Nos, R-2721, R-2828, & R-2829. (TIP R-2829A for This Modification)
NCDWR Project No. 20181249 version 23.

Dear Mr. Shapiro:

Attached hereto is a copy of Modification to Certification No. 4179 issued to The North Carolina Department of Transportation (NCDOT), Turnpike Authority, originally dated February 15, 2019 and most recent modification dated August 20, 2025

This approval is for the purpose and design described in your application. The plans and specifications for this project are incorporated by reference as part of this Water Quality Certification. If you change your project, you must notify the Division and you may be required to submit a new application package with the appropriate fee. If the property is sold, the new owner must be given a copy of this Certification and is responsible for complying with all conditions. [15A NCAC 02H .0507(d)(2)]. This Certification does not relieve the permittee of the responsibility to obtain all other required Federal, State, or Local approvals before proceeding with the project, including those required by, but not limited to, Sediment and Erosion Control, Non-Discharge, and Water Supply Watershed regulations.

If we can be of further assistance, do not hesitate to contact us.

Sincerely,

Signed by:

Faith Hardin

3185423002EA45E...

Richard E. Rogers Jr, Director
Division of Water Resources

Attachments

Cc: Eric Alsmeyer, US Corps of Engineers, Raleigh Field Office (Eric.C.Alsmeyer@usace.army.mil)
Jennifer Harris, PE, NC Turnpike Authority (ext-jharris1@ncdot.gov)
Deanna Riffey, NCDOT Environmental Analysis (driffey@ncdot.gov)
Camden M. Brunick, Wildlands Engineering Inc (cbrunick@wildlandseng.com)
File Copy



North Carolina Department of Environmental Quality | Division of Water Resources
512 North Salisbury Street | 1650 Mail Service Center | Raleigh, North Carolina 27699-1650
919.707.9000

MODIFICATION to 401 Water Quality Certification Pursuant to Section 401 of the Federal Clean Water Act with ADDITIONAL CONDITIONS

THIS MODIFIED CERTIFICATION is issued in conformity with the requirements of Section 401 Public Laws 92-500 and 95-217 of the United States and subject to the North Carolina Division of Water Resources (NCDWR) Regulations in 15 NCAC 2H .0500. This certification modification authorizes the NC Turnpike Authority to impact 8,798 acres of jurisdictional wetlands and 10517 linear feet of jurisdictional streams in Wake County for section **R-2829A** of the Complete 540 project. The project shall be constructed pursuant to the modification application received August 19, 2025. The authorized additional impacts for this modification are as described below:

Additional R-2829A Wetland Impact Modifications in the Neuse River Basin:

Site	Additional Permanent Fill (ac)	Additional Mechanized Clearing (ac)	Decrease in Temporary Impact (ac)
3	0.008	0.003	- 0.010

Additional Wetland Mitigation Required for R-2829A: +0.011

The application provides adequate assurance that the discharge of fill material into the waters of the Neuse River Basin in conjunction with the proposed development will not result in a violation of applicable Water Quality Standards and discharge guidelines. Therefore, the State of North Carolina certifies that this activity will not violate the applicable portions of Sections 301, 302, 303, 306, 307 of PL 92-500 and PL 95-217 if conducted in accordance with the application and conditions hereinafter set forth.

This approval is only valid for the purpose and design that you submitted in your modification application received November 14, 2024. Should your project change, you are required to notify the NCDWR and submit a new application. If the property is sold, the new owner must be given a copy of this Certification and approval letter, and is thereby responsible for complying with all the conditions. If any additional wetland impacts, or stream impacts, for this project (now or in the future) exceed one acre or 150 linear feet, respectively, additional compensatory mitigation may be required as described in 15A NCAC 2H .0506 (h) (6) and (7).

For this approval to remain valid, you are required to comply with all the conditions listed below. In addition, you should obtain all other federal, state or local permits before proceeding with your project including (but not limited to) Sediment and Erosion control, Coastal Stormwater, Non-discharge and Water Supply watershed regulations. This Certification shall expire on the same day as the expiration date of the corresponding Corps of Engineers Permit.

This Water Quality Certification neither grants nor affirms any property right, license, or privilege in any lands or waters, or any right of use in any waters. This Water Quality Certification does not authorize any person to interfere with the riparian rights, littoral rights, or water use rights of any other person and does not create any prescriptive right or any right of priority regarding any usage of water. This Water Quality Certification shall not be interposed as a defense in any action respecting the determination of riparian or littoral rights or other rights to water use. No consumptive user is deemed by virtue of this Water Quality Certification to possess any prescriptive or other right of priority with respect to any other consumptive user regardless of the quantity of the withdrawal or the date on which the withdrawal was initiated or expanded. Upon the presentation of proper credentials, the Division may inspect the property.



Condition of Certification:

1. Additional mitigation must be provided for the proposed impacts as specified in the table below. The attached Compensatory Mitigation Responsibility Acceptance Form (Form) shall be completed and provided to the Division prior to impacts occurring. If the Mitigation Provider specified on the attached Form(s) for the proposed impacts changes after issuance of this Certificate, then the Permittee shall request a revised Compensatory Mitigation Responsibility Acceptance Form from the Division prior to conducting any impacts. ***If multiple mitigation banks are used for this project, it is the responsibility of the permittee to verify that the credits from the various banks add up to an amount equal to or greater than the amount required in this certification.***

	Compensatory Mitigation Required	River Basin & HUC Number
Wetland	+ 0.011 acres (credits)	Neuse River Basin 03020201 HUC

Citation: 15A NCAC 02H .0506(c); 15A NCAC 02H .0507(c)

2. All other conditions in the Water Quality Certification for this project dated December 10, 2024, and all previous versions thereof, are still applicable to this approval.

This Certification shall become null and void unless the above conditions are made conditions of the Federal 404 and/or Coastal Area Management Act Permit. This Certification shall expire upon the expiration of the 404 or CAMA permit. Please be aware that impacting waters without first applying for and securing the issuance of a 401 Water Quality Certification violates Title 15A of the North Carolina Administrative Code (NCAC) 2H .0500. Title 15A NCAC 2H .0500 requires certifications pursuant to Section 401 of the Clean Water Act whenever construction or operation of facilities will result in a discharge into navigable waters, including wetlands, as described in 33 Code of Federal Regulations (CFR) Part 323. It also states any person desiring issuance of the State certification or coverage under a general certification required by Section 401 of the Federal Water Pollution Control Act shall file with the Director of the North Carolina Division of Water Quality. Violations of any condition herein set forth may result in revocation of this Certification and may result in criminal and/or civil penalties. Pursuant to G.S. 143-215.6A, these violations and any future violations are subject to a civil penalty assessment of up to a maximum of \$25,000.00 per day for each violation.

This approval and its conditions are final and binding unless contested [G.S. 143-215.5]. Please be aware that impacting waters without first applying for and securing the issuance of a 401 Water Quality Certification violates Title 15A of the North Carolina Administrative Code (NCAC) 2H .0500. Title 15A NCAC 2H .0500 requires certifications pursuant to Section 401 of the Clean Water Act whenever construction or operation of facilities will result in a discharge into navigable waters, including wetlands, as described in 33 Code of Federal Regulations (CFR) Part 323. It also states any person desiring issuance of the State certification or coverage under a general certification required by Section 401 of the Federal Water Pollution Control Act shall file with the Director of the North Carolina Division of Water Quality. Pursuant to G.S. 143-215.6A, these violations and any future violations are subject to a civil penalty assessment of up to a maximum of \$25,000.00 per day for each violation.

This Certification can be contested as provided in Chapter 150B of the North Carolina General Statutes by filing a Petition for a Contested Case Hearing (Petition) with the North Carolina Office of Administrative Hearings (OAH) **within sixty (60) calendar days**. Requirements for filing a Petition are set forth in Chapter 150B of the North Carolina General Statutes and Title 26 of the North Carolina Administrative Code. Additional information regarding requirements for filing a Petition and Petition forms may be accessed at <http://www.ncoah.com/> or by calling the OAH Clerk's Office at (919) 431-3000.

A party filing a Petition must serve a copy of the Petition on:
William F. Lane, General Counsel
Department of Environmental Quality
1601 Mail Service Center
Raleigh, NC 27699-1601



If the party filing the Petition is not the permittee, then the party must also serve the recipient of the Certification in accordance with N.C.G.S 150B-23(a).

This the 20th day of August 2025

DIVISION OF WATER RESOURCES

Signed by:
Faith Hardin
3185423002EA45E...

Richard E. Rogers, Jr, Director

WQC No. 4179



North Carolina Department of Environmental Quality | Division of Water Resources
512 North Salisbury Street | 1650 Mail Service Center | Raleigh, North Carolina 27699-1650
919.707.9000

Submittal August 19, 2025

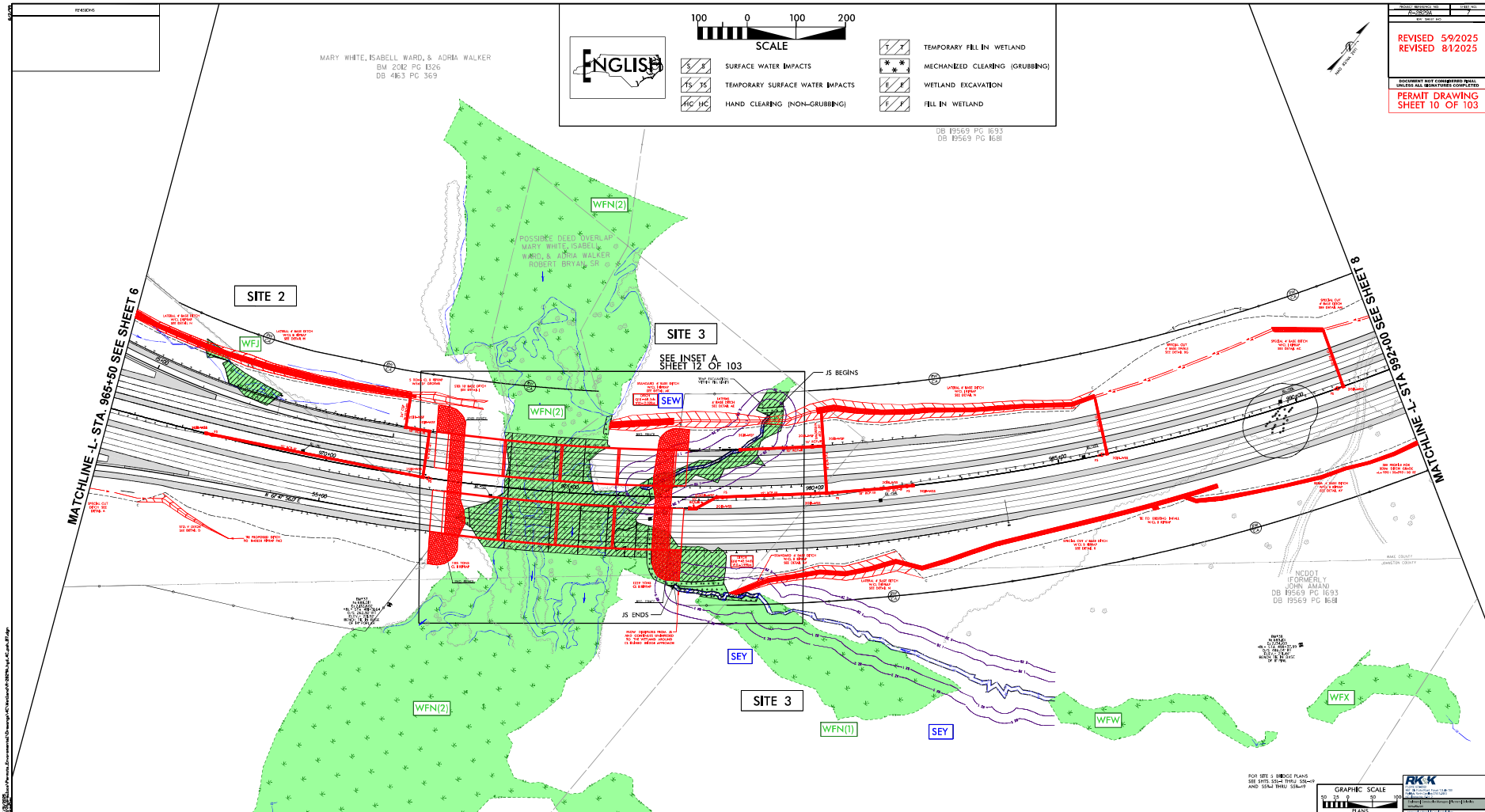



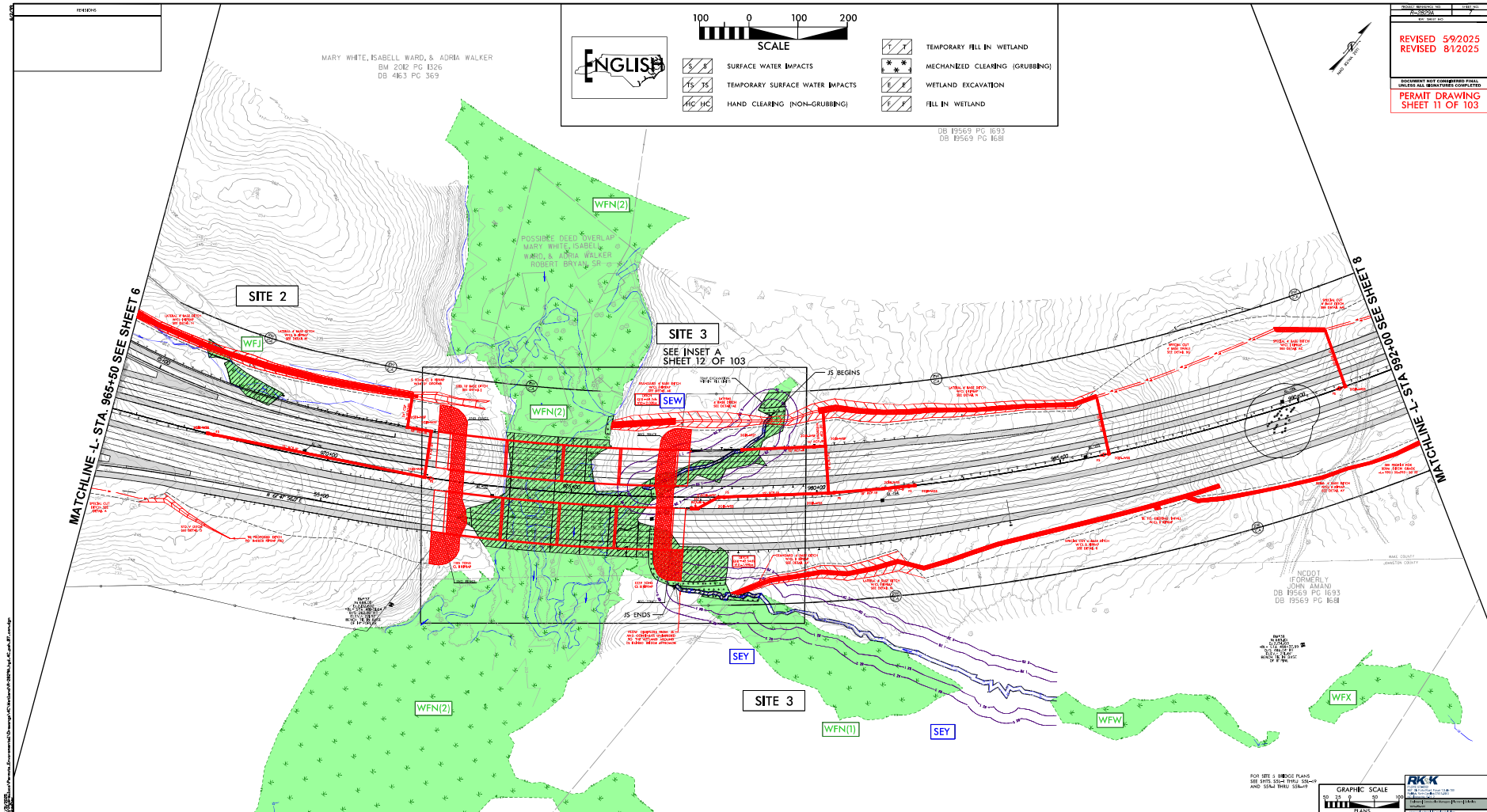

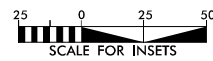

Submittal August 19, 2025



**DOCUMENT NOT CONSIDERED FINAL
UNLESS ALL SIGNATURES COMPLETED**



	SURFACE WATER IMPACTS
	TEMPORARY SURFACE WATER IMPACTS
	HAND CLEARING (NON-GRUBBING)

	FILL IN WETLAND
	MECHANIZED CLEARING (GRUBBING)
	WETLAND EXCAVATION
	TEMPORARY FILL IN WETLAND

SITE 3

INSET A

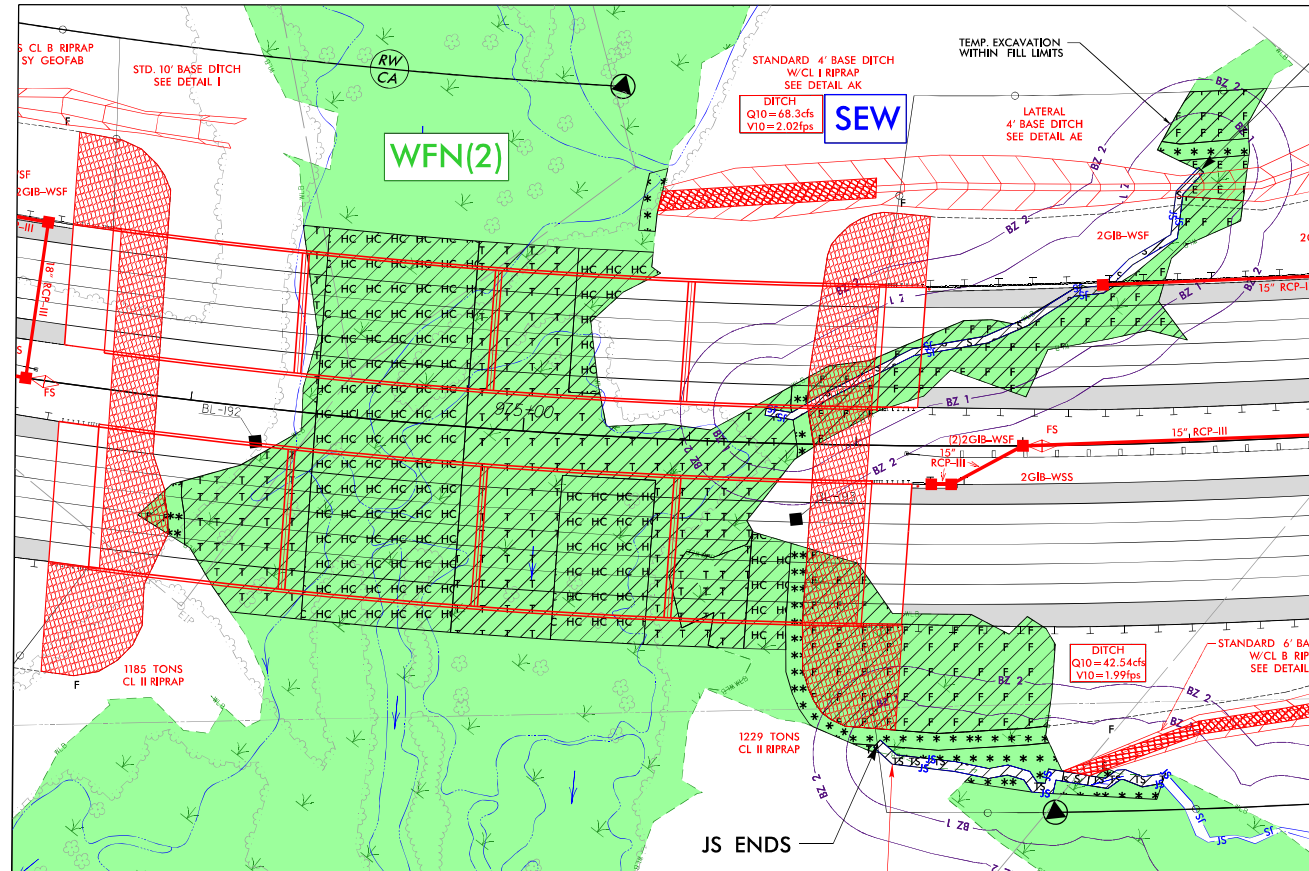

7/31/2025
R:\Hydraulics\Permits_Environmental\Drawings\4C\Westland\R-2829A_hyd_4C_psh.07_con.dgn
akaster

WETLAND AND SURFACE WATER IMPACTS SUMMARY												
Site No.	Station (From/To)	Structure Size / Type	WETLAND IMPACTS					SURFACE WATER IMPACTS				
			Permanent Fill In Wetlands (ac)	Temp. Fill In Wetlands (ac)	Excavation in Wetlands (ac)	Mechanized Clearing in Wetlands (ac)	Hand Clearing in Wetlands (ac)	Permanent SW impacts (ac)	Temp. SW impacts (ac)	Existing Channel Impacts Permanent (ft)	Existing Channel Impacts Temp. (ft)	Natural Stream Design (ft)
1	-Y22RPAFLY_REV- 28+00 - 29+58 LT	Roadway Fill: WFG	0.055									
2	-L- 967+04 - 968+83 LT	Roadway Fill: WFJ	0.098		0.023							
3	-L- 972+77 - 979+44 LT	Bridge: SEW						0.031		319		
		WFN(2)	0.184	0.706	0.018	0.037	0.660					
	-L- 976+61 - 978+80 RT	Roadway Fill: SEY						0.002	0.023	15	174	
		WFN(1)	0.257	0.049	0.001	0.098	0.037					
4	-L- 1001+92 - 1004+65 RT	48" RCP: WFY	0.449			0.034						
5	-L1- 1008+79	9'x8' RCBC, SFH						0.042	0.010	384	96	
		Structure Stabilization						0.007		63		
6	-L1- 1013+72	12'x8' RCBC, SFF						0.070	0.009	533	60	
		Structure Stabilization						0.012		86		
7	-L1- 1012+26 LT - 1018+49 RT	Roadway Fill: SFE						0.060	0.002	759	21	
		WFZ	0.113		0.015	0.010						
8	-L1- 1022+67 LT - 1025+03 RT	42" RCP: SFB						0.017		222		
		Structure Stabilization						0.001	0.001	24	10	
		WGD	0.021			0.001						
		WGC	0.013									
		WGB	0.079									
SHEET TOTALS*:			1.269	0.755	0.057	0.180	0.697	0.242	0.045	2405	361	0

*Rounded totals are sum of actual impacts

NOTES:

Site 3: 4 interior bents with 4 @ 3.5' diameter columns per bent= total 154.4sq ft (0.004ac) permanent wetland impact (included above)

Site 3: WFN(1) piece above SEW is a total take in summary above; hatching outside construction impacts is not shown.

Temporary Excavation (~0.01ac) within the permanently impacted wetland footprint limits due to an erosion control clean water diversion channel

Site 7: WFZ is a total take in summary above; hatching outside construction impacts is not shown

Revised 5/9/2025, **8/1/2025**

NC DEPARTMENT OF TRANSPORTATION
DIVISION OF HIGHWAYS
9/4/2024
Wake County
R-2829A

WETLAND AND SURFACE WATER IMPACTS SUMMARY												
Site No.	Station (From/To)	Structure Size / Type	WETLAND IMPACTS					SURFACE WATER IMPACTS				
			Permanent Fill In Wetlands (ac)	Temp. Fill In Wetlands (ac)	Excavation in Wetlands (ac)	Mechanized Clearing in Wetlands (ac)	Hand Clearing in Wetlands (ac)	Permanent SW impacts (ac)	Temp. SW impacts (ac)	Existing Channel Impacts Permanent (ft)	Existing Channel Impacts Temp. (ft)	Natural Stream Design (ft)
30	-Y23DR- 23+90 LT - 25+00 RT	42" RCP: SHT						0.011		225		
	-Y23DR- 23+59 - 25+53 LT	PAO						0.792				
31	-Y24R- 19+06 LT - 21+74 RT	5'x6' RCBC Ext / 72" WSP: SFY						0.001		6		
		Structure Stabilization						0.005	0.002	34	10	
		WGW	0.023		0.004	0.019						
		WGV(1)	0.055		0.010	0.021						
32	-Y24R- 34+65 CT	6'x8'9" RCBC Ext / 72" WSP: SGA						0.064	0.001	270	7	
		Structure Stabilization						0.007	0.003	30	12	
33	-Y26R- 18+73 CT	10'x9' RCBC: SGA						0.016	0.001	137	11	
		Structure Stabilization						0.007	0.006	40	37	
		WHD(2)			0.007	0.014						
		WAAK	0.026			0.020						
34	-Y26R- 18+50 LT	10'x9' RCBC: SAAK						0.002	0.001	31	11	
35	-Y26R- 18+35 LT	10'x9' RCBC: SAAL							0.001		10	
36	-Y22RPE_REV- 45+95 - 46+14 RT	Ditch: WFK				0.005						
SHEET TOTALS*:			0.104	0.000	0.021	0.079	0.000	0.905	0.015	773	98	0
PROJECT TOTALS*:			6.203	0.755	0.210	0.720	0.697	4.422	0.176	9326	951	0

*Rounded totals are sum of actual impacts

NOTES:

Site 33: Temporary Excavation (~0.001ac) shown within the mechanized clearing limits due to an erosion control temporary construction channel

Revised 5/9/2025, 8/1/2025

NC DEPARTMENT OF TRANSPORTATION
DIVISION OF HIGHWAYS
9/4/2024
Wake County
R-2829A