



## Pre-Construction Notification (PCN) Form

For Nationwide Permits and Regional General Permits

(along with corresponding Water Quality Certifications)

January 31, 2018 Ver 2.3

*Please note: fields marked with a red asterisk \* below are required. You will not be able to submit the form until all mandatory questions are answered.*

*Also, if at any point you wish to print a copy of the E-PCN, all you need to do is right-click on the document and you can print a copy of the form.*

Below is a link to the online help file.

<https://edocs.deq.nc.gov/WaterResources/0/edoc/624704/PCN%20Help%20File%202018-1-30.pdf>

### A. Processing Information

---

**County (or Counties) where the project is located: \***

Wake

**Is this project a public transportation project? \***

Yes  No

This is any publicly funded by municipal, state or federal funds road, rail, airport transportation project.

**Is this a NCDOT Project? \***

Yes  No

**(NCDOT only) T.I.P. or state project number:**

R-2721

**WBS #**

373673.1.TA2

(for NCDOT use only)

**1a. Type(s) of approval sought from the Corps: \***

Section 404 Permit (wetlands, streams and waters, Clean Water Act)

Section 10 Permit (navigable waters, tidal waters, Rivers and Harbors Act)

**1b. What type(s) of permit(s) do you wish to seek authorization? \***

Nationwide Permit (NWP)

Regional General Permit (RGP)

Standard (IP)

This form may be Corps to initiate the standard/individual permit process. Please contact your Corps representative for submittal of standard permits.

All required items that are not provided in the E-PCN and be added to the miscellaneous upload located at the bottom of this form.

---

**Nationwide Permit (NWP) Number:**

12 - Utility Lines

**NWP Number Other:**

List all NW numbers you are applying for not on the drop down list.

**1c. Type(s) of approval sought from the DWR: \***

check all that apply

- 401 Water Quality Certification - Regular  
 Non-404 Jurisdictional General Permit  
 Individual Permit

- 401 Water Quality Certification - Express  
 Riparian Buffer Authorization

1d. Is this notification solely for the record because written approval is not required? \*

For the record only for DWR 401 Certification:

Yes  No

For the record only for Corps Permit:

Yes  No

1e. Is payment into a mitigation bank or in-lieu fee program proposed for mitigation of impacts?

If so, attach the acceptance letter from mitigation bank or in-lieu fee program

Yes  No

#### Acceptance Letter Attachment

Click the upload button or drag and drop files here to attach document

R-2721B UTILITY DMS Letter.pdf

101.17KB

FILETYPE MUST BE PDF

1f. Is the project located in any of NC's twenty coastal counties? \*

Yes  No

1h. Is the project located in a designated trout watershed? \*

Yes  No

Link to trout information: <http://www.saw.usace.army.mil/Missions/Regulatory-Permit-Program/Agency-Coordination/Trout.aspx>

## B. Applicant Information

1a. Who is the Primary Contact? \*

NCDOT

1b. Primary Contact Email: \*

driffey@ncdot.gov

1c. Primary Contact Phone: \*

(xxx)xxx-xxxx

(919)707-6151

1d. Who is applying for the permit?

Owner  Applicant (other than owner)  Agent/Consultant  
(Check all that apply)

### 2. Owner Information

2a. Name(s) on recorded deed:

2b. Deed book and page no.:

2c. Responsible party:

(for Corporations)

2d. Address

Street Address

Address Line 2

City

State / Province / Region

Postal / Zip Code

Country

**2e. Telephone Number:**

(xxx)xxx-xxxx

**2f. Fax Number:**

(xxx)xxx-xxxx

**2g. Email Address: \***

pharris@ncdot.gov

---

## C. Project Information and Prior Project History

---

### 1. Project Information

---

**1a. Name of project: \***

Southern Wake Freeway from West of NC55 to East of US401-Central

**1b. Subdivision name:**

(if appropriate)

**1c. Nearest municipality / town: \***

Raleigh

**1d. Driving directions \***

If it is a new project and can not easily be found in a GPS mapping system. Please provide directions.

Project is near intersection of Donny Brook Road and US 401 (Fayetteville Road) close to Wake Technical Community College in Raleigh.

### 2. Project Identification

---

**2a. Property Identification Number:**

(tax PIN or parcel ID)

**2b. Property size:**

(in acres)

---

**2c. Project Address**

Street Address

Address Line 2

City

State / Province / Region

Postal / Zip Code

Country

**2d. Site coordinates in decimal degrees**

Please collect site coordinates in decimal degrees. Use between 4-6 digits (unless you are using a survey-grade GPS device) after the decimal place as appropriate, based on how the location was determined. (For example, most mobile phones with GPS provide locational precision in decimal degrees to map coordinates to 5 or 6 digits after the decimal place.)

---

**Latitude: \***

**35.6561**

ex: 34.208504

**Longitude: \***

**-78.7021**

-77.796371

### 3. Surface Waters

**3a. Name of the nearest body of water to proposed project: \***

UT Mills Branch

**3b. Water Resources Classification of nearest receiving water: \***

C: NSW

[Surface Water Lookup](#)

---

**3c. What river basin(s) is your project located in? \***

Neuse

[River Basin Lookup](#)

### 4. Project Description

**4a. Describe the existing conditions on the site and the general land use in the vicinity of the project at the time of this application: \***

Site conditions show both forested and clear cut areas. Land use is both residential and commercial.

**4b. Attach an 8 1/2 X 11 excerpt from the most recent version of the USGS topographic map indicating the location of the project site. (for DWR)**

Click the upload button or drag and drop files here to attach document

File type must be pdf

**4c. Attach an 8 1/2 X 11 excerpt from the most recent version of the published County NRCS Soil Survey map depicting the project site. (for DWR)**

Click the upload button or drag and drop files here to attach document

File type must be pdf

**4d. List the total estimated acreage of all existing wetlands on the property:**

1.17

**4e. List the total estimated linear feet of all existing streams on the property:**

(intermittent and perennial)

890

**4f. Explain the purpose of the proposed project: \***

Installation of a gas pipeline

**4g. Describe the overall project in detail, including indirect impacts and the type of equipment to be used: \***

A 16" steel gas transmission line will be constructed within a PUE outside of NCDOT's right of way to avoid conflicts with the proposed highway project. The line will be routed around the interchange of R-2721 and US 401 and tie back in to the existing pipeline east of this interchange. The pipeline will be installed by open trench construction. The trench side walls will be sloped back at a 1.5 to 1 ratio for accessibility and safety of the workers in the trench. The clearing and grubbing associated with the construction allows for regular scheduled patrolling and surveys by vehicle or by air and prolongs the life of the protective coating on the pipeline and decreases the chance of a gas release by reducing root damage and corrosion to the pipe. Standard construction equipment will be used.

**4h. Please upload project drawings for the proposed project.**

Click the upload button or drag and drop files here to attach document

R-2721 Colonial Pipeline Plans 8-18.pdf

2.75MB

File type must be pdf

### 5. Jurisdictional Determinations

**5a. Have the wetlands or streams been delineated on the property or proposed impact areas? \***

Yes

No

Unknown

**Comments:**

Delineated for Colonial Pipeline

**5b. If the Corps made a jurisdictional determination, what type of determination was made? \***

- Preliminary       Approved       Unknown       N/A

**Corps AID Number:**

Example: SAW-2017-99999

SAW-2009-02240

**5c. If 5a is yes, who delineated the jurisdictional areas?**

**Name (if known):** Shanna Cahill  
**Agency/Consultant Company:** Corblu Ecology Group  
**Other:**

**5d. If yes, list the dates of the Corps jurisdictional determinations or State determinations and attach documentation.**

June 11, 2018 and August 2, 2018

**5d1. Jurisdictional determination upload**

Click the upload button or drag and drop files here to attach document

18-08-07\_PJD\_Colonial Pipeline\_\_Expanded Area 5\_Complete 540.pdf 120.4KB

File type must be PDF

## 6. Project History

**6a. Have permits or certifications been requested or obtained for this project (including all prior phases) in the past? \***

- Yes       No       Unknown

## 7. Future Project Plans

**7a. Is this a phased project? \***

- Yes       No

**7b. If yes, explain.**

An Individual Permit application will be submitted for the proposed impacts associated with the remainder of entire Complete 540 project.

**Are any other NWP(s), regional general permit(s), or individual permits(s) used, or intended to be used, to authorize any part of the proposed project or related activity? This includes other separate and distant crossing for linear projects that require Department of the Army authorization but don't require pre-construction notification.**

Yes. An Individual Permit application will be submitted for the proposed impacts associated with the remainder of entire Complete 540 project.

## D. Proposed Impacts Inventory

### 1. Impacts Summary

**1a. Where are the impacts associated with your project? (check all that apply):**

- Wetlands       Streams-tributaries       Buffers  
 Open Waters       Pond Construction

### 2. Wetland Impacts

If there are wetland impacts proposed on the site, then complete this question for each wetland area impacted.

**2a. Site # - Reason for impact \***    **2b. Impact type \***    **2c. Type of wetland \***    **2d. Wetland name \*2e.**  
Forested \*    **2f. Type of Jurisdiction \***    **2g. Impact area \***

<b>1a- Mechanized Clearing</b> Map label (e.g. Road Crossing 1 - Culvert, dewatering, etc)	<b>P</b> Permanent (P) or Temporary (T)	<b>Headwater Forest</b>	<b>WBX (or Colonial Area 5)</b>	<b>No</b>	<b>Both</b> (404, 10) or DWR (401, other)	<b>0.001</b> (acres)
<b>1b- Mechanized Clearing</b> Map label (e.g. Road Crossing 1 - Culvert, dewatering, etc)	<b>P</b> Permanent (P) or Temporary (T)	<b>Headwater Forest</b>	<b>WBX (or Colonial Area 5)</b>	<b>No</b>	<b>Both</b> (404, 10) or DWR (401, other)	<b>0.002</b> (acres)
<b>2- Excavation</b> Map label (e.g. Road Crossing 1 - Culvert, dewatering, etc)	<b>P</b> Permanent (P) or Temporary (T)	<b>Bottomland Hardwood Forest</b>	<b>WBZ (or Colonial Area 5)</b>	<b>Yes</b>	<b>Both</b> (404, 10) or DWR (401, other)	<b>0.030</b> (acres)
<b>2- Mechanized Clearing</b> Map label (e.g. Road Crossing 1 - Culvert, dewatering, etc)	<b>P</b> Permanent (P) or Temporary (T)	<b>Bottomland Hardwood Forest</b>	<b>WBZ (or Colonial Area 5)</b>	<b>Yes</b>	<b>Both</b> (404, 10) or DWR (401, other)	<b>0.030</b> (acres)

**2g. Total Temporary Wetland Impact**

0.000

**2g. Total Permanent Wetland Impact**

0.063

**2g. Total Wetland Impact**

0.063

**2h. Comments:**

Wetland names assigned are both NCDOT for R-2721 and Colonial's for Area 5. Wetland WBX (or Colonial Area 5) has been clearcut. Site 1 (a & b) is approximately 121 square feet (0.003 ac) of wetland being cleared and grubbed as part of a utility construction easement. The pipeline will be installed by open trench due to the clearing and grubbing that is necessary. Clearing and grubbing of trees and roots associated with the construction allows for regular scheduled patrolling and surveys by vehicle or by air and prolongs the life of the protective coating on the pipeline and decreases the chance of a gas release by reducing root damage and corrosion to the pipe.

**3. Stream Impacts**

If there are perennial or intermittent stream impacts (including temporary impacts) proposed on the site, then complete this question for all stream sites impacted.

	<b>3a. Reason for impact</b>	<b>*3b. Impact type *</b>	<b>3c. Type of impact</b>	<b>*3d. Stream name *</b>	<b>3e. Stream Type *</b>	<b>3f. Type of Jurisdiction *</b>	<b>3g. Stream width *</b>	<b>3h. Impact length *</b>
<b>S1</b>	<b>2- Excavation</b> Map label (e.g. Road Crossing 1)	<b>T</b> Permanent (P) or Temporary (T)	<b>Excavation</b>	<b>SBJ (or Colonial Area 5)</b>	<b>Perennial</b> Perennial (PER) or intermittent (INT)	<b>Both</b>	<b>2</b> Average (feet)	<b>65</b> (linear feet)

\*\* All Perennial or Intermittent streams must be verified by DWR or delegated local government.

**3i. Total jurisdictional ditch impact in square feet:**

0

**3i. Total permanent stream impacts:**

0

**3i. Total temporary stream impacts:**

65

**3i. Total stream and tributary impacts:**

65

**3j. Comments:**

Stream names assigned are both NCDOT for R-2721 and Colonial's for Area 5. Excavation will involve open cut, back filling and pump around method.

**6. Buffer Impacts (for DWR)**

If project will impact a protected riparian buffer, then complete the chart below. Individually list all buffer impacts below.

### 6a. Project is in which protect basin(s)? \*

Check all that apply.

- Neuse  Tar-Pamlico  
 Catawba  Randleman  
 Goose Creek  Jordan Lake  
 Other

### 6b. Impact Type \*

#### Stie 2

Location and Exempt, Allow able, allow able w/  
mitigation

#### Site 2

Location and Exempt, Allow able, allow able w/  
mitigation

### 6c. Per or Temp \*

P

Permanent (P) or  
Temporary (T)

P

Permanent (P) or  
Temporary (T)

### 6d. Stream name \*

SBJ (or Colonial Area 5)

SBJ (or Colonial Area 5)

### 6e. Buffer mitigation required? \*

Yes

No

### 6f. Zone 1 impact \*

4,333

(square feet)

0

(square feet)

### 6g. Zone 2 impact \*

0

(square feet)

10,323

(square feet)

### 6h. Total buffer impacts:

	Zone 1	Zone 2
Temporary impacts:	0.00	0.00

	Zone 1	Zone 2
Permanent impacts:	4,333.00	10,323.00

	Zone 1	Zone 2
Total buffer impacts:	4,333.00	10,323.00

### 6i. Comments:

There are 2,590 sq. ft. buffers in wetlands in Zone 1. Mitigation = 4,333-2,590 = 1,743 sq. ft.

### Supporting Documentation - i.e. Impact Maps, Plan Sheet, etc.

Click the upload button or drag and drop files here to attach document

File must be PDF

## E. Impact Justification and Mitigation

### 1. Avoidance and Minimization

#### 1a. Specifically describe measures taken to avoid or minimize the proposed impacts in designing the project: \*

Pipeline was designed and placed where minimal impacts would occur in jurisdictional areas.

#### 1b. Specifically describe measures taken to avoid or minimize the proposed impacts through construction techniques: \*

Construction limits were pulled in adjacent to environmentally sensitive areas to avoid additional impacts.

### 2. Compensatory Mitigation for Impacts to Waters of the U.S. or Waters of the State

#### 2a. Does the project require Compensatory Mitigation for impacts to Waters of the U.S. or Waters of the State?

Yes  No

#### 2c. If yes, mitigation is required by (check all that apply):

DWR  Corps

#### 2d. If yes, which mitigation option(s) will be used for this project?

Mitigation bank

Payment to in-lieu fee program

Permittee Responsible Mitigation

#### 4. Complete if Making a Payment to In-lieu Fee Program

4a. Approval letter from in-lieu fee program is attached.

Yes

4b. Stream mitigation requested:

(linear feet)

4c. If using stream mitigation, what is the stream temperature:

NC Stream Temperature Classification Maps can be found under the Mitigation Concepts tab on the Wilmington District's [RIBITS](#) website.

4d. Buffer mitigation requested (DWR only):

(square feet)

1,743

4e. Riparian wetland mitigation requested:

(acres)

0.07

4f. Non-riparian wetland mitigation requested:

(acres)

4g. Coastal (tidal) wetland mitigation requested:

(acres)

4h. Comments

#### 6. Buffer mitigation (State Regulated Riparian Buffer Rules) - required by DWR

6a. Will the project result in an impact within a protected riparian buffer that requires buffer mitigation? If yes, you must fill out this entire form - please contact DWR for more information.

Yes

No

6b. If yes, then identify the square feet of impact to each zone of the riparian buffer that requires mitigation calculate the amount of mitigation required in the table below.

	6c. Reason for impact	6d. Total impact (square feet)	Multiplier	6e. Required mitigation (square feet)
Zone 1	Relocation of gas pipeline	4,333	3	12,999

Zone 2

0

0

6f. Total buffer mitigation required

12999

6g. If buffer mitigation is required, is payment to a mitigation bank or NC Division of Mitigation Services proposed?

Yes  No

6h. Attach the acceptance letter from the mitigation bank or NC Division of Mitigation Services.

(PDF only)

6j. Comments:



There are 2,590 sq. ft. buffers in wetlands in Zone 1. Mitigation = 4,333-2,590 = 1,743 sq. ft.

## F. Stormwater Management and Diffuse Flow Plan (required by DWR)

\*\*\* Recent changes to the stormwater rules have required updates to this section .\*\*\*

### 1. Diffuse Flow Plan

1a. Does the project include or is it adjacent to protected riparian buffers identified within one of the NC Riparian Buffer Protection Rules?

Yes  No

1b. All buffer impacts and high ground impacts require diffuse flow or other form of stormwater treatment. If the project is subject to a state implemented riparian buffer protection program, include a plan that fully documents how diffuse flow will be maintained.

All Stormwater Control Measures (SCM)s must be designed in accordance with the [NC Stormwater Design Manual](#). Associated supplement forms and other documentation shall be provided.

What type of SCM are you providing?

- Level Spreader  
 Vegetated Conveyance (lower SHWT)  
 Wetland Swale (higher SHWT)  
 Other SCM that removes minimum 30% nitrogen  
(check all that apply)

For a list of options to meet the diffuse flow requirements, click [here](#).

#### Diffus Flow Documentation

Click the upload button or drag and drop files here to attach document

File type must be PDF

### 2. Stormwater Management Plan

2a. Is this a NCDOT project subject to compliance with NCDOT's Individual NPDES permit NCS000250? \*

Yes  No

## G. Supplementary Information

### 1. Environmental Documentation

1a. Does the project involve an expenditure of public (federal/state/local) funds or the use of public (federal/state) land? \*

Yes  No

1b. If you answered "yes" to the above, does the project require preparation of an environmental document pursuant to the requirements of the National or State (North Carolina) Environmental Policy Act (NEPA/SEPA)? \*

Yes  No

1c. If you answered "yes" to the above, has the document review been finalized by the State Clearing House? (If so, attach a copy of the NEPA or SEPA final approval letter.) \*

Yes  No

#### NEPA or SEPA Final Approval Letter

Click the upload button or drag and drop files here to attach document

FILE TYPE MUST BE PDF

### 2. Violations (DWR Requirement)

2a. Is the site in violation of DWR Water Quality Certification Rules (15A NCAC 2H .0500), Isolated Wetland Rules (15A NCAC 2H .1300), or DWR Surface Water or Wetland Standards or Riparian Buffer Rules (15A NCAC 2B .0200)? \*

Yes  No

**2b. Is this an after-the-fact permit application? \***

Yes  No

### 3. Cumulative Impacts (DWR Requirement)

**3a. Will this project (based on past and reasonably anticipated future impacts) result in additional development, which could impact nearby downstream water quality? \***

Yes  No

**3b. If you answered "no," provide a short narrative description.**

Due to the minimal impact resulting from this pipeline relocation, this project will neither influence nearby land uses nor stimulate growth. Therefore, a detailed indirect or cumulative effects study will not be necessary.

### 4. Sewage Disposal (DWR Requirement)

**4a. Is sewage disposal required by DWR for this project? \***

Yes  No  N/A

### 5. Endangered Species and Designated Critical Habitat (Corps Requirement)

**5a. Will this project occur in or near an area with federally protected species or habitat? \***

Yes  No

**5b. Have you checked with the USFWS concerning Endangered Species Act impacts? \***

Yes  No

**5c. If yes, indicate the USFWS Field Office you have contacted.**

Raleigh

**5d. Is another Federal agency involved? \***

Yes  No  Unknown

**5e. Is this a DOT project located within Division's 1-8? \***

Yes  No

**5j. What data sources did you use to determine whether your site would impact Endangered Species or Designated Critical Habitat? \***

USFWS county list and NCNHP database were reviewed along with onsite field surveys. Surveys were done in July 2018 for Michaux's sumac and red-cockaded woodpecker by Corblu Ecology Group. Habitat found for Michaux's sumac not for RCW. Neither species found during field visit. Biological Conclusion is No Effect. Cape fear shiner, Dwarf wedgemussel and Tar River spinymussel is out not in range basin and has a Biological Conclusion of No Effect. The Biological Conclusion for the Northern Long Eared Bat is May Affect, Not Likely to Adversely Affect.

### 6. Essential Fish Habitat (Corps Requirement)

**6a. Will this project occur in or near an area designated as an Essential Fish Habitat? \***

Yes  No

**6b. What data sources did you use to determine whether your site would impact an Essential Fish Habitat? \***

NMFS County Index

### 7. Historic or Prehistoric Cultural Resources (Corps Requirement)

Link to the State Historic Preservation Office Historic Properties Map (does not include archaeological data: <http://gis.ncdcr.gov/hpweb/>)

**7a. Will this project occur in or near an area that the state, federal or tribal governments have designated as having historic or cultural preservation status (e.g., National Historic Trust designation or properties significant in North Carolina history and archaeology)? \***

Yes

No

**7b. What data sources did you use to determine whether your site would impact historic or archeological resources? \***

NEPA Documentation

**7c. Historic or Prehistoric Information Upload**

Click the upload button or drag and drop files here to attach document

File must be PDF

## 8. Flood Zone Designation (Corps Requirement)

Link to the FEMA Floodplain Maps: <https://msc.fema.gov/portal/search>

**8a. Will this project occur in a FEMA-designated 100-year floodplain? \***

Yes

No

**8c. What source(s) did you use to make the floodplain determination? \***

FEMA FRIS Maps

## Miscellaneous

**Miscellaneous attachments not previously requested.**

Click the upload button or drag and drop files here to attach document

File must be PDF or KMZ

## Signature

\*

By checking the box and signing below, I certify that:

- I have given true, accurate, and complete information on this form;
- I agree that submission of this PCN form is a "transaction" subject to Chapter 66, Article 40 of the NC General Statutes (the "Uniform Electronic Transactions Act");
- I agree to conduct this transaction by electronic means pursuant to Chapter 66, Article 40 of the NC General Statutes (the "Uniform Electronic Transactions Act");
- I understand that an electronic signature has the same legal effect and can be enforced in the same way as a written signature; AND
- I intend to electronically sign and submit the PCN form.

**Full Name: \***

Mack Christopher Rivenbark, III

**Signature**

*Mack C. Rivenbark, III*

**Date**

8/28/2018



August 23, 2018

Mr. Philip S. Harris, P.E., CPM  
Environmental Analysis Unit  
North Carolina Department of Transportation  
1598 Mail Service Center  
Raleigh, North Carolina 27699-1598

Dear Mr. Harris:

Subject: DMS Mitigation Acceptance Letter:

**R-2721B UTILITY**, NC 540 from East of SR 1389 (Pierce-Olive Road) to East of US 401, Wake County

The purpose of this letter is to notify you that the Division of Mitigation Services (DMS) will provide the wetland and buffer mitigation for the subject project. This acceptance letter is for the separate utility permit needed for this project. Based on the information supplied by you on August 22, 2018, the impacts are located in CU 03020201 of the Neuse River basin in the Central Piedmont (CP) Eco-Region, and are as follows:

Stream and Wetlands	River Basin	CU Location	Eco-Region	Stream			Wetlands		
				Cold	Cool	Warm	Riparian	Non-Riparian	Coastal Marsh
Impacts	Neuse	03020201	CP	0	0	0	0.07	0	0

\*Some of the impacts may be proposed to be mitigated at a 1:1 mitigation ratio. See permit application for details.

All buffer mitigation requests and approvals are administrated through the Riparian Restoration Buffer Fund. The NCDOT will be responsible to ensure that appropriate compensation for the buffer mitigation will be provided in the agreed upon method of fund transfer. Upon receipt of the NCDWR’s Buffer Authorization Certification, DMS will transfer funds from the NCDOT 2984 Fund into the Riparian Restoration Buffer Fund. Upon completion of transfer payment, NCDOT will have completed its riparian buffer mitigation responsibility for TIP Number R-2721B UTILITY. Subsequently, DMS will conduct a review of current NCDOT ILF Program mitigation projects in the river basin to determine if available buffer mitigation credits exist. If there are buffer mitigation credits available, then the Riparian Restoration Buffer Fund will purchase the appropriate amount of buffer mitigation credits from NCDOT ILF Program.



Mr. Harris  
August 23, 2018  
Page Two  
NCDOT TIP R-2721B UTILITY

Buffer	River Basin	CU	Eco-Region	Buffer Impacts		
				Zone 1	Zone 2	TOTAL
Impacts	Neuse	03020201	CP	1,743.0	0	1,743.0

DMS commits to implementing sufficient compensatory mitigation credits to offset the impacts associated with this project as determined by the regulatory agencies in accordance with the In-Lieu Fee Instrument dated July 28, 2010. If the above referenced impact amounts are revised, then this mitigation acceptance letter will no longer be valid and a new mitigation acceptance letter will be required from DMS

If you have any questions or need additional information, please contact Ms. Beth Harmon at 919-707-8420.

Sincerely,

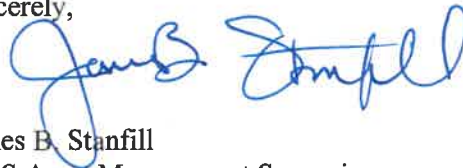

James B. Stanfill  
DMS Asset Management Supervisor

Cc: Mr. Eric Alsmeyer, USACE – Raleigh Regulatory Field Office  
Mr. Rob Ridings, NC Division of Water Resources  
File: R-2721B UTILITY



09\_08/2018

STATE OF NORTH CAROLINA  
DIVISION OF HIGHWAYS

STATE	STATE PROJECT REFERENCE NO.	SHEET NO.	TOTAL SHEETS
N.C.	R-2721	1	4
STATE PROJ. NO.	F.A. PROJ. NO.	DESCRIPTION	
6.401078	STP-540(19)	PE	

TIP PROJECT: R-2721

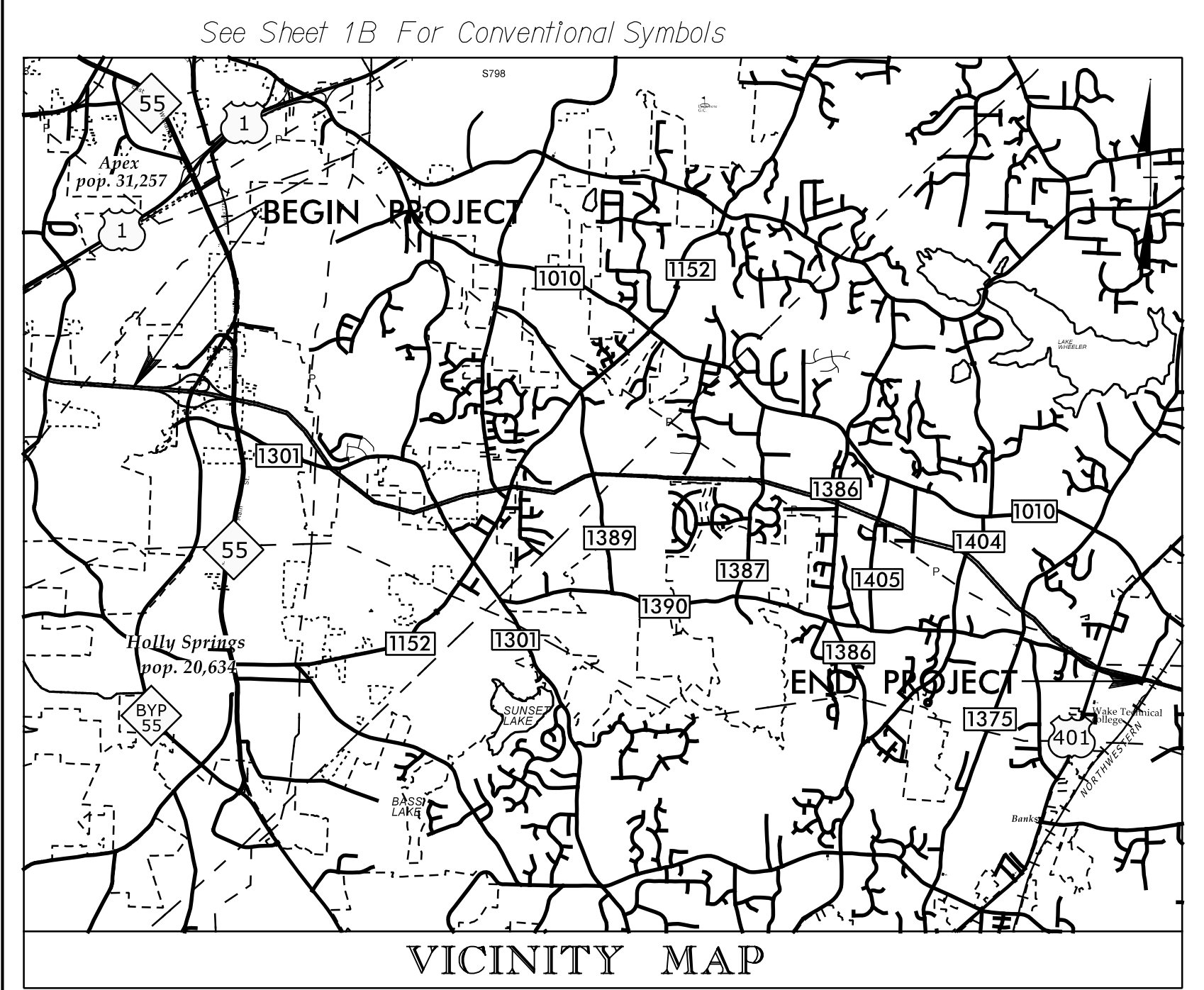

# WAKE COUNTY

LOCATION: COMPLETE 540 - FROM WEST OF NC55 TO EAST OF HWY 401

ENVIRONMENTAL PERMIT PLANS

TYPE OF WORK: GRADING, DRAINAGE, PAVING, AND STRUCTURES

25% SUBMITTAL

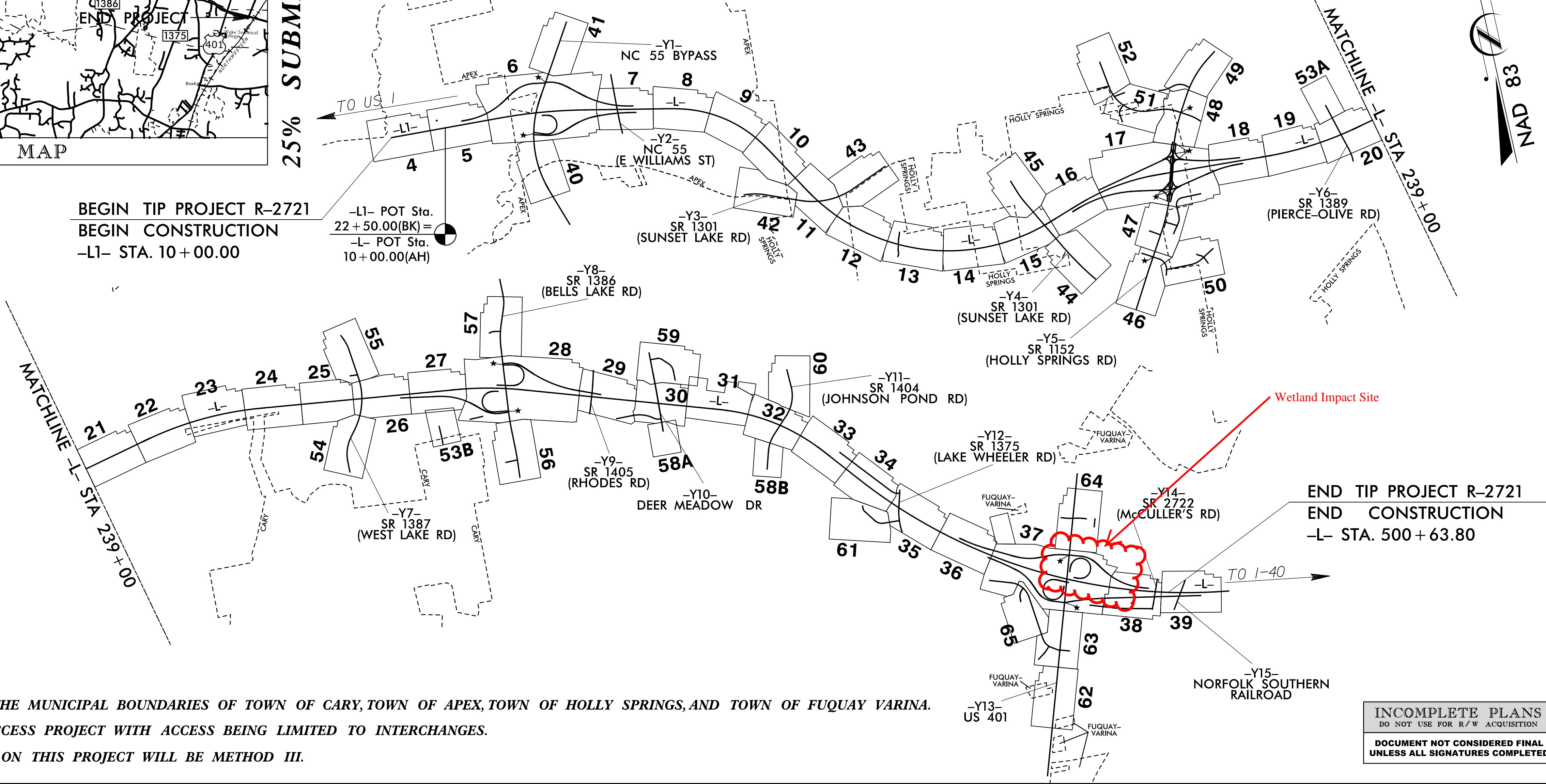

THIS PROJECT IS WITHIN THE MUNICIPAL BOUNDARIES OF TOWN OF CARY, TOWN OF APEX, TOWN OF HOLLY SPRINGS, AND TOWN OF FUQUAY VARINA.  
THIS IS A CONTROLLED ACCESS PROJECT WITH ACCESS BEING LIMITED TO INTERCHANGES.  
CLEARING AND GRUBBING ON THIS PROJECT WILL BE METHOD III.

INCOMPLETE PLANS  
DO NOT USE FOR R/W ACQUISITION  
DOCUMENT NOT CONSIDERED FINAL  
UNLESS ALL SIGNATURES COMPLETED

CONTRACT:

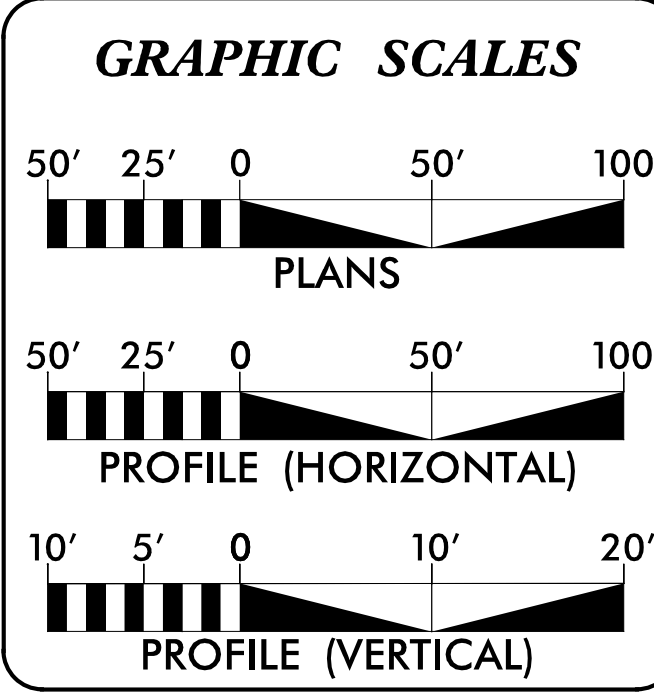

DESIGN DATA

ADT 2018 =	28,200
ADT 2040 =	66,400
K =	12 %
D =	65 %
T =	11 % *
V =	75 MPH
* TTST =	7% DUAL 4%
FUNC CLASS =	INTERSTATE

PROJECT LENGTH

LENGTH ROADWAY TIP PROJECT R-2721	= 9.529 Miles
LENGTH STRUCTURES	= 0.178 Miles
TOTAL LENGTH TIP PROJECT R-2721	= 9.351 Miles

Prepared in the Office of:

**LOCHNER**  
H. W. LOCHNER, INC.  
2840 PLAZA PLACE, SUITE 202  
RALEIGH, NC 27612  
(919) 571-7111

**ECOLOGICAL ENGINEERING**  
NC License Number F-0159

**SUNGATE DESIGN GROUP, P.A.**  
905 JONES FRANKLIN ROAD  
RALEIGH, NORTH CAROLINA 27606  
TEL (919) 859-2243 NC FIRM LICENSE NO. C-890

2018 STANDARD SPECIFICATIONS

RIGHT OF WAY DATE:  
February 18, 2020

LETTING DATE:  
February 18, 2020

Brian K. Eason, PE  
PROJECT ENGINEER

Christina L. Yokeley, EI  
PROJECT DESIGN ENGINEER

NC DOT CONTACT

HYDRAULICS ENGINEER

SIGNATURE: \_\_\_\_\_ P.E.

ROADWAY DESIGN ENGINEER

SIGNATURE: \_\_\_\_\_ P.E.

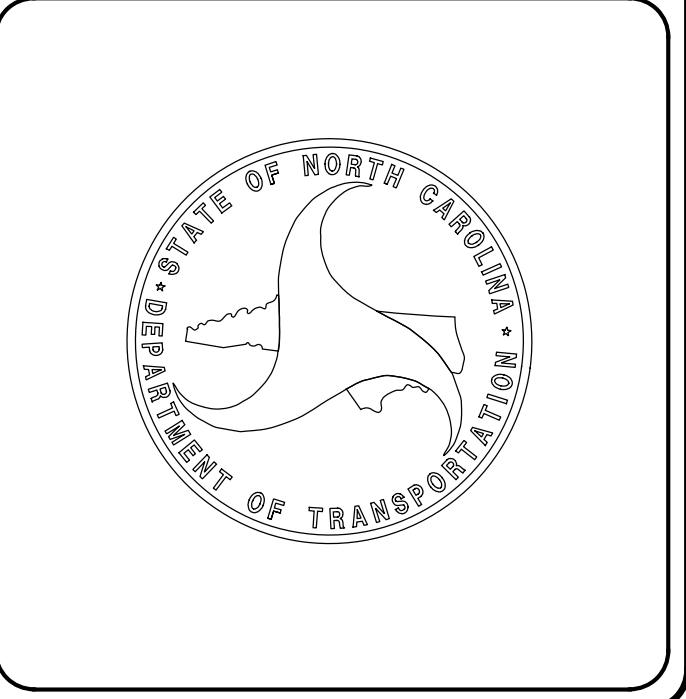



5/24/2018  
R2721L.RDY - TSH-01.dgn  
cyokeley

# WETLAND AND SURFACE WATER IMPACTS PERMIT

PROJECT REFERENCE NO. R-2721	SHEET NO. UE-03
DESIGNED BY: DRAWN BY: ABC	
CHECKED BY:	
APPROVED BY:	
REVISED: 08/15/18	
NORTH CAROLINA DEPARTMENT OF TRANSPORTATION	
UTILITIES ENGINEERING SEC. PHONE: (919) 707-6690 FAX: (919) 250-4151	UTILITY CONSTRUCTION PLANS ONLY

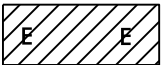
UTILITY CONSTRUCTION  
DOCUMENT NOT CONSIDERED FINAL  
UNLESS ALL SIGNATURES COMPLETED

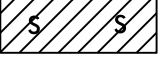
-  DENOTES EXCAVATION IN WETLAND
-  DENOTES MECHANIZED CLEARING
-  DENOTES IMPACTS IN SURFACE WATER

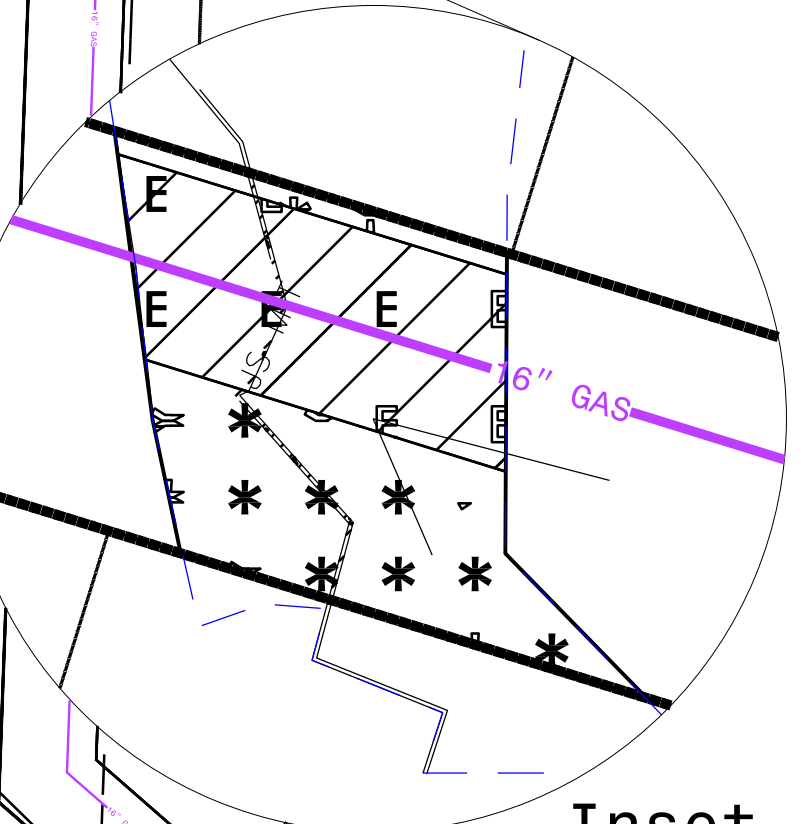
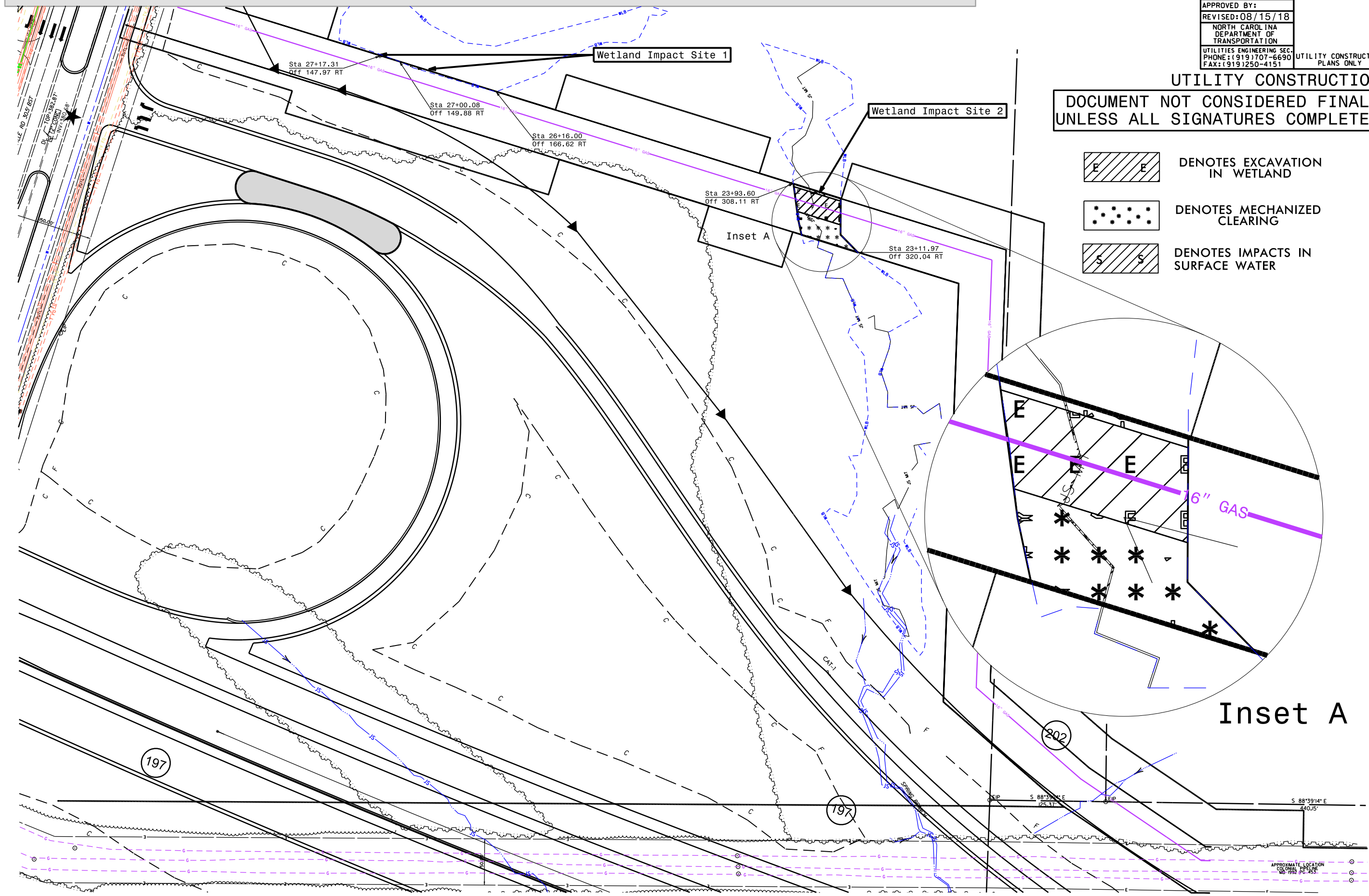

Inset A



5/14/99  
 23-AUG-2018 10:05 Narrative Revised\_R2721\_Ut\_UE\_WetlandImpacts.dgn  
 NEUN P 23-AUG-2018 10:05 Narrative Revised\_R2721\_Ut\_UE\_WetlandImpacts.dgn

APPROXIMATE LOCATION  
FOR FINAL FIGURE  
NO. 992 PG. 453

# WETLAND AND SURFACE WATER IMPACTS PERMIT

PROJECT REFERENCE NO. R-2721	SHEET NO. UE-03
DESIGNED BY: DRAWN BY: ABC	
CHECKED BY:	
APPROVED BY:	
REVISED: 08/15/18	
NORTH CAROLINA DEPARTMENT OF TRANSPORTATION	
UTILITIES ENGINEERING SEC. PHONE: (919) 707-6690 FAX: (919) 250-4151	UTILITY CONSTRUCTION PLANS ONLY

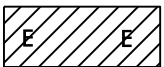
UTILITY CONSTRUCTION  
DOCUMENT NOT CONSIDERED FINAL  
UNLESS ALL SIGNATURES COMPLETED

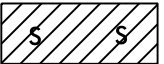
-  DENOTES EXCAVATION  
IN WETLAND
-  DENOTES MECHANIZED  
CLEARING
-  DENOTES IMPACTS IN  
SURFACE WATER

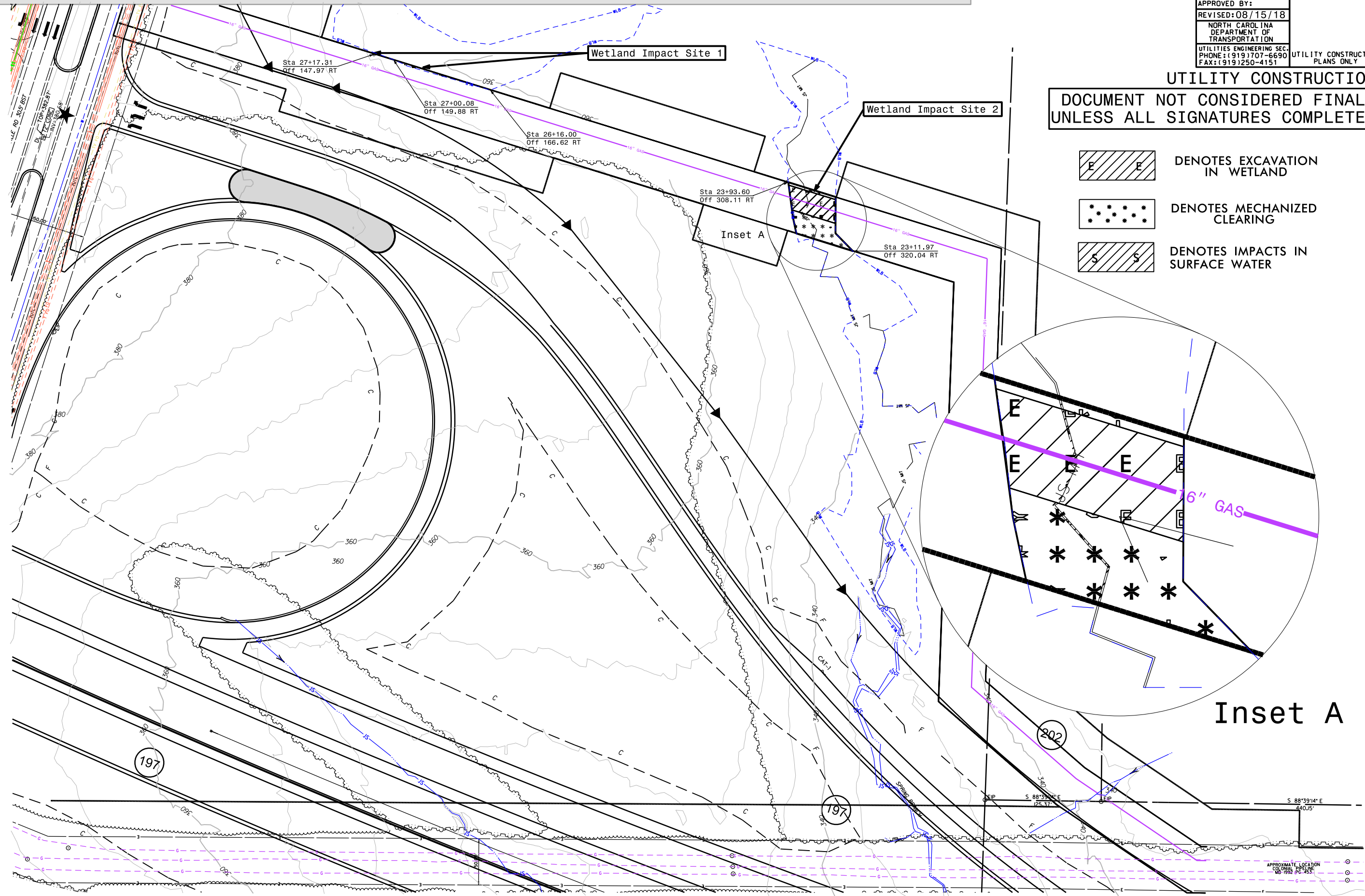

5/14/99

NEUN.P.23-AUG-2018 10:11 Narrative Revised\_R2721\_Ut\_UE\_WetlandImpacts.dgn

APPROXIMATE LOCATION  
FOR ORIGINAL SHEET  
NO. 992 PG. 453



**WETLAND PERMIT IMPACT SUMMARY**

Site No.	Station (From/To)	Structure Size / Type	WETLAND IMPACTS					SURFACE WATER IMPACTS				
			Permanent Fill In Wetlands (ac)	Temp. Fill In Wetlands (ac)	Excavation in Wetlands (ac)	Mechanized Clearing in Wetlands (ac)	Hand Clearing in Wetlands (ac)	Permanent SW impacts (ac)	Temp. SW impacts (ac)	Existing Channel Impacts Permanent (ft)	Existing Channel Impacts Temp. (ft)	Natural Stream Design (ft)
1a	-Y13RPA- Sta 27+17.31	Utility Relocation				<0.01						
1b	-Y13RPA- Sta 27+00.08 to -Y13RPA- Sta 26+16.00	Utility Relocation				<0.01						
2	-Y13RPA- Sta 23+93.60 to -Y13RPA- Sta 23+11.97	Utility Relocation			0.03	0.03					65	
<b>TOTALS*:</b>					0.03	0.04				0	65	0

\*Rounded totals are sum of actual impacts

NOTES:  
Site 1 is approximately 121 square feet (0.003 ac) of wetland being cleared and grubbed as part of a utility construction easement

NC DEPARTMENT OF TRANSPORTATION  
DIVISION OF HIGHWAYS

Wake County  
R-2721  
37673.1.2

SHEET 1 OF 4

09\_08/2018

STATE	STATE PROJECT REFERENCE NO.	SHEET NO.	TOTAL SHEETS
N.C.	R-2721	1	4
STATE PROJ. NO.	F.A. PROJ. NO.	DESCRIPTION	
6.401078	STP-540(19)	PE	

STATE OF NORTH CAROLINA  
DIVISION OF HIGHWAYS

# WAKE COUNTY

LOCATION: COMPLETE 540 - FROM WEST OF NC55 TO EAST OF HWY 401

TYPE OF WORK: GRADING, DRAINAGE, PAVING, AND STRUCTURES

**BUFFER CERTIFICATION PLANS**

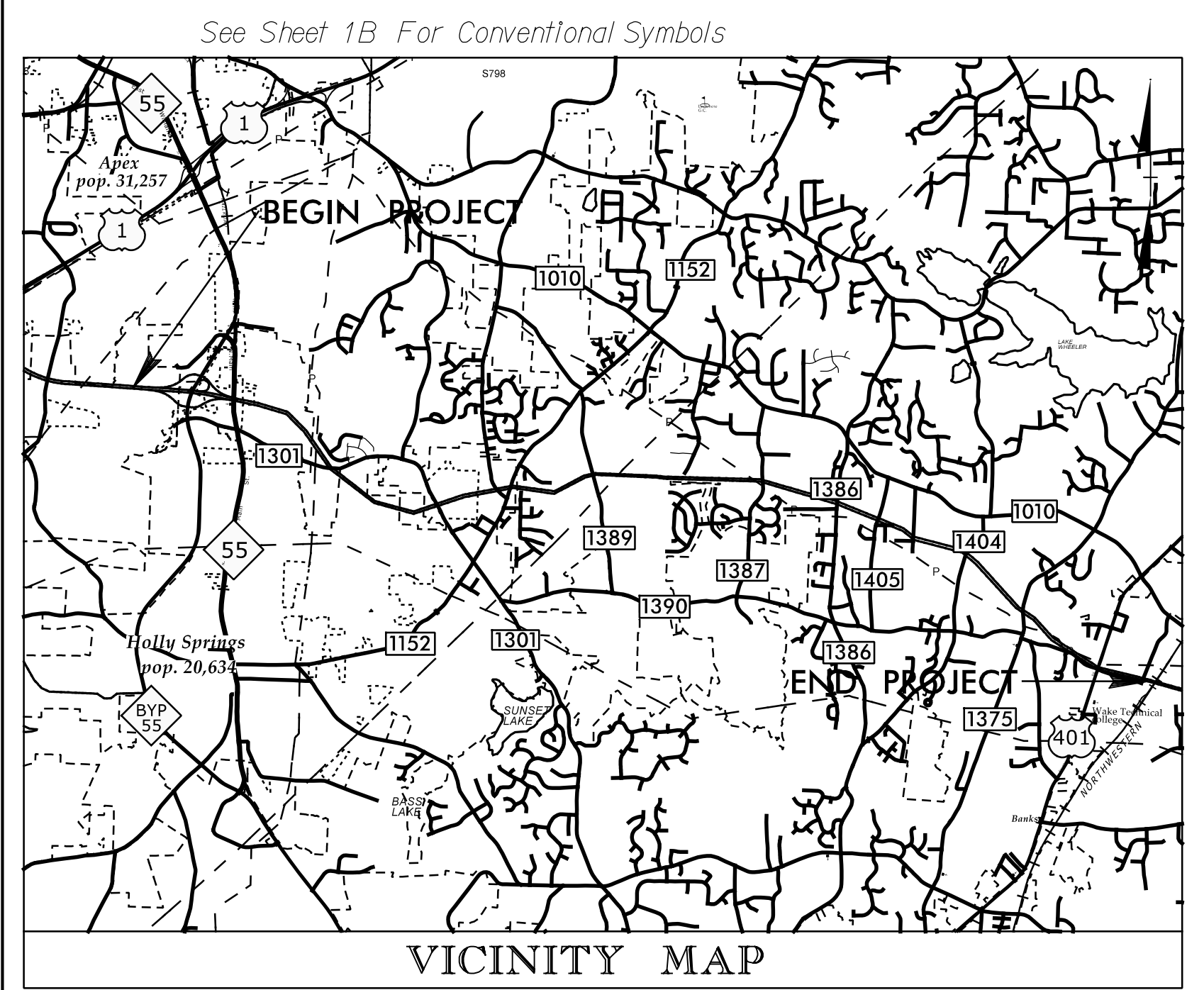

25% SUBMITTAL

TIP PROJECT: R-2721

BEGIN TIP PROJECT R-2721  
BEGIN CONSTRUCTION  
-L1- STA. 10+00.00

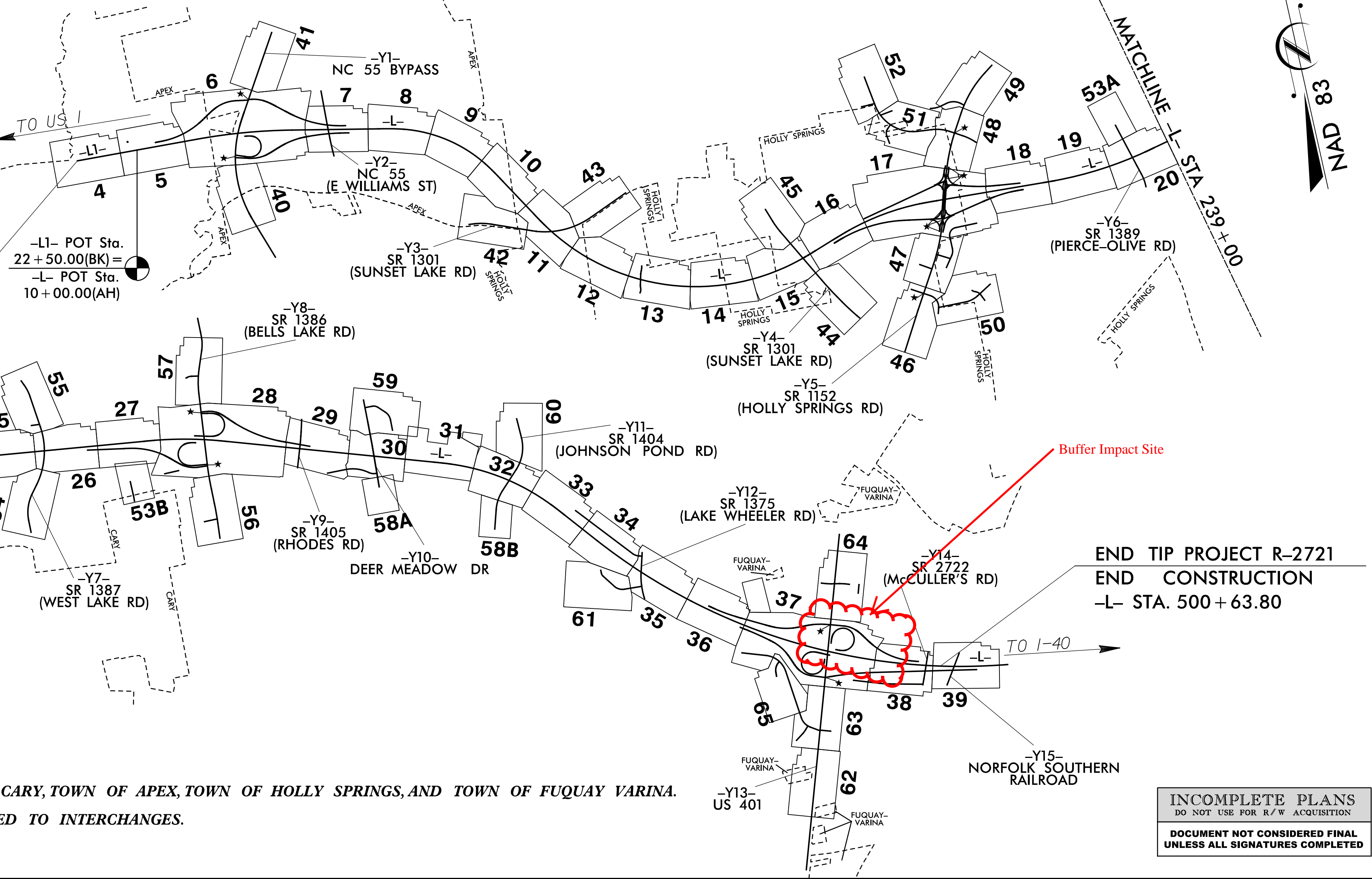

THIS PROJECT IS WITHIN THE MUNICIPAL BOUNDARIES OF TOWN OF CARY, TOWN OF APEX, TOWN OF HOLLY SPRINGS, AND TOWN OF FUQUAY VARINA.  
THIS IS A CONTROLLED ACCESS PROJECT WITH ACCESS BEING LIMITED TO INTERCHANGES.  
CLEARING AND GRUBBING ON THIS PROJECT WILL BE METHOD III.

INCOMPLETE PLANS  
DO NOT USE FOR R/W ACQUISITION  
DOCUMENT NOT CONSIDERED FINAL  
UNLESS ALL SIGNATURES COMPLETED

CONTRACT:

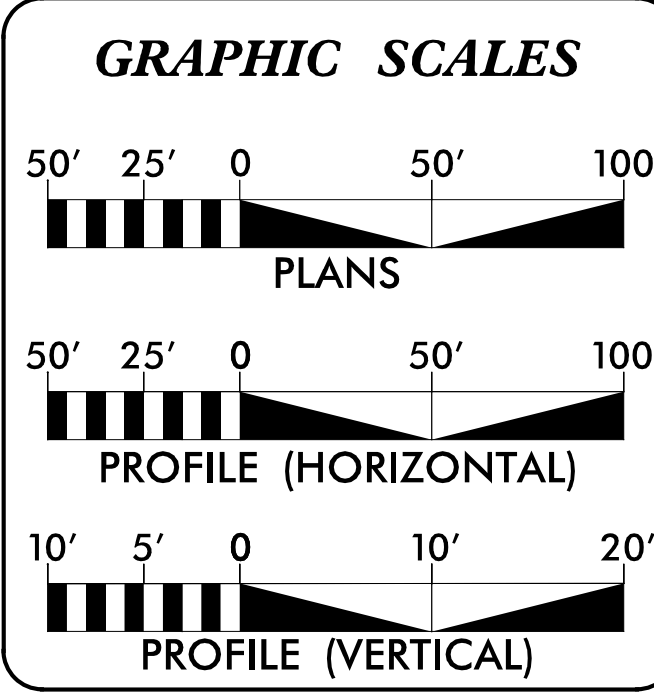

DESIGN DATA

ADT 2018 =	28,200
ADT 2040 =	66,400
K =	12 %
D =	65 %
T =	11 % *
V =	75 MPH
* TTST =	7% DUAL 4%
FUNC CLASS =	INTERSTATE

PROJECT LENGTH

LENGTH ROADWAY TIP PROJECT R-2721	= 9.529 Miles
LENGTH STRUCTURES	= 0.178 Miles
TOTAL LENGTH TIP PROJECT R-2721	= 9.351 Miles

Prepared in the Office of:

**LOCHNER**  
H. W. LOCHNER, INC.  
2840 PLAZA PLACE, SUITE 202  
RALEIGH, NC 27612  
(919) 571-7111

**ECOLOGICAL ENGINEERING**  
NC License Number F-0159

**SUNGATE DESIGN GROUP, P.A.**  
905 JONES FRANKLIN ROAD  
RALEIGH, NORTH CAROLINA 27606  
TEL (919) 859-2243 NC FIRM LICENSE NO. C-890

2018 STANDARD SPECIFICATIONS

RIGHT OF WAY DATE:  
February 18, 2020

LETTING DATE:  
February 18, 2020

NC DOT CONTACT

HYDRAULICS ENGINEER

SIGNATURE: \_\_\_\_\_ P.E.

ROADWAY DESIGN ENGINEER

SIGNATURE: \_\_\_\_\_ P.E.

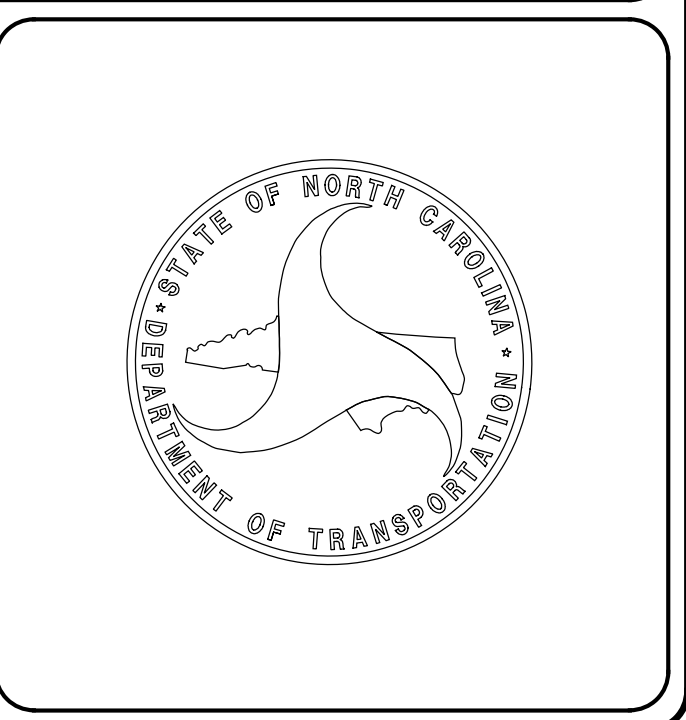

5/24/2018  
R2721.RDY - TSH-01.dgn  
cyokeley

# BUFFER IMPACTS PERMIT

PROJECT REFERENCE NO. R-2721	SHEET NO. UE-02
DESIGNED BY: DRAWN BY: ABC	
CHECKED BY:	
APPROVED BY:	
REVISED: 08/21/18	
NORTH CAROLINA DEPARTMENT OF TRANSPORTATION	
UTILITIES ENGINEERING SEC. PHONE: (919) 707-6690 FAX: (919) 250-4151	UTILITY CONSTRUCTION PLANS ONLY

## UTILITY CONSTRUCTION

**DOCUMENT NOT CONSIDERED FINAL  
UNLESS ALL SIGNATURES COMPLETED**



MITIGABLE IMPACTS ZONE 1



ALLOWABLE IMPACTS ZONE 2

Utility Buffer Impact  
Site 2

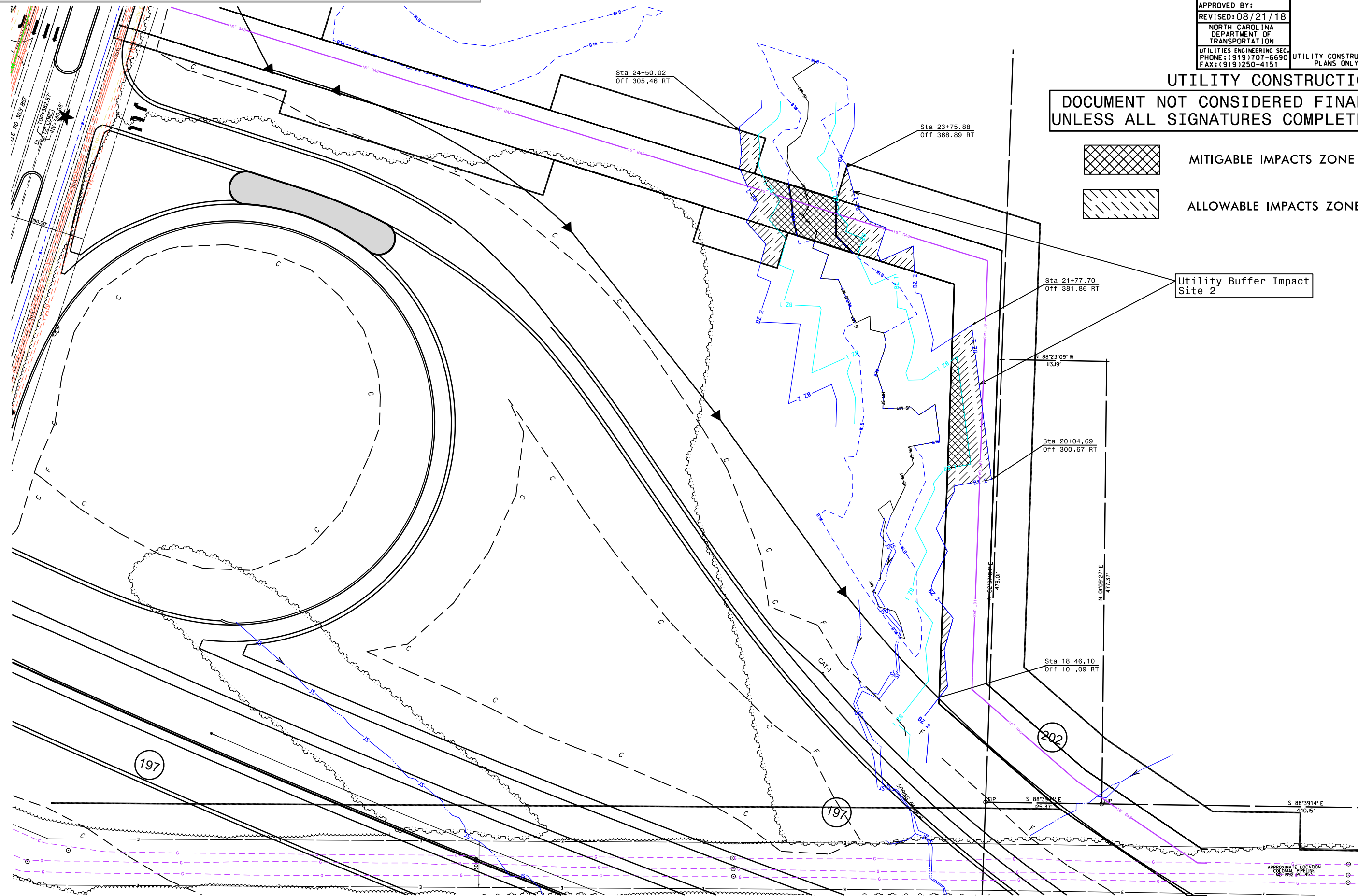

5/14/99  
 22-AUG-2018 08:47 Narrative Revised.R2721.Ut\_UE\_Buffer\_Impacts.dgn  
 NEUN

APPROXIMATE LOCATION  
FOR ORIGINAL PLAN  
NO. 992 PG. 453

## BUFFER IMPACTS SUMMARY

			IMPACT									BUFFER REPLACEMENT	
SITE NO.	STRUCTURE SIZE / TYPE	STATION (FROM/TO)	TYPE			ALLOWABLE			MITIGABLE			ZONE 1 (ft <sup>2</sup> )	ZONE 2 (ft <sup>2</sup> )
			ROAD CROSSING	BRIDGE	PARALLEL IMPACT	ZONE 1 (ft <sup>2</sup> )	ZONE 2 (ft <sup>2</sup> )	TOTAL (ft <sup>2</sup> )	ZONE 1 (ft <sup>2</sup> )	ZONE 2 (ft <sup>2</sup> )	TOTAL (ft <sup>2</sup> )		
2*	Utility Relocation	**-Y13RPA- Sta 24+50.02			X		10323		4333				
		-Y13RPA- Sta 18+46.10											
<b>TOTAL:</b>							10323		4333				

There are no buffer impacts at Site 1 (Permit Plans)

\*All impacts are considered non-perpendicular crossings.

\*\*This pipeline crossing is proposed to cross the stream at approximately 64 degrees.

N.C. DEPT. OF TRANSPORTATION  
DIVISION OF HIGHWAYS

Wake COUNTY  
PROJECT: 37673.1.2 (R-2721)

8/21/2018  
SHEET 3 OF 4

## WETLANDS IN BUFFER IMPACTS SUMMARY

SITE NO.	STATION (FROM/TO)		WETLANDS IN BUFFERS	
			ZONE 1 (ft <sup>2</sup> )	ZONE 2 (ft <sup>2</sup> )
2	-Y13RPA- Sta 23+93.58	-Y13RPA- Sta 23+12.17	2590	0
<b>TOTAL:</b>			2590	0

There are no buffer impacts at Site 1 (Permit Plans)

N.C. DEPT. OF TRANSPORTATION  
DIVISION OF HIGHWAYS

WAKE COUNTY  
PROJECT: 37673.1.2 (R-2721)

8/21/2018  
SHEET 4 OF 4