

Project Submittal Interim Form



Updated September 4, 2020

*Please note: fields marked with a red asterisk * below are required. You will not be able to submit the form until all mandatory questions are answered.*

Project Type: *

- ☐ For the Record Only (Courtesy Copy)
- ☐ New Project
- ☒ Modification/New Project with Existing ID
- ☐ More Information Response
- ☐ Other Agency Comments
- ☐ Pre-Application Submittal
- ☐ Re-Issuance/Renewal Request
- ☐ Stream or Buffer Appeal

Project Contact Information

Name: Gordon Cashin
Who is submitting the information?

Email Address: * gcashin@ncdot.gov

Project Information

Existing ID #: *

20200220
20170001 (no dashes)

Existing Version: *

2
1

Project Name: * Bridge No. 87 on NC 33 over Norfolk Southern Railroad, (B-5301 Central)

Is this a public transportation project? *

- ☒ Yes
- ☐ No

Is this a DOT project? *

- ☒ Yes
- ☐ No

Is the project located within a NC DCM Area of Environmental Concern (AEC)? *

☐ Yes ☒ No ☐ Unknown

TIP#:

B-5301

WBS#:

46015.1.1

(Applies to DOT projects only)

County (ies) *

Pitt

Please upload all files that need to be submitted.

[Click the upload button or drag and drop files here to attach document](#)

B-5301 General Modification Pitt January 19

1.87MB

2022.pdf

[Only pdf or kmz files are accepted.](#)

Describe the attachments or add comments:

The project now involves utility impacts not anticipated in the original application, which are explained in the attached narrative and utility drawings. This will involve an additional 0.021 acre of permanent impact as an area permitted as hand clearing will be excavated. See call out box on permit drawing (sheet 2 of 2) depicting new proposed impacts in relation to previously permitted impacts for mechanized clearing and hand clearing.

An additional 0.04 acre of mitigation will be debited from the Mildred Woods Mitigation Site to account for these impacts.

* ☒ By checking the box and signing box below, I certify that:

- I, the project proponent, hereby certifies that all information contained herein is true, accurate, and complete to the best of my knowledge and belief.
- I, the project proponent, hereby requests that the certifying authority review and take action on this CWA 401 certification request within the applicable reasonable period of time.
- I agree that submission of this online form is a "transaction" subject to Chapter 66, Article 40 of the NC General Statutes (the "Uniform Electronic Transactions Act");
- I agree to conduct this transaction by electronic means pursuant to Chapter 66, Article 40 of the NC General Statutes (the "Uniform Electronic Transactions Act");
- I understand that an electronic signature has the same legal effect and can be enforced in the same way as a written signature; AND
- I intend to electronically sign and submit the online form.

Signature: *



Submittal Date:

1/19/2022

[Is filled in automatically once submitted.](#)

Mildred Woods Mitigation Site
ONEID 033-001

The Mildred Woods Mitigation Site is located in Edgecombe County within the USGS hydrologic unit 03020103 of the Pamlico River. NCDOT acquired the 598.31 acre site to mitigate for unavoidable, jurisdictional impacts associated with TIP R-2111/R-2112A. Monitoring requirements were performed from 1996 to 2003 and the site was closed out in 2005. The 2002 Monitoring Report and Closeout Letters state that there is a total of 379.1 acres of total wetlands on the site. NCDOT sent EEP numbers based off of a starting amount of 369 acres of restoration and 23 acres of preservation. However, these should have been a starting amount of 356.1 acres of restoration and 23 acres of preservation. Table 1 shows the final mitigation quantities approved for the site. The site has been placed on the NCDOT On-site Debit Ledger for use within HUC 03020103. Tables 2-3 indicate all mitigation debits that have occurred per regulatory agency approval.

In order to offset unavoidable impacts associated with B-5301, NCDOT will be debiting the onsite debit ledger 0.75 acres from Mildred Woods mitigation site to cover the impacts associated with this project.

Table 1. Mitigation Quantities Approved

HUC	Mitigation Type	Starting Amount (Ac.)	Additional Notes
3020103	Non-Riparian Restoration	356.1	
3020103	Non-Riparian Preservation	23	

Table 2. Mitigation Debits – Non-Riparian Restoration

TYPE	DEBITAMOUNT	Status	SITE TIP	Action ID#	Notes
NRW_REST	-100	Close Out	EEP		EEP ledger indicates that 100 acres were transferred from EEP to NCDOT
NRW_REST	0	Close Out	Alterations		Issues with hydrology during monitoring were resolved at closeout says Jim Hauser. Was originally 23.5 ac
NRW_REST	0	Close Out	B-4020	2007-04084	Was originally 0.46 acres. But the mitigation was not needed due to a reduction in impacts for B-4020. The on-site restoration at Tranters Creek was sufficient to cover the impacts.
NRW_REST	0	Close Out	B-4021	2007-04082	Was originally 0.25 acres. But EEP will provide mitigation for impacts to 0.124 acres of riverine wetlands.
NRW_REST	1.86	Close Out	U-3826	2009-00101	0.62 acres @ 3:1

TYPE	DEBITAMOUNT	Status	SITE TIP	Action ID#	Notes
NRW_REST	9.2	Close Out	P-3309AB	2008-01789	4.62 acres @ 2:1
NRW_REST	23	Close Out	R-2112B	199601404	
NRW_REST	116.1	Close Out	EEP		Credits Transferred to EEP
NRW_REST	217	Close Out	R-2111, & R-2112A	199400662	
NRW_REST	1.54	Close Out	B-5301		0.04 acres was added due to utility impacts

Table 3. Mitigation Debits – Non-Riparian Preservation

TYPE	DEBITAMOUNT	Status	SITE TIP	Action ID#	Notes
NRW_PRES	8	Close Out	EEP		Credits Transferred to EEP
NRW_PRES	15	Close Out	R-2112B	199601404	

Date: 18 January 2022
TIP Number: B-5301
County: Pitt
Description: Bridge No. 87 over Norfolk Southern Railroad on NC 33

B-5301 NEU Environmental Permit Narrative

This roadway project impacts wetlands on NC33.

Duke Energy (Power)

Has no wetland impacts.

Centurylink (Communication)

Has no wetland impacts.

Town of Grimesland (Sewer)

The Town of Grimesland will replace their existing sewer system along the north side of NC 33. The railroad crossing will be core and jack with a launch pit located in the wetlands. There will be approximately 0.03 acres of excavation for the bore pit and 0.02 acres of temporary fill. To minimize wetland impact the wetland crossing will utilize the same launch pit and directional drill to a receiving pit outside the wetland area. (See sheet UE-4).

Town of Grimesland Contact: Lee Latham llatham@embarqmail.com 252-752-6337

09/08/2015

TIP PROJECT: B-5301

See Sheet 1A For Index of Sheets
See Sheet 1B For Conventional symbols
See Sheet 1C For Survey Control Sheet

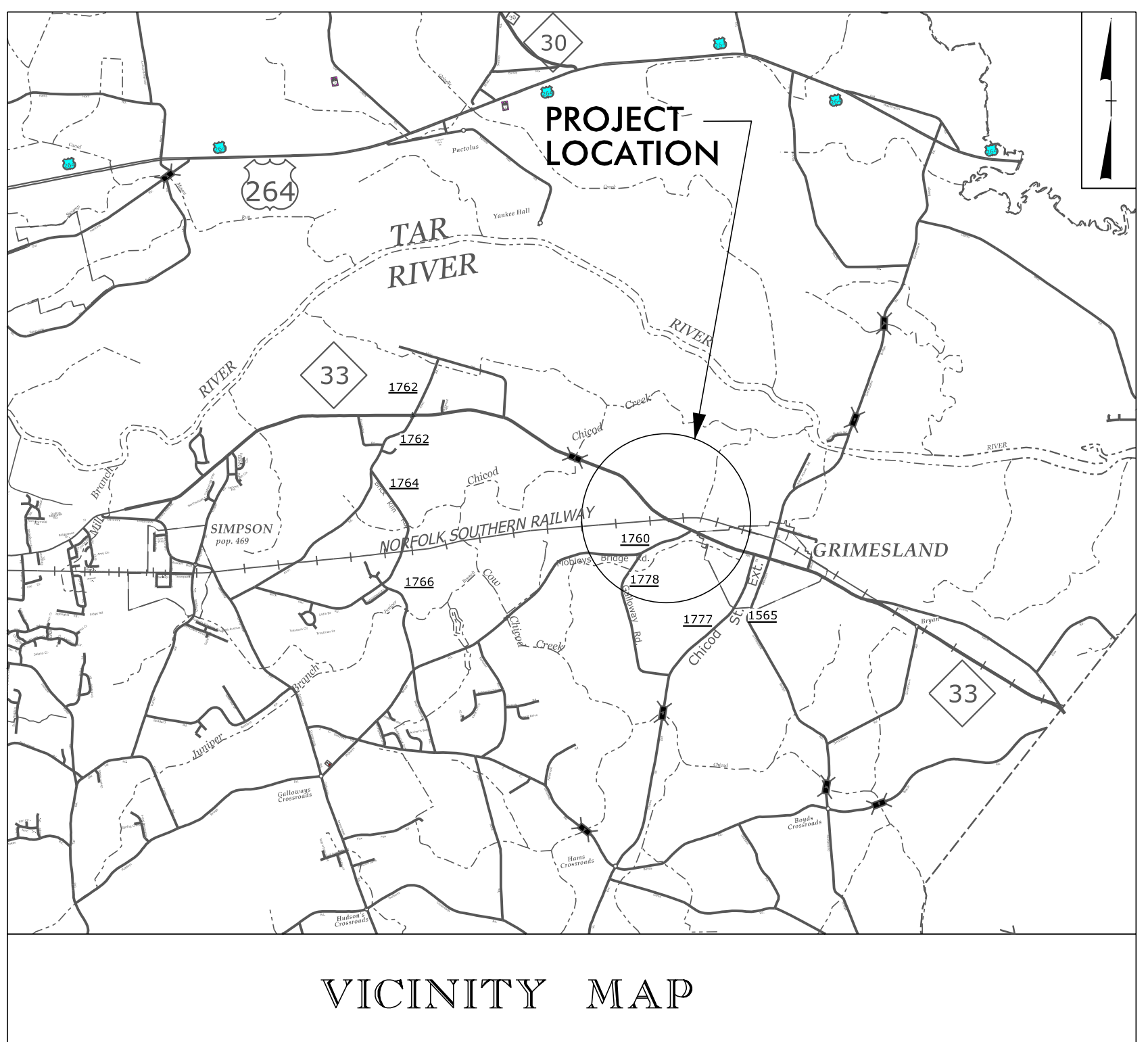

VICINITY MAP

STATE OF NORTH CAROLINA
DIVISION OF HIGHWAYS

UTILITY PERMIT DRAWINGS
PITT COUNTY

LOCATION: BRIDGE NO. 87 OVER NORFOLK SOUTHERN
RAILROAD ON NC 33

WETLAND IMPACTS

T.I.P. NO.	SHEET NO.
B-5301	UE-1
WETLAND IMPACT DRAWING SHEET 1 OF 2 UTILITIES	

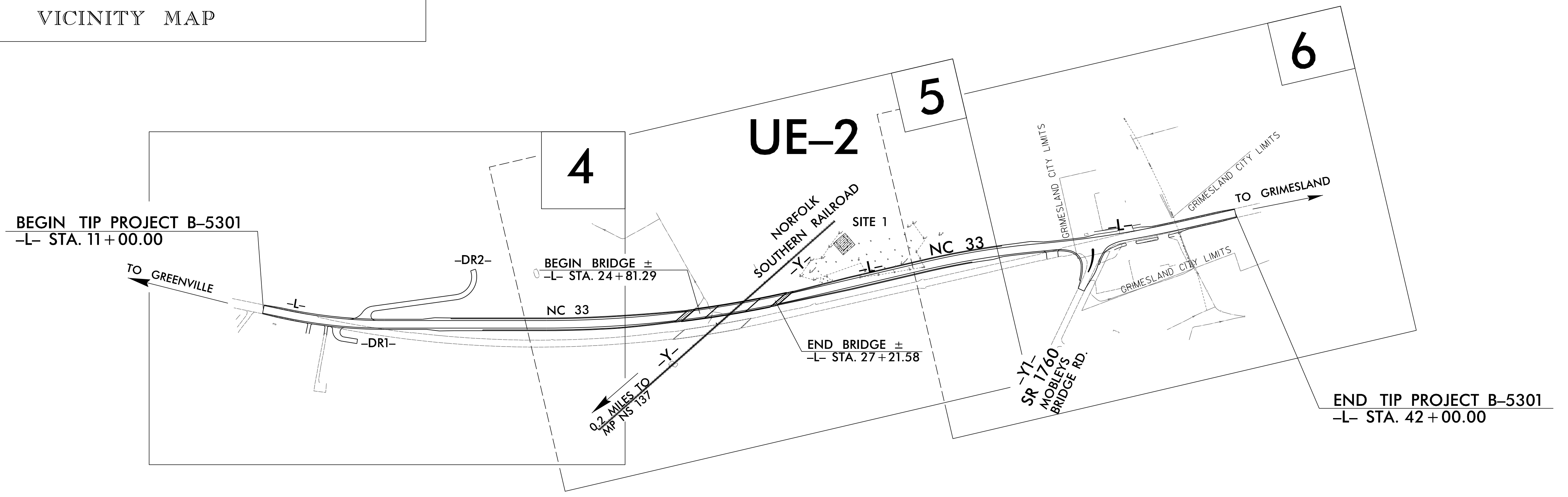
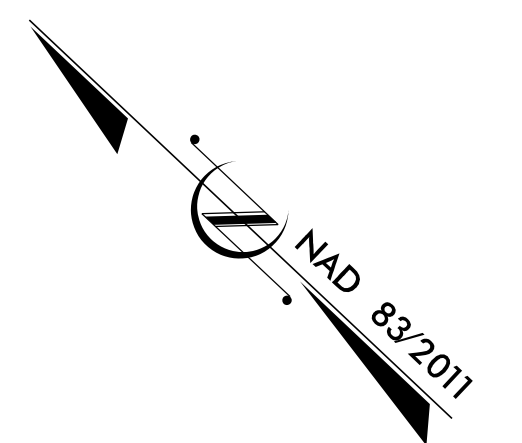

GRAPHIC SCALES

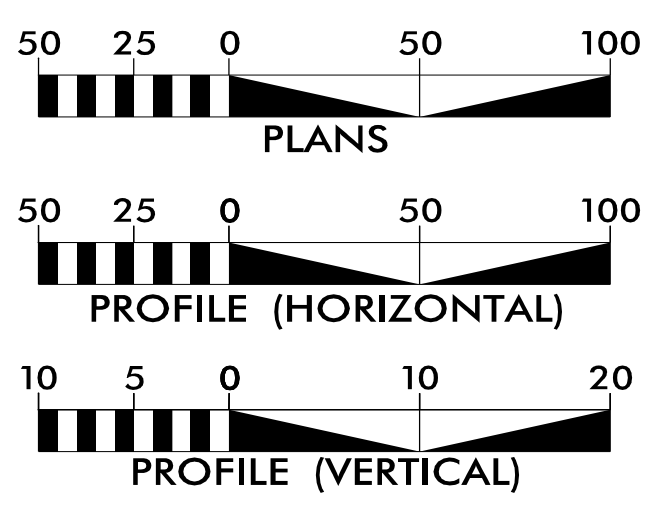

INDEX OF SHEETS

SHEET NO.:	DESCRIPTION:
UE-1	WETLAND IMPACT TITLE SHEET
UE-2	UTILITY WETLAND IMPACTS

PREPARED IN THE OFFICE OF:

WETHERILL ENGINEERING

1223 Jones Franklin Rd.
Raleigh, N.C. 27606
License No. F-0377
Bus: 919 851 8077
Fax: 919 851 8107

TRANSPORTATION PLANNING/DESIGN - BRIDGE/STRUCTURE DESIGN
CIVIL/SITE DESIGN - GIS/GPS - CONSTRUCTION OBSERVATION

John D. Schriener, PLS UTILITY PROJECT MANAGER
John D. Schriener, PLS PROJECT UTILITY COORDINATOR

**DIVISION OF HIGHWAYS
UTILITIES UNIT**
1555 MAIL SERVICES CENTER
RALEIGH NC 27699-1555
PHONE (919) 707-5690
FAX (919) 250-4151

Bo Hemphill, PE UTILITIES REGIONAL ENGINEER
Kelvin Martin UTILITIES ENGINEER
Tanga Sampson UTILITIES AREA COORDINATOR
UTILITIES COORDINATOR

UTILITIES BY OTHERS

ALL PROPOSED UTILITY WORK SHOWN ON THIS SHEET WILL BE DONE BY OTHERS. NO PAYMENT WILL BE MADE TO THE CONTRACTOR FOR PROPOSED UTILITY WORK SHOWN ON THIS SHEET.

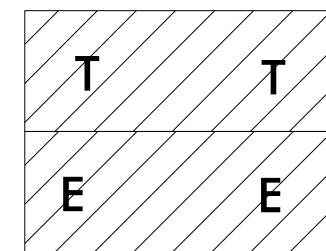

DENOTES TEMPORARY
FILL IN WETLAND
DENOTES EXCAVATION
IN WETLAND

WETLAND IMPACT
DRAWING
SHEET 2 OF 2
UTILITIES

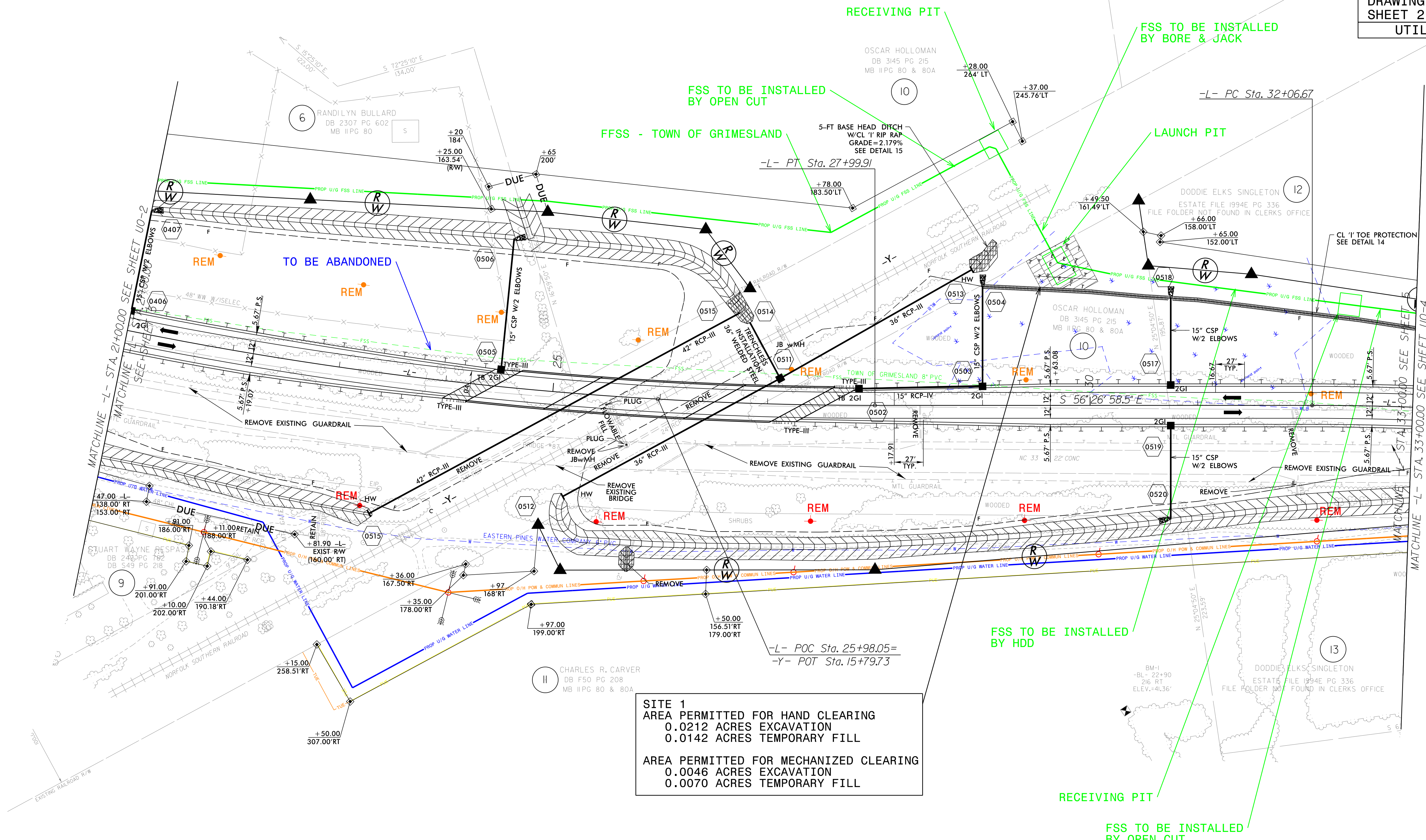

SITE 1
AREA PERMITTED FOR HAND CLEARING
0.0212 ACRES EXCAVATION
0.0142 ACRES TEMPORARY FILL
AREA PERMITTED FOR MECHANIZED CLEARING
0.0046 ACRES EXCAVATION
0.0070 ACRES TEMPORARY FILL

5/14/99
2:53:14 PM
C:\Users\NE\OneDrive\Plans and Narrative\B-5301\ut-rdy5-UE4-psd.dgn

UTILITY WETLAND IMPACTS SUMMARY												
			WETLAND IMPACTS					SURFACE WATER IMPACTS				
Site No.	Station (From/To)	Structure Size / Type	Permanent Fill In Wetlands (ac)	Temp. Fill In Wetlands (ac)	Excavation in Wetlands (ac)	Mechanized Clearing in Wetlands (ac)	Hand Clearing in Wetlands (ac)	Permanent SW impacts (ac)	Temp. SW impacts (ac)	Existing Channel Impacts Permanent (ft)	Existing Channel Impacts Temp. (ft)	Natural Stream Design (ft)
1	29+40 to 30+08	Sewer (Hand Clearing)		0.01	0.02							
1	29+40 to 30+10	Sewer (Mechanized clearing)		0.01	0.01							
TOTALS:				0.02	0.03		0.00					

Note: Clearing for utility relocation will not exceed the current clear zone being maintained for the existing utilities.

NC DEPARTMENT OF TRANSPORTATION
DIVISION OF HIGHWAYS

PITT COUNTIES
WBS - 46015.2.1 (B-5301)

SHEET 1 OF 1 18-Jan-22