



STATE OF NORTH CAROLINA  
DEPARTMENT OF TRANSPORTATION

MICHAEL F. EASLEY  
GOVERNOR

LYNDO TIPPETT  
SECRETARY

April 21, 2005

U. S. Army Corps of Engineers  
Regulatory Field Office  
151 Patton Avenue Room 208  
Asheville, NC 28801-5006

ATTN: Ms. Angie Pennock  
NCDOT Coordinator

Dear Madam:

Subject: **Individual Permit Modification Request for Action ID. 200430567, Project R-2813C, Widening of NC 146 (Long Shoals Road) between Interstate 26 and US Highway 25 (Hendersonville Road), south of Asheville, Buncombe County, North Carolina.**

Please reference the original Individual Permit (Action ID 200430567) and subsequent permit Modification dated January 25, 2005. In the original permit modification, it was stated that the finger to Lake Julian, approximately 1.324 acres in size, would need to be temporarily dewatered to repair and extend a 42-inch damaged pipe. This de-watering is no longer necessary. Construction methods at Site 2 have also changed. This modification describes the construction methods, which will result in the reduction of temporary impacts at both sites.

**Impacts at Site 1**

The application to extend the submerged pipe located at site 1 originally requested the temporary de-watering of Lake Julian and construction of a temporary impervious dike. NCDOT now proposes the following construction methods:

Rock fill will be placed on the east end of the finger of Lake Julian. Using this rock as a work pad, the bore and jack equipment can then be used to install the two 48-inch steel pipes. Once the two 48-inch pipes are in place, a plug will be used on the Lake Julian side to stop the flow of water through the damaged pipe rather than constructing an impervious dike. The rock will then be extended from the east side, isolating an area for equipment to repair the damaged pipe. Sheet piles may have to be used temporarily if the voids in the rock allow water to flow through. The water in this isolated area will be pumped through a silt bag and returned to the finger of Lake Julian. Any fish that are in this isolated area will also be relocated to the Finger of Lake Julian.

## Impacts at Site 2

After reviewing installation methods for the previously permitted 8x10-foot culvert at Site 2, it has been determined that the temporary impervious dike on the Lake Julian side is not feasible. A plug will be used to stop the flow through the culvert during construction of the extension. Prior to the insertion of this plug, the previously permitted 48-inch steel pipe will be installed to accommodate flow.

## Contingencies

At this time, NCDOT and their contractors feel the methods described above (from the April 19, 2005 field meeting) are the most appropriate to build these structures. However, if these methods fail to produce the conditions necessary to allow for the dry and safe construction of these structures, NCDOT may request to revert back to the original plan of de-watering the section of Lake Julian north of Long Shoals Road at Site 1. NCDOT will notify the Army Corps of Engineers and Division of Water Quality if this becomes necessary.

## Regulatory Approvals

Attached for your information are permit drawings for the subject project. Application is hereby made for a Department of the Army for a Section 404 Individual Permit Modification and a Section 401 Water Quality Certification for the above described activities. In compliance with Section 143-215.3D(e) of the NCAC we will provide \$475.00 to act as payment for processing the Section 401 permit application previously noted in this application (see Subject line). We are providing seven copies of this application to the North Carolina Department of Environment and Natural Resources, Division of Water Quality.

A copy of this permit application will be posted on the DOT website at:  
<http://www.ncdot.org/planning/pe/naturalunit/Permit.html>.

If you have any questions or need additional information, please contact Mr. Michael Turchy at (919) 715-1468.

Sincerely,

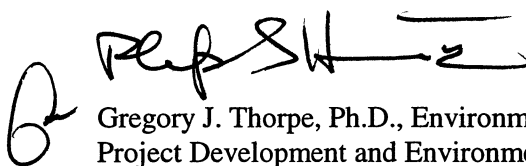

Gregory J. Thorpe, Ph.D., Environmental Management Director  
Project Development and Environmental Analysis Branch

W/attachment

Mr. John Hennessy, Division of Water Quality (7 copies)  
Ms. Marella Buncick, USFWS  
Ms. Marla Chambers, NCWRC  
Ms. Becky Fox, USEPA-Whitter, NC  
Mr. Ronald Mikulak, USEPA – Atlanta, GA  
Mr. Harold Draper, TVA  
Mr. David Chang, P.E., Hydraulics  
Mr. Greg Perfetti, P.E., Structure Design  
Mr. J. J. Swain, P.E., Division Engineer  
Mr. Roger Bryan, DEO

W/o attachment

Mr. Jay Bennett, P.E., Roadway Design  
Mr. Omar Sultan, Programming and TIP  
Mr. Art McMillan, P.E., Highway Design  
Mr. Mark Staley, Roadside Environmental  
Mr. David Franklin, USACE, Wilmington  
Ms. Jackie Obediente, Project Planning Engineer

PROJECT REFERENCE NO. R-2813C  
 R/W SHEET NO. HYDRAULICS  
 ROADWAY DESIGN ENGINEER  
 METRIX

CONST. REV.  
 R/W REV.

SCALE: 1" = 10'

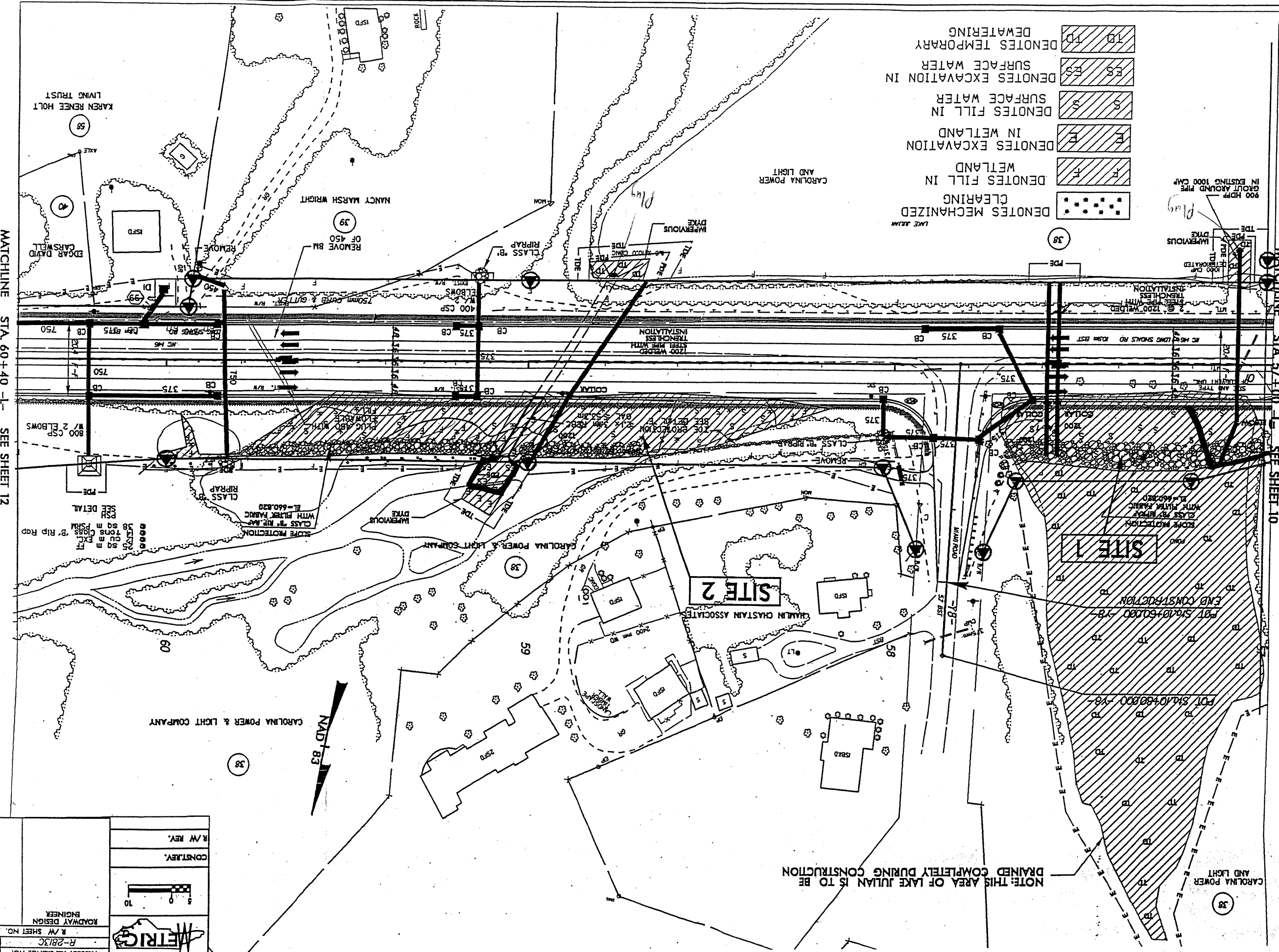

- DENOTES MECHANIZED CLEARING
- DENOTES FILL IN WETLAND
- DENOTES EXCAVATION IN WETLAND
- DENOTES FILL IN SURFACE WATER
- DENOTES EXCAVATION IN SURFACE WATER
- DENOTES TEMPORARY DEMATERING

NOTE: THIS AREA OF LAKE JULIAN IS TO BE DRAINED COMPLETELY DURING CONSTRUCTION

R/W REVISION, ADDED TCE ON PARCEL 38 W/ B 6/28/04  
 REVISIONS

MATCHLINE STA. 60+40 L- SEE SHEET 12

MATCHLINE STA. 57+00 L- SEE SHEET 10