



STATE OF NORTH CAROLINA
DEPARTMENT OF TRANSPORTATION

MICHAEL F. EASLEY
GOVERNOR

LYNDO TIPPETT
SECRETARY

August 5, 2008

U.S. Army Corps of Engineers
Regulatory Field Office
Post Office Box 1000
Washington, NC 27889-1000

Attn: Mr. William Wescott
NCDOT Coordinator

Dear Sir:

Subject: Revised Application for Individual Section 404 and 401 Permits and Neuse Riparian Buffer Authorization for the construction of the southern section of Crescent Road from US 70 to US 258 in Lenoir County, west of Kinston. State Project No. 8.2200101. Federal Aid Project Number STP-224(3). TIP No. R-2719A., WBS 34501.1.1.

Reference: Application for Individual Section 404 and 401 Permits and Neuse Riparian Buffer Authorization dated February 15, 2008

The purpose of this letter is to provide a revision to the application for a Section 404 Individual Permit, Section 401 Water Quality Certification, and Neuse Riparian Buffer Authorization. In addition to the cover letter this application package includes the following: revised permit drawings, a set of revised half size roadway plans, and a revised mitigation plan.

This revision describes the changes in the wetlands impacts due to the outcome of the reverification of the wetlands; also to describe the design change at the railroad crossing. NCDOT redelineated wetlands, due to the expiration of the jurisdictional determination. Several of the wetland lines were shifted as a result of this redelineation. Permit sites 8, 9, 10, 14, and 16 were changed and were verified by William Wescott with the USACE on March 6, 2008.

The design of the project at the railroad crossing has changed, but will not affect the jurisdictional impacts. The railroad grade separation at approximate Station 85+98 was redesigned to provide 24-foot clearance over the railroad. This was accommodated by providing girders with less depth. An additional design change shortened the bridge length by adding retaining walls; thus end fill slopes were eliminated. The revised plans for changes associated with the railroad revisions will be provided as soon as they become available.

The rest of the referenced permit application that was submitted February 15, 2008 remains accurate.

The revised wetland and design will not change the existing permit application with respect to:

- Protected Species
- FEMA compliance
- Cultural Resources
- Avoidance and Minimization

Summary of Impacts

Waters of the U.S.: Revised impacts to jurisdictional areas total 12.05 acres of permanent wetland impacts and 2,363 linear feet of permanent stream impacts. Of these impacts 2.7 acre are in riparian wetlands and 9.35 are in non-riparian wetlands.

Temporary Impacts: There will be 1,227 feet of temporary impacts in surface waters. Proposed temporary impacts to wetlands of 0.35 acres of Temporary Fill in Wetlands in the Hand Clearing areas for the installation of erosion control measures, including some or all of the following: Temporary Silt Fence, Special Sediment Control Fence, and Temporary Rock Silt Checks.

Hand Clearing: There will be 1.15 acre of hand clearing within the wetlands.

Neuse Riparian Buffers: Revised impacts to riparian buffers total 348,634 ft²; of this Zone 1 has 214,078 ft² and Zone 2 has 134,556 ft² of proposed impacts.

Utility Impacts: There will be no impacts to jurisdictional resources as a result of utility relocations.

Table 1. Impacts to Wetlands within R-2719A

Permit Drawing Site Number	Wetland Classification within 2002 NRTR	Wetland Site ID 2004 LEDPA Meeting	Type	Permanent (ac.)	Hand Clearing (ac.)	Mitigation Required*
7	Headwater Swamp	C	riparian	0.03	<0.01	Yes
8	Headwater Swamp	D	riparian	2.67	0.20	Yes
9	Wet Pine Flats /Pocosin	E	non-riparian	2.93	0.31	Yes
10	Wet Pine Flats /Pocosin	E	non-riparian	1.96	0.18	Yes
11	Wet Pine Flats /Pocosin	F	non-riparian	1.39	0.14	Yes
12	Wet Pine Flats /Pocosin	F	non-riparian	0.95	0.10	Yes
13	Wet Pine Flats /Pocosin	G	non-riparian	0.76	0.09	Yes
14**	Wet Pine Flats /Pocosin	H	non-riparian	0.94	0.04	Yes
15	Wet Pine Flats /Pocosin	I	non-riparian	0.06	0.01	Yes
16	Wet Pine Flats /Pocosin	J	non-riparian	0.36	0.08	Yes
18	Wet Pine Flats /Pocosin	A	non-riparian	0.00	<0.01	Yes
Total				12.05	1.15	

Notes: * Mitigation requirement for permanent impacts only. ** An additional 0.02 ac. of impacts added due to the total take.

Summary of Mitigation

The NCDOT has avoided and minimized impacts to jurisdictional resources to the greatest extent possible as described in the original application. The unavoidable impacts to; 12.05 ac of wetlands, 2,363 ft of streams, and 258,773 ft² of buffers will be offset by compensatory mitigation provided by onsite mitigation and other mitigation within the NCDOT debit ledger for this area. The following are the site names that are referred to in Tables 2-4 as well as the mitigation package that was attached to the original permit application: Banks School Road Site 1 and 2, Crescent Road Site, NEU-CON MBI – Casey King, and Jeffrey’s Warehouse. Attached is revised mitigation information for the Crescent Road and Jeffrey’s Warehouse sites. The revisions are due to wetland impact changes. Also, please note there were no changes to the buffer impacts nor the sources of buffer mitigation. However, there has been a change in the quantities being debited from the Crescent Road and Jeffrey’s Warehouse sites. Please replace the original information for these sites in the mitigation packet with the revised attached information.

Table 2. Summary of Wetland Mitigation for R-2719A

Site	Riverine Wetland Mitigation		
	Restoration (1:1)	Preservation (5:1)	Total Credits Proposed
Banks School Road (Site 2)	0.68 acre	n/a	0.68 acre
Jeffrey’s Warehouse	2.02 acres	n/a	2.02 acres
	Non-Riverine Mitigation		
NEU-CONMBI-Casey King	6.59 acres	n/a	6.59 acres
Jeffrey’s Warehouse	2.76 acres	n/a	2.76 acres
Totals	12.05 acres	n/a	12.05 acres

Table 3. Summary of Stream Mitigation for R-2719A

Site	Stream Mitigation (lf) (Ratio)		
	Restoration (1:1)	Preservation (5:1)	Total Credits Proposed
Banks School Road (Site 1)	2,077 ft	n/a	2,077 ft
Banks School Road (Site 2)	286 ft	n/a	286 ft
Totals	2,363 ft	n/a	2,363 ft

Table 4. Summary of Buffer Mitigation for R-2719A

Site	Buffer Mitigation (sq. ft)	
	Restoration	Total Credits Proposed
Banks School Road (Site 1)	165,963	165,963
Banks School Road (Site 2)	91,476	91,476
Crescent Road Site	200,376	200,376
Jeffrey’s Warehouse	172,387	172,387
Totals	630,202	630,202

Regulatory Approvals

Section 404: Please incorporate these revisions into the previously submitted Individual Section 404 permit application.

Section 401: We are also requesting a Section 401 Water Quality Certification from the NCDWQ. In compliance with Section 143-215.3D(e) of the NCAC, we have provided \$570.00 with the previous application to act as payment for processing the Section 401 permit. We are providing five (5) copies of this revision to the NCDWQ, for their review and approval.

Neuse Riparian Buffer Authorization: NCDOT requests that the NC Division of Water Quality review this application and issue a written approval for a Neuse Riparian Buffer Authorization.

A copy of this permit application will be posted on the NCDOT website at:
<http://www.ncdot.org/doh/preconstruct/pe/neu/permit.html>

If you have any questions or need additional information, please call Mr. Chris Manley, at 919-715-1487.

Sincerely,

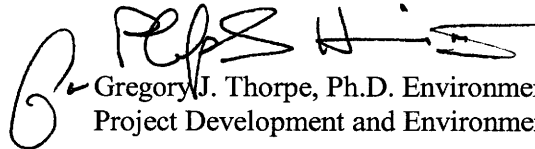

Gregory J. Thorpe, Ph.D. Environmental Management Director
Project Development and Environmental Analysis Branch

cc List:

W/attachment

Mr. Brian Wrenn, NCDWQ (5 Copies)
Ms. Kathy Matthews, USEPA

W/o attachment (see website for attachments)

Dr. David Chang, P.E., Hydraulics
Mr. Greg Perfetti, P.E., Structure Design
Mr. Victor Barbour, P.E., Project Services Unit
Mr. Mark Staley, Roadside Environmental
Mr. C. E. Lassiter, P.E., Division 2 Engineer
Mr. Jay Johnson, Division 2 Environmental Officer
Mr. Scott McLendon, USACE, Wilmington
Mr. Gary Jordan, USFWS
Mr. Travis Wilson, NCWRC
Mr. Ron Sechler, NMFS
Ms. Anne Deaton, NCDMF
Mr. Jay Bennett, P.E., Roadway Design
Mr. Majed Alghandour, P. E., Programming and TIP
Mr. Art McMillan, P.E., Highway Design
Mr. Ted Devens, PE, Project Planning Engineer
Mr. Drew Joyner, PE, Human Environment Unit Head
Mr. Clarence W. Coleman, P.E., FHWA
Ms. LeiLani Paugh, NEU
Mr. Randy Griffin, NEU

Crescent Road Site

The site is situated immediately south and adjacent to C.F. Harvey Road (Crescent Road) in the western portion of Lenoir County (Figure 1). It lies approximately 2 miles (3.2 kilometers) northeast of Kinston within HU 3020202. The Crescent Road Site was constructed as an on-site stream mitigation project in order to provide mitigation for stream impacts associated with the construction of R-2719BA.

The US Army Corps of Engineers (USACE) permit for R-2719BA dated June 12, 2001 states that the Crescent Road onsite mitigation site is to provide a minimum of 0.58 acres of riverine wetland restoration and 1,706 linear feet of stream restoration to offset unavoidable impacts imposed by the adjacent roadway project. According to the as-built drawings of the site, the site actually restored 3.71 acres of riverine wetland restoration, 2,291 linear feet of stream restoration, and 7.6 acres of Neuse River riparian buffer.

The fourth year of monitoring has been completed (Year 2007). Based on the overall monitoring assessment, the Crescent Road Site has met the required monitoring criteria. Based on information obtained from the US Geological Survey (USGS), the Crescent Road Site has already met the required monitoring protocols for hydrology as it relates to bankfull events. The NCDOT will continue stream monitoring at the Crescent Road Mitigation Site for 2008.

Site name	HUC	River Basin	Division	County
Crescent Road	3020202	Neuse	2	Lenoir

Mitigation Type	As Built Quantity	Available	Debit	Debit
			R-2719	R-2719A
Riverine Wetland Restoration	3.35	2.77	0.58	
Stream Restoration	2,009	303	1,706	
Buffer (S.F.)	200,376	0		200,376

Jeffrey's Warehouse

The site is located adjacent to US 117 in Goldsboro (Figure 1) within HU 3020201. It was constructed to provide mitigation for stream impacts associated with TIP number R-1030AA in Wayne County. The mitigation project covers approximately 3,380 linear feet of channel length and 7.27 acres of Neuse River riparian buffer. Construction was completed during 2006 by the NCDOT.

Based on the overall monitoring assessment, the site has met the required monitoring criteria for the first year of monitoring and is stable at this time. There is evidence along the floodplain that the site has experienced several bankfull events since construction was completed in March 2006. The NCDOT will continue stream monitoring at the site in 2008.

Site name	HUC	River Basin	Division	County
Jefferey's Warehouse (JALO)	3020201	Neuse	4	Wayne

Mitigation Type	As Built Quantity	Available	Debit	Debit	Debit	Debit	Debit
			B-3528	B-4300	R-2719A	B-4592	B-4304
Stream Restoration	3,731	3,279	452(226@2:1)				
Riverine Wetland Restoration	3.66	0.72			2.02		0.92
Non-Riverine Wetland Restoration	23.02	20.26			2.76		
Riverine Wetland Preservation	12.36	12.36					
Neuse Buffer Restoration (S.F.)	689,607	381,517	75,577	40,075	172,387	16,398	3,653

WETLAND PERMIT IMPACT SUMMARY

Site No.	Station (From/To)	Structure Size / Type	WETLAND IMPACTS					SURFACE WATER IMPACTS							
			Permanent Fill In Wetlands (ac)	Temp. Fill In Wetlands (ac)	Excavation in Wetlands (ac)	Mechanized Clearing in Wetlands (ac)	Hand Clearing in Wetlands (ac)	Permanent SW impacts (ac)	Temp. SW impacts (ac)	Existing Channel Impacts (ft)	Existing Channel Impacts Temp. (ft)	Natural Stream Design (ft)			
1	-Y1- 74+43	3@12'x10' RCBC									0.10	0.05	499	208	
2	-Y1RPCA- 16+14	3@12'x10' RCBC									0.18	0.07	619	245	
3	-L- 69+50	60" RCP									0.01	<0.01	158	18	
4	-Y1RPCA- 9+20	60" RCP									0.01	<0.01	119	18	
5A	-SVRD5- 21+90	2@60" RCP									0.02	0.01	50	18	
5B	-L- 87+80 LT	TEMP 2@36" CSP									0.02	<0.01	21	61	
6*	-L- 103+73	36" RCP									0.03	0.01	286	36	286*
7	-L- 108+40 TO 109+40	Roadway Fill	0.03							<0.01					
8	-L- 113+26 TO 119+26	Roadway Fill	2.67							0.20					
9	-L- 119+50 TO 127+61	Roadway Fill	2.93							0.31					
10	-L- 127+61 TO 133+27	Roadway Fill	1.96							0.18					
11	-L- 135+50 TO 140+70	2@9'X8' RCBC	1.36		0.03					0.14	0.03	237	182		
12	-L- 150+80 TO 154+00	2@8'X8' RCBC	0.94		0.01					0.10	0.02	188	155		
13	-L- 154+80 TO 158+90	Roadway Fill	0.73		0.03					0.09					
14**	-L- 203+39 TO 206+22	Roadway Fill	0.89		0.01	0.02				0.04					
15	-L- 241+20 TO 241+90	Roadway Fill	0.06							0.01					
16	-L- 249+10 TO 253+80	Roadway Fill	0.36							0.08					
17	-Y6- 33+75	TEMP 48" CSP										0.02		109	
18	-Y1- 18+30	EXISTING BRIDGE								<0.01					
19*	-Y1- 38+22	2@9'X6' RCBC									0.04	0.04	186	177	
TOTALS:			11.93	0.00	0.08	0.02	1.15	0.46	0.25	2363	1227	286			

* SEE MITIGATION PLANS

** The wetland impact to site 14 along right side should be considered as a "total take", and the additional impact area is 0.02 acre. Therefore, the total wetland impact = (0.89+0.01+0.02+0.04)+0.02 = 0.98 acre

Site 5B - Temporary impacts/pipes due to need for Construction Access

0.35 acres of Temporary Fill In Wetlands in the Hand Clearing areas for erosion control measures.

Permit Drawing
Sheet 5 of 66

NC DEPARTMENT OF TRANSPORTATION
DIVISION OF HIGHWAYS

LENOIR COUNTY
PROJECT: 34501.1.1 (R-2719A)

SHEET
June-08

8/17/99
 REVISIONS
 32006 - REVISED PARCEL NUMBER IN LOWER RIGHT CORNER OF SHEET FROM 46 TO 38
 32206 - REVISED RIGHT OF WAY PERMIT REQUEST TO ELIMINATE REMNANT
 32206 - REVISED RIGHT OF WAY PERMIT REQUEST TO ELIMINATE REMNANT
 32206 - ADDED MATCHLINE TO SHEET 7A AND ADDED MITIGATION AREA BOUNDARY
 8/21/2008
 B:\Projects\Permits\2008_05_30 (Update)\r-2719a_hyd-prm-wet.dgn
 C:\Assistants\...

MILLED RUMBLE STRIPS SHALL BE PLACED ON -L-
 ACCORDING TO NCDOT STANDARD DRAWING No.665.01

NOTE: FOR -L- PROFILE, SEE SHEET 39
 FOR -SVRDI- PROFILE, SEE SHEET 62
 SEE SHEET 2-L FOR DRAINAGE DITCH DETAILS

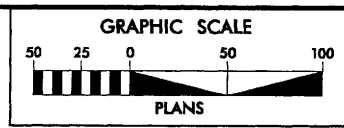

Prepared by
URS
 URS Corporation - North Carolina
 1600 Perimeter Park Drive
 Morrisville, North Carolina 27560
 TELEPHONE (919) 461-1100 FAX (919) 461-1413

PROJECT REFERENCE NO.	SHEET NO.
R-2719A	9
RW SHEET NO.	9
ROADWAY DESIGN ENGINEER	HYDRAULICS ENGINEER
Permit Drawing Sheet 24 of 66	
PRELIMINARY PLANS DO NOT USE FOR CONSTRUCTION	

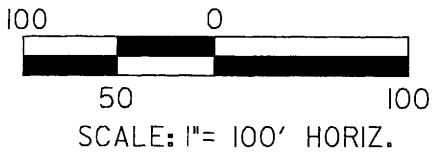
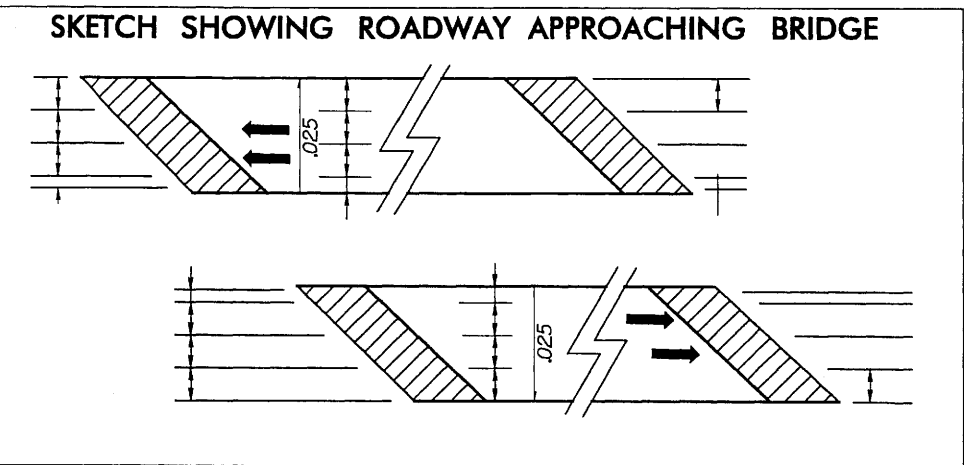
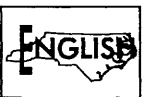

PLAN VIEW
 SITES 7 CON'T.
 & 8

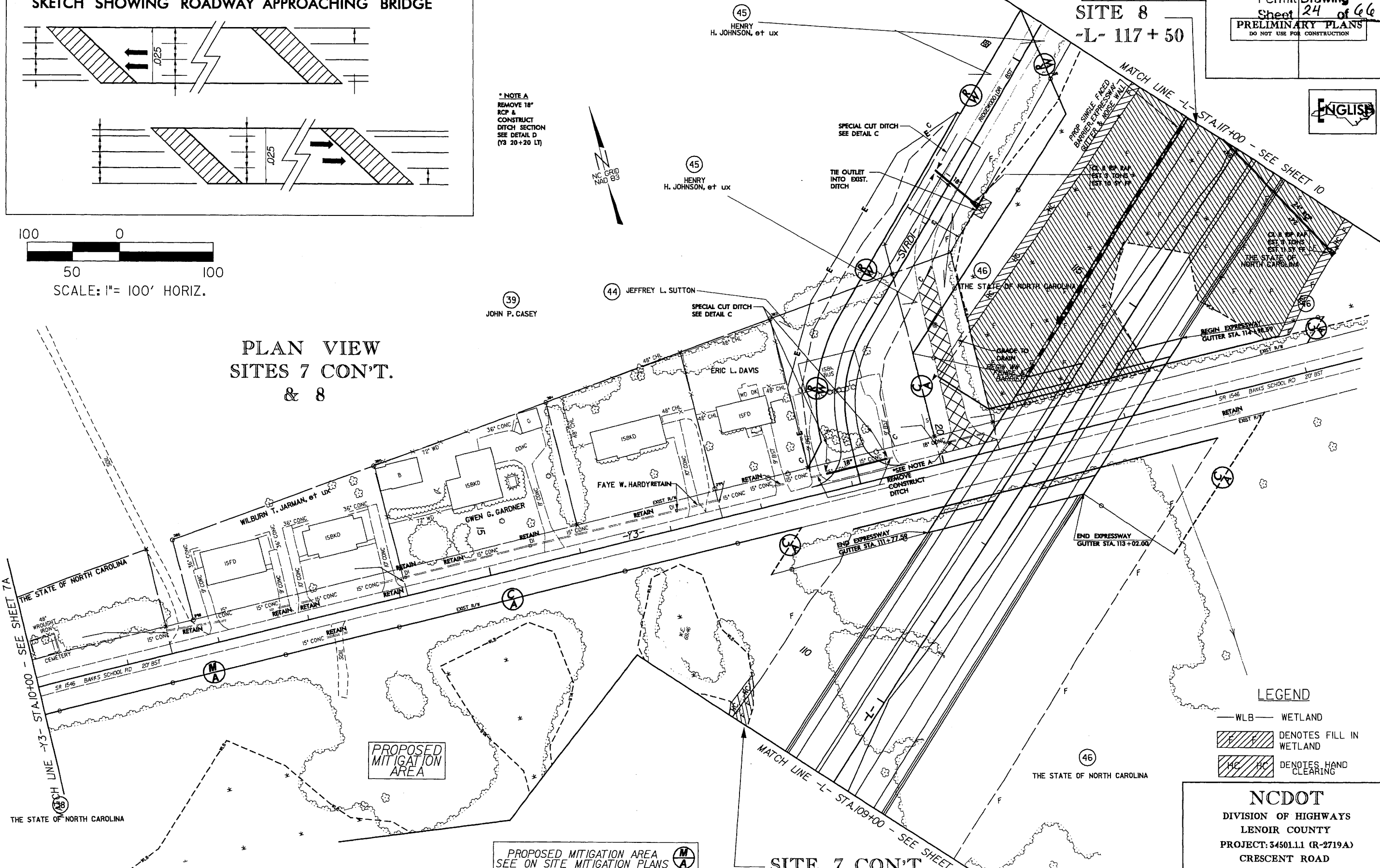

* NOTE A
 REMOVE 18"
 RCP &
 CONSTRUCT
 DITCH SECTION
 SEE DETAIL D
 (73 20+20 LT)



LEGEND

- WLB — WETLAND
- DENOTES FILL IN WETLAND
- DENOTES HAND CLEARING

NCDOT
 DIVISION OF HIGHWAYS
 LENOIR COUNTY
 PROJECT: 34501.11 (R-2719A)
 CRESCENT ROAD
 IN KINSTON FROM
 US 70 TO US 258

PROPOSED MITIGATION AREA
 SEE ON SITE MITIGATION PLANS

NOTE: STRUCTURE OVER BANKS SCHOOL ROAD DESIGNED
 TO ACCOMMODATE FUTURE WIDENING UNDER STRUCTURE

SITE 7 CON'T
 -L- 109+00

SITE 8
 -L- 117+50

MATCH LINE -L- STA. 117+00 - SEE SHEET 10

SEE SHEET 7A
 STA. 10+00 - Y3

MATCH LINE -L- STA. 109+00 - SEE SHEET 8

8/17/99

MILLED RUMBLE STRIPS SHALL BE PLACED ON -L- ACCORDING TO NCDOT STANDARD DRAWING No.665.01

NOTE: FOR -L- PROFILE, SEE SHEET 39
FOR -SVRDI- PROFILE, SEE SHEET 62
SEE SHEET 2-L FOR DRAINAGE DITCH DETAILS

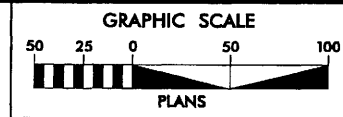

Prepared by
URS
URS Corporation - North Carolina
1600 Parkview Park Drive
Morrisville, North Carolina 27560
TELEPHONE (919) 461-1100 FAX (919) 461-1415

PROJECT REFERENCE NO. R-2719A	SHEET NO. 9
RW SHEET NO. 9	
ROADWAY DESIGN ENGINEER	HYDRAULICS ENGINEER
Permit Drawing Sheet 25 of 66	
PRELIMINARY PLANS DO NOT USE FOR CONSTRUCTION	

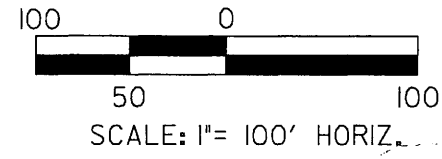
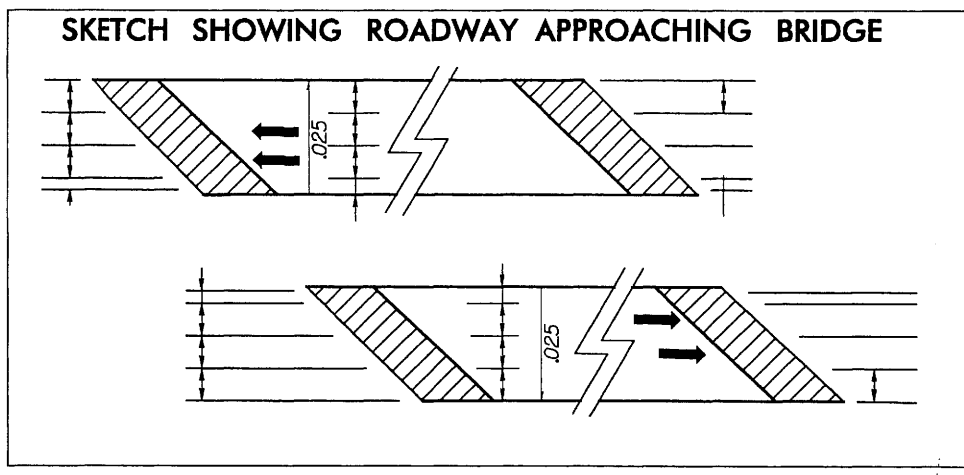

* NOTE A
REMOVE 18"
ICP &
CONSTRUCT
DITCH SECTION
SEE DETAIL D
(Y3 20+20 LT)



PLAN VIEW SITES 7 CON'T. & 8

SITE 8
-L- 117 + 50

SITE 7 CON'T
-L- 109 + 00

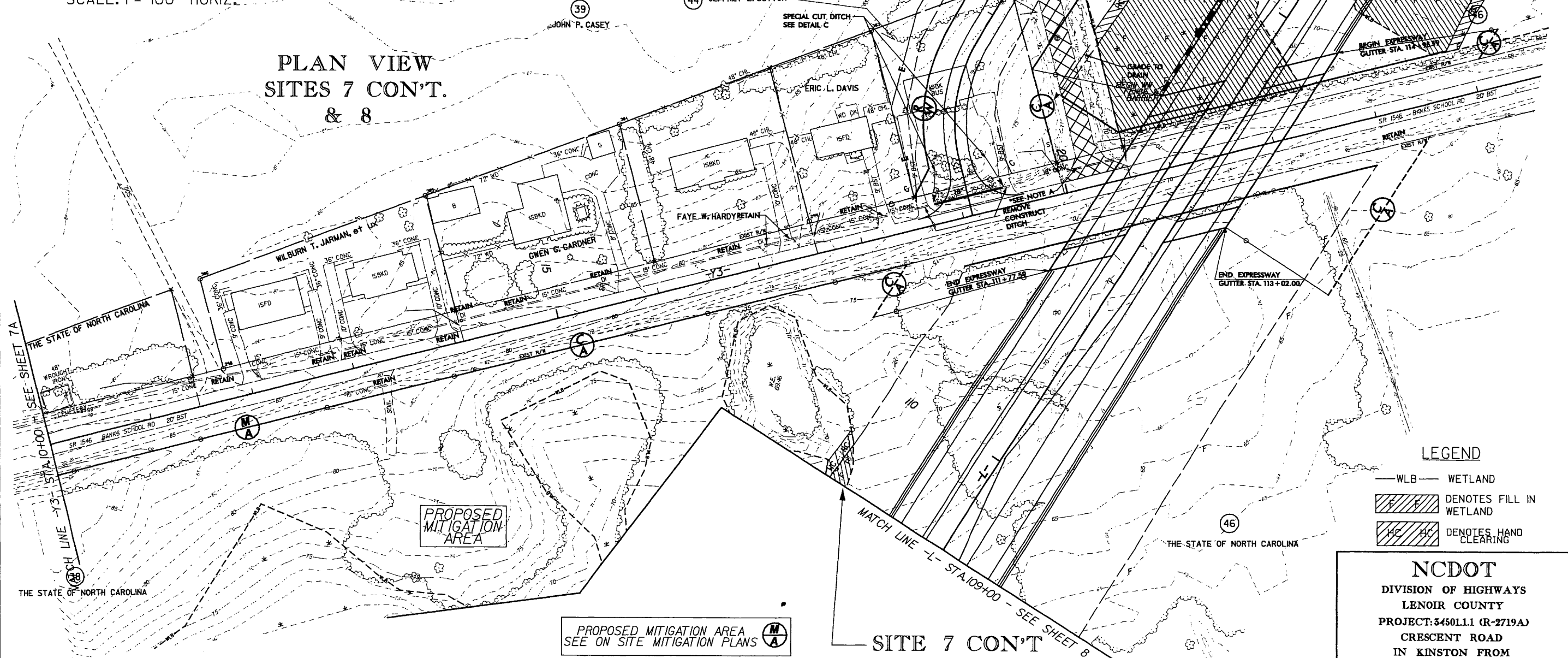

LEGEND

— WLB —	WETLAND
	DENOTES FILL IN WETLAND
	DENOTES HAND CLEARING

NCDOT
DIVISION OF HIGHWAYS
LENOIR COUNTY
PROJECT: 3450L1.1 (R-2719A)
CRESCENT ROAD
IN KINSTON FROM
US 70 TO US 258

REVISIONS
 32006 - REVISED PARCEL NUMBER IN LOWER RIGHT CORNER OF SHEET FROM 46 TO 38
 32206 - REVISED RIGHT OF WAY ON PARCEL 45 PER REQUEST TO ELIMINATE REMNANT
 32206 - ADDED MATCHLINE TO SHEET 7A AND ADDED MITIGATION AREA BOUNDARY

NOTE: STRUCTURE OVER BANKS SCHOOL ROAD DESIGNED TO ACCOMMODATE FUTURE WIDENING UNDER STRUCTURE

PROPOSED MITIGATION AREA SEE ON SITE MITIGATION PLANS

8/31/2008
C:\Users\perry\Documents\Projects\2008.05.30 (Updates)\R-2719a_hyd.prm...ve t.06.dgn

8/17/99

NOTE: FOR -L- PROFILE, SEE SHEET 40
SEE SHEET 2-L FOR DRAINAGE DITCH DETAILS
MILLED RUMBLE STRIPS SHALL BE PLACED ON -L-
ACCORDING TO NCDOT STANDARD DRAWING No.665.01

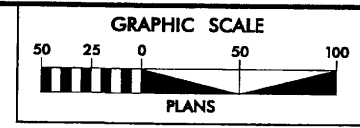

Prepared by
URS
URS Corporation - North Carolina
1400 Perimeter Park Drive
Morrisville, North Carolina 27560
TELEPHONE (919) 461-1100 FAX (919) 461-1415

PROJECT REFERENCE NO. R-2719A	SHEET NO. 10
HW SHEET NO. 10	
ROADWAY DESIGN ENGINEER	HYDRAULICS ENGINEER
PRELIMINARY PLANS DO NOT USE FOR CONSTRUCTION	

Permit Drawing
Sheet 30 of 66

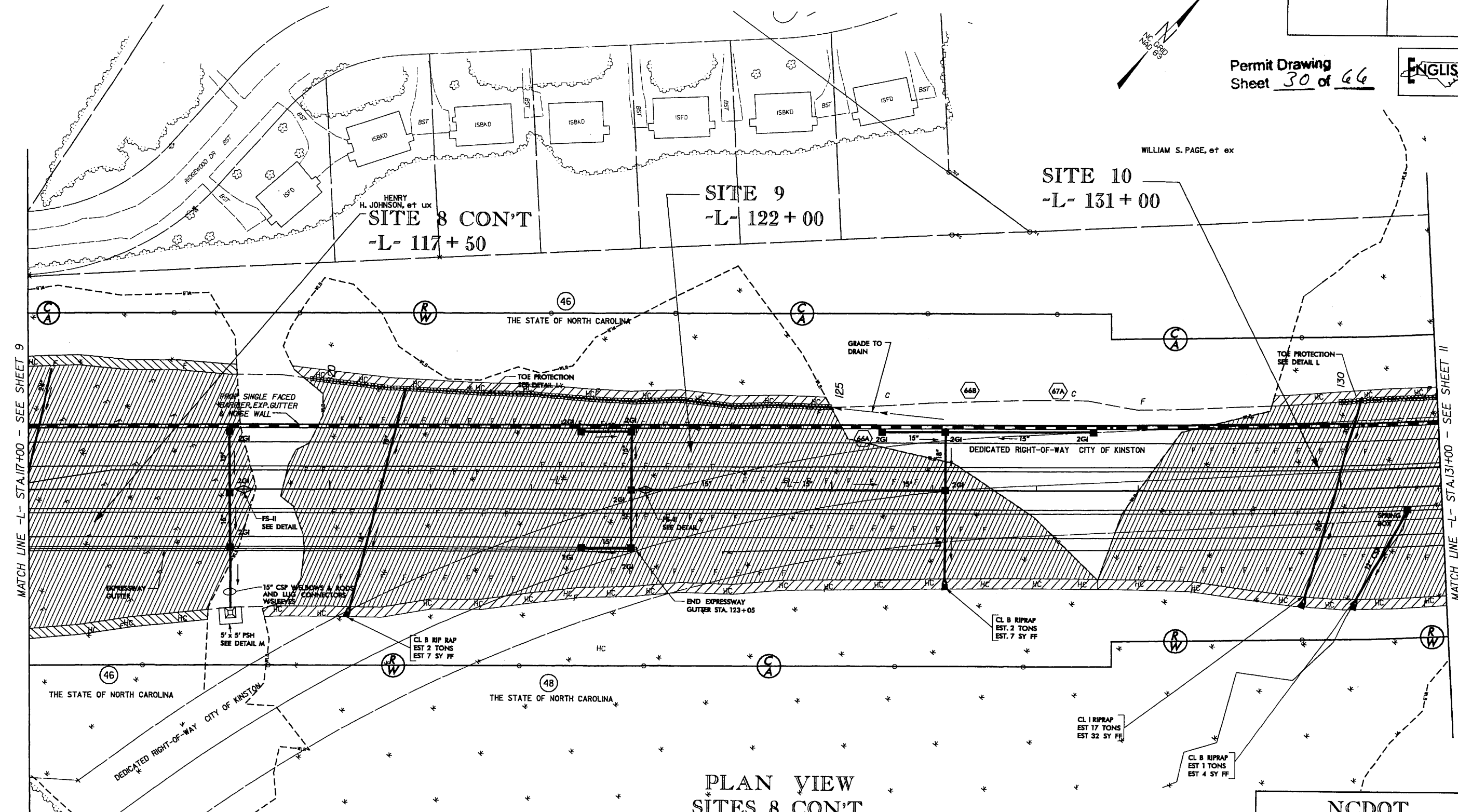

WILLIAM S. PAGE, et al

SITE 10
-L- 131+00

SITE 9
-L- 122+00

HENRY H. JOHNSON, et al
SITE 8 CONT'
-L- 117+50

MATCH LINE -L- STA.117+00 - SEE SHEET 9

MATCH LINE -L- STA.131+00 - SEE SHEET 11

PLAN VIEW SITES 8 CONT', 9 & 10

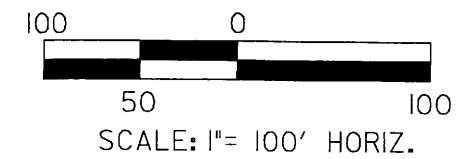

LEGEND

- WLB — WETLAND
- DENOTES FILL IN WETLAND
- DENOTES HAND CLEARING

NCDOT
DIVISION OF HIGHWAYS
LENOIR COUNTY
PROJECT: 34501.11 (R-2719A)
CRESCENT ROAD
IN KINSTON FROM
US 70 TO US 258

6/27/2008 R:\Hydraulics\Permits-2008_05_30 (Updates)\r-2719a_hyd.prm_wet_10.dgn

8/17/99

NOTE: FOR -L- PROFILE, SEE SHEET 40
SEE SHEET 2-L FOR DRAINAGE DITCH DETAILS
MILLED RUMBLE STRIPS SHALL BE PLACED ON -L-
ACCORDING TO NCDOT STANDARD DRAWING No.665.01

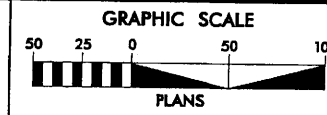

Prepared by
URS
URS Corporation - North Carolina
1400 Perimeter Park Drive
Morrisville, North Carolina 27560
TELEPHONE (919) 461-1100 FAX (919) 461-1415

PROJECT REFERENCE NO. R-2719A	SHEET NO. 10
RAW SHEET NO. 10	
ROADWAY DESIGN ENGINEER	HYDRAULICS ENGINEER
PRELIMINARY PLANS DO NOT USE FOR CONSTRUCTION	

Permit Drawing
Sheet 31 of 66

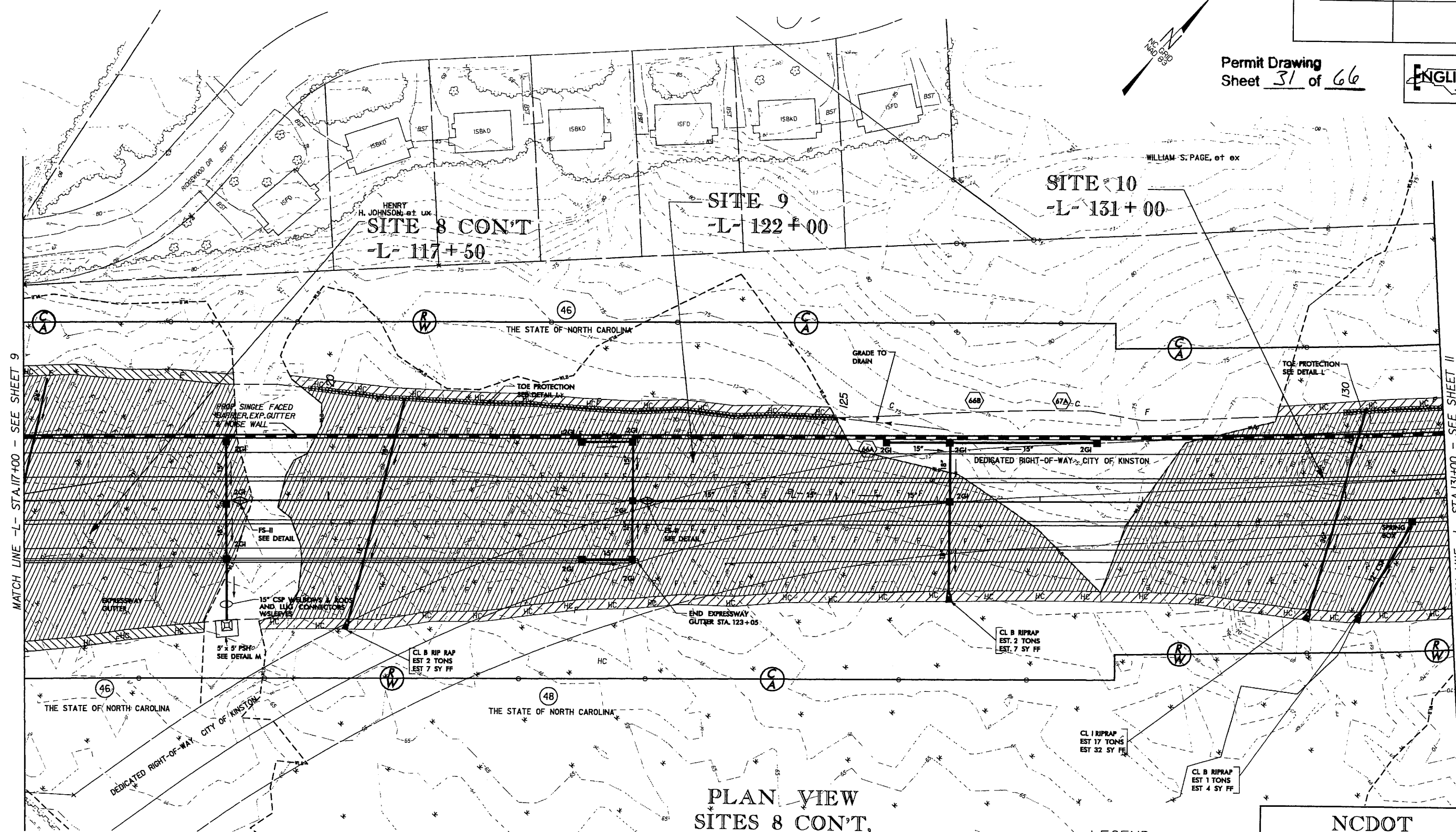

PLAN VIEW
SITES 8 CON'T,
9 & 10

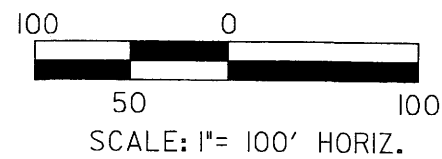

LEGEND

— WLB —	WETLAND
	DENOTES FILL IN WETLAND
	DENOTES HAND CLEARING

NCDOT
DIVISION OF HIGHWAYS
LENOIR COUNTY
PROJECT: 3450L11 (R-2719A)
CRESCENT ROAD
IN KINSTON FROM
US 70 TO US 258

6/27/2008 8:41:58 AM C:\Hydraulics\Permit\2008_05_30\Updates\2719a_hyd_prm_vet_10.dgn

8/17/99

SITE 14 -L- 205+00

NOTE: FOR -L- PROFILE, SEE SHEET 43
SEE SHEET 2-L FOR DRAINAGE DITCH DETAILS
MILLED RUMBLE STRIPS SHALL BE PLACED ON -L-
ACCORDING TO NCDOT STANDARD DRAWING No.665.01

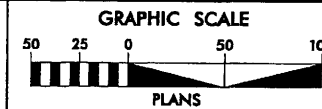

Prepared by
URS
URS Corporation - North Carolina
1600 Parkview Park Drive
Morrisville, North Carolina 27560
TELEPHONE (919) 461-1100 FAX (919) 461-1415

PROJECT REFERENCE NO. R-2719A	SHEET NO. 16
R/W SHEET NO. 16	HYDRAULICS ENGINEER
ROADWAY DESIGN ENGINEER	Permit Drawing Sheet 46 of 66
PRELIMINARY PLANS DO NOT USE FOR CONSTRUCTION	

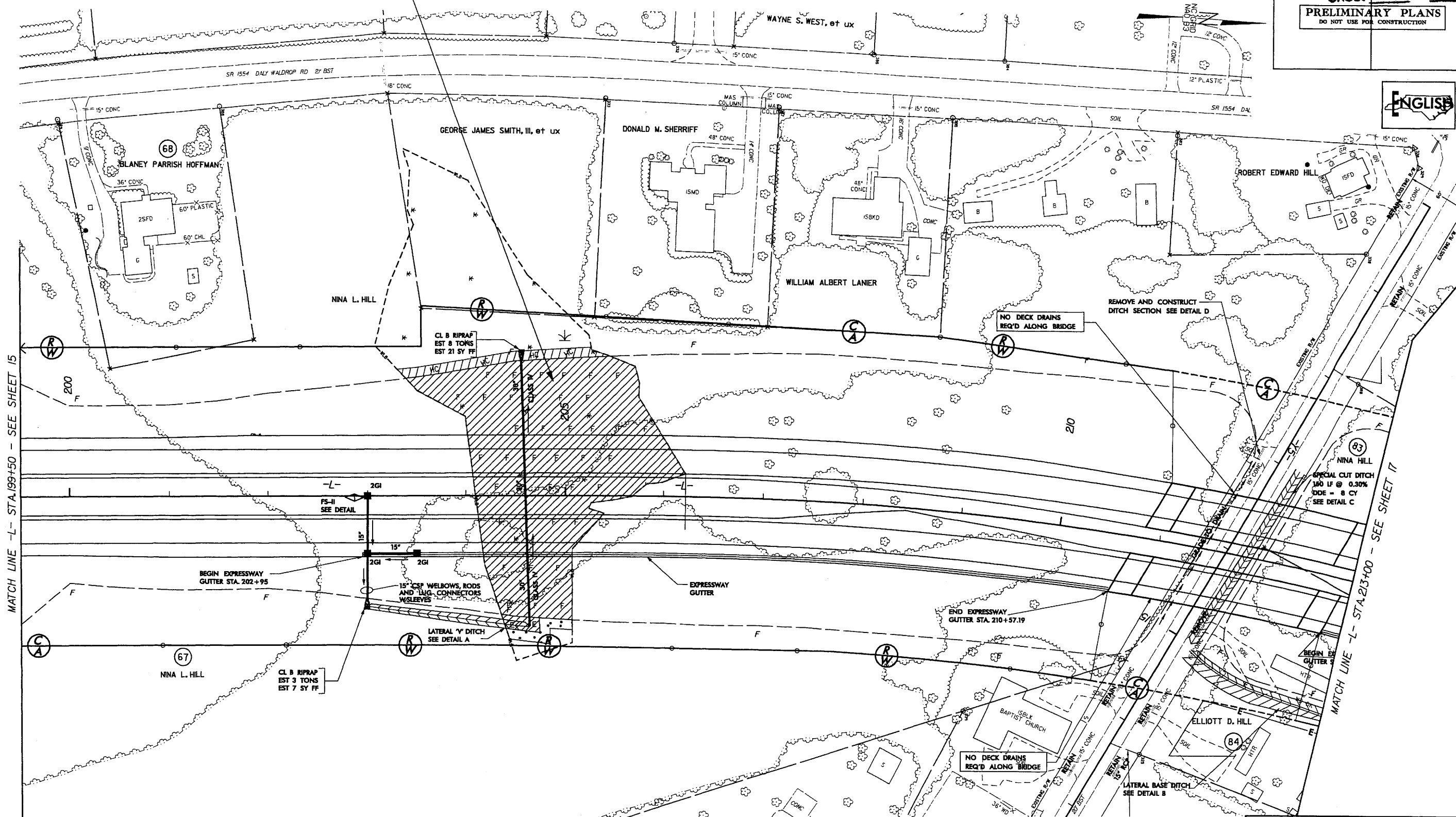

PLAN VIEW SITE 14

LEGEND

	DENOTES EXCAVATION IN WETLAND		WETLAND
	DENOTES HAND CLEARING		DENOTES FILL IN WETLAND
	DENOTES MECHANIZED CLEARING		

NCDOT
DIVISION OF HIGHWAYS
LENOIR COUNTY
PROJECT: 34501.1 (R-2719A)
CRESCENT ROAD
IN KINSTON FROM
US 70 TO US 258

8/27/2008 8:45:00 AM C:\projects\2719a\updates\1-2719a_hyd_p.m.wet_16.dgn

8/17/99

SITE 14 -L- 205+00

NOTE: FOR -L- PROFILE, SEE SHEET 43
SEE SHEET 2-L FOR DRAINAGE DITCH DETAILS
MILLED RUMBLE STRIPS SHALL BE PLACED ON -L-
ACCORDING TO NCDOT STANDARD DRAWING No.665.01

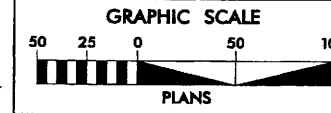

Prepared by
URS
URS Corporation - North Carolina
1600 Parkview Park Drive
Morrisville, North Carolina 27560
TELEPHONE (919) 461-1100 FAX (919) 461-1415

PROJECT REFERENCE NO. R-2719A	SHEET NO. 16
R/W SHEET NO. 16	HYDRAULICS ENGINEER
ROADWAY DESIGN ENGINEER	Permit Drawing Sheet 47 of 66
PRELIMINARY PLANS DO NOT USE FOR CONSTRUCTION	

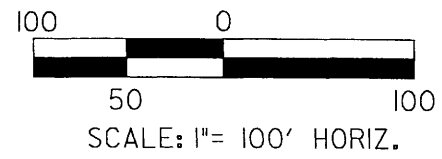
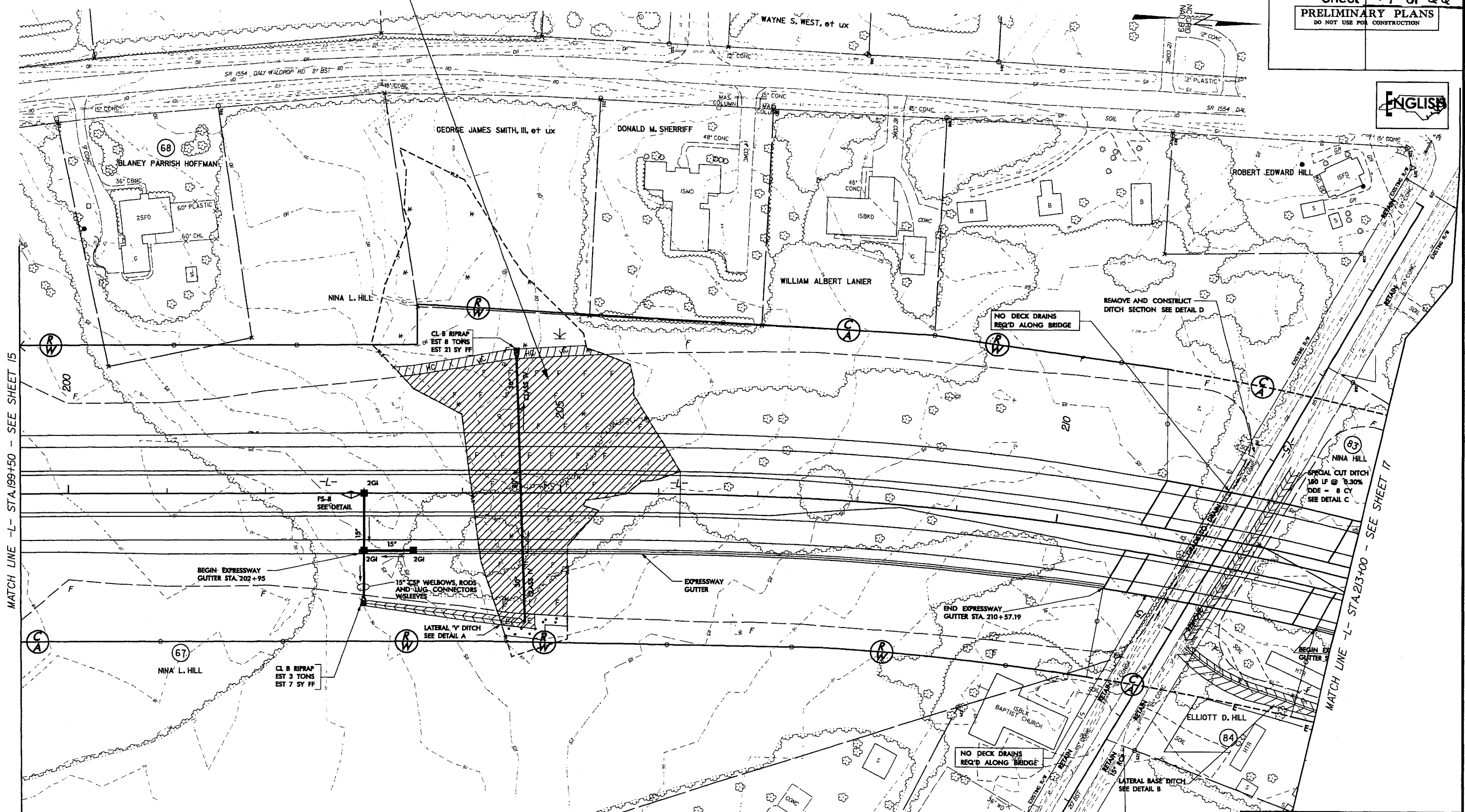

PLAN VIEW SITE 14

LEGEND

	DENOTES EXCAVATION IN WETLAND		DENOTES MECHANIZED CLEARING
	DENOTES HAND CLEARING		DENOTES WETLAND
	DENOTES WETLAND		DENOTES FILL IN WETLAND

NCDOT
DIVISION OF HIGHWAYS
LENOIR COUNTY
PROJECT: 34501.11 (R-2719A)
CRESCENT ROAD
IN KINSTON FROM
US 70 TO US 258

8/17/2008 10:51:30 AM C:\Users\perry\Documents\2008_05_30 (Updates)\N-2719a_hyd_p.m_wet_16.dgn

8/17/99

Prepared by
URS
 URS Corporation - North Carolina
 1400 Parkcenter Park Drive
 Morrisville, North Carolina 27560
 TELEPHONE (919) 461-1100 FAX (919) 461-1415

PROJECT REFERENCE NO. R-2719A		SHEET NO. 19A	
ROADWAY DESIGN ENGINEER		HYDRAULICS ENGINEER	
PRELIMINARY PLANS DO NOT USE FOR CONSTRUCTION			



Permit Drawing
 Sheet 54 of 66

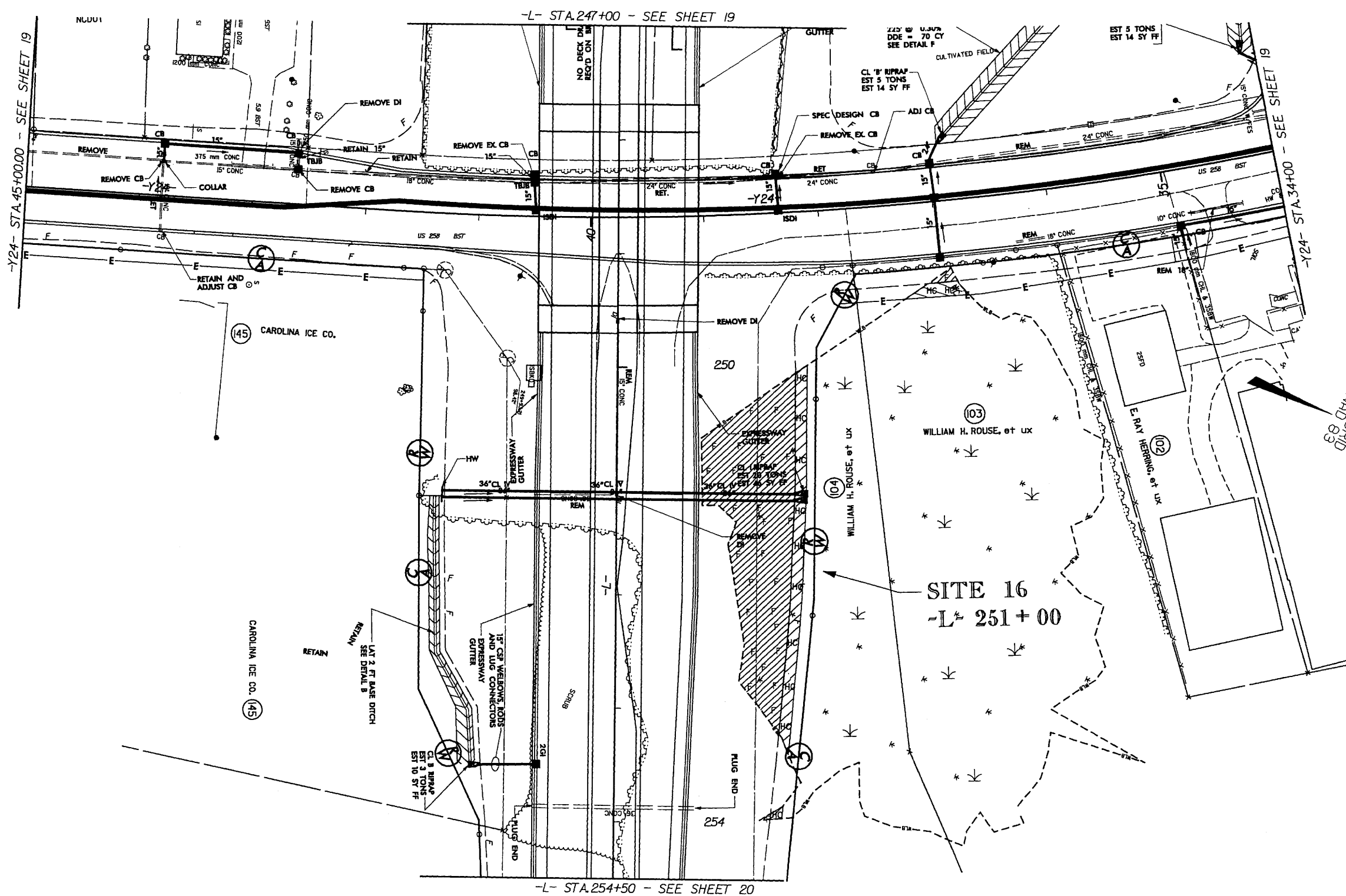

LEGEND

— WLB —	WETLAND
	DENOTES FILL IN WETLAND
	DENOTES HAND CLEARING

NCDOT
 DIVISION OF HIGHWAYS
 LENOIR COUNTY
 PROJECT: 3450L11 (R-2719A)
 CRESCENT ROAD
 IN KINSTON FROM
 US 70 TO US 258

PLAN VIEW
 SITE 16

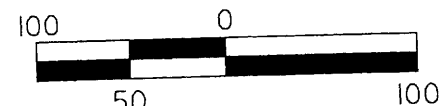

08 bullock\p\proj\25-2008-05-30 (Updates)\r-2719a_hyd_prm_vet_19a.dgn

8/17/99

Prepared by
URS
 URS Corporation - North Carolina
 1600 Parkside Park Drive
 Morrisville, North Carolina 27560
 TEL: 919/416-1100 FAX: 919/416-1415

PROJECT REFERENCE NO. R-2719A	SHEET NO. 19A
NW SHEET NO.	
ROADWAY DESIGN ENGINEER	HYDRAULICS ENGINEER
PRELIMINARY PLANS DO NOT USE FOR CONSTRUCTION	



Permit Drawing
 Sheet 55 of 66

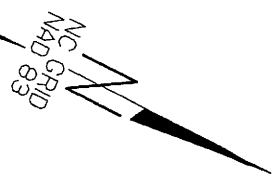
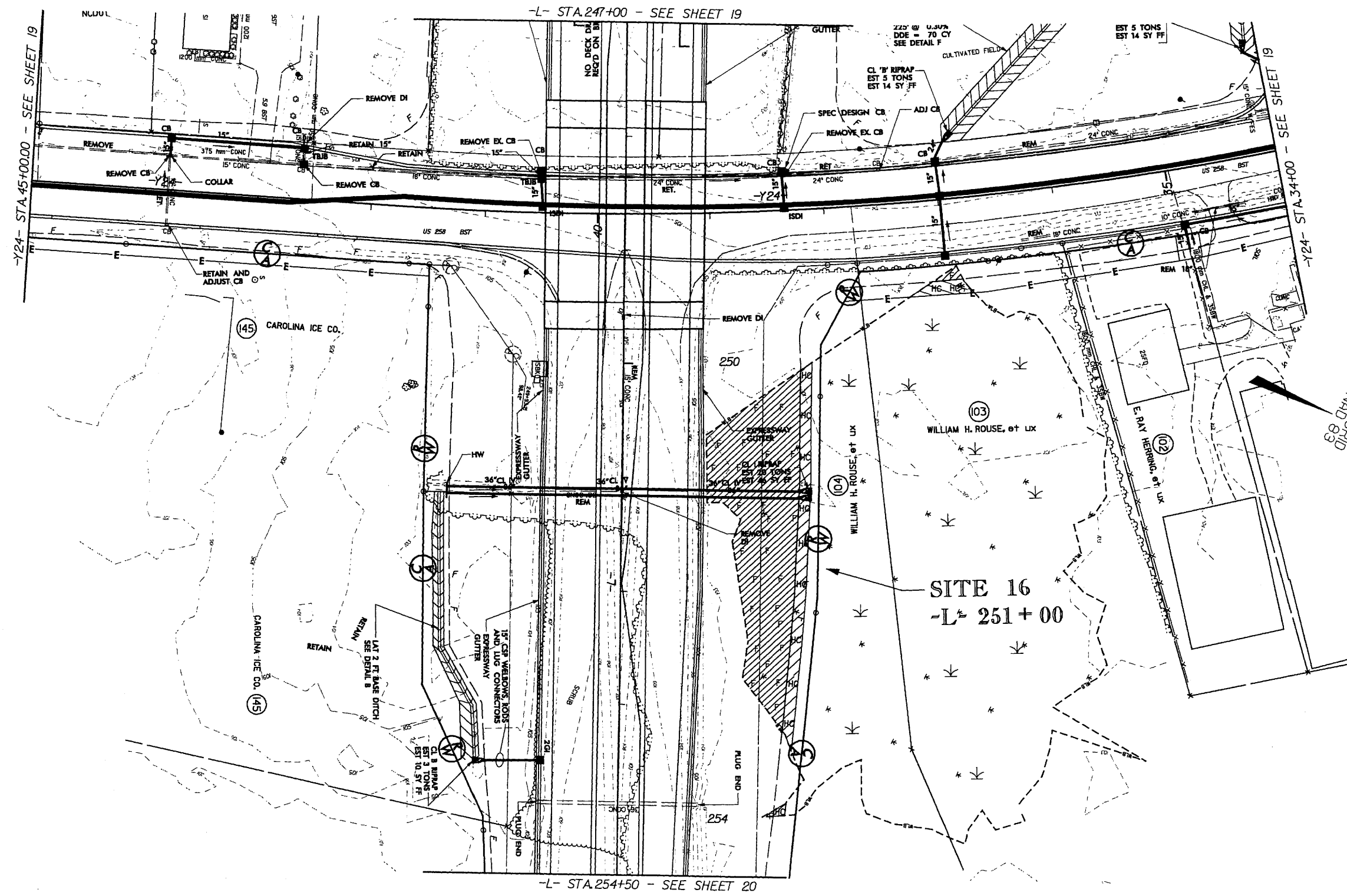

LEGEND

— WLB —	WETLAND
	DENOTES FILL IN WETLAND
	DENOTES HAND CLEARING

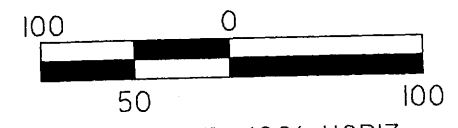

**PLAN VIEW
 SITE 16**

NCDOT
 DIVISION OF HIGHWAYS
 LENOIR COUNTY
 PROJECT: 3450L1.1 (R-2719A)
 CRESCENT ROAD
 IN KINSTON FROM
 US 70 TO US 258

2008.05.30 (Updates) R-2719a_hyd_prm_wet_19a.dgn
 2008.05.30 (Updates) R-2719a_hyd_prm_wet_19a.dgn

MILLED RUMBLE STRIPS SHALL BE PLACED ON -L- ACCORDING TO NCDOT STANDARD DRAWING No.665.01

NOTE: FOR -L- PROFILE, SEE SHEET 39 FOR -SVRDI- PROFILE, SEE SHEET 62 SEE SHEET 2-L FOR DRAINAGE DITCH DETAILS

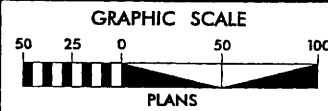

Prepared by URS URS Consultants - North Carolina 1600 Perimeter Park Drive Morrisville, North Carolina 27560 TELEPHONE (919) 461-1100 FAX (919) 461-1415

PROJECT REFERENCE NO. R-2719A SHEET NO. 9 ROADWAY DESIGN ENGINEER HYDRAULICS ENGINEER PRELIMINARY PLANS DO NOT USE FOR CONSTRUCTION

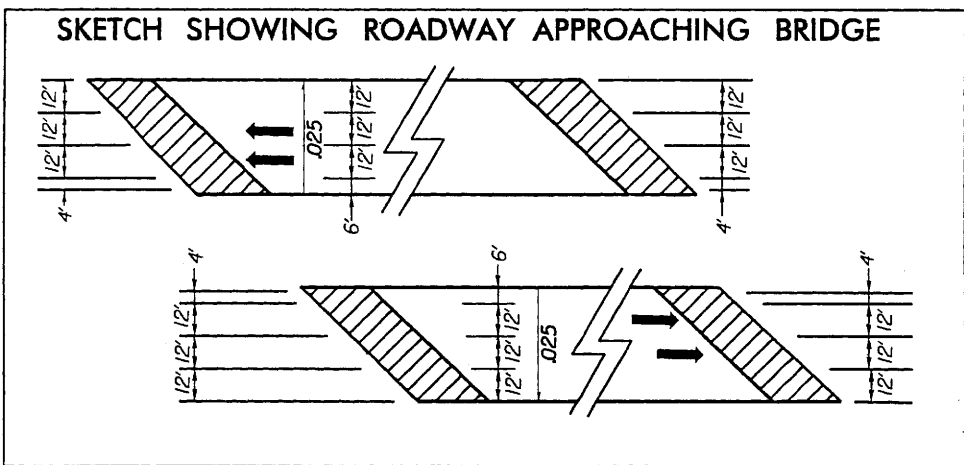

-SVRDI- CURVE DATA
PI Sta 11+40.00
Delta = 43° 59' 38.8" (RT)
D = 38' 11" 49.9"
L = 115.18'
T = 60.59'
R = 150.00'
R.O. = SEE PLANS

*NOTE A REMOVE 18" RCP & CONSTRUCT DITCH SECTION SEE DETAIL D (Y3 20+20 LT)

39 JOHN P. CASEY DB 97 - PG 59 MB 7 - PG 16

44 JEFFREY L. SUTTON DB 836 - PG 569

45 HENRY H. JOHNSON, et ux DB 931 - PG 436 DB 759 - PG 524 DB 757 - PG 16 PC L SLIDE 68, PG 136

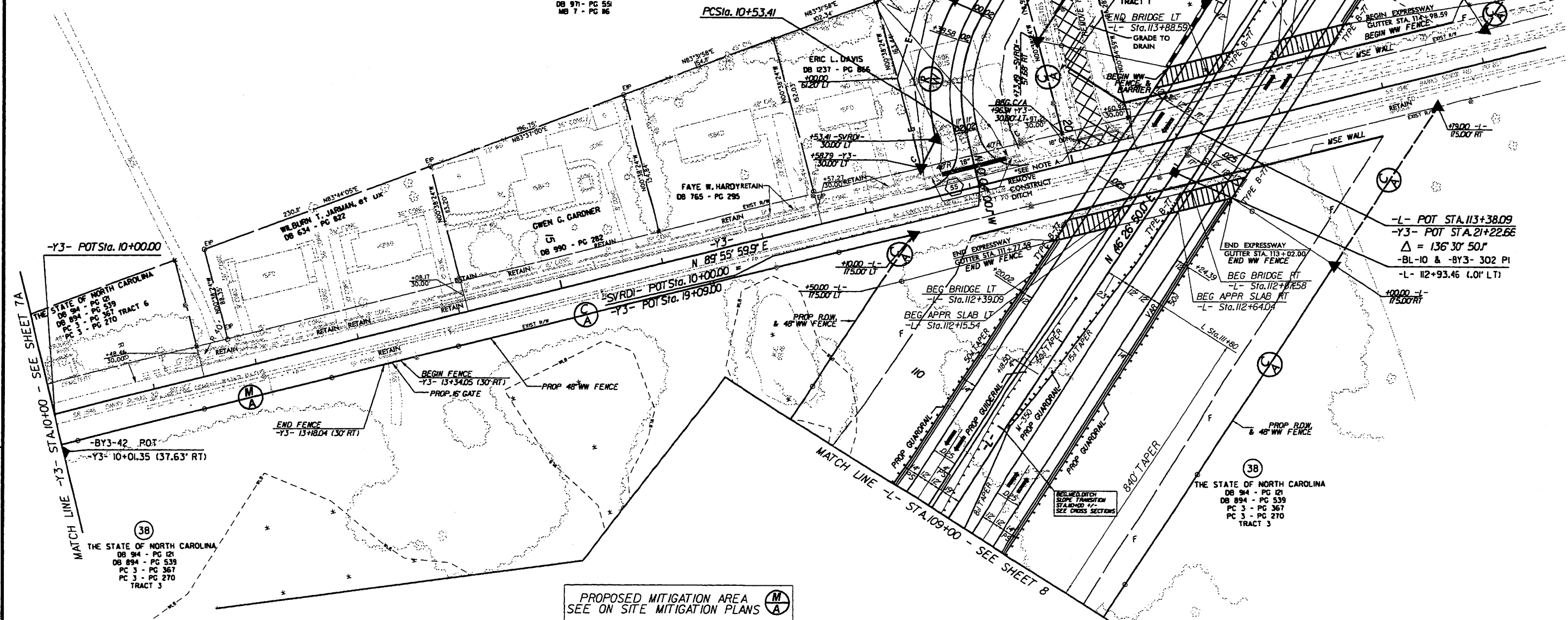

REVISIONS

MATCH LINE -Y3- STA 10+00 - SEE SHEET 7A

MATCH LINE -L- STA 109+00 - SEE SHEET 8

-L- POT STA. 113+38.09
-Y3- POT STA. 21+22.66
Delta = 136° 30' 50"
-BL-10 & -BY3- 302 PI
-L- 112+93.46 (.01' LT)

PROPOSED MITIGATION AREA SEE ON SITE MITIGATION PLANS

NOTE: STRUCTURE OVER BANKS SCHOOL ROAD DESIGNED TO ACCOMMODATE FUTURE WIDENING UNDER STRUCTURE

B/174

NOTE: FOR -L- PROFILE, SEE SHEET 40
SEE SHEET 2-L FOR DRAINAGE DITCH DETAILS
MILLED RUMBLE STRIPS SHALL BE PLACED ON -L- ACCORDING TO NCDOT STANDARD DRAWING No.665.D1

-L- CURVE DATA

PIs Sta 129+40.45	PI Sta 151+30.46
$\Theta_s = 1^\circ 30' 28.0"$	$\Delta = 47^\circ 50' 08.7" (LT)$
$L_s = 250.00'$	$D = 112^\circ 22.4'$
$LT = 166.67'$	$L = 3,965.73'$
$ST = 83.34'$	$T = 2106.68'$
	$R = 4,750.00'$
	$e = 5\%$

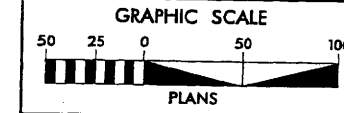

Prepared by
URS
URS Corporation - North Carolina
1600 Perimeter Park Drive
Morrisville, North Carolina 27560
TELEPHONE 1-919-461-1100 FAX 1-919-461-1418

PROJECT REFERENCE NO. R-2719A	SHEET NO. 10
R/W SHEET NO. 10	HYDRAULICS ENGINEER
ROADWAY DESIGN ENGINEER	
PRELIMINARY PLANS DO NOT USE FOR CONSTRUCTION	

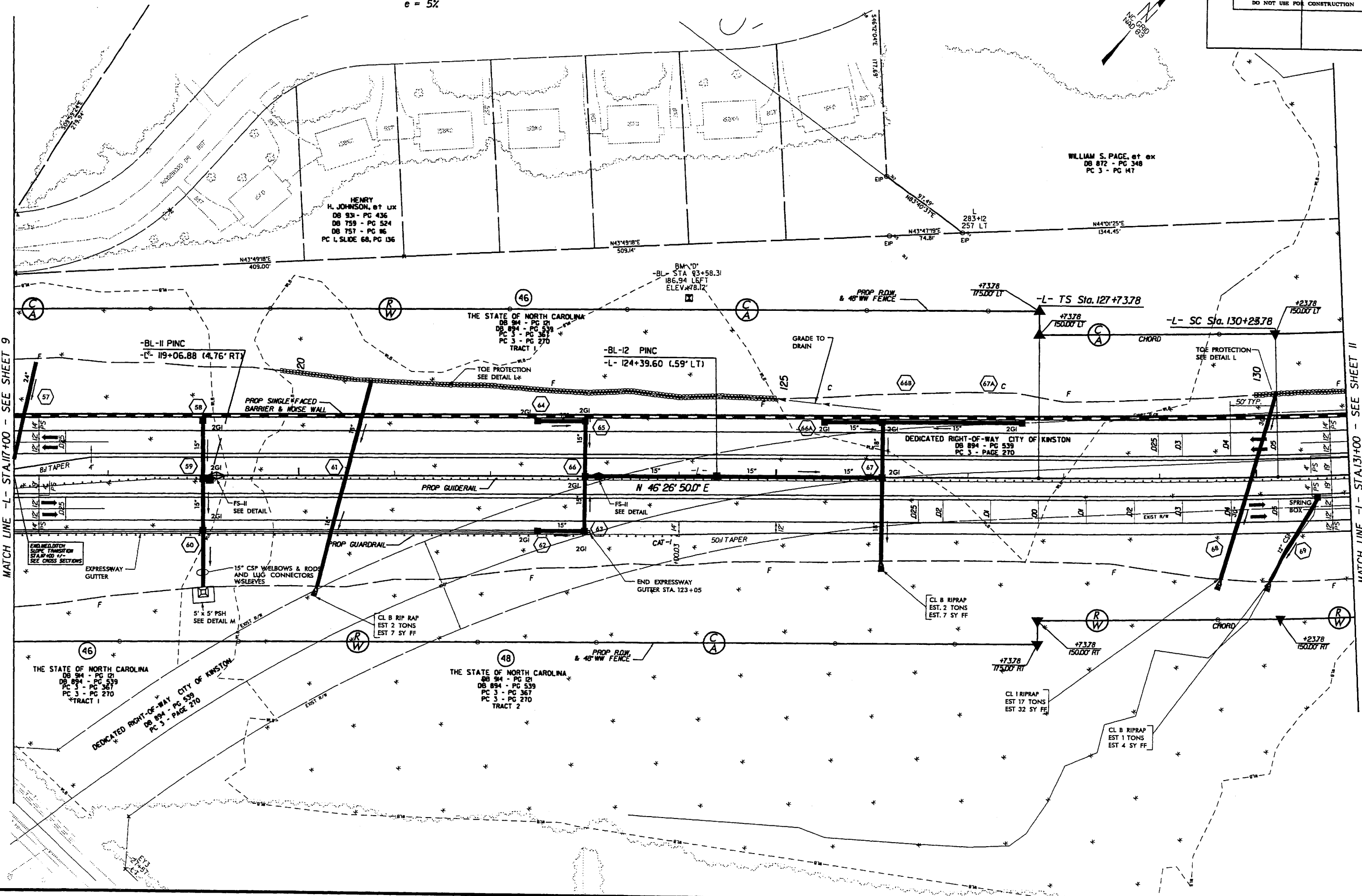

MATCH LINE -L- STA.117+00 - SEE SHEET 9

MATCH LINE -L- STA.131+00 - SEE SHEET 11

REVISIONS

7/8/2008
N:\proj\2719a_rdw.psh.10.dgn
1:00 pm
rdw

8/17

FOUNDATION RECOMMENDATION NOTES:
 1. DRIVE PILES AT END BENT NO.1 AND END BENT NO.2 TO A REQUIRED BEARING CAPACITY OF 140 TONS PER PILE. THE REQUIRED BEARING CAPACITY IS EQUAL TO THE ALLOWABLE BEARING CAPACITY WITH A MINIMUM FACTOR OF SAFETY OF TWO.
 2. THE ALLOWABLE BEARING CAPACITY FOR PILES AT END BENT NO.1 AND END BENT NO.2 IS 70 TONS PER PILE.
 3. TESTING PILES WITH THE PILE DRIVING ANALYZER (PDA) DURING DRIVING, RESTRIKING OR REDRIVING MAY BE REQUIRED. THE ENGINEER WILL DETERMINE THE NEED FOR PDA TESTING.
 4. OBSERVE A ONE-MONTH WAITING PERIOD AFTER CONSTRUCTING THE EMBANKMENT, END BENT AND REINFORCED APPROACH FILL BEFORE BEGINNING APPROACH SLAB CONSTRUCTION AT END BENT NO.1 AND END BENT NO.2.

NOTE: FOR -L- PROFILE, SEE SHEET 43
 SEE SHEET 2-L FOR DRAINAGE DITCH DETAILS
 MILLED RUMBLE STRIPS SHALL BE PLACED ON -L- ACCORDING TO NCDOT STANDARD DRAWING No.665.01
 FOR STRUCTURE DETAILS SEE STRUCTURE PLANS S- THRU S-

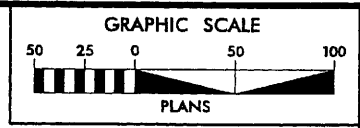

Prepared by
URS
 URS Corporation - North Carolina
 1600 Parkcenter Park Drive
 Morrisville, North Carolina 27560
 TELEPHONE (919) 461-1100 FAX (919) 461-1410

PROJECT REFERENCE NO. R-2719A	SHEET NO. 16
RAW SHEET NO. 16	
ROADWAY DESIGN ENGINEER	HYDRAULICS ENGINEER
PRELIMINARY PLANS DO NOT USE FOR CONSTRUCTION	

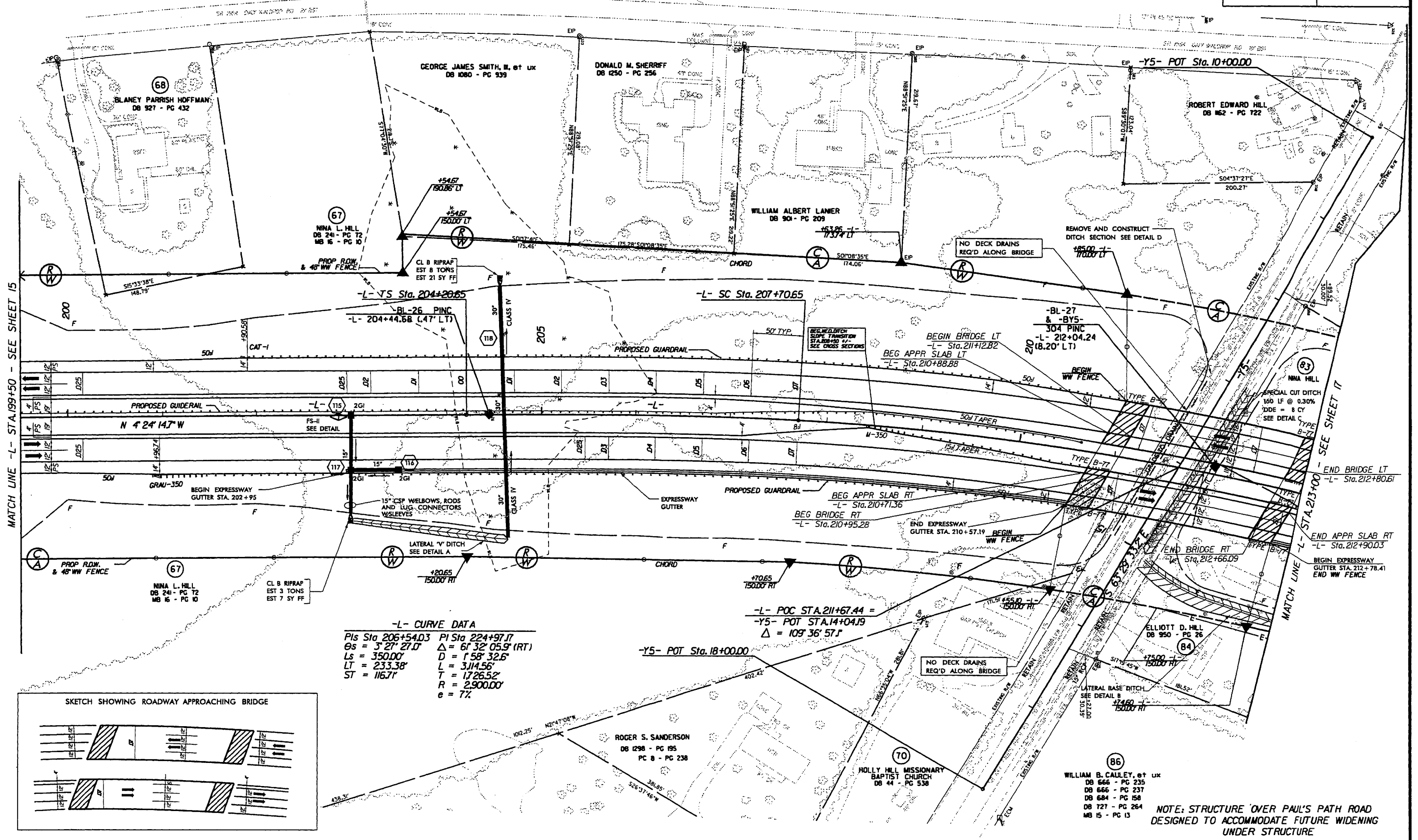

-L- CURVE DATA

PIs Sta 206+54.03	PI Sta 224+97.17
Os = 3° 27' 27.0"	Δ = 61° 32' 05.9" (RT)
Ls = 350.00'	D = 1° 58' 32.6"
LT = 233.38'	L = 3,114.56'
ST = 116.71'	T = 1,726.52'
	R = 2,900.00'
	e = 7%

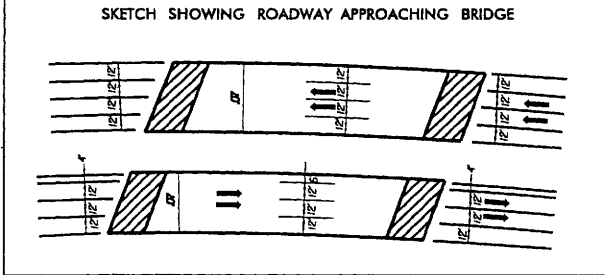

NOTE: STRUCTURE OVER PAUL'S PATH ROAD DESIGNED TO ACCOMMODATE FUTURE WIDENING UNDER STRUCTURE

REVISIONS

7/8/2008 N:\proj\2719a_rdy.psh_16.dgn

-Y24PC- CURVE DATA

PI Sta 2404252 G = 1.27 27.2 L = 350.0 LT = 523.36 ST = 1637	PI Sta 1247255 G = 5.39 24.4 L = 280.0 LT = 462.07 ST = 93.45	PI Sta 1519423 G = 7.37 12.3 L = 280.0 LT = 160.15 ST = 70.2	PI Sta 812251 G = 7.09 43.7 L = 312.0 LT = 98.43 ST = 820.0 e = 82
--	---	--	---

-Y24PC- CURVE DATA

PI Sta 812251 G = 7.09 43.7 L = 312.0 LT = 98.43 ST = 820.0 e = 82	PI Sta 1318206 G = 7.09 43.7 L = 312.0 LT = 98.43 ST = 820.0 e = 82	PI Sta 1475330 G = 7.09 43.7 L = 312.0 LT = 98.43 ST = 820.0 e = 82	PI Sta 1513190 G = 7.09 43.7 L = 312.0 LT = 98.43 ST = 820.0 e = 82
---	--	--	--

-Y24PB- CURVE DATA

PI Sta 813075 G = 3.47 43.0 (LT) L = 308.0 LT = 54.90 ST = 1500.0 e = 82	PI Sta 1015131 G = 3.47 43.0 (LT) L = 308.0 LT = 54.90 ST = 1500.0 e = 82	PI Sta 1318206 G = 7.09 43.7 L = 312.0 LT = 98.43 ST = 820.0 e = 82	PI Sta 1475330 G = 7.09 43.7 L = 312.0 LT = 98.43 ST = 820.0 e = 82	PI Sta 1513190 G = 7.09 43.7 L = 312.0 LT = 98.43 ST = 820.0 e = 82
---	--	--	--	--

-Y24PB- CURVE DATA

PI Sta 2404252 G = 1.27 27.2 L = 350.0 LT = 523.36 ST = 1637	PI Sta 1247255 G = 5.39 24.4 L = 280.0 LT = 462.07 ST = 93.45	PI Sta 1519423 G = 7.37 12.3 L = 280.0 LT = 160.15 ST = 70.2	PI Sta 812251 G = 7.09 43.7 L = 312.0 LT = 98.43 ST = 820.0 e = 82
--	---	--	---

-Y24PC- CURVE DATA

PI Sta 11349 G = 2.57 49.3 L = 200.0 LT = 134.9 ST = 67.45	PI Sta 91778 G = 1.05 37.4 (LT) L = 200.0 LT = 68.00 ST = 67.45	PI Sta 91510 G = 2.57 49.3 L = 200.0 LT = 134.9 ST = 67.45	PI Sta 91510 G = 2.57 49.3 L = 200.0 LT = 134.9 ST = 67.45
--	---	--	--

NOTES:

- FOR -L- PROFILE SEE SHEETS 44 & 45
- FOR -T- PROFILE SEE SHEETS 55 & 56
- FOR -Y24- PROFILE SEE SHEETS 65 & 66
- FOR -Y24PB- PROFILE SEE SHEETS 67 & 68
- FOR -SVRD- PROFILE SEE SHEET 62
- FOR -Y24PC- PROFILE SEE SHEET 69
- FOR -Y24LP- PROFILE SEE SHEET 67
- FOR -Y24LP- PROFILE SEE SHEET 68

SEE SHEET 20 FOR VARIABLE MILLING DETAIL ON Y24 LT
SEE SHEET 2-1 FOR DRAINAGE DITCH DETAILS
FOR CORE DETAIL SEE MCDOT STANDARD DRAWING 22503

100' OF 3" COMPACTED CONCRETE ISLAND TO BE PLACED BETWEEN THE RAMP AND LOOPS IMMEDIATELY ADJACENT TO Y24
MILLED RUMBLE STRIPS SHALL BE PLACED ON -L- ACCORDING TO MCDOT STANDARD DRAWING 22503

PROJECT REFERENCE NO. **R-2719A** SHEET NO. **75**

DATE: **11/11/10**

DESIGNED BY: **URS** DRAWN BY: **URS**

PRELIMINARY PLANS

GRAPHIC SCALE

1" = 100'

Prepared by **URS**

URS Corporation - North Carolina
1400 Piedmont Park Drive
Raleigh, North Carolina 27604
TELEPHONE: 919.489.1111 FAX: 919.489.1110

R-2719A (L/US 258 (Y24) TRAFFIC DIAGRAM

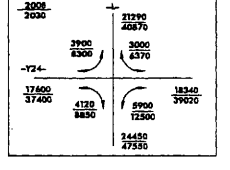

★ PROPOSED SIGNAL

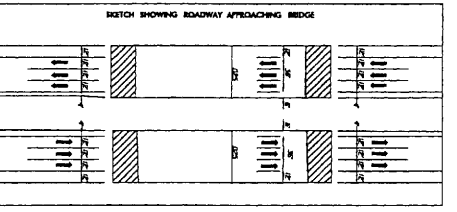
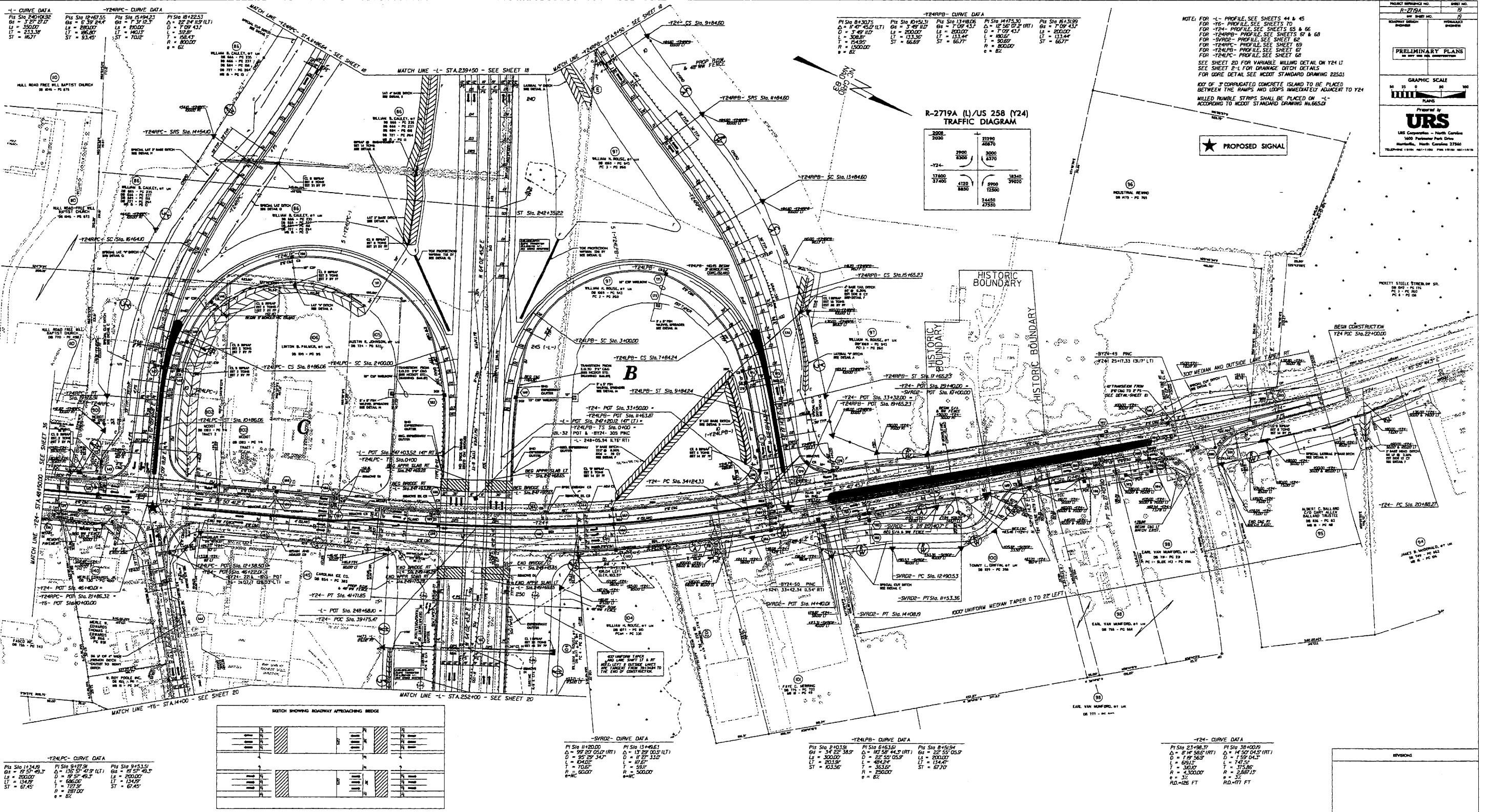

-SVRD- CURVE DATA

PI Sta 11349 G = 2.57 49.3 L = 200.0 LT = 134.9 ST = 67.45	PI Sta 91778 G = 1.05 37.4 (LT) L = 200.0 LT = 68.00 ST = 67.45	PI Sta 91510 G = 2.57 49.3 L = 200.0 LT = 134.9 ST = 67.45	PI Sta 91510 G = 2.57 49.3 L = 200.0 LT = 134.9 ST = 67.45
--	---	--	--

-Y24LP- CURVE DATA

PI Sta 2404252 G = 1.27 27.2 L = 350.0 LT = 523.36 ST = 1637	PI Sta 1247255 G = 5.39 24.4 L = 280.0 LT = 462.07 ST = 93.45	PI Sta 1519423 G = 7.37 12.3 L = 280.0 LT = 160.15 ST = 70.2	PI Sta 812251 G = 7.09 43.7 L = 312.0 LT = 98.43 ST = 820.0 e = 82
--	---	--	---

-Y24- CURVE DATA

PI Sta 21498.37 G = 6.14 58.0 (RT) L = 1.59 56.9 L = 680.0 L = 360.0 L = 375.96 R = 4300.0 e = 32 RD=126 FT	PI Sta 18400.0 G = 1.59 56.9 (RT) L = 1.59 56.9 L = 1.59 56.9 L = 375.96 R = 4300.0 e = 32 RD=117 FT
---	---