



STATE OF NORTH CAROLINA
DEPARTMENT OF TRANSPORTATION

MICHAEL F. EASLEY
GOVERNOR

LYNDO TIPPETT
SECRETARY

October 7, 2005

U. S. Army Corps of Engineers
Regulatory Field Office
151 Patton Avenue, Room 208
Asheville, NC 28801-5006

ATTN.: Mr. Steve Lund
NCDOT Coordinator

Subject: **MINOR MODIFICATION for Individual Section 404 and 401 permits for TIP R-2616** for the proposed widening of US 601 from the South Carolina State Line to north of Marion Lee Road (SR 2105) south of Monroe in Union County; NCDOT Division 10. Federal Project No. STP-NHS-601(4), State Project No. 8.1690303, WBS Element 34485.1.1.

Dear Sir:

Please reference the July 21, 2005 Individual Permit application. During the Concurrence Point 2A and 3 meeting held on March 16, 2004, NCDOT made a commitment to investigate the feasibility of a bottomless culvert at the crossing of Wicker Branch, pending geotechnical studies and further design of the project. NCDOT has determined that it is feasible to replace the existing double barrel 8'x7' reinforced concrete box culvert with a single 16'x 8' bottomless structure. This revision will reduce the impacts at Site 16 from 210' to 25' of permanent stream impact. Permanent stream impacts are necessary due to the difference between the existing stream location and the new channel in the bottomless structure. The amount of temporary linear stream impact will increase from 20' to 210' to accommodate construction of the new structure.

These changes will reduce the total permanent linear stream impact for the project from 2,969 to 2,784, and increase the temporary stream impact from 464 to 654 feet.

There will be no changes to impacts to Waters of the US at any other sites.

Revised hydraulic (permit) drawings and summary table is included in this modification.

Thank you for your assistance with this project. If you have any questions or need additional information, please contact Mr. Michael Turchy at maturchy@dot.state.nc.us or (919) 715-1468. A copy of this application will also be posted at <http://www.doh.dot.state.nc.us/preconstruct/pe/>.

Sincerely,

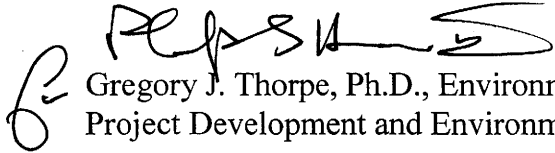

Gregory J. Thorpe, Ph.D., Environmental Management Director
Project Development and Environmental Analysis Branch

Cc list:

W/attachment

- Mr. John Hennessy, NCDWQ (7 Copies)
- Ms. Marella Buncick, USFWS
- Ms. Marla Chambers, NCWRC
- Ms. Becky Fox, USEPA – Whittier, NC
- Mr. Ronald Mikulak, USEPA – Atlanta, GA
- Mr. Clarence W. Coleman, P.E., FHWA
- Dr. David Chang, P.E., Hydraulics
- Mr. Greg Perfetti, P.E., Structure Design
- Mr. Mark Staley, Roadside Environmental
- Mr. B. G. Payne, P.E., Division Engineer, Division 10
- Mr. Larry Thompson, DEO, Division 10

W/o attachment

- Mr. Jay Bennett, P.E., Roadway Design
- Mr. Majed Alghandour, P. E., Programming and TIP
- Mr. Art McMillan, P.E., Highway Design
- Mr. Scott McLendon, USACE, Wilmington
- Ms. Beth Harmon, EEP
- Mr. Todd Jones, NCDOT External Audit Branch
- Mr. Carl Goode, PE, Human Environment Unit Head
- Mr. Mark Pierce, P.E., PDEA Project Planning Engineer

SITE 16 -L- STA. 315 + 75

PROJECT REFERENCE NO. R-2616 A&B	SHEET NO. 25
ROADWAY DESIGN ENGINEER	HYDRAULICS ENGINEER
PRELIMINARY PLANS <small>DO NOT USE FOR CONSTRUCTION</small> INCOMPLETE PLANS <small>DO NOT USE FOR E.C.V. ACQUISITION</small>	

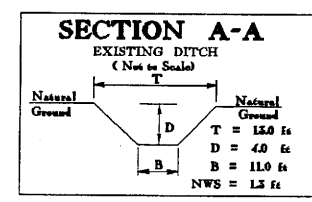
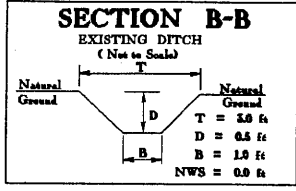

- FILL IN WETLAND
- PERMANENT SURFACE WATER IMPACT
- MECHANIZED CLEARING
- TEMPORARY SURFACE WATER IMPACT

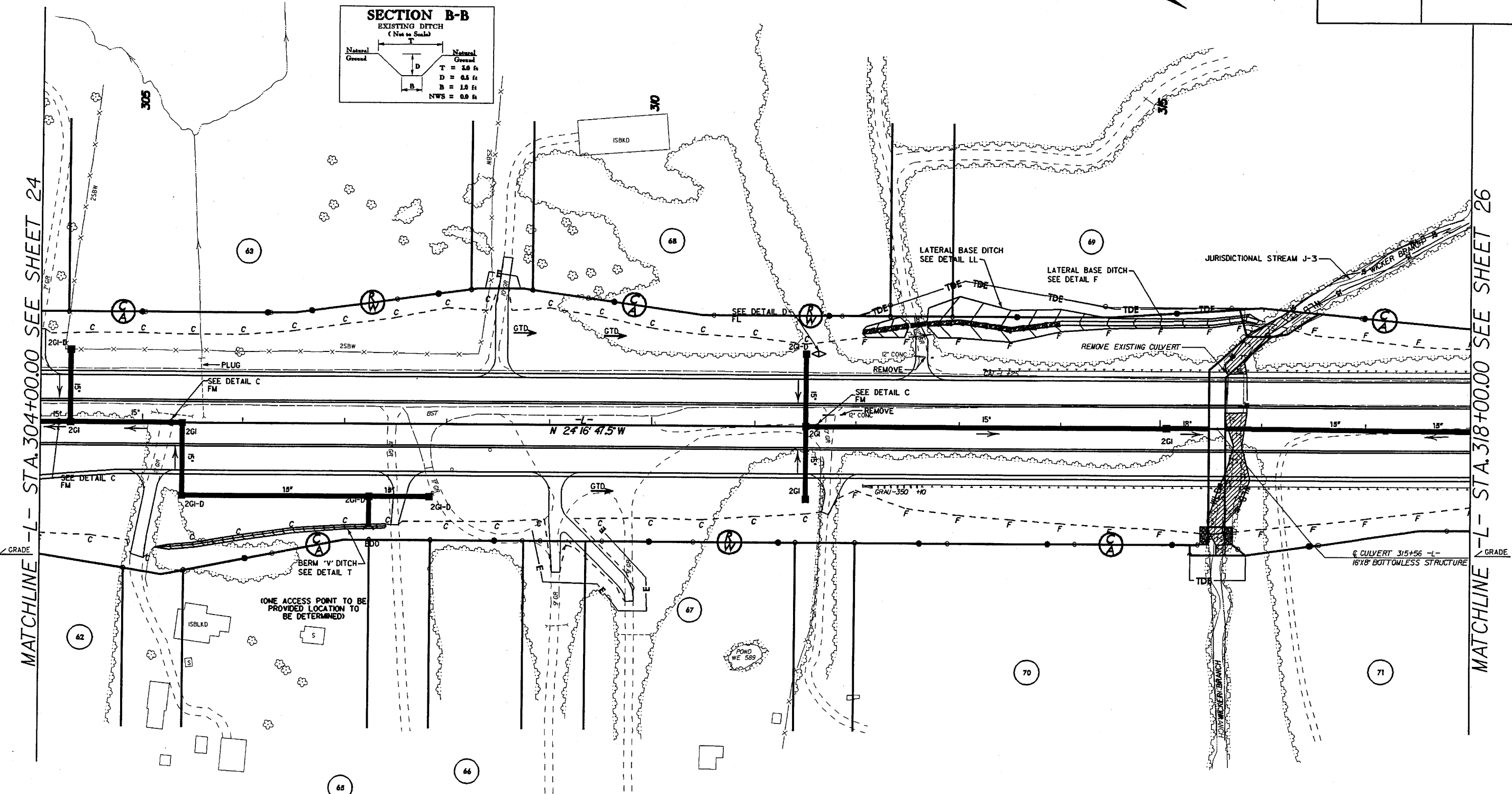
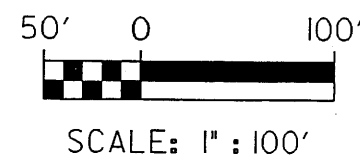

MATCHLINE -L- STA. 304+00.00 SEE SHEET 24

MATCHLINE -L- STA. 318+00.00 SEE SHEET 26



SITE 16 -L- STA. 315+75

PROJECT REFERENCE NO. R-2616 A&B	SHEET NO. 25
ROADWAY DESIGN ENGINEER	HYDRAULICS ENGINEER
PRELIMINARY PLANS <small>DO NOT USE FOR CONSTRUCTION</small>	
INCOMPLETE PLANS <small>DO NOT USE FOR CONSTRUCTION</small>	

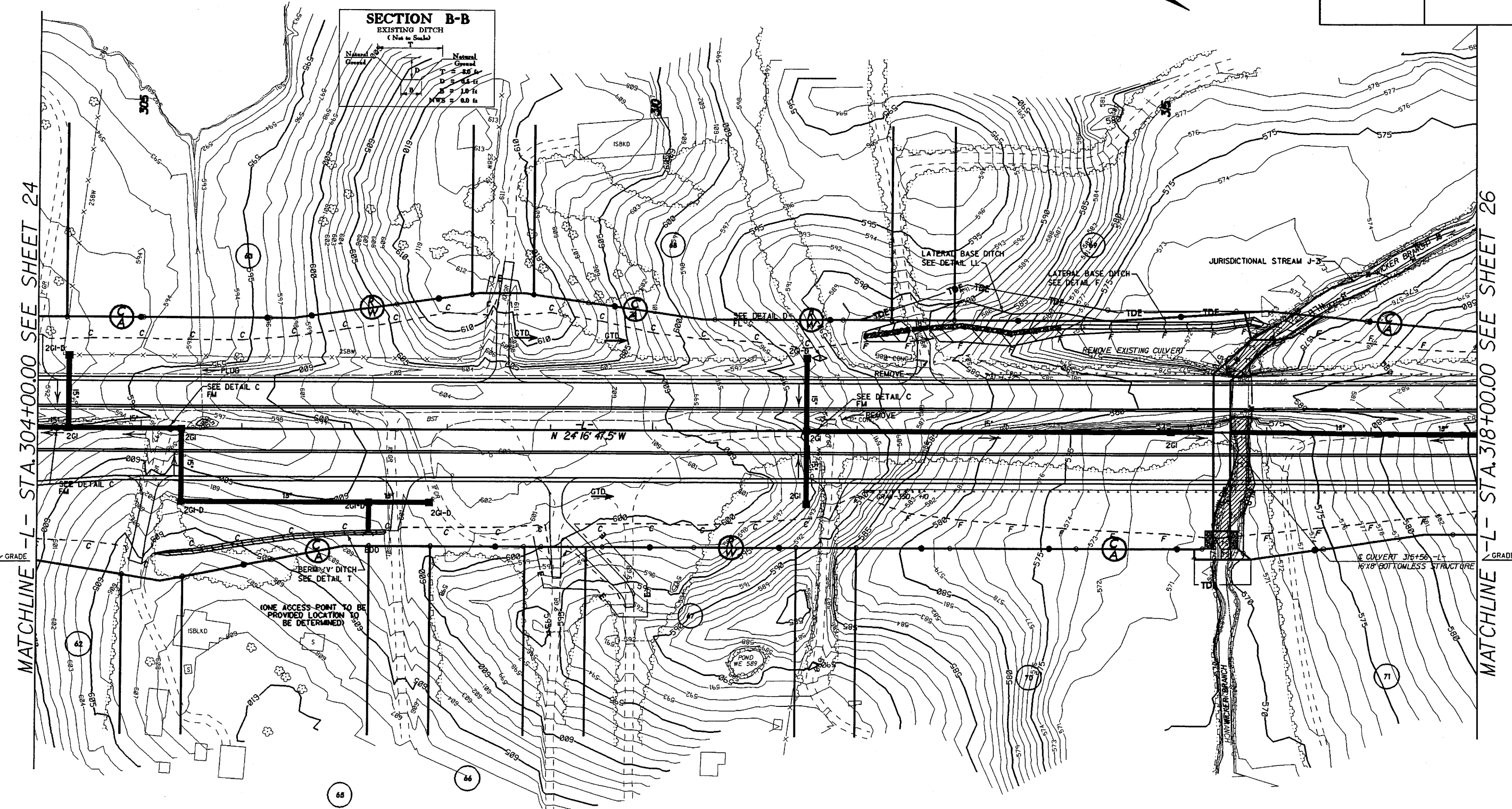

MATCHLINE -L- STA. 304+00.00 SEE SHEET 24

MATCHLINE -L- STA. 318+00.00 SEE SHEET 26

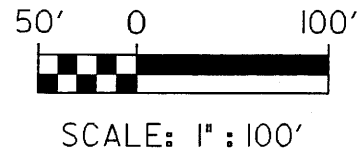
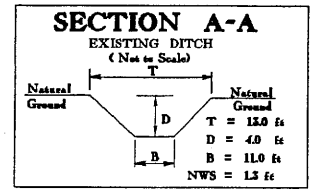
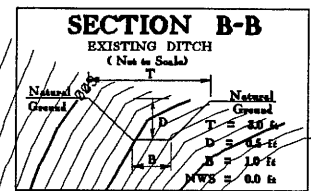

- FILL IN WETLAND
- PERMANENT SURFACE WATER IMPACT
- MECHANIZED CLEARING
- TEMPORARY SURFACE WATER IMPACT

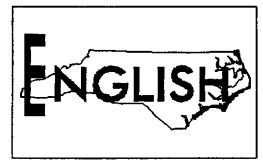

(ONE ACCESS POINT TO BE PROVIDED LOCATION TO BE DETERMINED)

N 24° 16' 41.5" W

64

65

66

71

SITE 15 -L- STA 315+75

PROJECT REFERENCE NO. I-2616 A&B	SHEET NO. 25A
ROADWAY DESIGN ENGINEER	HYDRAULICS ENGINEER
PRELIMINARY PLANS <small>DO NOT USE FOR CONSTRUCTION</small>	
INCOMPLETE PLANS <small>DO NOT USE FOR R/F ACQUISITION</small>	

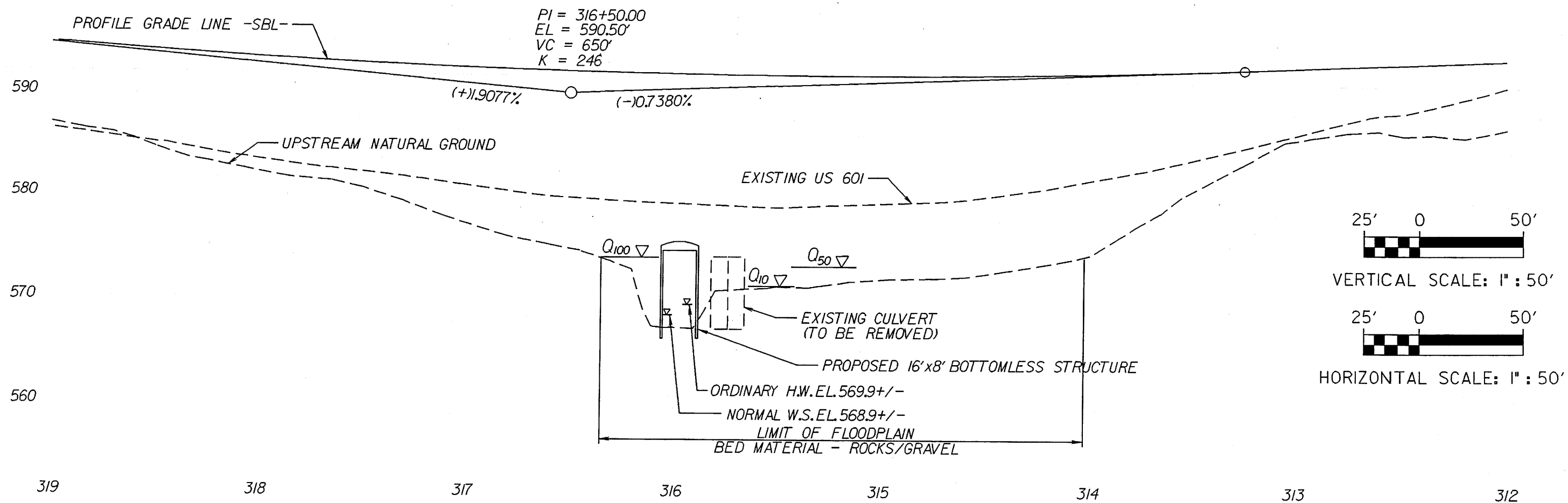

IMPACT SUMMARY

Site No.	Station (From/To)	Structure Size	WETLAND IMPACTS					SURFACE WATER IMPACTS							
			Permanent Fill In Wetlands (ac)	Temp. Fill In Wetlands (ac)	Excavation In Wetlands (ac)	Mechanized Clearing In Wetlands (ac)	Hand Clearing In Wetlands (ac)	Permanent SW Impacts (ac)	Temp. SW Impacts (ac)	Exist. Chan. Impacts Permanent (ft)	Exist. Chan Impacts Temp. (ft)	Natural Stream Design (ft)			
1	L 102+00 to 106+50	2 @ 54" RCP													
2	L 119+35	3 @ 10X8' RCBC													
3	L 129+70	(2) 2 SPAN@65' BRIDGE													
4	L 145+70	42" RCP													
5	L 180+30 RT	48" RCP													
6	L 180+30 LT	48" RCP	0.011			0.004									
7	L 180+30 to 183+00	Earthen Fill													
8	L 215+70 RT	24" RCP	0.006			0.003									
9	L 221+70 LT	Drain Pond													
10	L 231+30	54" RCP													
11	L 242+35	66" RCP													
12	L 248+30 to 251+09	48" RCP													
13	L 281+50	12'X10' RCBC													
14	L 288+00	2 @ 8X7' RCBC													
15	L 290+00 to 294+30	2 @ 30" RCP													
16	L 315+75 *	16X8' Bottomless Structure													
17	L 342+00 LT	Drain Pond													
18	L 349+50 RT	Earthen Fill & Drain Pond	0.04												
19	L 349+50 LT	Drain Pond													
20	L 400+00 RT	Drain Pond													
21	L 422+00 RT	Drain Pond													
22	L 426+03 to 430+50	54" RCP													
23	L 474+07 to 476+41	24" RCP	0.02			0.005									
24	L 534+20	48" RCP													
25	L 549+60	36" RCP	0.03			0.03									
26	L 575+85	24" RCP													
TOTALS:			0.11	0	0	0.04	0	0.029	0.001	0.29	27/84	654	210		

* Stream replacement by addition of bottomless culvert. Permanent impact of 25' due to difference between length of existing stream impact and proposed bottomless structure.

NORTH CAROLINA DEPARTMENT OF
TRANSPORTATION
UNION COUNTY
WBS - 34485.122 (R-2616)