

| STATE | STATE PROJECT REFERENCE NO. | SHEET NO. | TOTAL SHEETS |
|-----------------|-----------------------------|----------------|--------------|
| N.C. | B-5157 | 1 | |
| STATE PROJ. NO. | P.A. PROJ. NO. | DESCRIPTION | |
| 42332.1.1 | BRZ-1304(10) | P.E. | |
| 42332.2.FD1 | BRZ-1304(10) | RW & UTILITIES | |
| | | | |
| | | | |
| | | | |
| | | | |
| | | | |
| | | | |
| | | | |

**BUFFER DRAWING
SHEET 1 OF 5**

STATE OF NORTH CAROLINA
DIVISION OF HIGHWAYS

GRANVILLE COUNTY

LOCATION: BRIDGE NO. 178 OVER FOX CREEK ON SR 1304
(SUNSET ROAD)

TYPE OF WORK: GRADING, PAVING, DRAINAGE AND STRUCTURE

BUFFER IMPACTS PERMIT

NC GRID (NAD 83/NSRS 2007)

See Sheet 1-A For Index of Sheets
See Sheet 1-B For Conventional Symbols

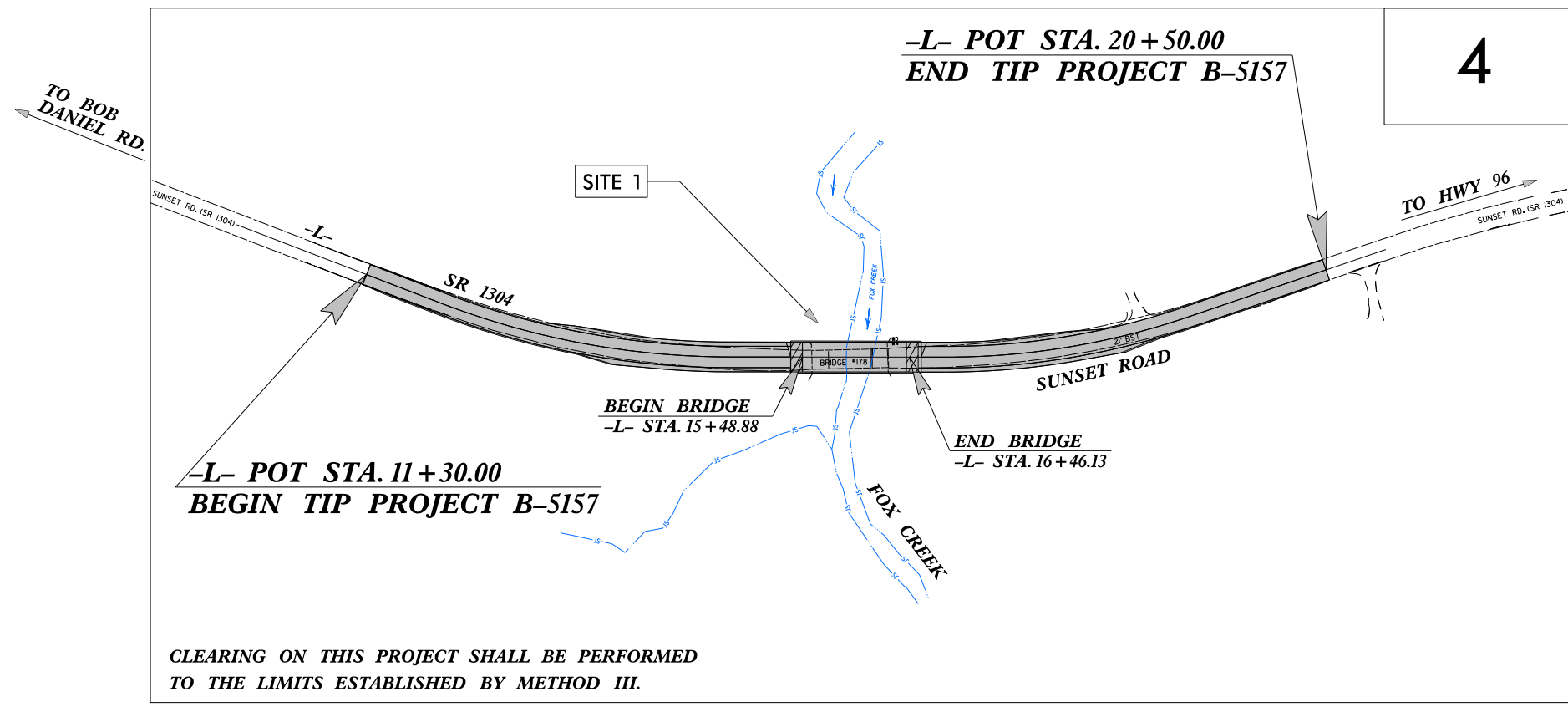
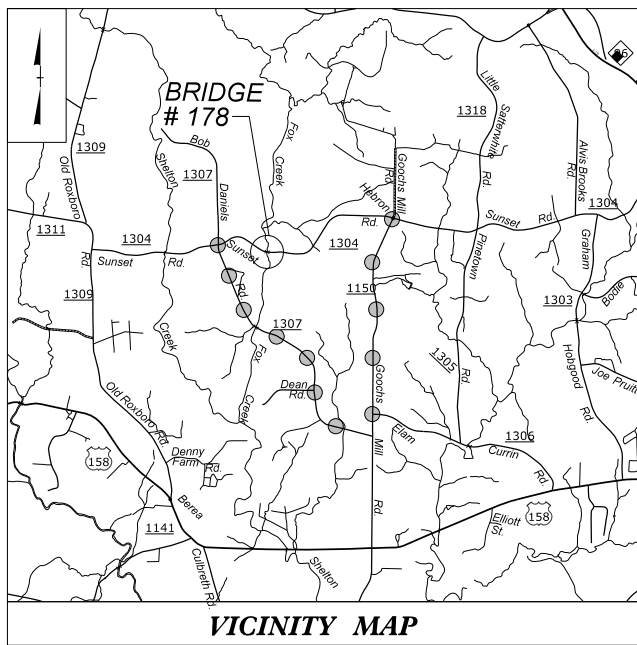

CLEARING ON THIS PROJECT SHALL BE PERFORMED TO THE LIMITS ESTABLISHED BY METHOD III.

PRELIMINARY PLANS
DO NOT USE FOR CONSTRUCTION

CONTRACT: TIP PROJECT: B-5157

CONTRACT:

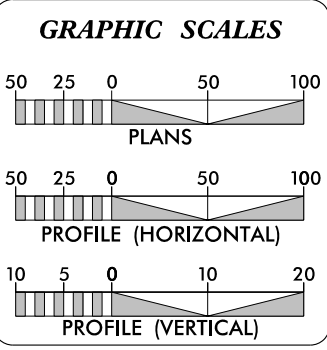

DESIGN DATA

| | |
|-------------------|-------------|
| ADT 2016 = | 225 |
| ADT 2036 = | 305 |
| K = | 10 % |
| D = | 60 % |
| T = | 5 % * |
| V = | 35 MPH |
| * TTST = | 2% DUAL 3% |
| FUNC CLASS = | RURAL LOCAL |
| SUB-REGIONAL TIER | |

PROJECT LENGTH

| | | |
|--|---|-------------|
| LENGTH OF ROADWAY TIP PROJECT B-5157 | = | 0.156 MILES |
| LENGTH OF STRUCTURE TIP PROJECT B-5157 | = | 0.018 MILES |
| TOTAL LENGTH TIP PROJECT B-5157 | = | 0.174 MILES |

Prepared in the Office of:

SUNGATE DESIGN GROUP, P.A.
915 JONES FRANKLIN ROAD
 WAKEFELD, NORTH CAROLINA 27169
 TEL (919) 859-2243 FAX (919) 859-6258
 ENG. PERM. LICENSE NO. C-499

Stantec
Stantec Consulting Services Inc.
 801 Jones Franklin Road Suite 300
 Raleigh, NC 27606
 Tel. (919) 851-6866 Fax. (919) 851-7024 www.stantec.com License No. F-0072

for the North Carolina Department of Transportation

| | |
|--------------------------------------|---|
| 2012 STANDARD SPECIFICATIONS | STANTEC CONTACT |
| RIGHT OF WAY DATE: APRIL 23, 2015 | STEVE SMALLWOOD, P.E. PROJECT ENGINEER |
| LETTING DATE: APRIL 19, 2016 | NCDOT CONTACT: RON MCCOLLUM, P.E. |

HYDRAULICS ENGINEER

SIGNATURE: _____ P.E.

ROADWAY DESIGN ENGINEER

SIGNATURE: _____ P.E.

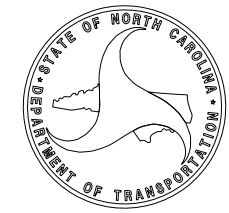

09/08/09
5/13/2015
B-5157_Hyd_prm_buf_tsh.dgn
bsmith

BUFFER IMPACTS PERMIT

BUFFER DRAWING SHEET 2 OF 5

| | |
|---|---------------------|
| PROJECT REFERENCE NO. B-5157 | SHEET NO. 04 |
| RW SHEET NO. | |
| ROADWAY DESIGN ENGINEER | HYDRAULICS ENGINEER |
| PRELIMINARY PLANS DO NOT USE FOR CONSTRUCTION | |

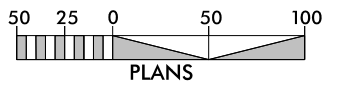

- ALLOWABLE IMPACTS ZONE 1
- ALLOWABLE IMPACTS ZONE 2

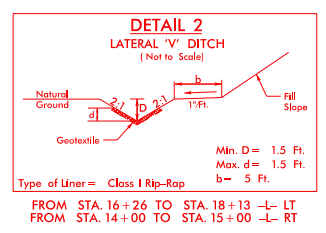
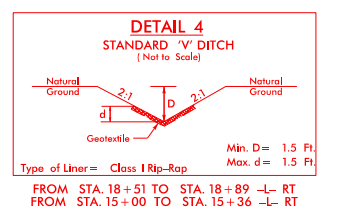
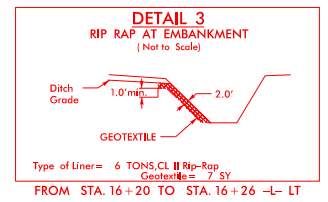
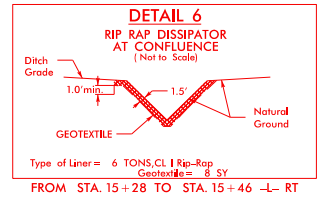
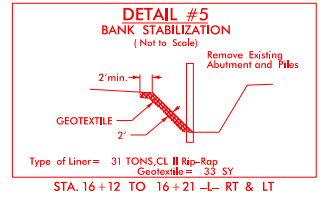
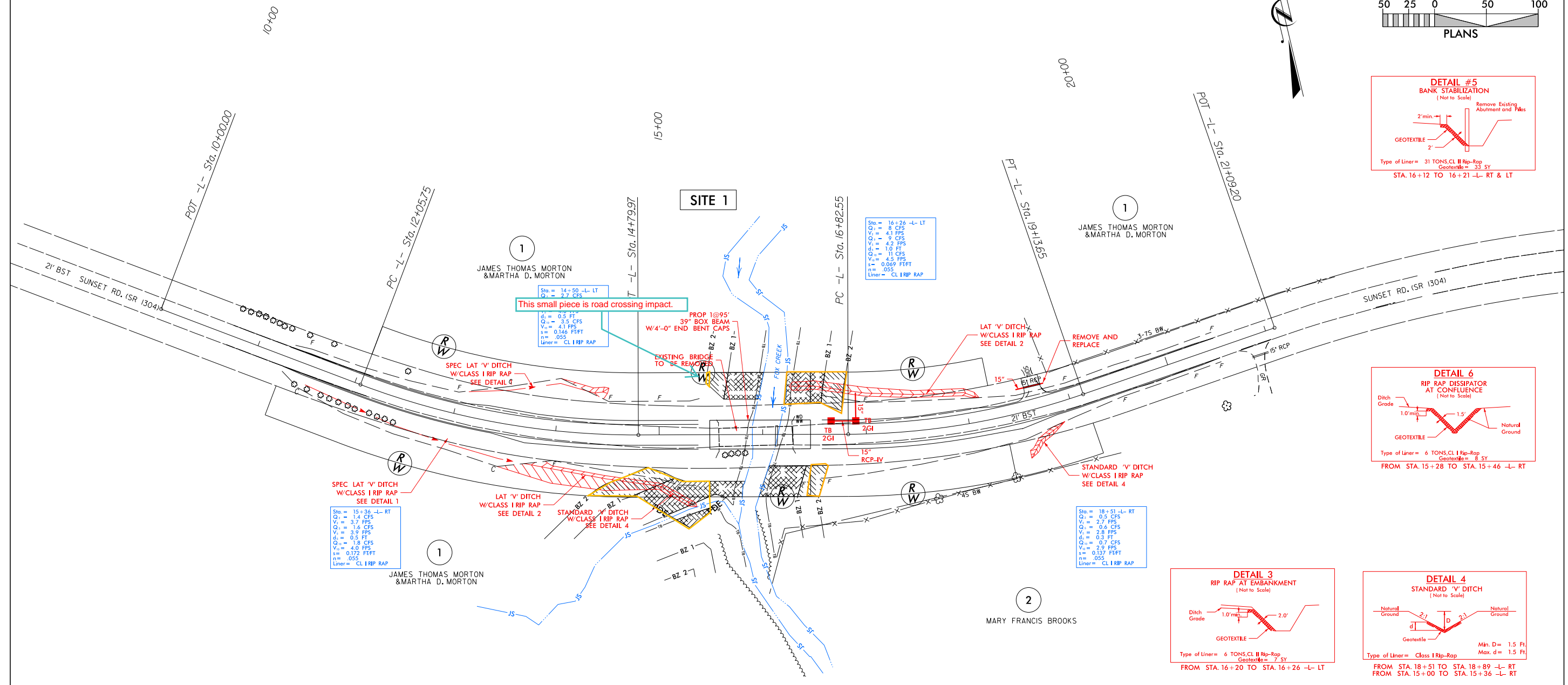

5/14/99

BUFFER IMPACTS PERMIT

BUFFER DRAWING SHEET 3 OF 5

| | |
|---|---------------------|
| PROJECT REFERENCE NO. B-5157 | SHEET NO. 04 |
| RW SHEET NO. | |
| ROADWAY DESIGN ENGINEER | HYDRAULICS ENGINEER |
| PRELIMINARY PLANS DO NOT USE FOR CONSTRUCTION | |

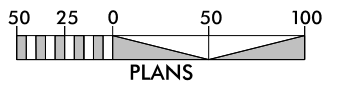

- ALLOWABLE IMPACTS ZONE 1
- ALLOWABLE IMPACTS ZONE 2

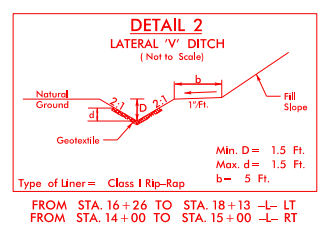
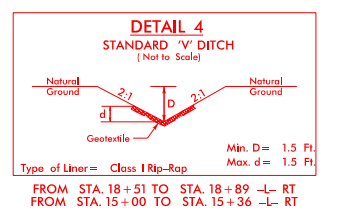
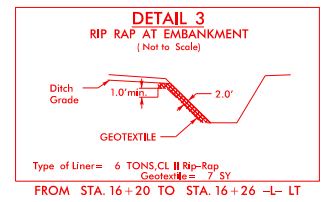
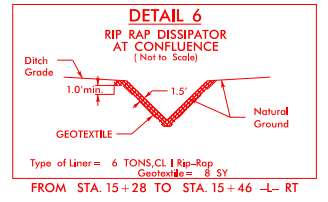
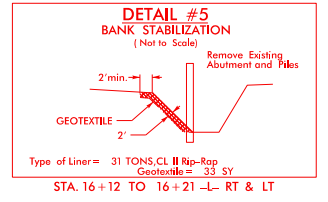
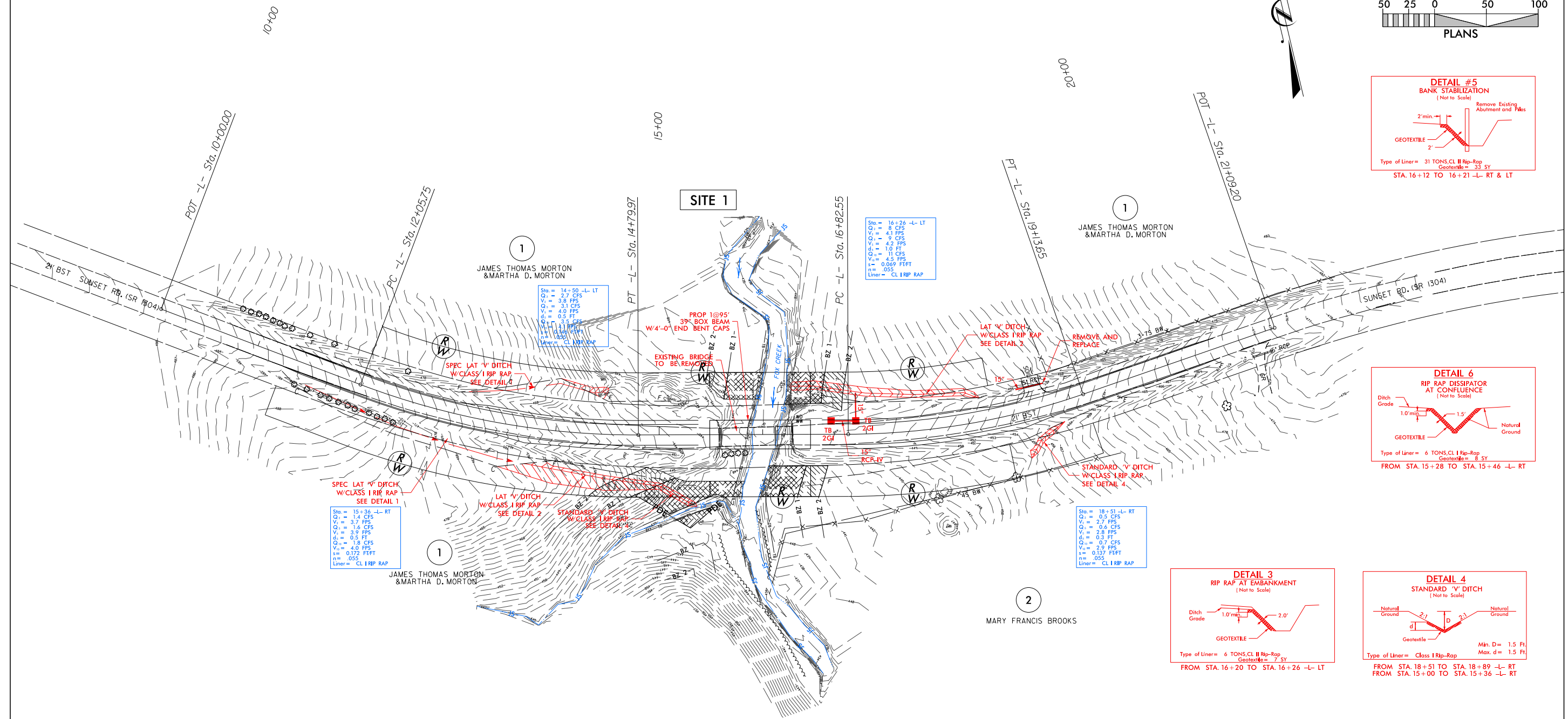

5/13/2015
B-5157-Hyd-prm-buf_psn04.dgn
bam:tkh

BUFFER IMPACTS SUMMARY

| | | | IMPACT | | | | | | | | | BUFFER REPLACEMENT | |
|---------------|-----------------------|--------------------|---------------|--------|-----------------|---------------------------|---------------------------|--------------------------|---------------------------|---------------------------|--------------------------|---------------------------|---------------------------|
| SITE NO. | STRUCTURE SIZE / TYPE | STATION (FROM/TO) | TYPE | | | ALLOWABLE | | | MITIGABLE | | | ZONE 1 (ft ²) | ZONE 2 (ft ²) |
| | | | ROAD CROSSING | BRIDGE | PARALLEL IMPACT | ZONE 1 (ft ²) | ZONE 2 (ft ²) | TOTAL (ft ²) | ZONE 1 (ft ²) | ZONE 2 (ft ²) | TOTAL (ft ²) | | |
| 1 | 1 @ 95' BRIDGE | 15+50 TO 16+45 -L- | | X | | 3150 | 576 | 3726 | | | | | |
| 1 | IMPACTS TO UT -L- RT | 14+35 TO 15+50 -L- | | | X | 1754 | 1179 | 2933 | | | | | |
| 1 | -L- LT | 15+45 TO 15+50 -L- | X | | | 0 | 37 | 37 | | | | | |
| 1 | -L- LT & RT | 16+45 TO 16+81 -L- | X | | | 360 | 1050 | 1410 | | | | | |
| | | | | | | | | | | | | | |
| | | | | | | | | | | | | | |
| | | | | | | | | | | | | | |
| | | | | | | | | | | | | | |
| | | | | | | | | | | | | | |
| | | | | | | | | | | | | | |
| | | | | | | | | | | | | | |
| | | | | | | | | | | | | | |
| | | | | | | | | | | | | | |
| | | | | | | | | | | | | | |
| | | | | | | | | | | | | | |
| | | | | | | | | | | | | | |
| TOTAL: | | | | | | 5264 | 2842 | 8106 | 0 | 0 | 0 | | |

N.C. DEPT. OF TRANSPORTATION
 DIVISION OF HIGHWAYS

 GRANVILLE COUNTY
 PROJECT: 42332.1.1 (B-5157)

 5/8/2015
 SHEET 4 OF 5

WETLANDS IN BUFFER IMPACTS SUMMARY

| SITE NO. | STATION (FROM/TO) | WETLANDS IN BUFFERS | |
|---------------|----------------------|------------------------------|------------------------------|
| | | ZONE 1 (ft ²) | ZONE 2 (ft ²) |
| 1 | 11+30 TO 20+50 -L- | 0 | 0 |
| | | | |
| | | | |
| | | | |
| | | | |
| | | | |
| | | | |
| | | | |
| | | | |
| | | | |
| | | | |
| | | | |
| | | | |
| | | | |
| | | | |
| | | | |
| | | | |
| | | | |
| | | | |
| | | | |
| TOTAL: | | 0 | 0 |

N.C. DEPT. OF TRANSPORTATION
DIVISION OF HIGHWAYS

GRANVILLE COUNTY
PROJECT: 42332.1.1 (B-5157)

5/8/2015
SHEET 5 OF 5