



STATE OF NORTH CAROLINA
DEPARTMENT OF TRANSPORTATION

PAT L. MCCRORY
GOVERNOR

ANTHONY J. TATA
SECRETARY

September 16, 2013

U. S. Army Corps of Engineers
Regulatory Field Office
151 Patton Avenue, Room 208
Asheville, NC 28801-5006

ATTN: Mr. Steven Kichefski
NCDOT Coordinator

Subject: **Modification of Section 404 Nationwide Permit 13 and 33 and Section 401 Water Quality Certification** for the proposed replacement of Bridge No. 215 over Mountain Creek on SR 1542 in Stanly County, Federal Aid Project No. BRZ-1542(7), Division 10, TIP No. B-5137, Debit \$240 from WBS 42296.1.1.

Reference: Section 404 Nationwide 13 and 33 Permit, Action ID 2012-00790 issued July 25, 2013.
Section 401 Water Quality Certification, DWQ No. 13-0718, issued July 23, 2013.

Dear Sir:

Due to Division concerns regarding the stability of the existing bank under the bridge during the construction of the new eastern bent, the design has been modified to include 70 additional linear feet of bank stabilization in this location. This revised design will preserve the integrity of the channel profile under the bridge during and after construction. It will result in an increase of bank stabilization impacts from 8 to 78 linear feet. It does not constitute loss of water and does not require mitigation.

Due to the increased bank stabilization, a portion of the location of the <0.01 ac (10 linear feet) of temporary impact has been shifted to the north end of the stabilization.

MAILING ADDRESS:
NC DEPARTMENT OF TRANSPORTATION
PROJECT DEVELOPMENT AND ENVIRONMENTAL ANALYSIS
1598 MAIL SERVICE CENTER
RALEIGH NC 27699-1598

TELEPHONE: 919-707-6000
FAX: 919-212-5785
WEBSITE: NCDOT.GOV

LOCATION:
CENTURY CENTER, BUILDING B
1020 BIRCH RIDGE DRIVE
RALEIGH NC 27610

All other impacts remain as stated in the July 10, 2013 application and subsequent permits. Please see enclosed revised permit sheets.

A copy of this permit modification request and its distribution list will be posted on the NCDOT Website at: <http://connect.ncdot.gov/resources/Environmental/Pages>. If you have any questions or need additional information, please call Erin Cheely at (919) 707-6108.

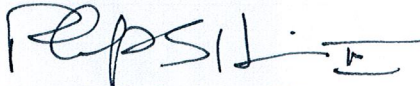

Sincerely,



Deborah M. Barbour, PE
Director of Preconstruction

cc:

NCDOT Permit Application Standard Distribution List

PROJECT REFERENCE NO. B-5137	SHEET NO. 4
RW SHEET NO.	
ROADWAY DESIGN ENGINEER	HYDRAULICS ENGINEER
PRELIMINARY PLANS DO NOT USE FOR CONSTRUCTION	

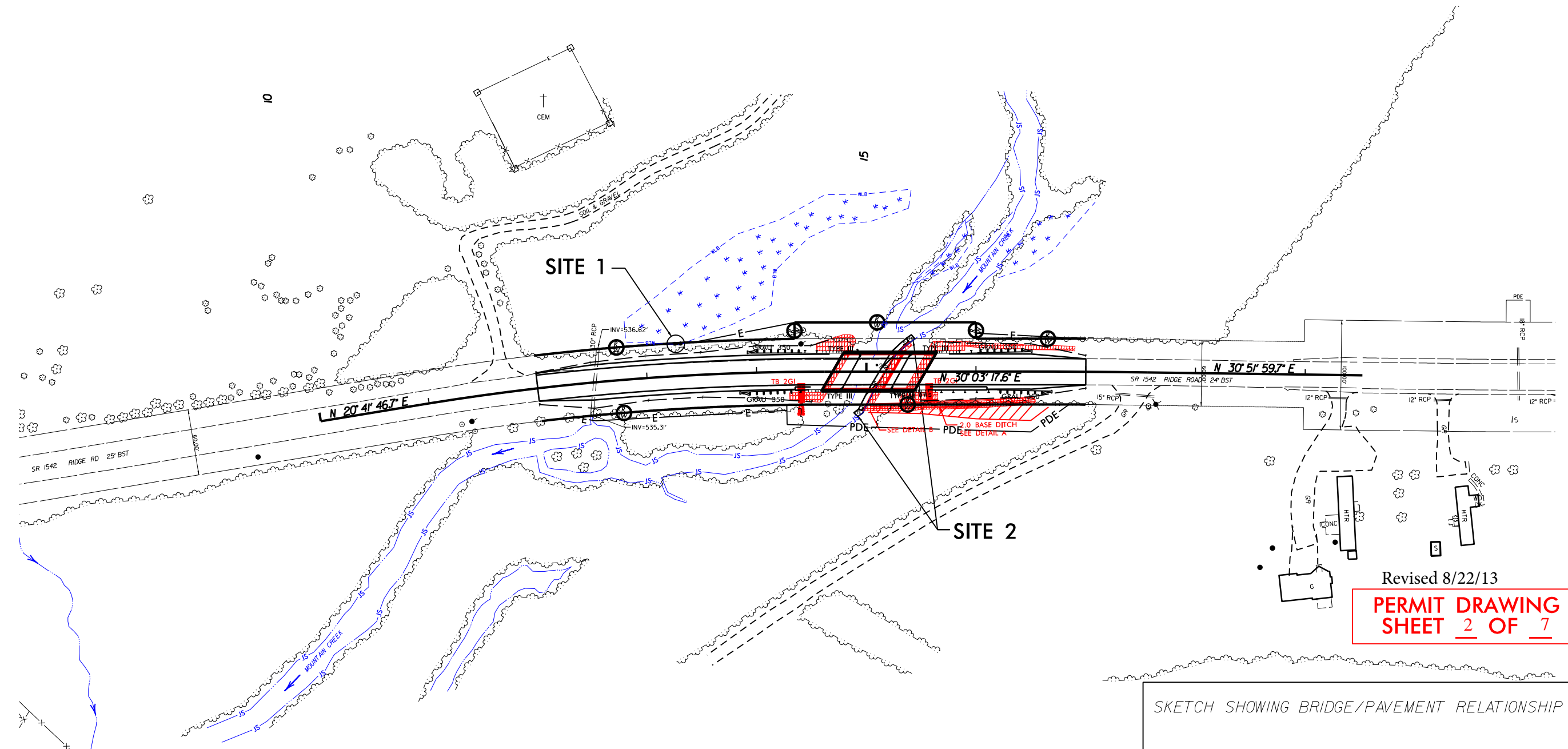
-  DENOTES IMPACTS IN SURFACE WATER
-  DENOTES TEMPORARY IMPACTS IN SURFACE WATER
-  DENOTES MECHANIZED CLEARING



Revised 8/22/13
PERMIT DRAWING SHEET 2 OF 7

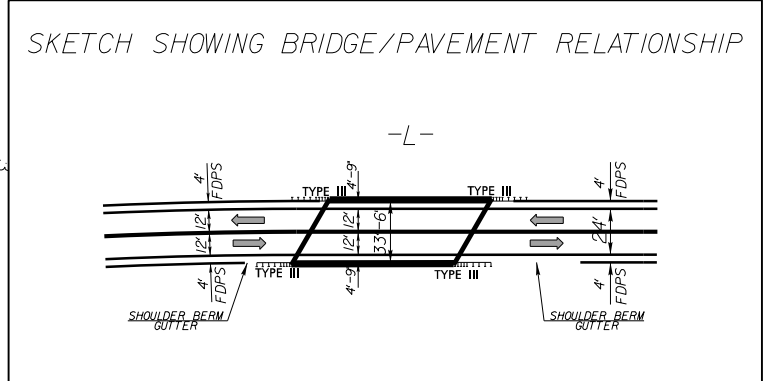
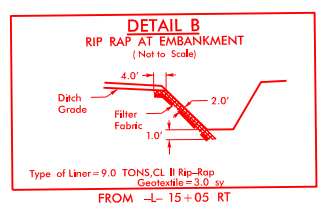
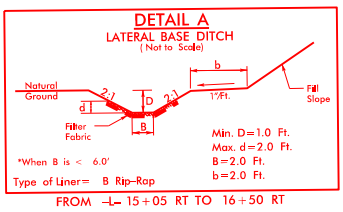
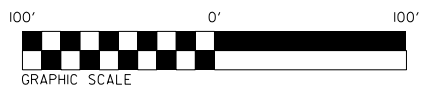



REVISIONS
 B.M. Rev. Corrected of set distance for proposed R.W. L. and Rt. of Sta. 17+00.00 -L- -WLB JL/29/12

4/2/2013
 R. Johnson
 R. Hydraulics Permits Environmental Drawings
 \$\$\$\$\$\$SYTIME\$\$\$\$\$\$
 \$\$\$\$\$\$DGN\$\$\$\$\$\$
 \$\$\$\$\$\$\$\$\$\$\$\$

8/17/99

PROJECT REFERENCE NO. B-5137	SHEET NO. 4
RW SHEET NO.	HYDRAULICS ENGINEER
ROADWAY DESIGN ENGINEER	HYDRAULICS ENGINEER
PRELIMINARY PLANS DO NOT USE FOR CONSTRUCTION	

-  DENOTES IMPACTS IN SURFACE WATER
-  DENOTES TEMPORARY IMPACTS IN SURFACE WATER
-  DENOTES MECHANIZED CLEARING

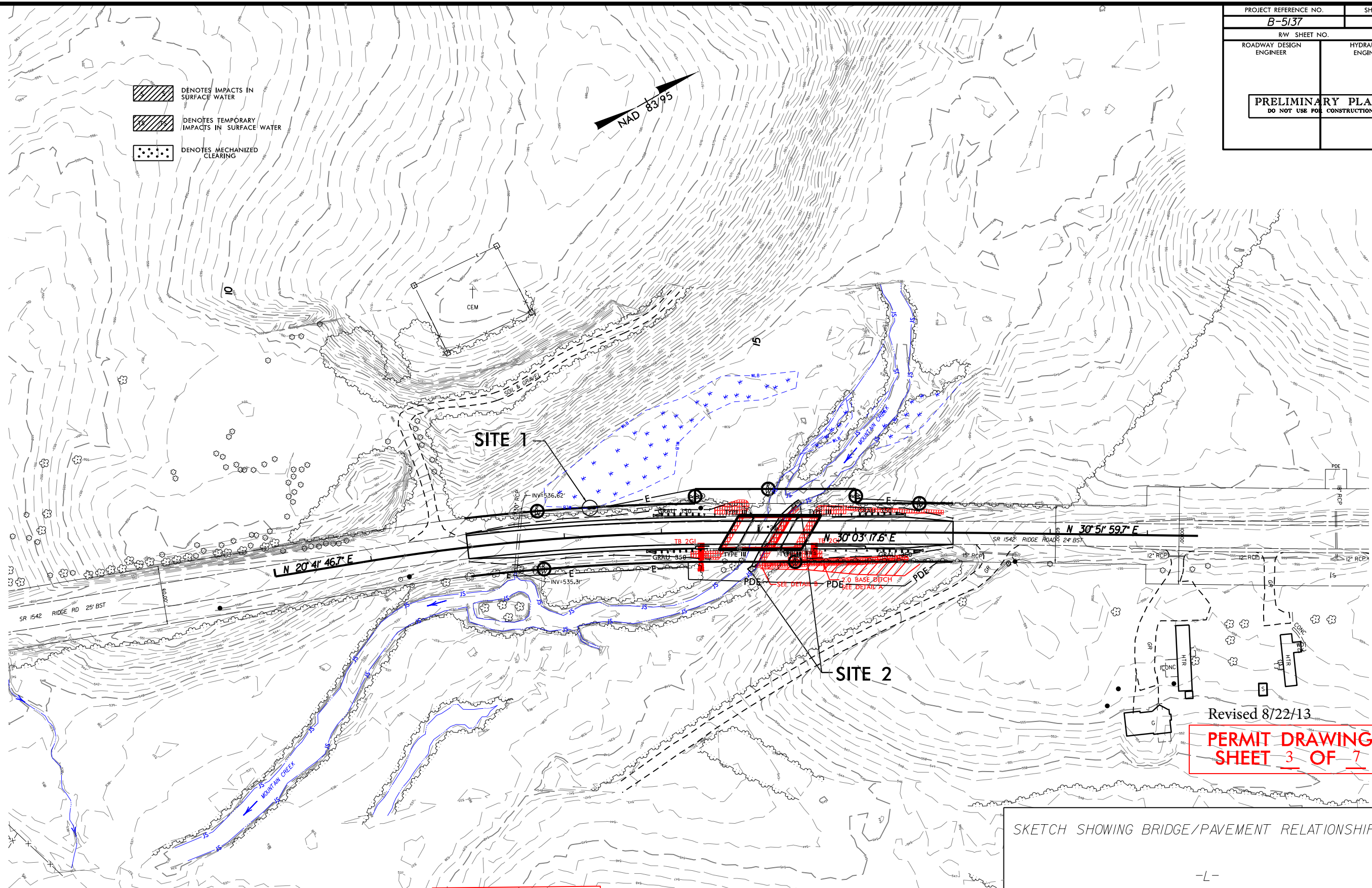

Revised 8/22/13
PERMIT DRAWING
SHEET 3 OF 7

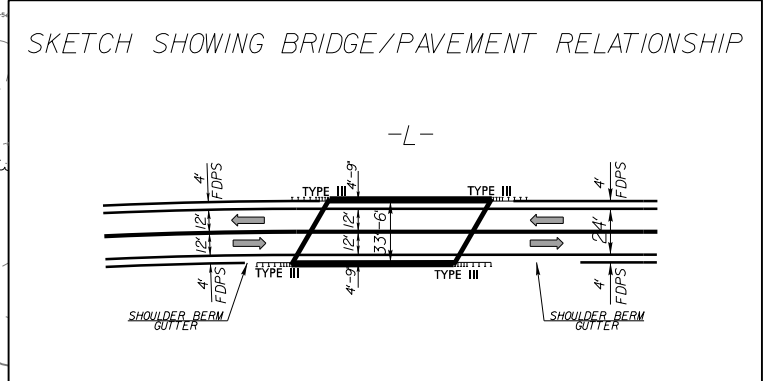
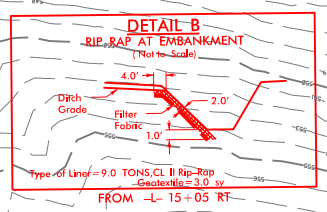
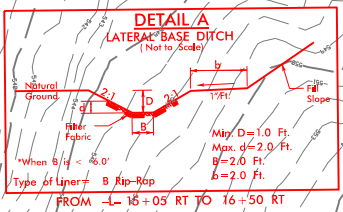
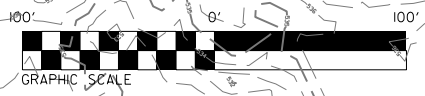

REVISIONS
 B.M. Rev. Corrected of set distance for proposed R.W. L. and Rt. of Sta. IZ +00.00 -L- -WLB JL/29/12

4/2/2013
 R. Hydrolics Permits Environmental Drawings
 \$\$\$\$\$\$SYTIME\$\$\$\$\$\$
 \$\$\$\$\$\$DGN\$\$\$\$\$\$
 \$\$\$\$\$\$PRINT\$\$\$\$\$\$

PROJECT REFERENCE NO.	SHEET NO.
RW SHEET NO.	
ROADWAY DESIGN ENGINEER	HYDRAULICS ENGINEER
INCOMPLETE PLANS DO NOT USE FOR A/W ACQUISITION	
PRELIMINARY PLANS DO NOT USE FOR CONSTRUCTION	

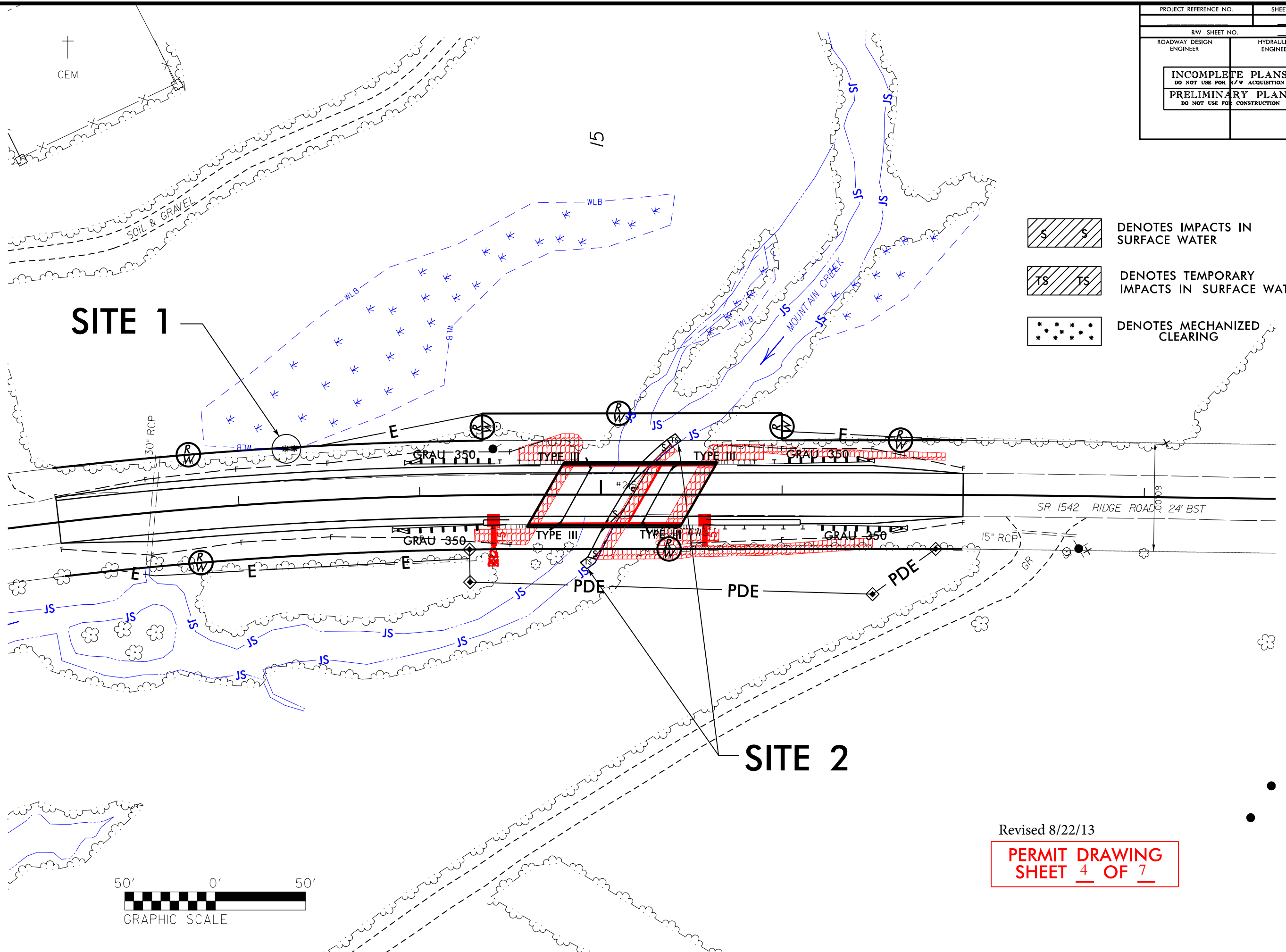

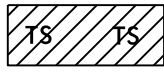
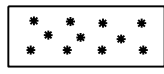
-  DENOTES IMPACTS IN SURFACE WATER
-  DENOTES TEMPORARY IMPACTS IN SURFACE WATER
-  DENOTES MECHANIZED CLEARING

Revised 8/22/13
PERMIT DRAWING
SHEET 4 OF 7

4/22/2013
 R:\Hydraulics\Permits\Environmental\Drawing
 Idclawson
 8/17/99
 REVISIONS
 \$\$\$\$\$\$SYTIME\$\$\$\$\$\$
 \$\$\$\$\$\$DGN\$\$\$\$\$\$
 \$\$\$\$\$\$PRIN\$\$\$\$\$\$

5/14/99

PROJECT REFERENCE NO. SHEET NO.

B-5137 5

ROADWAY DESIGN ENGINEER

HYDRAULICS ENGINEER

PRELIMINARY PLANS
DO NOT USE FOR CONSTRUCTION

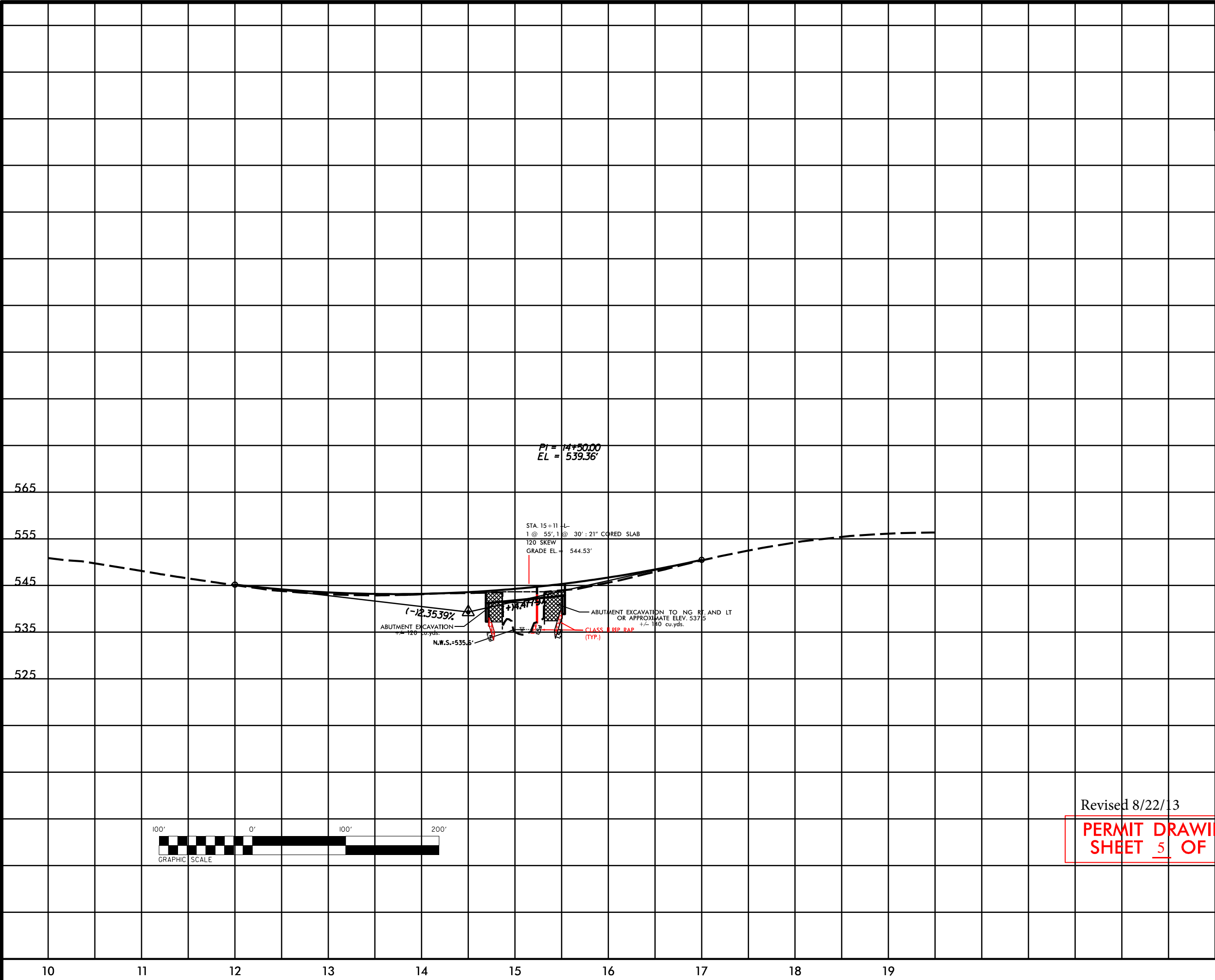

Revised 8/22/13
PERMIT DRAWING
SHEET 5 OF 7

4/2/2013
 Idlawson
 R:\Hydraulics\Permits_Env\Drawing

WETLAND PERMIT IMPACT SUMMARY

Site No.	Station (From/To)	Structure Size / Type	WETLAND IMPACTS					SURFACE WATER IMPACTS				
			Permanent Fill In Wetlands (ac)	Temp. Fill In Wetlands (ac)	Excavation in Wetlands (ac)	Mechanized Clearing in Wetlands (ac)	Hand Clearing in Wetlands (ac)	Permanent SW impacts (ac)	Temp. SW impacts (ac)	Existing Channel Impacts Permanent (ft)	Existing Channel Impacts Temp. (ft)	Natural Stream Design (ft)
1	13+30 Lt.					<.01						
2	15+00 Rt.	Bank Stabilization						<.01	<.01	78	10	
TOTALS:						<.01		<.01	<.01	78	10	

NC DEPARTMENT OF TRANSPORTATION
 DIVISION OF HIGHWAYS

 COUNTY
 WBS - 42296.1.1 (B-5137)
 Revised 8/22/13
 SHEET **7 of 7**
 8/21/2013