



PAT McCrory  
Governor

NICHOLAS J. TENNYSON  
Secretary

October 20, 2016

Mr. Stephen Lane  
N.C. Dept. of Environmental Quality  
Division of Coastal Management  
400 Commerce Avenue  
Morehead City, NC 28557

Subject: **Minor Modification Request for the CAMA Major Development Permit** for the replacement of Bridge No. 16 over the Intracoastal Waterway on NC 210/50 in Pender County, North Carolina; TIP No. B-4929; Federal Aid Project No. BRSTP-50(10); Debit \$100 from WBS No. 40233.1.1

Reference: CAMA Major Development Permit No. 60-16 issued May 27, 2016

Dear Sir:

The NCDOT is requesting a Minor Modification for CAMA Major Development Permit #60-16. The contractor has proposed modifying the work bridge by reducing the out-to-out width from 40' to 30', finger widths from 40' to 30', as well as, placing them directly over the permanent bents. Four 30' wide fingers would be added to the back side of the trestle, so cranes can be moved off of the main line trestle. These fingers are at approximately 24+50 RT, 30+00 RT, 44+50 and 50+75. In addition, temporary fenders are proposed at Bents 14 and 15 to protect crews and structures during construction. Please see the attached work trestle plans.

NCDOT will continue to follow all other conditions of the CAMA permit, as originally authorized.

If you have any questions or need additional information, please contact Tyler Stanton at [tstanton@ncdot.gov](mailto:tstanton@ncdot.gov) or (919) 707-6156.

Sincerely,

A handwritten signature in black ink, appearing to read 'PHILIP S. HARRIS III', written over a horizontal line.

 Philip S. Harris III, P.E., C.P.M.  
Natural Environment Section Head

cc: Cathy Brittingham, NCDOT Raleigh Office

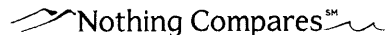
Nothing Compares<sup>SM</sup>

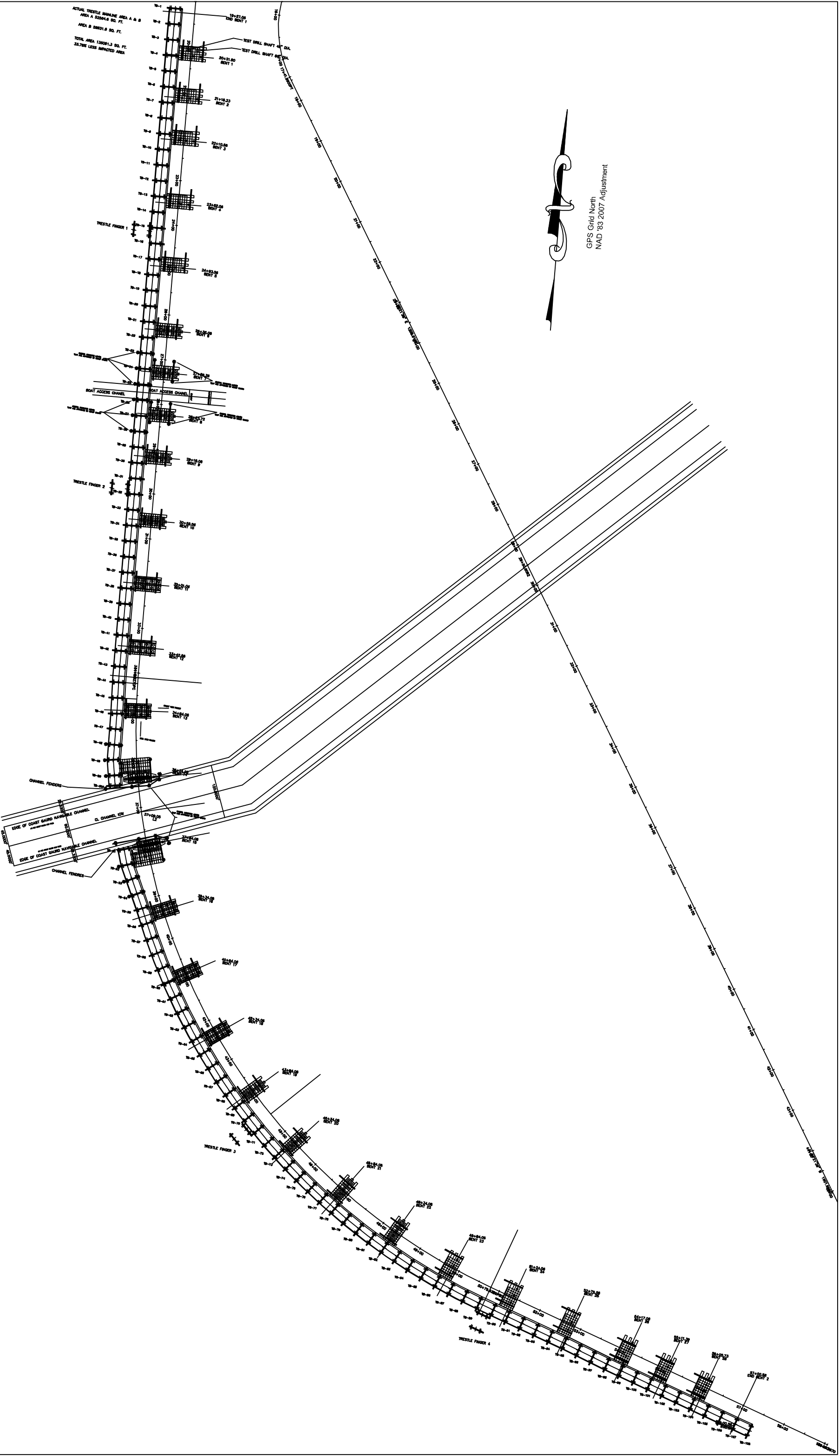

NO.	DATE	APPR.	NO.	DATE	APPR.
1	10/07/2016				

TOPSAIL ISLAND BRIDGE  
REPLACEMENT PROJECT  
TIP PROJECT B-4929  
CONTRACT C203789

NC 50 / NC 210 BETWEEN US 17 AND TOPSAIL BEACH  
OVER THE INTERCOASTAL WATERWAY NEAR SURF CITY N.C.  
TOPSAIL, NORTH CAROLINA

**Balfour Beatty Infrastructure, Inc.**  
4301 Balfour Road, Wilmington, NC 28403  
3365 Franklenn Rd, Wilmington, NC 28403

DESIGNED	S. ESCOBEDO	DATE	10/07/2016
PROJECT ENGINEER	ROB MANN		
PROJECT MANAGER	D. REED # 681		
APPROVED	J. BOUD		

WORK TRESTLE FOR THE  
TOPSAIL ISLAND BRIDGE PROJECT

DATE 10/07/2016

SCALE AS NOTED

ISSUED FOR

DATE

DESIGNED BY	1
REV. NO.	0
SHEET	1
OF	21

MATCH LINE 9

MATCH LINE 10

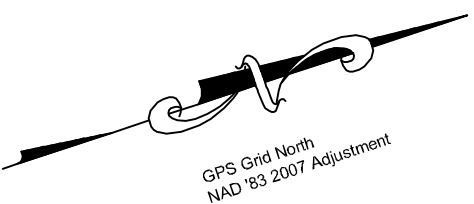
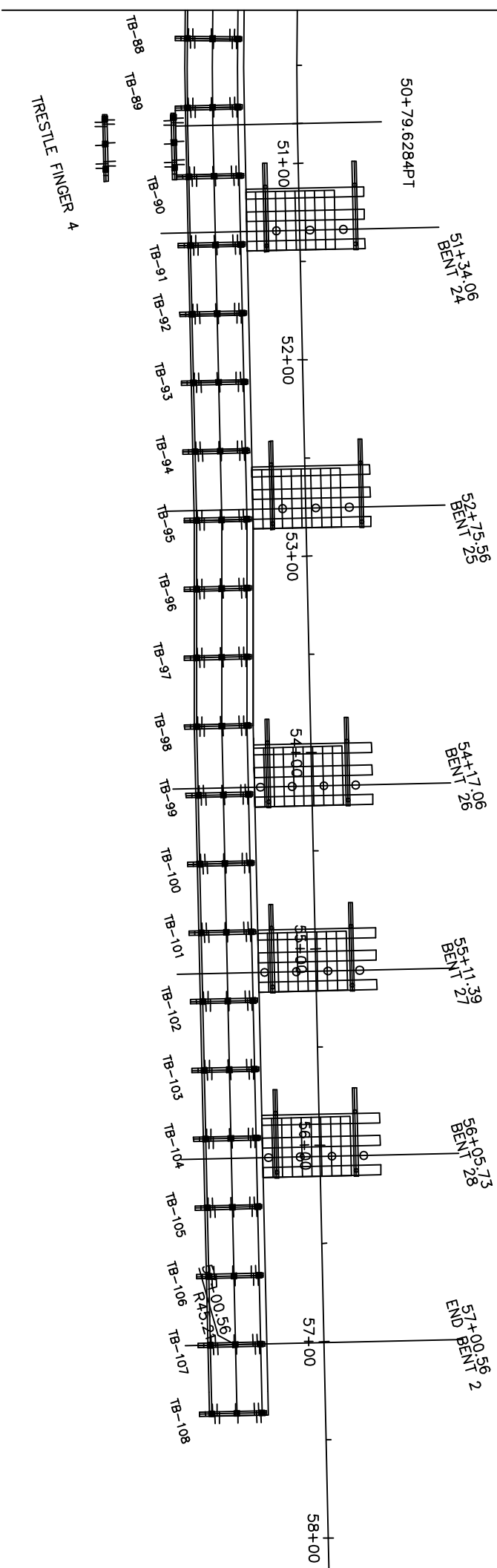

NO.	DATE	APPR.	NO.	DATE	APPR.
1	10/07/2016				
TRESTLE FOR TOPSAIL ISLAND PROJECT					
TOPSAIL ISLAND BRIDGE REPLACEMENT PROJECT					
TIP PROJECT B-4929 CONTRACT C203789					
NC 50 / NC 210 BETWEEN US 17 AND TOPSAIL BEACH OVER THE INTERCOASTAL WATERWAY NEAR SURF CITY N.C. TOPSAIL, NORTH CAROLINA					
Balfour Beatty Infrastructure, Inc. 4801 Balfour Road, Wilmington, NC 28403 3345 Franklinton Rd., Wilmington, NC 28403					
DESIGNED BY	S. ESCOBEDO	DATE	10/07/2016		
PROJECT ENGINEER	ROB MANN				
CHECK ENGINEER	D. REED # 681				
PROJECT MANAGER	J. BOUD				
APPROVED	M. McDERMOTT	DATE	10/07/2016		
AS NOTED		ISSUED FOR		DATE	
WORK TRESTLE FOR THE TOPSAIL ISLAND BRIDGE PROJECT					
ISSUING NO.					1
SHEET					10
REV. NO.					0
					21

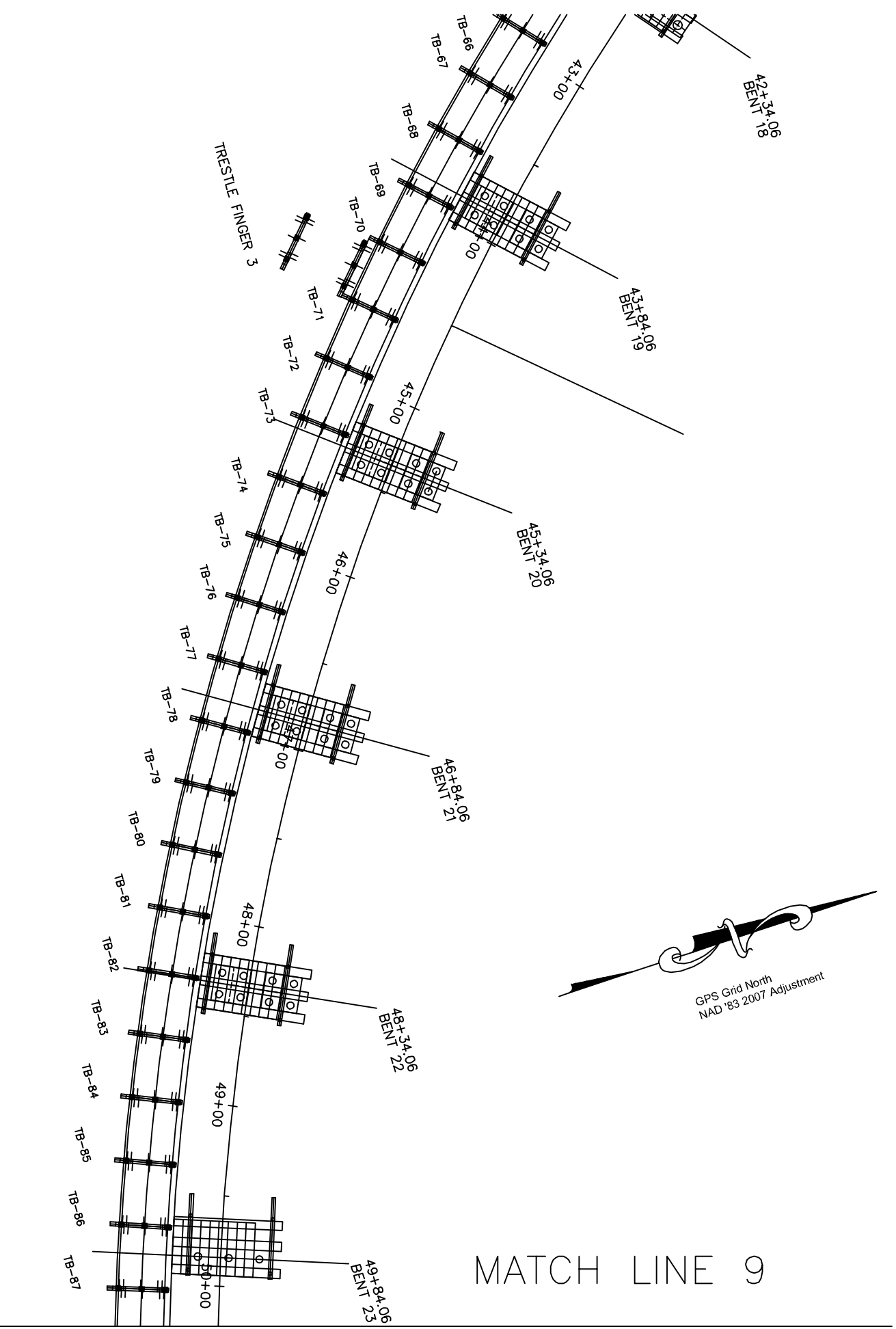

MATCH LINE 9

MATCH LINE 10

NO.	DATE	APPR.	NO.	DATE	APPR.
1	10/07/2016				
TRESTLE FOR TOPSAIL ISLAND PROJECT					
TOPSAIL ISLAND BRIDGE REPLACEMENT PROJECT					
TIP PROJECT B-4929 CONTRACT C203789					
NC 50 / NC 210 BETWEEN US 17 AND TOPSAIL BEACH OVER THE INTERCOASTAL WATERWAY NEAR SURF CITY N.C. TOPSAIL, NORTH CAROLINA					
Balfour Beatty Infrastructure, Inc. 4801 Balfour Road, Wilmington, NC 28403 3305 Franklinton Rd., Wilmington, NC 28403					
DESIGNED BY	S. ESCOBEDO	DATE	10/07/2016		
PROJECT ENGINEER	ROB MANN				
CHECK ENGINEER	D. REED # 681				
PROJECT MANAGER	J. BOYD				
APPROVED	M. MCDERMOTT	DATE	10/07/2016		
TOPSAIL ISLAND BRIDGE PROJECT					
CLIENT APPROVAL	ISSUED FOR	DATE			
SHEET 9 OF 21					

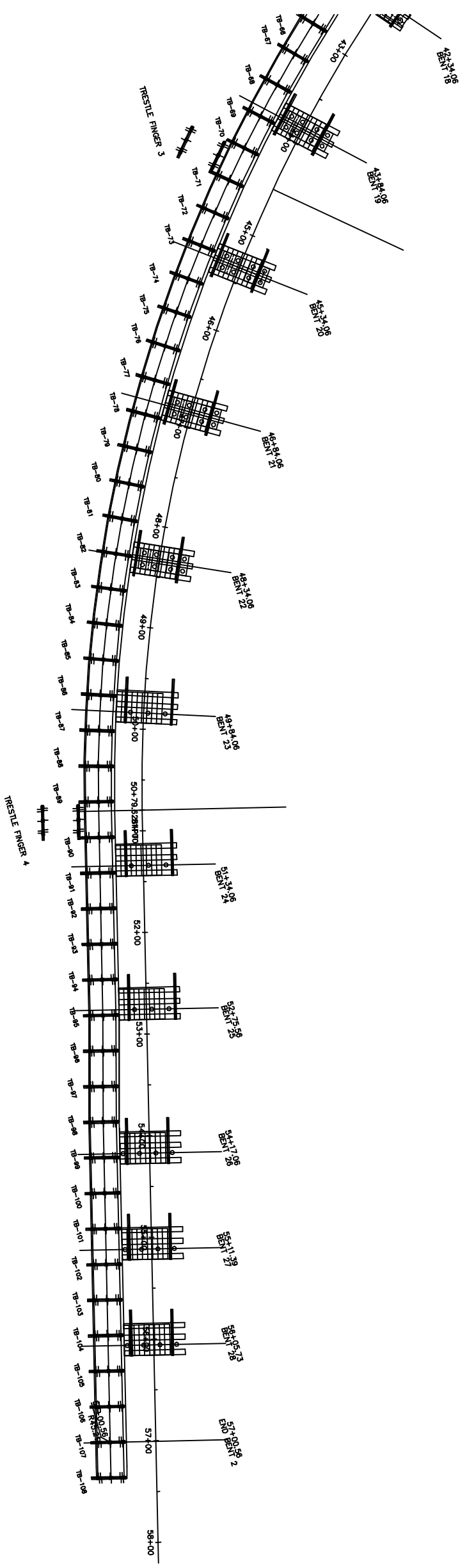
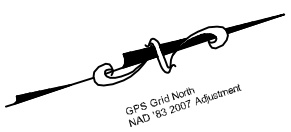

NO.	DATE	APPR.	NO.	DATE	APPR.
1	10/07/2016				
<p>TOPSAIL ISLAND BRIDGE REPLACEMENT PROJECT</p> <p>TIP PROJECT B-4929 CONTRACT C203789</p> <p>NC 50 / NC 210 BETWEEN US 17 AND TOPSAIL BEACH OVER THE INTERCOASTAL WATERWAY NEAR SURF CITY N.C. TOPSAIL, NORTH CAROLINA</p> <p><b>Balfour Beatty Infrastructure, Inc.</b> 480 Edwards Road, Wilmington, NC 28403 3365 Franklenn Rd., Wilmington, NC 28403</p>					
<p>DESIGNED BY: S. ESCOBEDO</p> <p>CHECKED BY: ROB MANN</p> <p>PROJECT ENGINEER: D. REED # 681</p> <p>PROJECT MANAGER: J. BOYD</p> <p>APPROVED:</p>		<p>DATE: 10/07/2016</p> <p>SCALE: AS NOTED</p>		<p>DATE: 10/07/2016</p> <p>SCALE: AS NOTED</p>	
<p>WORK TRESTLE FOR THE TOPSAIL ISLAND BRIDGE PROJECT</p>					
<p>CLIENT APPROVAL:</p> <p>ISSUED FOR:</p>				<p>DATE:</p>	
<p>SHEET 8 OF 21</p>					

MATCH LINE 6

MATCH LINE 7

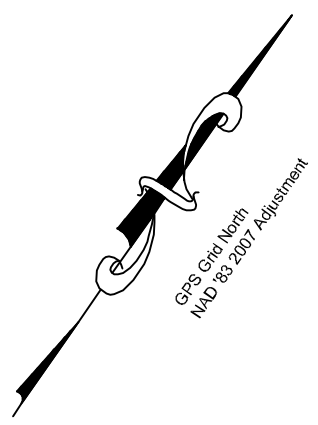
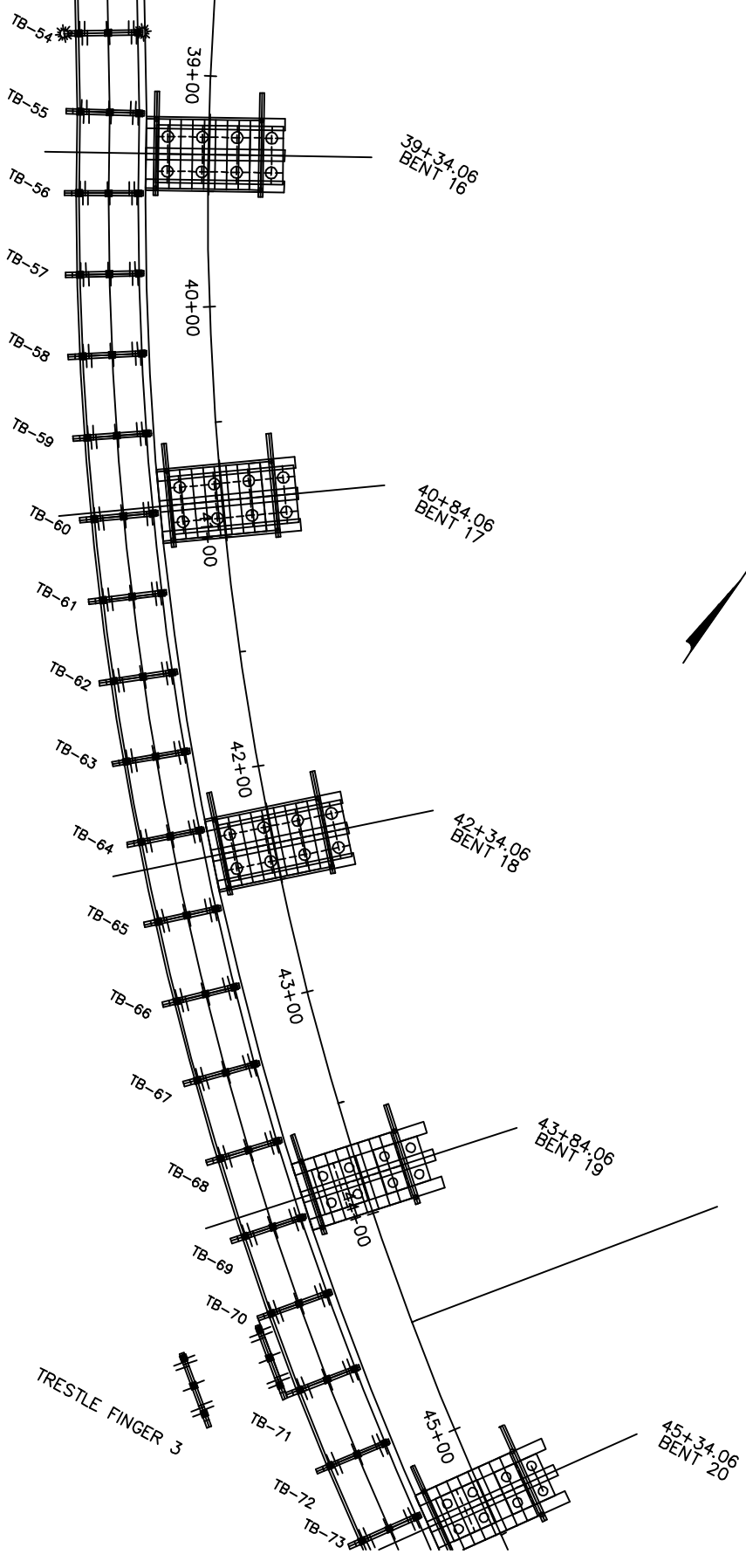

NO.	DATE	APPR.
1	10/07/2016	

TRESTLE FOR TOPSAIL ISLAND PROJECT

TOPSAIL ISLAND BRIDGE REPLACEMENT PROJECT

TIP PROJECT B-4929  
CONTRACT C203789

NC 50 / NC 210 BETWEEN US 17 AND TOPSAIL BEACH OVER THE INTERCOASTAL WATERWAY NEAR SURF CITY N.C. TOPSAIL, NORTH CAROLINA

**Balfour Beatty Infrastructure, Inc.**  
4801 Balfour Road, Wilmington, NC 28403  
3365 Franklinton Rd., Wilmington, NC 28403

DESIGNED	DATE
S. ESCOBEDO	10/07/2016
PROJECT ENGINEER	
ROB MANN	
CHECK ENGINEER	
D. REED # 681	
PROJECT MANAGER	
J. BOYD	
APPROVED	

WORK TRESTLE FOR THE TOPSAIL ISLAND BRIDGE PROJECT

DATE: 10/07/2016  
SCALE: AS NOTED

CLIENT APPROVAL: \_\_\_\_\_  
ISSUED FOR: \_\_\_\_\_  
DATE: \_\_\_\_\_

ISSUING NO.	SHEET	OF	TOTAL
1	7	0	21

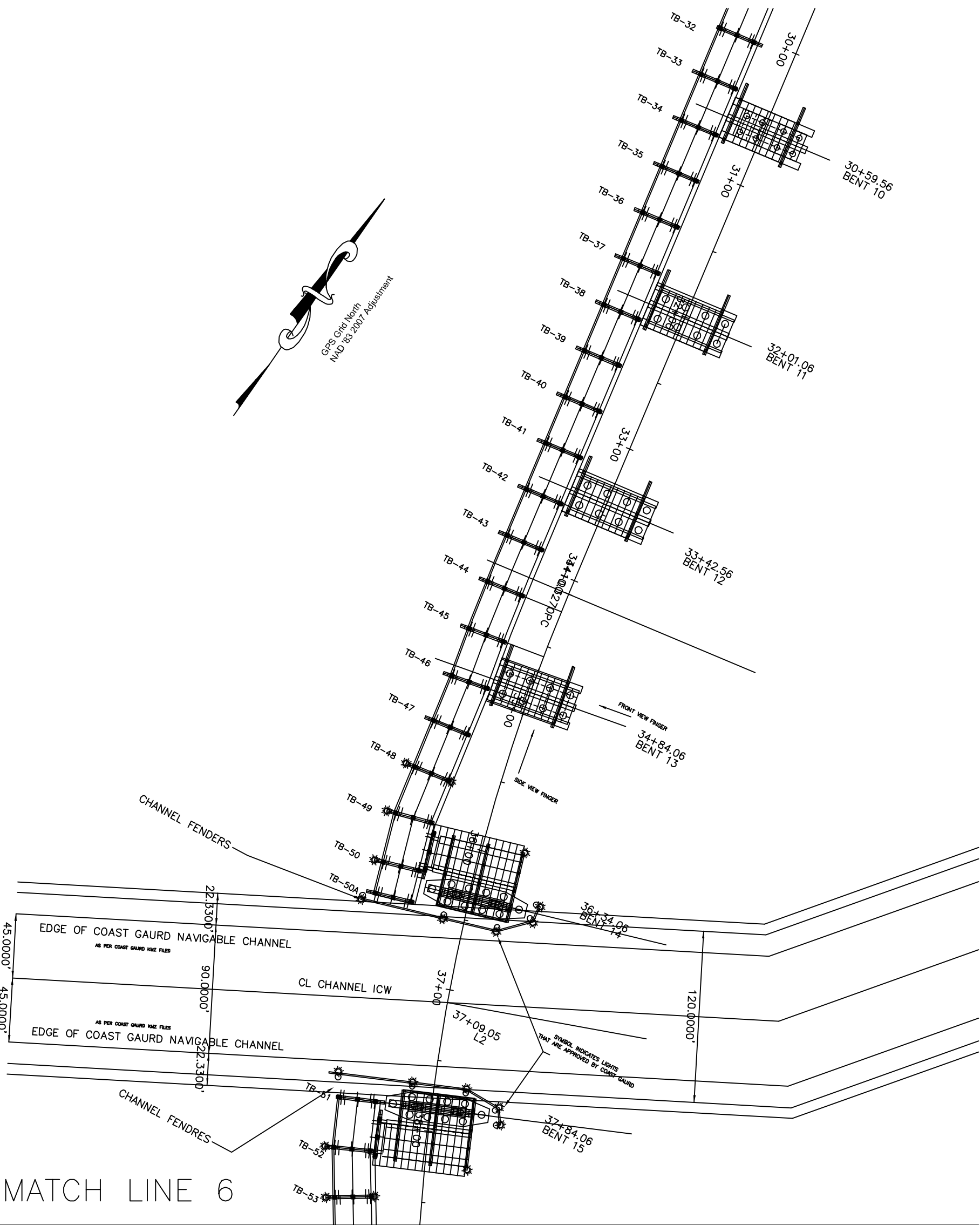

MATCH LINE 6

MATCH LINE 7

NO.	DATE	APPR.	NO.	DATE	APPR.
1	10/07/2016				

TOPSAIL ISLAND BRIDGE REPLACEMENT PROJECT		TOPSAIL ISLAND BRIDGE REPLACEMENT PROJECT	
TIP PROJECT B-4929 CONTRACT C203789		TIP PROJECT B-4929 CONTRACT C203789	

NC 50 / NC 210 BETWEEN US 17 AND TOPSAIL BEACH OVER THE INTERCOASTAL WATERWAY NEAR SURF CITY N.C. TOPSAIL, NORTH CAROLINA		Balfour Beatty Infrastructure, Inc. 4801 Balfour Road, Wilmington, NC 28403 3365 Franklinton Rd., Wilmington, NC 28403	
---	--	--	--

DESIGNED BY S. ESCOBEDO	DATE 10/07/2016	DESIGNED BY M. MCDERMOTT	DATE 10/07/2016
CHECKED BY ROB MANN		CHECKED BY M. MCDERMOTT	
PROJECT NUMBER D. REED # 681		PROJECT NUMBER M. MCDERMOTT	
APPROVED BY I. BOYD		APPROVED BY M. MCDERMOTT	

WORK TRESTLE FOR THE TOPSAIL ISLAND BRIDGE PROJECT	DATE 10/07/2016	ISSUED FOR	DATE	SHEET 6	REV. NO. 0
---	--------------------	------------	------	------------	---------------

DESIGNED BY	DATE	SHEET	REV. NO.
		6	0

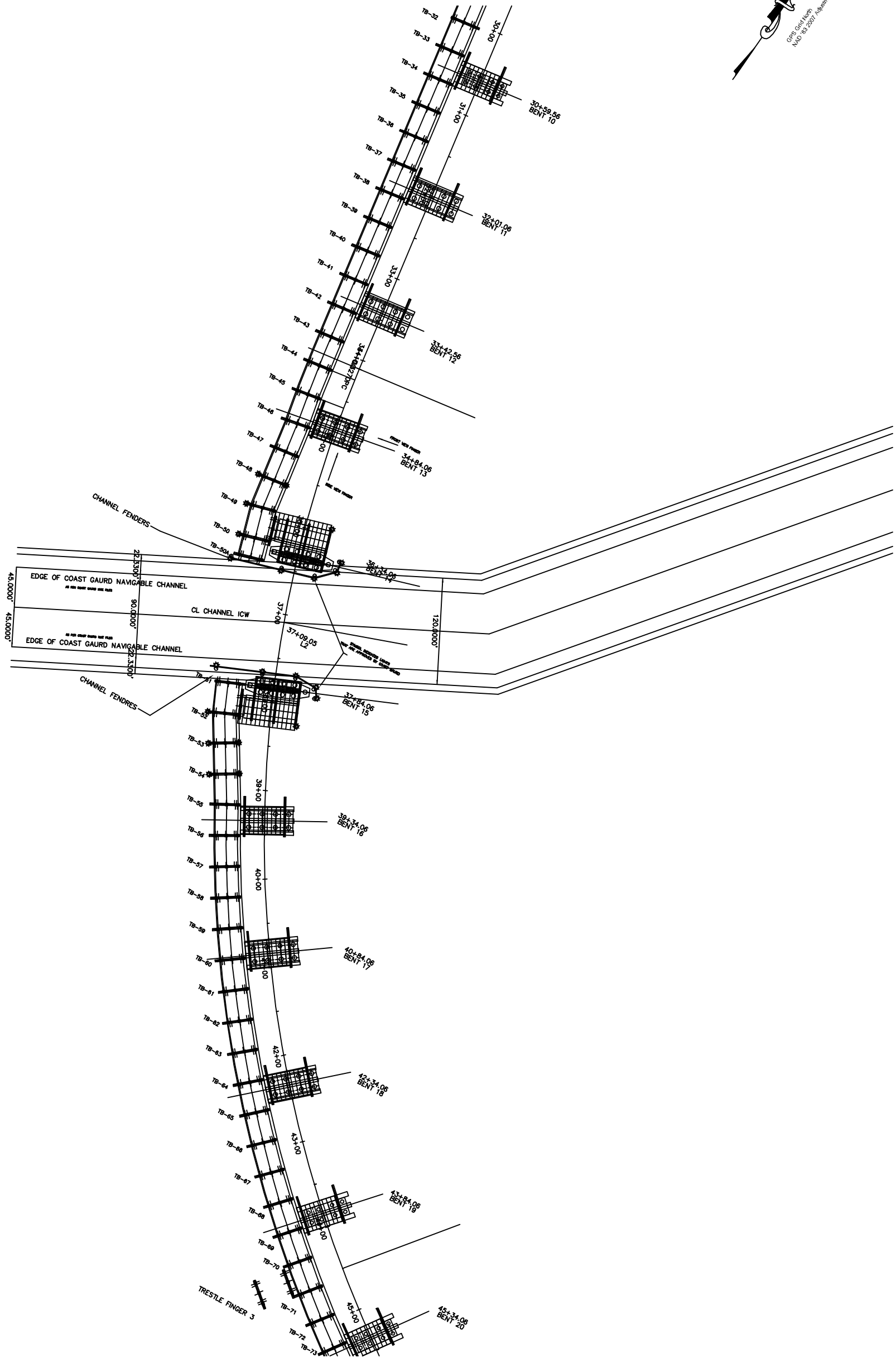

NO.	DATE	APPR.	NO.	DATE	APPR.
1	10/07/2016				

TRESTLE FOR TOPSAIL ISLAND PROJECT

TOPSAIL ISLAND BRIDGE  
REPLACEMENT PROJECT

TIP PROJECT B-4929  
CONTRACT C203789

NC 50 / NC 210 BETWEEN TS 17 AND TOPSAIL BEACH  
OVER THE INTERCOASTAL WATERWAY NEAR SURF CITY N.C.  
TOPSAIL, NORTH CAROLINA

**Balfour Beatty Infrastructure, Inc.**  
4801 Balfour Road, Wilmington, NC 28411  
3365 Franklinton Rd., Wilmington, NC 28411

DESIGNED	S. ESCOBEDO	DATE	10/07/2016
PROJECT ENGINEER	ROB MANN		
PROJECT ENGINEER	D. REED # 681		
PROJECT MANAGER	J. BOUD		
APPROVED			

WORK TRESTLE FOR THE  
TOPSAIL ISLAND BRIDGE PROJECT

DATE 10/07/2016

SCALE AS NOTED

CLIENT APPROVAL

ISSUED FOR

DATE

DESIGNED BY	1
REV. NO.	0
SHEET	5
OF	21



MATCH LINE 3

MATCH LINE 4

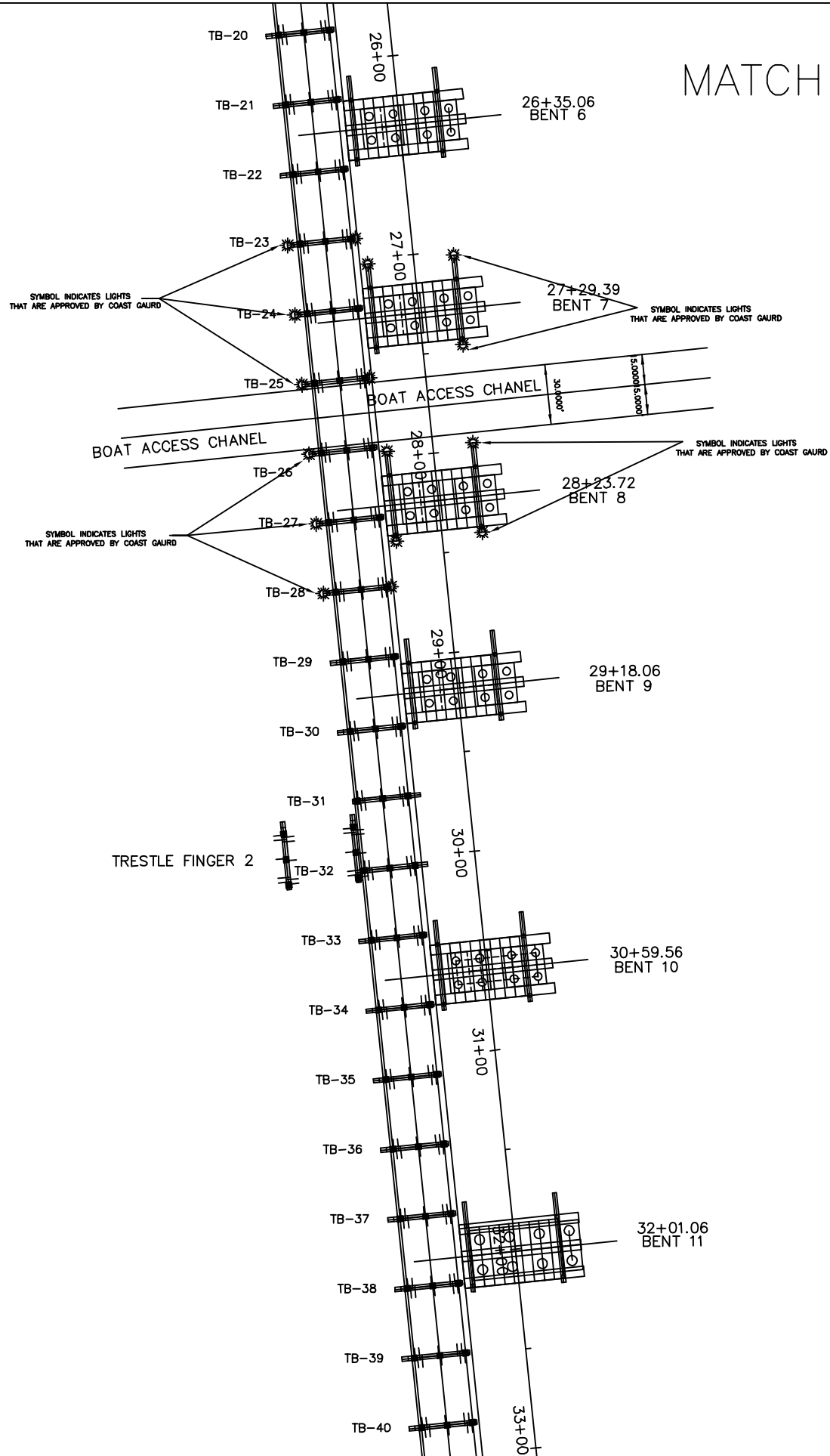

NO.	DATE	APPR.	NO.	DATE	APPR.
1	10/07/2016				

TOPSAIL ISLAND BRIDGE  
REPLACEMENT PROJECT  
TIP PROJECT B-4929  
CONTRACT C203789

NC 50 / NC 210 BETWEEN US 17 AND TOPSAIL BEACH  
OVER THE INTERCOASTAL WATERWAY NEAR SURF CITY N.C.  
TOPSAIL, NORTH CAROLINA

**Balfour Beatty Infrastructure, Inc.**  
4801 Balfour Road, Wilmington, NC 28403  
3365 Franklinton Rd., Wilmington, NC 28403

DESIGNED	DATE
S. ESCOBEDO	10/07/2016

PROJECT ENGINEER	PROJECT MANAGER
ROB MANN	J. BOYD

CHECKED	DATE
D. REED # 681	

WORK TRESTLE FOR THE  
TOPSAIL ISLAND BRIDGE PROJECT

DATE: 10/07/2016  
SCALE: AS NOTED

ISSUED FOR	DATE	SHEET	REV. NO.
		4	0
			21

NO.	DATE	APPR.	NO.	DATE	APPR.
1	10/07/2016				

TRESTLE FOR TOPSAIL ISLAND PROJECT

TOPSAIL ISLAND BRIDGE REPLACEMENT PROJECT

TIP PROJECT B-4929  
CONTRACT C203789

NC 50 / NC 210 BETWEEN US 17 AND TOPSAIL BEACH OVER THE INTERCOASTAL WATERWAY NEAR SURF CITY N.C. TOPSAIL, NORTH CAROLINA

**Balfour Beatty Infrastructure, Inc.**  
4801 Balfour Road, Wilmington, NC 28403  
3365 Frolicks Rd, Wilmington, NC 28403

DESIGNED BY	S. ESCOBEDO	DATE	10/07/2016
PROJECT ENGINEER	ROB MANN		
PROJECT MANAGER	D. REED # 681		
APPROVED	J. BOYD		

TOPSAIL ISLAND BRIDGE PROJECT

WORK TRESTLE FOR THE

DATE 10/07/2016

ISSUED FOR

DATE

DESIGNED BY	NO. 3
REV. NO.	0
SHEET	3
OF	21

ACTUAL TRESTLE MAINLINE AREA A & B  
 AREA A 52564.6 SQ. FT.  
 AREA B 59831.9 SQ. FT.  
 TOTAL AREA 135091.3 SQ. FT.  
 33.78% LESS IMPACTED AREA

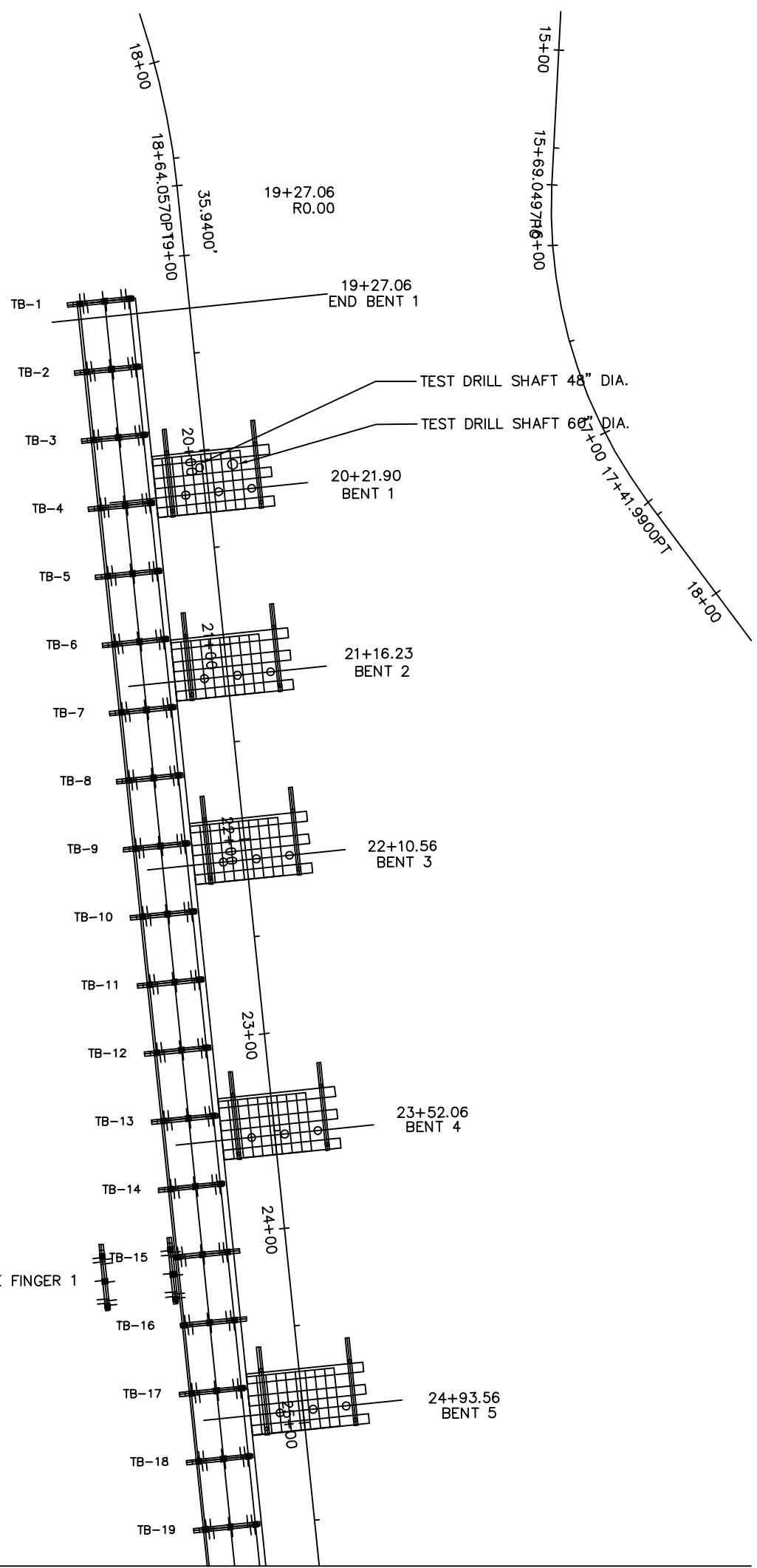
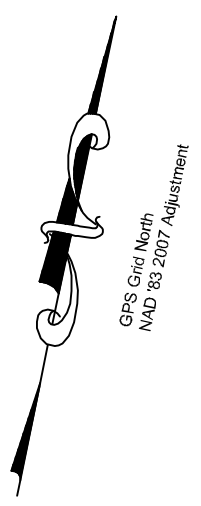

MATCH LINE 3

MATCH LINE 4

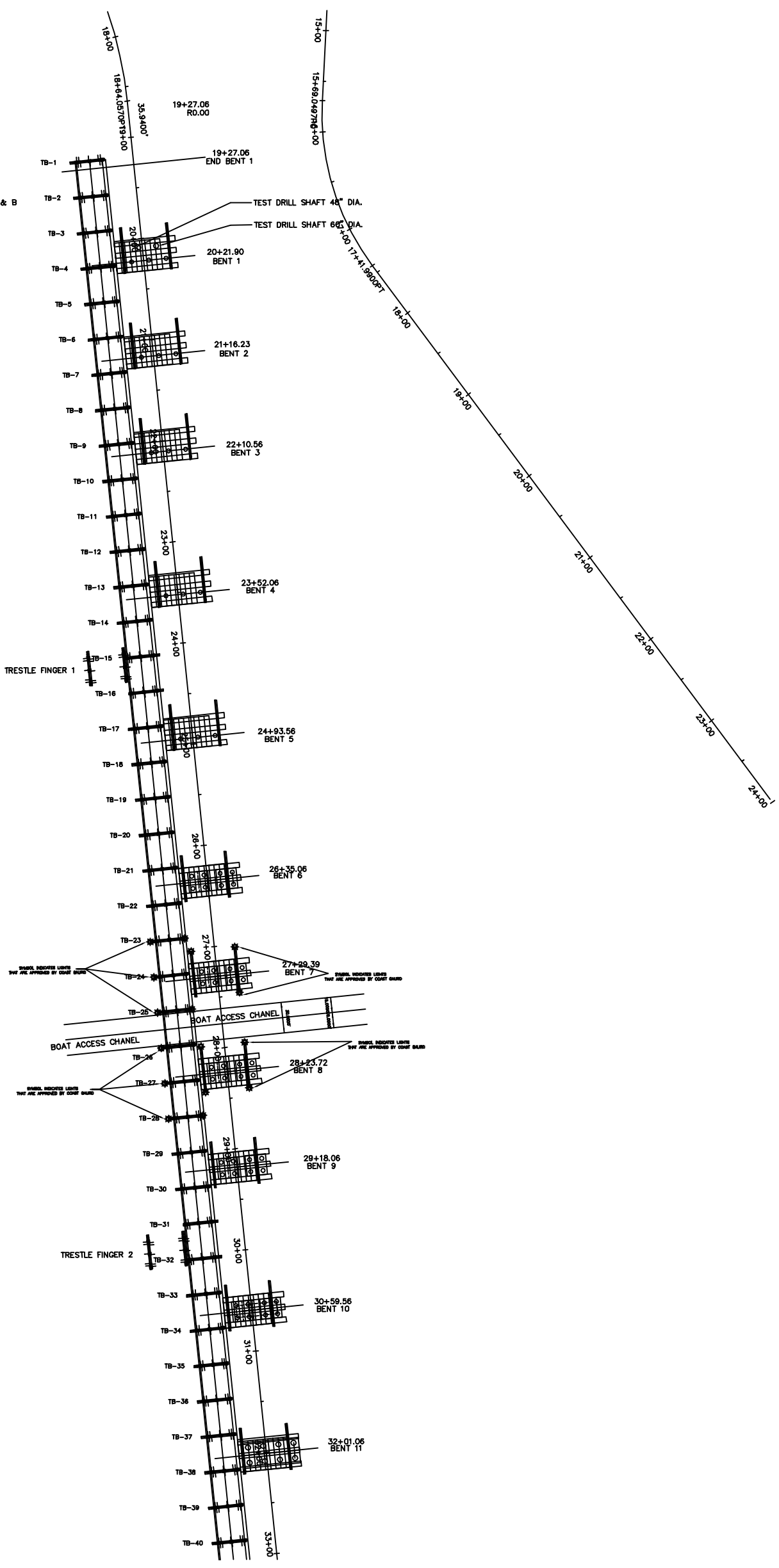

ACTUAL TRESTLE MAINLINE AREA A & B  
 AREA A 52584.6 SQ. FT.  
 AREA B 59831.9 SQ. FT.  
 TOTAL AREA 135091.3 SQ. FT.  
 33.78% LESS IMPACTED AREA

NO.	DATE	APPR.	NO.	DATE	APPR.
1	10/07/2016				

TOPSAIL ISLAND BRIDGE  
 REPLACEMENT PROJECT  
 TIP PROJECT B-4929  
 CONTRACT C203789

NC 50 / NC 210 BETWEEN US 17 AND TOPSAIL BEACH  
 OVER THE INTERCOASTAL WATERWAY NEAR SURF CITY N.C.  
 TOPSAIL, NORTH CAROLINA  
**Balfour Beatty Infrastructure, Inc.**  
 4801 Balfour Road, Wilmington, NC 28403  
 3365 Franklinton Rd, Wilmington, NC 28403

DESIGNED BY	S. ESCOBEDO	DATE	10/07/2016
PROJECT ENGINEER	ROB MANN		
PROJECT MANAGER	D. REED # 681		
APPROVED	J. BOYD		

WORK TRESTLE FOR THE  
 TOPSAIL ISLAND BRIDGE PROJECT  
 CHECKED BY: M. McDERMOTT  
 DATE: 10/07/2016  
 CLIENT APPROVAL: ISSUED FOR: DATE: SHEET: 2 OF 21

DESIGNED BY	S. ESCOBEDO	DATE	10/07/2016
PROJECT ENGINEER	ROB MANN		
PROJECT MANAGER	D. REED # 681		
APPROVED	J. BOYD		



MATCH LINE 19

MATCH LINE 20

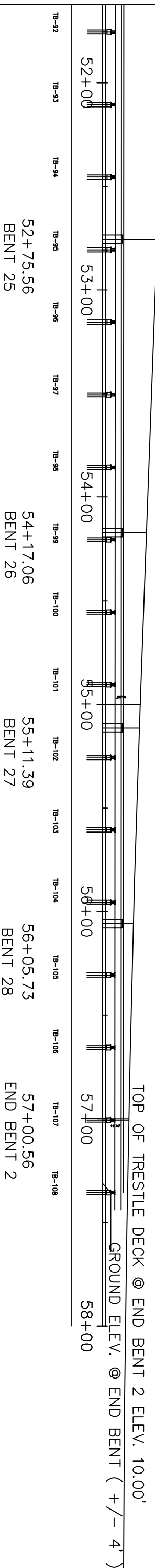

PVC STA. 55+00  
ELEV. 18.30'

PVT STA. 57+00  
ELEV. 12.70'

TOP OF TRESTLE DECK @ END BENT 2 ELEV. 10.00'

GROUND ELEV. @ END BENT ( + / - 4' )

52+75.56  
BENT 25

54+17.06  
BENT 26

55+11.39  
BENT 27

56+05.73  
BENT 28

57+00.56  
END BENT 2

NO.	DATE	APPR.	NO.	DATE	APPR.
1	10/07/2016				
<p>TOPSAIL ISLAND BRIDGE REPLACEMENT PROJECT</p> <p>TIP PROJECT B-4929 CONTRACT C203789</p> <p>NC 50 / NC 210 BETWEEN US 17 AND TOPSAIL BEACH OVER THE INTERCOASTAL WATERWAY NEAR SURF CITY N.C. TOPSAIL, NORTH CAROLINA</p> <p><b>Balfour Beatty Infrastructure, Inc.</b> 4801 Balmwood Road, Wilmington, NC 28418 3845 Frolicks Rd, Wilmington, NC 28411</p>					
<p>DESIGNED BY: S. ESCOBEDO PROJECT ENGINEER: ROB MANN CHECKED: D. REED # 681 PROJECT MANAGER: J. BOYD APPROVED:</p>			<p>DATE: 10/07/2016</p>		
<p>DESIGNED BY: M. MCDERMOTT SCALE: AS NOTED</p>			<p>DATE: 10/07/2016</p>		
<p>WORK TRESTLE FOR THE TOPSAIL ISLAND BRIDGE PROJECT</p>					
<p>CLEAR APPROVAL ISSUED FOR DATE:</p>					<p>SHEET 20</p>
<p>REV. NO. 0</p>					<p>21</p>

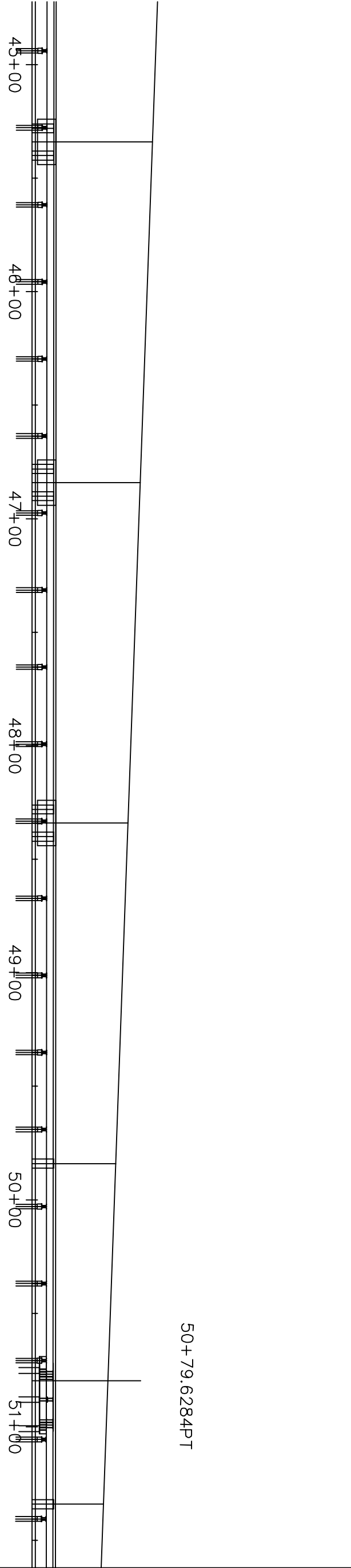

45+00	46+00	47+00	48+00	49+00	50+00	51+00
45+34.06	46+84.06	47+44.06	48+34.06	49+84.06	50+34.06	51+34.06
BENT 20	BENT 21		BENT 22	BENT 23		BENT 24

50+79.6284PT

TRESTLE FINGER 4

MATCH LINE 19

MATCH LINE 20

NO.	DATE	APPR.	NO.	DATE	APPR.
1	10/07/2016				
TRESTLE FOR TOPSAIL ISLAND PROJECT					
TOPSAIL ISLAND BRIDGE REPLACEMENT PROJECT					
TIP PROJECT B-4929 CONTRACT C203789					
NC 50 / NC 210 BETWEEN US 17 AND TOPSAIL BEACH OVER THE INTERCOASTAL WATERWAY NEAR SURF CITY N.C. TOPSAIL, NORTH CAROLINA					
Balfour Beatty Infrastructure, Inc. 4801 Balmwood Road, Wilmington, NC 28403 3305 Frolicksden Rd., Wilmington, NC 28403					
DESIGNED	S. ESCOBEDO	DATE	10/07/2016		
PROJECT ENGINEER	ROB MANN				
CHECK ENGINEER	D. REED # 681				
PROJECT MANAGER	J. BOYD				
APPROVED		DATE	10/07/2016		
WORK TRESTLE FOR THE TOPSAIL ISLAND BRIDGE PROJECT					
DESIGNED BY	M. MCDERMOTT	DATE	10/07/2016	CHECK APPROVAL	
SCALE	AS NOTED	W.A. NO.		ISSUED FOR	
					DATE
					SHEET
					19
					OF
					21
					REV. NO.
					0
					1

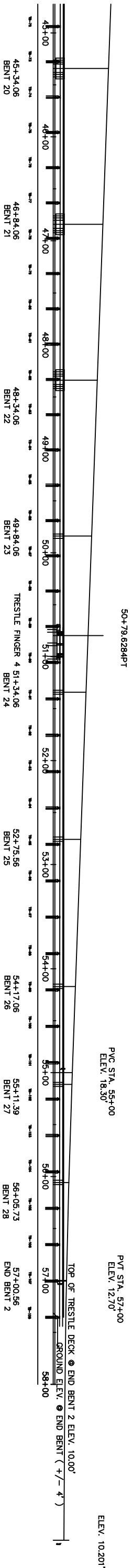

NO.	DATE	APPR.	NO.	DATE	APPR.
1	10/07/2016				
TRESTLE FOR TOPSAIL ISLAND PROJECT					
TOPSAIL ISLAND BRIDGE REPLACEMENT PROJECT					
TIP PROJECT B-4929 CONTRACT C203789					
NC 50 / NC 210 BETWEEN US 17 AND TOPSAIL BEACH OVER THE INTERCOASTAL WATERWAY NEAR SURF CITY N.C. TOPSAIL, NORTH CAROLINA					
Balfour Beatty Infrastructure, Inc. 480 Bahwood Road, Wilmington, NC 28403 3305 Frolicks Rd, Wilmington, NC 28403					
DESIGNED	S. ESCOBEDO	DATE	10/07/2016		
PROJECT ENGINEER	ROB MANN				
CHECK ENGINEER	D. REED # 681				
PROJECT MANAGER	J. BOYD				
APPROVED		DATE	10/07/2016		
WORK TRESTLE FOR THE TOPSAIL ISLAND BRIDGE PROJECT					
DESIGNED BY	M. MCDERMOTT	DATE	10/07/2016	CLIENT APPROVAL	ISSUED FOR
SCALE	AS NOTED	DATE		DATE	
SHEET 18 OF 21					

PVT STA. 39+50  
ELEV. 74.10'

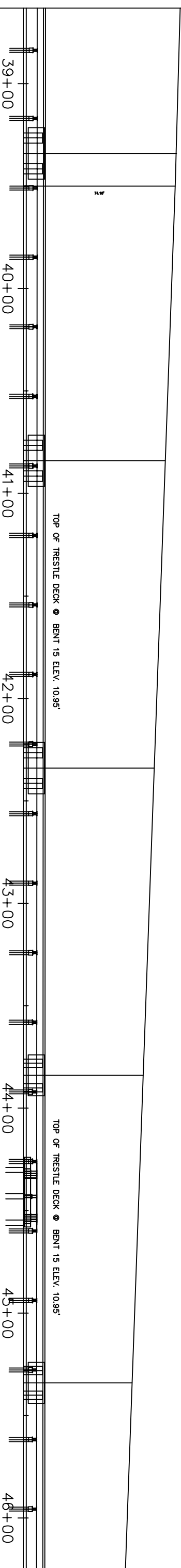

39+00	39+34.06	40+00	40+84.06	41+00	42+00	42+34.06	43+00	43+84.06	44+00	45+00	45+34.06	46+00
	BENT 16		BENT 17			BENT 18		BENT 19			BENT 20	

MATCH LINE 16  
MATCH LINE 17

NO.	DATE	APPR.	NO.	DATE	APPR.	NO.	DATE	APPR.
1	10/07/2016							
TRESTLE FOR TOPSAIL ISLAND PROJECT			TOPSAIL ISLAND BRIDGE REPLACEMENT PROJECT			TIP PROJECT B-4929 CONTRACT C203789		
NC 50 / NC 210 BETWEEN US 17 AND TOPSAIL BEACH OVER THE INTERCOASTAL WATERWAY NEAR SURF CITY N.C. TOPSAIL, NORTH CAROLINA			Balfour Beatty Infrastructure, Inc.			4801 Balmwood Road, Wilmington, NC 28403 3305 Froelichs Rd, Wilmington, NC 28403		
DESIGNED BY	DATE	PROJECT ENGINEER	DATE	PROJECT MANAGER	DATE	PROJECT MANAGER	DATE	PROJECT MANAGER
S. ESCOBEDO	10/07/2016	ROB MANN		J. BOYD		J. BOYD		J. BOYD
CHECKED BY	DATE	PROJECT MANAGER	DATE	PROJECT MANAGER	DATE	PROJECT MANAGER	DATE	PROJECT MANAGER
D. REED # 681		J. BOYD		J. BOYD		J. BOYD		J. BOYD
APPROVED		APPROVED		APPROVED		APPROVED		APPROVED
WORK TRESTLE FOR THE TOPSAIL ISLAND BRIDGE PROJECT			WORK TRESTLE FOR THE TOPSAIL ISLAND BRIDGE PROJECT			WORK TRESTLE FOR THE TOPSAIL ISLAND BRIDGE PROJECT		
DATE	DATE	DATE	DATE	DATE	DATE	DATE	DATE	DATE
10/07/2016	10/07/2016	10/07/2016	10/07/2016	10/07/2016	10/07/2016	10/07/2016	10/07/2016	10/07/2016
AS NOTED	AS NOTED	AS NOTED	AS NOTED	AS NOTED	AS NOTED	AS NOTED	AS NOTED	AS NOTED
SHEET 17			SHEET 17			SHEET 17		
REV. NO. 0			REV. NO. 0			REV. NO. 0		
21			21			21		



NO.	DATE	APPR.	NO.	DATE	APPR.
1	10/07/2016				

TOPSAIL ISLAND BRIDGE  
REPLACEMENT PROJECT  
TIP PROJECT B-4929  
CONTRACT C203789

NC 50 / NC 210 BETWEEN US 17 AND TOPSAIL BEACH  
OVER THE INTERCOASTAL WATERWAY NEAR SURF CITY N.C.  
TOPSAIL, NORTH CAROLINA  
**Balfour Beatty Infrastructure, Inc.**  
4801 Balmwood Road, Wilmington, NC 28411  
3365 Frolicksden Rd, Wilmington, NC 28411

ISSUED BY	DATE
S. ESCOBEDO	10/07/2016
PROJECT ENGINEER	
ROB MANN	
CHECKED BY	
D. REED # 681	
PROJECT MANAGER	
J. BOYD	
APPROVED	

ISSUED BY	DATE	ISSUED FOR	DATE
M. McDERMOTT	10/07/2016		
SCALE	AS NOTED		
WORK TRESTLE FOR THE TOPSAIL ISLAND BRIDGE PROJECT			
CLIENT APPROVAL			
DATE			

ISSUING NO.	REV. NO.
16	0
17	21

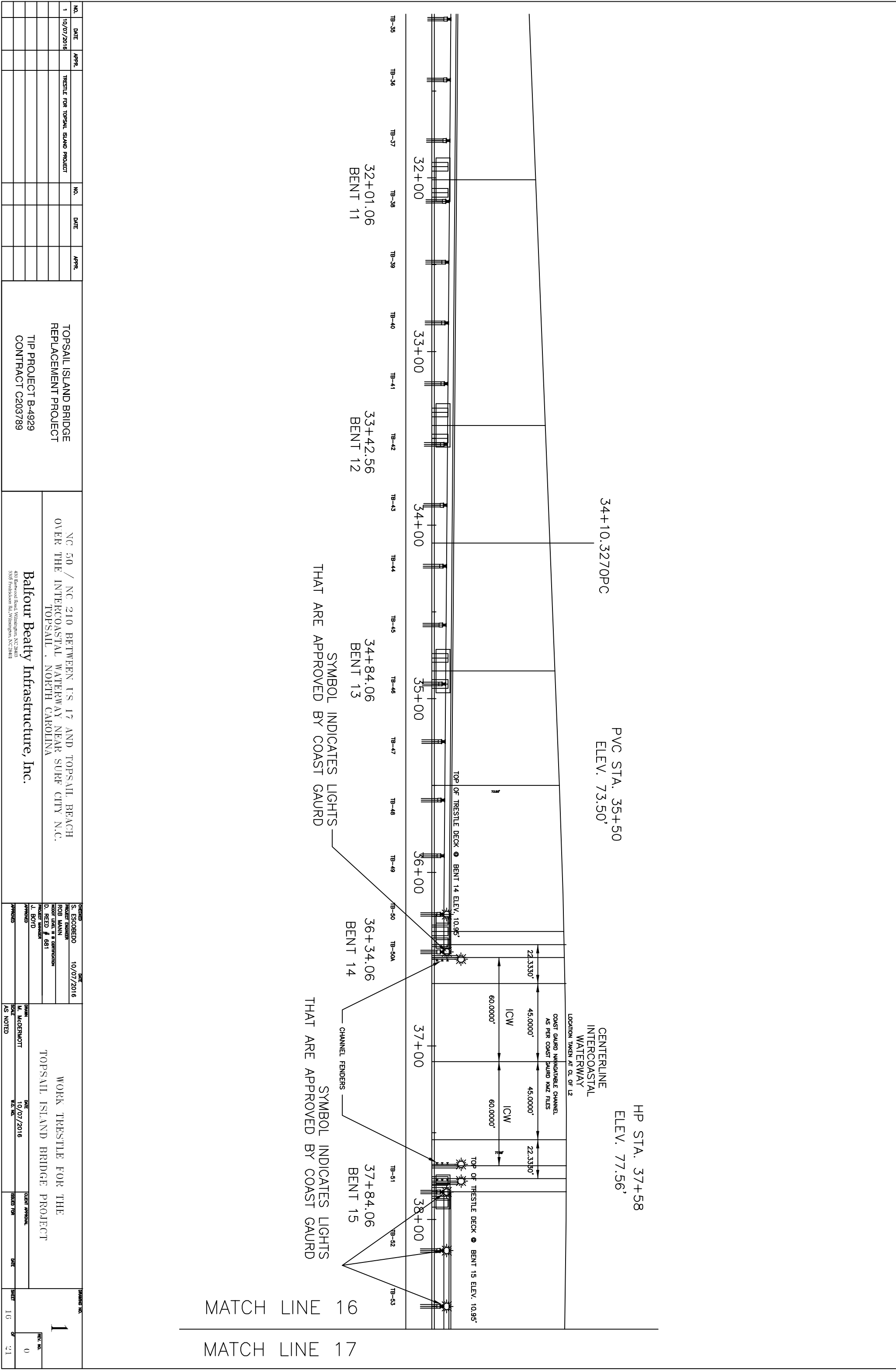

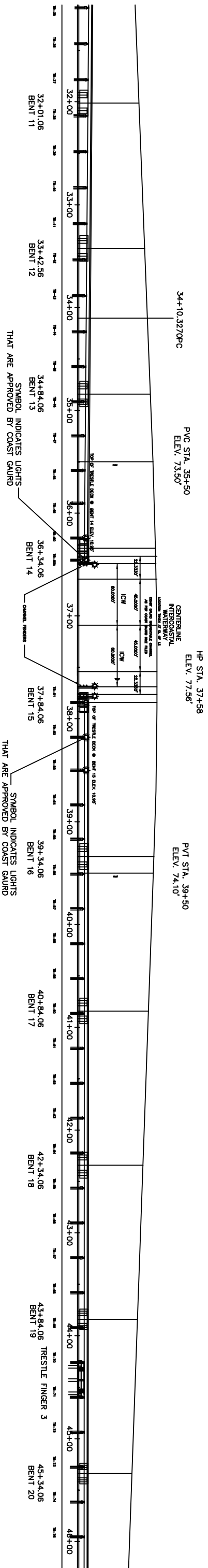

NO.	DATE	APPR.	NO.	DATE	APPR.
1	10/07/2016				

TOPSAIL ISLAND BRIDGE  
REPLACEMENT PROJECT  
TIP PROJECT B-4929  
CONTRACT C203789

NC 50 / NC 210 BETWEEN I-17 AND TOPSAIL BEACH  
OVER THE INTERCOASTAL WATERWAY NEAR SURF CITY N.C.  
TOPSAIL, NORTH CAROLINA  
Balfour Beatty Infrastructure, Inc.  
4801 Balfour Road, Wilmington, NC 28403  
3365 Frickman Rd., Wilmington, NC 28403

DESIGNED	S. ESCOBEDO	DATE	10/07/2016
PROJECT ENGINEER	ROB MANN		
CHECK ENGINEER	D. REED # 681		
PROJECT MANAGER	J. BOUD		
APPROVED			

WORK TREXSTLE FOR THE TOPSAIL ISLAND BRIDGE PROJECT	
DATE	10/07/2016
SCALE	AS NOTED
DESIGNED BY	M. McDERMOTT
CHECK APPROVAL	
DATE	

REVISION NO.	0
SHEET	13 OF 21

MATCH LINE 13

MATCH LINE 14

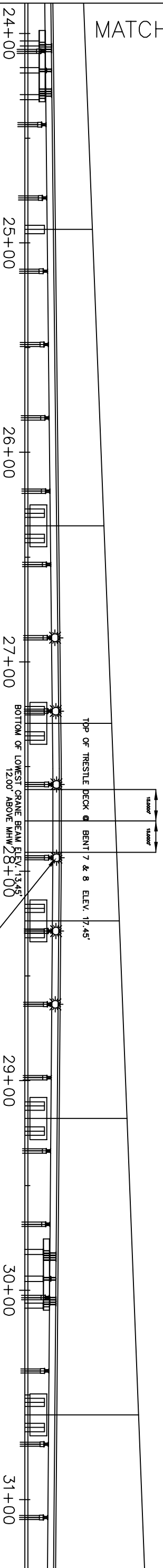

BOAT ACCESS CHANNEL

- |                  |       |       |       |       |       |       |       |       |       |                  |       |       |       |       |       |       |       |       |       |          |  |  |  |  |  |  |  |  |  |          |  |  |  |  |  |  |  |  |  |          |  |  |  |  |  |  |  |  |  |          |  |  |  |  |  |  |  |  |  |
|------------------|-------|-------|-------|-------|-------|-------|-------|-------|-------|------------------|-------|-------|-------|-------|-------|-------|-------|-------|-------|----------|--|--|--|--|--|--|--|--|--|----------|--|--|--|--|--|--|--|--|--|----------|--|--|--|--|--|--|--|--|--|----------|--|--|--|--|--|--|--|--|--|
| TB-15            | TB-16 | TB-17 | TB-18 | TB-19 | TB-20 | TB-21 | TB-22 | TB-23 | TB-24 | TB-25            | TB-26 | TB-27 | TB-28 | TB-29 | TB-30 | TB-31 | TB-32 | TB-33 | TB-34 | TB-35    |  |  |  |  |  |  |  |  |  |          |  |  |  |  |  |  |  |  |  |          |  |  |  |  |  |  |  |  |  |          |  |  |  |  |  |  |  |  |  |
| TRESTLE FINGER 1 |       |       |       |       |       |       |       |       |       | TRESTLE FINGER 2 |       |       |       |       |       |       |       |       |       |          |  |  |  |  |  |  |  |  |  |          |  |  |  |  |  |  |  |  |  |          |  |  |  |  |  |  |  |  |  |          |  |  |  |  |  |  |  |  |  |
| BENT 5           |       |       |       |       |       |       |       |       |       | BENT 6           |       |       |       |       |       |       |       |       |       | BENT 7   |  |  |  |  |  |  |  |  |  | BENT 8   |  |  |  |  |  |  |  |  |  | BENT 9   |  |  |  |  |  |  |  |  |  | BENT 10  |  |  |  |  |  |  |  |  |  |
| 24+93.56         |       |       |       |       |       |       |       |       |       | 26+35.06         |       |       |       |       |       |       |       |       |       | 27+29.39 |  |  |  |  |  |  |  |  |  | 28+23.72 |  |  |  |  |  |  |  |  |  | 29+18.06 |  |  |  |  |  |  |  |  |  | 30+59.56 |  |  |  |  |  |  |  |  |  |

SYMBOL INDICATES LIGHTS THAT ARE APPROVED BY COAST GAURD

NO.	DATE	APPR.	NO.	DATE	APPR.	NO.	DATE	APPR.	NO.	DATE	APPR.
1	10/07/2016										
TRESTLE FOR TOPSAIL ISLAND PROJECT			TOPSAIL ISLAND BRIDGE REPLACEMENT PROJECT			TIP PROJECT B-4929 CONTRACT C203789			NC 50 / NC 210 BETWEEN US 17 AND TOPSAIL BEACH OVER THE INTERCOASTAL WATERWAY NEAR SURF CITY N.C. TOPSAIL, NORTH CAROLINA <b>Balfour Beatty Infrastructure, Inc.</b> <small>480 Barnwood Road, Wilmington, NC 28403 3305 Frolicks Rd, Wilmington, NC 28403</small>		
DESIGNED BY: S. ESCOBEDO PROJECT ENGINEER: ROB MANN CHECKED BY: D. REED # 681 PROJECT MANAGER: J. BOUD APPROVED:			DATE: 10/07/2016 SCALE: AS NOTED			WORK TRESTLE FOR THE TOPSAIL ISLAND BRIDGE PROJECT DATE: 10/07/2016 W.A. NO.:			SHEET NO.: 14 OF 21 REV. NO.: 0		

PTC STA. 16+70  
ELEV. 9.13'

LP STA. 17+73.91  
ELEV. 8.06'

PVT STA. 19+70  
ELEV. 11.88'

MATCH LINE 13

MATCH LINE 14

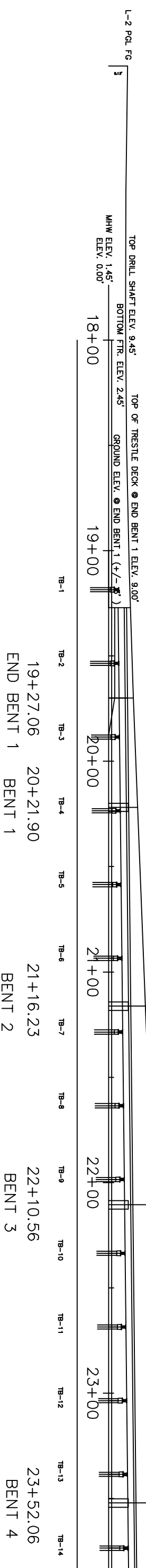

L-2 PCL FG  
TOP DRILL SHAFT ELEV. 9.45'  
MHW ELEV. 1.45'  
BOTTOM FTR. ELEV. 2.45'  
GROUND ELEV. @ END BENT 1 (+/- 0.1')

TOP OF TRESTLE DECK @ END BENT 1 ELEV. 9.00'

NO.	DATE	APPR.	NO.	DATE	APPR.
1	10/07/2016				
TRESTLE FOR TOPSAIL ISLAND PROJECT					
TOPSAIL ISLAND BRIDGE REPLACEMENT PROJECT					
TIP PROJECT B-4929 CONTRACT C203789					
NC 50 / NC 210 BETWEEN US 17 AND TOPSAIL BEACH OVER THE INTERCOASTAL WATERWAY NEAR SURF CITY N.C. TOPSAIL, NORTH CAROLINA			<b>Balfour Beatty Infrastructure, Inc.</b> 4801 Balfour Road, Wilmington, NC 28403 3365 Froelichs Rd, Wilmington, NC 28403		
DESIGNED BY	S. ESCOBEDO	DATE	10/07/2016	CHECKED BY	M. MCDERMOTT
PROJECT ENGINEER	ROB MANN	SCALE	AS SHOWN	DATE	10/07/2016
PROJECT MANAGER	D. REED # 681	ISSUED FOR	AS NOTED	DATE	
APPROVED	J. BOYD	CLEAR APPROVAL		DATE	
WORK TRESTLE FOR THE TOPSAIL ISLAND BRIDGE PROJECT			SHEET 13 OF 21		

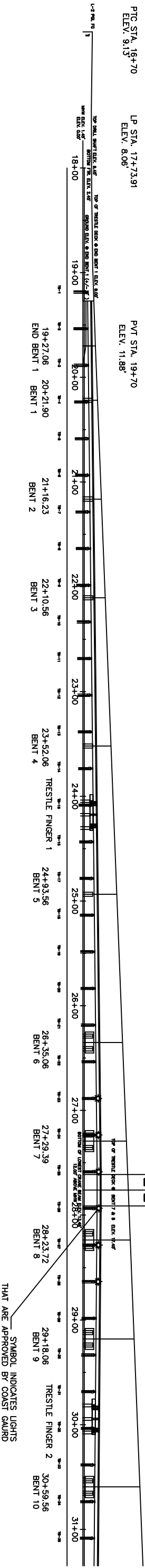

NO.	DATE	APPR.	NO.	DATE	APPR.
1	10/07/2016				
		TRESTLE FOR TOPSAIL ISLAND PROJECT			

TOPSAIL ISLAND BRIDGE  
REPLACEMENT PROJECT

TIP PROJECT B-4929  
CONTRACT C203789

NC 50 / NC 210 BETWEEN US 17 AND TOPSAIL BEACH  
OVER THE INTERCOASTAL WATERWAY NEAR SURF CITY N.C.  
TOPSAIL, NORTH CAROLINA

**Balfour Beatty Infrastructure, Inc.**  
4801 Balfour Road, Wilmington, NC 28403  
3365 Franklinton Rd., Wilmington, NC 28403

DESIGNED BY	S. ESCOBEDO	DATE	10/07/2016
PROJECT ENGINEER	ROB MANN		
CHECK ENGINEER	D. REED # 681		
PROJECT MANAGER	J. BOYD		
APPROVED			

OWNER		DATE	
M. McDERMOTT		10/07/2016	
WORK TRESTLE FOR THE TOPSAIL ISLAND BRIDGE PROJECT			
ISSUED FOR	CLEAR APPROVAL	DATE	
		10/07/2016	
AS NOTED			

ISSUING NO.	1
REV. NO.	0
SHEET	12
OF	21

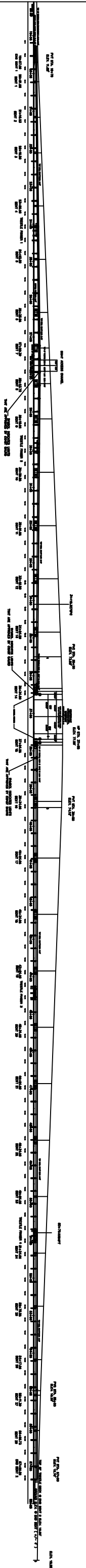

NO.	DATE	APPR.	NO.	DATE	APPR.
1	10/07/2016				

TOPSAIL ISLAND BRIDGE  
 TRESTLE FOR TOPSAIL ISLAND PROJECT  
 REPLACEMENT PROJECT

TIP PROJECT B-4929  
 CONTRACT C203789

NC 50 / NC 210 BETWEEN US 17 AND TOPSAIL BEACH  
 OVER THE INTERCOASTAL WATERWAY NEAR SURF CITY N.C.  
 TOPSAIL, NORTH CAROLINA

**Balfour Beatty Infrastructure, Inc.**  
 4501 Balmwood Road, Wilmington, NC 28410  
 3305 Frolicksden Rd, Wilmington, NC 28410

DESIGNED	S. ESCOBEDO	DATE	10/07/2016
PROJECT ENGINEER	ROB MANN		
CHECK ENGINEER	D. REED # 681		
PROJECT MANAGER	J. BOYD		
APPROVED			

WORK TRESTLE FOR THE  
 TOPSAIL ISLAND BRIDGE PROJECT

DATE 10/07/2016  
 SCALE AS NOTED

ISSUED FOR DATE

ISSUING NO.	1
REV. NO.	0
SHEET	11
OF	21