



STATE OF NORTH CAROLINA
DEPARTMENT OF TRANSPORTATION

BEVERLY EAVES PERDUE
GOVERNOR

EUGENE A. CONTI, JR.
SECRETARY

December 18, 2012

U.S. Army Corps of Engineers
Regulatory Field Office
2407 West 5th Street
Washington, NC 27889

Attention: Mr. Tom Steffens
NCDOT Coordinator

Dear Sir:

Subject: **Application for Section 404 Nationwide Permits (NWP) 23 & 12, and Section 401 Water Quality Certification** for the replacement of Bridge No. 66 over Contentnea Creek Swamp on SR 1163 in Wilson County; TIP Project B-4679; Federal Aid Project No. BRSTP-1163(4); Debit \$240 from WBS No. 33833.1.1.

Please find enclosed PCN, permit drawings, stormwater management plan, roadway plans, and EEP request letter for the above referenced project proposed by the North Carolina Department of Transportation (NCDOT). A Categorical Exclusion (CE) was completed for this project on July 7 2011 and distributed shortly thereafter. Additional copies are available upon request. The NCDOT proposes to replace existing Bridge No. 66 over Contentnea Creek Swamp on SR 1163 in Wilson County. The project involves replacement of the existing structurally deficient bridge and approaches with a new structure. The replacement structure will be approximately 64 feet long providing a minimum 36 foot clear deck width. The bridge will include two 12-foot lanes and a minimum of 6-foot offsets. The approach roadway will extend approximately 220 feet from the southwest end and 300 feet from the northeast end of the new bridge. The southeast approach will begin as a 24-foot pavement width providing two 12-foot lanes, and will widen to three 12-foot lanes approximately 150 feet before the bridge. Eight-foot shoulders will be provided at this end of the approach. The northeast approach will be widened to include four 12-foot lanes. Eight-foot shoulders (11-foot shoulders where guardrail is included), including four-foot paved shoulders, will be provided at this end of the approach.

Proposed permanent impacts to riparian wetlands from bridge construction are 0.19 acre of fill and 0.19 acre of hand clearing. Utility relocations will require less than 0.01 acre of fill in wetlands 0.25 acre of hand clearing. Traffic will be detoured off-site during construction.

MAILING ADDRESS:

NC DEPARTMENT OF TRANSPORTATION
PROJECT DEVELOPMENT AND ENVIRONMENTAL ANALYSIS
NATURAL ENVIRONMENT SECTION
1598 MAIL SERVICE CENTER
RALEIGH NC 27699-1598

TELEPHONE: 919-707-6100
FAX: 919-212-5785

WEBSITE: WWW.NCDOT.ORG

LOCATION:

1020 BIRCH RIDGE DRIVE
RALEIGH NC 27610-4328

This project calls for a letting date of June 18, 2013 and a review date of April 30, 2013; however, the let date may advance as additional funding becomes available.

Regulatory Approvals

Section 404 Permit: All aspects of this project are being processed by the Federal Highway Administration as a "Categorical Exclusion" in accordance with 23 CFR 771.115(b). The NCDOT requests that the project be authorized by NWP 23 for bridge construction and NWP 12 for utility relocations.

Section 401 Permit: We anticipate 401 General Certification numbers 3891 and 3884 will apply to this project. NCDOT is requesting written concurrence from the North Carolina Department of Environmental and Natural Resources, Division of Water Quality. We are providing two copies of this application to the NCDWQ for their approval.

Neuse Riparian Buffer Authorization: Although this projects lies in the Neuse River Basin, the NCDWQ has determined that this project is not subject to the Neuse Basin Riparian Buffer rules, therefore a Riparian Buffer Authorization will not be required.

A copy of this permit application and its distribution list will be posted on the NCDOT website at <http://www.ncdot.org/doh/preconstruct/pe/neu/permit.html>.

If you have any questions or need additional information, please contact John S. Merritt at (919) 707-6140 or email at jsmerritt@ncdot.gov.

Sincerely,

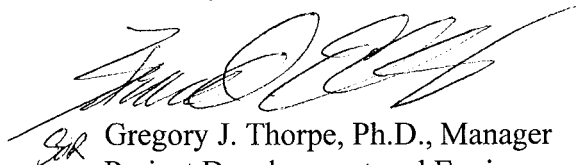

Gregory J. Thorpe, Ph.D., Manager
Project Development and Environmental Analysis Unit

cc

NCDOT Permit Application Standard Distribution List.



Office Use Only:
 Corps action ID no. _____
 DWQ project no. _____
 Form Version 1.3 Dec 10 2008

Pre-Construction Notification (PCN) Form

A. Applicant Information

1. Processing

1a. Type(s) of approval sought from the Corps: Section 404 Permit Section 10 Permit

1b. Specify Nationwide Permit (NWP) number: 23 & 12 or General Permit (GP) number:

1c. Has the NWP or GP number been verified by the Corps? Yes No

1d. Type(s) of approval sought from the DWQ (check all that apply):
 401 Water Quality Certification – Regular Non-404 Jurisdictional General Permit
 401 Water Quality Certification – Express Riparian Buffer Authorization

1e. Is this notification solely for the record because written approval is not required?	For the record only for DWQ 401 Certification: <input type="checkbox"/> Yes <input checked="" type="checkbox"/> No	For the record only for Corps Permit: <input type="checkbox"/> Yes <input checked="" type="checkbox"/> No
--	---	--

1f. Is payment into a mitigation bank or in-lieu fee program proposed for mitigation of impacts? If so, attach the acceptance letter from mitigation bank or in-lieu fee program.	<input type="checkbox"/> Yes <input checked="" type="checkbox"/> No
---	---

1g. Is the project located in any of NC's twenty coastal counties. If yes, answer 1h below.	<input type="checkbox"/> Yes <input checked="" type="checkbox"/> No
---	---

1h. Is the project located within a NC DCM Area of Environmental Concern (AEC)?	<input type="checkbox"/> Yes <input checked="" type="checkbox"/> No
---	---

2. Project Information

2a. Name of project:	Replacement of Bridge No. 66 over a Swamp on SR 1163 (Downing Street)
2b. County:	Wilson
2c. Nearest municipality / town:	Wilson
2d. Subdivision name:	<i>not applicable</i>
2e. NCDOT only, T.I.P. or state project no.:	B-4679

3. Owner Information

3a. Name(s) on Recorded Deed:	North Carolina Department of Transportation
3b. Deed Book and Page No.	<i>not applicable</i>
3c. Responsible Party (for LLC if applicable):	<i>not applicable</i>
3d. Street address:	1598 Mail Service Center
3e. City, state, zip:	Raleigh, NC 27699-1598
3f. Telephone no.:	(919) 707-6140
3g. Fax no.:	(919) 431-2002
3h. Email address:	jsmeritt@ncdot.gov

4. Applicant Information (if different from owner)	
4a. Applicant is:	<input type="checkbox"/> Agent <input type="checkbox"/> Other, specify:
4b. Name:	<i>not applicable</i>
4c. Business name (if applicable):	
4d. Street address:	
4e. City, state, zip:	
4f. Telephone no.:	
4g. Fax no.:	
4h. Email address:	
5. Agent/Consultant Information (if applicable)	
5a. Name:	<i>not applicable</i>
5b. Business name (if applicable):	
5c. Street address:	
5d. City, state, zip:	
5e. Telephone no.:	
5f. Fax no.:	
5g. Email address:	

B. Project Information and Prior Project History	
1. Property Identification	
1a. Property identification no. (tax PIN or parcel ID):	<i>not applicable</i>
1b. Site coordinates (in decimal degrees):	Latitude: 35.705497, Longitude: -77.955299
1c. Property size:	2.8 acres
2. Surface Waters	
2a. Name of nearest body of water (stream, river, etc.) to proposed project:	Contentnea Creek
2b. Water Quality Classification of nearest receiving water:	WS IV; NSW; CA
2c. River basin:	Neuse River Basin
3. Project Description	
3a. Describe the existing conditions on the site and the general land use in the vicinity of the project at the time of this application:	Urban, forested stream corridors, Wiggins Mill Reservoir
3b. List the total estimated acreage of all existing wetlands on the property:	2.1
3c. List the total estimated linear feet of all existing streams (intermittent and perennial) on the property:	N/A
3d. Explain the purpose of the proposed project:	To replace a structurally deficient bridge.
3e. Describe the overall project in detail, including the type of equipment to be used:	The project involves replacing a bridge on the existing alignment using an off-site detour. Standard road building equipment, such as trucks, dozers, and cranes will be used.
4. Jurisdictional Determinations	
4a. Have jurisdictional wetland or stream determinations by the Corps or State been requested or obtained for this property / project (including all prior phases) in the past? Comments: William Wescott visited the site on May 28, 2009, but no JD was issued. JD is requested with this application.	<input checked="" type="checkbox"/> Yes <input type="checkbox"/> No <input type="checkbox"/> Unknown
4b. If the Corps made the jurisdictional determination, what type of determination was made?	<input type="checkbox"/> Preliminary <input type="checkbox"/> Final
4c. If yes, who delineated the jurisdictional areas? Name (if known): John Merritt, Tyler Stanton	Agency/Consultant Company: Baker Engineering Other:
4d. If yes, list the dates of the Corps jurisdictional determinations or State determinations and attach documentation.	
5. Project History	
5a. Have permits or certifications been requested or obtained for this project (including all prior phases) in the past?	<input type="checkbox"/> Yes <input checked="" type="checkbox"/> No <input type="checkbox"/> Unknown
5b. If yes, explain in detail according to "help file" instructions.	
6. Future Project Plans	
6a. Is this a phased project?	<input type="checkbox"/> Yes <input checked="" type="checkbox"/> No
6b. If yes, explain.	

C. Proposed Impacts Inventory

1. Impacts Summary

1a. Which sections were completed below for your project (check all that apply):

- Wetlands Streams - tributaries Buffers
 Open Waters Pond Construction

2. Wetland Impacts

If there are wetland impacts proposed on the site, then complete this question for each wetland area impacted.

2a. Wetland impact number – Permanent (P) or Temporary (T)	2b. Type of impact	2c. Type of wetland (if known)	2d. Forested	2e. Type of jurisdiction (Corps - 404, 10 DWQ – non-404, other)	2f. Area of impact (acres)
Site 1 <input checked="" type="checkbox"/> P <input type="checkbox"/> T	Fill - bridge	riparian	<input checked="" type="checkbox"/> Yes <input type="checkbox"/> No	<input checked="" type="checkbox"/> Corps <input type="checkbox"/> DWQ	0.19
Site 1 <input checked="" type="checkbox"/> P <input type="checkbox"/> T	Fill - utilities	riparian	<input checked="" type="checkbox"/> Yes <input type="checkbox"/> No	<input checked="" type="checkbox"/> Corps <input type="checkbox"/> DWQ	<0.01
Site 2 <input type="checkbox"/> P <input type="checkbox"/> T			<input type="checkbox"/> Yes <input type="checkbox"/> No	<input type="checkbox"/> Corps <input type="checkbox"/> DWQ	
Site 2 <input type="checkbox"/> P <input type="checkbox"/> T			<input type="checkbox"/> Yes <input type="checkbox"/> No	<input type="checkbox"/> Corps <input type="checkbox"/> DWQ	
Site 2 <input type="checkbox"/> P <input type="checkbox"/> T			<input type="checkbox"/> Yes <input type="checkbox"/> No	<input type="checkbox"/> Corps <input type="checkbox"/> DWQ	
Site 6 <input type="checkbox"/> P <input type="checkbox"/> T			<input type="checkbox"/> Yes <input type="checkbox"/> No	<input type="checkbox"/> Corps <input type="checkbox"/> DWQ	

2g. Total wetland impacts 0.19 Perm.

2h. Comments: There will be 0.19 ac of hand clearing due to bridge construction & 0.25 ac due to utility relocation. Additionally, there will be 0.04 ac of temporary fill in wetlands in the hand clearing areas for the installation of erosion control measures, including temporary silt fence and/or special sediment control fence.

3. Stream Impacts

If there are perennial or intermittent stream impacts (including temporary impacts) proposed on the site, then complete this question for all stream sites impacted.

3a. Stream impact number - Permanent (P) or Temporary (T)	3b. Type of impact	3c. Stream name	3d. Perennial (PER) or intermittent (INT)?	3e. Type of jurisdiction (Corps - 404, 10 DWQ – non-404, other)	3f. Average stream width (feet)	3g. Impact length (linear feet)
Site 1 <input type="checkbox"/> P <input type="checkbox"/> T			<input type="checkbox"/> PER <input type="checkbox"/> INT	<input type="checkbox"/> Corps <input type="checkbox"/> DWQ		
Site 2 <input type="checkbox"/> P <input type="checkbox"/> T			<input type="checkbox"/> PER <input type="checkbox"/> INT	<input type="checkbox"/> Corps <input type="checkbox"/> DWQ		
Site 3 <input type="checkbox"/> P <input type="checkbox"/> T			<input type="checkbox"/> PER <input type="checkbox"/> INT	<input type="checkbox"/> Corps <input type="checkbox"/> DWQ		
Site 4 <input type="checkbox"/> P <input type="checkbox"/> T			<input type="checkbox"/> PER <input type="checkbox"/> INT	<input type="checkbox"/> Corps <input type="checkbox"/> DWQ		
Site 5 <input type="checkbox"/> P <input type="checkbox"/> T			<input type="checkbox"/> PER <input type="checkbox"/> INT	<input type="checkbox"/> Corps <input type="checkbox"/> DWQ		

3h. Total stream and tributary impacts 0.0 Perm
0.0 Temp

3i. Comments:

4. Open Water Impacts

If there are proposed impacts to lakes, ponds, estuaries, tributaries, sounds, the Atlantic Ocean, or any other open water of the U.S. then individually list all open water impacts below.

4a. Open water impact number – Permanent (P) or Temporary (T)	4b. Name of waterbody (if applicable)	4c. Type of impact	4d. Waterbody type	4e. Area of impact (acres)
O1 <input checked="" type="checkbox"/> P <input type="checkbox"/> T	Open Water not named	Permanent		<0.01
O2 <input type="checkbox"/> P <input type="checkbox"/> T				
O3 <input type="checkbox"/> P <input type="checkbox"/> T				
O4 <input type="checkbox"/> P <input type="checkbox"/> T				
4f. Total open water impacts				<0.01 Permanent

4g. Comments:

5. Pond or Lake Construction

If pond or lake construction proposed, then complete the chart below.

5a. Pond ID number	5b. Proposed use or purpose of pond	5c. Wetland Impacts (acres)			5d. Stream Impacts (feet)			5e. Upland (acres)
		Flooded	Filled	Excavated	Flooded	Filled	Excavated	Flooded
P1								
P2								
5f. Total								

5g. Comments:

5h. Is a dam high hazard permit required?	<input type="checkbox"/> Yes <input type="checkbox"/> No If yes, permit ID no:
5i. Expected pond surface area (acres):	
5j. Size of pond watershed (acres):	
5k. Method of construction:	

6. Buffer Impacts (for DWQ)

If project will impact a protected riparian buffer, then complete the chart below. If yes, then individually list all buffer impacts below. If any impacts require mitigation, then you **MUST** fill out Section D of this form.

6a. Project is in which protected basin?		<input type="checkbox"/> Neuse <input type="checkbox"/> Catawba		<input type="checkbox"/> Tar-Pamlico <input type="checkbox"/> Randleman		<input type="checkbox"/> Other:	
6b. Buffer impact number – Permanent (P) or Temporary (T)	6c. Reason for impact	6d. Stream name	6e. Buffer mitigation required?	6f. Zone 1 impact (square feet)	6g. Zone 2 impact (square feet)		
B1 <input type="checkbox"/> P <input type="checkbox"/> T			<input type="checkbox"/> Yes <input type="checkbox"/> No				
B2 <input type="checkbox"/> P <input type="checkbox"/> T			<input type="checkbox"/> Yes <input type="checkbox"/> No				
B3 <input type="checkbox"/> P <input type="checkbox"/> T			<input type="checkbox"/> Yes <input type="checkbox"/> No				
6h. Total buffer impacts							
6i. Comments:							

D. Impact Justification and Mitigation

1. Avoidance and Minimization

1a. Specifically describe measures taken to avoid or minimize the proposed impacts in designing project.
 The proposed bridge is longer than the existing bridge; the proposed bridge will be at approximately the same grade as the existing structure; an off site detour will be used. Slopes of 3:1 will be constructed in wetlands.

1b. Specifically describe measures taken to avoid or minimize the proposed impacts through construction techniques.
 Sub regional tier design guidelines for bridge projects were used to develop this project. Best management practices include replacement of bridge along existing alignment, minimization of fill slopes and use of hand clearing as opposed to mechanized clearing.

2. Compensatory Mitigation for Impacts to Waters of the U.S. or Waters of the State

2a. Does the project require Compensatory Mitigation for impacts to Waters of the U.S. or Waters of the State?	<input checked="" type="checkbox"/> Yes <input type="checkbox"/> No If no, explain: Due to the minimal amount of impacts, compensatory mitigation is not proposed.
2b. If yes, mitigation is required by (check all that apply):	<input type="checkbox"/> DWQ <input checked="" type="checkbox"/> Corps
2c. If yes, which mitigation option will be used for this project?	<input type="checkbox"/> Mitigation bank <input checked="" type="checkbox"/> Payment to in-lieu fee program <input type="checkbox"/> Permittee Responsible Mitigation

3. Complete if Using a Mitigation Bank

3a. Name of Mitigation Bank: EEP

3b. Credits Purchased (attach receipt and letter)	Type	Quantity
3c. Comments is attach:		

4. Complete if Making a Payment to In-lieu Fee Program

4a. Approval letter from in-lieu fee program is attached.	<input type="checkbox"/> Yes
4b. Stream mitigation requested:	linear feet
4c. If using stream mitigation, stream temperature:	<input type="checkbox"/> warm <input type="checkbox"/> cool <input type="checkbox"/> cold
4d. Buffer mitigation requested (DWQ only):	square feet
4e. Riparian wetland mitigation requested:	0.38 acre
4f. Non-riparian wetland mitigation requested:	acres
4g. Coastal (tidal) wetland mitigation requested:	acres
4h. Comments: The EEP request letter is attached.	

5. Complete if Using a Permittee Responsible Mitigation Plan

5a. If using a permittee responsible mitigation plan, provide a description of the proposed mitigation plan.

6. Buffer Mitigation (State Regulated Riparian Buffer Rules) – required by DWQ

6a. Will the project result in an impact within a protected riparian buffer that requires buffer mitigation? Yes No

6b. If yes, then identify the square feet of impact to each zone of the riparian buffer that requires mitigation. Calculate the amount of mitigation required.

Zone	6c. Reason for impact	6d. Total impact (square feet)	Multiplier	6e. Required mitigation (square feet)
Zone 1			3 (2 for Catawba)	
Zone 2			1.5	
6f. Total buffer mitigation required:				

6g. If buffer mitigation is required, discuss what type of mitigation is proposed (e.g., payment to private mitigation bank, permittee responsible riparian buffer restoration, payment into an approved in-lieu fee fund).

6h. Comments:

E. Stormwater Management and Diffuse Flow Plan (required by DWQ)	
1. Diffuse Flow Plan	
1a. Does the project include or is it adjacent to protected riparian buffers identified within one of the NC Riparian Buffer Protection Rules?	<input type="checkbox"/> Yes <input checked="" type="checkbox"/> No
1b. If yes, then is a diffuse flow plan included? If no, explain why. Comments:	<input type="checkbox"/> Yes <input type="checkbox"/> No
2. Stormwater Management Plan	
2a. What is the overall percent imperviousness of this project?	N/A
2b. Does this project require a Stormwater Management Plan?	<input checked="" type="checkbox"/> Yes <input type="checkbox"/> No
2c. If this project DOES NOT require a Stormwater Management Plan, explain why:	
2d. If this project DOES require a Stormwater Management Plan, then provide a brief, narrative description of the plan: See attached permit drawings.	
2e. Who will be responsible for the review of the Stormwater Management Plan?	<input type="checkbox"/> Certified Local Government <input type="checkbox"/> DWQ Stormwater Program <input checked="" type="checkbox"/> DWQ 401 Unit
3. Certified Local Government Stormwater Review	
3a. In which local government's jurisdiction is this project?	not applicable
3b. Which of the following locally-implemented stormwater management programs apply (check all that apply):	<input type="checkbox"/> Phase II <input type="checkbox"/> NSW <input type="checkbox"/> USMP <input type="checkbox"/> Water Supply Watershed <input type="checkbox"/> Other:
3c. Has the approved Stormwater Management Plan with proof of approval been attached?	<input type="checkbox"/> Yes <input type="checkbox"/> No
4. DWQ Stormwater Program Review	
4a. Which of the following state-implemented stormwater management programs apply (check all that apply):	<input type="checkbox"/> Coastal counties <input type="checkbox"/> HQW <input type="checkbox"/> ORW <input type="checkbox"/> Session Law 2006-246 <input type="checkbox"/> Other:
4b. Has the approved Stormwater Management Plan with proof of approval been attached?	<input type="checkbox"/> Yes <input type="checkbox"/> No
5. DWQ 401 Unit Stormwater Review	
5a. Does the Stormwater Management Plan meet the appropriate requirements?	<input type="checkbox"/> Yes <input type="checkbox"/> No N/A
5b. Have all of the 401 Unit submittal requirements been met?	<input type="checkbox"/> Yes <input type="checkbox"/> No N/A

F. Supplementary Information	
1. Environmental Documentation (DWQ Requirement)	
1a. Does the project involve an expenditure of public (federal/state/local) funds or the use of public (federal/state) land?	<input checked="" type="checkbox"/> Yes <input type="checkbox"/> No
1b. If you answered "yes" to the above, does the project require preparation of an environmental document pursuant to the requirements of the National or State (North Carolina) Environmental Policy Act (NEPA/SEPA)?	<input checked="" type="checkbox"/> Yes <input type="checkbox"/> No
1c. If you answered "yes" to the above, has the document review been finalized by the State Clearing House? (If so, attach a copy of the NEPA or SEPA final approval letter.) Comments:	<input checked="" type="checkbox"/> Yes <input type="checkbox"/> No
2. Violations (DWQ Requirement)	
2a. Is the site in violation of DWQ Wetland Rules (15A NCAC 2H .0500), Isolated Wetland Rules (15A NCAC 2H .1300), DWQ Surface Water or Wetland Standards, or Riparian Buffer Rules (15A NCAC 2B .0200)?	<input type="checkbox"/> Yes <input checked="" type="checkbox"/> No
2b. Is this an after-the-fact permit application?	<input type="checkbox"/> Yes <input checked="" type="checkbox"/> No
2c. If you answered "yes" to one or both of the above questions, provide an explanation of the violation(s):	
3. Cumulative Impacts (DWQ Requirement)	
3a. Will this project (based on past and reasonably anticipated future impacts) result in additional development, which could impact nearby downstream water quality?	<input type="checkbox"/> Yes <input checked="" type="checkbox"/> No
3b. If you answered "yes" to the above, submit a qualitative or quantitative cumulative impact analysis in accordance with the most recent DWQ policy. If you answered "no," provide a short narrative description. Due to the minimal transportation impact resulting from this bridge replacement, this project will neither influence nearby land uses nor stimulate growth. Therefore, a detailed indirect or cumulative effects study will not be necessary.	
4. Sewage Disposal (DWQ Requirement)	
4a. Clearly detail the ultimate treatment methods and disposition (non-discharge or discharge) of wastewater generated from the proposed project, or available capacity of the subject facility. not applicable	

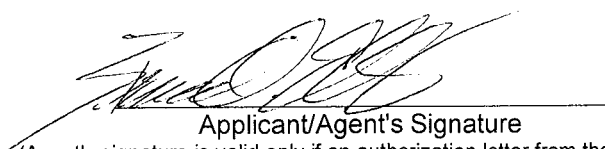
5. Endangered Species and Designated Critical Habitat (Corps Requirement)		
5a. Will this project occur in or near an area with federally protected species or habitat?	<input type="checkbox"/> Yes	<input checked="" type="checkbox"/> No
5b. Have you checked with the USFWS concerning Endangered Species Act impacts?	<input type="checkbox"/> Yes	<input checked="" type="checkbox"/> No
5c. If yes, indicate the USFWS Field Office you have contacted.	<input type="checkbox"/> Raleigh <input type="checkbox"/> Asheville	
5d. What data sources did you use to determine whether your site would impact Endangered Species or Designated Critical Habitat? USFWS County Site, NC Natural Heritage site, field survey's for bald eagle and dwarf wedgemussel (survey attached)		
6. Essential Fish Habitat (Corps Requirement)		
6a. Will this project occur in or near an area designated as essential fish habitat?	<input type="checkbox"/> Yes	<input checked="" type="checkbox"/> No
6b. What data sources did you use to determine whether your site would impact Essential Fish Habitat? NMFS County Index		
7. Historic or Prehistoric Cultural Resources (Corps Requirement)		
7a. Will this project occur in or near an area that the state, federal or tribal governments have designated as having historic or cultural preservation status (e.g., National Historic Trust designation or properties significant in North Carolina history and archaeology)?	<input type="checkbox"/> Yes	<input checked="" type="checkbox"/> No
7b. What data sources did you use to determine whether your site would impact historic or archeological resources? NEPA Documentation		
8. Flood Zone Designation (Corps Requirement)		
8a. Will this project occur in a FEMA-designated 100-year floodplain?	<input checked="" type="checkbox"/> Yes	<input type="checkbox"/> No
8b. If yes, explain how project meets FEMA requirements: NCDOT Hydraulics Unit coordination with FEMA		
8c. What source(s) did you use to make the floodplain determination? FEMA Maps		
<u>Dr. Gregory J. Thorpe, Ph D</u> Applicant/Agent's Printed Name	 Applicant/Agent's Signature <small>(Agent's signature is valid only if an authorization letter from the applicant is provided.)</small>	12/18/12 Date



MITIGATION REQUEST FORM TRI-PARTY MOA (NCDOT)

Revised 3/24/2008



Fill in requested information, print out the form, sign and date, and either mail to EEP, 1652 Mail Service Center, Raleigh, NC 27699-1652, or fax to 919-715-2219. Attachments are acceptable for clarification purposes.

Electronic submissions are permissible; however, an acceptance letter cannot be sent until the original signed form has been received.

NCDOT CONTACT INFORMATION		REGULATORY CONTACT INFORMATION	
Agency/Division	NCDOT-Highways	USACE Office	Regulatory Field Office
Branch	PDEA-NEU	USACE Contact	Mr. Tom Steffens
Mailing Address	1598 Mail Service Center	Mailing Address	Post Office Box 1000
City, State, Zip	Raleigh, NC 27699-1598	City, State, Zip	Washington, NC 27889-1000
Project Manager	John Merritt	USACE Fax Number	(252) 975-1399
Telephone Number	(919) 707-6000	NCDWQ Contact	
E-Mail Address	jsmerritt@dot.state.nc.us	Mailing Address	
Supervisor	Chris Rivenbark	City, State, Zip	
Telephone Number	(919) 707-6000	NCDWQ Fax Number	

PROJECT LOCATION INFORMATION AND IMPACTS			
TIP Number(s)		B-4679	
TIP Description		Replace Bridge No. 66 over Contentnea Creek Swamp on SR 1163	
Current Let Date		6/18/13	
NCDOT Highway Division		Division 4	
County(ies)		Wilson	
EEP Ecoregion(s)		Northern Inner Coastal Plain	
River Basin(s)			
Cataloging Unit(s) (8-digit)		03020203	
Total Stream (feet)	Warm		
	Cool		
	Cold		
	TOTAL		
Total Riparian Wetland Impact (acres)		0.19	
Total Non-Riparian Wetland Impact (acres)			
Total Coastal Marsh Impact (acres)			
Total Buffer Impact	Zone 1 (square feet)		
	Zone 2 (square feet)		

OTHER INFORMATION	
USACE Action ID Number (if known)	
NCDWQ Project Number (if known)	
NCDCM Project Number (if known)	
Comments:	

<p style="text-align: center;">IMPORTANT</p> <p style="text-align: center;">Check below if this request is a:</p> <p><input checked="" type="checkbox"/> New Mitigation Request</p> <p><input type="checkbox"/> Revision to a current acceptance</p>	<p style="text-align: center;">Signature of Applicant or Agent:</p> <p style="text-align: center;">_____</p> <p>Date: _____</p>
---	--



North Carolina Department of Transportation

Highway Stormwater Program
STORMWATER MANAGEMENT PLAN

FOR LINEAR ROADWAY PROJECTS



(Version 1.2; Released July 2012)

Project/TIP No.: B-4679 County(ies): Wilson Page 1 of 3

General Project Information

Project No.:		B-4679		Project Type: Bridge Replacement		Date: 9/19/2012	
NCDOT Contact:		Randy Henegar, P.E.		Contractor / Designer:			
	Address:	1590 Mail Service center Raleigh, NC 27699			Address:		
	Phone:	919-707-6726			Phone:		
	Email:	rhenegar@ncdot.gov			Email:		
City/Town:		Wilson		County(ies): Wilson			
River Basin(s):		Neuse		CAMA County?		No	
Primary Receiving Water:		Contentnea Creek		NCDWQ Stream Index No.:		27-86-(5.8) (checked)	
NCDWQ Surface Water Classification for Primary Receiving Water			Primary:	Water Supply IV (WS-IV)			
			Supplemental:	Nutrient Sensitive Waters (NSW)			
Other Stream Classification:		None		CA			
303(d) Impairments:		None					
Buffer Rules in Effect		N/A					

Project Description

Project Length (lin. Miles or feet):		0.111 MILES		Surrounding Land Use:		Swamp, woods.	
Proposed Project				Existing Site			
Project Built-Up Area (ac.)		0.51 ac.		0.33 ac.			
Typical Cross Section Description:		48' FACE TO FACE @ NORMAL CROWN		24' FACE TO FACE @ NORMAL CROWN			
Average Daily Traffic (veh/hr/day):		Design/Future: ADT 2035=14,700 TRK 3%		Existing: ADT 2009=8000			

General Project Narrative: B-4679 has a project # of 33833.1.1, Sta 12+53 _L_. Over Contentnea Creek. This is a bridge to be replaced by 90' 33" Box Beam, county brg. # 970066, on SR 1163 between 264 ByPass and SR 1165. Length of roadway project = 0.099 miles, Length of structure= 0.012 miles, total length of State Project = 0.111 miles, project is within Municipal boundaries of Wilson.

References

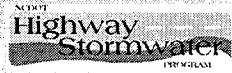

North Carolina Department of Transportation
Highway Stormwater Program
STORMWATER MANAGEMENT PLAN
FOR LINEAR ROADWAY PROJECTS



(Version 1.2; Released July 2012)

Project/TIP No.: B-4679

County(ies): Wilson

Page 2 of 3

Swales

Sheet No.	Station (From / To)	Stream Crossing Station	Base Width (ft)	Front Slope (H:V)	Back Slope (H:V)	Drainage Area (ac)	Recommended Treatment Length (ft)	Actual Length (ft)	Longitudinal Slope (%)	Q2 (cfs)	V2 (fps)	Q10 (cfs)	V10 (fps)	Rock Checks Used
4	14+50 15+86 RT			max.3:1	3:1	2.75	275		0.30%	5.7	1.4	7.4	1.5	no
							0							
							0							
							0							
							0							
							0							
							0							
							0							
							0							
							0							
							0							
							0							
							0							
							0							
							0							
							0							
							0							
							0							
							0							
							0							
							0							
							0							
							0							
							0							

YES NO Have minimum design criteria, as presented in the NCDOT Best Management Practices Toolbox, Version 1 (March 2008), been met and verified? If No, provide further explanation of why design criteria was not met.

Additional Comments

STATE OF NORTH CAROLINA
DIVISION OF HIGHWAYS

WILSON COUNTY

Permit Drawing
Sheet 1 of 8

STATE	STATE PROJECT REFERENCE NO.	SHEET NO.	TOTAL SHEETS
N.C.	B-4679	1	
STATE PROJ. NO.	F.A. PROJ. NO.	DESCRIPTION	
33833.1.1	BRSTP-1163(4)	PE	
33833.2.1	BRSTP-1163(4)	RW & UTIL	

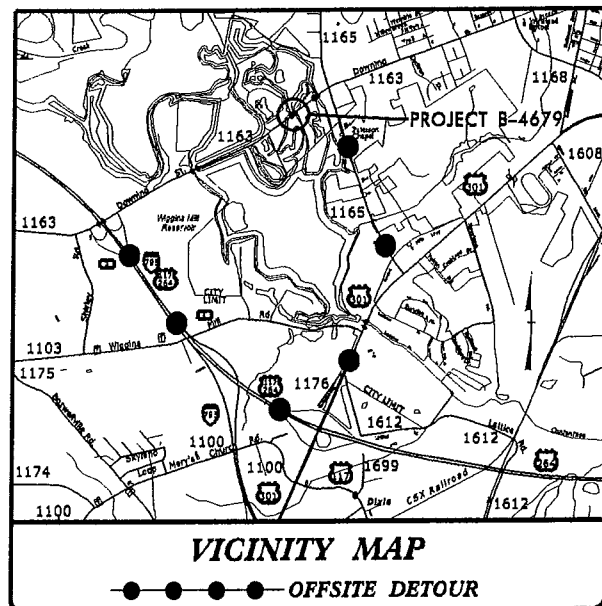

**LOCATION: BRIDGE 66 OVER A SWAMP OF CONTENTNEA CK
OVERFLOW/WIGGINS MILL RESERVOIR ON SR 1163
(DOWNING ROAD) IN WILSON**

WETLAND AND SURFACE WATER IMPACTS

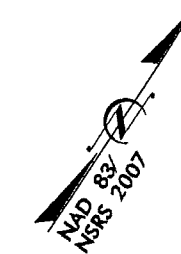

-L- STA 15+86.00 END TIP PROJECT B-4679

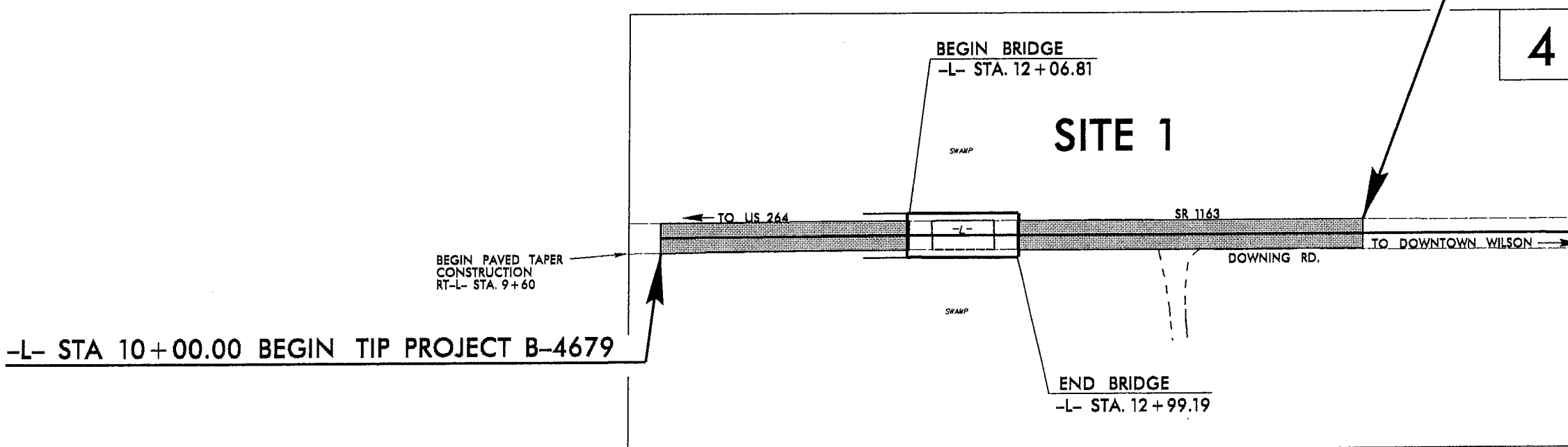

CLEARING ON THIS PROJECT SHALL BE PERFORMED TO THE LIMITS ESTABLISHED BY METHOD III
THIS PROJECT IS WITHIN THE MUNICIPAL BOUNDARIES OF WILSON

PRELIMINARY PLANS
DO NOT USE FOR CONSTRUCTION

GRAPHIC SCALES

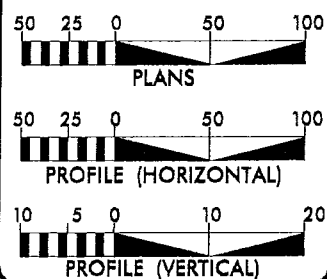

DESIGN DATA

ADT 2012 = 8,774
 ADT 2035 = 14,700
 DHV = 14 %
 D = 80 %
 T = 3 % *
 V = 60 MPH
 * TTST = 1% DUAL = 2%
 FUNC CLASS = LOCAL
 SUB REGIONAL TIER

PROJECT LENGTH

LENGTH OF ROADWAY TIP PROJECT B-4679 = 0.094 MILES
 LENGTH OF STRUCTURE TIP PROJECT B-4679 = 0.017 MILES
 TOTAL LENGTH OF STATE PROJECT B-4679 = 0.111 MILES

Prepared in the Office of:
DIVISION OF HIGHWAYS

1000 Birch Ridge Dr., Raleigh NC, 27610

2006 STANDARD SPECIFICATIONS

RIGHT OF WAY DATE:
June 15, 2012

LETTING DATE:
June 18, 2013

JAMES A. SPEER, PE
PROJECT ENGINEER

ALLISON K. WHITE
PROJECT DESIGN ENGINEER

HYDRAULICS ENGINEER

SIGNATURE: _____ P.E.

ROADWAY DESIGN
ENGINEER

SIGNATURE: _____ P.E.

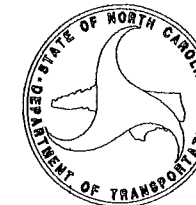

TIP PROJECT: B-4679

CONTRACT: C203157

SYSTEM TIME 09/10/2013 09:08:45

8/17/98

B-4679		4
RW SHEET NO.		
ROADWAY DESIGN ENGINEER	HYDRAULICS ENGINEER	
INCOMPLETE PLANS DO NOT USE FOR R/W ACQUISITION		
PRELIMINARY PLANS DO NOT USE FOR CONSTRUCTION		



Permit Drawing
Sheet 2 of 8

10+00

15+00

20+00

REVISIONS

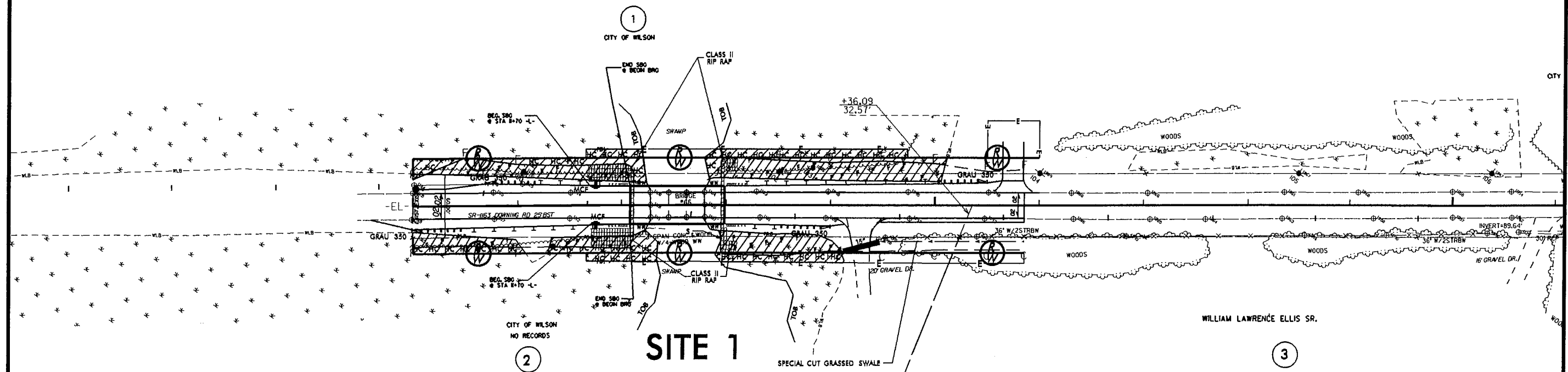

- DENOTES FILL IN WETLAND
- DENOTES IMPACTS IN SURFACE WATER
- DENOTES HAND CLEARING

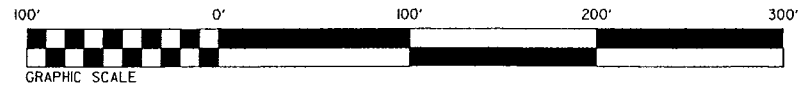

1
 2
 3
 4
 5
 6
 7
 8
 9
 10
 11
 12
 13
 14
 15
 16
 17
 18
 19
 20
 21
 22
 23
 24
 25
 26
 27
 28
 29
 30
 31
 32
 33
 34
 35
 36
 37
 38
 39
 40
 41
 42
 43
 44
 45
 46
 47
 48
 49
 50
 51
 52
 53
 54
 55
 56
 57
 58
 59
 60
 61
 62
 63
 64
 65
 66
 67
 68
 69
 70
 71
 72
 73
 74
 75
 76
 77
 78
 79
 80
 81
 82
 83
 84
 85
 86
 87
 88
 89
 90
 91
 92
 93
 94
 95
 96
 97
 98
 99
 100

PROJECT REFERENCE NO. B-4679	SHEET NO. 4
RW SHEET NO.	
ROADWAY DESIGN ENGINEER	HYDRAULICS ENGINEER
INCOMPLETE PLANS DO NOT USE FOR R/W ACQUISITION	
PRELIMINARY PLANS DO NOT USE FOR CONSTRUCTION	

MAD 83/MSR 2007

Permit Drawing
Sheet 3 of 8

REVISIONS

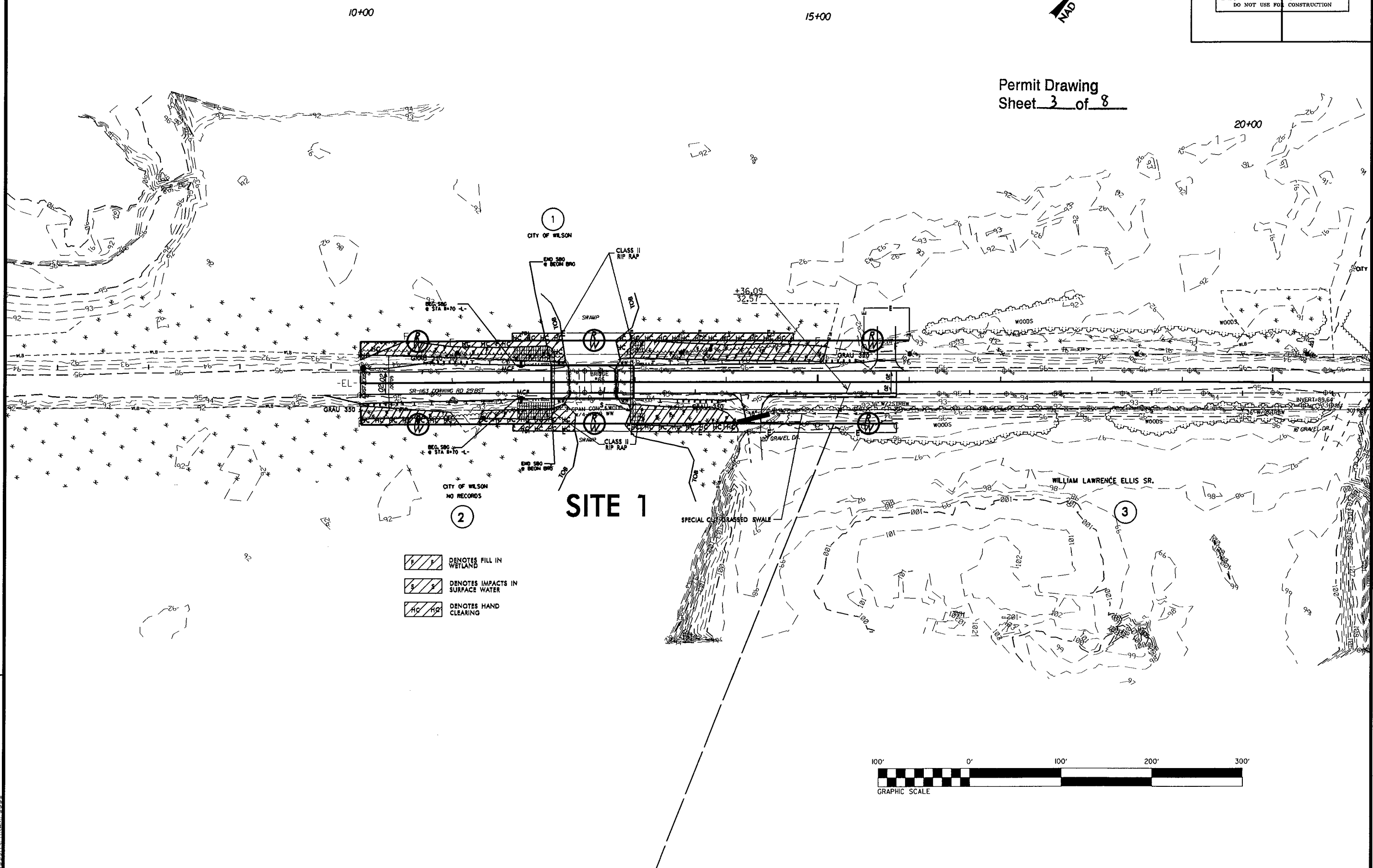

8/17/99

$PI = 10+46.00$
 $EL = 94.79'$
 $VC = 64'$

$\text{CL STA. } 12+53.00 \text{ -L-}$
 $1 @ 90', 33'' \text{ BOX BEAM}$
 $\text{CL GRADE} = 95.41'$
 $\text{SKEW} = 90 \text{ DEGREES}$

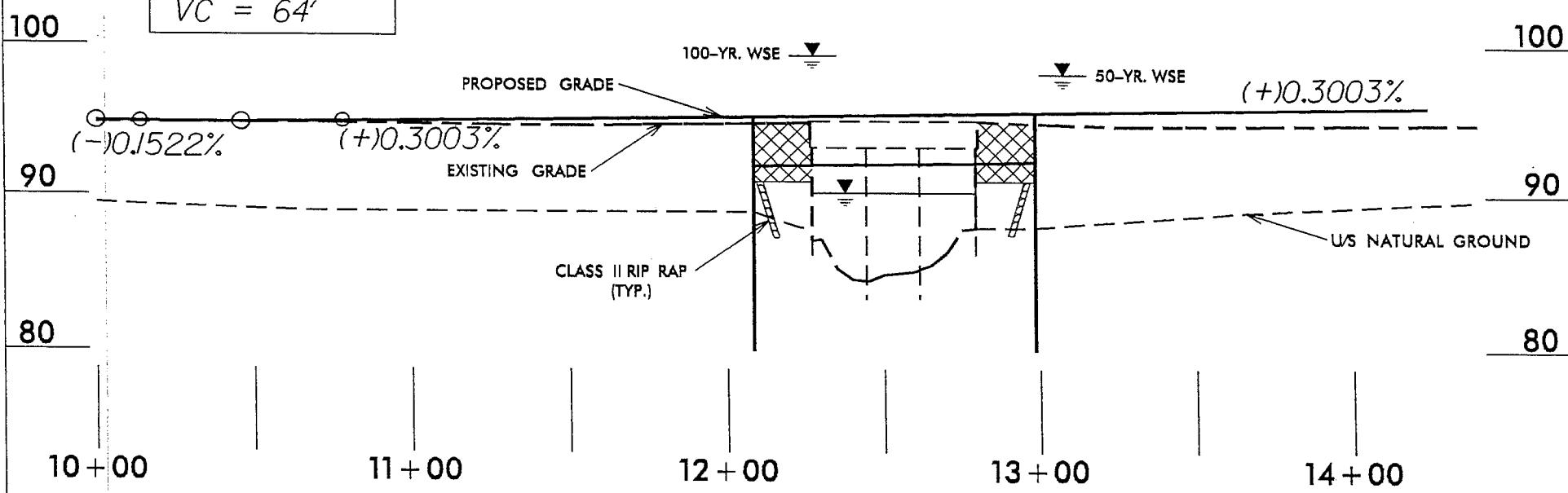

PROFILE

Permit Drawing
 Sheet 4 of 8

NCDOT
 DIVISION OF HIGHWAYS
 WILSON COUNTY
 PROJECT: 33833.1.1 (B-4679)
 BRIDGE 66 OVER A
 SWAMP ON CONTENTNEA CK
 OVERFLOW/WIGGINS MILL RESERVOIR
 ON SR1163 (DOWNING RD.) IN WILSON
 SHEET OF 08/17/12

8/23/99

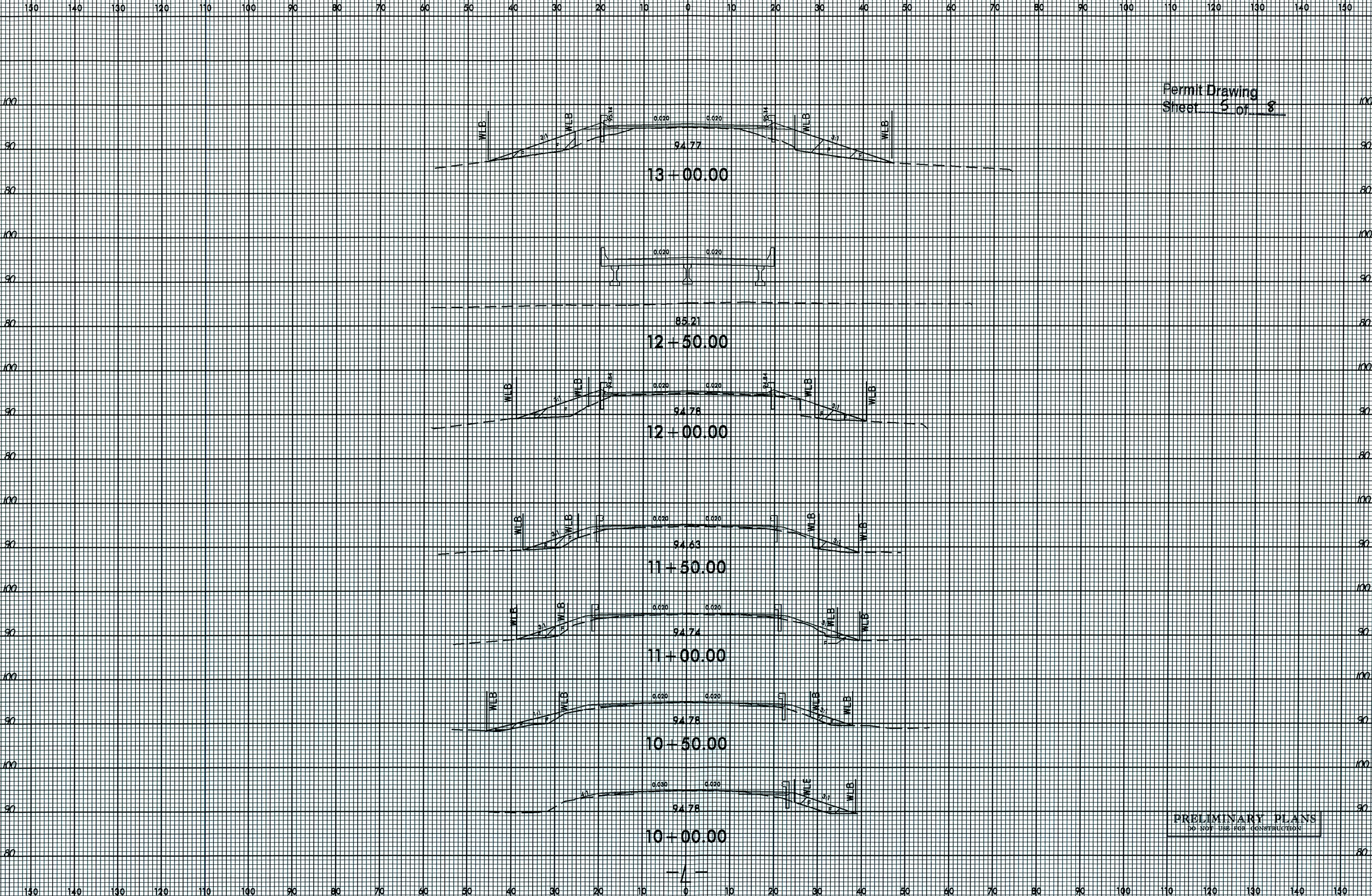

Permit Drawing
Sheet 5 of 8

PRELIMINARY PLANS
DO NOT USE FOR CONSTRUCTION

*****SYTIME*****
*****SUN*****
*****SCHUBERT*****

PROPERTY OWNERS

<u>Site</u>	<u>Last Name</u>	<u>First Name</u>	<u>Address</u>	<u>City/Town</u>	<u>State</u>	<u>Zip Code</u>
1	CITY OF WILSON		PO Box 10	Wilson	NC	27894-0010

Permit Drawing
Sheet 7 of 8

NC DEPARTMENT OF TRANSPORTATION
DIVISION OF HIGHWAYS

CUMBERLAND COUNTY
WBS - 33833.1.1 (B-4679)

SHEET

8/17/2012

WETLAND PERMIT IMPACT SUMMARY

Site No.	Station (From/To)	Structure Size / Type	WETLAND IMPACTS					SURFACE WATER IMPACTS				
			Permanent Fill In Wetlands (ac)	Temp. Fill In Wetlands (ac)	Excavation in Wetlands (ac)	Mechanized Clearing in Wetlands (ac)	Hand Clearing in Wetlands (ac)	Permanent SW impacts (ac)	Temp. SW impacts (ac)	Existing Channel Impacts Permanent (ft)	Existing Channel Impacts Temp. (ft)	Natural Stream Design (ft)
1	12+53 -L-	BRIDGE	0.19				0.19	<0.01				
TOTALS:			0.19				0.19	<0.01				

Impact of 0.04 acres of Temporary Fill in Wetlands for Erosion Control devices.

Permit Drawing
Sheet 8 of 8

NC DEPARTMENT OF TRANSPORTATION
DIVISION OF HIGHWAYS

WILSON COUNTY
WBS - 33833.1.1 (B-4679)

SHEET 8/15/2012

ATN Revised 3/31/05

TIP PROJECT: B-4679

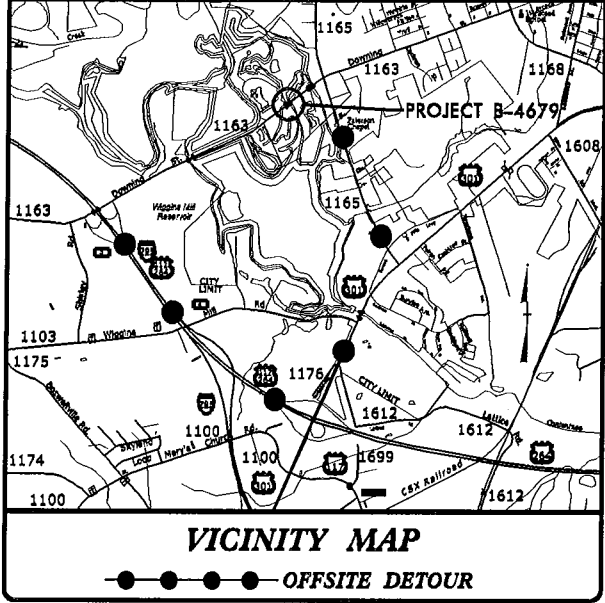

STATE OF NORTH CAROLINA
DIVISION OF HIGHWAYS

**NEU UTILITY
RELOCATION PLANS
WILSON COUNTY**

T.I.P. NO.	SHEET NO.
B-4679	UO-1

NEU UTILITY
RELOCATION PLANS

Utility Permit Drawing
Sheet 1 of 3

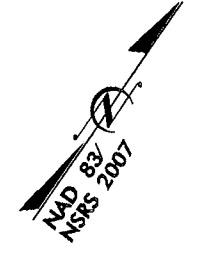

**LOCATION: BRIDGE NO. 66 OVER A SWAMP ON SR 1163 DOWNING RD.
TYPE OF WORK: RELOCATION OF POWER AND TELEPHONE POLES AND LINES**

-L- STA 15+86.00 END TIP PROJECT B-4679

-L- STA 10+00.00 BEGIN TIP PROJECT B-4679

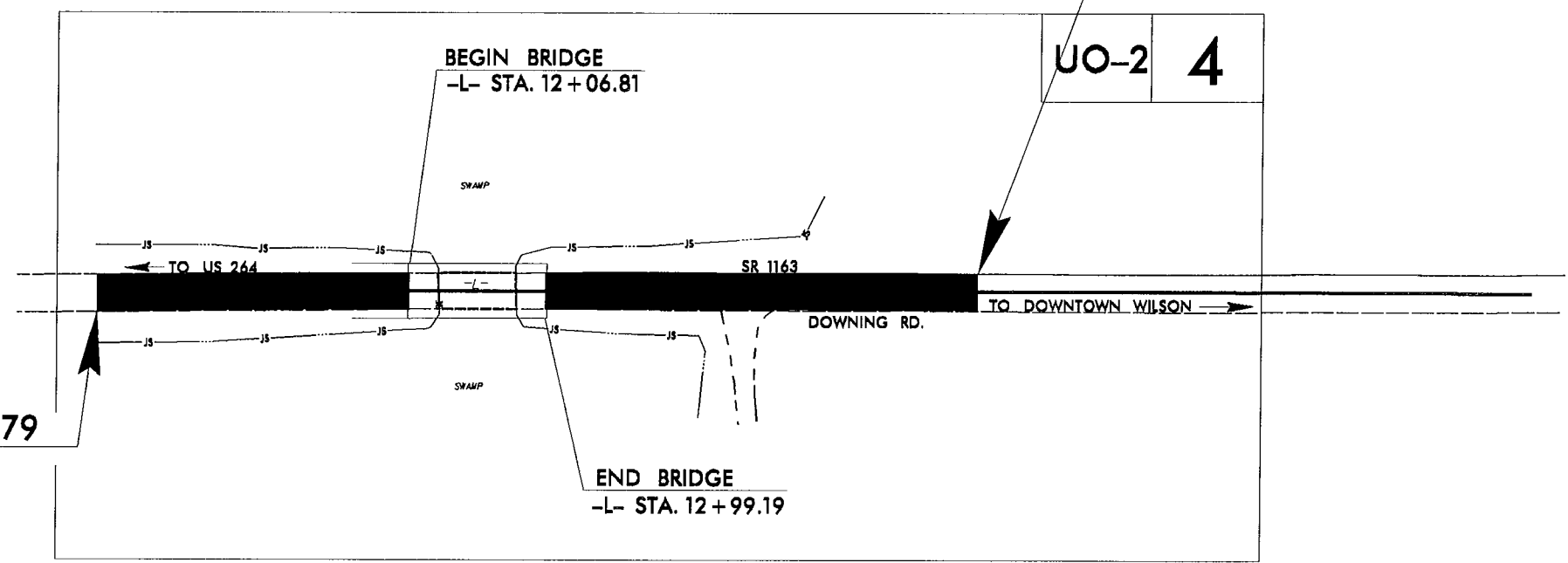

INCOMPLETE PLANS
DO NOT USE FOR R/W ACQUISITION
PRELIMINARY PLANS
DO NOT USE FOR CONSTRUCTION

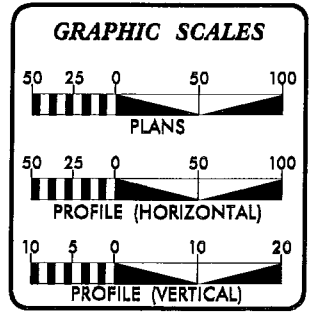

SHEET NO.	DESCRIPTION
UO-1	TITLE SHEET
UO-2	UTILITY BY OTHERS PLAN SHEET

UTILITY OWNERS ON PROJECT
(1) CITY OF WILSON POWER
(2) CENTURYLINK TELEPHONE

PREPARED IN THE OFFICE OF:
**DIVISION OF HIGHWAYS
UTILITIES UNIT
UTILITIES ENGINEERING**

1591 MAIL SERVICES CENTER
RALEIGH NC 27699-1591
PHONE (919) 707-6690
FAX (919) 250-4151

<u>Roger Worthington, P.E.</u>	UTILITIES SECTION ENGINEER
<u>Corey Bouquet, P.E.</u>	UTILITIES SQUAD LEADER PROJECT ENGINEER
<u>Kelvin Martin</u>	UTILITIES PROJECT DESIGNER

28-NOV-2012 14:11 R:\Utilities\Proj\Neu\B-4679_Ut_U01sh.dgn \$\$\$\$USERNAME\$\$\$

UTILITIES BY OTHERS

NOTE:
ALL PROPOSED UTILITY WORK
SHOWN ON THIS SHEET WILL
BE DONE BY OTHERS

Utility Permit Drawing
Sheet 2 of 3

PRELIMINARY PLANS
DO NOT USE FOR CONSTRUCTION

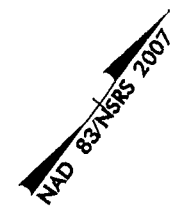

10+00

15+00

20+00

BEGIN TIP PROJECT
-L- STA.10+00.00

END TIP PROJECT B-4679
BEGIN TIP PROJECT B-5126
-L- STA.15+86.00

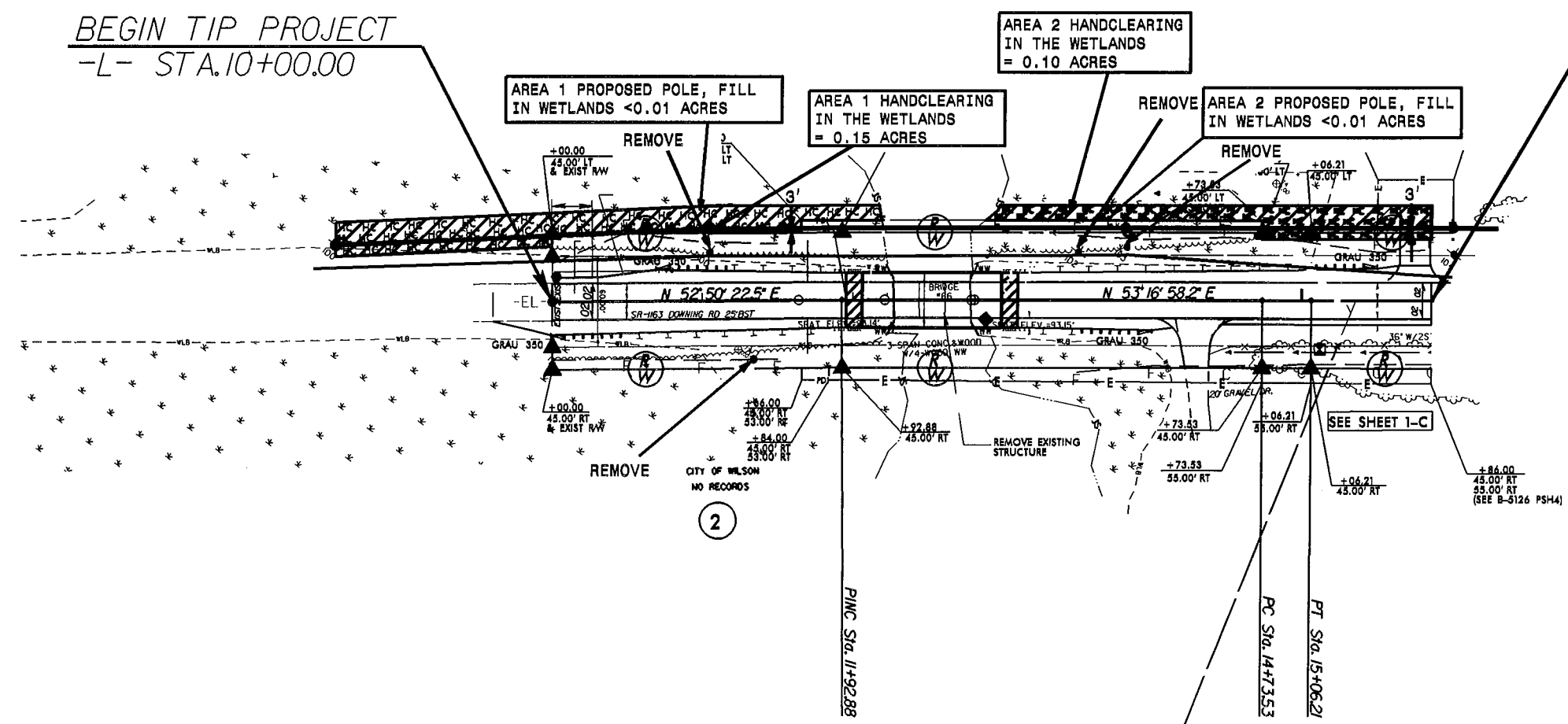

(FILL IN WETLANDS IS DUE TO INSTALLATION OF 3 MULTIUSE POLES)

DENOTES FILL IN WETLAND
 DENOTES HAND CLEARING

Site No.	Station (From/To)	Structure Size / Type	WETLAND IMPACTS					SURFACE WATER IMPACTS				
			Permanent Fill In Wetlands (ac)	Temp. Fill In Wetlands (ac)	Excavation in Wetlands (ac)	Mechanized Clearing in Wetlands (ac)	Hand Clearing in Wetlands (ac)	Permanent SW impacts (ac)	Temp. SW impacts (ac)	Existing Channel Impacts Permanent (ft)	Existing Channel Impacts Temp. (ft)	Natural Stream Design (ft)
A1	10+00 to 12+24	O/H Pow/Tel Line					0.15					
A1	11+06	Utl Pole	<0.01									
A2	12+79 to 15+86	O/H Pow/Tel Line					0.10					
A2	13+82	Utl Pole	<0.01									
TOTALS:			<0.01				0.25					

Utility Permit Drawing
 Sheet 3 of 3

NC DEPARTMENT OF TRANSPORTATION
 DIVISION OF HIGHWAYS

 WILSON COUNTY
 PROJECT: B-4679

 SHEET 1 OF 1 11/28/2012