



STATE OF NORTH CAROLINA
DEPARTMENT OF TRANSPORTATION

MICHAEL F. EASLEY
GOVERNOR

LYNDO TIPPETT
SECRETARY

November 14, 2003

U. S. Army Corps of Engineers
Regulatory Field Office
Post Office Box 1000
Washington, NC 27889-1000

ATTENTION: Mr. Mike Bell
NCDOT Coordinator

Dear Sir:

Subject: **Nationwide 23 Permit Application** for the Replacement of Bridge No. 88 over Falling Creek on SR 1006, Wayne County, Federal Aid Project No. BRZ-1006(11), State Project No. 8.2331501, TIP B-3712, Division 4.

Please find enclosed three copies of the project planning report for the above referenced project. Bridge No. 88 will be replaced in the existing location with a cored slab bridge, approximately 100 feet (30 m) in length with a 40-foot (12.0 m) clear roadway width. The bridge will have two 12.0-foot (3.6 m) travel lanes and 8.0-foot (2.4 m) lateral offsets on each side. The new approach roadway will include two 12-foot (3.6 m) travel lanes, and 8-foot (2.4 m) shoulders on each side. A design speed of 60 mph (100 km/hr) will be provided.

There will be no permanent or temporary jurisdictional wetland impacts associated with this project. There will be no permanent surface water impacts; however, there will be temporary impacts due to bridge demolition.

The Stream Crossing Guidelines for Anadromous Fish Passage will be implemented, as applicable.

The bridge will be built using top-down construction. Access can be achieved from either side of the bank due to the bridge being a 2-span structure. No causeway or work pad will be needed, and thus, there will be no temporary impacts from construction access.

During construction, traffic will be maintained by an off-site detour using SR 1106, SR 1105, and US 13.

Bridge Demolition

Bridge Demolition: Bridge No. 88 is a four span bridge composed of a reinforced concrete deck with an asphalt-wearing surface supported by timber abutments. The existing structure is 70 feet (21.0 m) long with a 24-foot (7.2 m) clear roadway width. Due to the structural components of the bridge, there is the possibility of 34 cubic yards (26 cu. m) of temporary fill being dropped into the "Waters of the United States". All measures will be taken to avoid any temporary fill from entering Waters of the U.S. Best Management Practices for Bridge Demolition and Removal will be implemented.

As noted in the project's CE document, NCDOT will observe an in-stream construction moratorium from February 15 to June 1.

Federally Protected Species

As of January 29, 2003, the United States Fish and Wildlife Service (USFWS) lists one federally protected species for Wayne County. The red-cockaded woodpecker (*Picoides borealis*) is listed as endangered. This project CE's Biological Conclusion for the red-cockaded woodpecker remains: No Effect.

Regulatory Approvals

Section 404 Permit: This project is being processed by the Federal Highway Administration as a "Categorical Exclusion" in accordance with 23 CFR 771.115(b). Therefore, we do not anticipate requesting an individual permit but propose to proceed under a Nationwide 23 as authorized by a Nationwide Permit 23 (67 FR 2020; January 15, 2002).

Section 401 Permit: We anticipate 401 General Certification number 3403 will apply to this project. In accordance with 15A NCAC 2H, Section .0500(a) we are providing two copies of this application to the North Carolina Department of Environmental and Natural Resources, Division of Water Quality, for their review.

Neuse Buffer Rules: A Buffer Certification Application was requested on October 3, 2003 from the North Carolina Division of Water Quality (DWQ). This project lies within the Neuse River Basin; therefore, the regulations pertaining to the Neuse River Buffer Rules will apply. There are 0.067 acres of impacts to Buffer Zone One and 0.082 acres of impacts to Buffer Zone Two (see sheet 7 of 7).

A copy of this permit application will be posted on the DOT website at: <http://www.ncdot.org/planning/pe/naturalunit/Permit.html>.

If you have any questions or need additional information, please contact Mr. Chris Underwood at (919) 715-1541.

Sincerely,



Gregory J. Thorpe, PhD, Environmental Management Director
Project Development and Environmental Analysis Branch

cc:

w/attachment

Mr. John Dorney, Division of Water Quality (2 copies)
Mr. Travis Wilson, NCWRC
Mr. Gary Jordan, USFWS
Mr. Greg Perfetti, P.E., Structure Design

w/o attachment

Mr. David Franklin, USACE, Wilmington
Mr. Jay Bennett, P.E., Roadway Design
Mr. Omar Sultan, Programming and TIP
Ms. Debbie Barbour, P.E., Highway Design
Mr. David Chang, P.E., Hydraulics
Mr. Mark Staley, Roadside Environmental
Mr. John Sullivan, FHWA
Mr. J. H. Trogdon, P.E., Division Engineer
Mr. Jamie Shern, DEO
Ms. Stacy Baldwin, Project Planning Engineer

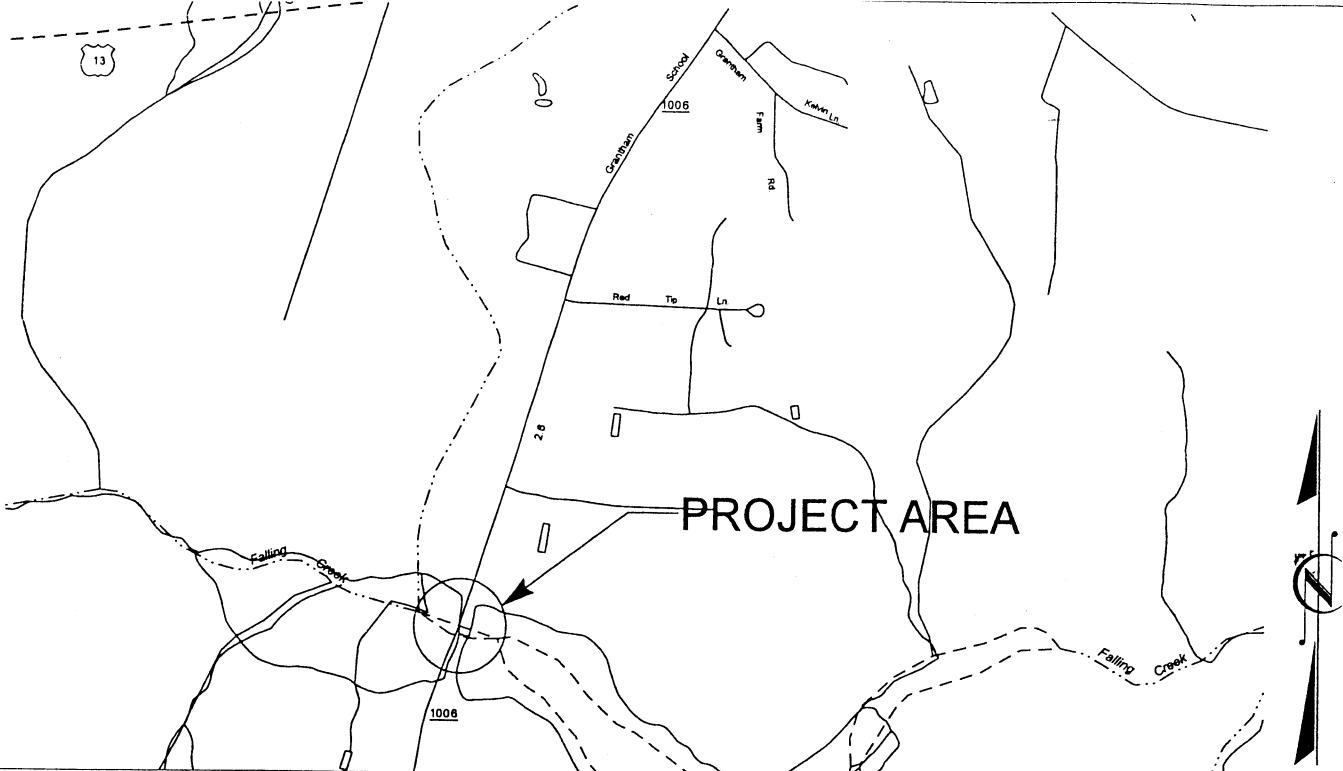

PROJECT AREA

PORTION OF WAYNE COUNTY

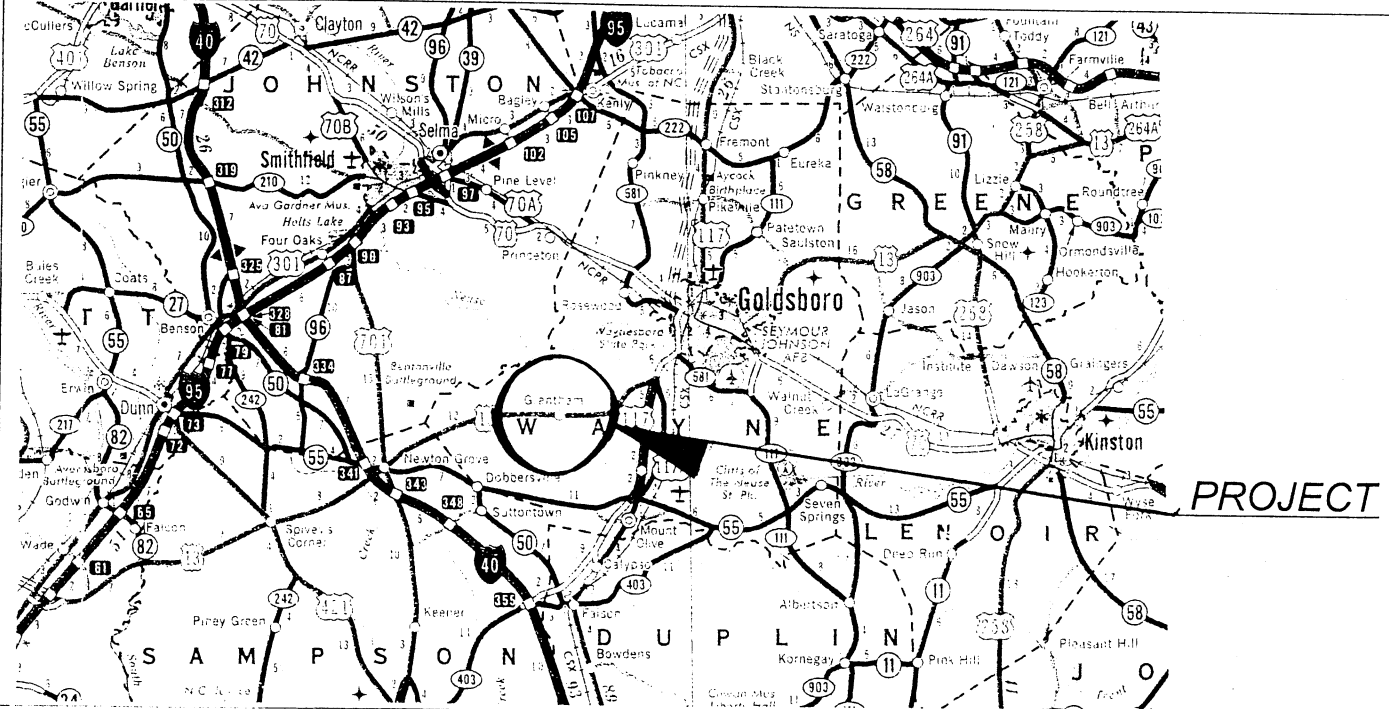

PROJECT

PORTION OF STATE MAP

NORTH CAROLINA
DEPARTMENT OF HIGHWAYS

WAYNE COUNTY
8,2331501 (B-3712)
REPLACE BRIDGE NO.88 AND APPROACHES
OVER FALLING CREEK ON SR 1006

WETLAND IMPACTS

SCALE AS SHOWN

SHEET 1 OF 7

82331501 (B-3712) 11/10/2000

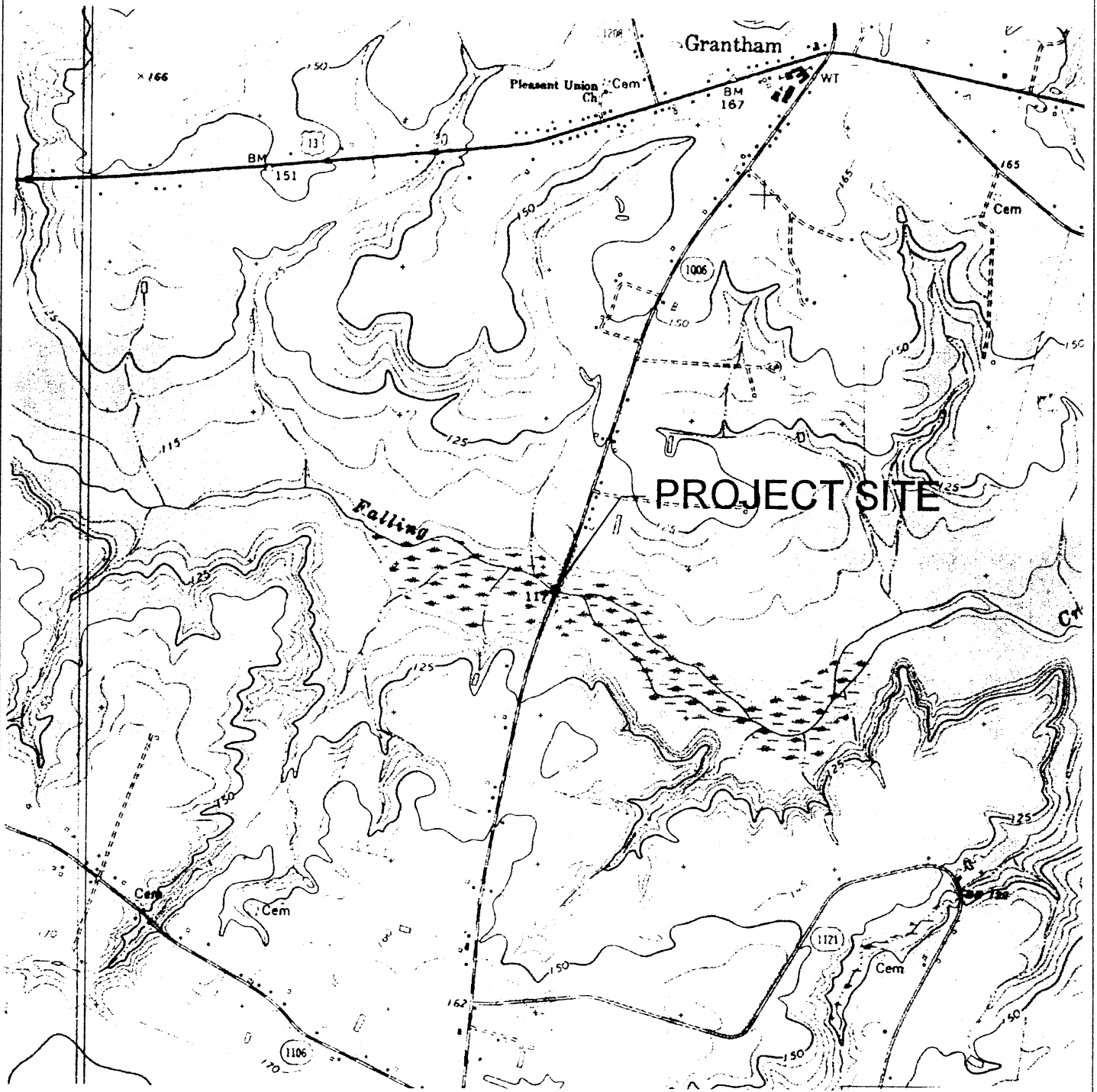

PROJECT SITE

QUAD MAP OVERLAY
WETLAND SITE MAP

*NORTH CAROLINA
 DEPARTMENT OF HIGHWAYS*

WAYNE COUNTY
 8.2331501(B-3712)
 REPLACE BRIDGE NO.88 AND APPROACHES
 OVER FALLING CREEK ON SR 1006

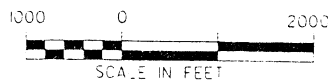

SCALE AS SHOWN

SHEET **2** OF **7**

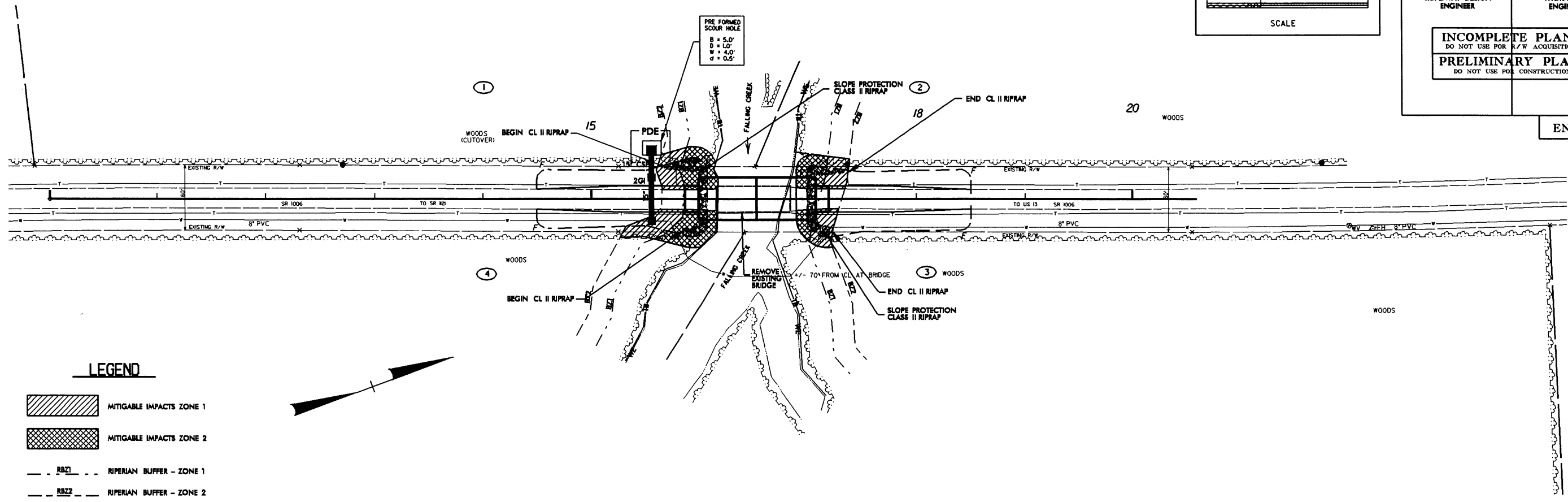
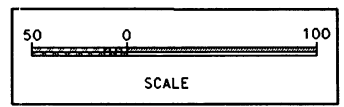

LEGEND

- MITIGABLE IMPACTS ZONE 1
- MITIGABLE IMPACTS ZONE 2
- RBZ1 RIPARIAN BUFFER - ZONE 1
- RBZ2 RIPARIAN BUFFER - ZONE 2

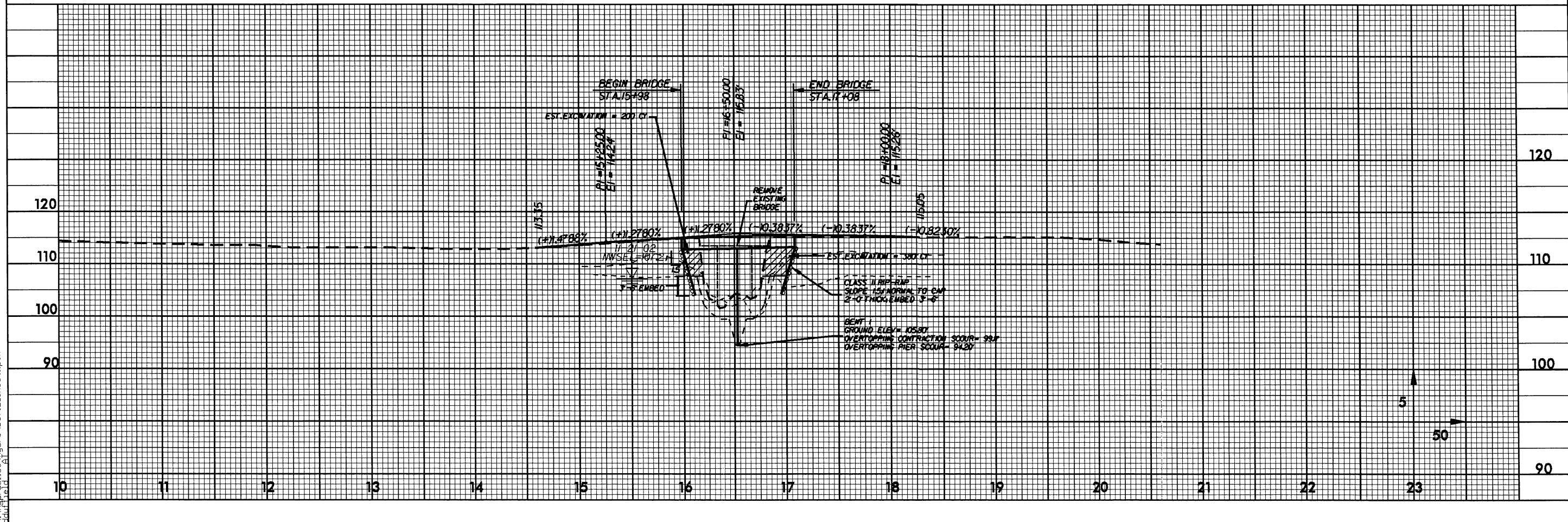

07_AUG-2003 14:09
 R:\Hydraulics\Hydro\B3712-sheet1.psh
 addfield

PROJECT REFERENCE NO. B-3712	SHEET NO. 4097
R/W SHEET NO. ROADWAY DESIGN ENGINEER	HYDRAULICS ENGINEER
INCOMPLETE PLANS DO NOT USE FOR ACQUISITION PRELIMINARY PLANS DO NOT USE FOR CONSTRUCTION	

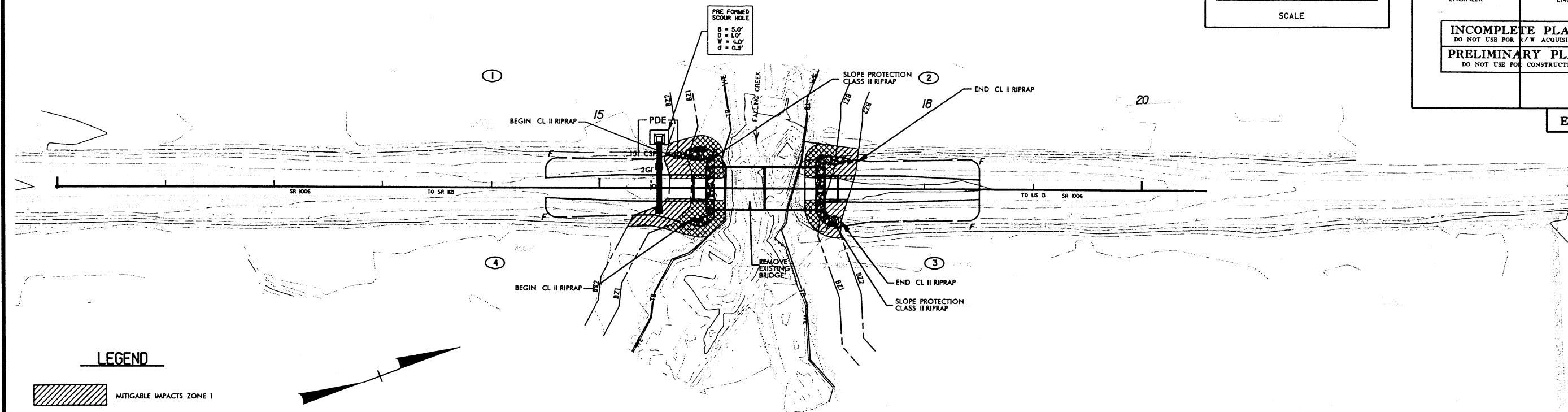
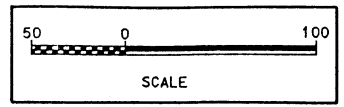

LEGEND

	MITIGABLE IMPACTS ZONE 1
	MITIGABLE IMPACTS ZONE 2
	RBZ1 RIPERIAN BUFFER - ZONE 1
	RBZ2 RIPERIAN BUFFER - ZONE 2

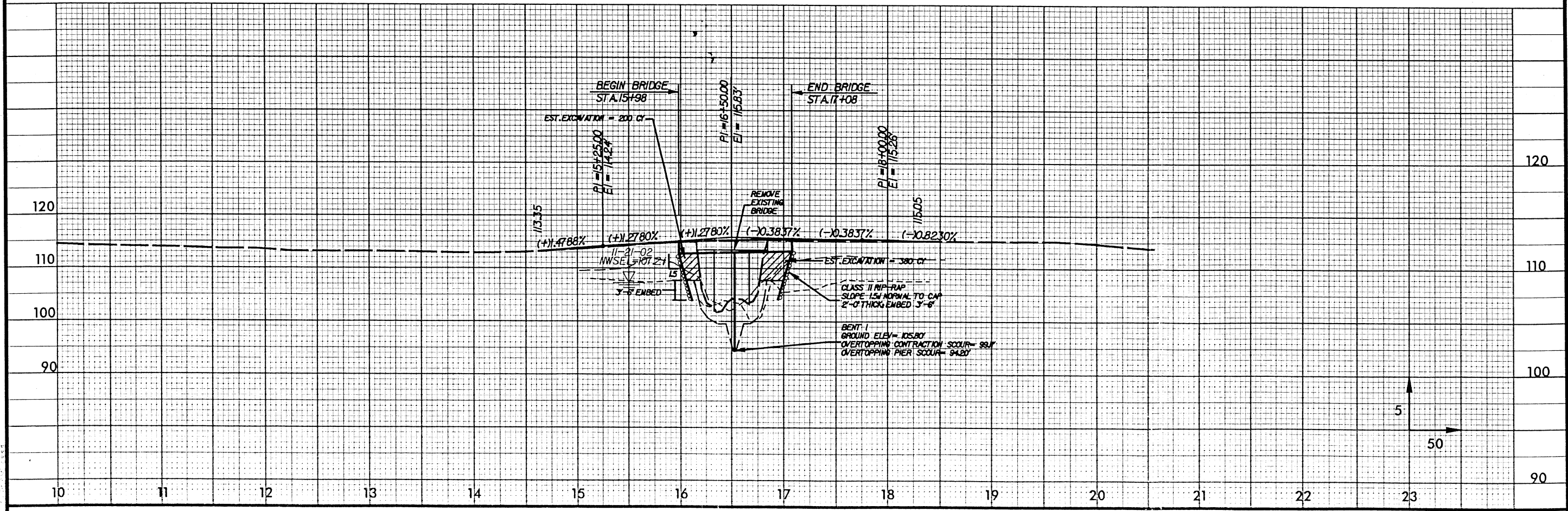

11/15/02
 11/21/02
 11/27/02
 11/28/02
 11/29/02
 11/30/02
 12/01/02
 12/02/02
 12/03/02
 12/04/02
 12/05/02
 12/06/02
 12/07/02
 12/08/02
 12/09/02
 12/10/02
 12/11/02
 12/12/02
 12/13/02
 12/14/02
 12/15/02
 12/16/02
 12/17/02
 12/18/02
 12/19/02
 12/20/02
 12/21/02
 12/22/02
 12/23/02
 12/24/02
 12/25/02
 12/26/02
 12/27/02
 12/28/02
 12/29/02
 12/30/02
 12/31/02

