



STATE OF NORTH CAROLINA  
DEPARTMENT OF TRANSPORTATION

MICHAEL F. EASLEY  
GOVERNOR

LYNDO TIPPETT  
SECRETARY

February 24, 2005

Division of Coastal Management  
1367 U.S. 17 South  
Elizabeth City, NC 27909

ATTENTION: Ms. Lynn Mathis  
NCDOT Coordinator

Dear Madam:

Subject: **CAMA Major Development Permit Application** for the Replacement of Bridge No. 32 over Rose Bay Creek on US 264, Hyde County. Federal Aid Project No. BRSTP-264(11), State Project No. 8.1080701, TIP Project No. B-3349.

Please find enclosed revisions to the permit drawings and half-size plan sheets for the above-mentioned project. Please replace originals with the corresponding plans.

If you have any questions or need additional information, please contact Chris Underwood at (919) 715-1451.

Sincerely,

Gregory J. Thorpe, Ph.D., Environmental Management Director  
Project Development and Environmental Analysis

w/ attachment:

Mr. John Hennessy, DWQ Raleigh  
Ms. Cathy Brittingham, DCM  
Mr. Travis Wilson, NCWRC  
Mr. Gary Jordan, USFWS  
Mr. Jay Bennett, P.E., Roadway Design  
Mr. Omar Sultan, Programming and TIP  
Mr. Art McMillan, P.E., Highway Design  
Mr. David Chang, P.E., Hydraulics  
Mr. Greg Perfetti, P.E., Structure Design  
Mr. Mark Staley, Roadside Environmental  
Mr. John Sullivan, FHWA  
Mr. D.R. Conner, P.E., Division Engineer  
Mr. Clay Willis, DEO  
Mr. David Franklin, USACE, Wilmington  
Ms. Stacy Baldwin, P.E., PDEA

**MAILING ADDRESS:**  
NC DEPARTMENT OF TRANSPORTATION  
PROJECT DEVELOPMENT AND ENVIRONMENTAL ANALYSIS  
1548 MAIL SERVICE CENTER  
RALEIGH NC 27699-1548

TELEPHONE: 919-733-3141  
FAX: 919-733-9794

WEBSITE: [WWW.NCDOT.ORG](http://WWW.NCDOT.ORG)

**LOCATION:**  
TRANSPORTATION BUILDING  
1 SOUTH WILMINGTON STREET  
RALEIGH NC



STATE OF NORTH CAROLINA  
DEPARTMENT OF TRANSPORTATION

MICHAEL F. EASLEY  
GOVERNOR

LYNDO TIPPETT  
SECRETARY

February 24, 2005

U. S. Army Corps of Engineers  
Regulatory Field Office  
Post Office Box 1000  
Washington, NC 27889-1000

ATTENTION: Mr. Bill Biddlecome  
NCDOT Coordinator

Dear Sir:

Subject: **Nationwide 23 Permit Drawing and Half-size Plan Revisions** for the Replacement of Bridge No. 32 over Rose Bay Creek on US 264, Hyde County. Federal Aid Project No. BRSTP-264(11), State Project No. 8.1080701, TIP Project No. B-3349.

Please find enclosed revisions to the permit drawings and half-size plan sheets for the above-mentioned project. Please replace originals with the corresponding plans.

If you have any questions or need additional information, please contact Chris Underwood at (919) 715-1451.

Sincerely,

Gregory J. Thorpe, Ph.D., Environmental Management Director  
Project Development and Environmental Analysis

W/attachment

Mr. John Hennessy, Division of Water Quality (7 copies)  
Mr. Gary Jordan, USFWS  
Mr. Travis Wilson, NCWRC  
Ms. Cathy Brittingham, NCDCM  
Ms. Lynn Mathis, NCDCM  
Mr. David Chang, P.E., Hydraulics  
Mr. Greg Perfetti, P.E., Structure Design  
Mr. Don Conner, P.E., Division Engineer  
Mr. Clay Willis, DEO

W/o attachment

Mr. David Franklin, USACE, Wilmington (Cover Letter Only)  
Mr. Jay Bennett, P.E., Roadway Design  
Mr. Omar Sultan, Programming and TIP  
Mr. Art McMillan, P.E., Highway Design  
Mr. Mark Staley, Roadside Environmental  
Ms. Stacy Baldwin, P.E., PDEA

7/2/99

REVISIONS



REVISED 01/18/05



PROJECT REFERENCE NO. B-3349	SHEET NO. 4
RW SHEET NO.	
ROADWAY DESIGN ENGINEER	HYDRAULICS ENGINEER
	2-23-05 RCH
-L-	

BEGIN PROJECT B-3349 -L- STA. 11+50

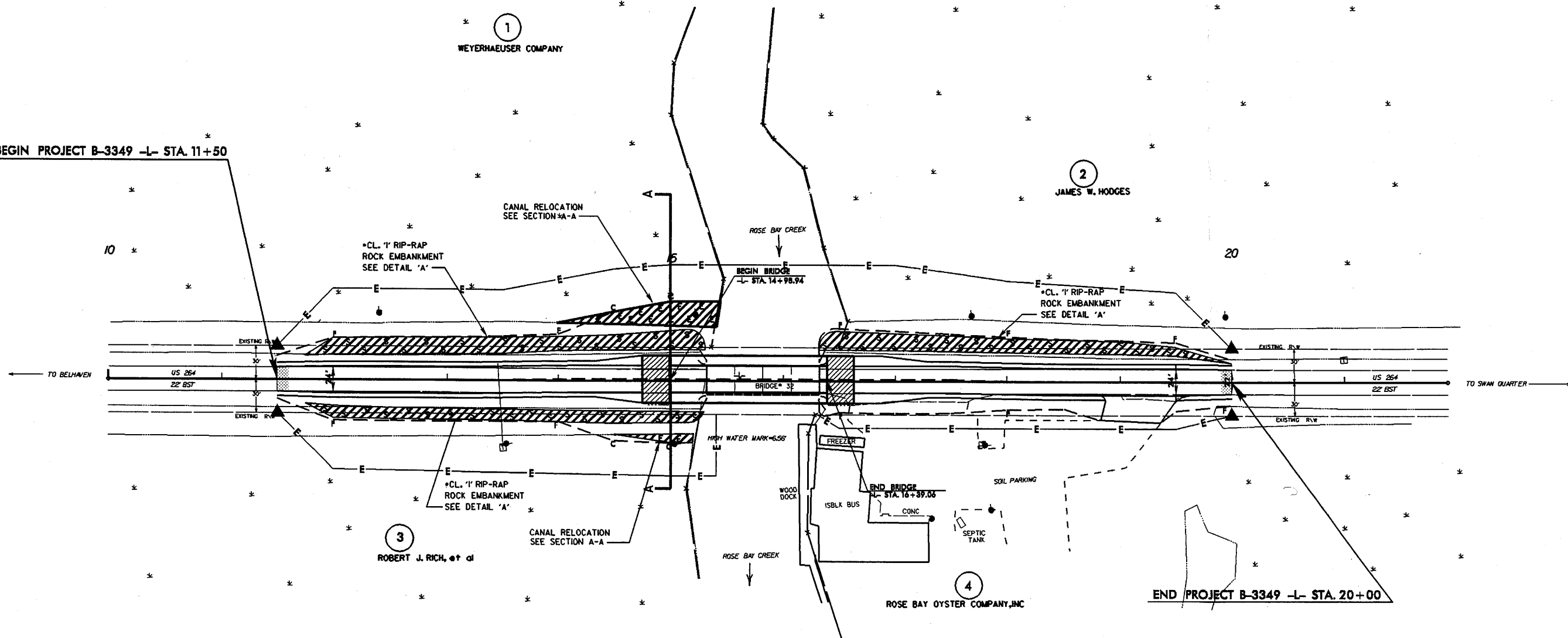

DENOTES FILL IN SURFACE WATER

DENOTES EXCAVATION IN WETLAND

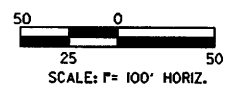

REVISED 1/18/05

DESIGN EXCEPTION REQUIRED FOR -L- LINE SHOULDER WIDTHS.

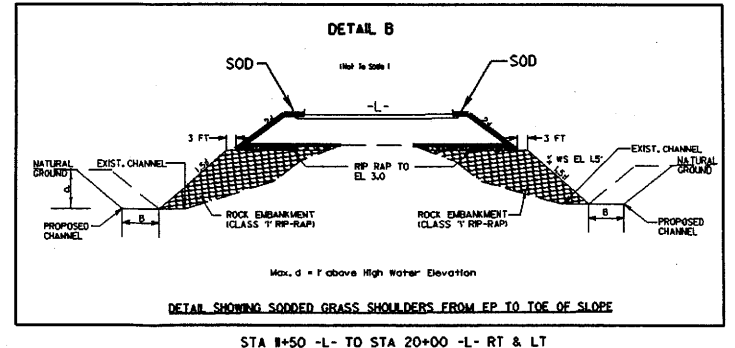

NOTE: SEE SHEET 5 FOR -L- PROFILE  
SEE SHEETS S-1 THRU S-44 FOR STRUCTURE PLANS  
SEE SHEET 4A FOR DETOUR ALIGNMENT

23-FEB-2005 11:01  
P:\Hydro\Utilities\Revised\cadd\b3349\_hyd\_drn.dgn  
jedunnh000

7/2/99

REVISIONS



REVISED 01/18/05



PROJECT REFERENCE NO. B-3349	SHEET NO. 05
RW SHEET NO.	
ROADWAY DESIGN ENGINEER	HYDRAULICS ENGINEER
	2-23-05 RCH
-L-	

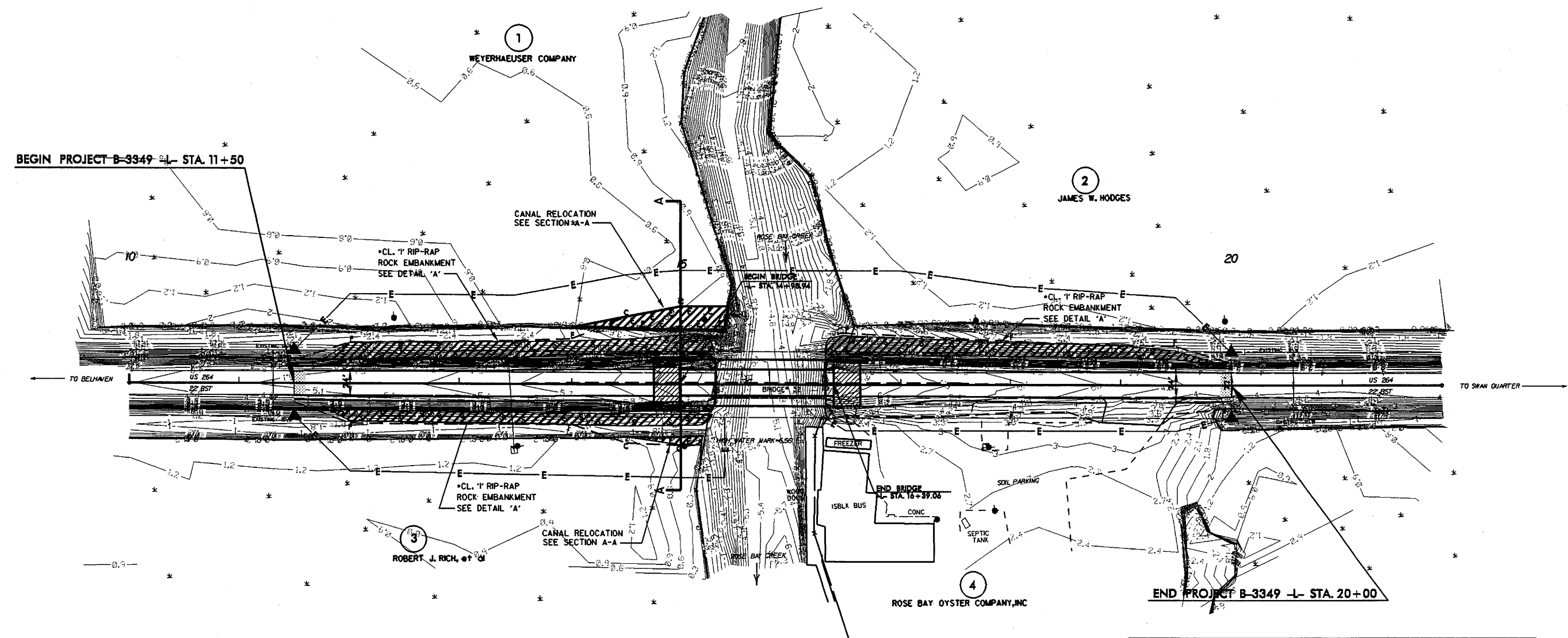

DENOTES FILL IN SURFACE WATER

DENOTES EXCAVATION IN WETLAND

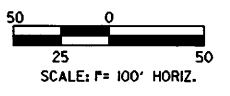

REVISED 1/18/05

DESIGN EXCEPTION REQUIRED FOR -L- LINE SHOULDER WIDTHS.

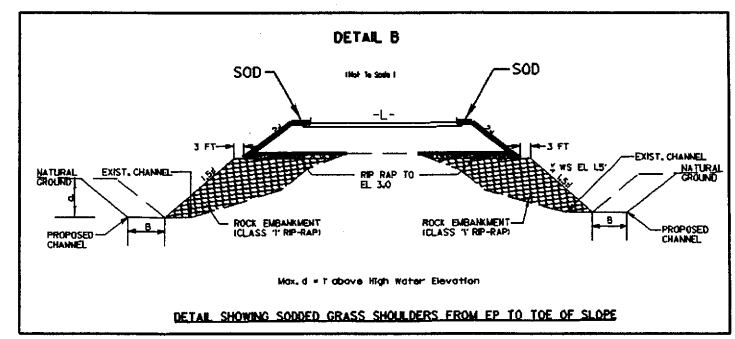

STA #+50 -L- TO STA 20+00 -L- RT & LT

NOTE: SEE SHEET 5 FOR -L- PROFILE  
SEE SHEETS S-1 THRU S-44 FOR STRUCTURE PLANS  
SEE SHEET 4A FOR DETOUR ALIGNMENT

23-FEB-2005 10:59  
 F:\Hydraulics\revised\cadd\b3349\_hyd\_drn.dgn  
 jrdunneho

7/2/99

REVISIONS

PROJECT REFERENCE NO. B-3349		SHEET NO. 4	
RW SHEET NO.			
ROADWAY DESIGN ENGINEER		HYDRAULICS ENGINEER	
		2-23-05 RLH	
-L-			

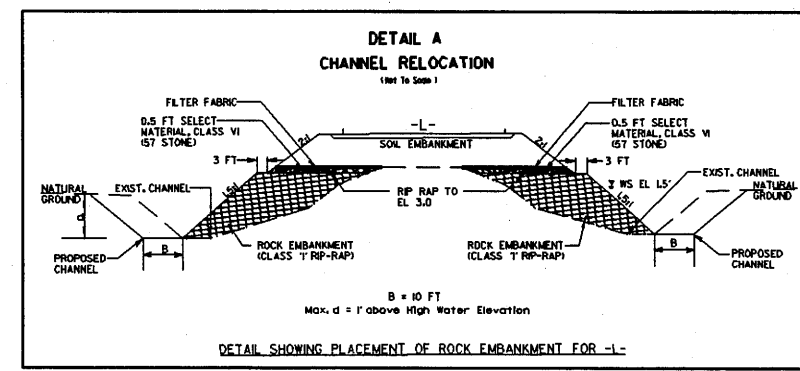

STA 14+50 -L- TO STA 15+30 -L- RT  
STA 14+50 -L- TO STA 15+30 -L- LT

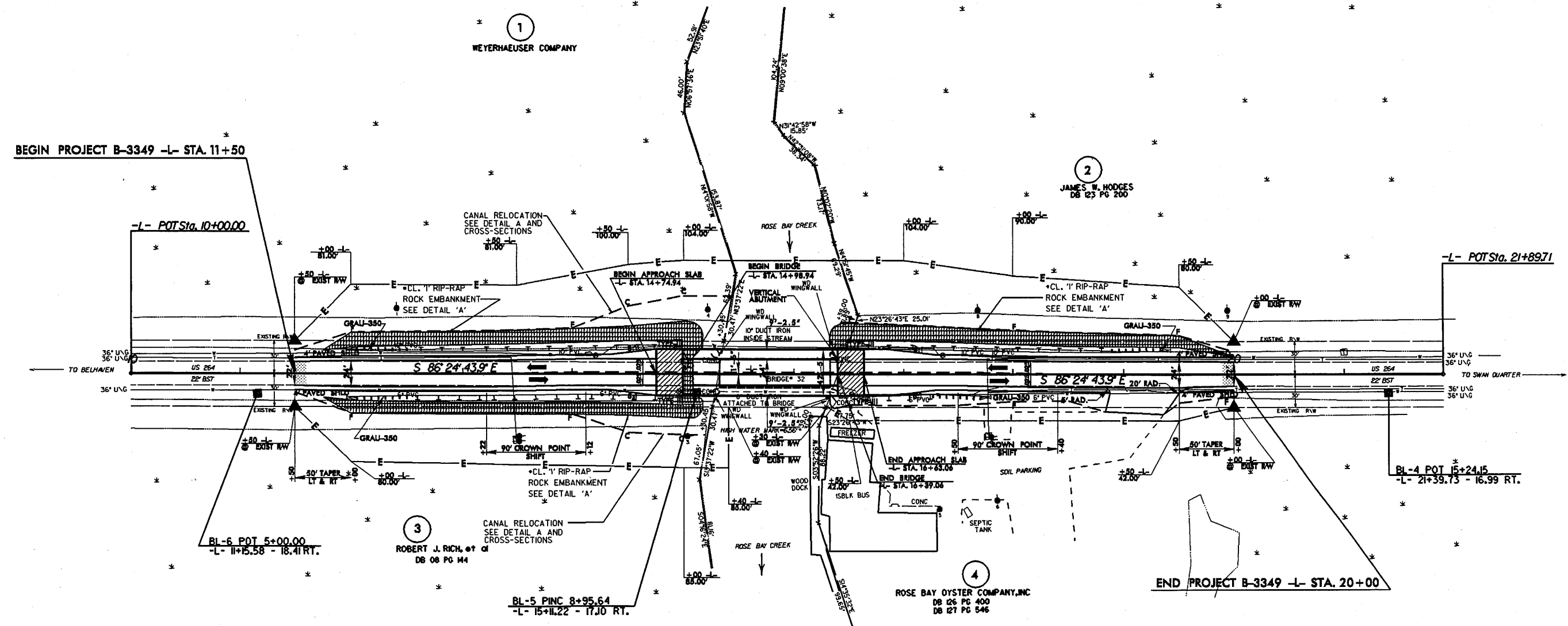

**DATUM DESCRIPTION**

THE LOCALIZED COORDINATE SYSTEM DEVELOPED FOR THIS PROJECT IS BASED ON THE STATE PLANE COORDINATES ESTABLISHED BY MOGS FOR MONUMENT "DRILL"

WITH NAD 83 STATE PLANE GRID COORDINATES OF NORTHING: 63323267811 EASTING: 271515137411

THE AVERAGE COMBINED GRID FACTOR USED ON THIS PROJECT (GROUND TO GRID) IS: 0.9998791

THE N.C. LAMBERT GRID BEARING AND LOCALIZED HORIZONTAL GROUND DISTANCE FROM "DRILL" TO -L- POT STATION 11+50 IS

$N 86^{\circ} 29' 52.92'' W 3131.11$  FT

ALL LINEAR DIMENSIONS ARE LOCALIZED HORIZONTAL DISTANCES

VERTICAL DATUM USED IS MVD 29

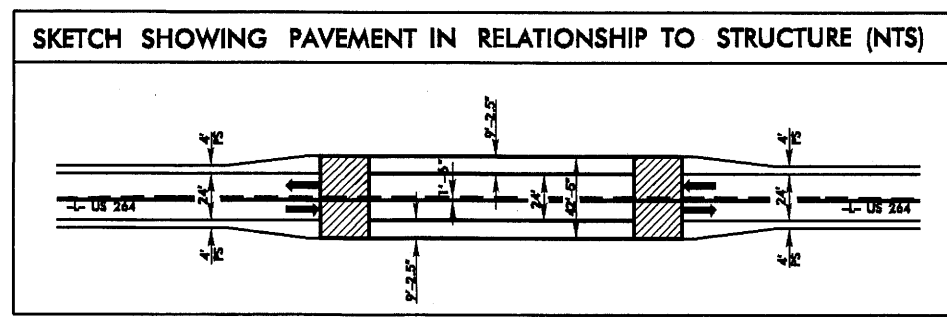

DESIGN EXCEPTION REQUIRED FOR -L- LINE SHOULDER WIDTHS.

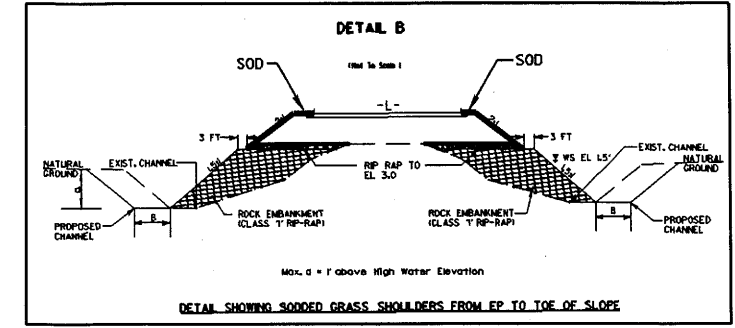

STA 11+50 -L- TO STA 20+00 -L- RT & LT

NOTE: SEE SHEET 5 FOR -L- PROFILE  
SEE SHEETS S-1 THRU S-44 FOR STRUCTURE PLANS  
SEE SHEET 4A FOR DETOUR ALIGNMENT

23-FEB-2005 10:43  
R:\proj\15334\94.4.rsh  
DWG:dner

7/2/99

REVISIONS

PROJECT REFERENCE NO. B-3349	SHEET NO. 4A
RAW SHEET NO.	
ROADWAY DESIGN ENGINEER	HYDRAULICS ENGINEER
	2-23-05 RCH
<b>-DETOUR-</b> Vdet = 35 MPH	

-DETOUR-			
PI Sta 10+35.38 Δ = 8' 42" 11.2' (LT) D = 12' 19" 18.0" L = 70.63' T = 35.38' R = 465.00' SE = SEE PLANS	PI Sta 11+06.02 Δ = 8' 42" 11.2' (RT) D = 12' 19" 18.0" L = 70.63' T = 35.38' R = 465.00' SE = SEE PLANS	PI Sta 13+53.73 Δ = 8' 42" 11.2' (RT) D = 12' 19" 18.0" L = 70.63' T = 35.38' R = 465.00' SE = SEE PLANS	PI Sta 14+24.36 Δ = 8' 42" 11.2' (LT) D = 12' 19" 18.0" L = 70.63' T = 35.38' R = 465.00' SE = SEE PLANS

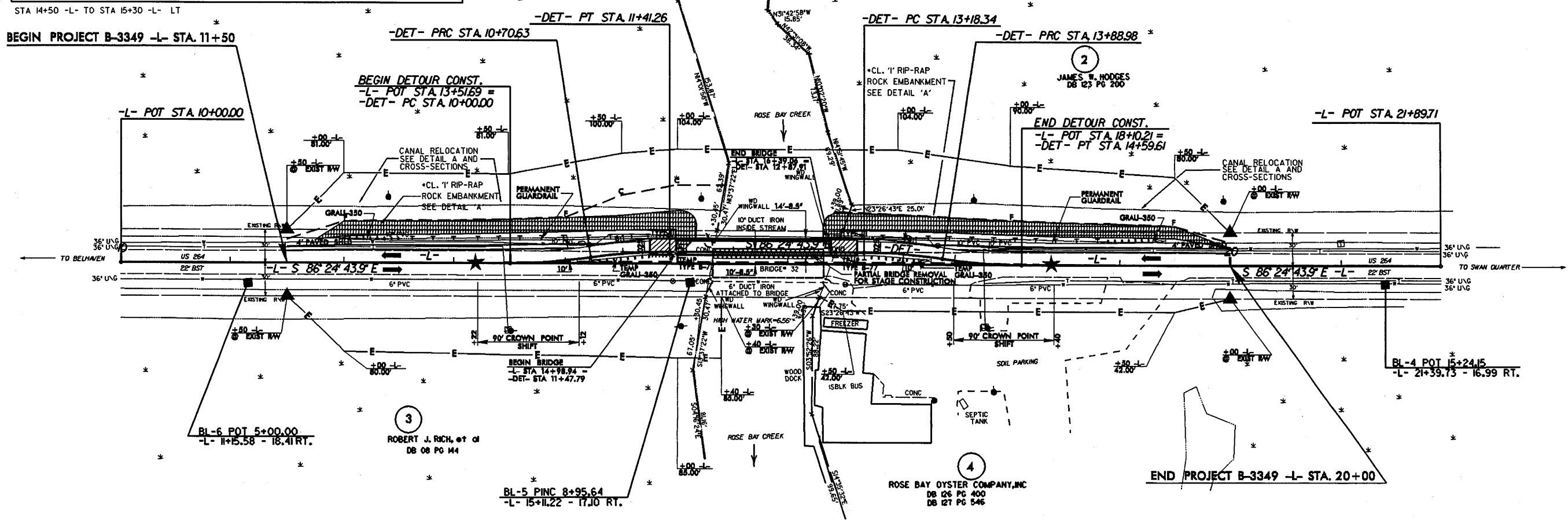
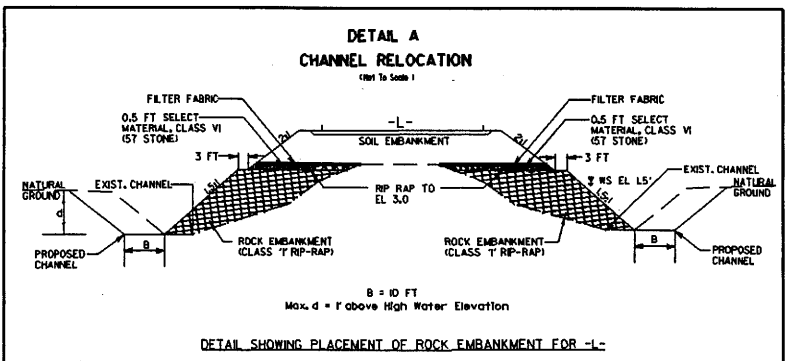

NOTE: THE DETOUR ALIGNMENT WILL USE THE PROJECTION OF THE -L- GRADE AT THE .025 SUPER RATE FOR THE DETOUR GRADE.

DESIGN EXCEPTION REQUIRED FOR -L- LINE SHOULDER WIDTH.

★ DENOTES SIGNAL REQUIRED FOR ONE LANE TWO-WAY DETOUR OPERATION SEE SHEETS TCP-1 THRU TCP-10 FOR DETOUR OPERATION SEE SHEETS S-1 THRU S-44 FOR STRUCTURE PLANS

23-FEB-2005 09:43  
R:\proj\B3349\dwg\DWG.dwg  
DWG Gardner AT 1/20/2005