



STATE OF NORTH CAROLINA  
DEPARTMENT OF TRANSPORTATION

PAT L. MCCRORY  
GOVERNOR

ANTHONY J. TATA  
SECRETARY

June 6, 2013

U. S. Army Corps of Engineers  
Regulatory Field Office  
151 Patton Avenue, Room 208  
Asheville, NC 28801-5006

ATTN: Ms. Loretta Beckwith  
NCDOT Coordinator

Subject: **Application for Section 404 Nationwide Permit 23 & 33 and Section 401 Water Quality Certification** for the proposed replacement of Bridge No. 42 over Saconon Creek on SR 1734 (Stepp Mill Road) in Henderson County, Federal Aid Project No. BRZ-1734(3); Division 14; TIP No. B-3346  
\$570.00 debit WBS No. 33004.1.1

Dear Madam:

The North Carolina Department of Transportation (NCDOT) proposes to replace Bridge No. 42 over Saconon Creek on SR 1734 with a 45-foot long, single-span bridge. There will be 147 linear feet of permanent impacts and <0.01 acre (52 linear feet) of temporary impacts to Saconon Creek for filling and relocation associated with the bridge replacement.

Please see enclosed copies of the Pre-Construction Notification (PCN), EEP acceptance letter, Stormwater Management Plan, permit drawings, and design plans. A Categorical Exclusion (CE) was completed in January 2013 and distributed shortly thereafter. Additional copies are available upon request.

Comments from the North Carolina Wildlife Resources Commission (NCWRC) will be required prior to authorization by the Corps of Engineers. By copy of this letter and attachments, NCDOT hereby requests NCWRC review. NCDOT requests that NCWRC forward their comments to the Corps of Engineers and the NCDOT within 30 calendar days of receipt of this application.

This project calls for a letting date of February 18, 2014 and a review date of December 31, 2013; however, the let date may advance as additional funding becomes available.

**MAILING ADDRESS:**  
NC DEPARTMENT OF TRANSPORTATION  
PROJECT DEVELOPMENT & ENVIRONMENTAL ANALYSIS UNIT  
1598 MAIL SERVICE CENTER  
RALEIGH NC 27699-1548

TELEPHONE: 919-707-6000  
FAX: 919-212-5785  
WEBSITE: NCDOT.GOV

**LOCATION:**  
CENTURY CENTER, BUILDING B  
1020 BIRCH RIDGE DRIVE  
RALEIGH NC 27610

A copy of this permit application and its distribution list will be posted on the NCDOT Website at: <http://www.ncdot.org/doh/preconstruct/pe/neu/permit.html>. If you have any questions or need additional information, please call Bill Barrett at (919) 707-6103.

Sincerely,

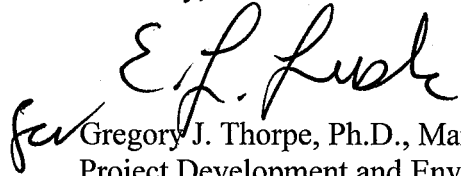
A handwritten signature in black ink, appearing to read "Gregory J. Thorpe". The signature is written in a cursive style with a large initial "G".

Gregory J. Thorpe, Ph.D., Manager  
Project Development and Environmental Analysis Unit

cc:

NCDOT Permit Application Standard Distribution List



Office Use Only:  
Corps action ID no. \_\_\_\_\_  
DWQ project no. \_\_\_\_\_  
Form Version 1.3 Dec 10 2008

## Pre-Construction Notification (PCN) Form

### A. Applicant Information

#### 1. Processing

1a. Type(s) of approval sought from the Corps:	<input checked="" type="checkbox"/> Section 404 Permit	<input type="checkbox"/> Section 10 Permit
1b. Specify Nationwide Permit (NWP) number: 23 33 or General Permit (GP) number:		
1c. Has the NWP or GP number been verified by the Corps?	<input type="checkbox"/> Yes	<input checked="" type="checkbox"/> No
1d. Type(s) of approval sought from the DWQ (check all that apply):		
<input checked="" type="checkbox"/> 401 Water Quality Certification – Regular		
<input type="checkbox"/> Non-404 Jurisdictional General Permit		
<input type="checkbox"/> 401 Water Quality Certification – Express		
<input type="checkbox"/> Riparian Buffer Authorization		
1e. Is this notification solely for the record because written approval is not required?	For the record only for DWQ 401 Certification: <input type="checkbox"/> Yes <input checked="" type="checkbox"/> No	For the record only for Corps Permit: <input type="checkbox"/> Yes <input checked="" type="checkbox"/> No
1f. Is payment into a mitigation bank or in-lieu fee program proposed for mitigation of impacts? If so, attach the acceptance letter from mitigation bank or in-lieu fee program.	<input checked="" type="checkbox"/> Yes	<input type="checkbox"/> No
1g. Is the project located in any of NC's twenty coastal counties. If yes, answer 1h below.	<input type="checkbox"/> Yes	<input checked="" type="checkbox"/> No
1h. Is the project located within a NC DCM Area of Environmental Concern (AEC)?	<input type="checkbox"/> Yes	<input checked="" type="checkbox"/> No

#### 2. Project Information

2a. Name of project:	Replacement of Bridge No. 42 over Saconon Creek on SR 1734 (Stepp Mill Rd.)
2b. County:	Henderson
2c. Nearest municipality / town:	Blue Ridge
2d. Subdivision name:	<i>not applicable</i>
2e. NCDOT only, T.I.P. or state project no:	B-3346

#### 3. Owner Information

3a. Name(s) on Recorded Deed:	North Carolina Department of Transportation
3b. Deed Book and Page No.	<i>not applicable</i>
3c. Responsible Party (for LLC if applicable):	<i>not applicable</i>
3d. Street address:	1598 Mail Service Center
3e. City, state, zip:	Raleigh, NC 27699-1598
3f. Telephone no.:	(919) 707-6103
3g. Fax no.:	(919) 212-5785
3h. Email address:	wabarrett@ncdot.gov

<b>4. Applicant Information (if different from owner)</b>	
4a. Applicant is:	<input type="checkbox"/> Agent <input type="checkbox"/> Other, specify:
4b. Name:	<i>not applicable</i>
4c. Business name (if applicable):	
4d. Street address:	
4e. City, state, zip:	
4f. Telephone no.:	
4g. Fax no.:	
4h. Email address:	
<b>5. Agent/Consultant Information (if applicable)</b>	
5a. Name:	<i>not applicable</i>
5b. Business name (if applicable):	
5c. Street address:	
5d. City, state, zip:	
5e. Telephone no.:	
5f. Fax no.:	
5g. Email address:	

<b>B. Project Information and Prior Project History</b>	
<b>1. Property Identification</b>	
1a. Property identification no. (tax PIN or parcel ID):	<i>not applicable</i>
1b. Site coordinates (in decimal degrees):	Latitude: 35.3406 (DD.DDDDDD) Longitude: - 82.3501 (-DD.DDDDDD)
1c. Property size:	0.21 acre
<b>2. Surface Waters</b>	
2a. Name of nearest body of water (stream, river, etc.) to proposed project:	Saconon Creek (aka: North Branch Hungry Creek)
2b. Water Quality Classification of nearest receiving water:	C;Tr
2c. River basin:	Broad
<b>3. Project Description</b>	
3a. Describe the existing conditions on the site and the general land use in the vicinity of the project at the time of this application:  The area is rural in nature with forested lands and scattered residential homes. Portions of the project are occurring within the Stepp's Mill property, a property determined eligible for listing in the Natinal Register of Historic Places. A Memorandum of Agreement (MOA) has been executed.	
3b. List the total estimated acreage of all existing wetlands on the property:  0	
3c. List the total estimated linear feet of all existing streams (intermittent and perennial) on the property:  250	
3d. Explain the purpose of the proposed project:  To replace a structurally deficient (sufficiency rating of 47.6 out of a possible 100) and functionally obsolete (deck geometry of 2 out of 9) bridge.	
3e. Describe the overall project in detail, including the type of equipment to be used:  The project involves replacing a 36-foot bridge with a 45-foot, single-span bridge with an off-site detour. The bridge is being constructed upgradient of the existing structure, as the existing bridge is connected by its abutments to the existing dam on Saconon Creek. The roadway grade of the new structure will be approximately the same as the existing grade. Standard road building equipment, such as trucks, dozers, and cranes will be used.	
<b>4. Jurisdictional Determinations</b>	
4a. Have jurisdictional wetland or stream determinations by the Corps or State been requested or obtained for this property / project (including all prior phases) in the past?  Comments:	<input type="checkbox"/> Yes <input checked="" type="checkbox"/> No <input type="checkbox"/> Unknown
4b. If the Corps made the jurisdictional determination, what type of determination was made?	<input type="checkbox"/> Preliminary <input type="checkbox"/> Final
4c. If yes, who delineated the jurisdictional areas? Name (if known):	Agency/Consultant Company: Other:
4d. If yes, list the dates of the Corps jurisdictional determinations or State determinations and attach documentation.	
<b>5. Project History</b>	
5a. Have permits or certifications been requested or obtained for this project (including all prior phases) in the past?	<input type="checkbox"/> Yes <input checked="" type="checkbox"/> No <input type="checkbox"/> Unknown
5b. If yes, explain in detail according to "help file" instructions.	

**6. Future Project Plans**

6a. Is this a phased project?

Yes

No

6b. If yes, explain.

<b>C. Proposed Impacts Inventory</b>						
<b>1. Impacts Summary</b>						
1a. Which sections were completed below for your project (check all that apply):						
<input type="checkbox"/> Wetlands <input checked="" type="checkbox"/> Streams - tributaries <input type="checkbox"/> Buffers <input type="checkbox"/> Open Waters <input type="checkbox"/> Pond Construction						
<b>2. Wetland Impacts</b>						
If there are wetland impacts proposed on the site, then complete this question for each wetland area impacted.						
2a. Wetland impact number – Permanent (P) or Temporary (T)	2b. Type of impact	2c. Type of wetland (if known)	2d. Forested	2e. Type of jurisdiction (Corps - 404, 10 DWQ – non-404, other)	2f. Area of impact (acres)	
Site 1 <input type="checkbox"/> P <input type="checkbox"/> T			<input type="checkbox"/> Yes <input type="checkbox"/> No	<input type="checkbox"/> Corps <input type="checkbox"/> DWQ		
Site 2 <input type="checkbox"/> P <input type="checkbox"/> T			<input type="checkbox"/> Yes <input type="checkbox"/> No	<input type="checkbox"/> Corps <input type="checkbox"/> DWQ		
Site 3 <input type="checkbox"/> P <input type="checkbox"/> T			<input type="checkbox"/> Yes <input type="checkbox"/> No	<input type="checkbox"/> Corps <input type="checkbox"/> DWQ		
Site 4 <input type="checkbox"/> P <input type="checkbox"/> T			<input type="checkbox"/> Yes <input type="checkbox"/> No	<input type="checkbox"/> Corps <input type="checkbox"/> DWQ		
Site 5 <input type="checkbox"/> P <input type="checkbox"/> T			<input type="checkbox"/> Yes <input type="checkbox"/> No	<input type="checkbox"/> Corps <input type="checkbox"/> DWQ		
Site 6 <input type="checkbox"/> P <input type="checkbox"/> T			<input type="checkbox"/> Yes <input type="checkbox"/> No	<input type="checkbox"/> Corps <input type="checkbox"/> DWQ		
<b>2g. Total wetland impacts</b>					X Permanent X Temporary	
2h. Comments:						
<b>3. Stream Impacts</b>						
If there are perennial or intermittent stream impacts (including temporary impacts) proposed on the site, then complete this question for all stream sites impacted.						
3a. Stream impact number - Permanent (P) or Temporary (T)	3b. Type of impact	3c. Stream name	3d. Perennial (PER) or intermittent (INT)?	3e. Type of jurisdiction (Corps - 404, 10 DWQ – non-404, other)	3f. Average stream width (feet)	3g. Impact length (linear feet)
Site 1 <input checked="" type="checkbox"/> P <input type="checkbox"/> T	bridge replacement	Saconon	<input checked="" type="checkbox"/> PER <input type="checkbox"/> INT	<input checked="" type="checkbox"/> Corps <input type="checkbox"/> DWQ	15	147
Site 2 <input type="checkbox"/> P <input checked="" type="checkbox"/> T	bridge replacement	Saconon	<input checked="" type="checkbox"/> PER <input type="checkbox"/> INT	<input checked="" type="checkbox"/> Corps <input type="checkbox"/> DWQ	5	52 (<0.01 ac)
Site 3 <input type="checkbox"/> P <input type="checkbox"/> T			<input type="checkbox"/> PER <input type="checkbox"/> INT	<input type="checkbox"/> Corps <input type="checkbox"/> DWQ		
Site 4 <input type="checkbox"/> P <input type="checkbox"/> T			<input type="checkbox"/> PER <input type="checkbox"/> INT	<input type="checkbox"/> Corps <input type="checkbox"/> DWQ		
Site 5 <input type="checkbox"/> P <input type="checkbox"/> T			<input type="checkbox"/> PER <input type="checkbox"/> INT	<input type="checkbox"/> Corps <input type="checkbox"/> DWQ		
Site 6 <input type="checkbox"/> P <input type="checkbox"/> T			<input type="checkbox"/> PER <input type="checkbox"/> INT	<input type="checkbox"/> Corps <input type="checkbox"/> DWQ		
<b>3h. Total stream and tributary impacts</b>					147 Perm 52 Temp (<0.01ac)	
3i. Comments:						

**4. Open Water Impacts**

If there are proposed impacts to lakes, ponds, estuaries, tributaries, sounds, the Atlantic Ocean, or any other open water of the U.S. then individually list all open water impacts below.

4a. Open water impact number – Permanent (P) or Temporary (T)	4b. Name of waterbody (if applicable)	4c. Type of impact	4d. Waterbody type	4e. Area of impact (acres)
O1 <input type="checkbox"/> P <input type="checkbox"/> T				
O2 <input type="checkbox"/> P <input type="checkbox"/> T				
O3 <input type="checkbox"/> P <input type="checkbox"/> T				
O4 <input type="checkbox"/> P <input type="checkbox"/> T				
<b>4f. Total open water impacts</b>				X Permanent X Temporary

4g. Comments:

**5. Pond or Lake Construction**

If pond or lake construction proposed, then complete the chart below.

5a. Pond ID number	5b. Proposed use or purpose of pond	5c. Wetland Impacts (acres)			5d. Stream Impacts (feet)			5e. Upland (acres)
		Flooded	Filled	Excavated	Flooded	Filled	Excavated	Flooded
P1								
P2								
<b>5f. Total</b>								

5g. Comments:

5h. Is a dam high hazard permit required?	<input type="checkbox"/> Yes	<input type="checkbox"/> No	If yes, permit ID no:
5i. Expected pond surface area (acres):			
5j. Size of pond watershed (acres):			
5k. Method of construction:			



**6. Buffer Impacts (for DWQ)**

If project will impact a protected riparian buffer, then complete the chart below. If yes, then individually list all buffer impacts below. If any impacts require mitigation, then you **MUST** fill out Section D of this form.

6a. Project is in which protected basin?		<input type="checkbox"/> Neuse <input type="checkbox"/> Catawba		<input type="checkbox"/> Tar-Pamlico <input type="checkbox"/> Randleman	<input type="checkbox"/> Other:
6b. Buffer impact number – Permanent (P) or Temporary (T)	6c. Reason for impact	6d. Stream name	6e. Buffer mitigation required?	6f. Zone 1 impact (square feet)	6g. Zone 2 impact (square feet)
B1 <input type="checkbox"/> P <input type="checkbox"/> T			<input type="checkbox"/> Yes <input type="checkbox"/> No		
B2 <input type="checkbox"/> P <input type="checkbox"/> T			<input type="checkbox"/> Yes <input type="checkbox"/> No		
B3 <input type="checkbox"/> P <input type="checkbox"/> T			<input type="checkbox"/> Yes <input type="checkbox"/> No		
<b>6h. Total buffer impacts</b>					
6i. Comments:					

**D. Impact Justification and Mitigation**

**1. Avoidance and Minimization**

1a. Specifically describe measures taken to avoid or minimize the proposed impacts in designing project.  
The proposed bridge is 9 feet longer than the existing bridge; the proposed bridge will be at approximately the same grade as the existing structure; an off site detour will be used, 3:1 fill slopes where practicable.

1b. Specifically describe measures taken to avoid or minimize the proposed impacts through construction techniques.  
*Design Standards in Sensitive Watersheds* will be implemented during construction. NCDOT will follow the Trout Stream moratorium from January 1 to April 15. BMPs for Bridge Removal will be implemented.

**2. Compensatory Mitigation for Impacts to Waters of the U.S. or Waters of the State**

2a. Does the project require Compensatory Mitigation for impacts to Waters of the U.S. or Waters of the State?  Yes  No  
If no, explain:

2b. If yes, mitigation is required by (check all that apply):  DWQ  Corps

2c. If yes, which mitigation option will be used for this project?  Mitigation bank  Payment to in-lieu fee program  Permittee Responsible Mitigation

**3. Complete if Using a Mitigation Bank**

3a. Name of Mitigation Bank: not applicable

3b. Credits Purchased (attach receipt and letter)	Type	Quantity
---	------	----------

3c. Comments:

**4. Complete if Making a Payment to In-lieu Fee Program**

4a. Approval letter from in-lieu fee program is attached.  Yes

4b. Stream mitigation requested: 147 linear feet

4c. If using stream mitigation, stream temperature:  warm  cool  cold

4d. Buffer mitigation requested (DWQ only): square feet

4e. Riparian wetland mitigation requested: acres

4f. Non-riparian wetland mitigation requested: acres

4g. Coastal (tidal) wetland mitigation requested: acres

4h. Comments: There will be 147 LF of permanent stream impact at the site, of which NCDOT will be re-channeling 111 LF, resulting in 36 LF of total stream loss. Pursuant to conversation with Lori Beckwith/USACE on 6-3-13, a mitigation ratio of 2:1 is required for the 36 linear feet of total stream loss, and a mitigation ratio of 1.5:1 will be required for the 111 LF of stream that will be re-channelized.

**5. Complete if Using a Permittee Responsible Mitigation Plan**

5a. If using a permittee responsible mitigation plan, provide a description of the proposed mitigation plan.

**6. Buffer Mitigation (State Regulated Riparian Buffer Rules) – required by DWQ**

6a. Will the project result in an impact within a protected riparian buffer that requires buffer mitigation?  Yes  No

6b. If yes, then identify the square feet of impact to each zone of the riparian buffer that requires mitigation. Calculate the amount of mitigation required.

Zone	6c. Reason for impact	6d. Total impact (square feet)	Multiplier	6e. Required mitigation (square feet)
Zone 1			3 (2 for Catawba)	
Zone 2			1.5	
<b>6f. Total buffer mitigation required:</b>				

6g. If buffer mitigation is required, discuss what type of mitigation is proposed (e.g., payment to private mitigation bank, permittee responsible riparian buffer restoration, payment into an approved in-lieu fee fund).

6h. Comments:

<b>E. Stormwater Management and Diffuse Flow Plan (required by DWQ)</b>	
<b>1. Diffuse Flow Plan</b>	
1a. Does the project include or is it adjacent to protected riparian buffers identified within one of the NC Riparian Buffer Protection Rules?	<input type="checkbox"/> Yes <input checked="" type="checkbox"/> No
1b. If yes, then is a diffuse flow plan included? If not, explain why. Comments: If required from 1a, see attached buffer permit drawings.	<input type="checkbox"/> Yes <input type="checkbox"/> No
<b>2. Stormwater Management Plan</b>	
2a. What is the overall percent imperviousness of this project?	N/A
2b. Does this project require a Stormwater Management Plan?	<input checked="" type="checkbox"/> Yes <input type="checkbox"/> No
2c. If this project DOES NOT require a Stormwater Management Plan, explain why:	
2d. If this project DOES require a Stormwater Management Plan, then provide a brief, narrative description of the plan: See attached permit drawings.	
2e. Who will be responsible for the review of the Stormwater Management Plan?	<input type="checkbox"/> Certified Local Government <input type="checkbox"/> DWQ Stormwater Program <input checked="" type="checkbox"/> DWQ 401 Unit
<b>3. Certified Local Government Stormwater Review</b>	
3a. In which local government's jurisdiction is this project?	not applicable
3b. Which of the following locally-implemented stormwater management programs apply (check all that apply):	<input type="checkbox"/> Phase II <input type="checkbox"/> NSW <input type="checkbox"/> USMP <input type="checkbox"/> Water Supply Watershed <input type="checkbox"/> Other:
3c. Has the approved Stormwater Management Plan with proof of approval been attached?	<input type="checkbox"/> Yes <input type="checkbox"/> No
<b>4. DWQ Stormwater Program Review</b>	
4a. Which of the following state-implemented stormwater management programs apply (check all that apply):	<input type="checkbox"/> Coastal counties <input type="checkbox"/> HQW <input type="checkbox"/> ORW <input type="checkbox"/> Session Law 2006-246 <input type="checkbox"/> Other:
4b. Has the approved Stormwater Management Plan with proof of approval been attached?	<input type="checkbox"/> Yes <input type="checkbox"/> No
<b>5. DWQ 401 Unit Stormwater Review</b>	
5a. Does the Stormwater Management Plan meet the appropriate requirements?	<input type="checkbox"/> Yes <input type="checkbox"/> No N/A
5b. Have all of the 401 Unit submittal requirements been met?	<input type="checkbox"/> Yes <input type="checkbox"/> No N/A

<b>F. Supplementary Information</b>	
<b>1. Environmental Documentation (DWQ Requirement)</b>	
1a. Does the project involve an expenditure of public (federal/state/local) funds or the use of public (federal/state) land?	<input checked="" type="checkbox"/> Yes <input type="checkbox"/> No
1b. If you answered "yes" to the above, does the project require preparation of an environmental document pursuant to the requirements of the National or State (North Carolina) Environmental Policy Act (NEPA/SEPA)?	<input checked="" type="checkbox"/> Yes <input type="checkbox"/> No
1c. If you answered "yes" to the above, has the document review been finalized by the State Clearing House? (If so, attach a copy of the NEPA or SEPA final approval letter.)  Comments:	<input checked="" type="checkbox"/> Yes <input type="checkbox"/> No
<b>2. Violations (DWQ Requirement)</b>	
2a. Is the site in violation of DWQ Wetland Rules (15A NCAC 2H .0500), Isolated Wetland Rules (15A NCAC 2H .1300), DWQ Surface Water or Wetland Standards, or Riparian Buffer Rules (15A NCAC 2B .0200)?	<input type="checkbox"/> Yes <input checked="" type="checkbox"/> No
2b. Is this an after-the-fact permit application?	<input type="checkbox"/> Yes <input checked="" type="checkbox"/> No
2c. If you answered "yes" to one or both of the above questions, provide an explanation of the violation(s):	
<b>3. Cumulative Impacts (DWQ Requirement)</b>	
3a. Will this project (based on past and reasonably anticipated future impacts) result in additional development, which could impact nearby downstream water quality?	<input type="checkbox"/> Yes <input checked="" type="checkbox"/> No
3b. If you answered "yes" to the above, submit a qualitative or quantitative cumulative impact analysis in accordance with the most recent DWQ policy. If you answered "no," provide a short narrative description.  Due to the minimal transportation impact resulting from this bridge replacement, this project will neither influence nearby land uses nor stimulate growth. Therefore, a detailed indirect or cumulative effects study will not be necessary.	
<b>4. Sewage Disposal (DWQ Requirement)</b>	
4a. Clearly detail the ultimate treatment methods and disposition (non-discharge or discharge) of wastewater generated from the proposed project, or available capacity of the subject facility.  not applicable	

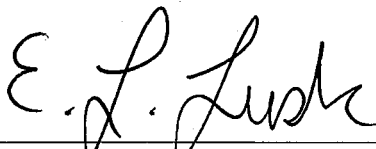
<b>5. Endangered Species and Designated Critical Habitat (Corps Requirement)</b>		
5a. Will this project occur in or near an area with federally protected species or habitat?	<input checked="" type="checkbox"/> Yes	<input type="checkbox"/> No
5b. Have you checked with the USFWS concerning Endangered Species Act impacts?	<input type="checkbox"/> Yes	<input checked="" type="checkbox"/> No
5c. If yes, indicate the USFWS Field Office you have contacted.	<input type="checkbox"/> Raleigh <input type="checkbox"/> Asheville	
5d. What data sources did you use to determine whether your site would impact Endangered Species or Designated Critical Habitat?  NHP, USFWS, and NCDOT field surveys. The only species with habitat at the site, small whorled pogonia, was last surveyed for on May 25, 2011. The survey did not identify any individuals of this species, resulting in a biological conclusion of No Effect.		
<b>6. Essential Fish Habitat (Corps Requirement)</b>		
6a. Will this project occur in or near an area designated as essential fish habitat?	<input type="checkbox"/> Yes	<input checked="" type="checkbox"/> No
6b. What data sources did you use to determine whether your site would impact Essential Fish Habitat? NMFS County Index		
<b>7. Historic or Prehistoric Cultural Resources (Corps Requirement)</b>		
7a. Will this project occur in or near an area that the state, federal or tribal governments have designated as having historic or cultural preservation status (e.g., National Historic Trust designation or properties significant in North Carolina history and archaeology)?	<input checked="" type="checkbox"/> Yes	<input type="checkbox"/> No
7b. What data sources did you use to determine whether your site would impact historic or archeological resources? NEPA Documentation		
<b>8. Flood Zone Designation (Corps Requirement)</b>		
8a. Will this project occur in a FEMA-designated 100-year floodplain?	<input type="checkbox"/> Yes	<input checked="" type="checkbox"/> No
8b. If yes, explain how project meets FEMA requirements: NCDOT Hydraulics Unit coordination with FEMA		
8c. What source(s) did you use to make the floodplain determination? FEMA Maps		
Dr. Gregory J. Thorpe, Ph D Applicant/Agent's Printed Name	 Applicant/Agent's Signature (Agent's signature is valid only if an authorization letter from the applicant is provided.)	6-7-13 Date



June 4, 2013

Mr. Gregory J. Thorpe, Ph.D.  
Manager, Project Development and Environmental Analysis Unit  
North Carolina Department of Transportation  
1548 Mail Service Center  
Raleigh, North Carolina 27699-1548

Dear Dr. Thorpe:

Subject: EEP Mitigation Acceptance Letter:

**B-3346, Replace Bridge 42 over Saconon Creek on SR 1734, Henderson County**

The purpose of this letter is to notify you that the Ecosystem Enhancement Program (EEP) will provide the compensatory stream mitigation for the subject project. Based on the information supplied by you on June 3, 2013, the impacts are located in CU 03050105 of the Broad River basin in the Southern Mountains (SM) Eco-Region, and are as follows:

Broad 03050105 CP	Stream			Wetlands			Buffer (Sq. Ft.)	
	Cold	Cool	Warm	Riparian	Non- Riparian	Coastal Marsh	Zone 1	Zone 2
Impacts (feet/acres)	147.0	0	0	0	0	0	0	0

\*Some of the stream and wetland impacts may be proposed to be mitigated at a 1:1 mitigation ratio. See permit application for details.

EEP commits to implementing sufficient compensatory stream mitigation credits to offset the impacts associated with this project as determined by the regulatory agencies in accordance with the N.C. Department of Environment and Natural Resources' Ecosystem Enhancement Program In-Lieu Fee Instrument dated July 28, 2010. If the above referenced impact amounts are revised, then this mitigation acceptance letter will no longer be valid and a new mitigation acceptance letter will be required from EEP.

If you have any questions or need additional information, please contact Ms. Beth Harmon at 919-707-8420.

Sincerely,

James B. Stanfill  
EEP Asset Management Supervisor

cc: Ms. Lori Beckwith, USACE – Asheville Regulatory Field Office  
Ms. Amy Chapman, Division of Water Quality, Wetlands/401 Unit  
File: B-3346

*Restoring... Enhancing... Protecting Our State*





North Carolina Department of Transportation  
 Highway Stormwater Program  
**STORMWATER MANAGEMENT PLAN**  
 FOR LINEAR ROADWAY PROJECTS



(Version 1.2; Released July 2012)

Project/TIP No.: 33004.1.1

County(ies): Henderson

Page 1 of 2

**General Project Information**

Project No.:		33004.1.1		Project Type:		Bridge Replacement		Date:		3/27/2013	
NCDOT Contact:		Randy Henegar, P.E.		Contractor / Designer:							
	Address:	1020 Birchridge Dr. Raleigh, N.C. 27610			Address:						
	Phone:	919-707-6726			Phone:						
	Email:	rhenegar@ncdot.gov			Email:						
City/Town:		Blue Ridge		County(ies):		Henderson					
River Basin(s):		Broad		CAMA County?		No					
Primary Receiving Water:		Saconon Creek		NCDWQ Stream Index No.:		9-29-30-2-1					
NCDWQ Surface Water Classification for Primary Receiving Water		Primary:		Class C							
		Supplemental:		Trout Waters (Tr)							
Other Stream Classification:											
303(d) Impairments:		None									
Buffer Rules in Effect											

**Project Description**

Project Length (lin. Miles or feet):		0.087miles		Surrounding Land Use:		Residential	
		Proposed Project		Existing Site			
Project Built-Up Area (ac.)		0.21 ac.		0.16 ac.			
Typical Cross Section Description:							
Average Daily Traffic (veh/hr/day):		Design/Future: 900		Existing: 580			

**General Project Narrative:** Bridge #42 is a single span structure that consist of a timber floor on I-beams with an asphalt surface. The end bents are reinforced concrete abutments that are an extension of the dam across Saconon Creek. The overall length of the structure is 36 feet with a clear roadway of 13.1 feet. The replacement structure is a bridge approximately 45 feet long with 10-foot lanes with 2.5-foot offsets on each side.

**References**





**Project Environmental Summary**

**Surface Water Impacts**

Sheet No.	Station (From / To)	Feature Impacted	Water / Wetland / Buffer Type	Receiving Surface Water Name	NRTR Map ID	NCDWQ Stream Index	NCDWQ Surface Water Classification	303(d) Impairments	Type of Impact	Existing SCM	Proposed SCM
4	12+00	Stream	Perennial	Saconon	Saconon Creek	9-29-30-2-1	C;Tr	None	Fill	N/A	
	13+00										

\* List all stream and surface water impact locations regardless of jurisdiction or size.  
 Equalizer Pipes to be noted as a minimization of impacts.  
 All proposed SCMs listed must also be listed under Swales, Performed Sour Holes and other Energy Dissipators, or Other Stormwater Control Measures.

**Description of Minimization of Impacts or Mitigation**

**References**

09/08/13

See Sheet 1-A For Index of Sheets  
 See Sheet 1-B For Conventional Symbols  
 See Sheet 1-C For Survey Control Sheet

STATE OF NORTH CAROLINA  
 DIVISION OF HIGHWAYS

STATE	STATE PROJECT REFERENCE NO.	SHEET NO.	TOTAL SHEETS
N.C.	B-3346	1	
STATE PROJ. NO.	F.A. PROJ. NO.	DESCRIPTION	
33004.1.1	BRZ-1734(3)	P.E.	
33004.2.1	BRZ-1734(3)	RW & UTILITIES	

CONTRACT: TIP PROJECT: B-3346

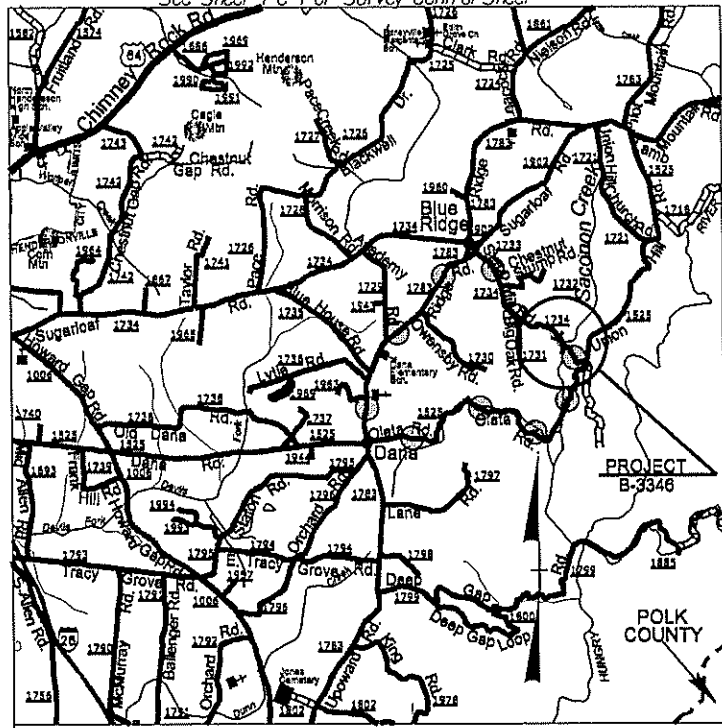

VICINITY MAP

○ ○ ○ ○ ○ DETOUR ROUTE

**HENDERSON COUNTY**

**LOCATION: BRIDGE NO. 42 OVER SACNONON CREEK  
 ON SR 1734 (STEPP MILL ROAD)**

**TYPE OF WORK: GRADING, DRAINAGE, PAVING, STRUCTURE,  
 RETAINING WALL, AND EXISTING STRUCTURE  
 RETROFIT**

Permit Drawings  
 Sheet 1 of 6

STA. 11+05.00 -L- BEGIN TIP PROJECT B-3346

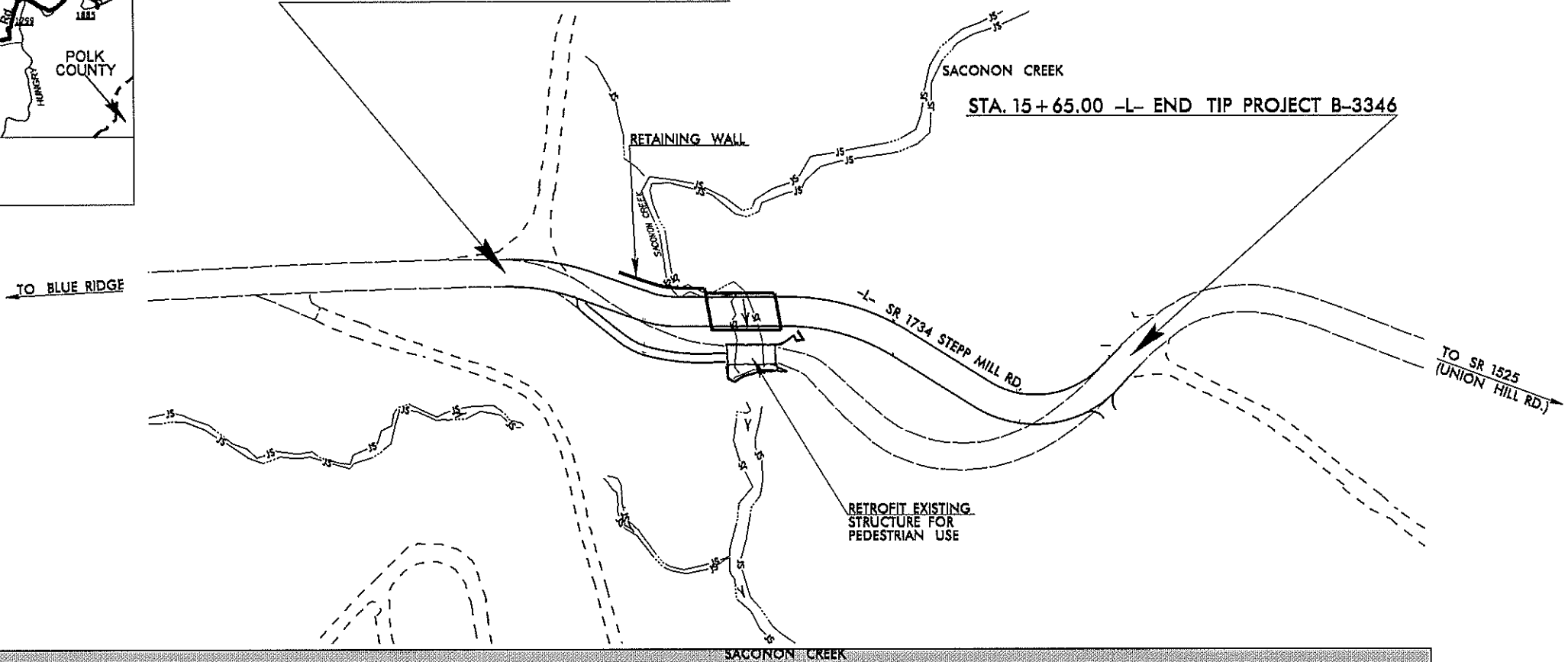

**WETLAND AND SURFACE WATER IMPACTS PERMIT**

THIS PROJECT IS NOT WITHIN ANY MUNICIPAL BOUNDARIES.  
 DESIGN EXCEPTION REQUIRED FOR DESIGN SPEED AND SUPERELEVATION.  
 CLEARING ON THIS PROJECT SHALL BE PERFORMED TO THE LIMITS ESTABLISHED BY METHOD II.

PRELIMINARY PLANS  
 DO NOT USE FOR CONSTRUCTION

CONTRACT:

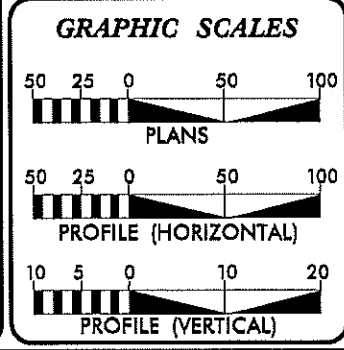

**DESIGN DATA**

ADT 2014 =	580
ADT 2035 =	900
DHV =	12 %
D =	60 %
T =	12 % *
V =	15 MPH
*TTST 1%	DUAL 11%

FUNC CLASS=RURAL LOCAL  
 SUB REGIONAL TIER

**PROJECT LENGTH**

LENGTH ROADWAY TIP PROJECT B-3346 =	0.078 MILES
LENGTH STRUCTURE TIP PROJECT B-3346 =	0.009 MILES
TOTAL LENGTH OF TIP PROJECT B-3346 =	0.087 MILES

Prepared in the Office of:  
**DIVISION OF HIGHWAYS**  
 1000 Birch Ridge Dr., Raleigh NC, 27610

2012 STANDARD SPECIFICATIONS

RIGHT OF WAY DATE: MARCH 1, 2013

LETTING DATE: FEBRUARY 18, 2014

JAMES A. SPEER, PE  
 PROJECT ENGINEER

DANIEL W. GARDNER, JR., PE  
 PROJECT DESIGN ENGINEER

**HYDRAULICS ENGINEER**

SIGNATURE: \_\_\_\_\_ P.E.

**ROADWAY DESIGN ENGINEER**

SIGNATURE: \_\_\_\_\_ P.E.

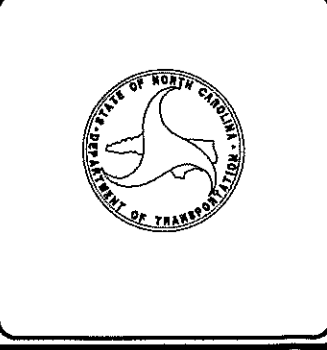

\$\$\$SYTIME\$\$\$\$\$  
 \$\$\$DCN\$\$\$\$\$  
 \$\$\$USERNAME\$\$\$\$\$

PROJECT REFERENCE NO. <b>B-3346</b>	SHEET NO. <b>4</b>
RAY SHEET NO.	
ROADWAY DESIGN ENGINEER	HYDRAULICS ENGINEER
<b>PRELIMINARY PLANS</b> DO NOT USE FOR CONSTRUCTION	

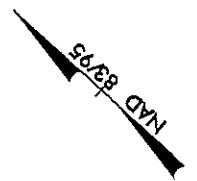
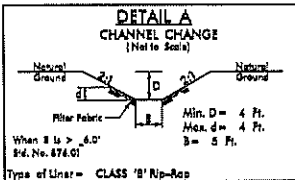

Permit Drawings  
Sheet 2 of 6

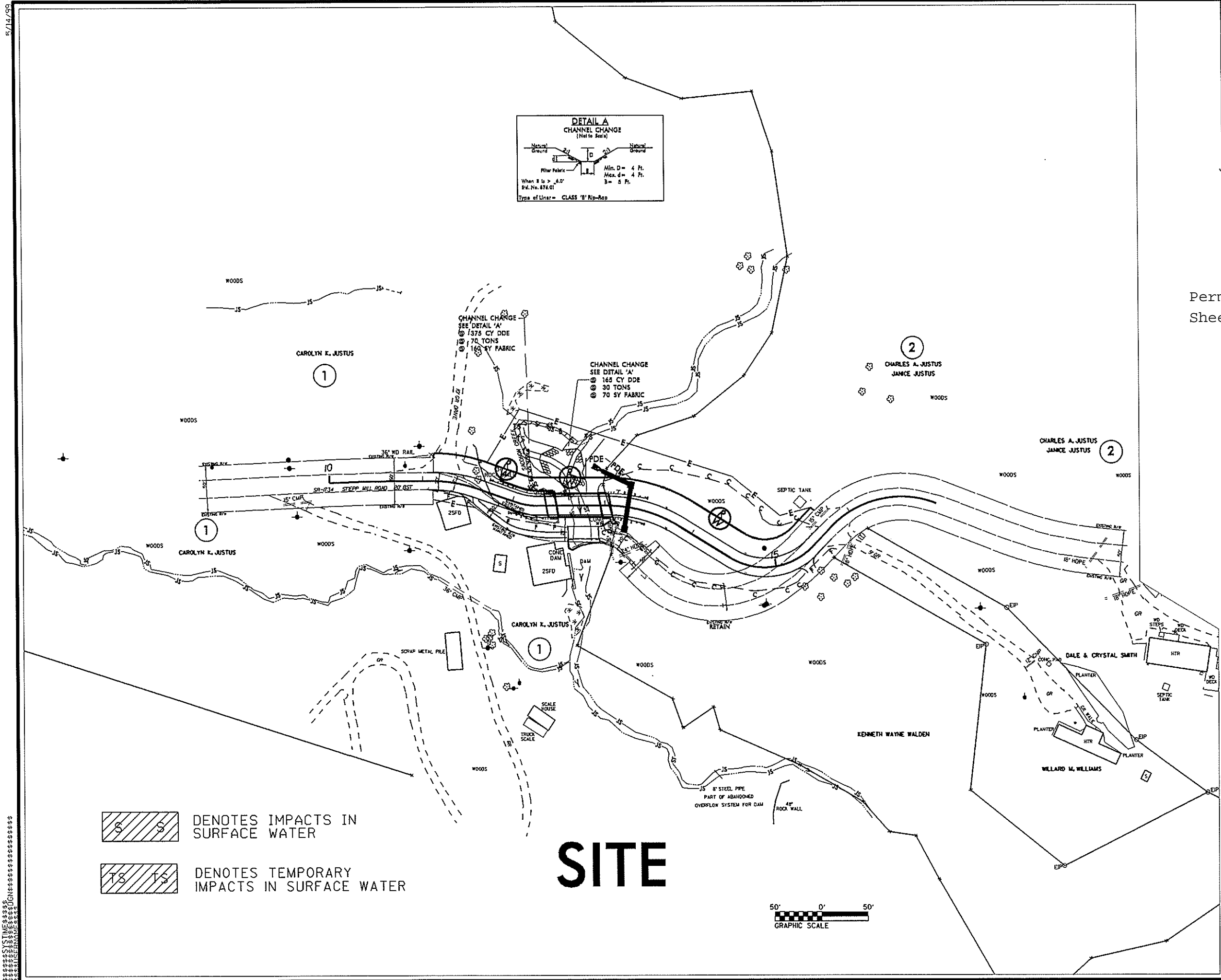

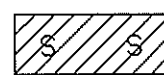
 DENOTES IMPACTS IN SURFACE WATER

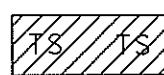
 DENOTES TEMPORARY IMPACTS IN SURFACE WATER

# SITE

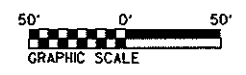

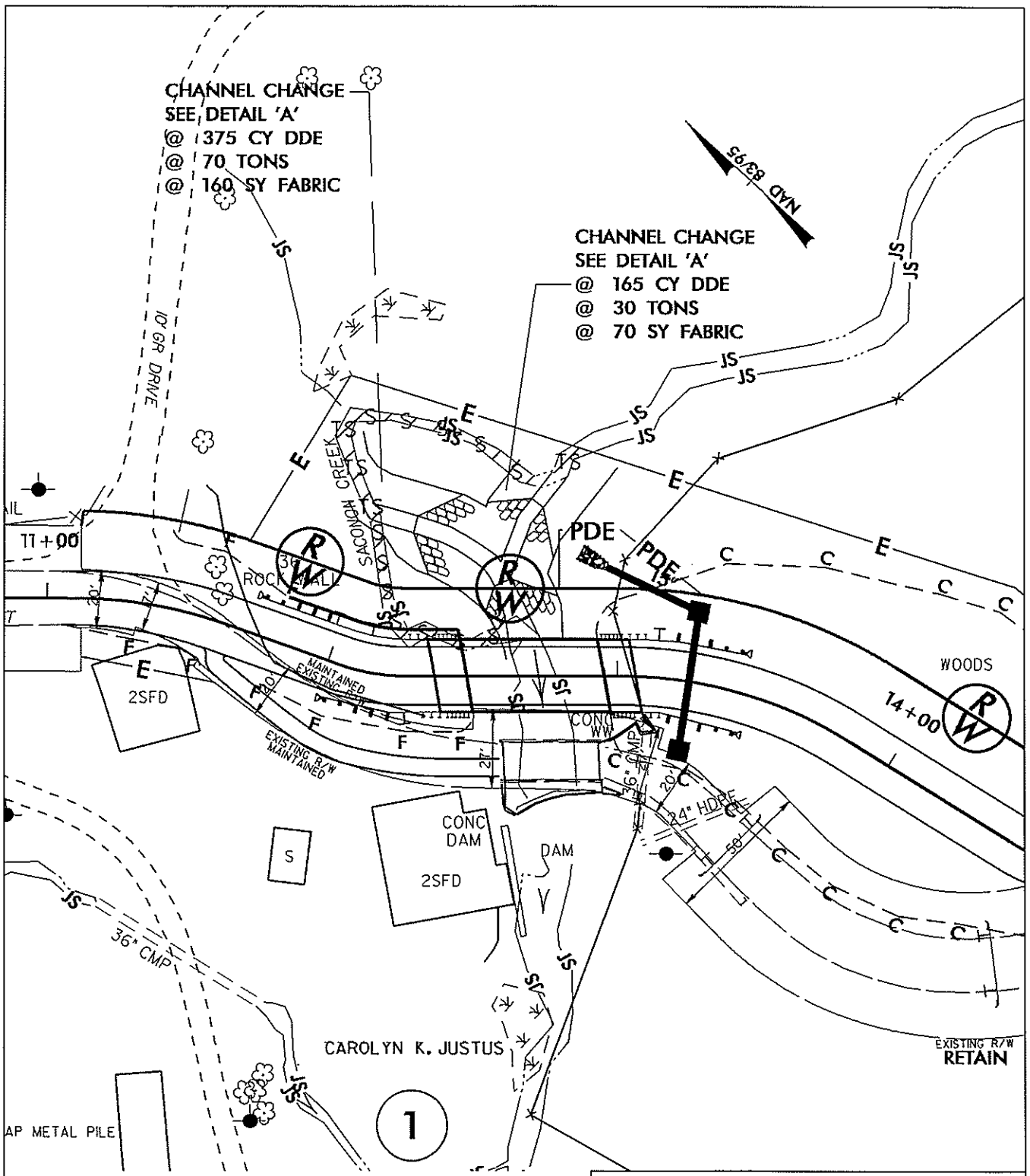

SYSTEMS DESIGN GROUP  
 10000 W. 10TH AVENUE, SUITE 100  
 DENVER, CO 80202  
 TEL: 303.755.1000  
 FAX: 303.755.1001  
 WWW: WWW.SDGROUP.COM



CHANNEL CHANGE  
SEE DETAIL 'A'  
@ 375 CY DDE  
@ 70 TONS  
@ 160 SY FABRIC

CHANNEL CHANGE  
SEE DETAIL 'A'  
@ 165 CY DDE  
@ 30 TONS  
@ 70 SY FABRIC

PLAN VIEW

-  DENOTES IMPACTS IN SURFACE WATER
-  DENOTES TEMPORARY IMPACTS IN SURFACE WATER

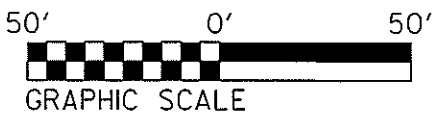

**NCDOT**  
 DIVISION OF HIGHWAYS  
 HENDERSON COUNTY  
 PROJECT: 33004.1.1 (B-3346)

REPLACE BRG#42 OVER SACONON  
 CREEK ON SR 1734 (STEPP MILL RD.)

SHEET 3 OF 6 REV 05/29/13

5/14/99

PROJECT REFERENCE NO. <b>B-3346</b>	SHEET NO. <b>4</b>
RAW SHEET NO.	
ROADWAY DESIGN ENGINEER	HYDRAULICS ENGINEER
<b>PRELIMINARY PLANS</b> DO NOT USE FOR CONSTRUCTION!	

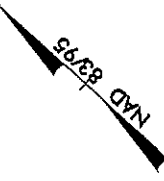

Permit Drawings  
Sheet 4 of 6

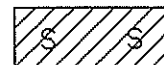
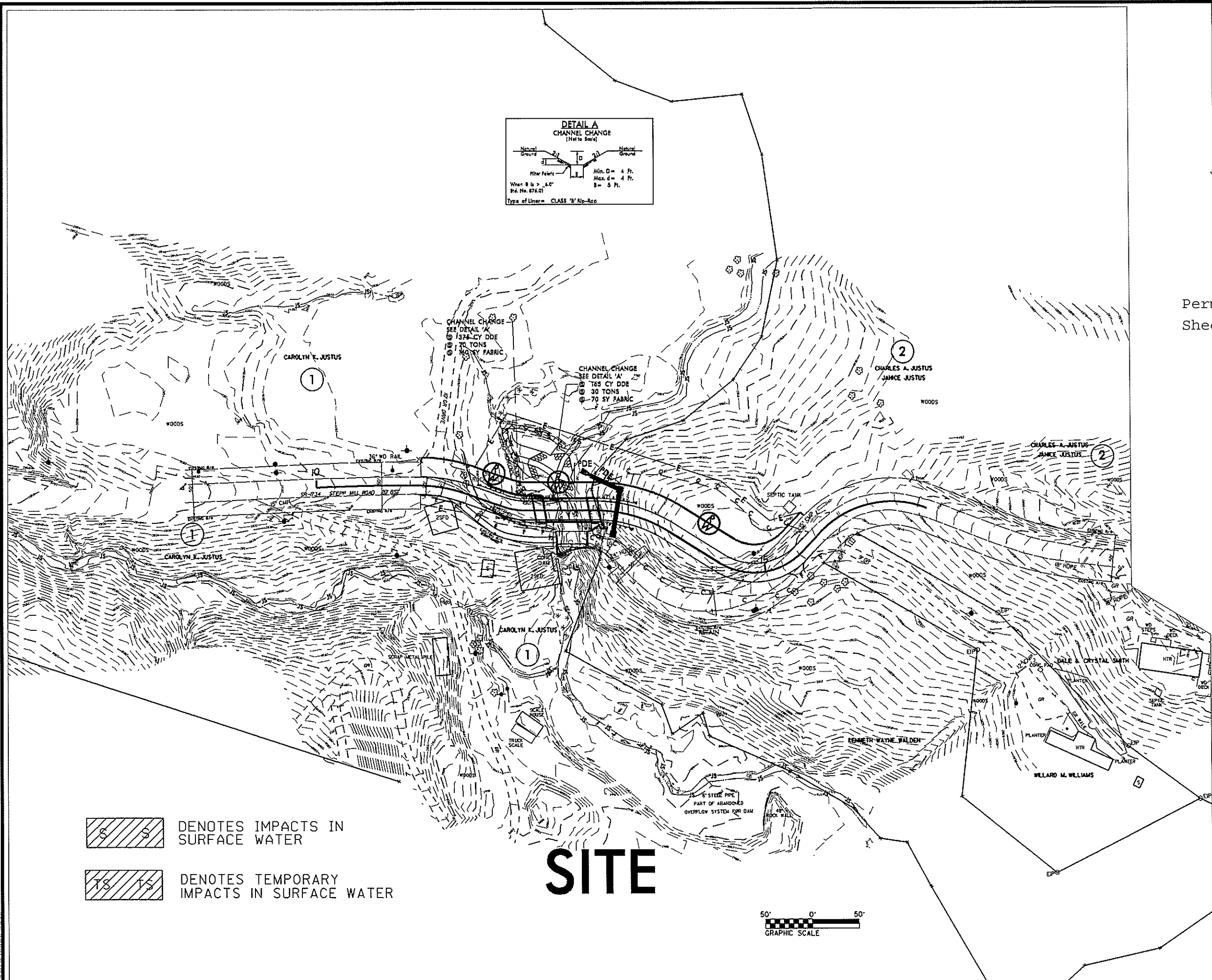
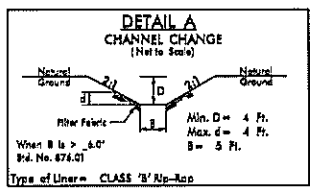

DENOTES IMPACTS IN SURFACE WATER

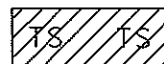

DENOTES TEMPORARY IMPACTS IN SURFACE WATER

**SITE**

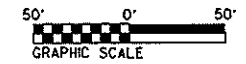

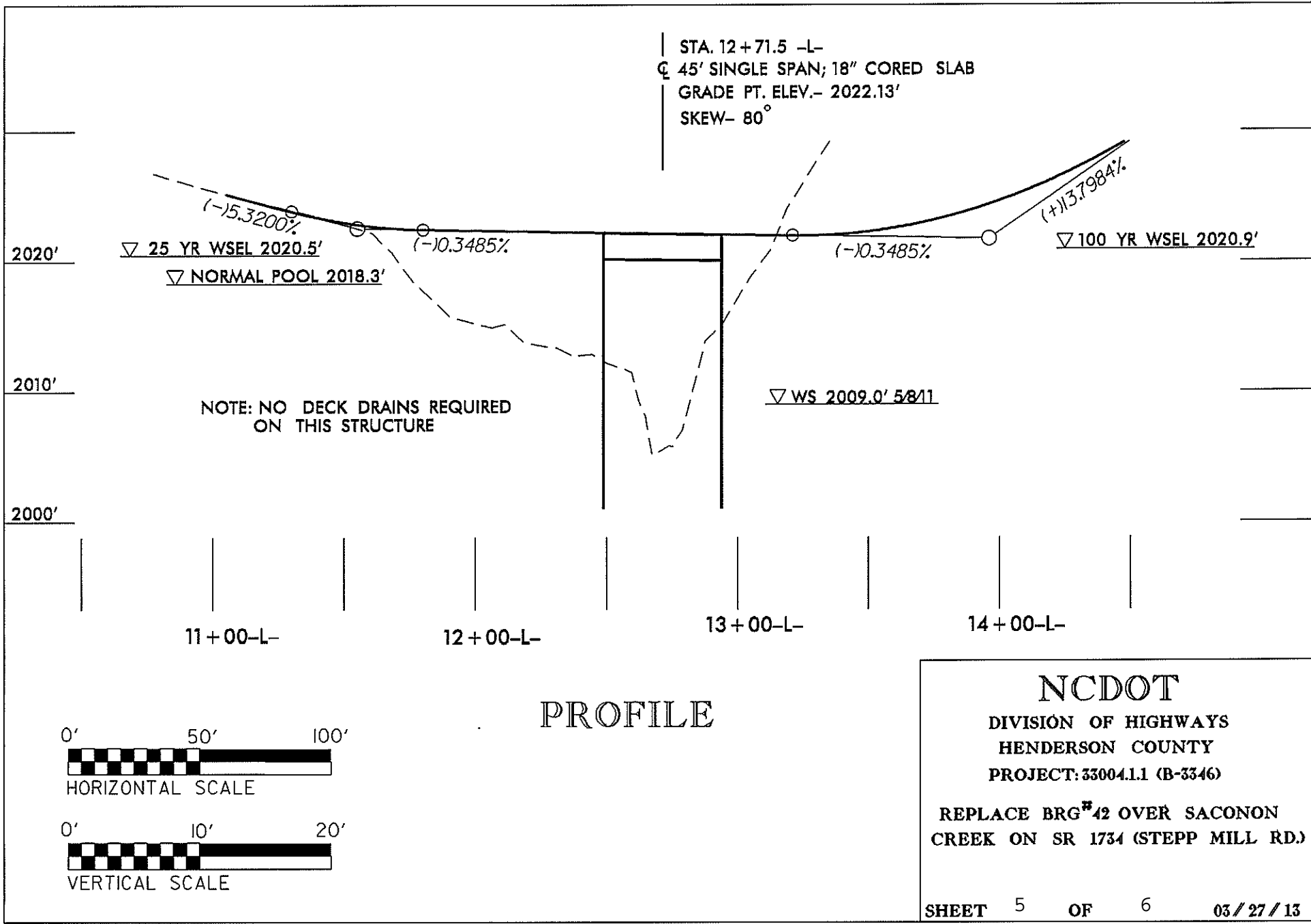

STA. 12+71.5 -L-  
 45' SINGLE SPAN; 18" CORED SLAB  
 GRADE PT. ELEV.- 2022.13'  
 SKEW- 80°

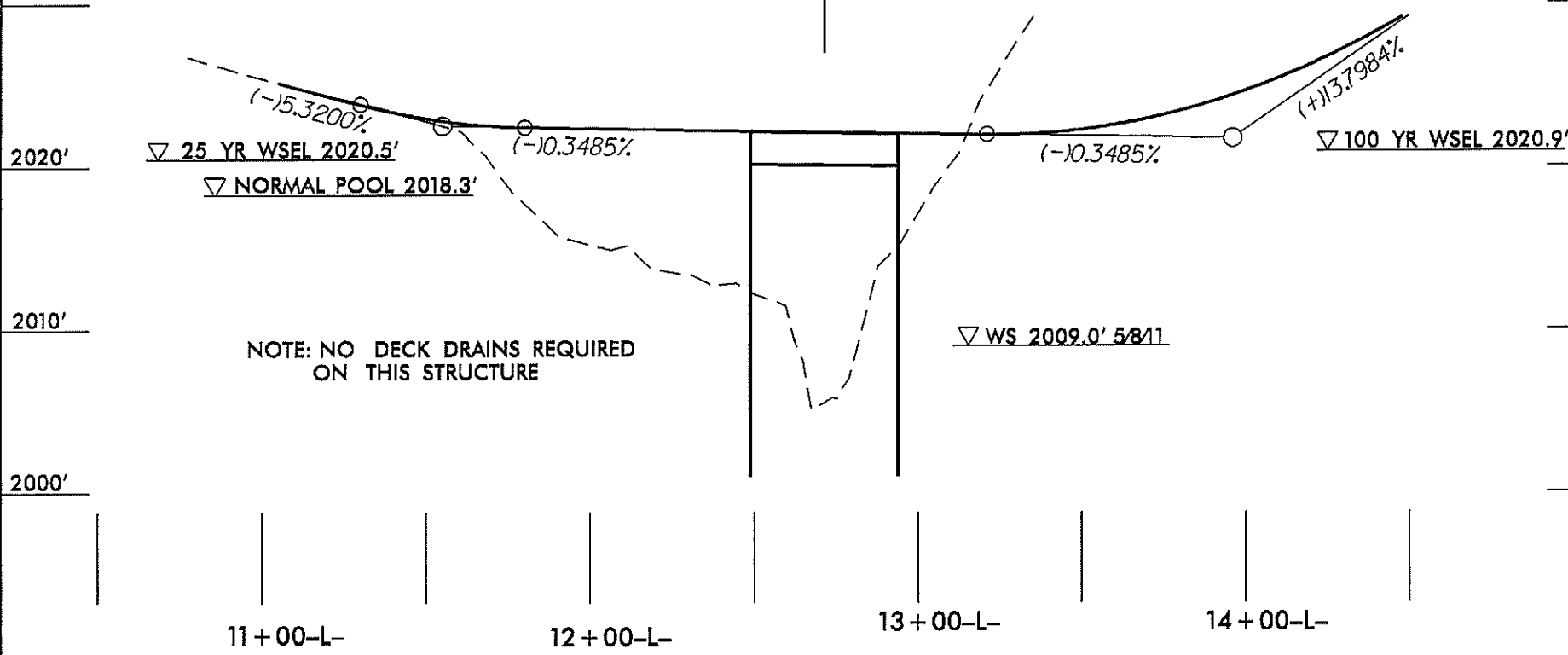

NOTE: NO DECK DRAINS REQUIRED ON THIS STRUCTURE

# PROFILE

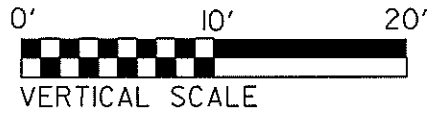
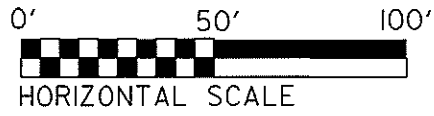

**NCDOT**  
 DIVISION OF HIGHWAYS  
 HENDERSON COUNTY  
 PROJECT: 33004.1.1 (B-3346)  
 REPLACE BRG#42 OVER SACONON  
 CREEK ON SR 1734 (STAPP MILL RD.)  
 SHEET 5 OF 6 03 / 27 / 13

**WETLAND PERMIT IMPACT SUMMARY**

Site No.	Station (From/To)	Structure Size / Type	WETLAND IMPACTS					SURFACE WATER IMPACTS				
			Permanent Fill In Wetlands (ac)	Temp. Fill In Wetlands (ac)	Excavation in Wetlands (ac)	Mechanized Clearing in Wetlands (ac)	Hand Clearing in Wetlands (ac)	Permanent SW impacts (ac)	Temp. SW impacts (ac)	Existing Channel Impacts Permanent (ft)	Existing Channel Impacts Temp. (ft)	Natural Stream Design (ft)
	12+00-L- to 13+00-L-	1 @ 45'; 18" Cored Slab Bridge						0.014	0.006	147	52	111
<b>TOTALS:</b>								0.01	<0.01	147	52	111

NC DEPARTMENT OF TRANSPORTATION  
DIVISION OF HIGHWAYS

HENDERSON COUNTY  
WBS -33004.1.1 (B-3346)

09/108/799

TIP PROJECT: B-3346

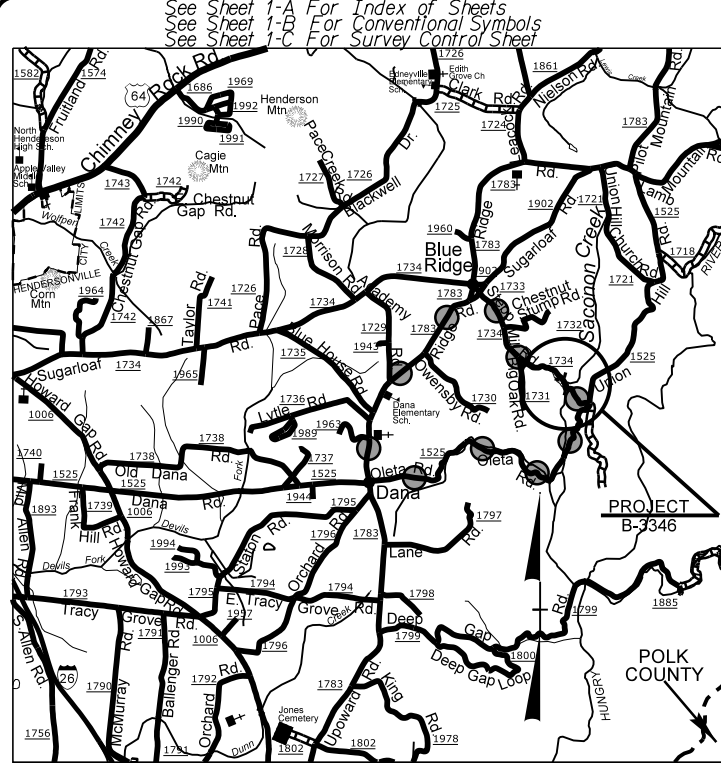

VICINITY MAP

●●●●● DETOUR ROUTE

TO BLUE RIDGE

STATE OF NORTH CAROLINA  
DIVISION OF HIGHWAYS

**HENDERSON COUNTY**

LOCATION: BRIDGE NO. 42 OVER SACONON CREEK  
ON SR 1734 (STEPP MILL ROAD)

TYPE OF WORK: GRADING, DRAINAGE, PAVING, STRUCTURE,  
RETAINING WALL, AND EXISTING STRUCTURE  
RETROFIT

STATE	STATE PROJECT REFERENCE NO.	SHEET NO.	TOTAL SHEETS
N.C.	B-3346	1	
STATE PROJ. NO.	F.A. PROJ. NO.	DESCRIPTION	
33004.1.1	BRZ-1734(3)	P.E.	
33004.2.1	BRZ-1734(3)	R/W & UTILITIES	

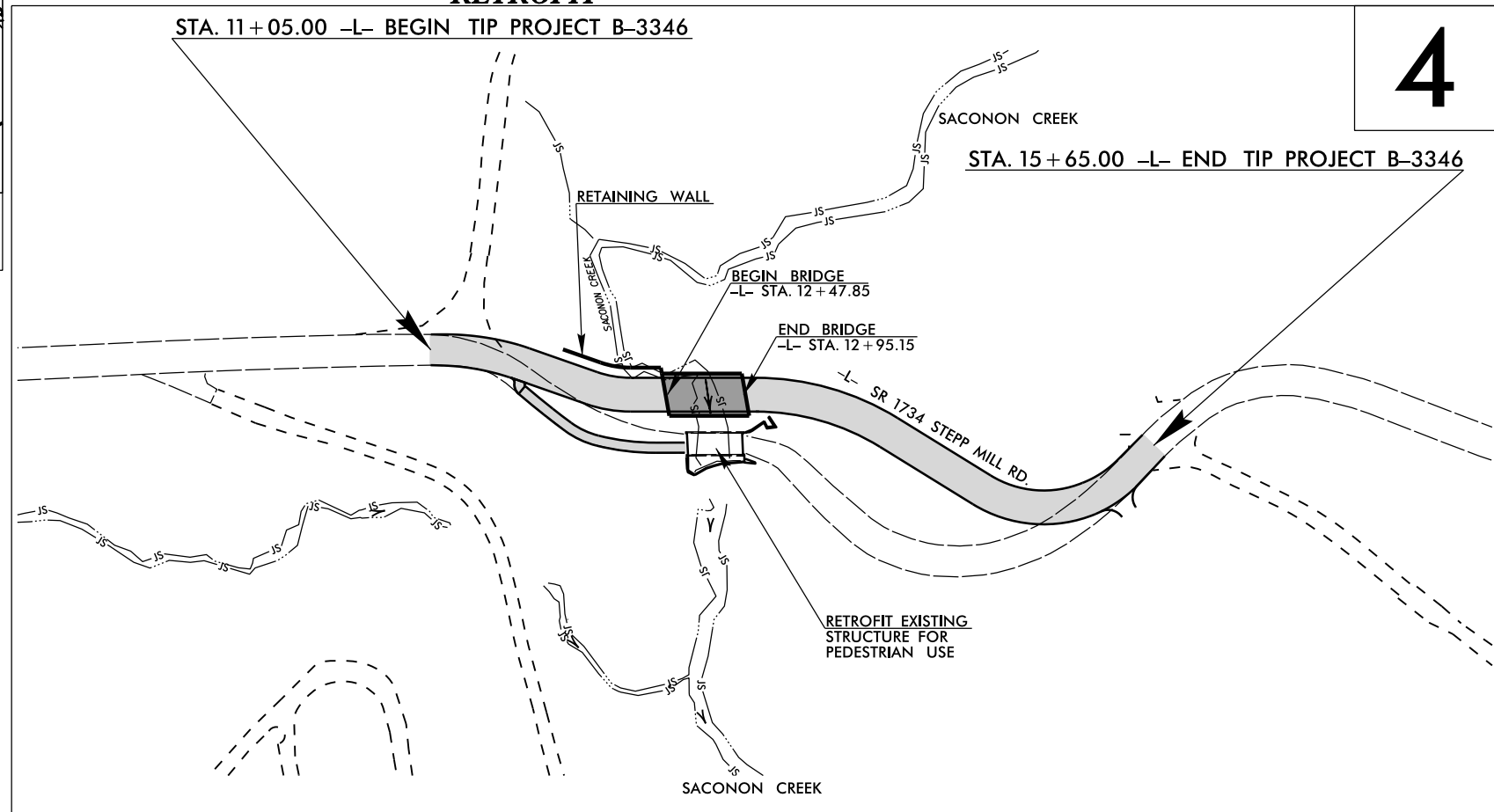
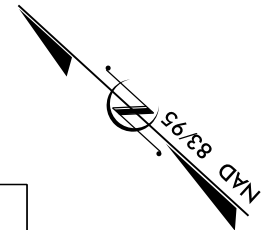

THIS PROJECT IS NOT WITHIN ANY MUNICIPAL BOUNDARIES.  
DESIGN EXCEPTION REQUIRED FOR DESIGN SPEED AND SUPERELEVATION.  
CLEARING ON THIS PROJECT SHALL BE PERFORMED TO THE LIMITS ESTABLISHED BY METHOD II.

PRELIMINARY PLANS  
DO NOT USE FOR CONSTRUCTION

GRAPHIC SCALES

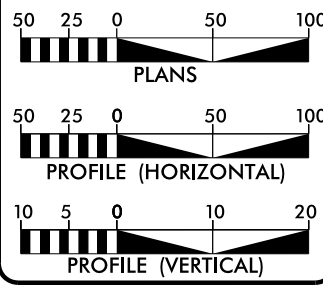

DESIGN DATA

ADT 2014 = 580  
 ADT 2035 = 900  
 DHV = 12 %  
 D = 60 %  
 T = 12 % \*  
 V = 15 MPH  
 \*TTST 1% DUAL 11%

FUNC CLASS=RURAL LOCAL  
SUB REGIONAL TIER

PROJECT LENGTH

LENGTH ROADWAY TIP PROJECT B-3346 = 0.078 MILES  
 LENGTH STRUCTURE TIP PROJECT B-3346 = 0.009 MILES  
 TOTAL LENGTH OF TIP PROJECT B-3346 = 0.087 MILES

Prepared in the Office of:  
**DIVISION OF HIGHWAYS**  
 1000 Birch Ridge Dr., Raleigh NC, 27610

2012 STANDARD SPECIFICATIONS

RIGHT OF WAY DATE:  
 MARCH 1, 2013

JAMES A. SPEER, PE  
 PROJECT ENGINEER

LETTING DATE:  
 FEBRUARY 18, 2014

DANIEL W. GARDNER, JR., PE  
 PROJECT DESIGN ENGINEER

HYDRAULICS ENGINEER

SIGNATURE: P.E.

ROADWAY DESIGN ENGINEER

SIGNATURE: P.E.

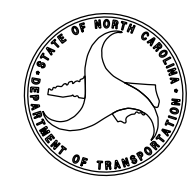

01-MAR-2013 09:20  
R:\Roadway\Projects\B3346-rdy-tsh.dgn  
\$\$\$\$\$USERNAME\$\$\$\$\$

CONTRACT:



# CONVENTIONAL PLAN SHEET SYMBOLS

## BOUNDARIES AND PROPERTY:

State Line	-----
County Line	-----
Township Line	-----
City Line	-----
Reservation Line	-----
Property Line	-----
Existing Iron Pin	○ EIP
Property Corner	-----*
Property Monument	□ ECM
Parcel/Sequence Number	⑩ 23
Existing Fence Line	-x-x-x-
Proposed Woven Wire Fence	○
Proposed Chain Link Fence	□
Proposed Barbed Wire Fence	◇
Existing Wetland Boundary	-w.b.-
Proposed Wetland Boundary	-w.b.-
Existing Endangered Animal Boundary	-e.a.b.-
Existing Endangered Plant Boundary	-e.p.b.-
Known Soil Contamination: Area or Site	☠ ☠
Potential Soil Contamination: Area or Site	?? ??

## BUILDINGS AND OTHER CULTURE:

Gas Pump Vent or U/G Tank Cap	○
Sign	○
Well	○
Small Mine	✕
Foundation	□
Area Outline	□
Cemetery	↑
Building	□
School	□
Church	□
Dam	▬

## HYDROLOGY:

Stream or Body of Water	-----
Hydro, Pool or Reservoir	□
Jurisdictional Stream	-j.s.-
Buffer Zone 1	-b.z. 1-
Buffer Zone 2	-b.z. 2-
Flow Arrow	←
Disappearing Stream	→
Spring	○
Wetland	⊥
Proposed Lateral, Tail, Head Ditch	← FLOW
False Sump	▽

## RAILROADS:

Standard Gauge	-----
RR Signal Milepost	○
Switch	□
RR Abandoned	-----
RR Dismantled	-----

## RIGHT OF WAY:

Baseline Control Point	◆
Existing Right of Way Marker	△
Existing Right of Way Line	-----
Proposed Right of Way Line	-----
Proposed Right of Way Line with Iron Pin and Cap Marker	○
Proposed Right of Way Line with Concrete or Granite R/W Marker	○
Proposed Control of Access Line with Concrete CA Marker	○
Existing Control of Access	○
Proposed Control of Access	○
Existing Easement Line	-----
Proposed Temporary Construction Easement	-----
Proposed Temporary Drainage Easement	-----
Proposed Permanent Drainage Easement	-----
Proposed Permanent Drainage / Utility Easement	-----
Proposed Permanent Utility Easement	-----
Proposed Temporary Utility Easement	-----
Proposed Aerial Utility Easement	-----
Proposed Permanent Easement with Iron Pin and Cap Marker	○

## ROADS AND RELATED FEATURES:

Existing Edge of Pavement	-----
Existing Curb	-----
Proposed Slope Stakes Cut	-----
Proposed Slope Stakes Fill	-----
Proposed Curb Ramp	-----
Existing Metal Guardrail	-----
Proposed Guardrail	-----
Existing Cable Guiderail	-----
Proposed Cable Guiderail	-----
Equality Symbol	⊕
Pavement Removal	⊗
VEGETATION:	
Single Tree	☼
Single Shrub	☼
Hedge	-----
Woods Line	-----

Orchard	☼ ☼ ☼
Vineyard	□

## EXISTING STRUCTURES:

MAJOR:	
Bridge, Tunnel or Box Culvert	CONC
Bridge Wing Wall, Head Wall and End Wall	CONC WW
MINOR:	
Head and End Wall	CONC HW
Pipe Culvert	-----
Footbridge	-----
Drainage Box: Catch Basin, DI or JB	CB
Paved Ditch Gutter	-----
Storm Sewer Manhole	⊕
Storm Sewer	-----

## UTILITIES:

POWER:	
Existing Power Pole	●
Proposed Power Pole	○
Existing Joint Use Pole	●
Proposed Joint Use Pole	○
Power Manhole	⊕
Power Line Tower	⊗
Power Transformer	⊗
U/G Power Cable Hand Hole	-----
H-Frame Pole	-----
Recorded U/G Power Line	-----
Designated U/G Power Line (S.U.E.*)	-----

## TELEPHONE:

Existing Telephone Pole	●
Proposed Telephone Pole	○
Telephone Manhole	⊕
Telephone Booth	⊕
Telephone Pedestal	⊕
Telephone Cell Tower	⊕
U/G Telephone Cable Hand Hole	-----
Recorded U/G Telephone Cable	-----
Designated U/G Telephone Cable (S.U.E.*)	-----
Recorded U/G Telephone Conduit	-----
Designated U/G Telephone Conduit (S.U.E.*)	-----
Recorded U/G Fiber Optics Cable	-----
Designated U/G Fiber Optics Cable (S.U.E.*)	-----

## WATER:

Water Manhole	⊕
Water Meter	○
Water Valve	⊗
Water Hydrant	⊕
Recorded U/G Water Line	-----
Designated U/G Water Line (S.U.E.*)	-----
Above Ground Water Line	A/G Water

## TV:

TV Satellite Dish	⊕
TV Pedestal	⊕
TV Tower	⊗
U/G TV Cable Hand Hole	-----
Recorded U/G TV Cable	-----
Designated U/G TV Cable (S.U.E.*)	-----
Recorded U/G Fiber Optic Cable	-----
Designated U/G Fiber Optic Cable (S.U.E.*)	-----

## GAS:

Gas Valve	◇
Gas Meter	⊕
Recorded U/G Gas Line	-----
Designated U/G Gas Line (S.U.E.*)	-----
Above Ground Gas Line	A/G Gas

## SANITARY SEWER:

Sanitary Sewer Manhole	⊕
Sanitary Sewer Cleanout	⊕
U/G Sanitary Sewer Line	-----
Above Ground Sanitary Sewer	A/G Sanitary Sewer
Recorded SS Forced Main Line	-----
Designated SS Forced Main Line (S.U.E.*)	-----

## MISCELLANEOUS:

Utility Pole	●
Utility Pole with Base	□
Utility Located Object	○
Utility Traffic Signal Box	⊕
Utility Unknown U/G Line	-----
U/G Tank; Water, Gas, Oil	□
Underground Storage Tank, Approx. Loc.	⊕
A/G Tank; Water, Gas, Oil	□
Geoenvironmental Boring	⊕
U/G Test Hole (S.U.E.*)	⊕
Abandoned According to Utility Records	AATUR
End of Information	E.O.I.

-L-		
PI Sta 10+56.03 Δ = 3° 12' 33.8" (RT) D = 2° 51' 53.2" L = 112.03' T = 56.03' R = 2,000.00'	PI Sta 11+36.73 Δ = 18° 42' 04.2" (RT) D = 38° 11' 49.9" L = 48.96' T = 24.70' R = 150.00'	PI Sta 12+15.50 Δ = 19° 18' 19.9" (LT) D = 81° 51' 04.0" L = 23.59' T = 11.91' R = 70.00'
-L-		
PI Sta 13+43.83 Δ = 31° 41' 22.8" (RT) D = 38° 11' 49.9" L = 82.96' T = 42.57' R = 150.00'	PI Sta 15+05.41 Δ = 77° 49' 57.2" (LT) D = 81° 51' 04.0" L = 95.09' T = 56.52' R = 70.00'	PI Sta 16+44.16 Δ = 67° 19' 06.5" (RT) D = 54° 34' 02.7" L = 123.37' T = 69.92' R = 105.00'
-L-		

\*DESIGN EXCEPTION REQUIRED FOR SUPERELEVATION

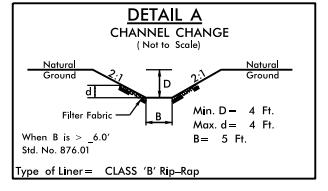

UTILITY OWNERS  
DUKE ENERGY CORPORATION  
526 S. CHURCH STREET  
P.O. BOX 1006 ECIOO  
CHARLOTTE, N.C. 28202  
BELLSOUTH TELECOMMUNICATIONS, INC.  
601 W. CHESTNUT ST.  
LOUISVILLE, KY. 40202-2034

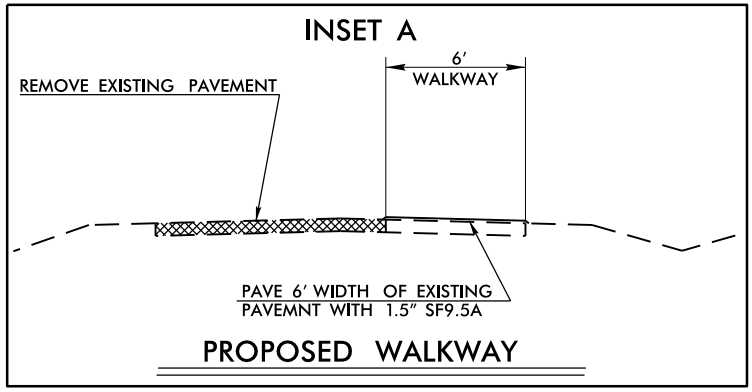
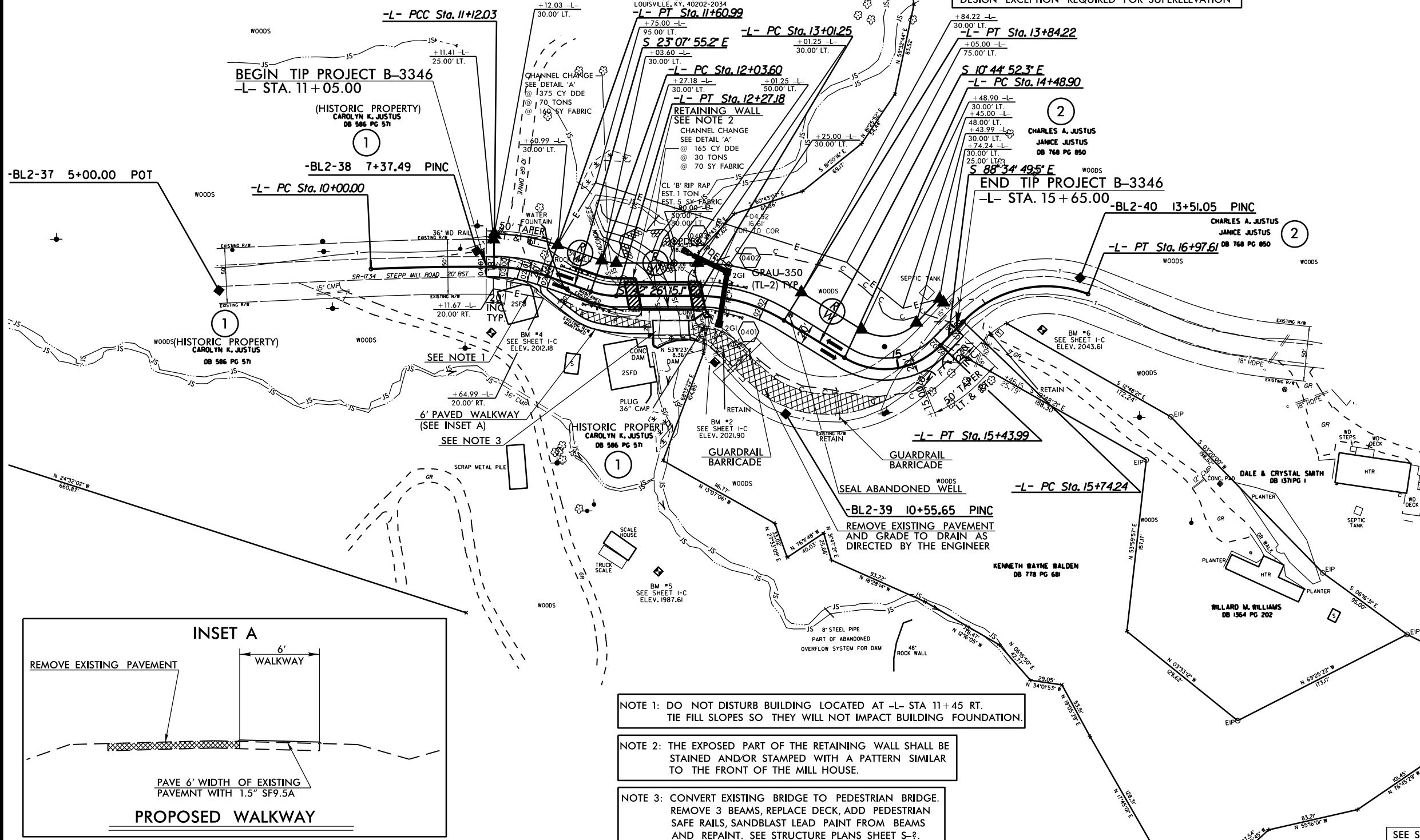
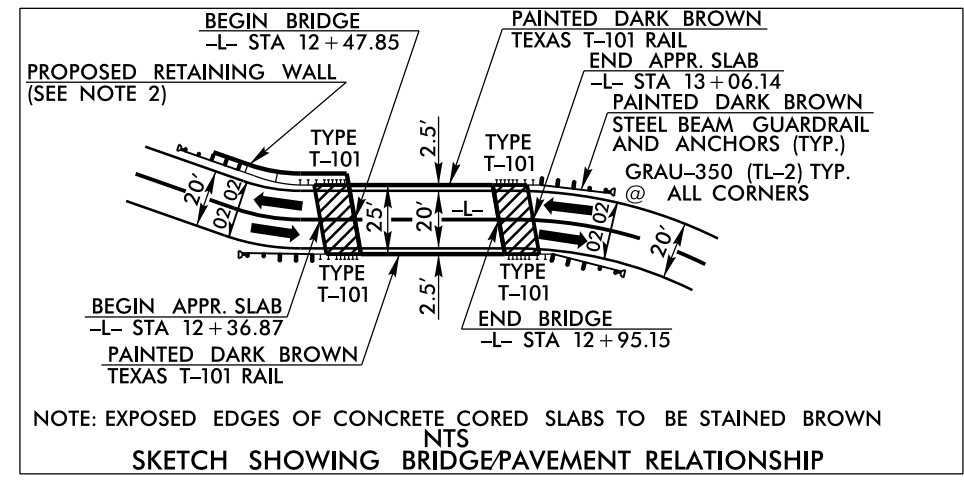

- NOTE 1: DO NOT DISTURB BUILDING LOCATED AT -L- STA 11+45 RT. TIE FILL SLOPES SO THEY WILL NOT IMPACT BUILDING FOUNDATION.
- NOTE 2: THE EXPOSED PART OF THE RETAINING WALL SHALL BE STAINED AND/OR STAMPED WITH A PATTERN SIMILAR TO THE FRONT OF THE MILL HOUSE.
- NOTE 3: CONVERT EXISTING BRIDGE TO PEDESTRIAN BRIDGE. REMOVE 3 BEAMS, REPLACE DECK, ADD PEDESTRIAN SAFE RAILS, SANDBLAST LEAD PAINT FROM BEAMS AND REPAINT. SEE STRUCTURE PLANS SHEET S-2.

SEE SHEET 5 FOR -L- PROFILE  
SEE SHEETS S-1 THRU S-2 FOR STRUCTURE PLANS

REVISIONS  
RAW REVISION 05-30-13 (DWG) - REVISED THE TCE ON PARCEL 1 (CAROLYN K. JUSTUS) AND PARCEL 2 (CHARLES A. JUSTUS, JANICE JUSTUS) FOR THE ADDITION OF A CHANNEL CHANGE AT -L- STA 12+80.00 LT.

30-MAY-2013 07:15  
R:\Roadway\Proj\3346\_rdy\_psh.dgn  
4:51 PM 5/30/2013

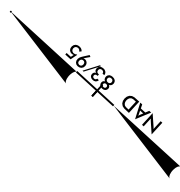

5/14/99



**BRIDGE HYDRAULIC DATA**

DESIGN DISCHARGE = 415 CFS  
 DESIGN FREQUENCY = 25 YRS  
 DESIGN HW ELEVATION = 2020.50 FT  
 BASE DISCHARGE = 600 CFS  
 BASE FREQUENCY = 100 YRS  
 BASE HW ELEVATION = 2020.90 FT  
 OVERTOPPING DISCHARGE = N/A CFS  
 OVERTOPPING FREQUENCY = 500 YRS  
 OVERTOPPING ELEVATION = 2021.95 FT

DATE OF SURVEY = 05/08/11  
 W.S. ELEVATION AT DATE OF SURVEY = 2009.00 FT

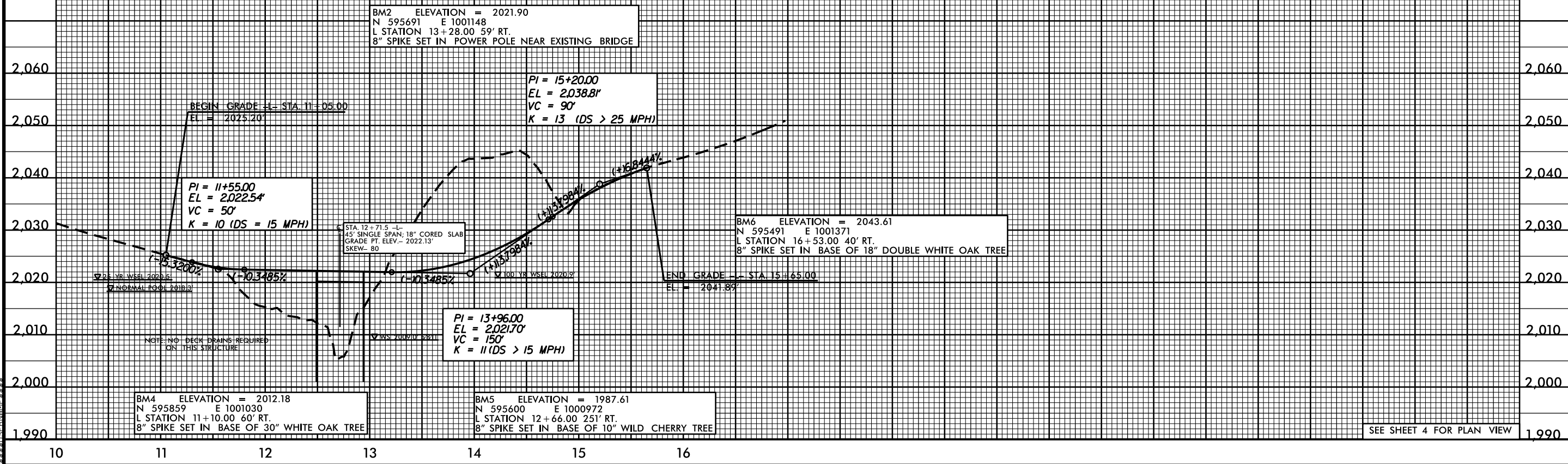

SEE SHEET 4 FOR PLAN VIEW

D:\MAR-2013 09:20 B3346\_rdy.pfl.dgn