



PAT McCrory
Governor

NICHOLAS J. TENNYSON
Secretary

August 19, 2016

N.C. Division of Water Resources
1611 Mail Service Center
Raleigh, NC 27699-1611

ATTN: Mr. S. Jay Zimmerman
Director

Subject: **Response to NCDWR On-Hold Letter dated July 19, 2016** for the proposed widening of NC 273 (South Main Street) from Tuckasee Road to Highland Street in Gaston County, Federal Aid Project No. STP-273-(1), Division 12, TIP No. U-3633, WBS 37649.1.1.

Reference: 404/401 Individual Permit Application dated July 8, 2016
NCDWR On Hold Letter dated July 19, 2016

Dear Sir:

On July 19, 2016, NCDWR sent a letter placing the permit application for the above-referenced project on-hold, citing eight areas where the permit drawings and design plans required revisions. This letter serves to provide all of the information requested to remedy the deficiencies. Please see the revised Table 1 below and the enclosed revised DMS acceptance, permit drawings, and design plan sheets 5 and 6 that replace the ones previously submitted with the July 8th permit application. The revised DMS acceptance was needed due to previous errors in impact measurement at Site 2, 6 and 7.

- 1) All riprap in jurisdictional areas has been upgraded to Class II.
- 2) No details referencing jurisdictional streams show geotextile fabric on the bed of the stream.
- 3) Inlet stabilization has been added to permit sites 1, 3, 4, and 5 (and impact summary sheet has been revised accordingly).
- 4) More detailed floodplain bench details for Fites Creek have been provided.
- 5) The rock sill detail (detail 6) for permit site 7 has been updated.
- 6) The easement line near the pond will be changed from a PUE (Permanent Utility Easement) to a DUE (Permanent Drainage/Utility Easement) to allow for better erosion control associated with installing a 24" drainage line next to the pond.
- 7) Temporary dewatering impacts for each site have been incorporated into the impacts.
- 8) Any riprap used in stream beds will be embedded.



Revised Table 1 – U-3633 Stream Impacts**

Site	Stream Name & Intermittent (I) or Perennial (P) ¹	Stream ID	Impact Type	Impact Length (linear feet)	Temporary Impacts (acres)	Mitigation Requirement ² (linear feet)
1	UT to Fites Creek (I)	SE	Perm. Fill	15	--	USACE & DWR
			Bank Stabilization	5	--	DWR
			Temp Fill	--	<0.01 (9')	--
2	UT to Fites Creek (I)	SE	Perm. Fill	188*	--	USACE & DWR
			Bank Stabilization	--	--	--
			Temp Fill	--	--	--
3	UT to Fites Creek (P)	SB	Perm. Fill	68	--	USACE & DWR
			Bank Stabilization	6	--	DWR
			Temp Fill	--	0.01 (16')	--
4	UT to Fites Creek (P)	SB	Perm. Fill	7	--	USACE & DWR
			Bank Stabilization	21	--	DWR
			Temp Fill	--	<0.01 (17')	--
5	UT to Fites Creek (P)	SB	Perm. Fill	484	--	USACE & DWR
			Bank Stabilization	24	--	DWR
			Temp Fill	--	<0.01 (23')	--
6	Fites Creek (P)	Fites Creek	Perm. Fill	223	--	USACE & DWR
			Bank Stabilization	--	--	--
			Temp. Fill	--	0.02 (65')	--
7	UT to Fites Creek (P)	SD	Perm. Fill	148	--	USACE
			Bank Stabilization	--	--	--
			Temp. Fill	--	<0.01 (18')	--
Total Temporary Impacts:				--	0.03 ³ (148')	--
Total Perm. Impacts (Perm. Fill + Bank Stabilization):				1,189	--	--
Permanent Impacts Requiring DWR Mitigation:				1,041	--	--
Permanent Impacts Requiring USACE Mitigation:				1,133	--	--
Total Impacts Requiring Mitigation:				1,133	--	†

1 – All streams are Class WS-IV waters 2 – Mitigation for bank stabilization impacts required by DWR – not required by USACE
3 – Values are based on rounding, due to some of the individual impacts being <0.01 acre † – Final mitigation requirement will be up to the USACE and DWR * – Of this 188', 43' is stream running through a concrete-lined channel ** – Impact amounts for all sites have changed since the July 8, 2016 permit application due to addition of bank stabilization and/or measurement correction.

We believe that the above information has satisfied the requested changes in the July 8, 2016 permit application and the project can be removed from "On-Hold" status and permitting can proceed. Thank you for your assistance with this project. If you have any questions or need additional information, please contact Erin Cheely at ekcheely@ncdot.gov or (919) 707-6108.

Sincerely,



Philip S. Harris III, P.E., C.P.M.
Natural Environment Section Head

cc:
NCDOT Permit Application Standard Distribution List



PAT MCCRORY
Governor

DONALD R. VAN DER VAART
Secretary

August 16, 2016

Mr. Philip S. Harris, P.E., CPM
Project Development and Environmental Analysis Unit
North Carolina Department of Transportation
1598 Mail Service Center
Raleigh, North Carolina 27699-1598

Dear Mr. Harris:

Subject: EEP Mitigation Acceptance Letter:

U-3633, Widen NC 273 (South Main Street) to Multi Lanes from Tuskaseegee Road to Highland Street at South Main Street, Gaston County

The purpose of this letter is to notify you that the Division of Mitigation Services (DMS) will provide the compensatory stream mitigation for the subject project. Based on the information supplied by you on August 16, 2016, the impacts are located in CU 03050101 of the Catawba River basin in the Southern Piedmont (SP) Eco-Region, and are as follows:

Catawba 03050101 SP	Stream			Wetlands			Buffer (Sq. Ft.)	
	Cold	Cool	Warm	Riparian	Non-Riparian	Coastal Marsh	Zone 1	Zone 2
Impacts (feet/acres)	0	0	1,133.0	0	0	0	0	0

This mitigation acceptance letter replaces the mitigation acceptance letter issued on June 14, 2016. DMS will commit to implement sufficient compensatory stream mitigation credits to offset the impacts associated with this project as determined by the regulatory agencies using the delivery timeline listed in Section F.3.c.iii of the In-Lieu Fee Instrument dated July 28, 2010. If the above referenced impact amounts are revised, then this mitigation acceptance letter will no longer be valid and a new mitigation acceptance letter will be required from EEP.

If you have any questions or need additional information, please contact Beth Harmon at 919-707-8420.

Sincerely,

James B. Stanfill
EEP Credit Management Supervisor

cc: Mr. Steve Kichefski, USACE – Asheville Regulatory Field Office
Ms. Amy Chapman, NCDWR
File: U-3633 Revised

09/08/99

\$\$\$SYTIME\$\$\$
 \$\$\$DGN\$\$\$
 \$\$\$USERNAME\$\$\$

A detailed map of Mount Holly, North Carolina, illustrating the project area. The map features several roads, including SR 2040, SR 2044, SR 2071, SR 2092, SR 2146, SR 2198, SR 1601, and SR 1603. Key landmarks include the Mt. Holly Cemetery, City Limits, and the Seaboard Coastline. The project area is defined by a thick blue line, starting from the "BEGIN PROJECT" point near SR 1601 and ending at the "END PROJECT" point near SR 1606. The map also shows the Gaston County and Mecklenburg County borders, as well as the CSX Main Line and Atlantic Railway. A north arrow is located in the upper right corner.

BEGIN T.I.P. PROJECT U-3633

END T.I.P. PROJECT U-3633

PERMIT DRAWING SHEET 1 OF 11

END T.I.P. PROJECT U-3633
-L- STA. 91+00.00

PRELIMINARY PLANS
DO NOT USE FOR CONSTRUCTION

**LOCATION: MOUNT HOLLY – NC 273 (SOUTH MAIN STREET) FROM
TUCKASEEGE ROAD AT BEATTY DRIVE TO HIGHLAND
STREET AT A&E DRIVE**

**TYPE OF WORK: WIDENING, GRADING, DRAINAGE, PAVING, RESURFACING,
& CULVERT.**

STATE	STATE PROJECT REFERENCE NO.	SHEET NO.	TOTAL SHEETS
N.C.	U-3633	1	
STATE PROJ. NO.	F. A. PROJ. NO.	DESCRIPTION	
37649.1.1	STP-0273(1)	PE	
37649.2.FRI	STP-0273(1)	R/W	
37649.2.FRUI	STP-0273(1)	UTIL	
_____	_____	_____	
_____	_____	_____	
_____	_____	_____	
_____	_____	_____	
_____	_____	_____	

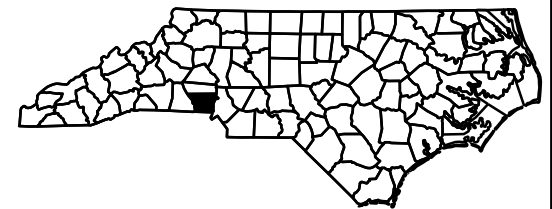

WETLAND AND SURFACE WATER IMPACTS PERMIT

NAD 83/2007

ADT 2014 = 26,800
ADT 2035 = 42,300
K = 10 %
D = 55 %
T = 4 % *
V = 50 MPH
* TTST = 2 DUAL 2
FUNC CLASS =
URBAN COLLECTOR
REGIONAL TIER

LENGTH ROADWAY T.I.P. PROJECT U-3633 = 1.365 MI

LENGTH STRUCTURE T.I.P. PROJECT U-3633 = 0.005 MI

TOTAL LENGTH OF T.I.P. PROJECT U-3633 = 1.370 MI

2012 STANDARD SPECIFICATIONS

RIGHT OF WAY DATE:
NOVEMBER 25, 2014

LETTING DATE:
JANUARY 17, 2017

JAMES A. SPEER, PE
PROJECT ENGINEER

NYA BOAYUE, PE
PROJECT DESIGN ENGINEER

P.E.

SIGNATURE: _____

**ROADWAY DESIGN
ENGINEER**

P.E.

SIGNATURE:

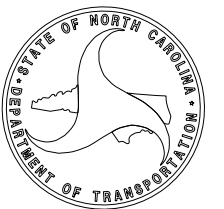

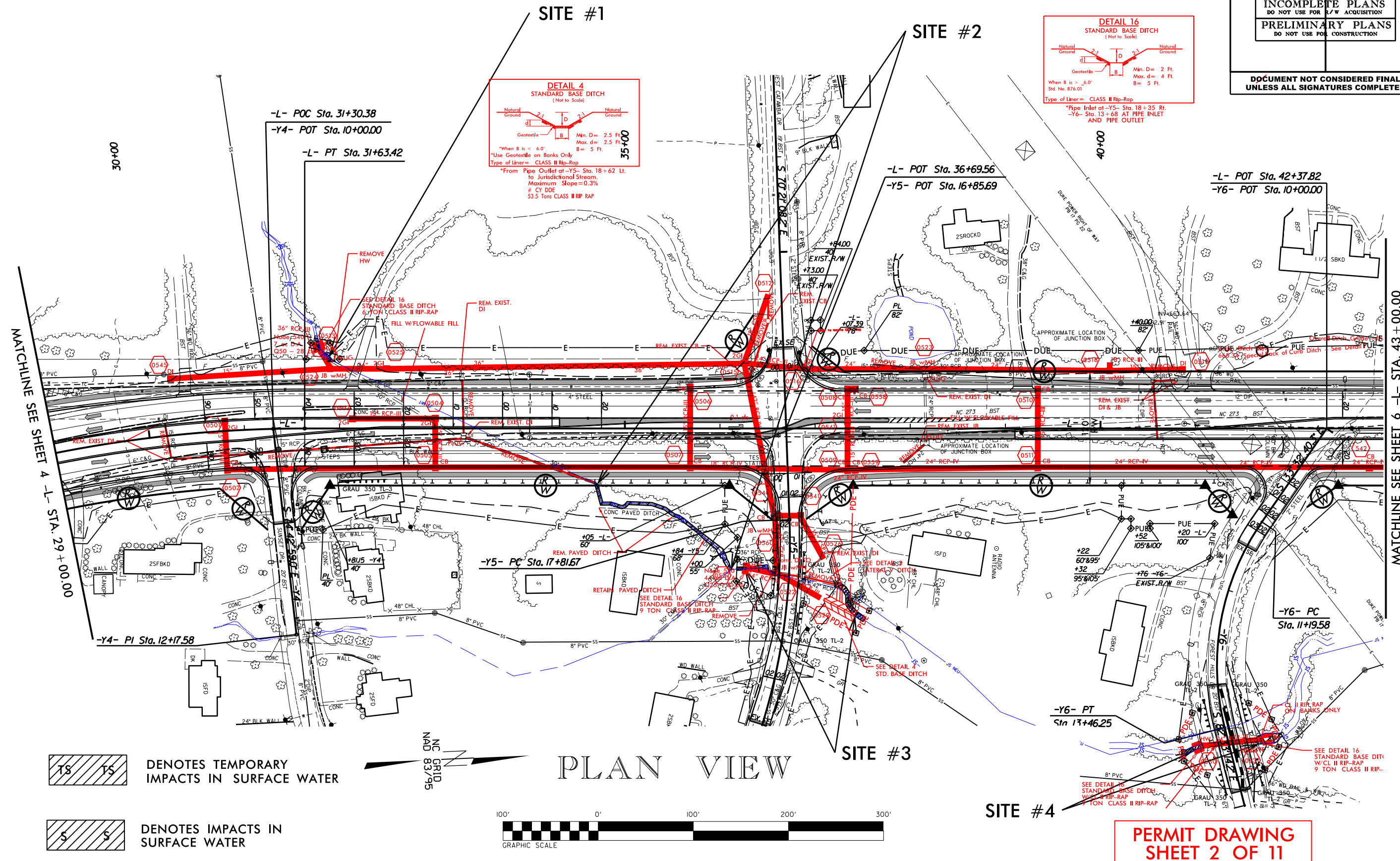

PERMIT DRAWING
SHEET 2 OF 11

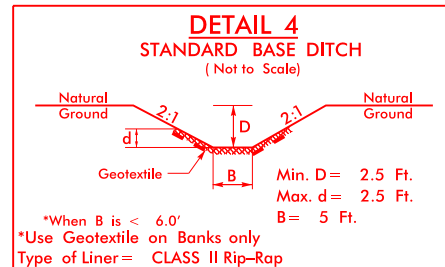
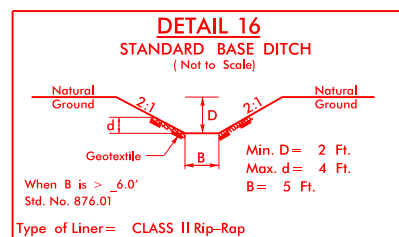

SITE #1

SITE #2

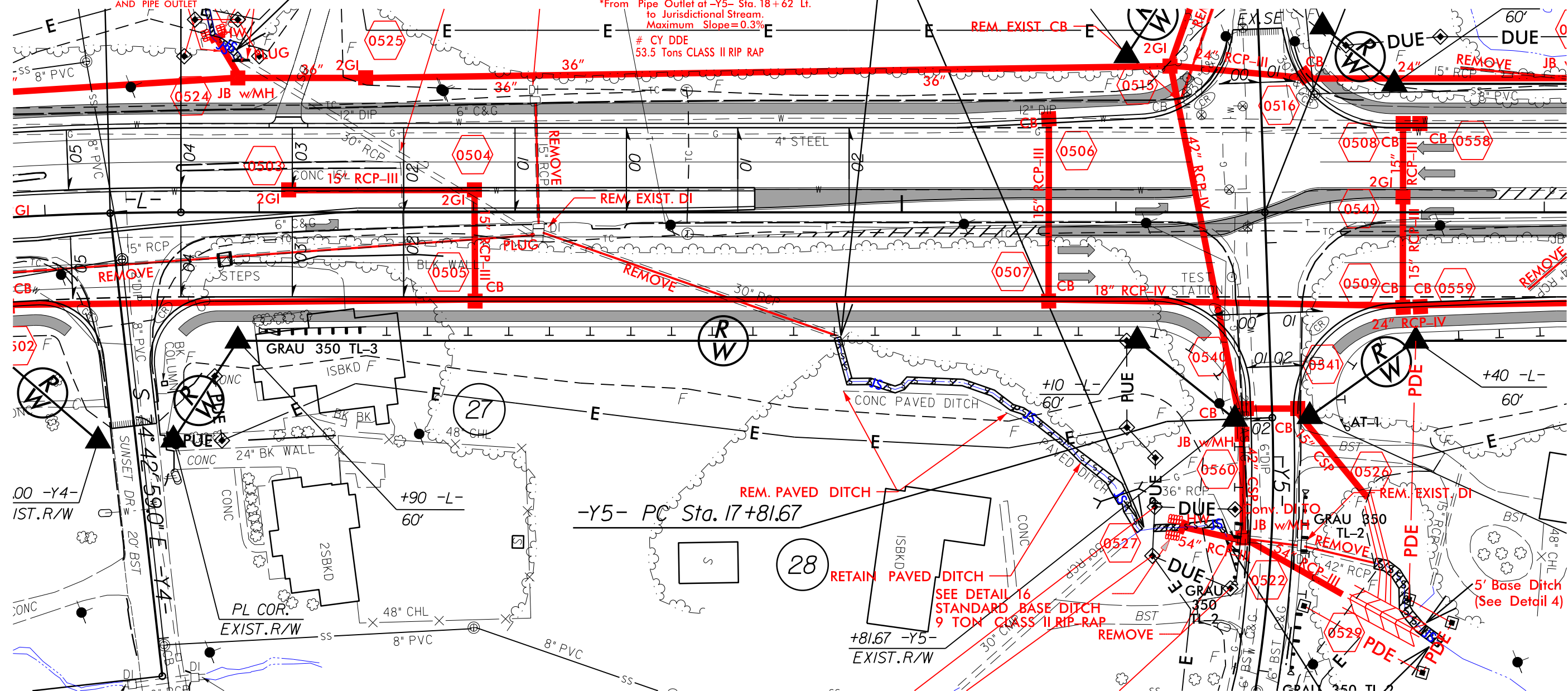

PLAN VIEW
ENLARGEMENT

SITE #3

PERMIT DRAWING
SHEET 4 OF 11

 DENOTES TEMPORARY
IMPACTS IN SURFACE WATER

 DENOTES IMPACTS IN SURFACE WATER

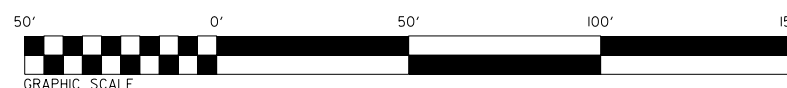

Scale: 1" = 50'

PROJECT REFERENCE NO.	SHEET NO.
U-3633	6
R/W SHEET NO.	
ROADWAY DESIGN ENGINEER	HYDRAULICS ENGINEER

SITE #6

SITE #7

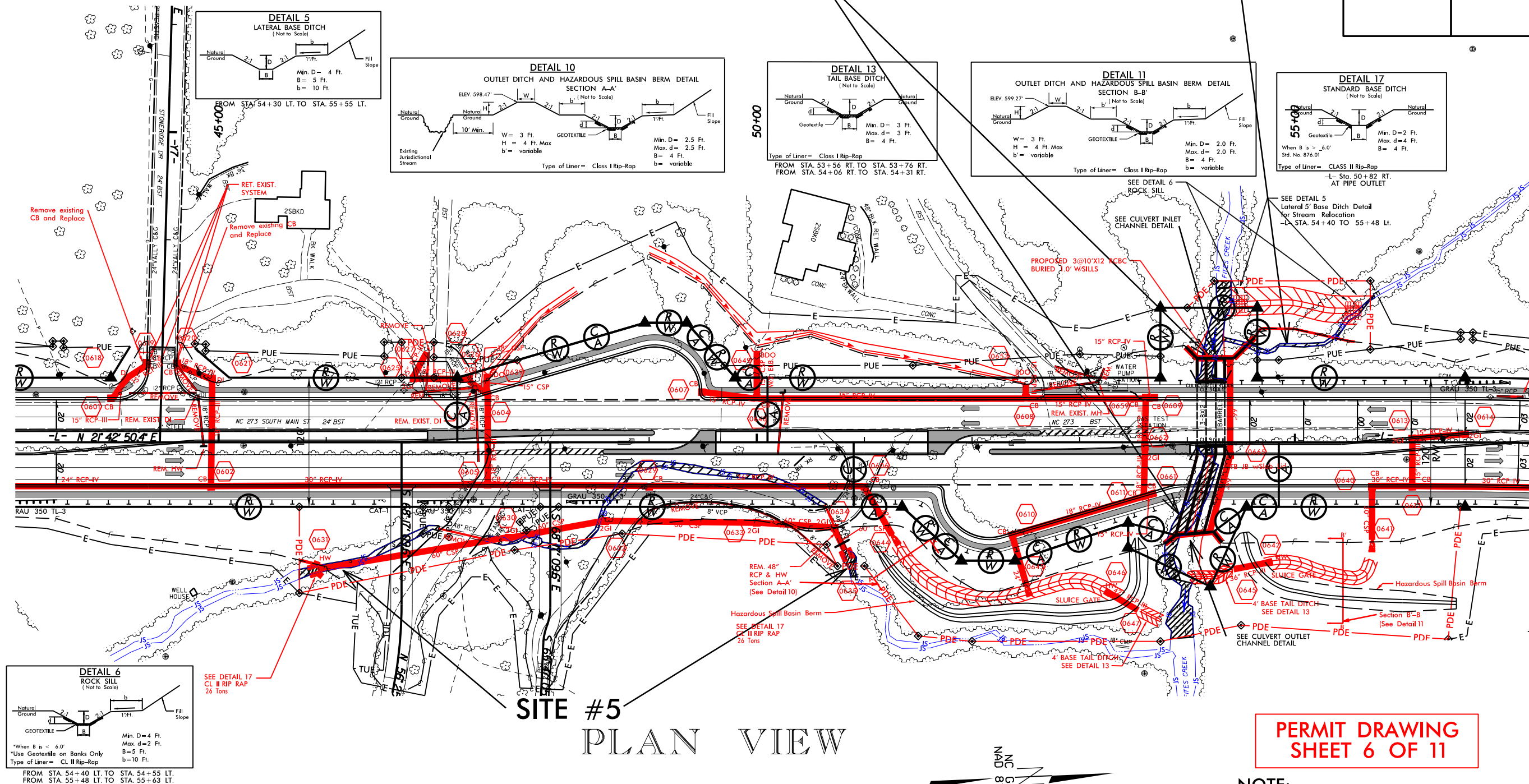

SITE #5

PLAN VIEW

PERMIT DRAWING
SHEET 6 OF 11

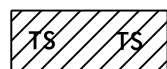
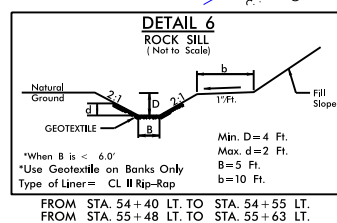

TS
DENOTES TEMPORARY
IMPACTS IN SURFACE WATER



S
DENOTES IMPACTS IN
SURFACE WATER

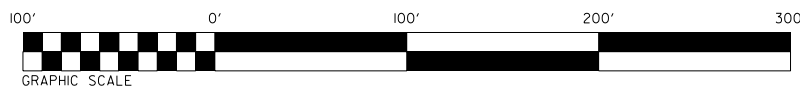

Scale: 1" = 100'

NC GRID
NAD 83/95

NOTE:
CL II Rip Rap Not Shown
in Plan View for Clarity

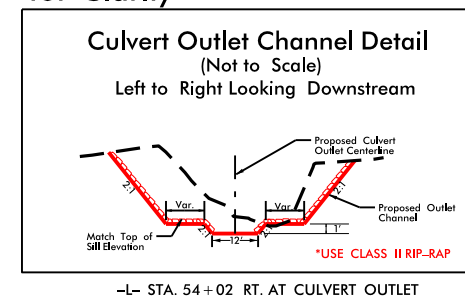
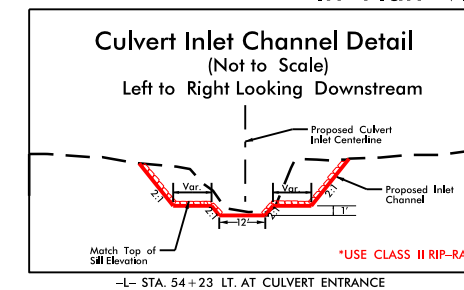

SITE #6

SITE #7

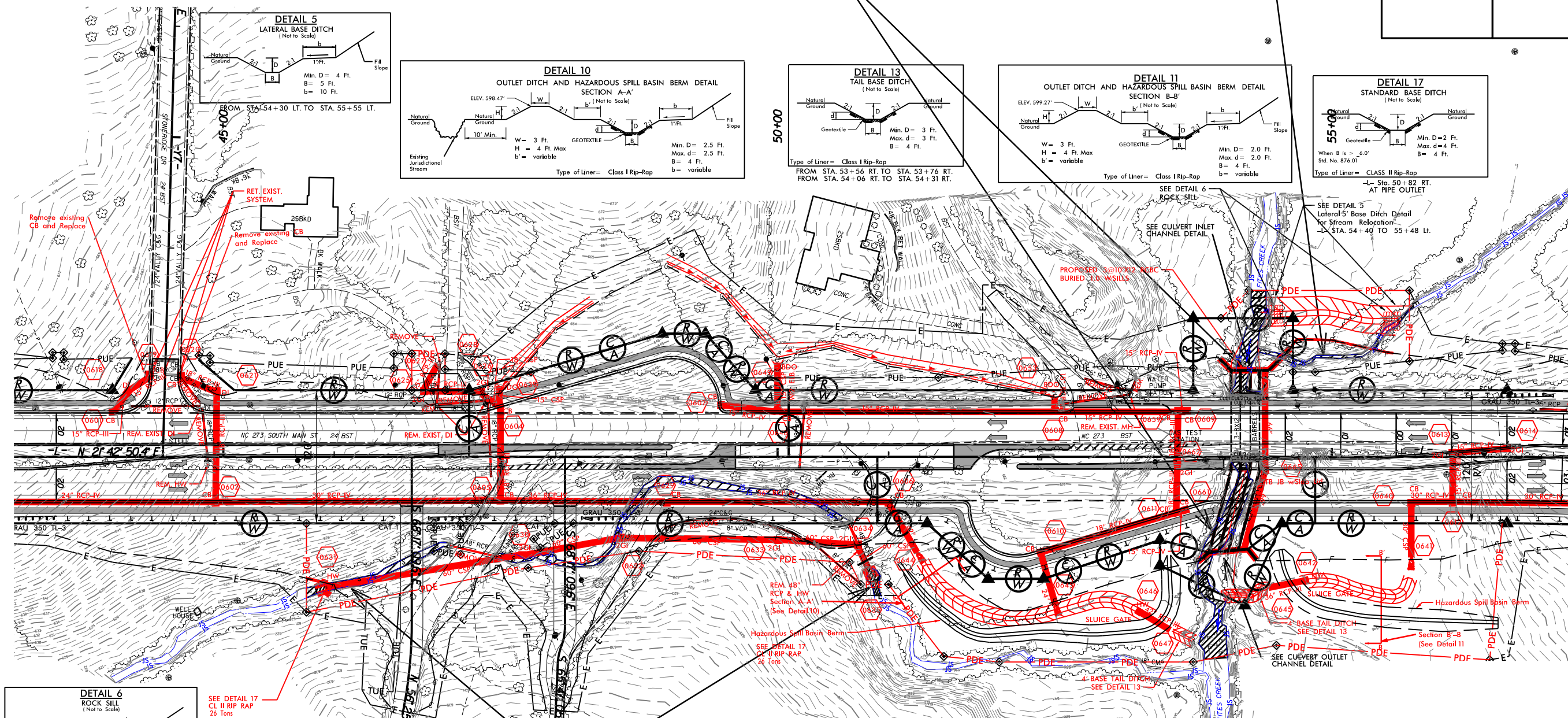

SITE #5

PLAN VIEW

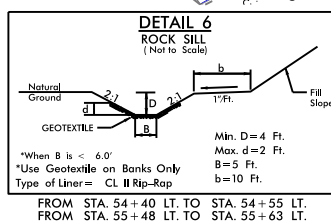

SEE DETAIL 17
CL II RIP RAP
2' T

 DENOTES TEMPORARY IMPACTS IN SURFACE WATER

 DENOTES IMPACTS IN SURFACE WATER

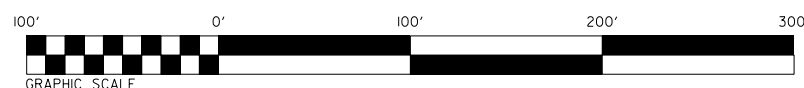

Scale: 1" = 100'

PERMIT DRAWING
SHEET 7 OF 11

NOTE:
CL II Rip Rap Not Shown
in Plan View for Clarity

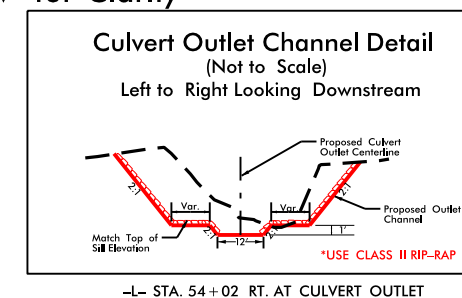
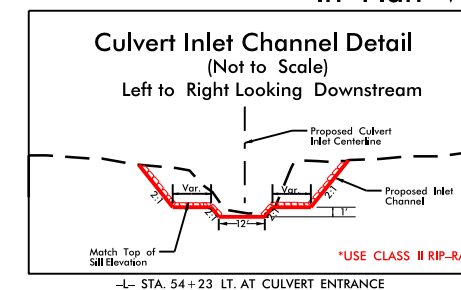

5/14/99

SITE 6 Profile and Sill Details

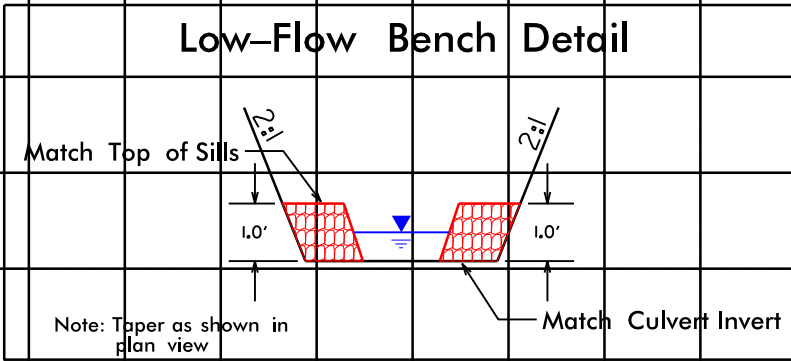
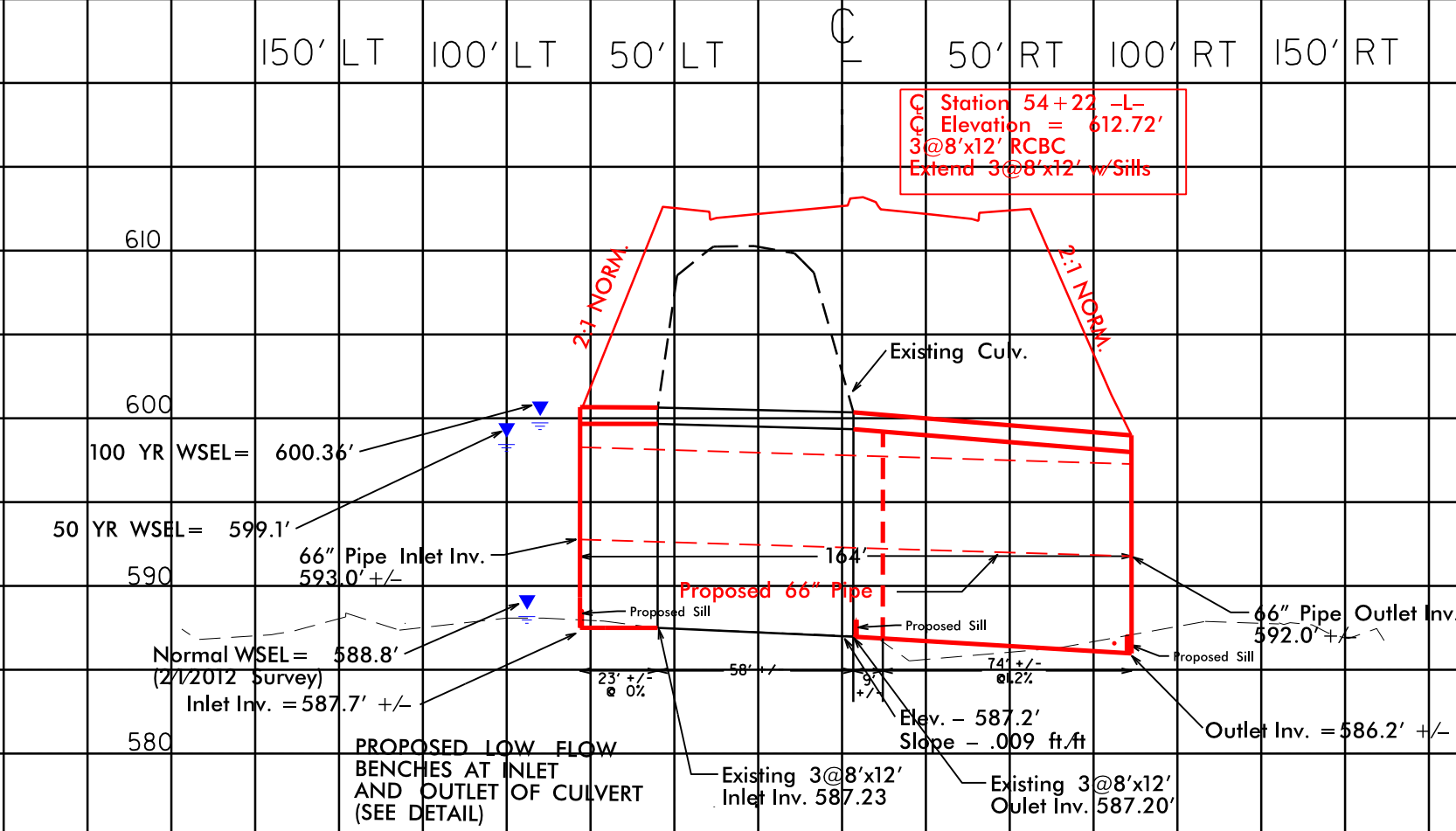

- ### Culvert Sill Locations
1. Place Sills at Culvert Outlet
 2. Place Sills 82' from Culvert Outlet
 3. Place Sills at Culvert Inlet

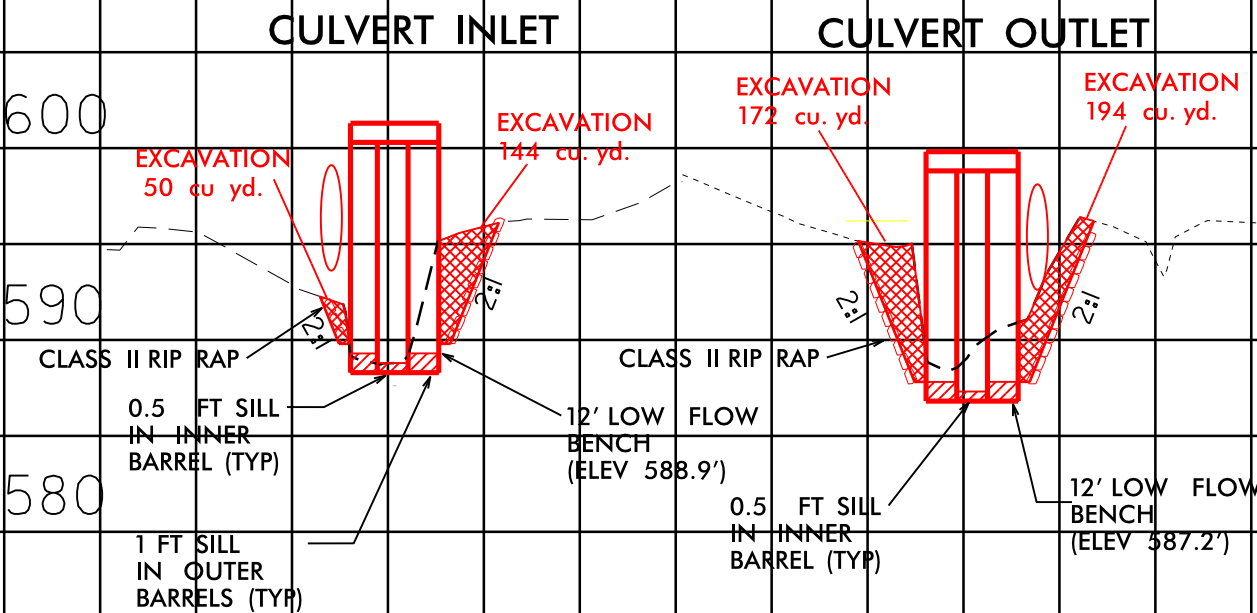

PERMIT DRAWING
SHEET 8 OF 11

PROJECT REFERENCE NO.	SHEET NO.
U-3633	6
R/W SHEET NO.	
ROADWAY DESIGN ENGINEER	HYDRAULICS ENGINEER
PRELIMINARY PLANS	
DO NOT USE FOR CONSTRUCTION	

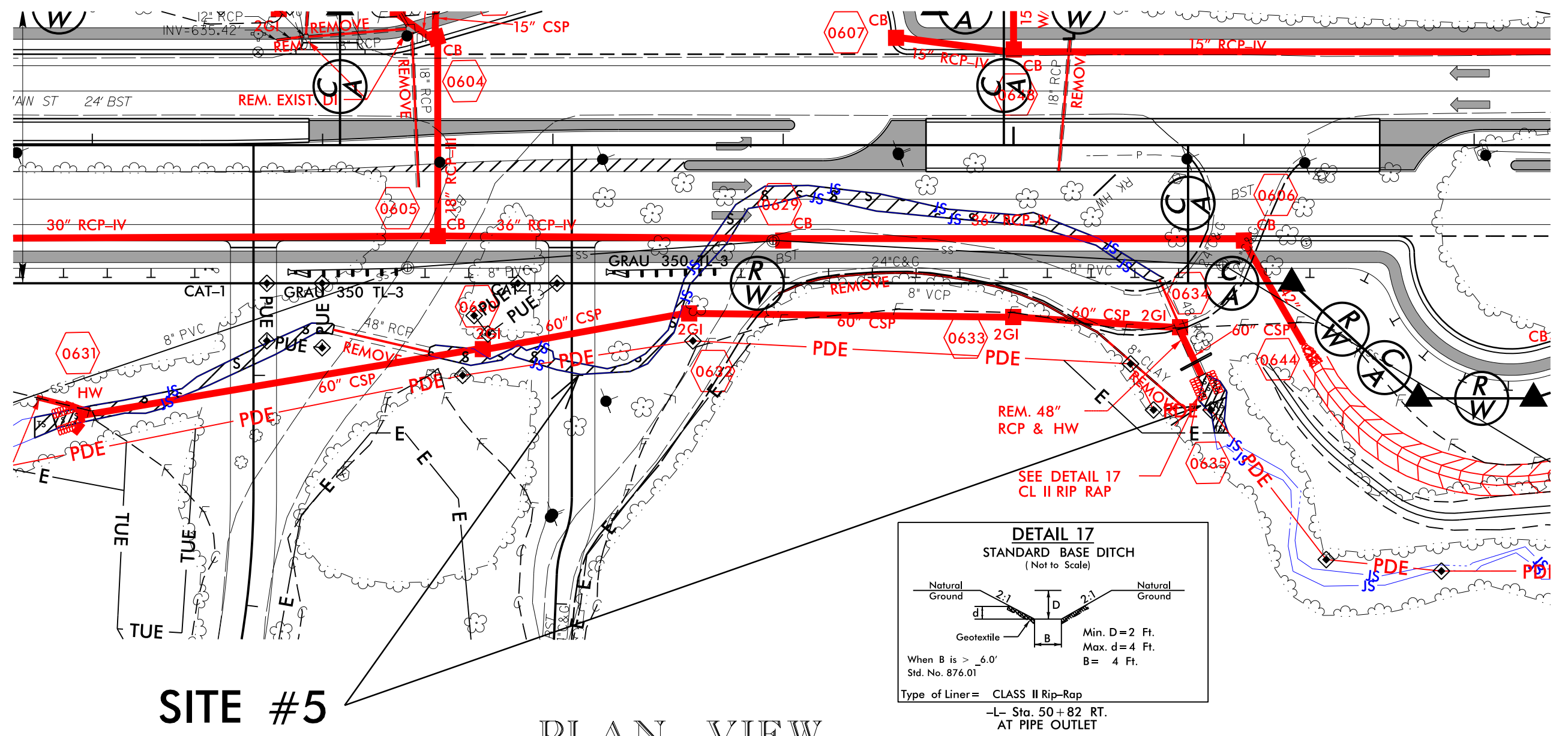

SITE #5

PLAN VIEW
ENLARGEMENT

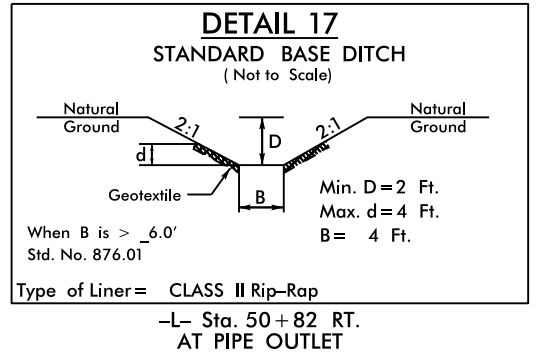

- DENOTES TEMPORARY IMPACTS IN SURFACE WATER
- DENOTES IMPACTS IN SURFACE WATER

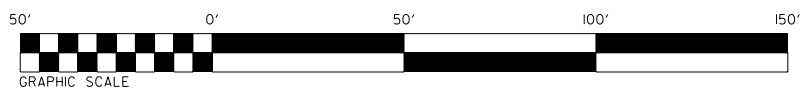

Scale: 1" = 50'

PERMIT DRAWING
SHEET 9 OF 11

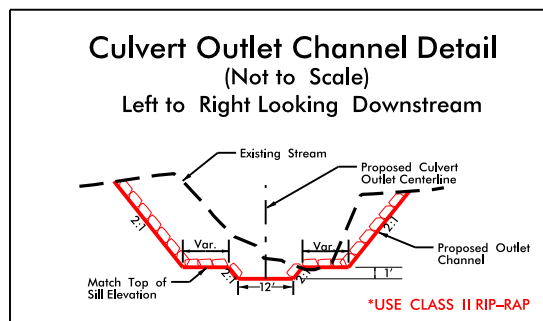

-L- STA. 54+02 RT. AT CULVERT OUTLET

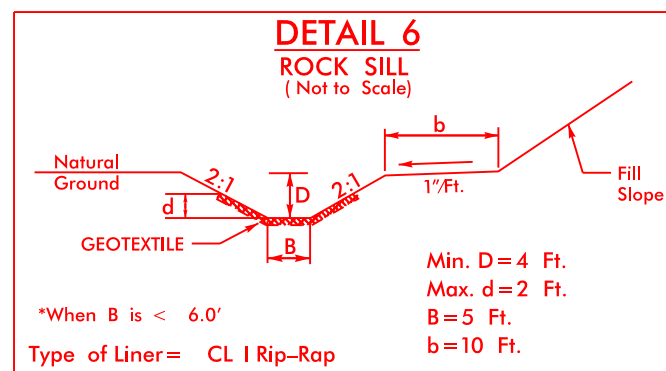
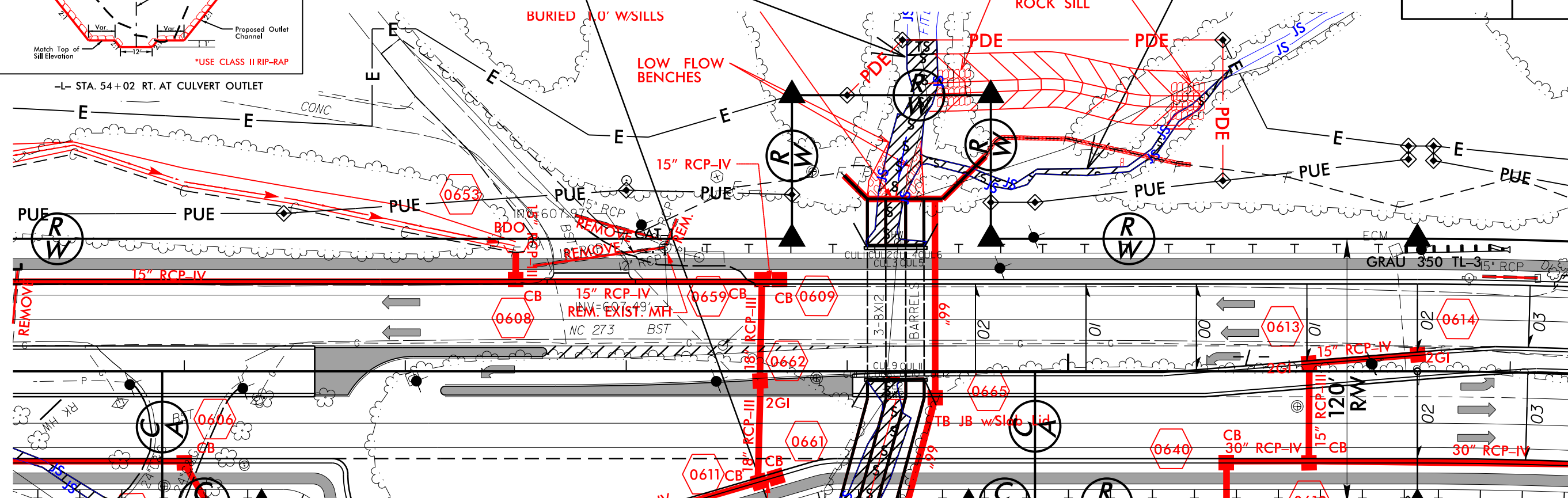

FROM STA. 54+40 LT. TO STA. 54+55 LT.
FROM STA. 55+48 LT. TO STA. 55+63 LT.

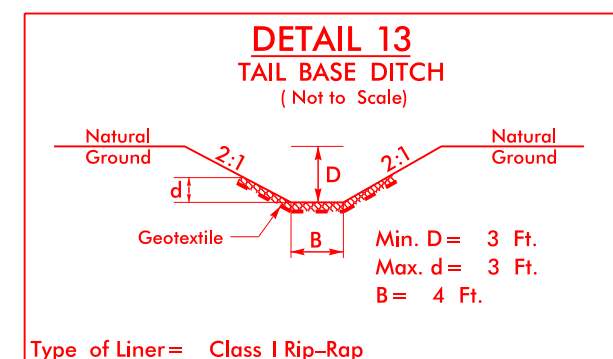
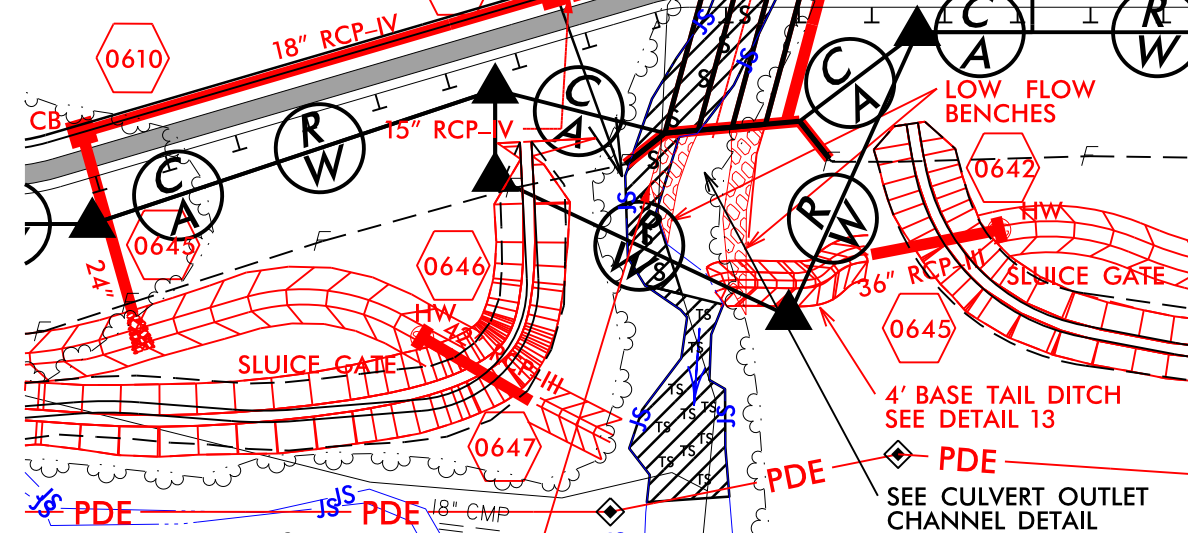

FROM STA. 53+56 RT. TO STA. 53+76 RT.
FROM STA. 54+06 RT. TO STA. 54+31 RT.

PLAN VIEW

ENLARGEMENT

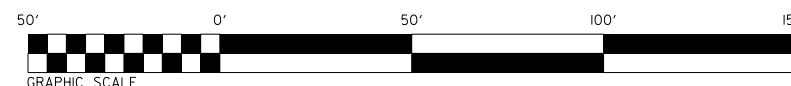

Scale: 1" = 50'

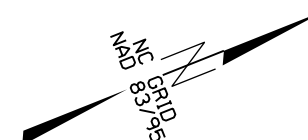

PERMIT DRAWING
SHEET 10 OF 11

WETLAND PERMIT IMPACT SUMMARY												
			WETLAND IMPACTS					SURFACE WATER IMPACTS				
Site No.	Station (From/To)	Structure Size / Type	Permanent Fill In Wetlands (ac)	Temp. Fill In Wetlands (ac)	Excavation in Wetlands (ac)	Mechanized Clearing in Wetlands (ac)	Hand Clearing in Wetlands (ac)	Permanent SW impacts (ac)	Temp. SW impacts (ac)	Existing Channel Impacts Permanent (ft)	Existing Channel Impacts Temp. (ft)	Natural Stream Design (ft)
1	31+77/31+92 LT.-L-	36" Inlet (Stub Out)						<0.01	<0.01	15	9	
1	31+77/31+92 LT.-L-	Bank Stabilization						<0.01		5		
2	34+69/36+12 RT.-L-	36"Pipe/42"Pipe						0.02		188		
3	18+34/18+75 -Y5-	54" Pipe IN/OUT						<0.01	0.01	68	16	
3	18+34/18+75 -Y5-	Bank Stabilization						<0.01		6		
4	13+63 -Y6-	54" Pipe IN/OUT						<0.01	<0.01	7	17	
4	13+63 -Y6-	Bank Stabilization						<0.01		21		
5	45+94/50+65 RT.-L-	60" CSP Pipe						0.06	<0.01	484	23	
5	45+90 & 50+84 RT.-L-	Bank Stabilization						<0.01		24		
6	53+80/54+29 RT.-L-	Culvert Extension						0.04	0.02	134	58	
6	54+08/54+36 LT.-L-	Culvert Extension						0.03	<0.01	89	7	
7	54+54/55+37 LT.-L-	Stream Relocation						0.01	<0.01	148	18	
TOTALS:								0.16	0.03	1189	148	

NOTE: 43' of Site 2 is paved ditch.

NC DEPARTMENT OF TRANSPORTATION
DIVISION OF HIGHWAYS

GASTON COUNTY

WBS - 37649.1.1 (U-3633)

SHEET 11 of 11 8/2/2016

NC DEPARTMENT OF TRANSPORTATION
DIVISION OF HIGHWAYS

GASTON COUNTY

WBS - 37649.1.1 (U-3633)

SHEET 11 of 11 8/2/2016

8/17/99

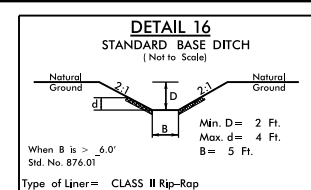
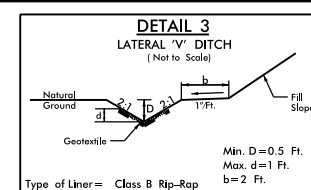
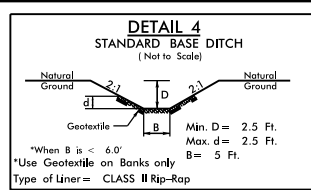

DEBORAH W. ROPER
DB 3896 PG 845

S 23°09'00" W
315.28'

+20.90
30.06'

-Y5- POT Sta. 11+65.00

-Y5-	-Y6-
PI Sta 19+08.42 Δ = 22°04'06.7" (RT) D = 8'48" 53.0" L = 250.36' T = 126.75' R = 650.00' SE = SEE PLANS	PI Sta 12+40.37 Δ = 49°00'33.9" (LT) D = 21'37" 15.8" L = 226.67' T = 120.79' R = 265.00' SE = SEE PLANS

PROJECT REFERENCE NO. **U-3633** SHEET NO. **5**

R/W SHEET NO.

ROADWAY DESIGN ENGINEER

HYDRAULICS ENGINEER

PRELIMINARY PLANS
DO NOT USE FOR CONSTRUCTION

DOCUMENT NOT CONSIDERED FINAL
UNLESS ALL SIGNATURES COMPLETED

HARVEY L. AND CAROL R. THOMAS
DB 4466 PG 2430

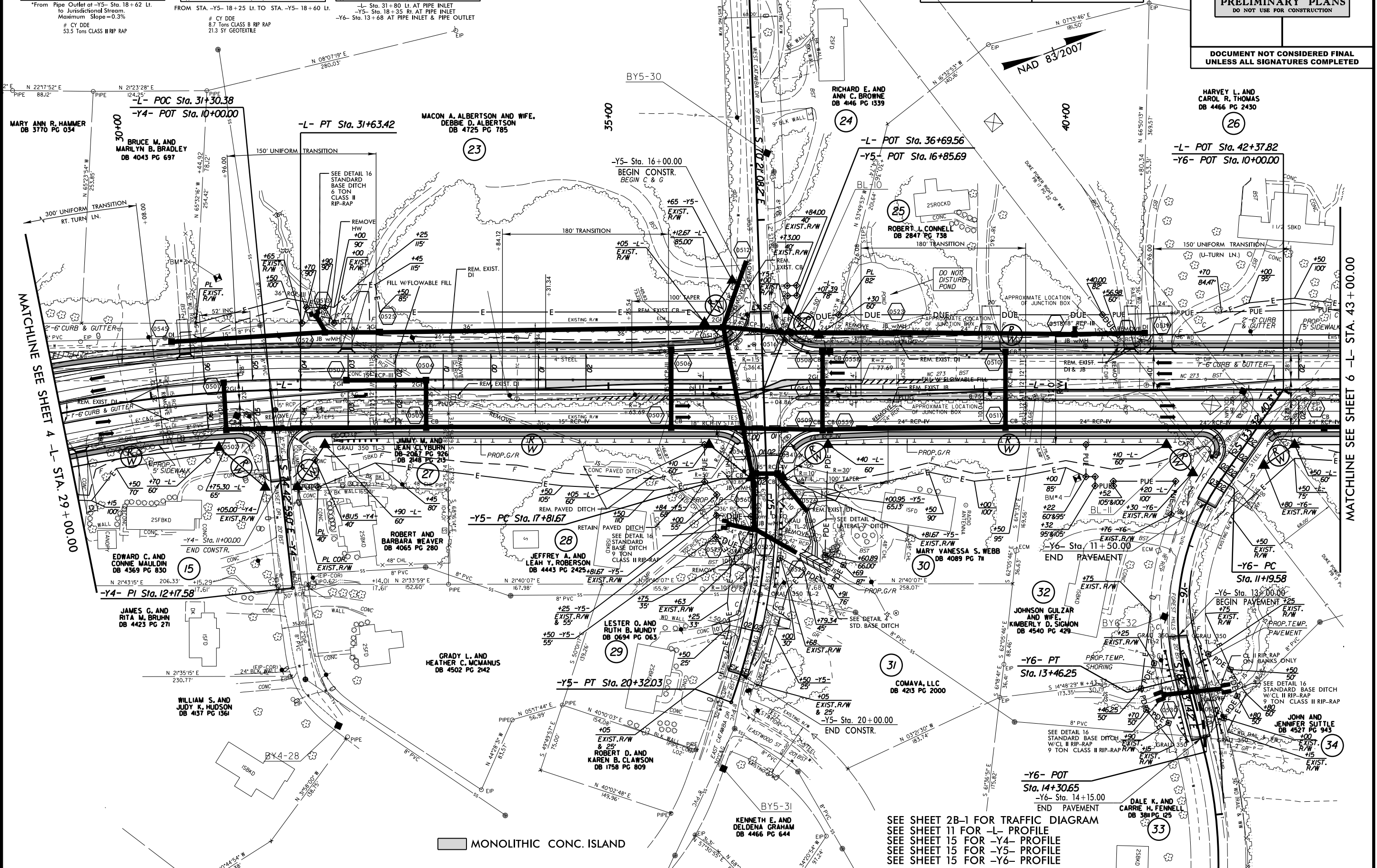

SEE SHEET 2B-1 FOR TRAFFIC DIAGRAM
SEE SHEET 11 FOR -L- PROFILE
SEE SHEET 15 FOR -Y4- PROFILE
SEE SHEET 15 FOR -Y5- PROFILE
SEE SHEET 15 FOR -Y6- PROFILE

REVISIONS

R/W REVISION : ADDED REVISED PUE TO DUE ON PARCEL 28 NE 1/30/15

R/W REVISION : CHANGE OWNER'S NAME FOR PARCEL *23 & *32 NE 8/14/15

R/W REVISION : CONVERTED A PORTION OF THE PROPOSED TCE FOR PARCEL *30 TO A PDE NE 11/3/15

R/W REVISION : CHANGED THE PUE TO DUE FROM -L- STA. 37+07.39 TO 40+40.00 LEFT SKR 8/4/16

19-AUG-2016 08:04
R:\Roadway\proj\U-3633_Rdy\ps15.dgn
\$\$\$\$\$ ISTRANM \$\$\$

SEE SHEET 2B-1 FOR TRAFFIC DIAGRAM
SEE SHEET 12 FOR -L- PROFILE
SEE SHEET 16 FOR -Y7- PROFILE
SEE SHEET 16 FOR -DR1- PROFILE
SEE SHEET 16 FOR -DR2- PROFILE

