

I:\23\2022\pw:\aecom-nc-pw-bentley.com\AECOM_DS21_NA_2020\Document\60646756-1-2513A\900-CAD GIS\910-CAD\70-NCDDT-TIP\Hydraulics\Permits_Envr\omental\AECOM\1-2513_B.C.D\1-2513_C\Drawings\01-2513\09_2021_99

See Sheet 1A For Index of Sheets
See Sheet 1B For Conventional Symbols

STATE OF NORTH CAROLINA DIVISION OF HIGHWAYS

BUNCOMBE COUNTY

**WETLAND AND
SURFACE WATER
IMPACTS PERMIT**
 NOVEMBER 2022

STATE	STATE PROJECT REFERENCE NO.	SHEET NO.	TOTAL SHEETS
N.C.	I-2513C	1	
STATE PROJ. NO.	F.A. PROJ. NO.	DESCRIPTION	
34165.1.2		P.E.	
34165.1.2		R/W	
34165.1.2		UTIL.	
34165.1.2		CONST.	

TIP PROJECT: I-2513C

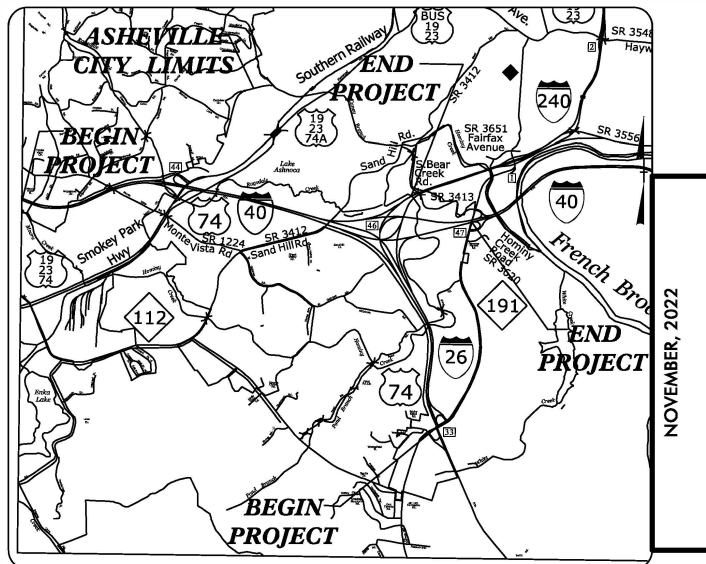

VICINITY MAP

**LOCATION: IMPROVEMENTS AT I-26/I-40-I-240
INTERCHANGE AND US 19/23 (SMOKEY PARK HIGHWAY)**

**TYPE OF WORK: GRADING, DRAINAGE, PAVING,
STRUCTURES, RETAINING WALLS,
SOUND WALLS, SIGNALS, AND SIGNING**

END TIP PROJECT I-2513C
BEGIN TIP PROJECT I-2513AC

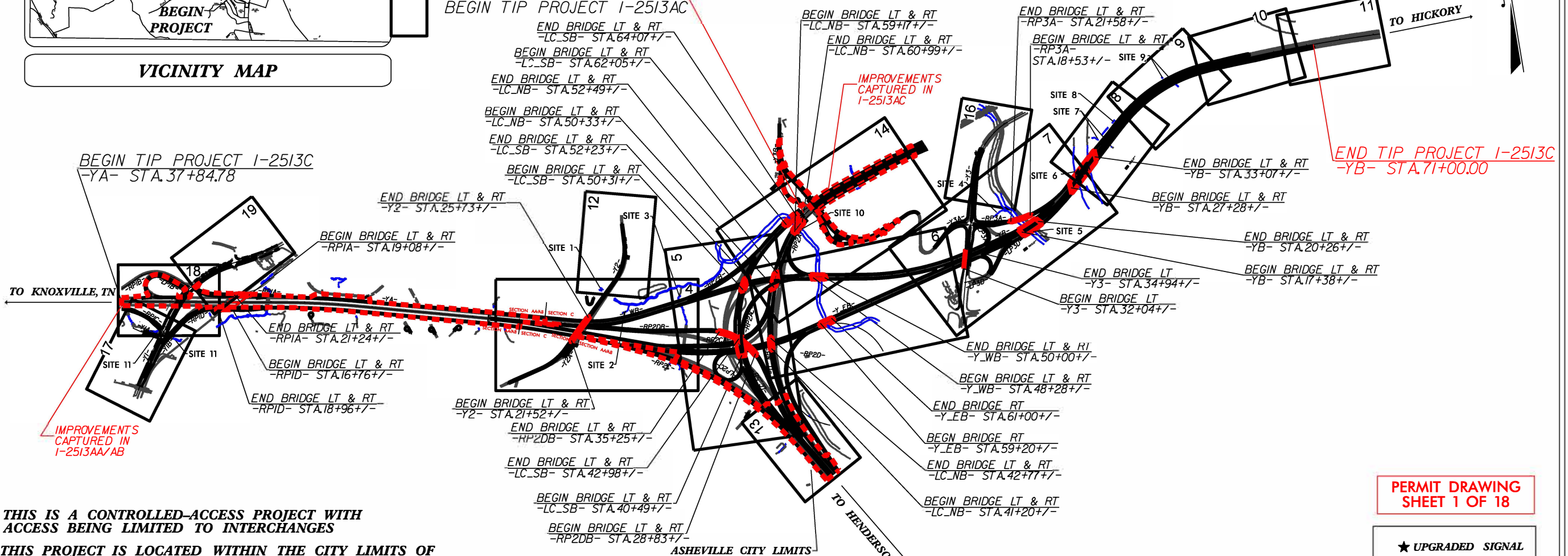

**THIS IS A CONTROLLED-ACCESS PROJECT WITH
ACCESS BEING LIMITED TO INTERCHANGES**

**THIS PROJECT IS LOCATED WITHIN THE CITY LIMITS OF
THE CITY OF ASHEVILLE**

**CLEARING ON THIS PROJECT WILL BE PERFORMED
TO THE LIMITS ESTABLISHED BY METHOD III**

PERMIT DRAWING
SHEET 1 OF 18

★ UPGRADED SIGNAL

**INCOMPLETE PLANS
DO NOT USE FOR R/W ACQUISITION**

 DOCUMENT NOT CONSIDERED FINAL
UNLESS ALL SIGNATURES COMPLETED

CONTRACT:

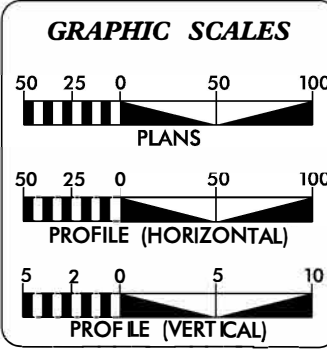

DESIGN DATA

ADT 2024 = NA
ADT 2040 = 101,400
K = 9 %
D = 55 %
T = 10 % *
V = 60 MPH
* TTST = 5% DUAL 5%
FUNC CLASS = INTERSTATE
STATEWIDE TIER

PROJECT LENGTH

LENGTH ROADWAY TIP PROJECT I-2513C =	6.835 MI
LENGTH STRUCTURE TIP PROJECT I-2513C =	0.910 MI
TOTAL LENGTH TIP PROJECT I-2513C =	7.745 MI

AECOM

NC FIRM LICENSE No: F-0342
 5438 Wade Park Blvd., Suite 200
 Raleigh, NC 27607
 (919) 854-6200 - (919) 854-6259(FAX)

2018 STANDARD SPECIFICATIONS RIGHT OF WAY DATE: OCTOBER 2023 LETTING DATE: OCTOBER 2023	<table style="width: 100%; border-collapse: collapse;"> <tr> <td style="border-bottom: 1px solid black; text-align: center;">PROJECT ENGINEER</td> </tr> <tr> <td style="border-bottom: 1px solid black; text-align: center;">PROJECT DESIGN ENGINEER</td> </tr> <tr> <td style="text-align: center;"> KEVIN E. MOORE, P.E. <small>NGDOT CONTACT</small> </td> </tr> </table>	PROJECT ENGINEER	PROJECT DESIGN ENGINEER	KEVIN E. MOORE, P.E. <small>NGDOT CONTACT</small>
PROJECT ENGINEER				
PROJECT DESIGN ENGINEER				
KEVIN E. MOORE, P.E. <small>NGDOT CONTACT</small>				

HYDRAULICS ENGINEER

SIGNATURE: _____ P.E.

ROADWAY DESIGN ENGINEER

SIGNATURE: _____ P.E.

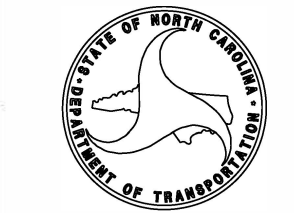

PROJECT REFERENCE NO. 1-2513C	SHEET NO. 4
RW SHEET NO.	
ROADWAY DESIGN ENGINEER	HYDRAULICS ENGINEER
INCOMPLETE PLANS DO NOT USE FOR R/W ACQUISITION	
DOCUMENT NOT CONSIDERED FINAL UNLESS ALL SIGNATURES COMPLETED	
Prepared in the Office of: AECOM	NC FIRM LICENSE No: F-0342 5438 Wood Park Boulevard Suite 200 Raleigh, NC 27607 (919) 854-6200 • (919) 854-6259 FAX

SITE 1

SURFACE WATER IMPACTS

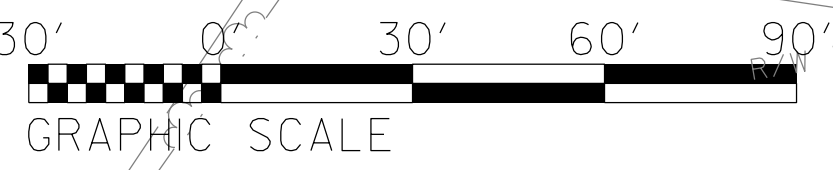
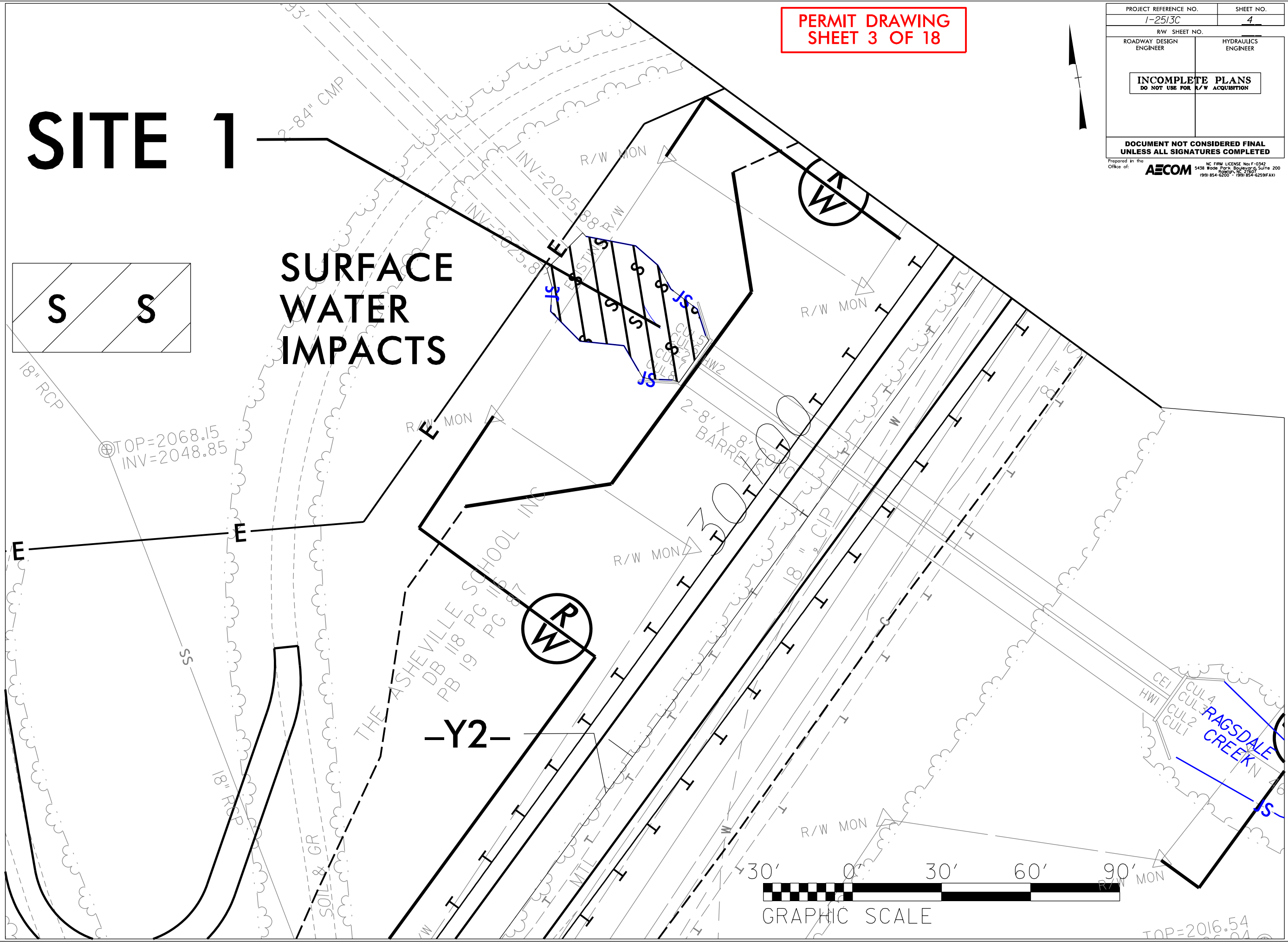
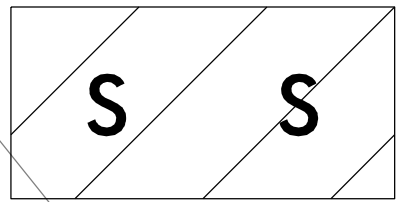

TOP=2016.54

PERMIT DRAWING
SHEET 5 OF 18

SITE 3



PROJECT REFERENCE NO. 1-2513C	SHEET NO. 4
R/W SHEET NO.	
ROADWAY DESIGN ENGINEER	HYDRAULICS ENGINEER
INCOMPLETE PLANS DO NOT USE FOR R/W ACQUISITION	
DOCUMENT NOT CONSIDERED FINAL UNLESS ALL SIGNATURES COMPLETED	
Prepared in the Office of:	NC FIRM LICENSE No: F-0342 5438 Wade Park Boulevard, Suite 200 Raleigh, NC 27617 (919) 854-6200 • (919) 854-6259 FAX

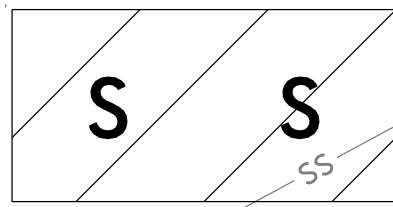

SURFACE WATER IMPACTS

GREEN EARTH DEVELOPMENTS LLC
DB 4973 PG 806

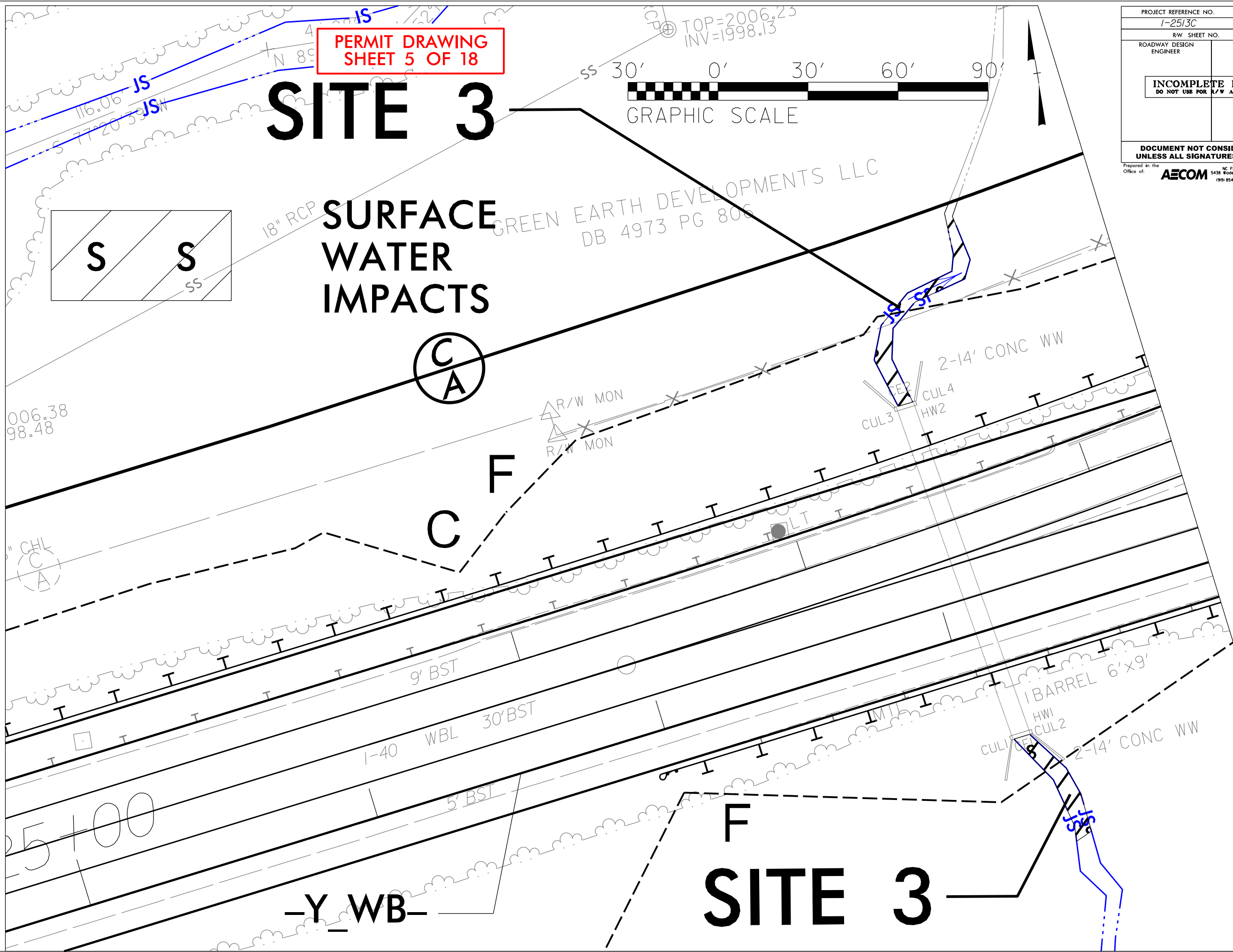

SITE 3

REVISIONS

PERMIT DRAWING SHEET 7 OF 18

PROJECT REFERENCE NO. 7-2513C	SHEET NO. 7
REV. SHEET NO. ROADWAY DESIGN ENGINEER	ISSUES ENGINEER
INCOMPLETE PLANS DO NOT BE FOR PERMITS OR FOR CONSTRUCTION	
DOCUMENT NOT CONSIDERED FINAL UNLESS ALL SIGNATURES COMPLETED	
AECOM	

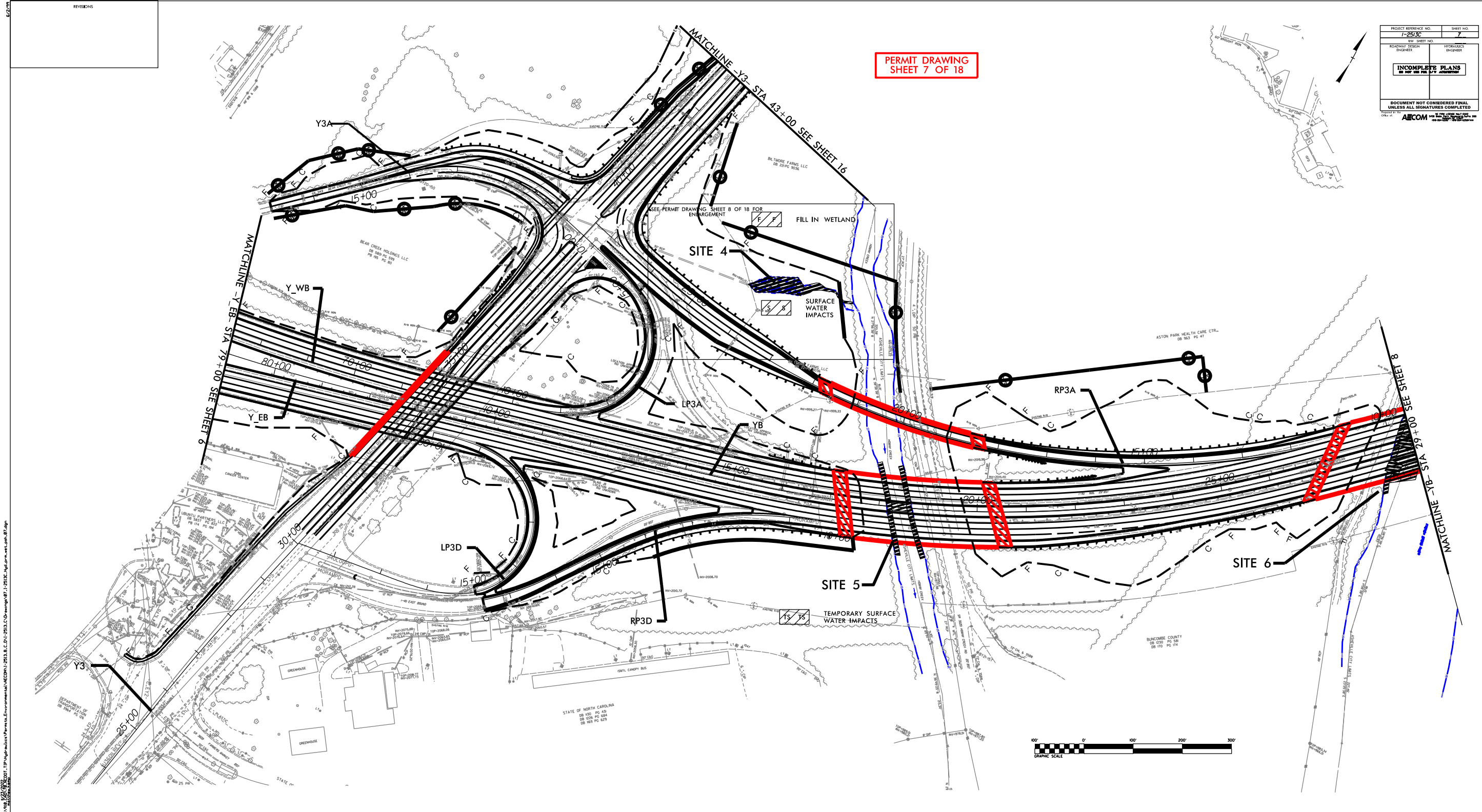

I:\Projects\2015\201511\7-2513C\Drawings\7-2513C-P\7-2513C-Roadway\7-2513C-Roadway-Permit\7-2513C-Roadway-Permit-07.dwg
 DATE: 2015.11.11 AM 9:59:10
 USER: jgibson

PERMIT DRAWING
SHEET 8 OF 18

PROJECT REFERENCE NO. 1-2513C	SHEET NO. 7
ROADWAY DESIGN ENGINEER	HYDRAULICS ENGINEER
INCOMPLETE PLANS DO NOT USE FOR A/W ACQUISITION	
DOCUMENT NOT CONSIDERED FINAL UNLESS ALL SIGNATURES COMPLETED	
Prepared in the Office of: AECOM	NC FIRM LICENSE No. F-0342 5438 Rode Park Boulevard, Suite 200 Raleigh, NC 27617 (919) 854-6200 / (919) 854-6259 FAX

SITE 4

FILL IN WETLAND

SURFACE WATER IMPACTS

-RP3A-

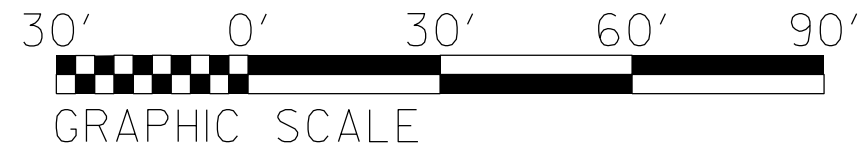
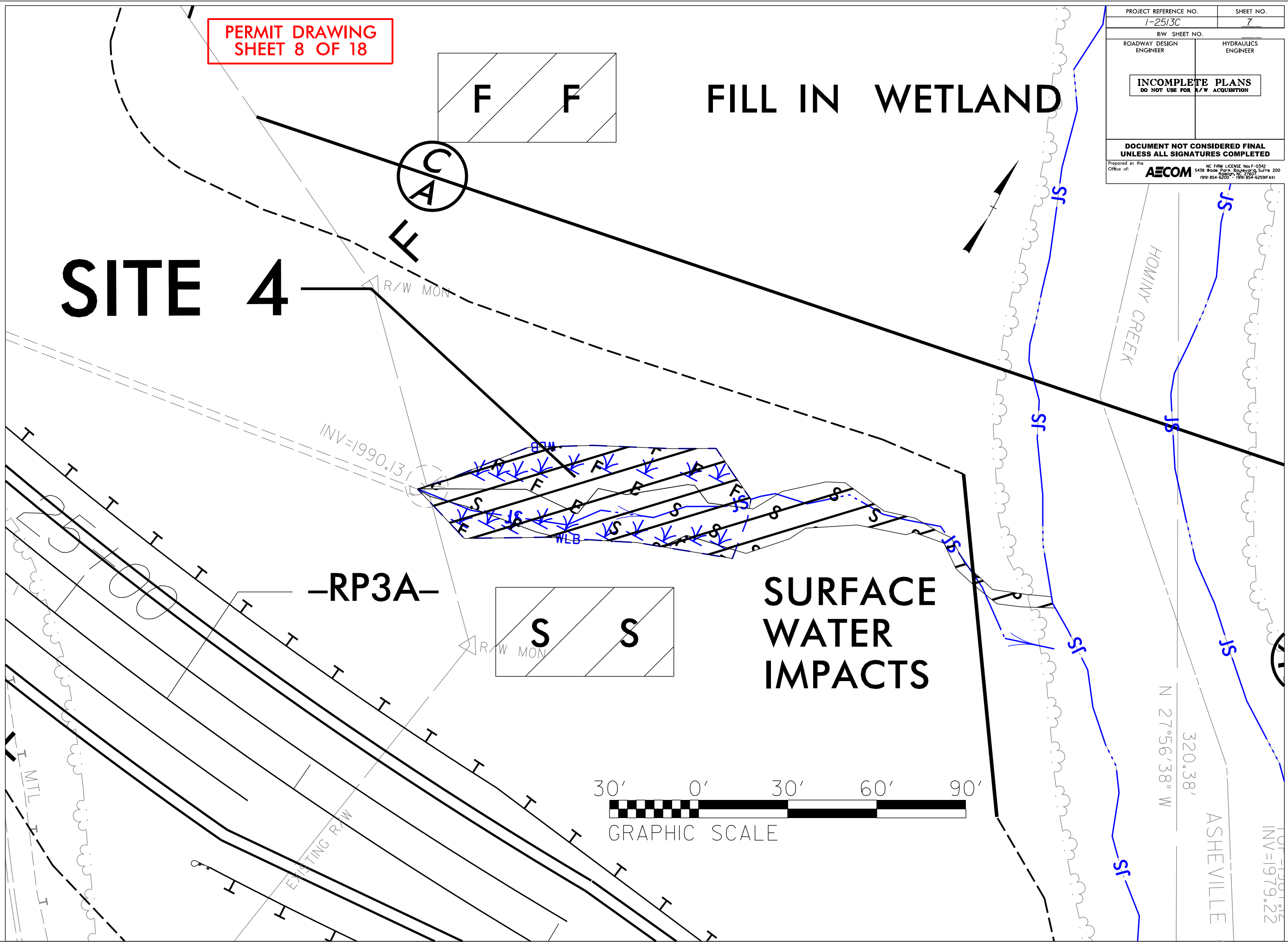
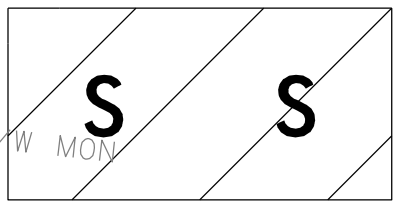
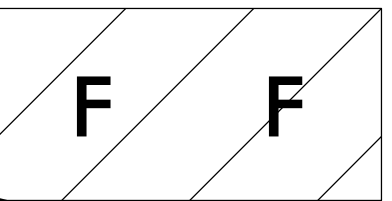

N 27°56'38" W
320.38'
ASHEVILLE
INV=1979.22

REVISIONS

--	--

PROJECT REFERENCE NO. 7-2513	SHEET NO. 7
REV. SHEET NO.	PROFESSIONAL ENGINEER
ROADWAY DESIGN ENGINEER	PROFESSIONAL ENGINEER
INCOMPLETE PLANS <small>DO NOT USE FOR CONSTRUCTION</small>	
<small>DOCUMENT NOT CONSIDERED FINAL UNLESS ALL SIGNATURES COMPLETED</small>	

PERMIT DRAWING
SHEET 9 OF 18

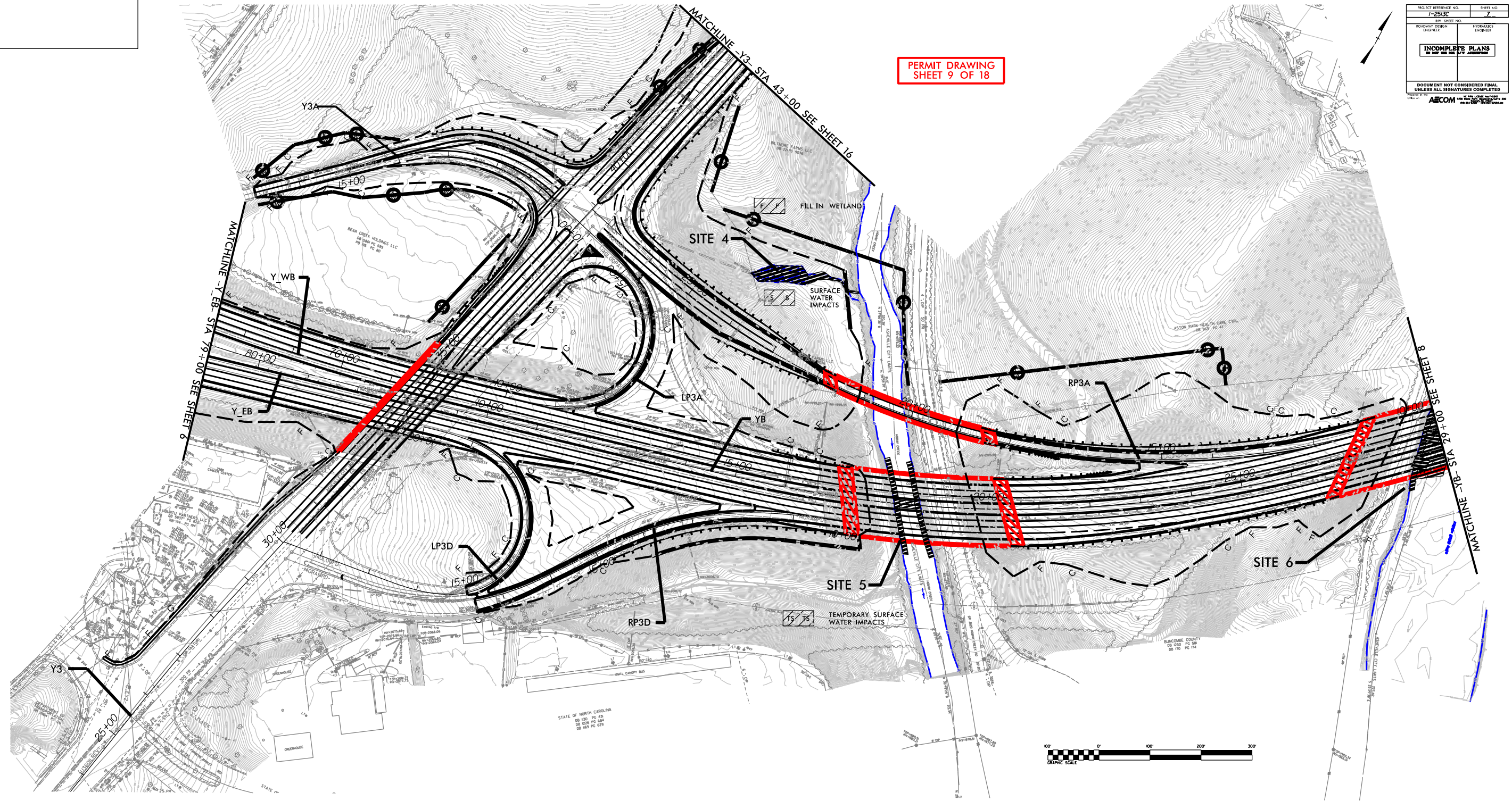

C:\Users\jdm\OneDrive\Documents\08864796-1\2024\WB-CAD\018\WB-CAD\018-WB-CAD.dwg 11/25/24 11:05 AM 11/25/24 11:05 AM

6/2/99
D:\GIS\910\1023\922\CDOT - TIP\Hydraulics\Permits\Environment\1-2513C-D\Drawings\10-1-2513C-Hyd_prm_wet.psh_08.dgn
10/23/2008
matthew.kemp

REVISIONS

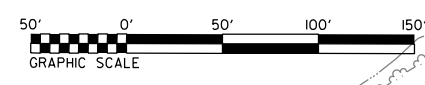

**PERMIT DRAWING
SHEET 10 OF 18**

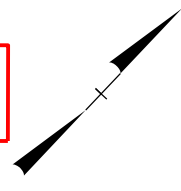

PROJECT REFERENCE NO. 1-2513C	SHEET NO. 8
RW SHEET NO.	
ROADWAY DESIGN ENGINEER	HYDRAULICS ENGINEER
INCOMPLETE PLANS DO NOT USE FOR R/W ACQUISITION	



**DOCUMENT NOT CONSIDERED FINAL
UNLESS ALL SIGNATURES COMPLETED**

Prepared in the Office of: **AECOM**
NC FIRM LICENSE No. F-0342
5438 Rode Park Boulevard, Suite 200
Raleigh, NC 27607
(919) 854-6200 • (919) 854-6259 (Fax)

MATCHLINE -YB- STA 29+00 SEE SHEET 7

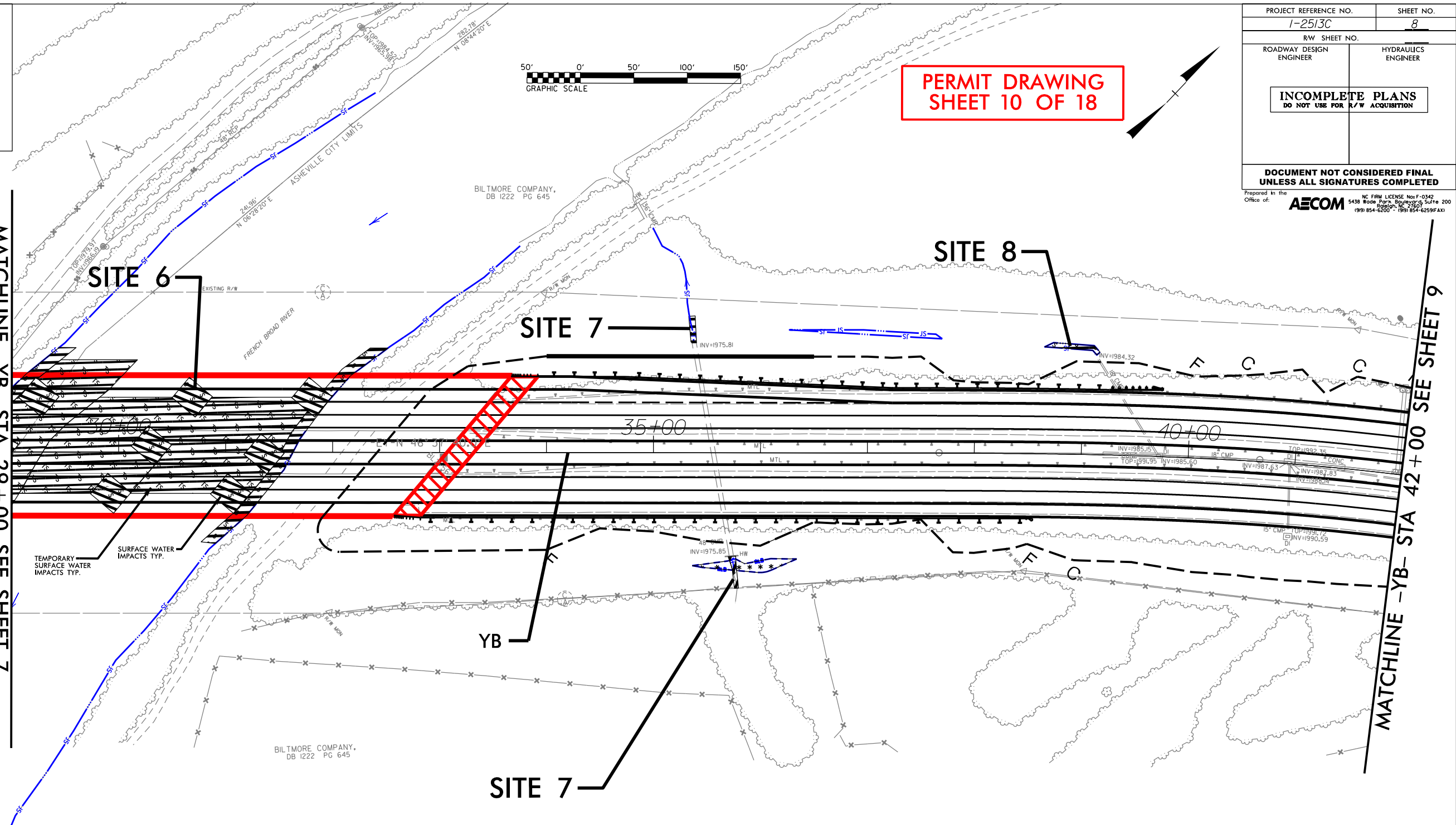
MATCHLINE -YB- STA 42+00 SEE SHEET 9

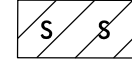
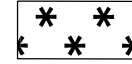

-  SURFACE WATER IMPACTS
-  MECHANIZED CLEARING (GRUBBING)
-  TEMPORARY SURFACE WATER IMPACTS

6/27/99

REVISIONS

PROJECT REFERENCE NO. 1-2513C	SHEET NO. 8
RW SHEET NO.	
ROADWAY DESIGN ENGINEER	HYDRAULICS ENGINEER
INCOMPLETE PLANS DO NOT USE FOR R/W ACQUISITION	

DOCUMENT NOT CONSIDERED FINAL UNLESS ALL SIGNATURES COMPLETED

Prepared in the Office of: **AECOM** NC FIRM LICENSE No. F-0342
5438 Rode Park Boulevard, Suite 200, Raleigh, NC 27607
(919) 854-6200 • (919) 854-6259 (FAX)

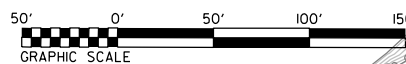



PERMIT DRAWING SHEET 11 OF 18

MATCHLINE -YB- STA 29+00 SEE SHEET 7

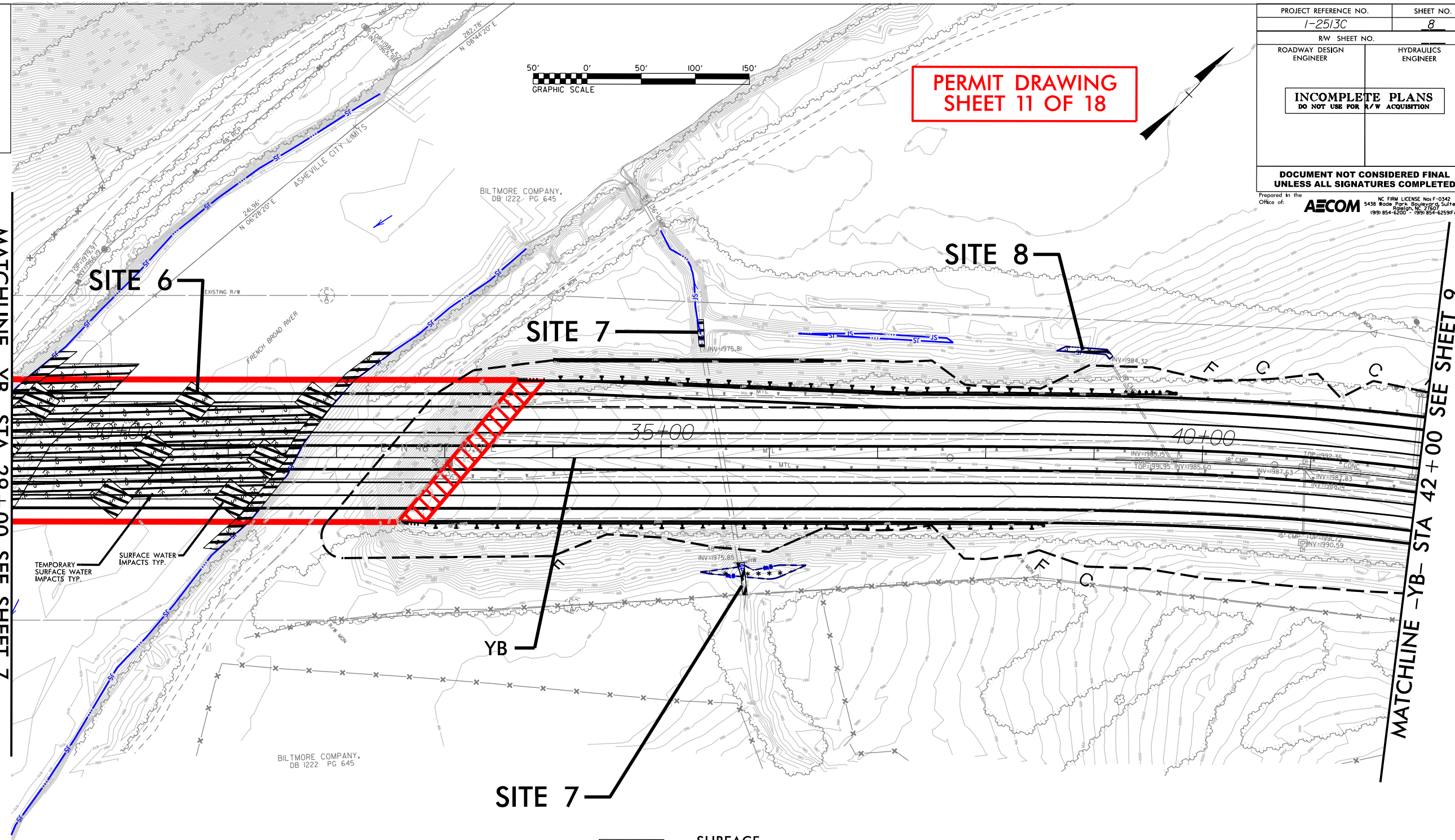
MATCHLINE -YB- STA 42+00 SEE SHEET 9

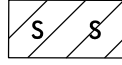

-  SURFACE WATER IMPACTS
-  MECHANIZED CLEARING (GRUBBING)
-  TEMPORARY SURFACE WATER IMPACTS

GIS\910_CAD\001_TIP_Hydraulics\Permits_Environment\AECOM\1-2513.B.C.D\1-2513.C\Drawings\1-2513C_Hyd_prm_wet_psh_08_con.dgn

6/2/99
I:\23\23022\GIS\910\AECOM\1-2513C\Drawings\1-2513C\DWG\1-2513C_Hyd_prm_wet_psh_09.dgn
11/23/2007 10:40:20 AM
C:\Users\matthew.kemp

REVISIONS

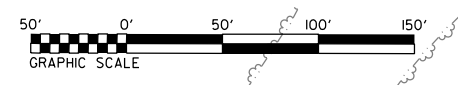

**PERMIT DRAWING
SHEET 12 OF 18**

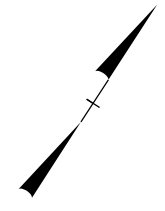

PROJECT REFERENCE NO. 1-2513C	SHEET NO. 9
RW SHEET NO.	
ROADWAY DESIGN ENGINEER	HYDRAULICS ENGINEER
INCOMPLETE PLANS DO NOT USE FOR R/W ACQUISITION	
DOCUMENT NOT CONSIDERED FINAL UNLESS ALL SIGNATURES COMPLETED	
Prepared in the Office of: AECOM	NC FIRM LICENSE No. F-0342 5438 Rode Park Boulevard, Suite 200 Raleigh, NC 27607 (919) 854-6200 • (919) 854-6259 (fax)

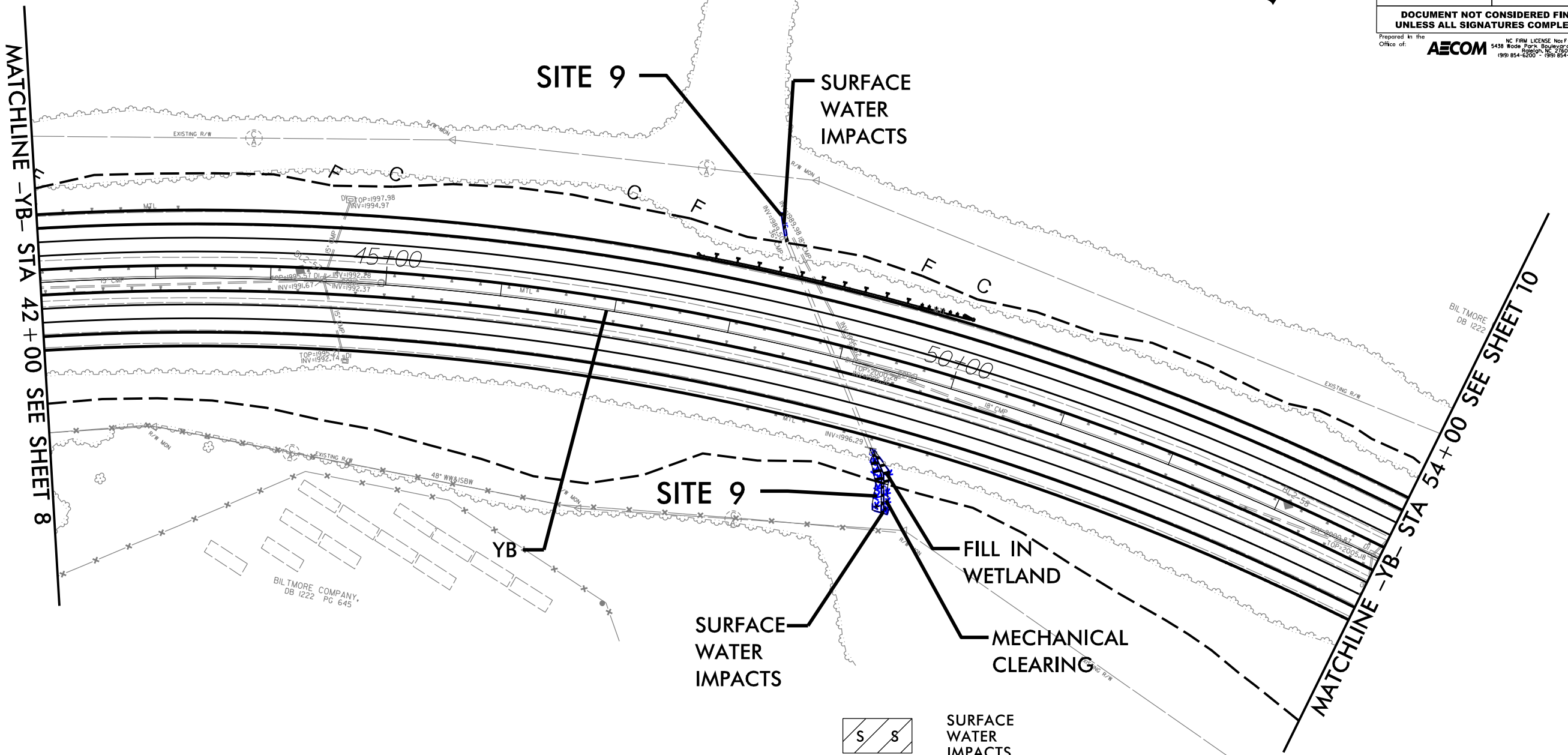

- SURFACE WATER IMPACTS
- FILL IN WETLAND
- MECHANICAL CLEARING (GRUBBING)

6/2/99

REVISIONS

PROJECT REFERENCE NO. 1-2513C	SHEET NO. 9
RW SHEET NO.	
ROADWAY DESIGN ENGINEER	HYDRAULICS ENGINEER
INCOMPLETE PLANS DO NOT USE FOR R/W ACQUISITION	

DOCUMENT NOT CONSIDERED FINAL UNLESS ALL SIGNATURES COMPLETED

Prepared in the Office of: **AECOM**

NC FIRM LICENSE No. F-0342
5438 Rode Park Boulevard, Suite 200
Raleigh, NC 27607
(919) 854-6200 • (919) 854-6259 (Fax)

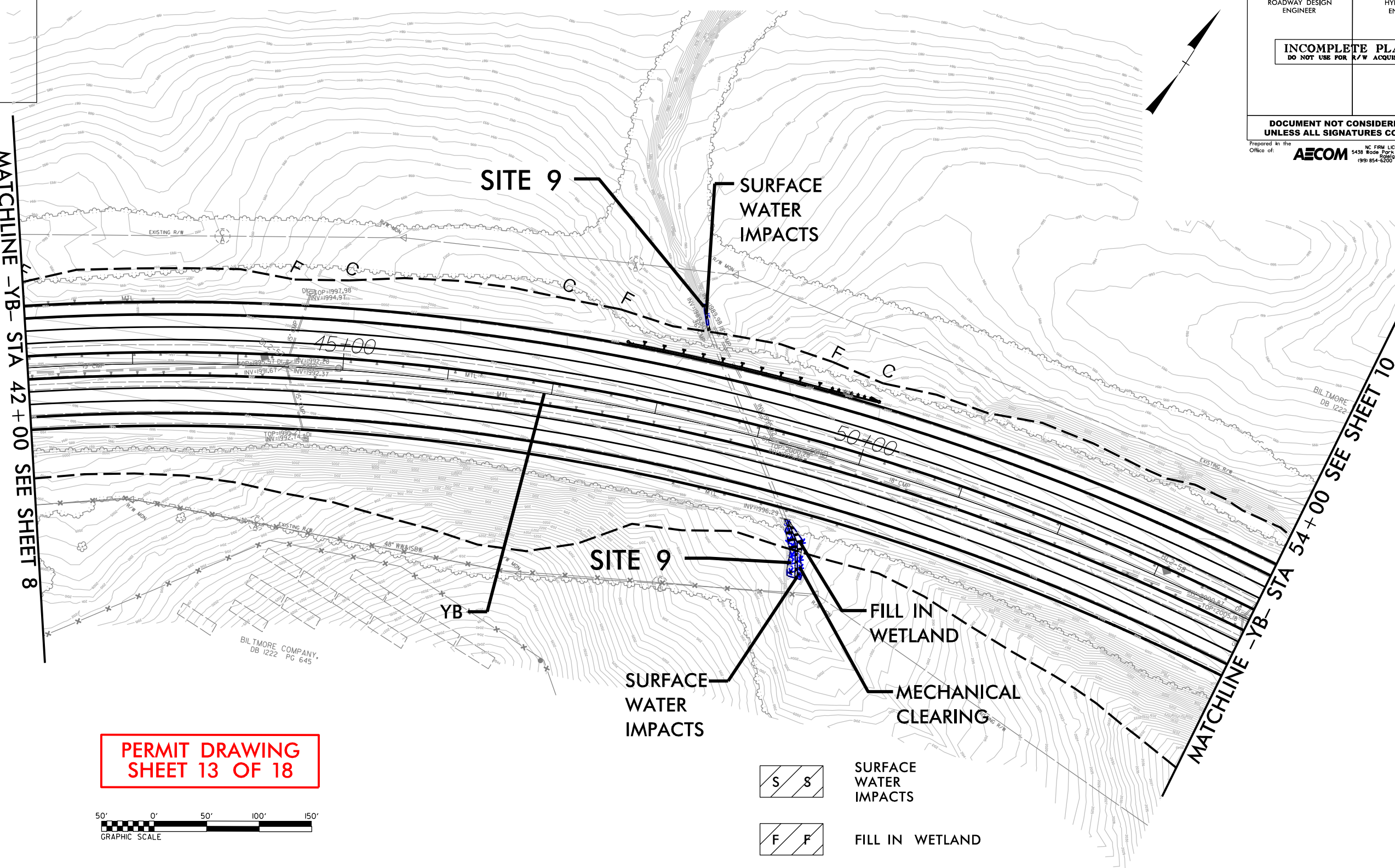

MATCHLINE -YB- STA 42+00 SEE SHEET 8

MATCHLINE -YB- STA 54+00 SEE SHEET 10



PERMIT DRAWING SHEET 13 OF 18

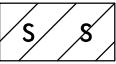

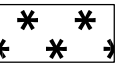
-  SURFACE WATER IMPACTS
-  FILL IN WETLAND
-  MECHANIZED CLEARING (GRUBBING)

GIS\910_CAD\2000\TIP_Hydraulics\Permits_Environmental\AECOM\1-2513.B.C.D\1-2513.C\Drawings\13.I-2513C_Hyd.prm.wet.psh_09_con.dgn

6/2/2/99

REVISIONS

PROJECT REFERENCE NO. 1-2513C		SHEET NO. 17	
ROADWAY DESIGN ENGINEER		HYDRAULICS ENGINEER	
INCOMPLETE PLANS DO NOT USE FOR R/W ACQUISITION			
DOCUMENT NOT CONSIDERED FINAL UNLESS ALL SIGNATURES COMPLETED			
Prepared in the Office of:		AECOM	
		NC FIRM LICENSE No. F-0342 5438 Rode Park Boulevard, Suite 200 Raleigh, NC 27607 (919) 854-6200 • (919) 854-6259 (fax)	

PERMIT DRAWING SHEET 17 OF 18

MATCHLINE -RPIC-
STA 19+00 -
SEE SHEET 18

MATCHLINE -Y1-
STA 22+00
SEE SHEET 18

MATCHLINE -RPID-
STA 24+00
SEE SHEET 18

GIS\9101_CAD\91010001_TIP\Hydraulics\Permits\Environmental\AECOM\1-2513.B.C.D\1-2513.C.D-rwings\17-1-2513C-Hyd-prm-wet-phs.17.com.dgn

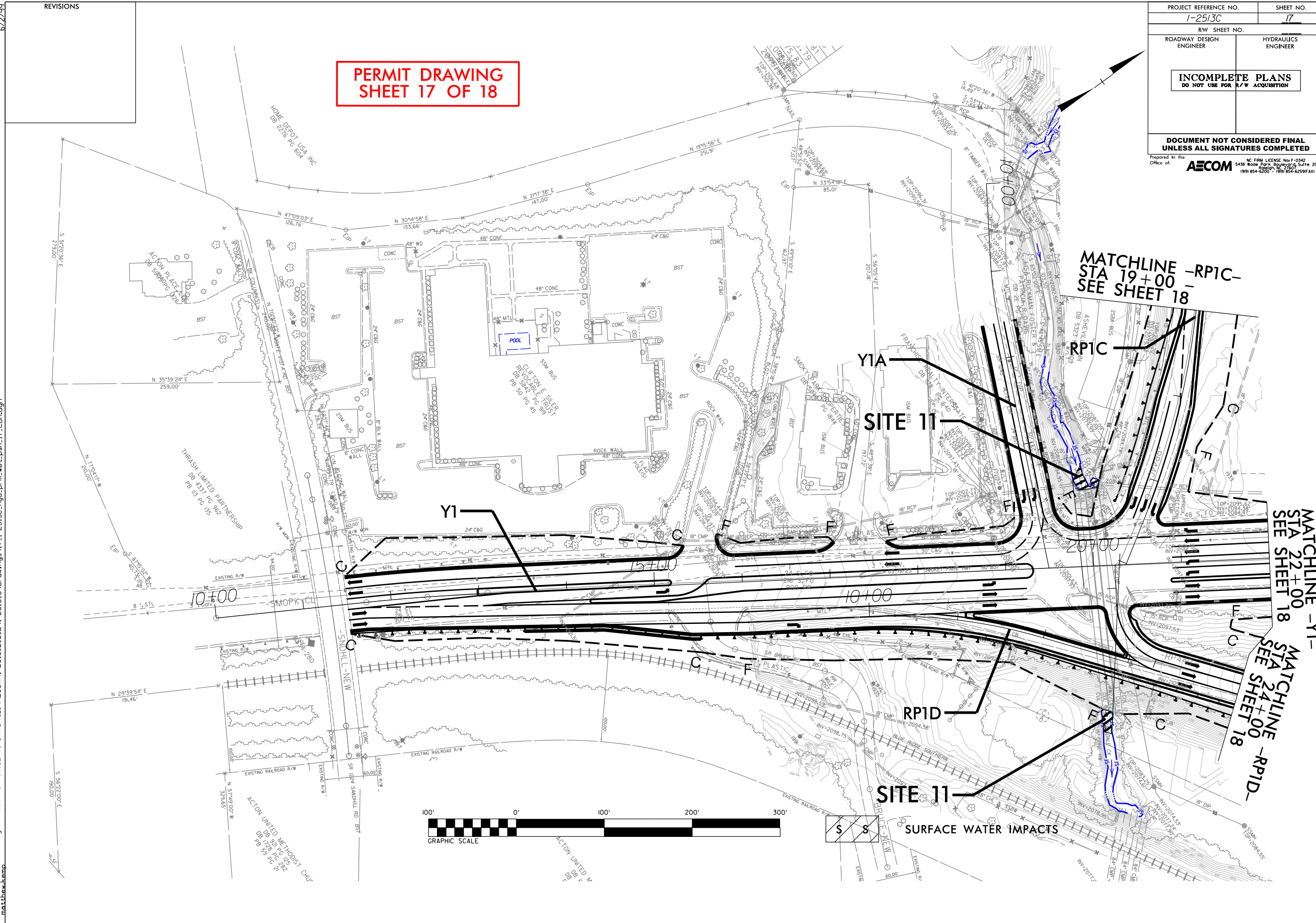

WETLAND AND SURFACE WATER IMPACTS SUMMARY

Site No.	Station (From/To)	Structure Size / Type	WETLAND IMPACTS					SURFACE WATER IMPACTS					
			Permanent Fill In Wetlands (ac)	Temp. Fill In Wetlands (ac)	Excavation in Wetlands (ac)	Mechanized Clearing in Wetlands (ac)	Hand Clearing in Wetlands (ac)	Permanent SW impacts (ac)	Temp. SW impacts (ac)	Existing Channel Impacts Permanent (ft)	Existing Channel Impacts Temp. (ft)	Natural Stream Design (ft)	
1	-Y2- Sta. 30+03 to 30+40 LT	Pipe / culvert							0.04		57		
2	-Y- WB Sta. 19+37 to 20+40	Pipe / culvert							0.02		112		
3	-Y- WB Sta. 28+02 RT to Sta. 28+45 RT/LT	Pipe / culvert							0.01		123		
4	-RP3A- Sta.21+99 to Sta. 24+24 RT	Pipe / culvert	0.04						0.05		232		
5	-YB- Sta. 17+91 to Sta. 19+01 RT/LT	Temp. Causeways**								0.02		16	
		Bank Stabilization										193	
6	-YB- Sta. 28+14 to Sta. 32+52 RT/LT	Temp Causeways**								0.84		315	
		Pier Impacts **							0.15				
		Bank Stabilization										426	
7	-YB- Sta. 35+33 to Sta. 36+34 RT/LT	Pipe / culvert				0.01			< 0.01		56		
8	-YB- Sta 38+64 to Sta. 39+15 LT	Pipe / culvert							< 0.01		48		
9	-Y2- Sta 48+32 to Sta. 49+77 RT/LT	Pipe / culvert	< 0.01			< 0.01			< 0.01		83		
10	-LC_NB- Sta. 59+62 to Sta. 63+41 RT/LT	Bank Stabilization									299		
11	-Y1- Sta. 19+87 to Sta. 20+30 RT/LT	Pipe / culvert							0.01		56		
TOTALS*:			0.05			0.02			0.30	0.86	1685	331	

*Rounded totals are sum of actual impacts

NOTES:

Pier Impacts and Bank Stabilization are not considered loss of water impacts.

** Impact numbers calculated in the 2019 document "I-26 Connector Bridge Construction and Demolition"

NC DEPARTMENT OF TRANSPORTATION
 DIVISION OF HIGHWAYS
 11/21/2022
 Buncombe
 I-2513C
 34165.1..2
 SHEET 18 OF 18