



STATE OF NORTH CAROLINA
DEPARTMENT OF TRANSPORTATION

JOSH STEIN
GOVERNOR

DANIEL H. JOHNSON
SECRETARY

February 12, 2026

MEMORANDUM TO: Division Environmental and Construction Units

FROM:  Michael A. Turchy, ECAP Group Leader
Environmental Analysis Unit

SUBJECT: Environmental Permits for the Replacement of:
Replacement of Bridge 132 over Ivy Creek on SR 2150 (Hobson Branch Road)
in Buncombe County, Division 13, WBS DF18313.2011366.PR

Please find enclosed the following permits for this project:

Agency	Permit Type	Expiration
US Army Corps of Engineers Section 404 Clean Water Act Permit	Nationwide Permit 3 Action ID: SAW-1994-04102 Dated February 12, 2026	March 14, 2026*
NC Division of Water Resources Section 401 Water Quality Certification	Individual Water Quality Certification ID: 20251669 Dated December 17, 2025	expires with above Permit

Work is authorized by the above-referenced documents and must be accomplished in strict accordance with the permitted plans.

The Environmental Coordination and Permitting Group (ECAP) or the Division Environmental Office must be consulted if any deviation from the permit(s) or accompanying drawings is required.

*All 404 Nationwide Permits expire on March 14, 2026. Since new Nationwide Permits are not issued until the previous set expires, a one-year period exists between March 14, 2026, and March 14, 2027 to complete construction, or renew the permit under the new Nationwide Permit.

ECAP will coordinate with Division Environmental Staff to determine project completion timelines and initiate the renewal process, if necessary.

404 Permit (USACE)



DEPARTMENT OF THE ARMY
U.S. ARMY CORPS OF ENGINEERS, WILMINGTON DISTRICT
151 Patton Avenue, Room 208
Asheville, NC 28801-5006

February 12, 2026

Regulatory Division
SAW-1994-04102

North Carolina Department of Transportation
Attn: Mr. Michael A. Turchy
Environmental Coordination and Permitting Group Leader
1598 Mail Service Center
Raleigh, North Carolina 27699-1598
Sent Via Email: maturchy@ncdot.gov

Dear Mr. Turchy,

This letter is in response to the application you submitted to the U.S. Army Corps of Engineers (USACE), Wilmington District, WRDA/Transportation Branch on December 10, 2025, for a Department of the Army general permit verification to replace a bridge that was destroyed by **Hurricane Helene**. This project will replace **Bridge No. 132** over Ivy Creek on SR 2150 in Buncombe County, North Carolina (35.7897, -82.5338) and has been assigned file number SAW-1994-04102. In order to perform this work, NCDOT proposes to conduct the following activities in waters of the U.S.:

Summary of Proposed Impacts

Impact ID #	NWP / GP #	Open Water (ac)		Wetland (ac)		Stream (lf)	
		Temporary	Permanent	Temporary	Permanent	Temporary	Permanent
Site 1 (Ivy Creek)	<u>NWP 3</u>					65' / dewatering	59' / bank stabilization
						71' / work pads	
Impact Totals		0	0	0	0	136'	59'
Total Loss of waters of the U.S. (wetlands and/or open waters)			0	Total Loss of waters of the U.S.			0

We have reviewed the proposed activities in waters of the U.S. and have determined that these activities are authorized by Nationwide Permit (NWP) 3 pursuant to authorities under Section 404 of the Clean Water Act (33 U.S.C § 1344). The proposed work must be accomplished in strict accordance with the following:

- enclosed terms, general conditions, and regional conditions of NWP 3
- special conditions of the verification letter (see below)
- information in the PCN and attachments
- enclosed plans

If the extent of the project area and/or nature of the authorized impacts to waters are modified, a request detailing the proposed changes must be submitted to this office for written approval before work is initiated. Any deviation from the terms and conditions of the permit, the special conditions of this letter, the information contained in the PCN, or your submitted plans, may subject the permittee to enforcement action.

This verification is valid until **March 14, 2026**, unless the subject NWP is suspended, revoked, or is modified prior to that date such that the activity no longer complies with the terms and conditions of the NWP.

Project Specific Special Conditions:

1. This verification letter does not authorize you to take a federally listed species. In order to legally take a federally listed species, you must have separate authorization under the Endangered Species Act (ESA) (e.g., an ESA Section 10 permit, or a Biological Opinion (BO) under ESA Section 7, with “incidental take” provisions with which you must comply). The U.S. Fish and Wildlife Service (USFWS) issued a document titled, “Biological and Conference Opinions and Informal Consultations – Batch Format, Replace Multiple Crossing Structures Destroyed by Tropical Storm Helene in Buncombe, Madison, McDowell, Mitchell, and Yancey Counties, North Carolina, Service Log #25-276 through 25-299” on September 4, 2025. This document contains mandatory terms and conditions to implement the reasonable and prudent measures that are associated with incidental take for this project. Your authorization under this verification letter and NWP 3 is conditional upon your compliance with the mandatory terms and conditions associated with incidental take listed in this document for this project. Failure to comply with the terms and conditions associated with incidental take detailed in this document, where a take of a federally listed species occurs, would constitute an unauthorized take, and it would also constitute non-compliance with your verification letter and NWP 3. The USFWS is the appropriate authority to determine compliance with the terms and conditions of its Opinion and with the ESA.

2. The permittee shall ensure that no more than 50% of the stream flow is constricted at any one time.

3. The permittee shall ensure that any equipment that is placed on the workpad/causeway is removed when either of the following situations are forecasted or anticipated: (1) the water level will rise to a point where the equipment could be flooded (even during work days), and (2) the water level is expected to rise overnight, or over a non-work period of time, to a point where the equipment could be flooded.

4. Upon completion of work that requires the workpad/causeway to be in the stream, the permittee shall remove all readily detectible workpad/causeway material, to the extent practicable, while removing as little of the original streambed as possible.
5. The permittee shall implement all reasonable and practicable measures to ensure that equipment, structures, fill pads, work, and operations associated with this project do not adversely affect upstream and/or downstream reaches. Adverse effects include, but are not limited to, channel instability, flooding, and/or stream bank erosion. The permittee shall routinely monitor for these effects, cease all work when detected, take initial corrective measures to correct actively eroding areas, and notify this office immediately. Permanent corrective measures may require additional authorization by the U.S. Army Corps of Engineers.
6. The permittee shall comply with conditions #1-4 in the attached letter from the North Carolina Wildlife Resources Commission dated December 10, 2025.
7. The permittee shall require its contractors and/or agents to comply with the terms and conditions of this authorization letter in the construction and maintenance of this project and shall provide each of its contractors and/or agents associated with the construction or maintenance of this project with a copy of this authorization letter, all conditions, and any authorized modifications. A copy of this authorization letter, all conditions, and any authorized modifications, shall be available at the project site during construction and maintenance of this project.

This general permit verification and any associated authorizations does not preclude the necessity to obtain any other Federal, State, or local permits, licenses, and/or certifications, which may be required.

If you have any questions related to this verification or have issues accessing documents referenced in this letter, please contact Lori Beckwith, Regulatory Project Manager of the WRDA/Transportation Branch at 828-230-0483, by mail at the above address, or by email at loretta.a.beckwith@usace.army.mil. Please take a moment to complete our customer satisfaction survey located at <https://regulatory.ops.usace.army.mil/customer-service-survey/>.

Sincerely,

A handwritten signature in black ink that reads "M. Scott Jones". The signature is written in a cursive, flowing style.

M. Scott Jones, PWS
WRDA / Transportation Branch Chief
USACE, Wilmington District

Enclosures

projects to be carried out over the next two years.

In-water impacts

Considering the range in structure and waterbody sizes analyzed in this review, and basing amounts on past similarly-sized structure and waterbody NCDOT crossing structure projects in WNC, the estimate of combined temporary and permanent in-water impacts for these projects range from 0.01 – 0.35 acres (or 4,356 – 15,246 square feet) per structure. Some structure replacements will fall in the lower portion of that range of in-water impacts while some will fall in the higher range. These impacts may be in the form of work pad causeways, bent removal and/or placement, and placement of stream-bank stabilization materials.

Tree Clearing, Access Roads, and Demolition

The maximum estimate for tree clearing at structure replacement locations is 0.10 acre. That amount will likely be less at most locations, given the variability in site conditions and the extreme scour (and resulting loss of riparian vegetation) during TS Helene flooding. The season during which clearing will occur is not known for each location. Clearing and grading will occur to allow for access roads and general construction functionality.

Where damaged structures or portions of damaged structures remain in place, demolition will occur. The details of demolition activities and seasonality of demolition will vary by project.

2.3 Avoidance and Minimization and Conservation Measures

NCDOT will employ the following agency Standards, Guides, and Best Practices to avoid and minimize project mediated activities that could negatively impact listed/proposed species or their habitat.

2.3.1 Avoidance and minimization measures (AMMs)

General (regardless of species): The following General AMMs will be implemented on all projects to minimize impacts to listed/proposed species and habitat:

- **General AMM1** - NCDOT will ensure that all operators, employees, and contractors working in areas of suitable habitat for federally listed/proposed species are aware of all NCDOT environmental commitments, including all applicable AMMs and all associated NCDOT guidance documents.
- **General AMM2** - Best management practices (BMP) and sediment and erosion control (SEC) measures will be utilized to prevent non-point source pollution, control storm water runoff, and minimize sediment damage to avoid and reduce overall water quality degradation.
- **General AMM3** - Areas of disturbance, such as tree clearing, grubbing, and grading, will be limited to the maximum extent possible.

Bats - The General AMMs will minimize impacts to listed and proposed bat species. **To the maximum extent possible**, the following AMMs will also be incorporated into project work – though implementation of all bat AMMs below cannot be guaranteed at the time of this consultation, given the scale, scope, and timeline constraints addressed previously.

- Bat AMM Noise - Percussive activities will occur only after tree clearing within the action area has been completed, helping to reduce the exposure of any tree-roosting bats within the action area to high decibel noise.
- Bat AMM Lighting - No new lighting will be added to the action area. Any lighting needed for night work will be directed at the work area and shielded from surrounding waters/landscape, only on when needed, no brighter than necessary, and blue light emissions will be limited.
- Bat AMM Riparian Planting - Disturbed riparian areas will be replanted with native, fast-growing tree and shrub species where feasible, with the understanding that plantings likely cannot be done in utility/drainage/construction easements.

Aquatics- The General AMMs above will minimize impacts to listed/proposed aquatic species. **To the maximum extent possible**, the following AMMs will also be incorporated into project work – though implementation of all aquatic AMMs below cannot be guaranteed at the time of this consultation, given the scale, scope, and timeline constraints addressed previously.

- Aquatic AMM Structure - To the maximum extent possible, structure will be built in the same location as the previous structure, with minimal impact [such as in-water bents] to water resource, built to NCDOT's current improved highway and hydraulic standards.
- Aquatic AMM Equipment - To the maximum extent possible, heavy machinery will not be utilized within the waterbody. Additionally, staging and storage areas for equipment and materials will be managed in such a way to ensure that potential spills and leaks do not have access to the waterbody.
- Aquatic AMM Temporary and Permanent Fill - Any temporary fill (i.e. causeways) or permanent (i.e. bents/piers) fill in excess of what was previously present will be avoided and minimized to the maximum extent possible.
- Aquatic AMM Abutments - Existing abutments will be completely removed unless removal results in destabilizing of banks or increases the adverse effect to listed/proposed aquatic species.
- Aquatic AMM Deck Drains - Deck drains that empty directly to the waterbody below will not be included in new bridge designs. Surface water drainage transport will be designed to incorporate improved treatment prior to drainage entering the waterbody.
- Aquatic AMM Erosion Control Matting - Coir fiber matting will be utilized instead of plastic or other synthetic matting.

2.3.2 Conservation Measures (CMs)

CMs represent actions, pledged in the project description, that the action agency will implement to further the recovery of the species under review. The beneficial effects of CMs are considered in making determinations of whether the projects will jeopardize the species under consideration in this document.

1. NCDOT shall ensure that the contractor(s) understands and follows the measures listed in the “Conservation Measures”, “Reasonable and Prudent Measures,” and “Terms and Conditions” sections of this Opinion.
2. NCDOT shall minimize the area of disturbance within the action areas to only the area necessary for the safe and successful implementation of the proposed actions.
3. NCDOT shall monitor and document any take numbers and the surrogate measures of take and report those to the Service in a batched format.

7.3 Terms and Conditions

In order to be exempt from the prohibitions of section 9 of the ESA, the Applicant must comply with the following terms and conditions, which implement the reasonable and prudent measures described above and outline required reporting and/or monitoring requirements. When incidental take is anticipated, the terms and conditions must include provisions for monitoring project activities to determine the actual project effects on listed fish or wildlife species (50 CFR §402.14(i)(3)). These terms and conditions are nondiscretionary. If this conference opinion is adopted as a biological opinion following a listing or designation, these terms and conditions will be non-discretionary.

1. NCDOT shall adhere to all measures as listed in the Avoidance and Minimization and Conservation Measures section as summarized in this Opinion.
2. The NCDOT will immediately inform the Service if the amount or extent of incidental take in the incidental take statement is exceeded.
3. When incidental take is anticipated, the Terms and Conditions must include provisions for monitoring project activities to determine the actual project effects on listed fish or wildlife species (50 CFR §402.14(i)(3)). In order to monitor the impact of incidental take, the NDOT must report the action impacts on the species to the Service according to the following:
 - a. The NCDOT will submit a report each year not later than September 30 identifying, per individual project (via Service Log # and NCDOT identifiers), the following for the preceding calendar year ending December 31:
 - i. Acreage and dates of tree removal (if any), if LAA for bats (excepting gray bat).
 - ii. Dates of structure removal (if any), if LAA for bats.
 - iii. List of implemented AMMs and BMPs [as listed in Section 2.3].

8. Conservation Recommendations

Section 7(a)(1) of the Endangered Species ESA directs Federal agencies to use their authorities to further the purposes of the Endangered Species ESA by carrying out conservation programs for the benefit of endangered and threatened species. Conservation recommendations are discretionary agency activities to minimize or avoid adverse effects of a proposed action on listed species or critical habitat, to help implement recovery plans, or to develop information.

- **Eastern Hellbender:** Proximity to eastern hellbender occurrence records was noted for the following crossing structures: Buncombe County structures 132, 135, and 139, and Yancey County structure 298. Ahead of work at this location, coordinate with the NCWRC and the Service to survey for/relocate any hellbender that may be within the action area and vulnerable to impacts from project work.
- **State Species of Concern:** Proximity to aquatic species with North Carolina designations was noted for Buncombe County crossing structures 132, 135, 175, and 200, Madison County crossing structure 042, McDowell County crossing structure 044, and Mitchell County crossing structure 123. While these species are not currently afforded legal protection under the ESA, we recommend the most



◻ North Carolina Wildlife Resources Commission ◻

M. Kyle Briggs, Executive Director

December 10, 2025

Lori Beckwith
U.S. Army Corps of Engineers, Asheville Regulatory Field Office
151 Patton Avenue, Room 208
Asheville, NC 28801

Amy Annino
401 and Buffer Transportation Permitting Branch
North Carolina Department of Environmental Quality
2090 U.S. 70 Highway
Swannanoa, NC 28778-8211

SUBJECT: Comments on Permit/WQC Application for Replacement of Bridge 132 on SR 2150
 (Hobson Branch Road) over Ivy Creek, Buncombe County.
 DF18313.2011366

The North Carolina Department of Transportation (NCDOT) applied for a 404 Permit and 401 Certification for the subject project. The North Carolina Wildlife Resources Commission's (NCWRC) comments are offered to help conserve the wildlife resources affected by the project and to promote wildlife-based recreation in accordance with applicable provisions of the Clean Water Act of 1977 (33 U.S.C. 466 et seq.) and the Fish and Wildlife Coordination Act (48 Stat. 401, as amended; 16 U.S.C. 661-667d).

The existing bridge was washed-out by Hurricane Helene. The bridge is being built on the same alignment as the original bridge. There is a suitable off-site detour.

Ivy Creek (WSII-HQW) is hatchery supported trout water under the NCWRC's Designated Public Mountain Trout Water Program. Trout may be stocked here again once the normal trout stocking program resumes. In scoping comments to NCDOT, the NCWRC requested that shoulder parking be accommodated near the bridge for fishermen. It appears that space may be limited for that request though there may be a little room between the drive and guardrail in the northeast bridge quadrant.

In scoping comments on the Division 13 Helene bridge replacements, the NCWRC identified about half of the bridges listed as not needing a trout moratorium. Buncombe 132 is one of those bridges that does not need a trout moratorium because trout spawning is unlikely near this bridge, and spawning was unlikely to occur here even before the storm.

While trout spawning is not a concern and a trout moratorium not needed for this bridge work, there used to be and may still be Eastern Hellbender (*Cryptobranchus alleganiensis*) in Ivy Creek. The NCWRC will likely not survey near this bridge before construction, but we do request that *Design Standards in Sensitive Waters* be incorporated into the project's erosion control to help avoid additional aquatic habitat damage in this stream (see part (d) of 15A NCAC 04B .0124).

The NCWRC requests that the following conditions be included in authorizations to help conserve trout habitat and other aquatic resources affected by the project:

1. Applicable measures from the current *NCDOT Erosion and Sediment Control Design and Construction Manual* should be adhered to. *Design Standards in Sensitive Waters* should be incorporated into the project's erosion control to help ensure protection of high-quality habitat (see part (d) of 15A NCAC 04B .0124).
2. In accordance with standard GC conditions, matting used in riparian areas should not contain nylon mesh because it entangles and kills wildlife. Coir matting should be used on disturbed stream banks that are steep or susceptible to high water. Matting should be anchored with wooden stakes according to NCDOT specifications.
3. Heavy equipment needs to be well-maintained and concrete pouring needs to be closely monitored to avoid and quickly mitigate fuel, fluid, or wet concrete losses in or near streams.
4. Sandbags, rock berms, cofferdams, or other diversion structures should be used where excavation or other periods of extended stream disturbance has the potential for downstream sedimentation.

Thank you for the opportunity to review and provide recommendations on this project. Please contact me at david.mchenry@ncwildlife.gov or (828) 476-1966 if you have any questions about these comments.

Sincerely,



Dave McHenry, NCWRC Western DOT Coordinator

cc: Yates Allen, NCDOT Division 13 Environmental Specialist II
Mike Sanderson, NCDOT Division 13 Environmental Supervisor
Karina Clough, NCDOT Division 13 PDEA
Michael Turchy, NCDOT ECAP Lead

U.S. Army Corps of Engineers (USACE) CERTIFICATION OF COMPLIANCE WITH DEPARTMENT OF THE ARMY PERMIT For use of this form, see Section 404 of the Clean Water Act, Section 10 of the Rivers and Harbors Act of 1899, and Section 103 of the Marine Protection, Research, and Sanctuaries Act; the proponent agency is CECW-COR.		Form Approved - OMB No. 0710-0003 Expires 2027-10-31
The Agency Disclosure Notice (ADN)		
<p>The Public reporting burden for this collection of information, 0710-0003, is estimated to average 10 minutes per response, including time for reviewing instructions, searching existing data sources, gathering and maintaining the data needed, and completing and reviewing the collection of information. Send comments regarding the burden estimate or burden reduction suggestions to the Department of Defense, Washington Headquarters Services, at whs.mc-alex.esd.mbx.dd-dod-information-collections@mail.mil. Respondents should be aware that notwithstanding any other provision of law, no person shall be subject to any penalty for failing to comply with a collection of information if it does not display a currently valid OMB control number.</p>		
<p>PURPOSE: This form is used by recipients of U.S. Army Corps of Engineer Regulatory permits to certify compliance with the permit terms and conditions.</p> <p>Your permitted activity is subject to a compliance inspection by a U.S. Army Corps of Engineers representative. If you fail to comply with this permit, you are subject to permit suspension, modification, or revocation.</p>		
<p>Upon completion of the activity authorized by this permit and any mitigation required by the permit, sign this certification and return it to the U.S. Army Corps of Engineers, Wilmington District, Regulatory Office.</p> <p>The certification can be submitted by email at loretta.a.beckwith@usace.army.mil or by mail at the below address:</p> <div style="text-align: center; margin-top: 20px;"> U.S. Army Corps of Engineers, Wilmington District Asheville Field Office Street Address: 151 Patton Avenue, Room 208 Asheville, North Carolina 28801-5006 </div>		
<div style="display: flex; justify-content: space-between;"> <div style="width: 30%;">Corps Action Number:</div> <div style="width: 70%; border-bottom: 1px solid black;">SAW-1994-04102</div> </div> <div style="display: flex; justify-content: space-between; margin-top: 10px;"> <div style="width: 30%;">Permit Type:</div> <div style="width: 70%; border-bottom: 1px solid black;">General Permit</div> </div> <div style="display: flex; justify-content: space-between; margin-top: 10px;"> <div style="width: 30%;">General Permit Number and Name (if applicable):</div> <div style="width: 70%; border-bottom: 1px solid black;">NWP 3</div> </div> <div style="display: flex; justify-content: space-between; margin-top: 10px;"> <div style="width: 30%;">Name of Permittee:</div> <div style="width: 70%; border-bottom: 1px solid black;">NCDOT, Division of Highways</div> </div> <div style="display: flex; justify-content: space-between; margin-top: 10px;"> <div style="width: 30%;">Project Name:</div> <div style="width: 70%; border-bottom: 1px solid black;">NCDOT / Hurricane Helene / DF18313.2011366 / Br 132 / SR 2150 / Buncombe / Div 13</div> </div> <div style="display: flex; justify-content: space-between; margin-top: 10px;"> <div style="width: 30%;">Project Location (physical address):</div> <div style="width: 70%; border-bottom: 1px solid black;">Bridge 132 SR 2150 Ivy Creek Buncombe Co. NC</div> </div>		
PERMITTEE'S CERTIFICATION		
<div style="display: flex; justify-content: space-between;"> <div style="width: 30%;">Date Work Started:</div> <div style="width: 70%; border-bottom: 1px solid black;"></div> </div> <div style="display: flex; justify-content: space-between; margin-top: 10px;"> <div style="width: 30%;">Date Work Completed:</div> <div style="width: 70%; border-bottom: 1px solid black;"></div> </div> <p>Enclose photographs showing the completed project (if available).</p> <p>I _____ hereby certify that the work authorized by the above referenced permit has been completed in accordance with all of the permit terms and conditions, and that any required compensatory mitigation has been completed in accordance with the permit conditions.</p>		
Name	Date	Signature

401

Certification (NCDWR)

JOSH STEIN
Governor

D. REID WILSON
Secretary

RICHARD E. ROGERS, JR.
Director

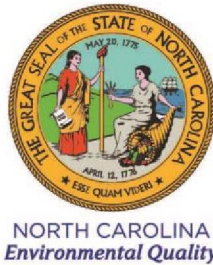

December 17, 2025
Buncombe County
NCDWR Project No. 20251669
Bridge 132 on SR 2150
Hobson Branch Road
WBS Element No. DF18313.2011366

APPROVAL of 401 WATER QUALITY CERTIFICATION with ADDITIONAL CONDITIONS

Mr. Michael Turchy
North Carolina Department of Transportation
1598 Mail Service Center
Raleigh, North Carolina, 27699-1598
MATurchy@NCDOT.gov

Subject: 401 Water Quality Certification Pursuant to Section 401 of the Federal Clean Water Act with ADDITIONAL CONDITIONS for Proposed replacement to Bridge 132 on State Road 2150 (Hobson Branch Road) in Buncombe County, NCDWR Project No. 20251669, WBS Element No. DF18313.2011366.

Dear Mr. Turchy:

Attached hereto is a copy of Water Quality Certification No. 008558 issued to The North Carolina Department of Transportation (NCDOT) dated December 17, 2025.

This approval is for the purpose and design described in your application. The plans and specifications for this project are incorporated by reference as part of this Water Quality Certification. If you change your project, you must notify the Division and you may be required to submit a new application package with the appropriate fee. If the property is sold, the new owner must be given a copy of this Certification and is responsible for complying with all conditions. [15A NCAC 02H .0507(d)(2)]. This Certification does not relieve the permittee of the responsibility to obtain all other required Federal, State, or Local approvals before proceeding with the project, including those required by, but not limited to, Sediment and Erosion Control, Non-Discharge, Water Supply Watershed, and Trout Buffer regulations.

This Water Quality Certification shall expire on the same day as the expiration date of the corresponding Section 404 Permit that is current at the time this Certification is issued. The conditions shall remain in effect for the life of the project, regardless of the expiration date of this Water Quality Certification.

Non-compliance with or violation of the conditions herein set forth may result in revocation of this Water Quality Certification for the project and may also result in criminal and/or civil penalties.

This letter completes the review of the Division under section 401 of the Clean Water Act and 15A NCAC 02H .0500. Please contact Mary Plummer at 704-235-2193 or mary.plummer@deq.nc.gov if you have any questions or concerns.

Sincerely,
Signed by:

Faith Hardin

3185428003FA45F
Richard E. Rogers Jr., Director
Division of Water Resources

Electronic copy only distribution
John Olinger, RKK



North Carolina Department of Environmental Quality | Division of Water Resources
512 North Salisbury Street | 1617 Mail Service Center | Raleigh, North Carolina 27699-1617
919.707.9000

Crystal Amschler, US Army Corps of Engineers, Asheville Field Office
Holland Youngman, US Fish and Wildlife Service
David McHenry, NC Wildlife Resources Commission
File Copy

401 Water Quality Certification Pursuant to Section 401 of the Federal Clean Water Act with ADDITIONAL CONDITIONS

THIS CERTIFICATION is issued in conformity with the requirements of Section 401 Public Laws 92-500 and 95-217 of the United States and subject to the North Carolina Division of Water Resources (NCDWR) Regulations in 15 NCAC 2H .0500. This certification authorizes the NCDOT to impact 195 Linear Feet of jurisdictional stream in Buncombe County. The project shall be constructed pursuant to the application dated and received December 10, 2025. The authorized impacts are as described below:

Stream Impacts (Linear Feet) in the French Broad River Basin.

Site	Permanent in Perennial	Temporary in Perennial	Temporary in Perennial	Total Stream Impacts
	Rip Rap/ Bank Stabilization	Rip Rap/ Impervious Dike	Rip Rap/ Causeway/ Work Pad	
1A	59	-	-	59
1B	-	65	-	65
1C	-	-	71	71
Totals	59	65	71	195
		136		

Total Stream Impacts for Project: 195 Linear Feet.

The application provides adequate assurance that the discharge of fill material into the waters of the French Broad River Basin in conjunction with the proposed development will not result in a violation of applicable Water Quality Standards and discharge guidelines. Therefore, the State of North Carolina certifies that this activity will not violate the applicable portions of Sections 301, 302, 303, 306, 307 of PL 92-500 and PL 95-217 if conducted in accordance with the application and conditions hereinafter set forth.

This approval is only valid for the purpose and design that you submitted in your application dated and received December 10, 2025. Should your project change, you are required to notify the NCDWR and submit a new application. If the property is sold, the new owner must be given a copy of this Certification and approval letter and is thereby responsible for complying with all the conditions. If any additional wetland impacts, or stream impacts, for this project (now or in the future) exceed one acre or 300 linear feet, respectively, additional compensatory mitigation may be required as described in 15A NCAC 2H .0506 (h) (6) and (7).

For this approval to remain valid, you are required to comply with all the conditions listed below. In addition, you should obtain all other federal, state or local permits before proceeding with your project including (but not limited to) Sediment and Erosion control, Coastal Stormwater, Non-discharge and Water Supply watershed regulations. This Certification shall expire on the same day as the expiration date of the corresponding Corps of Engineers Permit.

This Water Quality Certification neither grants nor affirms any property right, license, or privilege in any lands or waters, or any right of use in any waters. This Water Quality Certification does not authorize any person to interfere with the riparian rights, littoral rights, or water use rights of any other person and does not create any prescriptive right or any right of priority regarding any usage of water. This Water Quality Certification shall not be interposed as a defense in any action respecting the determination of riparian or littoral rights or other rights to water use. No consumptive user is deemed by virtue of this Water Quality Certification to possess any prescriptive or other right of priority with respect to any other consumptive user regardless of the quantity of the withdrawal or the date on which the withdrawal was initiated or expanded. Upon the presentation of proper credentials, the

Division may inspect the property.

Condition(s) of Certification:

Project Specific Conditions

1. The post-construction removal of any temporary bridge structures must return the project site to its preconstruction contours and elevations. The impacted areas shall be revegetated with appropriate native species. [15A NCAC 02H. 0506(b)(2)]
2. As a condition of this 401 Water Quality Certification, the bridge demolition and construction must be accomplished in strict compliance with the most recent version of NCDOT's Best Management Practices for Construction and Maintenance Activities. [15A NCAC 02H .0507(d)(2) and 15A NCAC 02H .0506(b)(5)]
3. Bridge deck drains shall not discharge directly into the stream. Stormwater shall be directed across the bridge and pre-treated through site-appropriate means (as described in the stormwater management plan) before entering the stream. [15A NCAC 02H .0507(d)(2) and 15A NCAC 02H .0506(b)(5)]
4. Bridge piles and bents shall be constructed using driven piles (hammer or vibratory) or drilled shaft construction methods. More specifically, jetting or other methods of pile driving are prohibited without prior written approval from the NCDWR first. [15A NCAC 02H.0506(b)(2)]
5. No drill slurry or water that has been in contact with uncured concrete shall be allowed to enter surface waters. This water shall be captured, treated, and disposed of properly. [15A NCAC 02H. 0506(b)(3)]
6. A turbidity curtain will be installed in the stream if driving or drilling activities occur within the stream channel, on the stream bank, or within 5 feet of the top of bank, or during the removal of bents from an old bridge. This condition can be waived with prior approval from the NCDWR. [15A NCAC 02H 0506(b)(3)]
7. All bridge construction shall be performed from the existing bridge, temporary work bridges, temporary causeways, or floating or sunken barges. If work conditions require barges, they shall be floated into position and then sunk. The barges shall not be sunk and then dragged into position. Under no circumstances should barges be dragged along the bottom of the surface water. [15A NCAC 02H 0506(b)(3)]
8. Impervious dikes or turbidity curtains shall be used to isolate all work areas from the stream at Ivy Creek, including pile or casement installation, placement of riprap, excavation or filling. Strict adherence to the Construction and Maintenance Best Management Practices will be required.
9. For projects impacting waters classified by the NC Environmental Management Commission as Trout (Tr), High Quality Waters (HQW), or Water Supply I or II (WSI, WSII) stormwater shall be directed to vegetated buffer areas, grass-lined ditches or other means appropriate to the site for the purpose of pre-treating storm water runoff prior to discharging directly into streams. Mowing of existing vegetated buffers is strongly discouraged.
10. The permittee shall use *Design Standards in Sensitive Watersheds* (15A NCAC 4B.0124[a]-[e]) in areas draining to **WS-II and HQW**.

General Conditions

1. Unless otherwise approved in this certification, placement of culverts and other structures in open waters and streams shall be placed below the elevation of the streambed by one foot for all culverts with a diameter greater than 48 inches, and 20 percent of the culvert diameter for culverts having a diameter less than 48 inches, to allow low flow passage of water and aquatic life. Design and placement of culverts and other structures including temporary erosion control measures shall not be conducted in a manner that may result in dis-equilibrium of

wetlands or streambeds or banks, adjacent to or upstream and down stream of the above structures. The applicant is required to provide evidence that the equilibrium is being maintained if requested in writing by NCDWR. If this condition is unable to be met due to bedrock or other limiting features encountered during construction, please contact NCDWR for guidance on how to proceed and to determine whether or not a permit modification will be required. [15A NCAC 02H.0506(b)(2)]

2. If concrete is used during construction, a dry work area shall be maintained to prevent direct contact between curing concrete and stream water. Water that inadvertently contacts uncured concrete shall not be discharged to surface waters due to the potential for elevated pH and possible aquatic life and fish kills. [15A NCAC 02B.0200]
3. For all streams being impacted due to site dewatering activities, the site shall be graded to its preconstruction contours and revegetated with appropriate native species. [15A NCAC 02H.0506(b)(2)]
4. During the construction of the project, no staging of equipment of any kind is permitted in waters of the U.S. or protected riparian buffers. [15A NCAC 02H.0506(b)(2)]
5. The dimension, pattern and profile of the stream above and below any crossing shall not be modified. Disturbed floodplains and streams shall be restored to natural geomorphic conditions. [15A NCAC 02H.0506(b)(2)]
6. The use of rip-rap above the Normal High Water Mark shall be minimized. Any rip-rap placed for stream stabilization shall be placed in stream channels in such a manner that it does not impede aquatic life passage. [15A NCAC 02H.0506(b)(2)]
7. The Permittee shall ensure that the final design drawings adhere to the permit and to the permit drawings submitted for approval. [15A NCAC 02H .0507 (c) and 15A NCAC 02H .0506 (b)(2) and (c)(2)]
8. All work in or adjacent to stream waters shall be conducted in a dry work area. Approved BMP measures from the most current version of NCDOT Construction and Maintenance Activities manual such as sandbags, rock berms, cofferdams and other diversion structures shall be used to prevent excavation in flowing water. [15A NCAC 02H.0506(b)(3)]
9. Heavy equipment shall be operated from the banks rather than in the stream channel in order to minimize sedimentation and reduce the introduction of other pollutants into the stream. [15A NCAC 02H.0506(b)(3)]
10. All mechanized equipment operated near surface waters must be regularly inspected and maintained to prevent contamination of stream waters from fuels, lubricants, hydraulic fluids, or other toxic materials. [15A NCAC 02H.0506(b)(3)]
11. No rock, sand or other materials shall be dredged from the stream channel except where authorized by this certification. [15A NCAC 02H.0506(b)(3)]
12. Discharging hydroseed mixtures and washing out hydroseeders and other equipment in or adjacent to surface waters is prohibited. [15A NCAC 02H.0506(b)(3)]
13. The permittee and its authorized agents shall conduct its activities in a manner consistent with State water quality standards (including any requirements resulting from compliance with §303(d) of the Clean Water Act) and any other appropriate requirements of State and Federal law. If the NCDWR determines that such standards or laws are not being met (including the failure to sustain a designated or achieved use) or that State or federal law is being violated, or that further conditions are necessary to assure compliance, the NCDWR may reevaluate and modify this certification. [15A NCAC 02B.0200]
14. All fill slopes located in jurisdictional wetlands shall be placed at slopes no flatter than 3:1, unless otherwise authorized by this certification. [15A NCAC 02H.0506(b)(2)]
15. A copy of this Water Quality Certification shall be maintained on the construction site at all times. In addition, the Water Quality Certification and all subsequent modifications, if any, shall be maintained with the Division

Engineer and the on-site project manager. [15A NCAC 02H .0507(c) and 15A NCAC 02H .0506 (b)(2) and (c)(2)]

16. The outside buffer, wetland or water boundary located within the construction corridor approved by this authorization, including all non-commercial borrow and waste sites associated with the project, shall be clearly marked by highly visible fencing prior to any land disturbing activities. Impacts to areas within the fencing are prohibited unless otherwise authorized by this certification. [15A NCAC 02H.0501 and .0502]
17. The issuance of this certification does not exempt the Permittee from complying with any and all statutes, rules, regulations, or ordinances that may be imposed by other government agencies (i.e. local, state, and federal) having jurisdiction, including but not limited to applicable buffer rules, stormwater management rules, soil erosion and sedimentation control requirements, etc.
18. The Permittee shall report any violations of this certification to the Division of Water Resources within 24 hours of discovery. [15A NCAC 02B.0506(b)(2)]
19. Upon completion of the project (including any impacts at associated borrow or waste sites), the NCDOT Division Engineer shall complete and return the "Certification of Completion Form" to notify the NCDWR when all work included in the 401 Certification has been completed. [15A NCAC 02H.0507]
20. Native riparian vegetation (i.e., herbaceous, trees, and shrubs native to your geographic region) must be reestablished in the riparian areas within the construction limits of the project by the end of the growing season following completion of construction. [15A NCAC 02B.0506(b)(2)]
21. There shall be no excavation from, or waste disposal into, jurisdictional wetlands or waters associated with this permit without appropriate modification. Should waste or borrow sites, or access roads to waste or borrow sites, be located in wetlands or streams, compensatory mitigation will be required since that is a direct impact from road construction activities. [15A NCAC 02H.0506(b)(3) and (c)(3)]
22. Erosion control matting that incorporates plastic mesh and/or plastic twine shall not be used along streambanks or within jurisdictional wetlands. [15A NCAC 2H.0506; 15A NCAC 2H.0507]
23. Erosion and sediment control practices must be in full compliance with all specifications governing the proper design, installation and operation and maintenance of such Best Management Practices in order to protect surface waters standards [15A NCAC 02H.0506(b)(3) and (c)(3)]:
 - a. The erosion and sediment control measures for the project must be designed, installed, operated, and maintained in accordance with the most recent version of the *North Carolina Sediment and Erosion Control Planning and Design Manual*.
 - b. The design, installation, operation, and maintenance of the sediment and erosion control measures must be such that they equal, or exceed, the requirements specified in the most recent version of the *North Carolina Sediment and Erosion Control Manual*. The devices shall be maintained on all construction sites, borrow sites, and waste pile (spoil) projects, including contractor-owned or leased borrow pits associated with the project.
 - c. For borrow pit sites, the erosion and sediment control measures must be designed, installed, operated, and maintained in accordance with the most recent version of the *North Carolina Surface Mining Manual*.
 - d. The reclamation measures and implementation must comply with the reclamation in accordance with the requirements of the Sedimentation Pollution Control Act.
24. Sediment and erosion control measures shall not be placed in wetlands or surface waters, or within 5 feet of the top of bank, without prior approval from DWR. [15A NCAC 02H.0506(b)(3) and (c)(3)]
25. When applicable, all construction activities shall be performed and maintained in full compliance with G.S. Chapter 113A Article 4 (Sediment and Pollution Control Act of 1973). Regardless of applicability of the Sediment and Pollution Control Act, all projects shall incorporate appropriate Best Management Practices for the control

of sediment and erosion so that no violations of state water quality standards, statutes, or rules occur. [15A NCAC 02H .0506(b)(3) and (c)(3) and 15A NCAC 02B .0200]

26. Design, installation, operation, and maintenance of all sediment and erosion control measures shall be equal to or exceed the requirements specified in the most recent version of the *North Carolina Sediment and Erosion Control Manual*, or for linear transportation projects, the *NCDOT Sediment and Erosion Control Manual*.
27. All devices shall be maintained on all construction sites, borrow sites, and waste pile (spoil) sites, including contractor-owned or leased borrow pits associated with the project. Sufficient materials required for stabilization and/or repair of erosion control measures and stormwater routing and treatment shall be on site at all times.
28. For borrow pit sites, the erosion and sediment control measures shall be designed, installed, operated, and maintained in accordance with the most recent version of the *North Carolina Surface Mining Manual*. Reclamation measures and implementation shall comply with the reclamation in accordance with the requirements of the Sedimentation Pollution Control Act and the Mining Act of 1971.

This Certification shall become null and void unless the above conditions are made conditions of the (applicable) Federal 404 and/or Coastal Area Management Act Permit. This Certification shall expire upon the expiration of the (applicable) 404 or CAMA permit. Please be aware that impacting waters without first applying for and securing the issuance of a 401 Water Quality Certification violates Title 15A of the North Carolina Administrative Code (NCAC) 2H .0500. Title 15A NCAC 2H .0500 requires certifications pursuant to Section 401 of the Clean Water Act whenever construction or operation of facilities will result in a discharge into navigable waters, including wetlands, as described in 33 Code of Federal Regulations (CFR) Part 323. It also states any person desiring issuance of the State certification or coverage under a general certification required by Section 401 of the Federal Water Pollution Control Act shall file with the Director of the North Carolina Division of Water Quality. Violations of any condition herein set forth may result in revocation of this Certification and may result in criminal and/or civil penalties. Pursuant to G.S. 143-215.6A, these violations and any future violations are subject to a civil penalty assessment of up to a maximum of \$25,000.00 per day for each violation.

This approval and its conditions are final and binding unless contested [G.S. 143-215.5]. Please be aware that impacting waters without first applying for and securing the issuance of a 401 Water Quality Certification violates Title 15A of the North Carolina Administrative Code (NCAC) 2H .0500. Title 15A NCAC 2H .0500 requires certifications pursuant to Section 401 of the Clean Water Act whenever construction or operation of facilities will result in a discharge into navigable waters, including wetlands, as described in 33 Code of Federal Regulations (CFR) Part 323. It also states any person desiring issuance of the State certification or coverage under a general certification required by Section 401 of the Federal Water Pollution Control Act shall file with the Director of the North Carolina Division of Water Quality. Pursuant to G.S. 143-215.6A, these violations and any future violations are subject to a civil penalty assessment of up to a maximum of \$25,000.00 per day for each violation.

This Certification can be contested as provided in Chapter 150B of the North Carolina General Statutes by filing a Petition for a Contested Case Hearing (Petition) with the North Carolina Office of Administrative Hearings (OAH) within sixty (60) calendar days. Requirements for filing a Petition are set forth in Chapter 150B of the North Carolina General Statutes and Title 26 of the North Carolina Administrative Code. Additional information regarding requirements for filing a Petition and Petition forms may be accessed at <http://www.ncoah.com/> or by calling the OAH Clerk's Office at (919) 431-3000.

A party filing a Petition must serve a copy of the Petition on:

Dan Hirschman, General Counsel
Department of Environmental Quality
1601 Mail Service Center
Raleigh, NC 27699-1601

If the party filing the Petition is not the permittee, then the party must also serve the recipient of the Certification in accordance with N.C.G.S 150B-23(a).

This letter completes the review of the Division under section 401 of the Clean Water Act and 15A NCAC 02H .0500. Please contact Mary Plummer at 704-235-2193 or mary.plummer@deq.nc.gov if you have any questions or concerns.

This the 17th day of December 2025

DIVISION OF WATER RESOURCES

Signed by:

A handwritten signature in black ink that reads "Faith Hardin". The signature is enclosed within a purple rectangular box.

3185423002EA45E...

Richard E. Rogers, Jr, Director

WQC No. 8558



NORTH CAROLINA
Environmental Quality

JOSH STEIN
Governor

D. REID WILSON
Secretary

RICHARD E. ROGERS, JR.
Director

DWR Project No.: _____ County: _____

Applicant: _____

Project Name: _____

Date of Issuance of 401 Water Quality Certification: _____

Certificate of Completion

Upon completion of all work approved within the 401 Water Quality Certification or applicable Buffer Rules, and any subsequent modifications, the applicant is required to return this certificate to the 401 Transportation Permitting Unit, North Carolina Division of Water Resources, 1617 Mail Service Center, Raleigh, NC, 27699-1617. This form may be returned to NCDWR by the applicant, the applicant's authorized agent, **or** the project engineer. It is not necessary to send certificates from all of these.

Applicant's Certification

I, _____, hereby state that, to the best of my abilities, due care and diligence was used in the observation of the construction such that the construction was observed to be built within substantial compliance and intent of the 401 Water Quality Certification and Buffer Rules, the approved plans and specifications, and other supporting materials.

Signature: _____ Date: _____

Agent's Certification

I, _____, hereby state that, to the best of my abilities, due care and diligence was used in the observation of the construction such that the construction was observed to be built within substantial compliance and intent of the 401 Water Quality Certification and Buffer Rules, the approved plans and specifications, and other supporting materials.

Signature: _____ Date: _____

Engineer's Certification

_____ Partial _____ Final

I, _____, as a duly registered Professional Engineer in the State of North Carolina, having been authorized to observe (periodically, weekly, full time) the construction of the project for the Permittee hereby state that, to the best of my abilities, due care and diligence was used in the observation of the construction such that the construction was observed to be built within substantial compliance and intent of the 401 Water Quality Certification and Buffer Rules, the approved plans and specifications, and other supporting materials.

Signature _____ Registration No. _____



Date _____

Completed hard copies can be emailed to kristilynn.carpenter@deq.nc.gov or mailed to:
NCDEQ Transportation Permitting
1617 Mail Service Center
Raleigh NC 27699-1617



North Carolina Department of Environmental Quality | Division of Water Resources
512 North Salisbury Street | 1617 Mail Service Center | Raleigh, North Carolina 27699-1617
919.707.9000

Permitted Drawings

		North Carolina Department of Transportation													
		Highway Stormwater Program													
		STORMWATER MANAGEMENT PLAN													
		FOR NCDOT PROJECTS													
(Version 3.02; Released April 23, 2024)															
WBS Element:		DF18313.2011306.F		TIP/Proj No:	C205028		County(ies):	Buncombe	Page	1	of	2			
General Project Information															
WBS Element:		DF18313.2011306.PR		TIP Number:	C205028		Project Type:	Bridge Replacement	Date:	10/17/2025					
NCDOT Contact:		Tom Veazey		Contractor / Designer:		John Olinger, PE									
		Address:		Resident Engineer's Office - Asheville 11 Old Charlotte Highway Asheville, NC 28803		Address:		8601 Six Forks Road Forum 1, Suite 700 Raleigh, NC 27615							
		Phone:		828-250-3270		Phone:		919-809-6564							
		Email:		tveazey@ncdot.gov		Email:		jolingerr@rkk.com							
City/Town:		Weaverville		County(ies):		Buncombe									
River Basin(s):		French Broad		CAMA County?		No									
Wetlands within Project Limits?		No													
Project Description															
Project Length (lin. miles or feet):		0.060 miles		Surrounding Land Use:		Rural, Residential									
		Proposed Project		Existing Site											
Project Built-Upon Area (ac.)		0.33 ac.		ac.		0.25		ac.							
Typical Cross Section Description:		The typical section for -L- includes 2-9' lanes (NC) with open shoulders varying from 3' to 7', dependant on the presence of guardrail. -Y1- is the same with 9' lanes and shoulders varying from 3' to 7', dependant on the presence of guardrail.		The existing typical cross-section is 18' wide with two 9' travel lanes and varying shoulders.											
Annual Avg Daily Traffic (veh/hr/day):		Design/Future:		490		Year:		2025		Existing:		300		Year:	
General Project Narrative: (Description of Minimization of Water Quality Impacts)		The replacement of Bridge 100132 is an emergency bridge replacement on SR 2150 (Hobson Branch Road) over Ivy Creek as the result of Hurricane Helene in September 2024. The storm washed out the existing bridge and roadway. Stream minimizations include: 1. Stormwater was designed to avoid direct discharge into jurisdictional features to the maximum extent possible. 2. Stormwater design velocities entering jurisdictional features have been mitigated to be non-erosive (less than 2 fps). 3. Open shoulder sections were maximized to promote sheet flow from the roadway. 4. Diffuse flow provided at outlets that do not have a well defined outfall. 5. Slopes steepened up to 1.5:1, with Class II riprap to minimize stream impacts.													



North Carolina Department of Transportation

Highway Stormwater Program
STORMWATER MANAGEMENT PLAN

(Version 3.02; Released April 23, 2024)

FOR NCDOT PROJECTS

WBS Element: DF18313.2011306.F TIP/Proj No.: C205028

County(ies): Buncombe

Page 2 of 2

General Project Information

Waterbody Information

Surface Water Body (1):	Ivy Creek	NCDWR Stream Index No.:	6-96-(0.5)
NCDWR Surface Water Classification for Water Body	Primary Classification:	Water Supply II (WS-II)	
	Supplemental Classification:	High Quality Waters (HQW)	
Other Stream Classification:	None		
Impairments:	fecal coliform		
Aquatic T&E Species?	No	Comments:	
NRTR Stream ID:		Buffer Rules in Effect:	N/A
Project Includes Bridge Spanning Water Body?	Yes	Deck Drains Discharge Over Buffer?	No
Deck Drains Discharge Over Water Body?	No	(If yes, provide justification in the General Project Narrative)	(If yes, describe in the General Project Narrative; if no, justify in the General Project Narrative)
(If yes, provide justification in the General Project Narrative)			
Surface Water Body (2):		NCDWR Stream Index No.:	
NCDWR Surface Water Classification for Water Body	Primary Classification:		
	Supplemental Classification:		
Other Stream Classification:			
Impairments:			
Aquatic T&E Species?		Comments:	
NRTR Stream ID:		Buffer Rules in Effect:	
Project Includes Bridge Spanning Water Body?		Deck Drains Discharge Over Buffer?	
Deck Drains Discharge Over Water Body?		(If yes, provide justification in the General Project Narrative)	(If yes, describe in the General Project Narrative; if no, justify in the General Project Narrative)
(If yes, provide justification in the General Project Narrative)			
Surface Water Body (3):		NCDWR Stream Index No.:	
NCDWR Surface Water Classification for Water Body	Primary Classification:		
	Supplemental Classification:		
Other Stream Classification:			
Impairments:			
Aquatic T&E Species?		Comments:	
NRTR Stream ID:		Buffer Rules in Effect:	
Project Includes Bridge Spanning Water Body?		Deck Drains Discharge Over Buffer?	
Deck Drains Discharge Over Water Body?		(If yes, provide justification in the General Project Narrative)	(If yes, describe in the General Project Narrative; if no, justify in the General Project Narrative)
(If yes, provide justification in the General Project Narrative)			

TIP PROJECT:

CONTRACT: C205028

See Sheet 1A For Index of Sheets

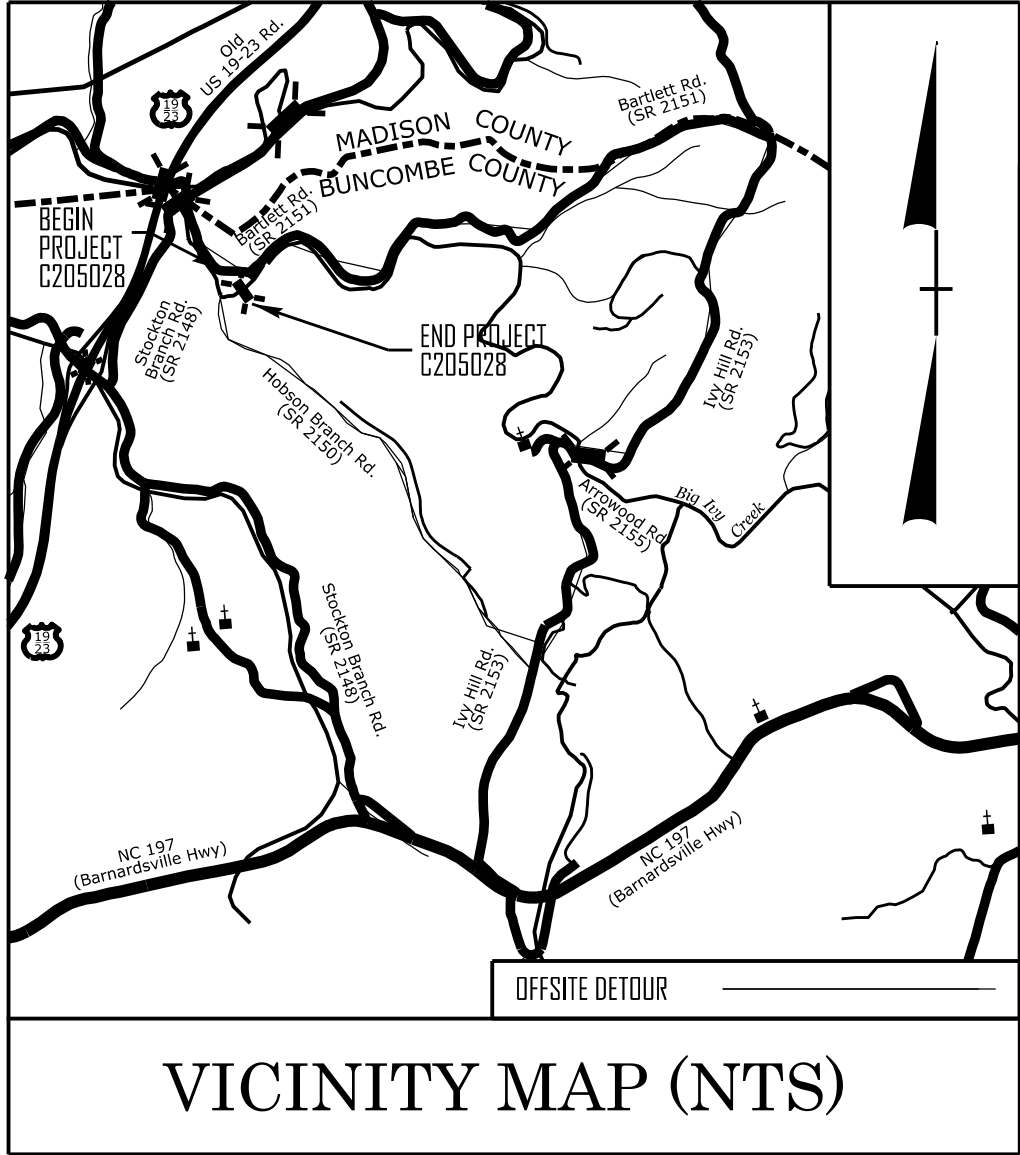

VICINITY MAP (NTS)

PERMIT DRAWING
SHEET 1 OF 5

STATE OF NORTH CAROLINA
DIVISION OF HIGHWAYS

BUNCOMBE COUNTY

LOCATION: *BRIDGE 100132 ON SR 2150 (HOBSON BRANCH ROAD)
OVER IVY CREEK*

TYPE OF WORK: *GRADING, DRAINAGE, PAVING, PAVEMENT MARKINGS
& STRUCTURE*

WETLAND AND SURFACE WATER IMPACTS PERMIT

STATE	STATE PROJECT REFERENCE NO.	SHEET NO.	TOTAL SHEETS
N.C.	C205028	11	
STATE PROJ. NO.		F. A. PROJ. NO.	DESCRIPTION
DF18313.2011366.PR			PE, ROW, UTIL., & CONSTRUCTION

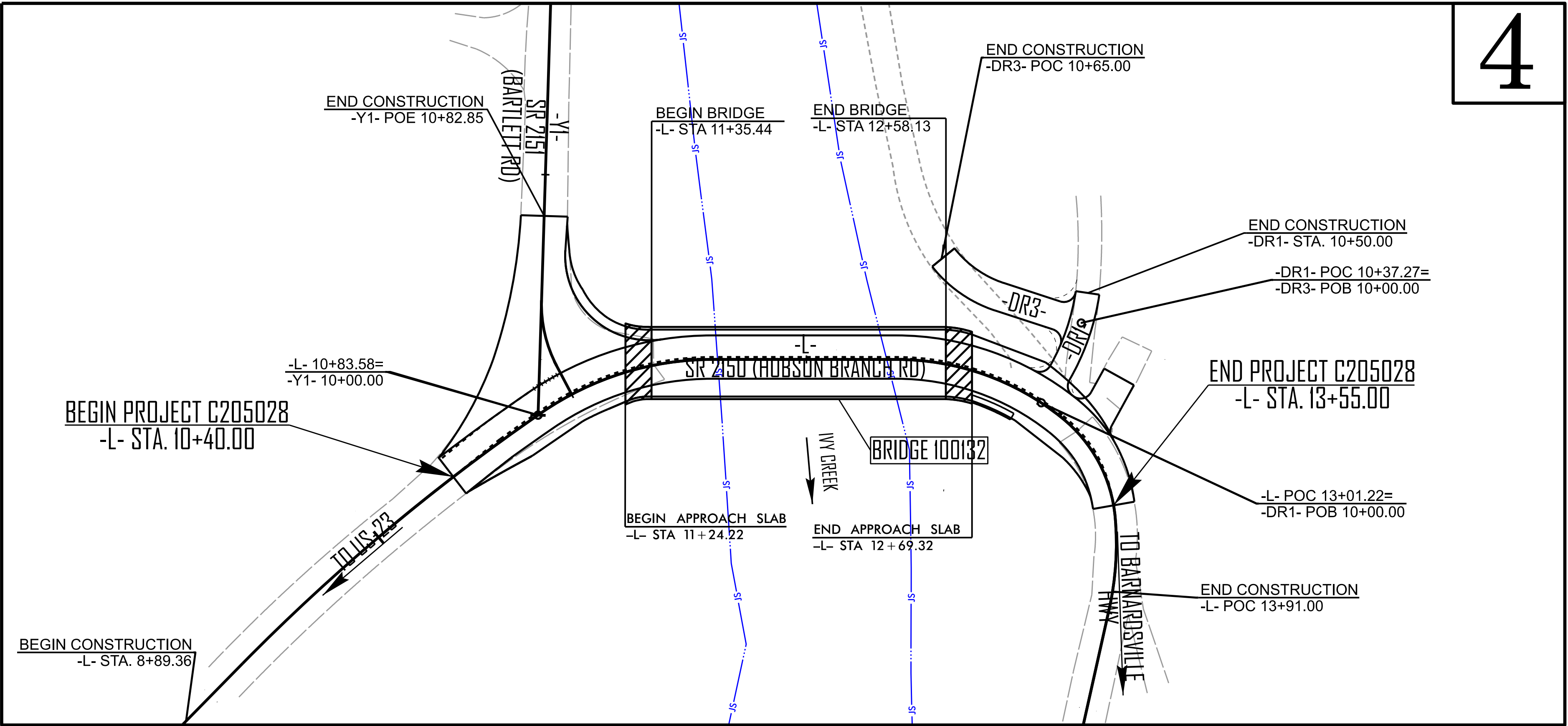
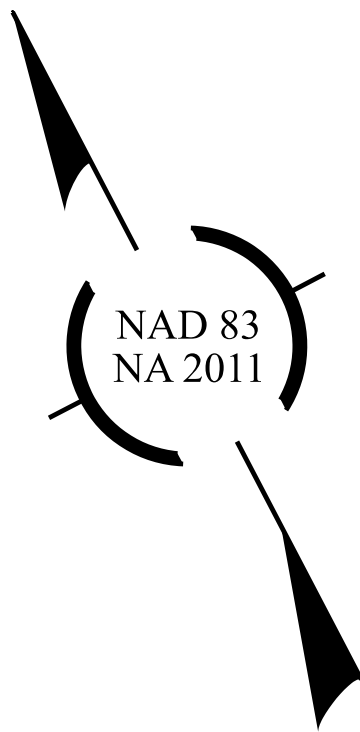
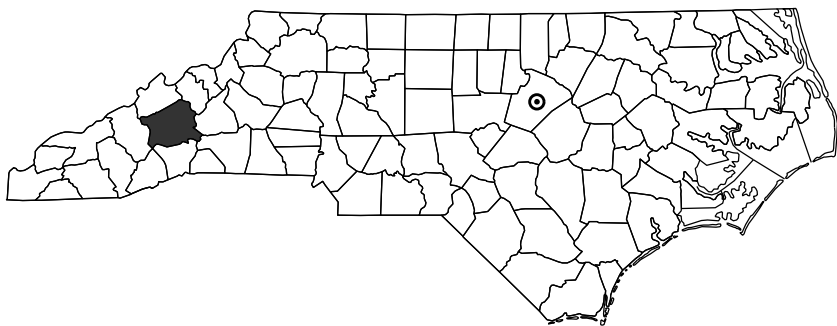

- NOTES:
1. CLEARING ON THIS PROJECT SHALL BE PERFORMED TO THE LIMITS ESTABLISHED BY METHOD II MODIFIED.
2. PROJECT NOT LOCATED WITHIN MUNICIPAL LIMITS.

PERMIT PLANS
SUBMITTAL NO. S-014
DATE: 09-16-2025

GRAPHIC SCALES

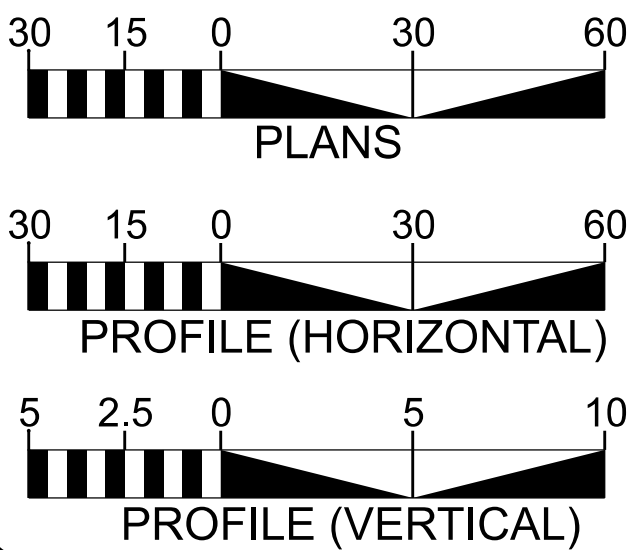

DESIGN DATA

ADT ____ = 490

K = N/A
D = N/A
T = 6 % *
V = 40 MPH
* TTST = 3% DUAL 3%
FUNC CLASS =
LOCAL RURAL
SUBREGIONAL TIER

PROJECT LENGTH

LENGTH OF ROADWAY PROJECT C205028 = 0.037 MILES
LENGTH OF STRUCTURE PROJECT C205028 = 0.023 MILE
TOTAL LENGTH OF PROJECT C205028 = 0.060 MILES

PLANS PREPARED BY:

RK&K

RUMMEL, KLEPPER & KAHL, LLP
8601 Six Forks Road, Fourth Floor 700
RALEIGH, NORTH CAROLINA 27615-3960
NC LICENSE NO. F-0112
1-888-521-4455 OR 919-878-9560

FOR NORTH CAROLINA DEPARTMENT OF TRANSPORTATION
2024 STANDARD SPECIFICATIONS

John R. Olinger, PE
PROJECT ENGINEER

Alexis MacPherson
PROJECT DESIGN ENGINEER

Todd Lapham
NCDOT CONTACT

LETTING DATE:
February 10, 2025

HYDRAULICS ENGINEER

SIGNATURE: P.E.
ROADWAY DESIGN ENGINEER

SIGNATURE: P.E.



TEMPORARY WORK PAD DETAIL
NOT TO SCALE

PERMIT DRAWING
SHEET 2 OF 5

EAST BANK

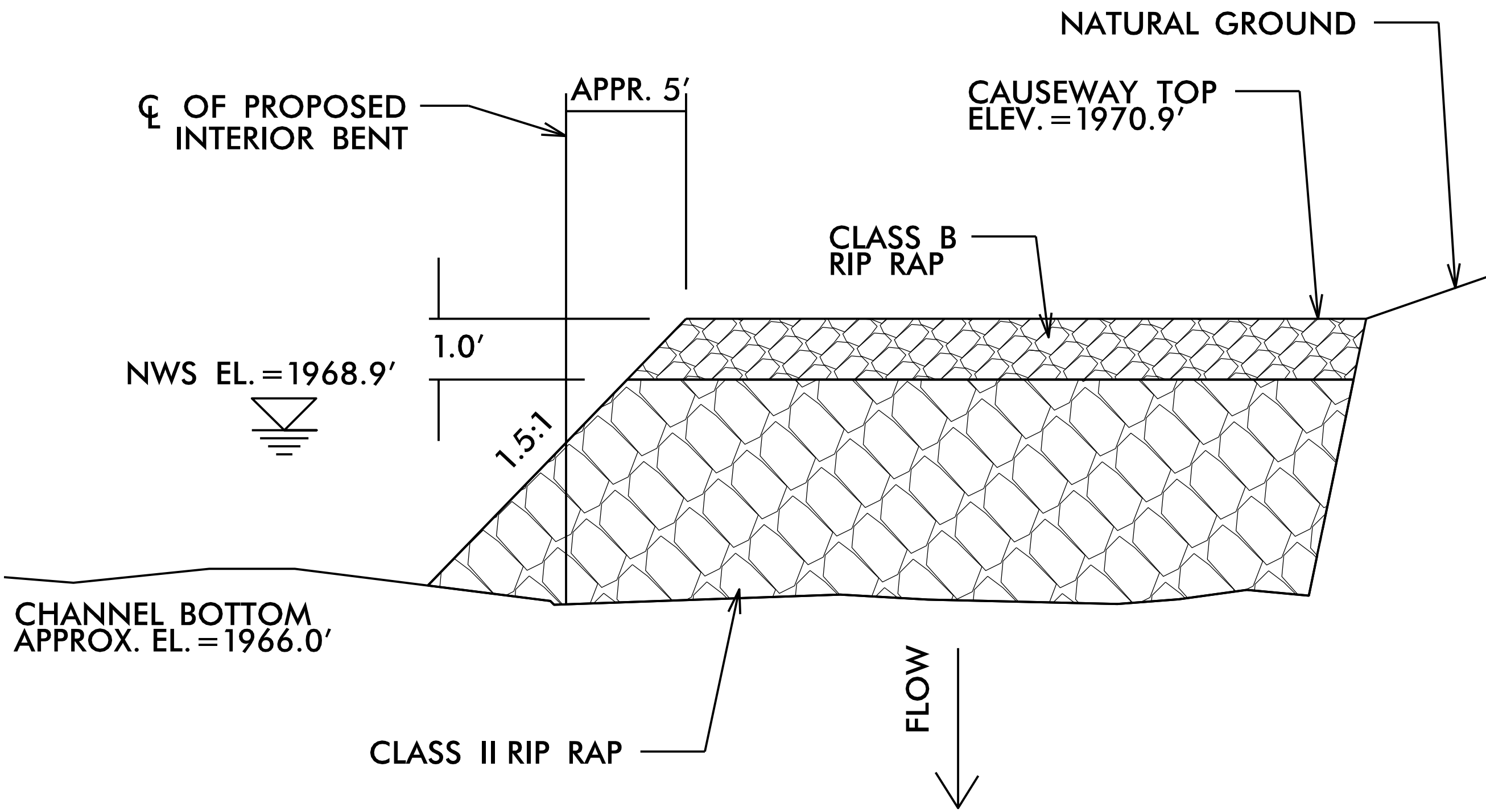
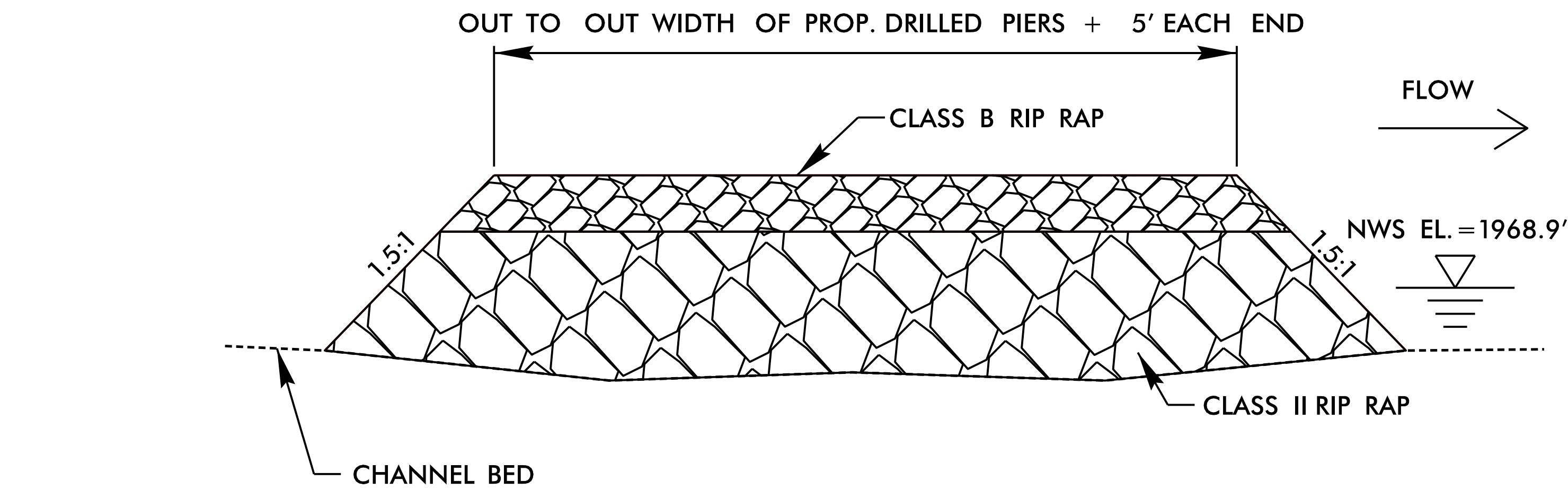

WORK PAD WILL NOT
BLOCK MORE THAN 50% OF
THE RIVER AT ANY ONE TIME

C205028

02

NORTH CAROLINA
DEPARTMENT OF TRANSPORTATION
BUNCOMBE COUNTY

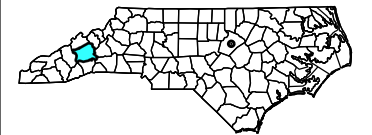

ROADWAY DESIGN UNIT
ROADWAY DESIGN
ENGINEER

HYDRAULICS
ENGINEER

INCOMPLETE PLANS
DO NOT BE USED FOR CONSTRUCTION

PREPARED BY



P: 919.878.3560
8601 Six Forks Road, Forum 1, Suite 700
Raleigh, North Carolina 27615-3960
NC License No. F-0112

Engineers | Construction Managers | Planners | Scientists

www.rk.com

Responsive People | Creative Solutions

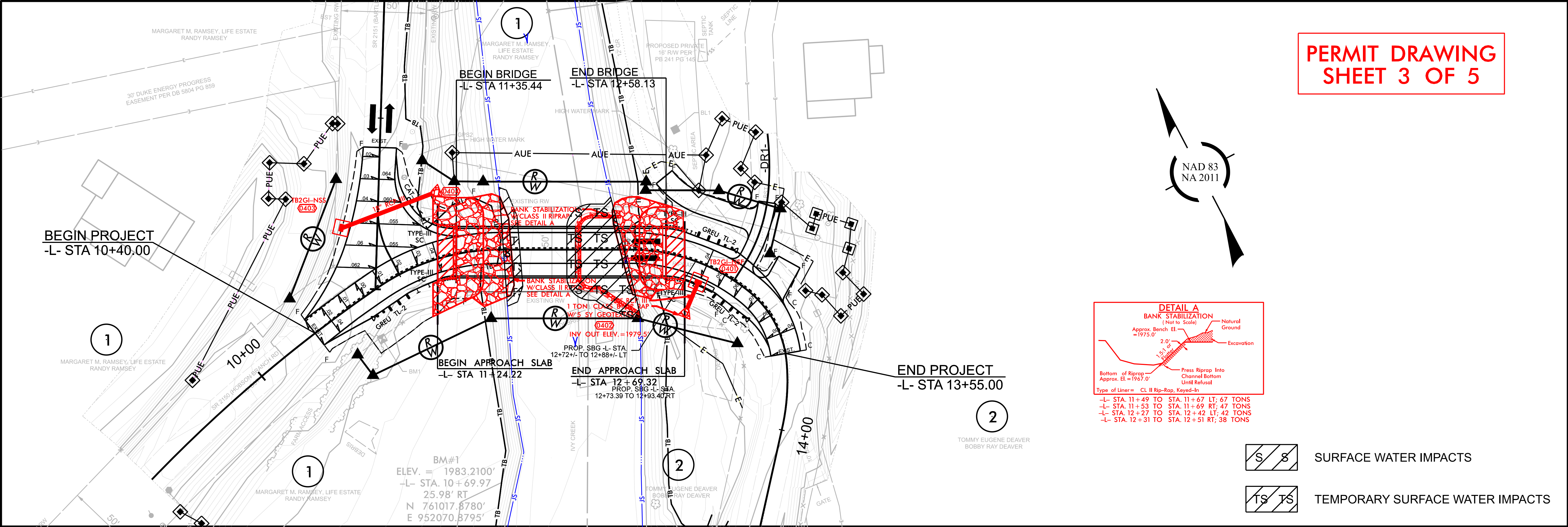

C205028

03

NORTH CAROLINA
DEPARTMENT OF TRANSPORTATION
BUNCOMBE COUNTY

ROADWAY DESIGN UNIT
ROADWAY DESIGN
ENGINEER

HYDRAULICS
ENGINEER

INCOMPLETE PLANS
DO NOT BE USED FOR CONSTRUCTION

PREPARED BY

RK&K

P: 919.878.5560
8601 Six Forks Road, Forum 1, Suite 700
Raleigh, North Carolina 27615-3960
NC License No. F-0112

Engineers | Construction Managers | Planners | Scientists
www.rkandk.com
Responsive People | Creative Solutions

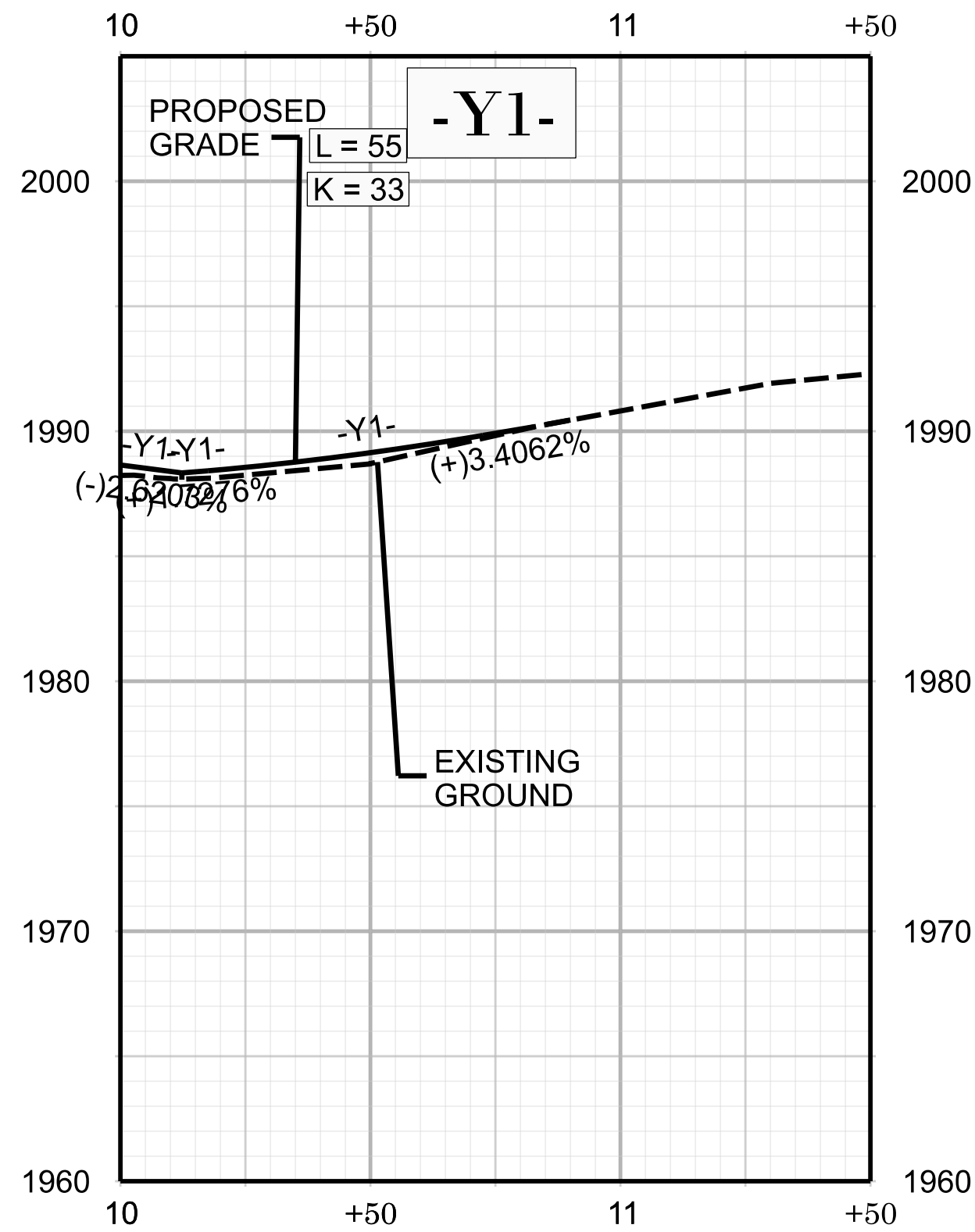
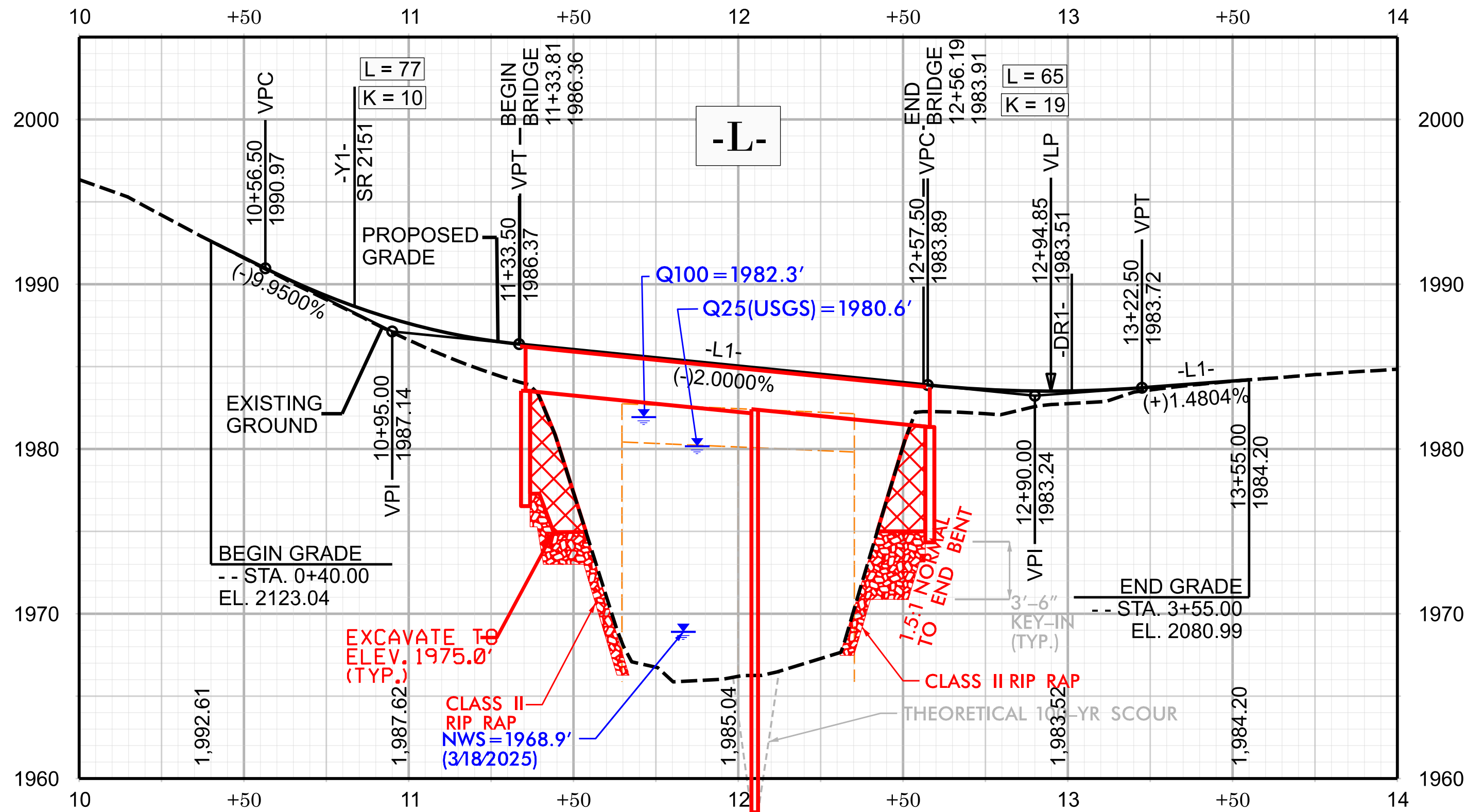

FOR -DR1- PROFILE, SEE SHEET 005
FOR -DR3- PROFILE, SEE SHEET 005

(NAD 83
NA 2011

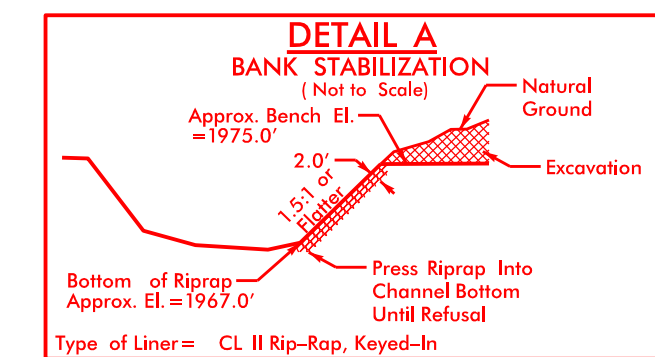
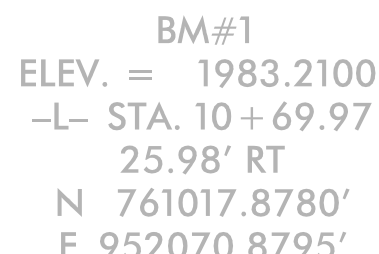

- L STA. 11+49 TO STA. 11+67 LT; 67 TONS
- L STA. 11+53 TO STA. 11+69 RT; 47 TONS
- L STA. 12+27 TO STA. 12+42 LT; 42 TONS
- L STA. 12+31 TO STA. 12+51 RT; 38 TONS

SURFACE WATER IMPACTS

TS TS

TEMPORARY SURFACE WATER IMPACTS

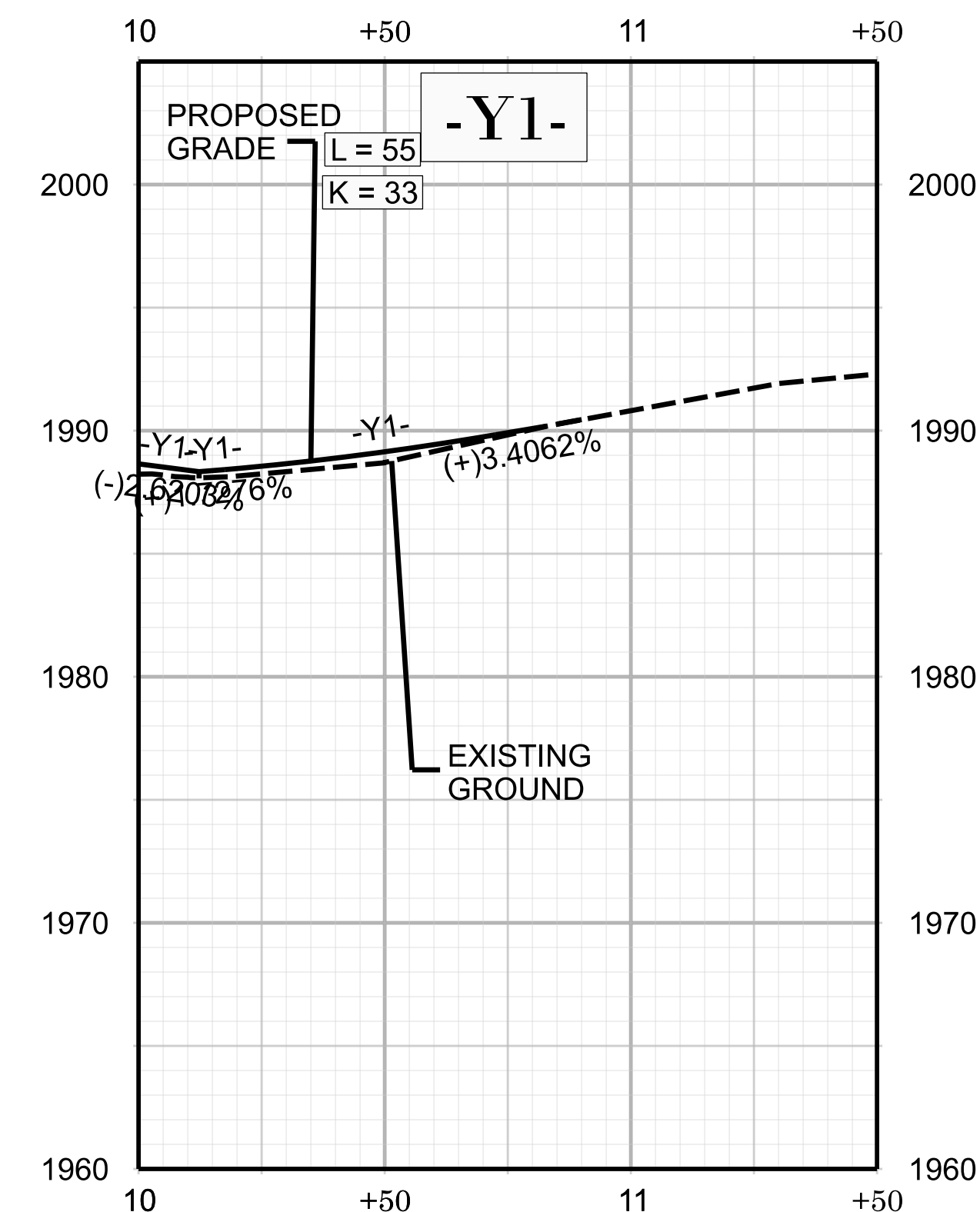
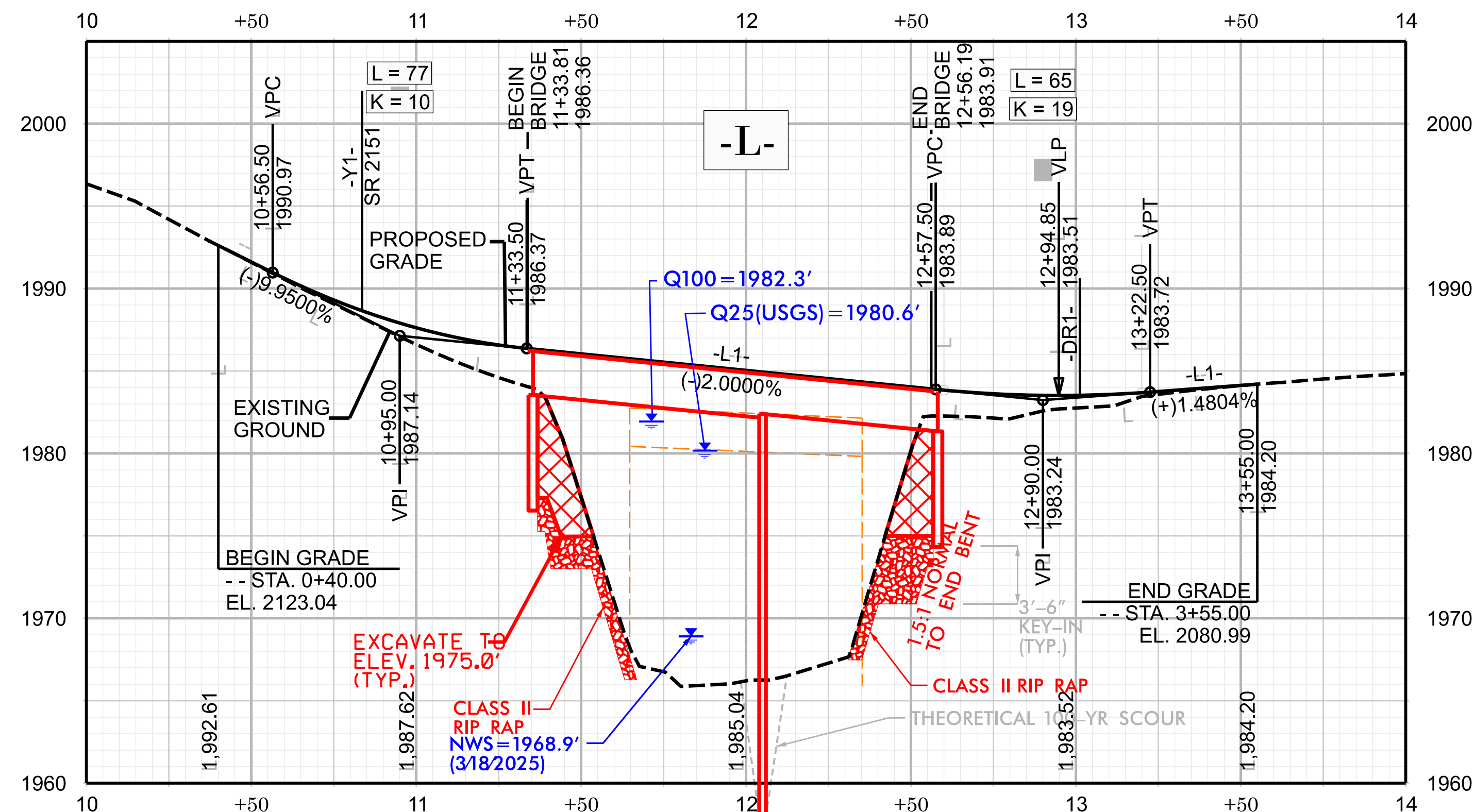

FOR -DR1- PROFILE, SEE SHEET 005
FOR -DR3- PROFILE, SEE SHEET 005

WETLAND AND SURACE WATER IMPACTS SUMMARY												
			WETLAND IMPACTS					SURFACE WATER IMPACTS				
Site No.	Station (From/To)	Structure Size / Type	Permanent Fill In Wetlands (ac)	Temp. Fill In Wetlands (ac)	Excavation in Wetlands (ac)	Mechanized Clearing in Wetlands (ac)	Hand Clearing in Wetlands (ac)	Permanent SW impacts (ac)	Temp. SW impacts (ac)	Existing Channel Impacts Permanent (ft)	Existing Channel Impacts Temp. (ft)	Natural Stream Design (ft)
1	-L- 11+63 - 11+71	Bank Stabilization						< 0.01	< 0.01	59	65	
	-L- 12+05 - 12+31	Causeway/Impervious Dike						< 0.01	0.03		71	
TOTALS*:								0.01	0.04	59	136	0

NOTES:
Jurisdictional Stream Within Project Limits
No Wetlands Within Project Limits
Permanent Impacts due to Interior Bent with (3) @ 3' diameter Drilled Shafts within JS = 21.2 sf of Permanent SW Impacts

Revised 2018 Feb

C205028

SHEET 5 OF 5