

•

Type I or II Categorical Exclusion Action Classification Form

STIP Project No.	<u>HL-0012</u>
WBS Element	<u>49468</u>
Federal Project No.	<u>N/A</u>

A. Project Description:

Pedestrian improvements and a right turn lane on the I-240 Eastbound off-ramp at Charlotte Street, Buncombe County, NC.

B. Description of Need and Purpose:

The project will reduce traffic congestion and increase pedestrian safety. The current interchange does not provide adequate storage and the pedestrian facilities need upgrades.

C. Categorical Exclusion Action Classification:

Type I(A) - Ground Disturbing Action

D. Proposed Improvements:

The project will construct crosswalks with pedestrian signals and add a turn lane to the east bound off ramp of I-240 at Charlotte Street (US 70). Total project length will be 0.21 mile.

*NOTE: The following Type I(C) Actions (NCDOT-FHWA 2019 CE Agreement, Appendix A) only require completion of Sections A through D to substantiate and document the CE classification: 1, 5, 8 (signs and pavement markings only), 11, 13, 14, 15, 16, 17, 19, and 20; or several other Type I Action subcategories identified in past NCDOT-FHWA CE Programmatic Agreements (see Appendix D). **Pre-approval as a CE does not exempt activities from compliance with other federal environmental laws.***

E. Special Project Information:

F. Project Impact Criteria Checklists:

F2. Ground Disturbing Actions – Type I (Appendix A) & Type II (Appendix B)				
<p>Proposed improvement(s) that fit Type I Actions (NCDOT-FHWA CE Programmatic Agreement, Appendix A) including 2, 3, 6, 7, 9, 12, 18, 21, 22 (ground disturbing), 23, 24, 25, 26, 27, 28, &/or 30; &/or Type II Actions (NCDOT-FHWA CE Programmatic Agreement, Appendix B) answer the project impact threshold questions (below) and questions 8 – 31.</p> <ul style="list-style-type: none"> • <i>If any question 1-7 is checked “Yes” then NCDOT certification for FHWA approval is required.</i> • <i>If any question 8-31 is checked “Yes” then additional information will be required for those questions in Section G.</i> 				
<u>PROJECT IMPACT THRESHOLDS</u> (FHWA signature required if any of the questions 1-7 are marked “Yes”.)			Yes	No
1	Does the project require formal consultation with U.S. Fish and Wildlife Service (USFWS) or National Marine Fisheries Service (NMFS)?	<input type="checkbox"/>	<input checked="" type="checkbox"/>	
2	Does the project result in impacts subject to the conditions of the Bald and Golden Eagle Protection Act (BGEPA)?	<input type="checkbox"/>	<input checked="" type="checkbox"/>	
3	Does the project generate substantial controversy or public opposition, for any reason, following appropriate public involvement?	<input type="checkbox"/>	<input checked="" type="checkbox"/>	
4	Does the project cause disproportionately high and adverse impacts relative to low-income and/or minority populations?	<input type="checkbox"/>	<input checked="" type="checkbox"/>	
5	Does the project involve a residential or commercial displacement, or a substantial amount of right of way acquisition?	<input type="checkbox"/>	<input checked="" type="checkbox"/>	
6	Does the project require an Individual Section 4(f) approval?	<input type="checkbox"/>	<input checked="" type="checkbox"/>	
7	Does the project include adverse effects that cannot be resolved with a Memorandum of Agreement (MOA) under Section 106 of the National Historic Preservation Act (NHPA) or have an adverse effect on a National Historic Landmark (NHL)?	<input type="checkbox"/>	<input checked="" type="checkbox"/>	
If any question 8-31 is checked “Yes” then additional information will be required for those questions in Section G.				
<u>Other Considerations</u>			Yes	No
8	Is an Endangered Species Act (ESA) determination unresolved or is the project covered by a Programmatic Agreement under Section 7?	<input type="checkbox"/>	<input checked="" type="checkbox"/>	
9	Is the project located in anadromous fish spawning waters?	<input type="checkbox"/>	<input checked="" type="checkbox"/>	
10	Does the project impact waters classified as Outstanding Resource Water (ORW), High Quality Water (HQW), Water Supply Watershed Critical Areas, 303(d) listed impaired water bodies, buffer rules, or Submerged Aquatic Vegetation (SAV)?	<input type="checkbox"/>	<input checked="" type="checkbox"/>	
11	Does the project impact Waters of the United States in any of the designated mountain trout streams?	<input type="checkbox"/>	<input checked="" type="checkbox"/>	
12	Does the project require a U.S. Army Corps of Engineers (USACE) Individual Section 404 Permit?	<input type="checkbox"/>	<input checked="" type="checkbox"/>	
13	Will the project require an easement from a Federal Energy Regulatory Commission (FERC) licensed facility?	<input type="checkbox"/>	<input checked="" type="checkbox"/>	

<u>Other Considerations for Type I and II Ground Disturbing Actions (continued)</u>		Yes	No
14	Does the project include a Section 106 of the National Historic Preservation Act (NHPA) effects determination other than a No Effect, including archaeological remains?	<input type="checkbox"/>	<input checked="" type="checkbox"/>
15	Does the project involve GeoEnvironmental Sites of Concerns such as gas stations, dry cleaners, landfills, etc.?	<input type="checkbox"/>	<input checked="" type="checkbox"/>
16	Does the project require work encroaching and adversely affecting a regulatory floodway or work affecting the base floodplain (100-year flood) elevations of a water course or lake, pursuant to Executive Order 11988 and 23 CFR 650 subpart A?	<input type="checkbox"/>	<input checked="" type="checkbox"/>
17	Is the project in a Coastal Area Management Act (CAMA) county and substantially affects the coastal zone and/or any Area of Environmental Concern (AEC)?	<input type="checkbox"/>	<input checked="" type="checkbox"/>
18	Does the project require a U.S. Coast Guard (USCG) permit?	<input type="checkbox"/>	<input checked="" type="checkbox"/>
19	Does the project involve construction activities in, across, or adjacent to a designated Wild and Scenic River present within the project area?	<input type="checkbox"/>	<input checked="" type="checkbox"/>
20	Does the project involve Coastal Barrier Resources Act (CBRA) resources?	<input type="checkbox"/>	<input checked="" type="checkbox"/>
21	Does the project impact federal lands (e.g. U.S. Forest Service (USFS), USFWS, etc.) or Tribal Lands?	<input type="checkbox"/>	<input checked="" type="checkbox"/>
22	Does the project involve any changes in access control or the modification or construction of an interchange on an interstate?	<input type="checkbox"/>	<input checked="" type="checkbox"/>
23	Does the project have a permanent adverse effect on local traffic patterns or community cohesiveness?	<input type="checkbox"/>	<input checked="" type="checkbox"/>
24	Will maintenance of traffic cause substantial disruption?	<input type="checkbox"/>	<input checked="" type="checkbox"/>
25	Is the project inconsistent with the STIP, and where applicable, the Metropolitan Planning Organization's (MPO's) Transportation Improvement Program (TIP)?	<input type="checkbox"/>	<input checked="" type="checkbox"/>
26	Does the project require the acquisition of lands under the protection of Section 6(f) of the Land and Water Conservation Act, the Federal Aid in Fish Restoration Act, the Federal Aid in Wildlife Restoration Act, Tennessee Valley Authority (TVA), Tribal Lands, or other unique areas or special lands that were acquired in fee or easement with public-use money and have deed restrictions or covenants on the property?	<input type="checkbox"/>	<input checked="" type="checkbox"/>
27	Does the project involve Federal Emergency Management Agency (FEMA) buyout properties under the Hazard Mitigation Grant Program (HMGP)?	<input type="checkbox"/>	<input checked="" type="checkbox"/>
28	Does the project include a <i>de minimis</i> or programmatic Section 4(f)?	<input type="checkbox"/>	<input checked="" type="checkbox"/>
29	Is the project considered a Type I under the NCDOT Noise Policy?	<input type="checkbox"/>	<input checked="" type="checkbox"/>
30	Is there prime or important farmland soil impacted by this project as defined by the Farmland Protection Policy Act (FPPA)?	<input type="checkbox"/>	<input checked="" type="checkbox"/>
31	Are there other issues that arose during the project development process that affected the project decision?	<input type="checkbox"/>	<input checked="" type="checkbox"/>

G. Additional Documentation as Required from Section F (ONLY for questions marked 'Yes'):

H. Project Commitments (attach as Green Sheet to CE Form):

NCDOT PROJECT COMMITMENTS

STIP Project No. **HL-0012**
I-240 at Charlotte Street (US 70)
Buncombe County
Federal Aid Project No. N/A
WBS Element 49468

1. Best Management Practices(BMP) for erosion control as prescribed by construction plans will be required throughout construction. NPDES Forms will be required per the NC DOT General Permit.

I. Categorical Exclusion Approval:

STIP Project No.	HL-0012
WBS Element	49468
Federal Project No.	N/A

Prepared By:

06/06/2022

Date

DocuSigned by:
Roger D. Bryan
33212C738EB8411...

Roger D. Bryan, Division 13 Environmental Program Supervisor

Prepared For:

NC Department of Transportation

Reviewed By:

06/06/2022

Date

DocuSigned by:
Mike Clark
EEC83FE49E092418...

Mike Clark, Division 13 Project Engineer



Approved

- If NO grey boxes are checked in Section F (pages 2 and 3), NCDOT approves the Type I or Type II Categorical Exclusion.



Certified

- If ANY grey boxes are checked in Section F (pages 2 and 3), NCDOT certifies the Type I or Type II Categorical Exclusion for FHWA approval.
- If classified as Type III Categorical Exclusion.

06/07/2022

Date

DocuSigned by:
Steve Cannon
0FECB6ABFE95408...

Steve Cannon, P.E., Division 13 Project Development Engineer
North Carolina Department of Transportation

FHWA Approved: For Projects Certified by NCDOT (above), FHWA signature required.

Date

for John F. Sullivan, III, PE, Division Administrator
Federal Highway Administration

09/08/99

See Sheet 1A For Index of Sheets

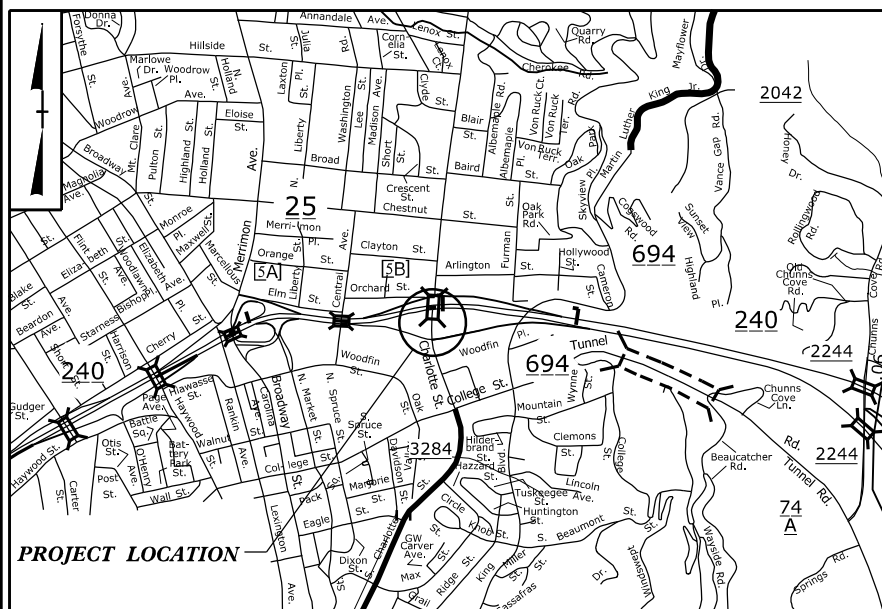

PROJECT LOCATION

VICINITY MAP

N.T.S

STATE OF NORTH CAROLINA
DIVISION OF HIGHWAYS

BUNCOMBE COUNTY

**LOCATION: I-240 AT US70 (CHARLOTTE ST.)
INTERSECTIONS**

**TYPE OF WORK: PEDESTRIAN IMPROVEMENTS AND A RIGHT TURN
LANE ON THE I-240 EASTBOUND OFF-RAMP**

STATE	STATE PROJECT REFERENCE NO.	SHEET NO.	TOTAL SHEETS
N.C.	HL-0012	1	
STATE PROJ. NO.	F.A. PROJ. NO.	DESCRIPTION	

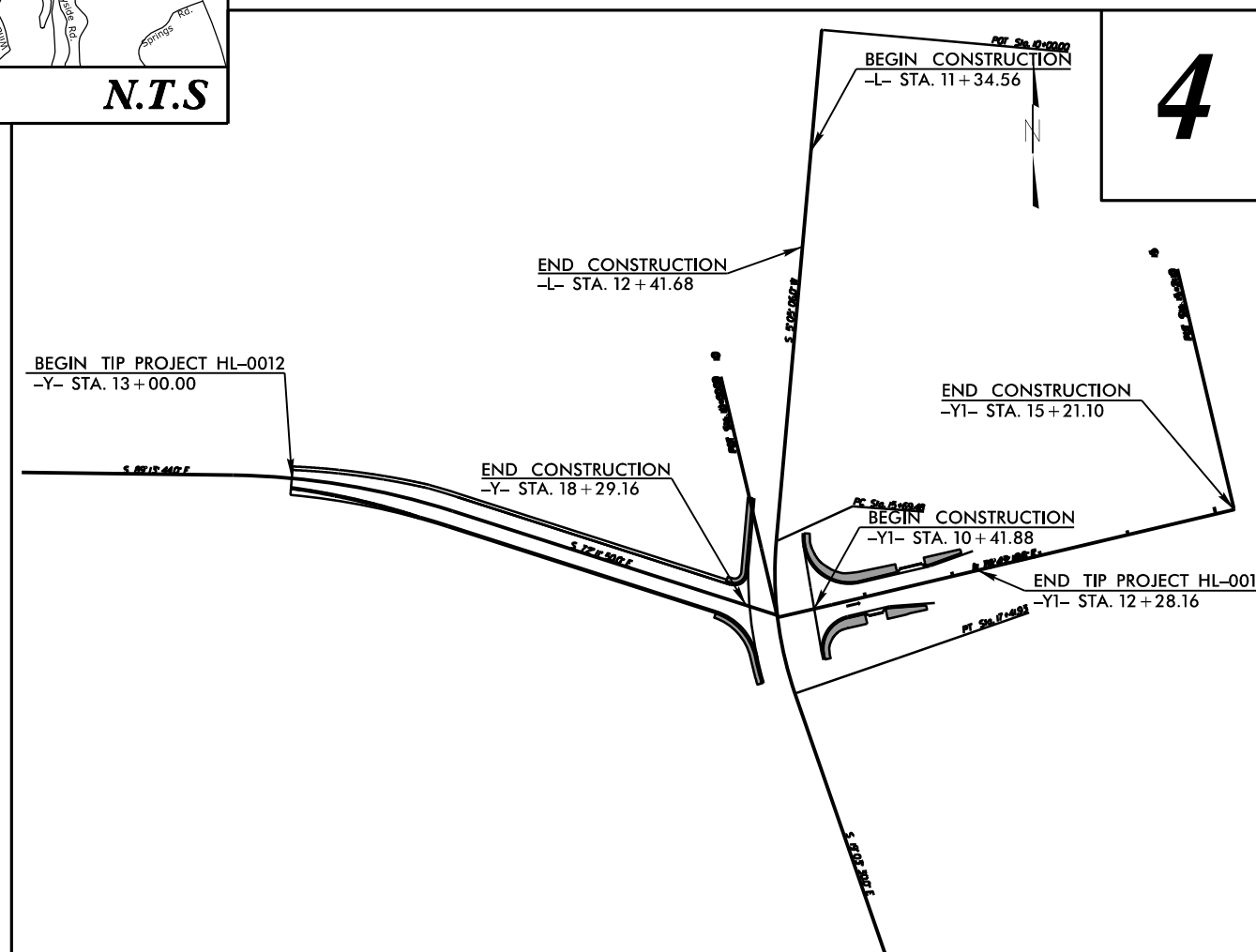
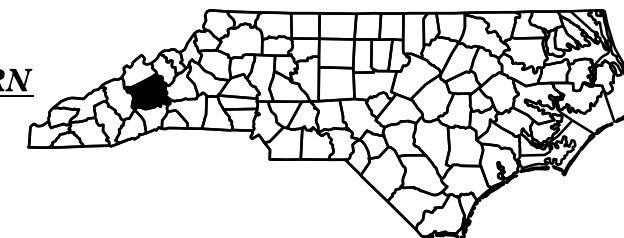

INCOMPLETE PLANS
DO NOT USE FOR R/W ACQUISITION
DOCUMENT NOT CONSIDERED FINAL
UNLESS ALL SIGNATURES COMPLETED

CONTRACT: TIP PROJECT: HL-0012

CONTRACT:

GRAPHIC SCALES

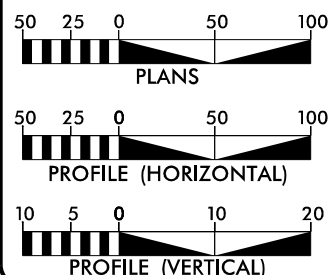

DESIGN DATA

ADT _____ = _____
ADT _____ = _____
K = _____ %
D = _____ %
T = _____ % *
V = _____ MPH
* TTST = _____ DUAL _____
FUNC CLASS = _____

PROJECT LENGTH

LENGTH ROADWAY TIP PROJECT HL-0012 = 0.21 MILES

Prepared in the Office of:
DIVISION OF HIGHWAYS
55 Orange St., Asheville NC, 28801

2018 STANDARD SPECIFICATIONS

RIGHT OF WAY DATE:

PROJECT ENGINEER

LETTING DATE:

PROJECT DESIGN ENGINEER

HYDRAULICS ENGINEER

SIGNATURE: _____ P.E.

ROADWAY DESIGN ENGINEER

SIGNATURE: _____ P.E.

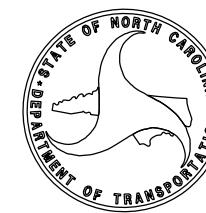

20-MAY-2022 13:41 S:\DCC\Projects\Buncombe\HL0012\Roadway\Proj\HL-0012_ddc_tsh.dgn

PROJECT REFERENCE NO. HL-0012	SHEET NO. 4
RW SHEET NO.	
ROADWAY DESIGN ENGINEER	HYDRAULICS ENGINEER
INCOMPLETE PLANS DO NOT USE FOR R/W ACQUISITION	
DOCUMENT NOT CONSIDERED FINAL UNLESS ALL SIGNATURES COMPLETED	

-L-	-Y-
PI Sta 16+57.01	PI Sta 13+59.69
$\Delta = 24^{\circ} 08' 36.0''$ (LT)	$\Delta = 17^{\circ} 01' 54.0''$ (RT)
D = 14' 00" 00.0"	D = 6' 51" 51.1"
L = 172.45'	L = 248.12'
T = 87.53'	T = 124.98'
R = 409.26'	R = 834.70'

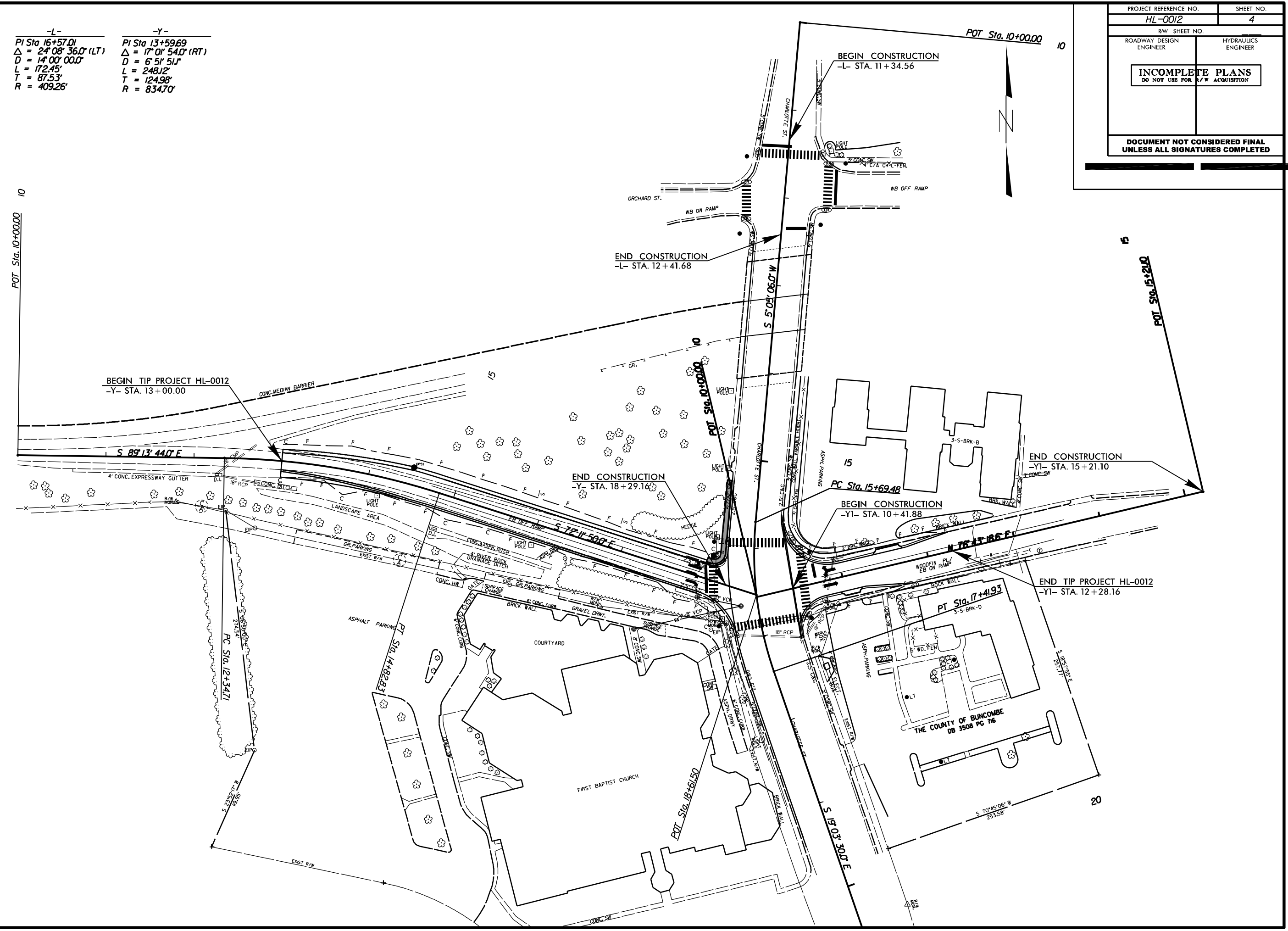

REVISIONS

19-MAY-2022 08:49 S:\DDC\Projects\Buncombe\HL0012\Roadway\Proj\HL0012_ddc_psh_4.dgn
 8/17/99

Cultural Resources Programmatic Agreement Screening Checklist for Section 106

Project TIP: HL-0012 **FA:** **WBS:** 49468
Project Name: Pedestrian crosswalk/turn lane **County:** Buncombe
Project Description: Pedestrian Crosswalk/Turn Lane
Funding Source: Federal **Lead Federal Agency:** FHWA
Permits Anticipated: None

Instructions:

NCDOT Project Managers, Project Engineers, or the Division Environmental Staff shall complete the following checklist based upon knowledge of the project site and adjacent parcels. Webservice (<https://www.ncdcr.gov/about/history/division-historical-resources/gis-maps-and-data>) should be reviewed for NRHP Eligible or Listed Buildings, Districts, Objects, Sites, or Structures. Before checking “Unable to Determine”, efforts should be made to acquire any available information. If the answer to any question is “Yes” or “Unable to Determine”, the undertaking is subject to further historic preservation review by NCDOT Cultural Resources staff. If answers to all the questions are “No”, the undertaking will be considered to have *Little Potential to Cause Effects – Exempt Activities* and excluded from further historic preservation review, until differing information is discovered. Please reference “Appendix A *Exempt Activities Under Section 106*” of the Programmatic Agreement for Transportation Program in North Carolina prior to completion.

	Yes	No	Unable to Determine
A. Would this activity have the potential to cause effects on historic properties, assuming historic properties are present? See list in Appendix A.		X	
B. Is this project directly related to other actions with individually insignificant, but cumulatively significant environmental effects?		X	
C. Are you aware of any concerns raised by the owner of a historic property or public controversy for this undertaking?		X	
D. Locations of cemeteries have been found on the webservice? (https://www.ncdcr.gov/about/history/division-historical-resources/gis-maps-and-data)		X	

By my signature, I certify that I have completed a site visit or am familiar with the specifics of the project and to the best of my knowledge answers to the questions above are correct. I also understand that no further environmental analysis is required at this time, as all of the answers are “No”.

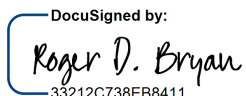
Roger D. Bryan  06/06/2022
33212C738EB8411

Name (print) Signature Date