

North Carolina Department of Transportation

NEPA/SEPA Consultation Form

STIP Project No. BR-0009
WBS Element 67009.1.1
Federal Aid Project No. N/A

A. Project Description, Location, and Purpose:

This project replaces Bridge No. 100079 on NC 9 over the Broad River in Buncombe County. The bridge will be replaced on the existing alignment using an on-site detour. This bridge will include two 11-foot lanes and a 4-foot shoulder and a minimum of 4-foot paved shoulders on the approaches. The approach roadway will extend approximately 260 feet from the west end of the new bridge and 294 feet from the east end of the new bridge. The roadway will be designed as a Collector using Regional Tier Guidelines with a 30 mph design speed.

B. Consultation Phase: (Check one)

- Right-of-Way
 Construction
 Other: Identify the trigger – (e.g., design change, change in impacts)

C. NEPA/SEPA Class of Action Initially Approved as: (Check one)

- SEPA MCDC 04/06/2019

Additional Notes:

D. Changes in Proposed Action & Environmental Consequences:

Protected Species: Northern long-eared bat (*Myotis septentrionalis*) There are no changes to the list of Federal Protected Species for Buncombe County since the completion of the MCDC. Due to the document type and the state funding for this project, the USACE was the lead federal agency for this project. By way of project permitting the USACE has resolved Section 7 for this project.

Water Resources: Water Resources and classifications in the project area have not changed since the completion of the MCDC.

Section 106: NCDOT has reviewed the Section 106 effects findings for historic properties within the project's area of potential effects (APE), that were made as part of the NEPA analysis. NCDOT has confirmed there is no new information that would alter the original Section 106 findings and, therefore, they remain valid.

Design Changes: There have been no design changes since the completion of the MCDC.

E. Conclusion:

The above NEPA/SEPA documentation has been reevaluated (as required by either 23 CFR 771 or by NC General Statute Chapter 113A Article 1). It has been determined that the current proposed action is essentially the same as the original proposed action. Proposed changes, if any, are noted in Section D. It has been determined that anticipated social, economic, and environmental impacts were accurately described in the above referenced document(s) unless noted otherwise herein. Therefore, the original Administration Action remains valid.

F. Coordination

NCDOT personnel have discussed the current project parameters with qualified NCDOT representatives and FHWA (where applicable). The NCDOT Project Manager, Nora McCann, EIT, hereby verifies the involvement of the following staff and the incorporation of their technical input:

Design Engineer:	Scott Schiflett, PE	11/24/2020
Environmental Specialist:	Michael Turchy	12/8/2020
Hydraulic Engineer:	N/A	N/A
Architectural Historian:	N/A	N/A
FHWA (if Applicable):	N/A	N/A

G. Consultation Approval for NCDOT Project BR-0009

Prepared By:

1/7/2021

Date

DocuSigned by:

Nora McCann

Nora McCann, EIT
NCDOT, Project Management Unit

Prepared For:

DocuSigned by:

Jacquelyn Bowles

Jacquelyn Bowles, PE
NCDOT, Structures Management Unit

Reviewed By:

1/7/2021

Date

DocuSigned by:

John Jamison

John Jamison, Team Lead
NCDOT, Environmental Policy Unit

Approved In adherence with 23 CFR 771 (NEPA) or NC General Statute Chapter 113A Article 1 (SEPA), NCDOT approves this Consultation.
or

Certified NCDOT staff certifies if FHWA signature was previously required or where changes have resulted in FHWA signature being required.

1/8/2021

Date

DocuSigned by:

A4A2999A8BC64F2...

David Stutts, PE – Project Engineer – PEF/Program Management
North Carolina Department of Transportation

FHWA Approved: FHWA signature required for Type I(B) CE, Type II(B) CE, Type III CE, FONSI or ROD.

Date

N/A
John F. Sullivan, III, PE, Division Administrator
Federal Highway Administration

H. Project Commitments (as of December 2020)

Project Commitments

Buncombe County
Replacement of Bridge #100079 on NC 9
over the Broad River
WBS No. 67009.1.1
TIP No. BR-0009

COMMITMENTS FROM DESIGN

Status for the project commitments as shown in the CE are printed in italics

Trout Moratorium. The U.S. Army Corps of Engineers (USACE) and the North Carolina Department of Environmental Quality (NCDEQ) have identified the section of Broad River within the project study area as within a designated trout watershed. Therefore, a mandatory trout moratorium is required for any in-stream work from October 15 to April 15 unless prior written approval is obtained from the North Carolina Wildlife Resources Commission (NCWRC). However, the project is not proposing any direct impacts to the Broad River, and proper erosion and sediment control will be established to protect the stream during construction.

Status: There are four Special Conditions from the 404 Permit issued on 12/17/2019 and they are listed below.

Northern Long-Eared Bat (NLEB). Construction activities for this project will not take place until Endangered Species Act Compliance is satisfied for NLEB.

Status: The USACE has resolved Section 7 of the Endangered Species Act and complied with this Act and has subsequently issued a permit for the bridge replacement. Memo dated 12/8/2020 from Michael Turchy, NCDOT Environmental Coordination and Permitting.

COMMITMENTS FROM PERMITTING

Special Conditions from 404 Permit issued 12/17/2019:

1. All work must be performed in strict compliance with the description of work and plans in the application dated October 17, 2019. Any modification to the description of work and/or the permit plans must be approved by the USACE prior to implementation.
2. The permittee shall ensure that no in-stream work is conducted between October 15th and April 15th of any year due to trout moratoria. If the North Carolina Wildlife Resources Commission notifies you that they have waived this requirement, please contact this office.

3. The permittee shall avoid impacting archaeological site 31BN1036; this includes ensuring that equipment and/or materials are not staged at/on this site.

4. The permittee shall require its contractors and/or agents to comply with the terms and conditions of this authorization letter in the construction and maintenance of this project, and shall provide each of its contractors and/or agents associated with the construction or maintenance of this project with a copy of this authorization letter, all conditions, and any authorized modifications. A copy of this authorization letter, all conditions, and any authorized modifications, shall be available at the project site during construction and maintenance of this project.

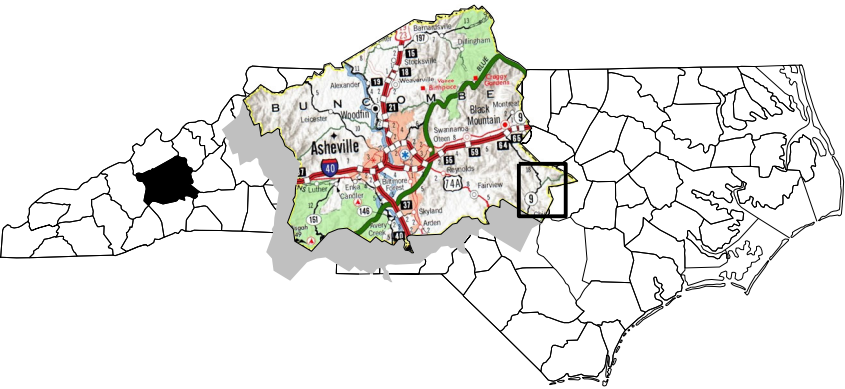
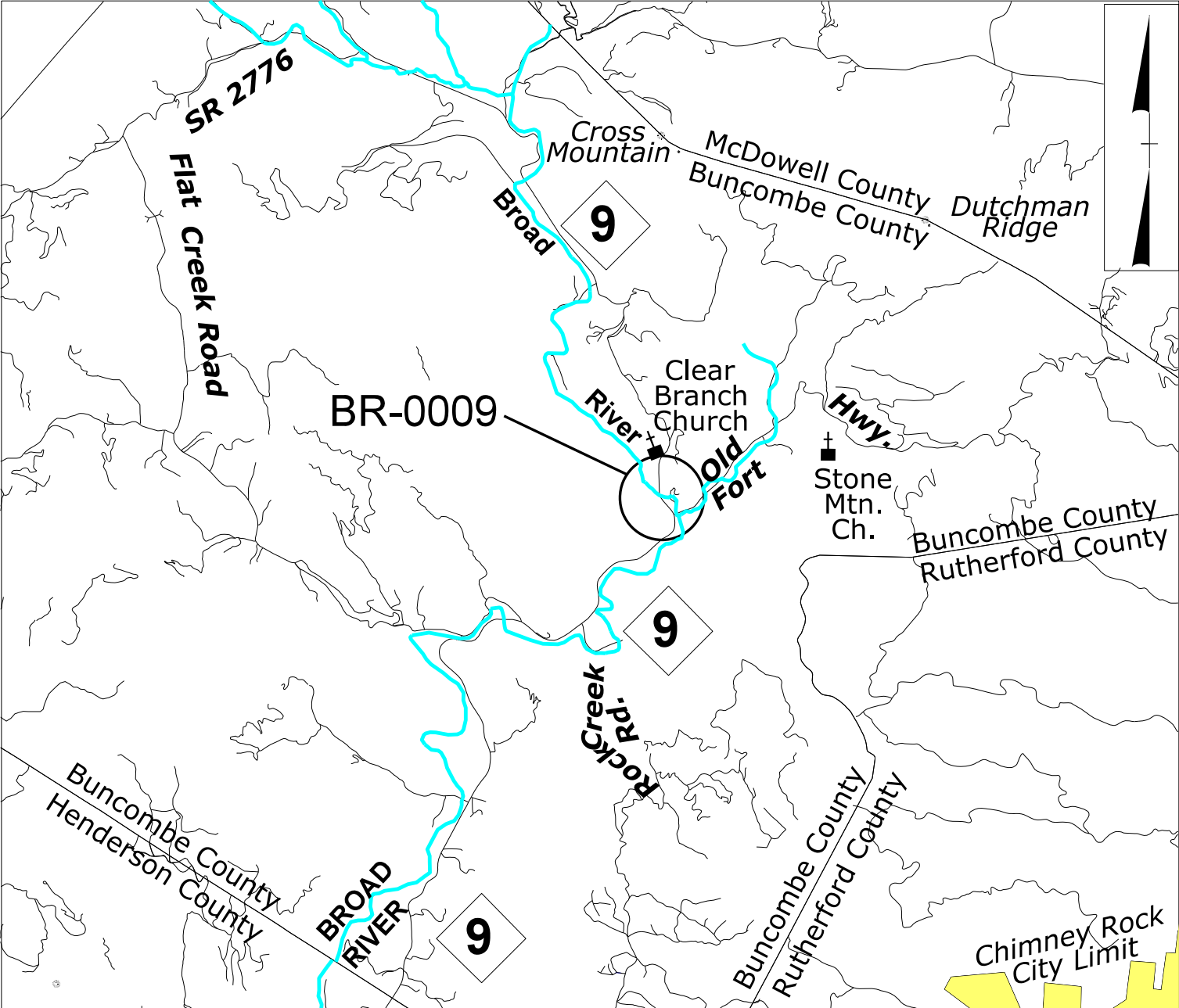

ATCS[®]

100 REGENCY FOREST DR., SUITE 130
CARY, NORTH CAROLINA 27518
919-341-9418 <http://www.atcsplc.com/>
NC LICENSE NO. P-0192

ENGINEERING | PLANNING | SURVEYING | ENVIRONMENTAL

BUNCOMBE COUNTY
REPLACE BRIDGE NO. 100079
OVER BROAD RIVER ON NC 9
STIP # BR-0009
WBS Element No. 67009.1.1

09.08/99

See Sheet 1A For Index of Sheets
See Sheet 1B For Conventional Plan Sheet Symbols

STATE OF NORTH CAROLINA
DIVISION OF HIGHWAYS

BUNCOMBE COUNTY

LOCATION: BRIDGE NO. 100079 OVER BROAD RIVER ON NC 9

TYPE OF WORK: GRADING, DRAINAGE, PAVING AND STRUCTURE

STATE	STATE PROJECT REFERENCE NO.	SHEET NO.	TOTAL SHEETS
N.C.	BR-0009	1	
STATE PROJ. NO.	F.A. PROJ. NO.	DESCRIPTION	
67009.1.1	N/A	P.E.	
67009.2.1	N/A	R/W & UTILITIES	
67009.3.1	N/A	CONST.	

TIP PROJECT: BR-0009

CONTRACT: C204386

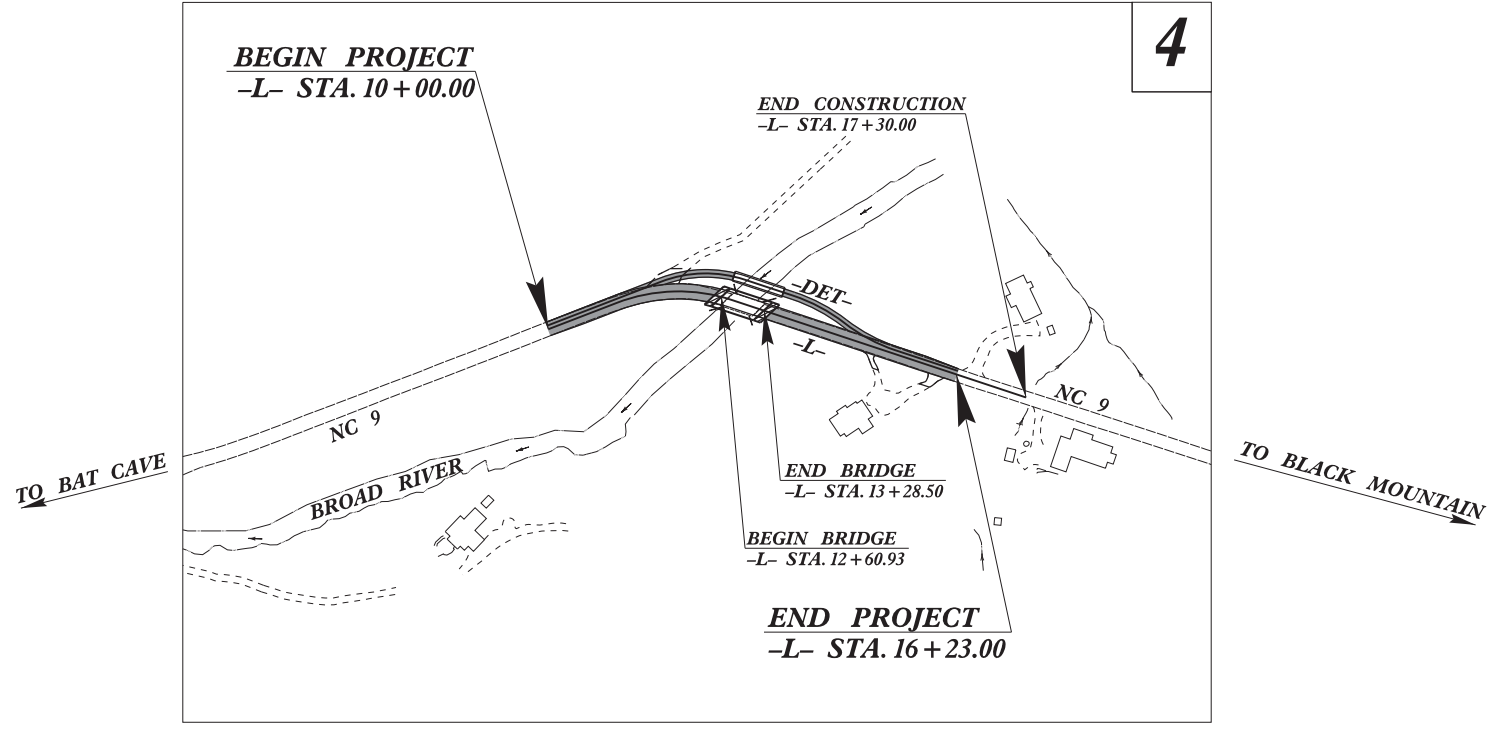
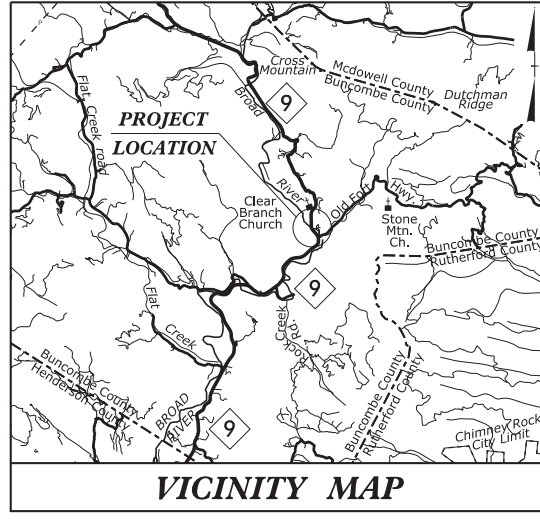

DESIGN EXCEPTION REQUIRED FOR DESIGN SPEED, STOPPING SIGHT DISTANCE, HORIZONTAL AND VERTICAL CURVES.
THERE IS NO CONTROL OF ACCESS ON THIS PROJECT.

DOCUMENT NOT CONSIDERED FINAL
UNLESS ALL SIGNATURES COMPLETED

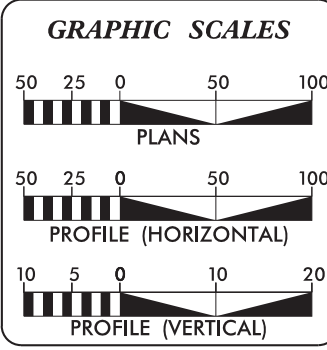

DESIGN DATA

ADT 2020 =	620
ADT 2040 =	1100
K =	12 %
D =	60 %
T =	5 % *
V =	30 MPH
* TTST =	1 DUAL 4
FUNC CLASS =	COLLECTOR
	REGIONAL TIER

PROJECT LENGTH

LENGTH ROADWAY TIP PROJECT BR-0009	=	0.105 MILES
LENGTH STRUCTURE TIP PROJECT BR-0009	=	0.013 MILES
TOTAL LENGTH TIP PROJECT BR-0009	=	0.118 MILES

Prepared for NCDOT in the Office of:
ATCS
100 REGENCY FOREST DR., SUITE 130
CARY, NORTH CAROLINA 27518
919-341-9418 <http://www.atcsplc.com/>
NC LICENSE NO. P-0192
ENGINEERING | PLANNING | SURVEYING | ENVIRONMENTAL

2018 STANDARD SPECIFICATIONS

RIGHT OF WAY DATE:
JANUARY 23, 2019

LETTING DATE:
FEBRUARY 16, 2021

TIM HAYES, PE
PROJECT ENGINEER

VASIM BARODAWALA, EI
PROJECT DESIGN ENGINEER

DAVID STUTTS, PE
NCDOT CONTACT

HYDRAULICS ENGINEER

SIGNATURE: _____

ROADWAY DESIGN ENGINEER

SIGNATURE: _____



21-OCT-2020 11:49
R:\Roadway\Proj\BR0009_Rdy_tsh.dgn
vbarodawala

6/2/2019

PAVEMENT SCHEDULE	
C1	PROP. APPROX. 1½" ASPHALT CONCRETE SURFACE COURSE, TYPE S9.5B, AT AN AVERAGE RATE OF 165 LBS. PER SQ. YD.
C2	PROP. APPROX. 3" ASPHALT CONCRETE SURFACE COURSE, TYPE S9.5B, AT AN AVERAGE RATE OF 165 LBS. PER SQ. YD. IN EACH OF TWO LAYERS.
C3	PROP. APPROX. 2½" ASPHALT CONCRETE SURFACE COURSE, TYPE S9.5B, AT AN AVERAGE RATE OF 137.5 LBS. PER SQ. YD. IN EACH OF TWO LAYERS.
C4	PROP. VAR. DEPTH ASPHALT CONCRETE SURFACE COURSE, TYPE S9.5B, AT AN AVERAGE RATE OF 110 LBS. PER SQ. YD. PER 1" DEPTH TO BE PLACED IN LAYERS NOT TO EXCEED 1½" IN DEPTH.
E1	PROP. APPROX. 4" ASPHALT CONCRETE BASE COURSE, TYPE B25.0C, AT AN AVERAGE RATE OF 456 LBS. PER SQ. YD.
E2	PROP. VAR. DEPTH ASPHALT CONCRETE BASE COURSE, TYPE B25.0C, AT AN AVERAGE RATE OF 114 LBS. PER SQ. YD. PER 1" DEPTH. TO BE PLACED IN LAYERS NOT LESS THAN 3" IN DEPTH OR GREATER THAN 5½" IN DEPTH.
J	PROP. 6" AGGREGATE BASE COURSE.
P	PRIME COAT AT THE RATE OF .35 GAL. PER SQ. YD.
R1	CONCRETE SHOULDER BERM GUTTER
T	EARTH MATERIAL
U	EXISTING PAVEMENT
V	INCIDENTAL MILLING
W	VARIABLE DEPTH ASPHALT PAVEMENT (SEE STANDARD WEDGING DETAIL)

NOTE: PAVEMENT EDGE SLOPES ARE 1:1 UNLESS SHOWN OTHERWISE.

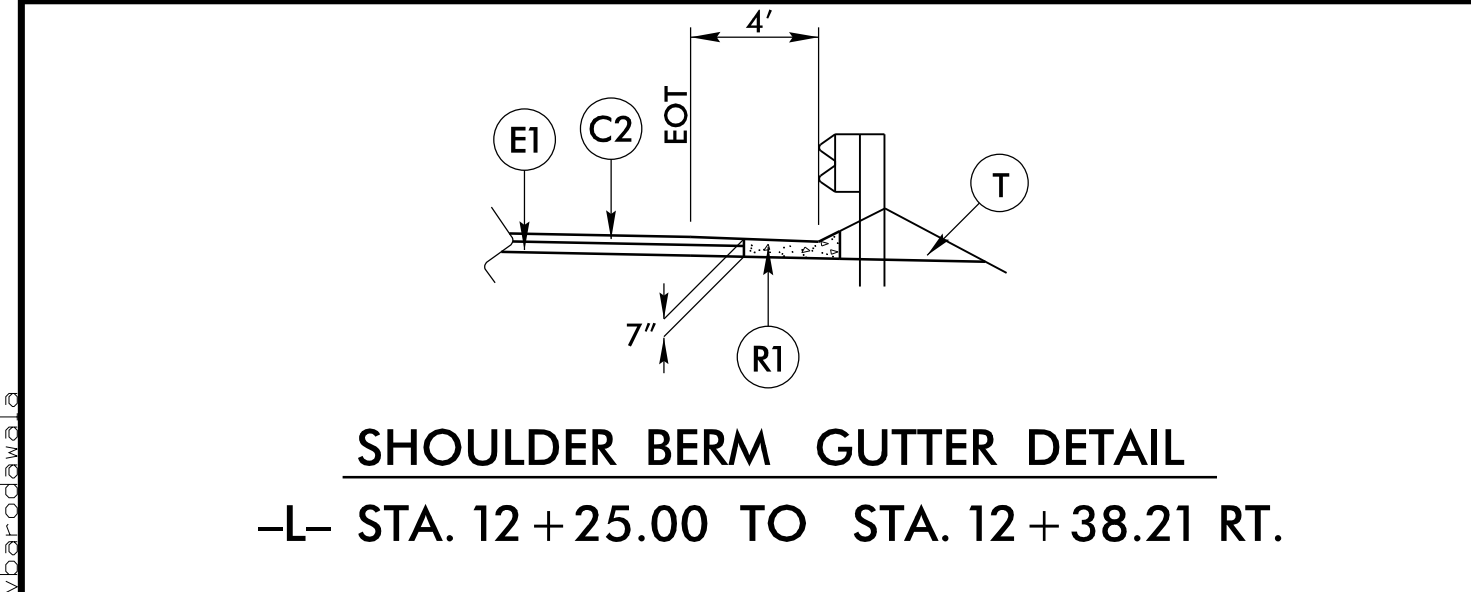
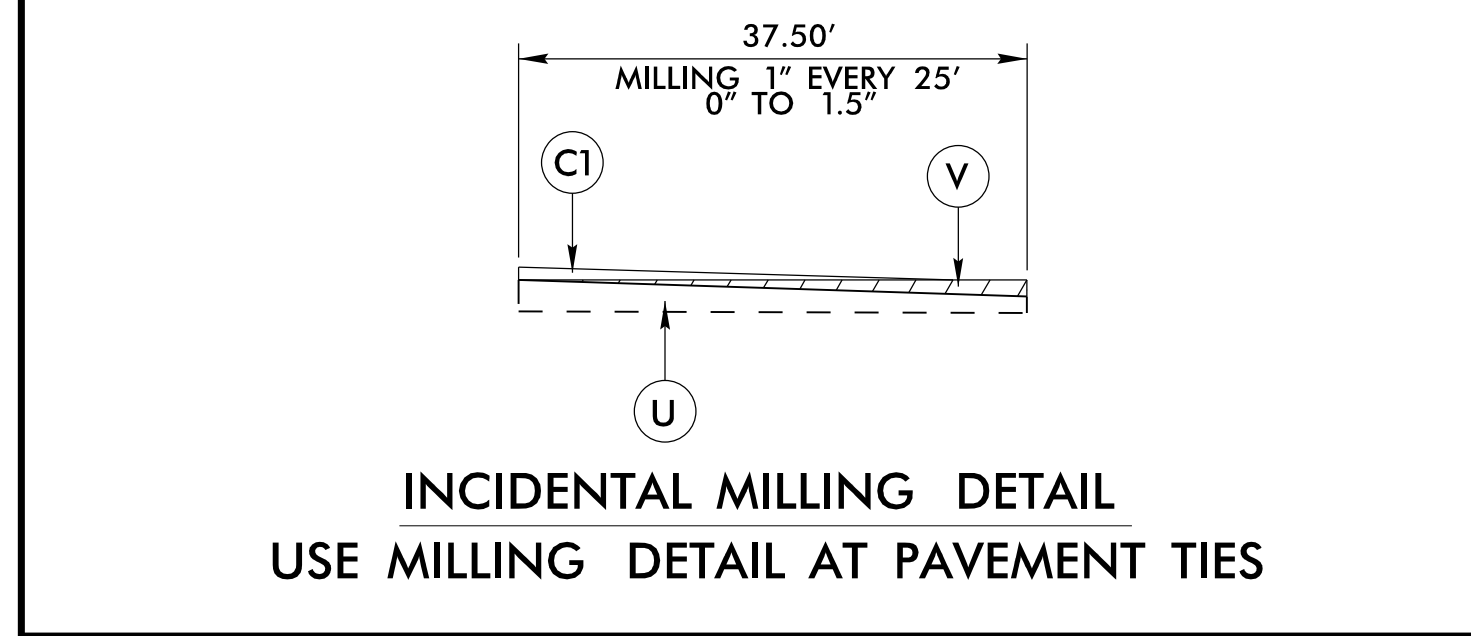
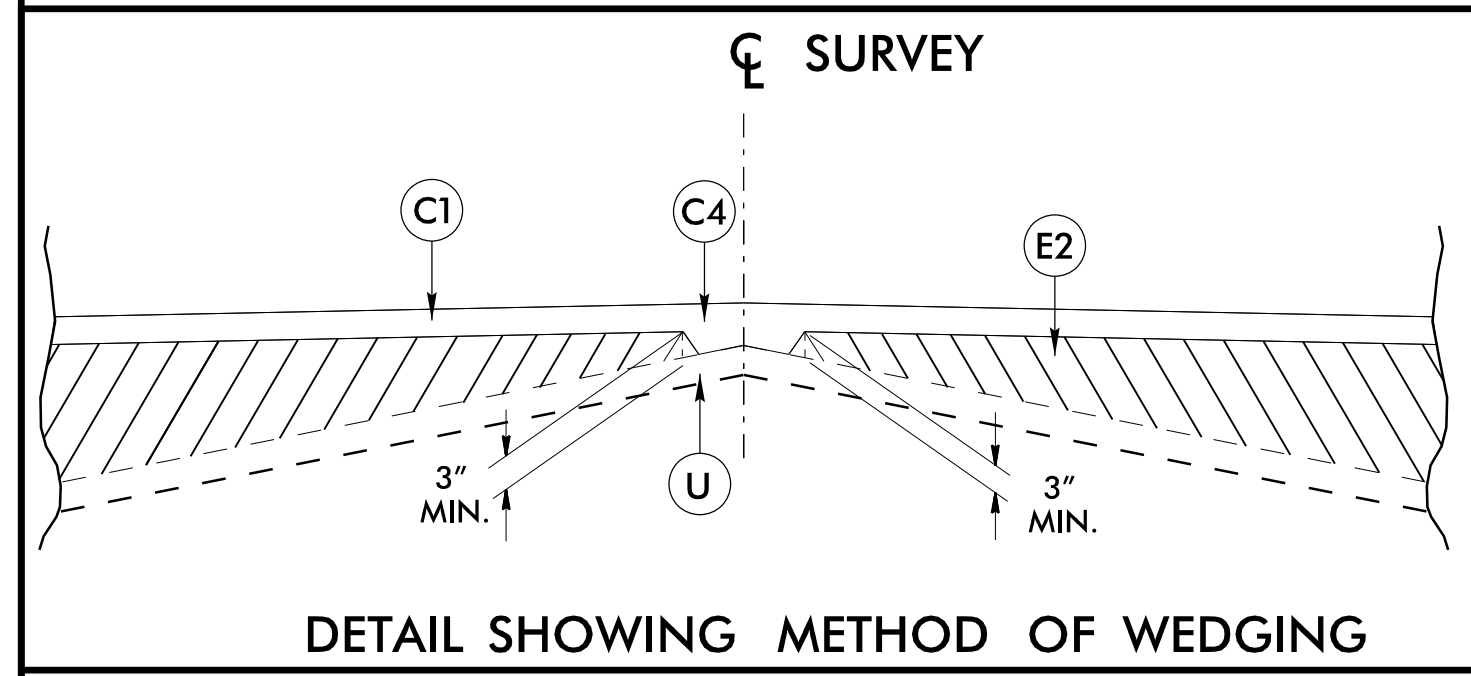

PROJECT REFERENCE NO. BR-0009	SHEET NO. 2A-1
ROADWAY DESIGN ENGINEER SEAL 19563 1/28/2020	PAVEMENT DESIGN ENGINEER SEAL 022896 1/27/2020
DOCUMENT NOT CONSIDERED FINAL UNLESS ALL SIGNATURES COMPLETED	
ATCS 100 REGENCY FOREST DR., SUITE 130 CARY, NORTH CAROLINA 27518 919-341-9418 http://www.atcsplc.com/ ENGINEERING PLANNING SURVEYING ENVIRONMENTAL	

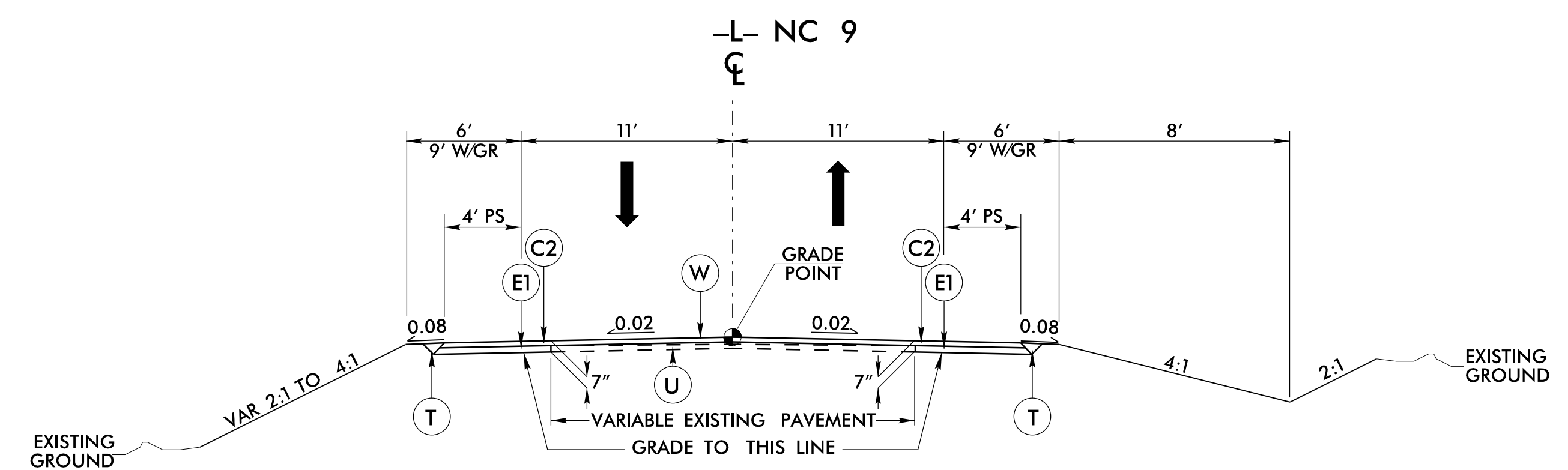

USE TYPICAL SECTION NO. 1
-L- STA. 10 + 00.00 TO STA. 12 + 00.00
-L- STA. 14 + 00.00 TO STA. 16 + 23.00

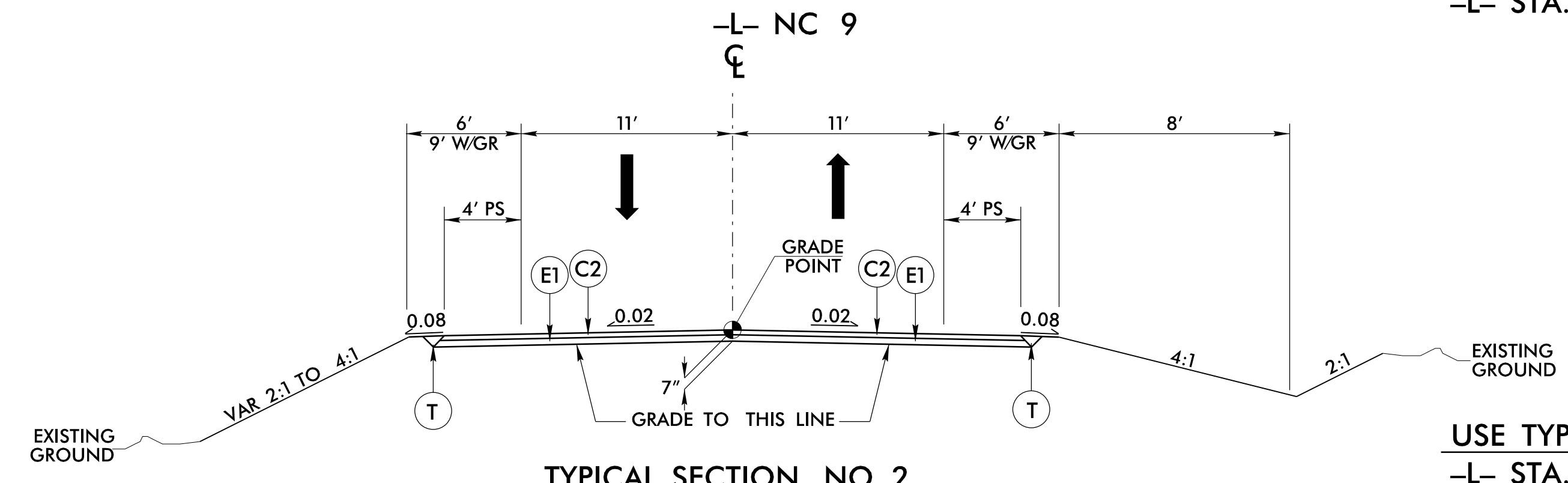

USE TYPICAL SECTION NO. 2
-L- STA. 12 + 00.00 TO STA. 12 + 60.93 (BEGIN BRIDGE)
-L- STA. 13 + 28.50 (END BRIDGE) TO STA. 14 + 00.00

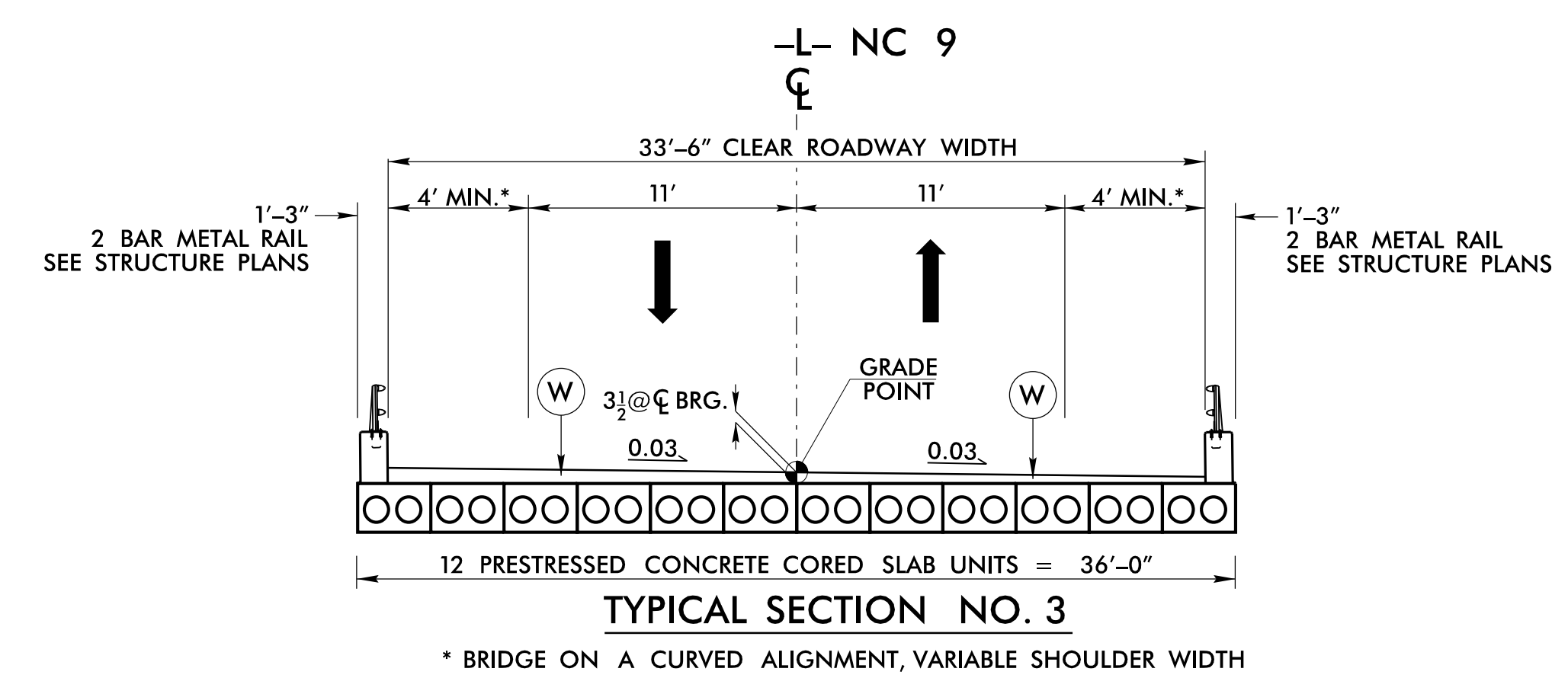

USE TYPICAL SECTION NO. 3
-L- STA. 12 + 60.93 (BEGIN BRIDGE) TO STA. 13 + 28.50 (END BRIDGE)

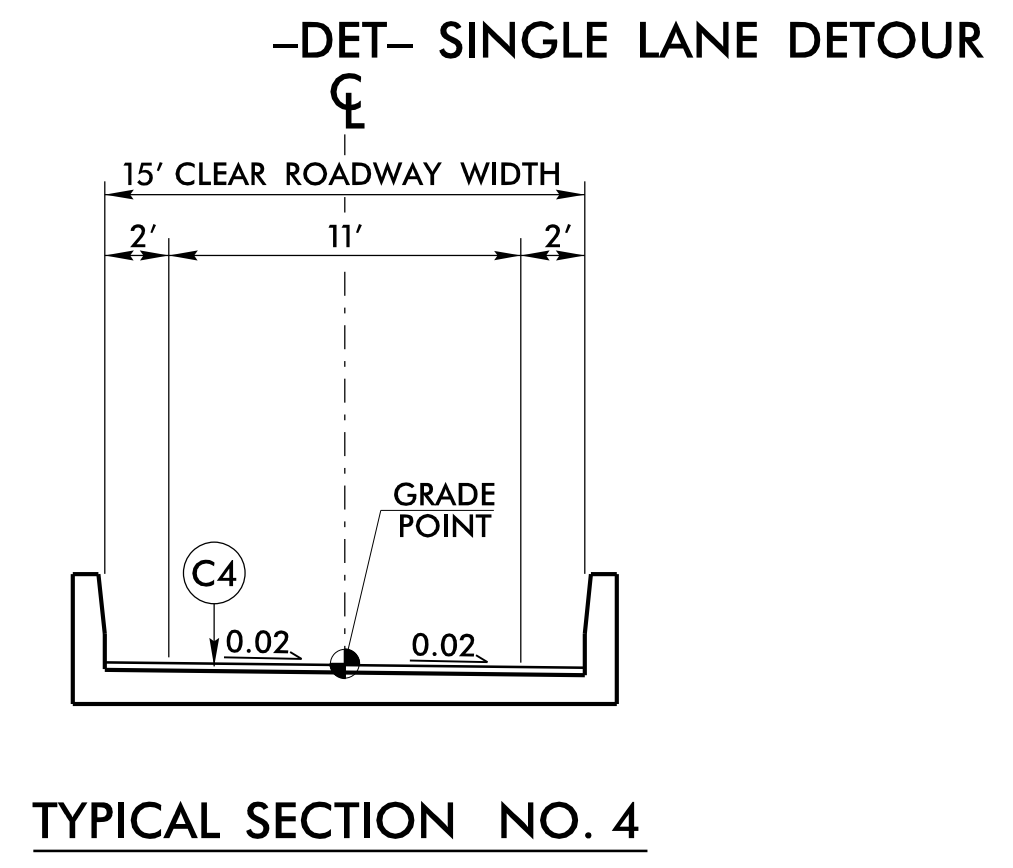

USE TYPICAL SECTION NO. 4
-DET- STA. 12 + 86.00 (BEGIN BRIDGE) TO STA. 13 + 62.00 (END BRIDGE)

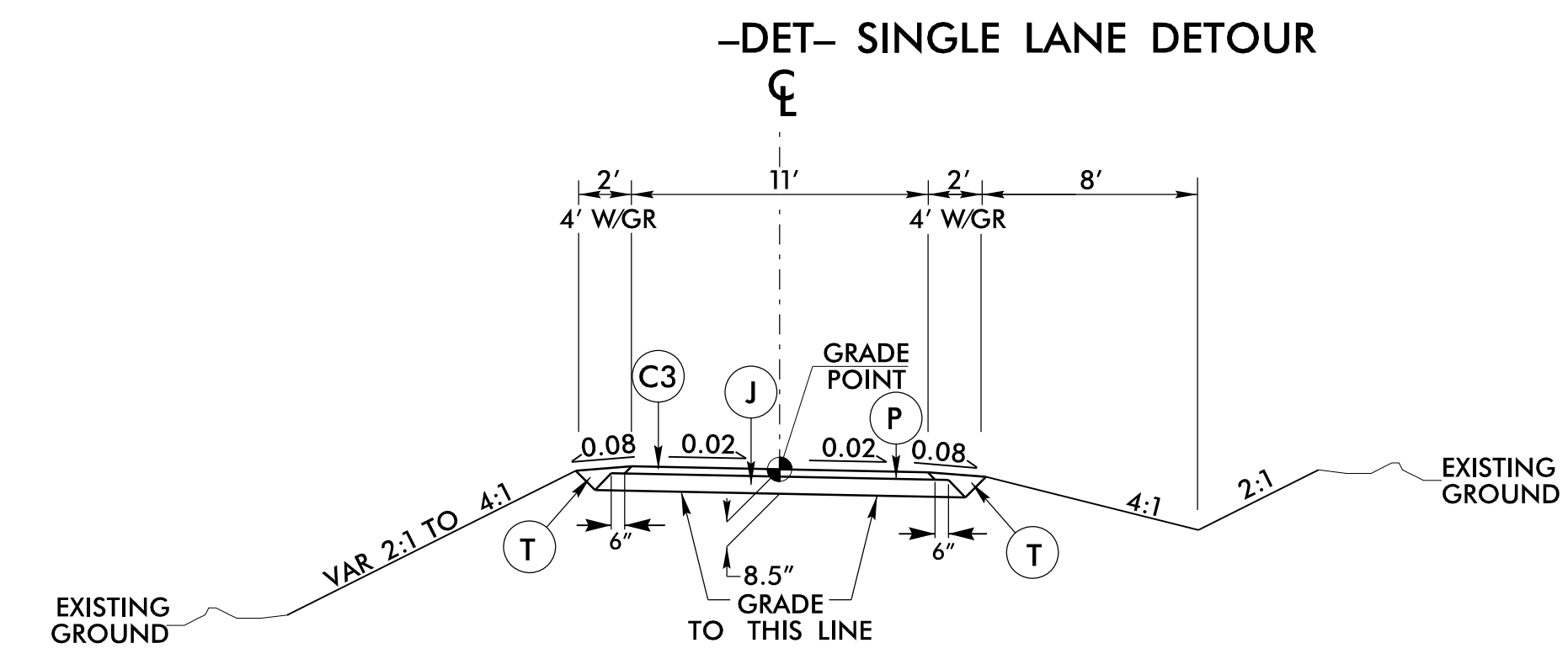

NOTE: TRANSITION FROM EXISTING TO TYPICAL SECTION NO. 5
FROM -DET- STA. 10 + 00.00 TO 11 + 50.00
FROM -DET- STA. 15 + 00.00 TO 16 + 43.00

USE TYPICAL SECTION NO. 5
-DET- STA. 11 + 50.00 TO STA. 12 + 86.00 (BEGIN BRIDGE)
-DET- STA. 13 + 62.00 (END BRIDGE) TO STA. 15 + 00.00

R:\NOV-2019\09-159 BR0009_Rdy_tjip.dgn

8/17/99

PROJECT REFERENCE NO. BR-0009	SHEET NO. 4
RW SHEET NO.	
ROADWAY DESIGN ENGINEER JUDITH SCOTT 1/28/2020	HYDRAULICS ENGINEER DANIEL C. HENNING 1/27/2020
DOCUMENT NOT CONSIDERED FINAL UNLESS ALL SIGNATURES COMPLETED ATCS 100 REGENCY FOREST DRIVE, SUITE 130 CARY, NORTH CAROLINA 27518 919-341-9418 http://www.atcsplc.com/ ENGINEERING PLANNING SURVEYING ENVIRONMENTAL	

-L- CURVE DATA
 PI Sta 11+96.27
 $\Delta = 39^\circ 24' 14.1" (RT)$
 $D = 22^\circ 55' 05.9"$
 $L = 1719.3'$
 $T = 89.52'$
 $R = 250.00'$
 $SE = 04$

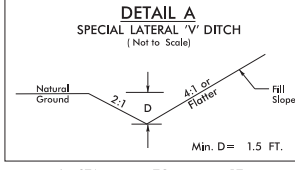

-L- STA. 15+15 TO 15+75 RT.

TEMPORARY SHORING REQUIRED, SEE TMP PLANS FOR DETAILS

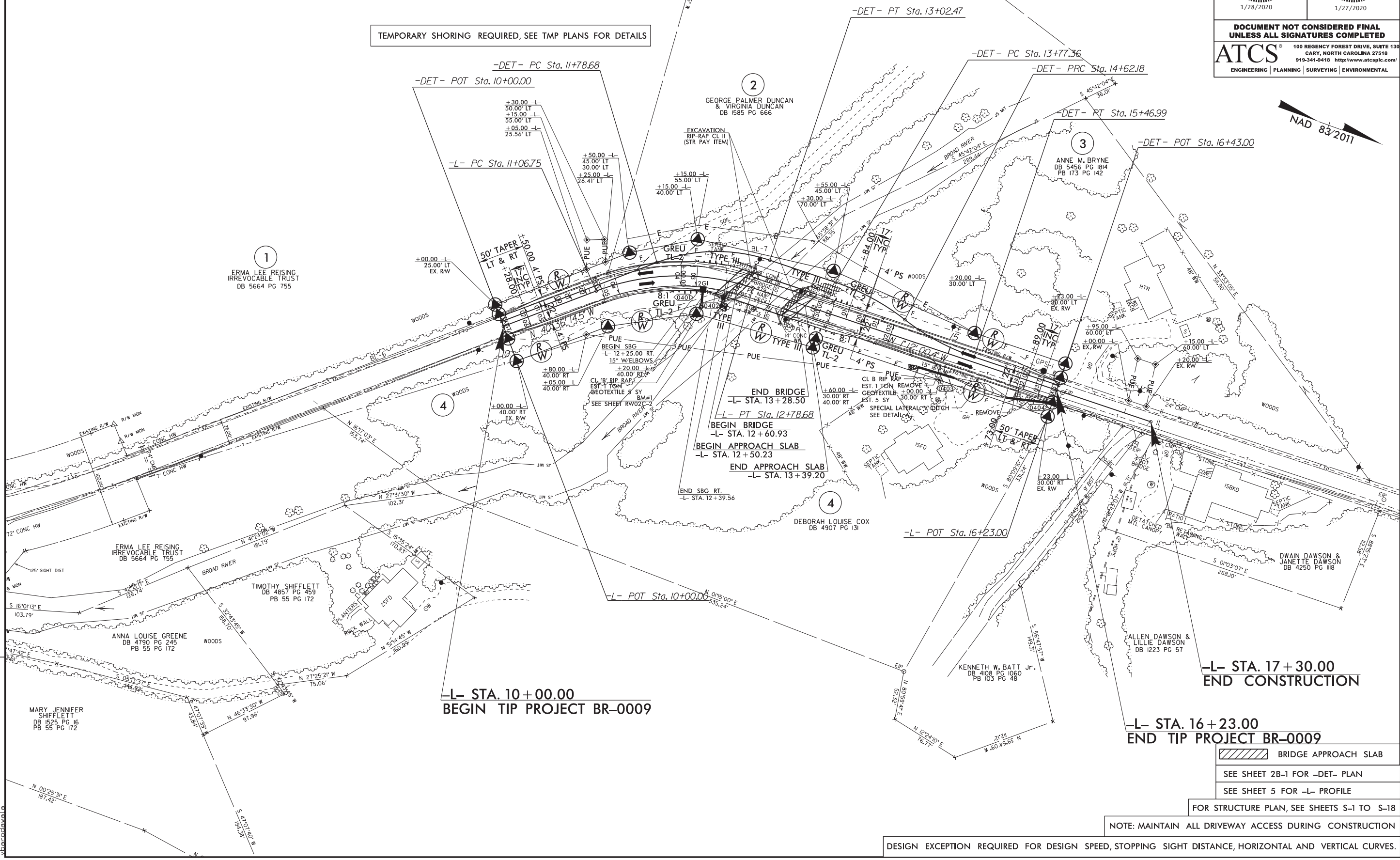

REVISIONS

RD-100-2020-1615 BR0009-Rdy_psh.dgn

BRIDGE APPROACH SLAB
 SEE SHEET 2B-1 FOR -DET- PLAN
 SEE SHEET 5 FOR -L- PROFILE

FOR STRUCTURE PLAN, SEE SHEETS S-1 TO S-18

NOTE: MAINTAIN ALL DRIVEWAY ACCESS DURING CONSTRUCTION

DESIGN EXCEPTION REQUIRED FOR DESIGN SPEED, STOPPING SIGHT DISTANCE, HORIZONTAL AND VERTICAL CURVES.