

R-2576 Mid-Currituck Bridge

Attachment 6:

Submerged Aquatic Vegetation (SAV) Impact Drawings

See Sheet 1A For Index of Sheets
See Sheet 1B For Conventional Symbols
See Sheet 1C For Survey Control Sheet

STATE OF NORTH CAROLINA
DIVISION OF HIGHWAYS

STATE	STATE PROJECT REFERENCE NO.	SHEET NO.	TOTAL SHEETS
N.C.	R-2576	1	
STATE PROJ. NO.	F.A. PROJ. NO.	DESCRIPTION	
34470.1.TA1	BRSTP-000(494)	P.E.	

TIP PROJECT: R-2576

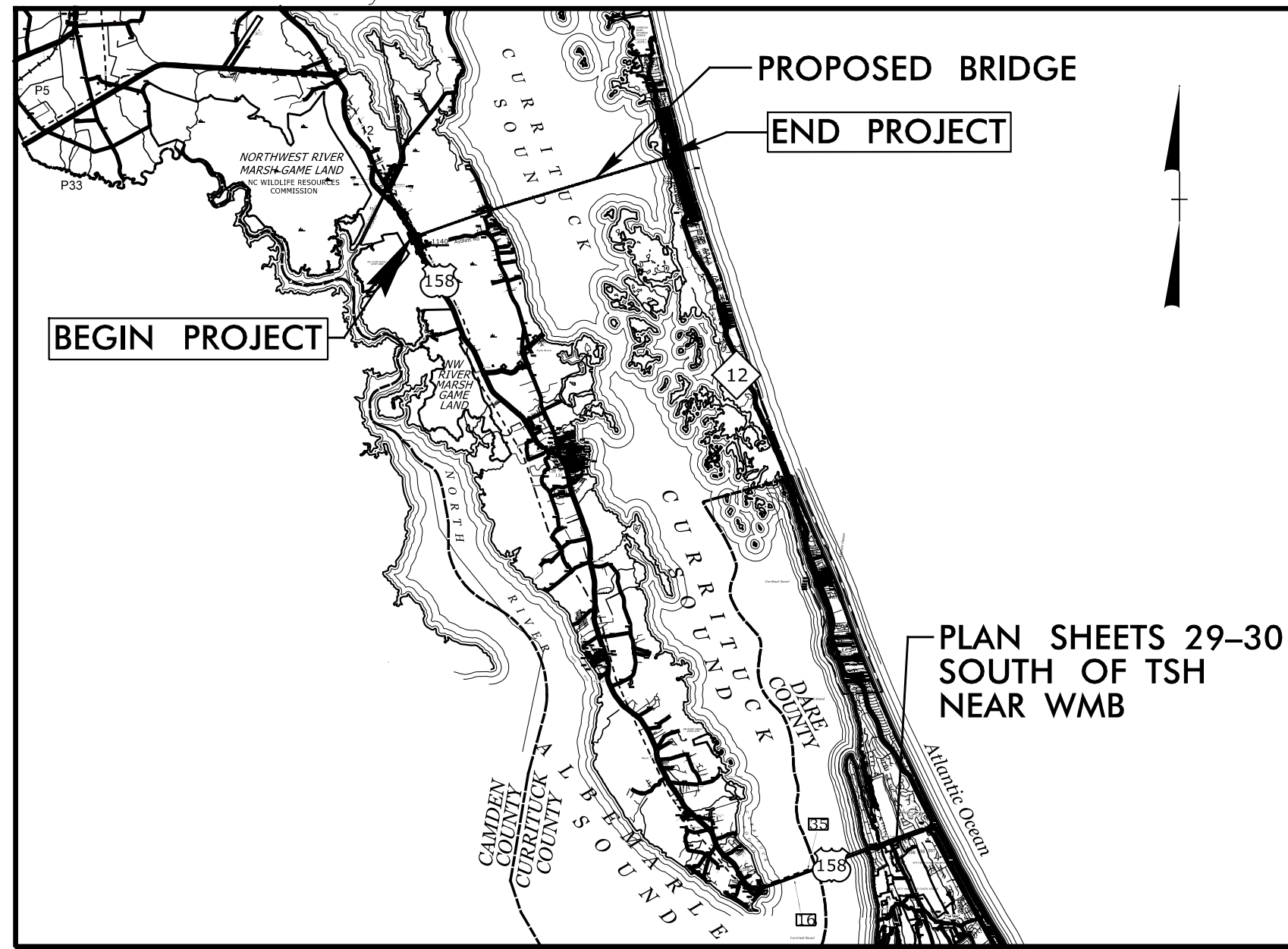

VICINITY MAP

75% PLANS

LOCATION: MID-CURRITUCK BRIDGE FROM US 158 SOUTH OF COINJOCK TO NC 12 SOUTH OF COROLLA

TYPE OF WORK: GRADING, DRAINAGE, PAVING, AND STRUCTURES

SAV IMPACT DRAWING 1 OF 11

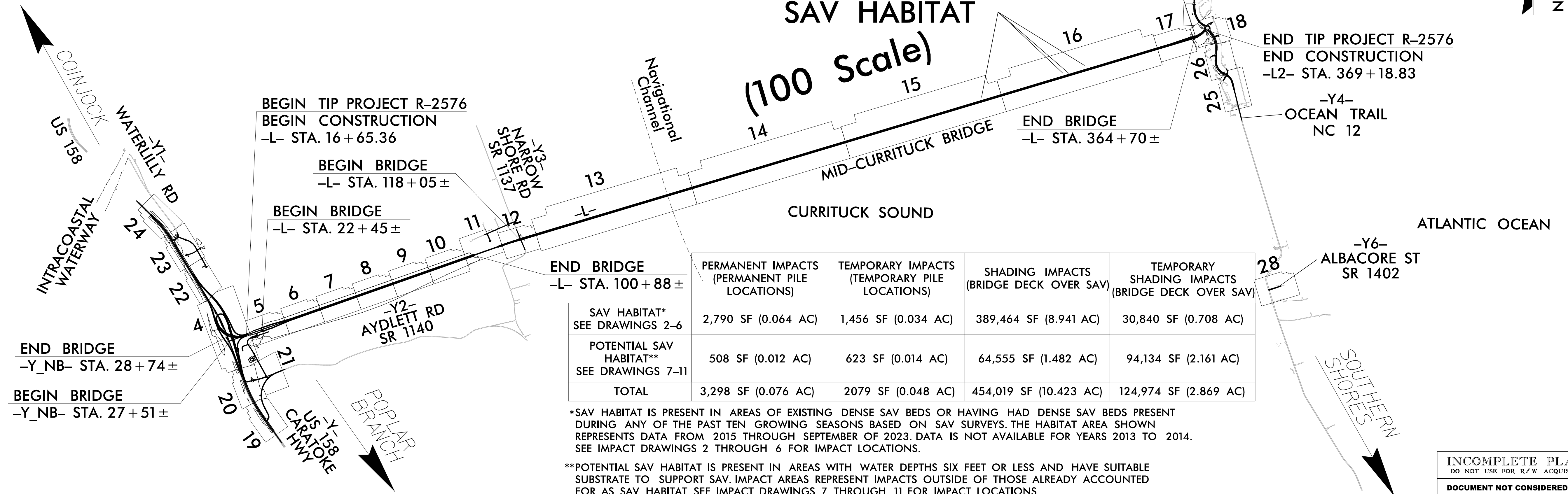

	PERMANENT IMPACTS (PERMANENT PILE LOCATIONS)	TEMPORARY IMPACTS (TEMPORARY PILE LOCATIONS)	SHADING IMPACTS (BRIDGE DECK OVER SAV)	TEMPORARY SHADING IMPACTS (BRIDGE DECK OVER SAV)
SAV HABITAT* SEE DRAWINGS 2-6	2,790 SF (0.064 AC)	1,456 SF (0.034 AC)	389,464 SF (8.941 AC)	30,840 SF (0.708 AC)
POTENTIAL SAV HABITAT** SEE DRAWINGS 7-11	508 SF (0.012 AC)	623 SF (0.014 AC)	64,555 SF (1.482 AC)	94,134 SF (2.161 AC)
TOTAL	3,298 SF (0.076 AC)	2,079 SF (0.048 AC)	454,019 SF (10.423 AC)	124,974 SF (2.869 AC)

*SAV HABITAT IS PRESENT IN AREAS OF EXISTING DENSE SAV BEDS OR HAVING HAD DENSE SAV BEDS PRESENT DURING ANY OF THE PAST TEN GROWING SEASONS BASED ON SAV SURVEYS. THE HABITAT AREA SHOWN REPRESENTS DATA FROM 2015 THROUGH SEPTEMBER OF 2023. DATA IS NOT AVAILABLE FOR YEARS 2013 TO 2014. SEE IMPACT DRAWINGS 2 THROUGH 6 FOR IMPACT LOCATIONS.

**POTENTIAL SAV HABITAT IS PRESENT IN AREAS WITH WATER DEPTHS SIX FEET OR LESS AND HAVE SUITABLE SUBSTRATE TO SUPPORT SAV. IMPACT AREAS REPRESENT IMPACTS OUTSIDE OF THOSE ALREADY ACCOUNTED FOR AS SAV HABITAT. SEE IMPACT DRAWINGS 7 THROUGH 11 FOR IMPACT LOCATIONS.

CLEARING ON THIS PROJECT SHALL BE PERFORMED TO THE LIMITS ESTABLISHED BY METHOD —

INCOMPLETE PLANS
DO NOT USE FOR R/W ACQUISITION
DOCUMENT NOT CONSIDERED FINAL
UNLESS ALL SIGNATURES COMPLETED

CONTRACT:

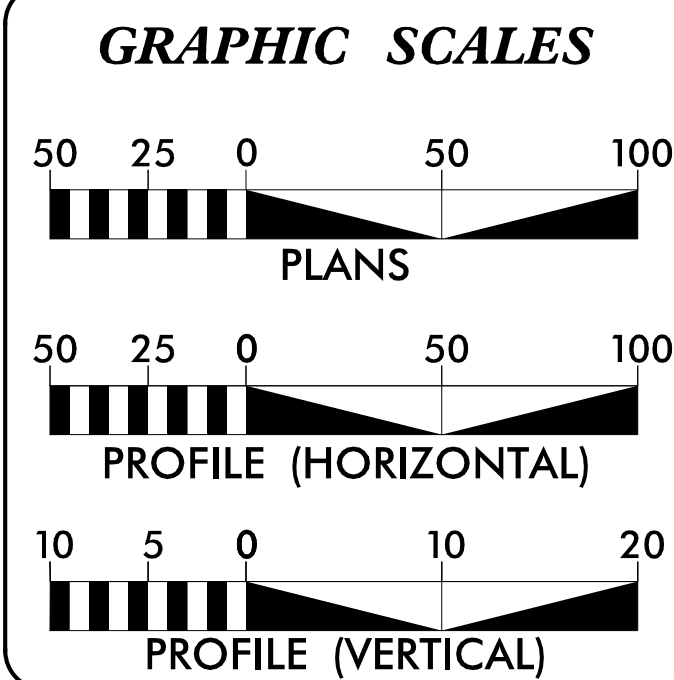

DESIGN DATA

# ADT 2020 =	11,800
ADT 2040 =	18,000
K =	9 %
D =	60 %
T =	7 % *
V =	60 MPH
* (TTST=2) + (DUAL=1) + (RV=4)	
FUNC CLASS =	ARTERIAL STATEWIDE TIER

PROJECT LENGTH

LENGTH ROADWAY TIP PROJECT R-2576	=0.524 Miles
LENGTH STRUCTURES	=6.153 Miles
TOTAL LENGTH TIP PROJECT R-2576	=6.677 Miles

PROJECT LEVEL TRAFFIC FORECAST (JUNE 2016) (SUMMER WEEKEND)

Prepared In the Office of:

LOCHNER
H. W. LOCHNER, INC.
2840 PLAZA PLACE, SUITE 202
RALEIGH, NC 27612
(919) 571-7111

NC License Number F-0159

2018 STANDARD SPECIFICATIONS

RIGHT OF WAY DATE: FY 2026

LETTING DATE: FY 2026

BRIAN K. EASON, PE
PROJECT ENGINEER

CHRISTINA L. YOKELEY, PE
PROJECT DESIGN ENGINEER

DENNIS JERNIGAN, PE
NCDOT / NCTA



HYDRAULICS ENGINEER

SIGNATURE: _____ P.E.

ROADWAY DESIGN ENGINEER

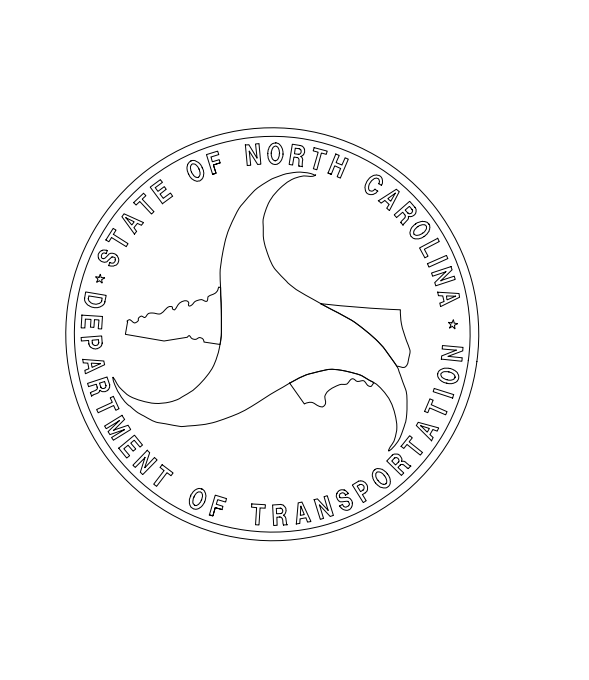
SIGNATURE: _____ P.E.

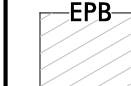

REVISIONS	
LEGEND	
	SAV HABITAT
	PERMANENT PILE IMPACTS
	TEMPORARY PILE IMPACTS

TEMPORARY 30" DIAMETER IMPACT FOR TRESTLE PILES (TYP.)

PERMANENT 30"x30" IMPACT (TYP.)

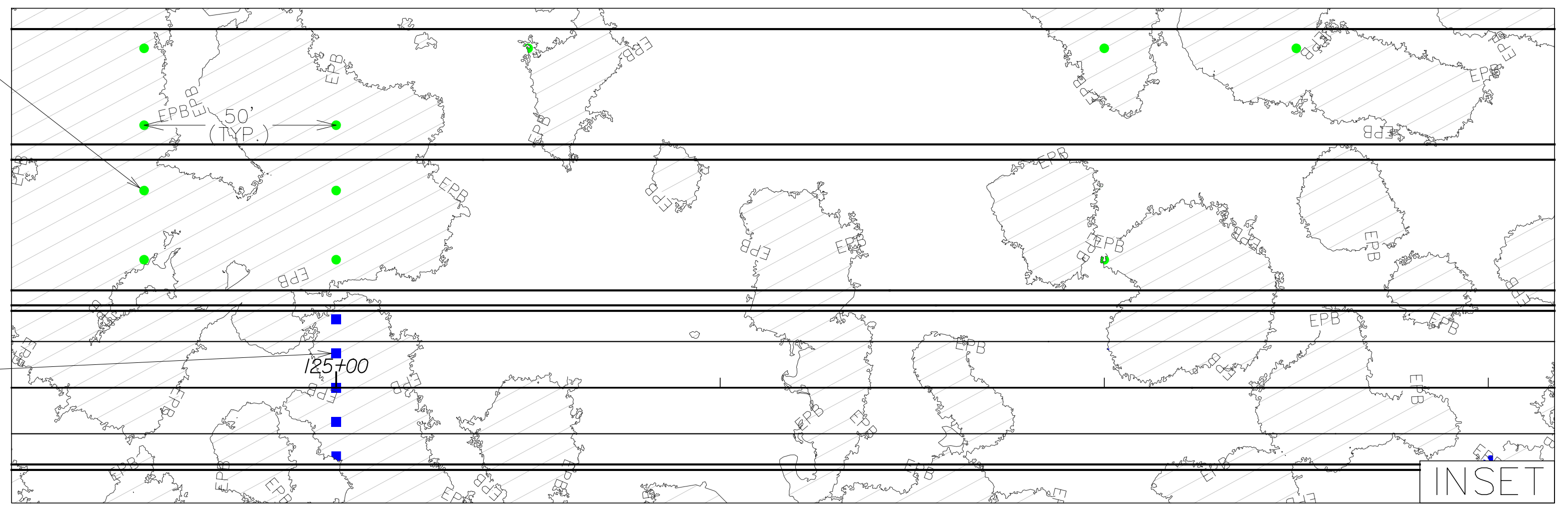

LOCHNER
 H. W. LOCHNER, INC.
 2840 PEARL PLACE SUITE 202
 RALEIGH, NC 27612
 (919) 271-7111

PROJECT REFERENCE NO. F-2576 SHEET NO. 13
 ROADWAY DESIGN ENGINEER HYDRAULIC ENGINEER
 NC License Number E-0202

INCOMPLETE PLANS
 DO NOT USE FOR P.P.A. ACCORDING

DOCUMENT NOT CONSIDERED FINAL UNLESS ALL SIGNATURES COMPLETED

SAV IMPACT DRAWING 3 OF 11

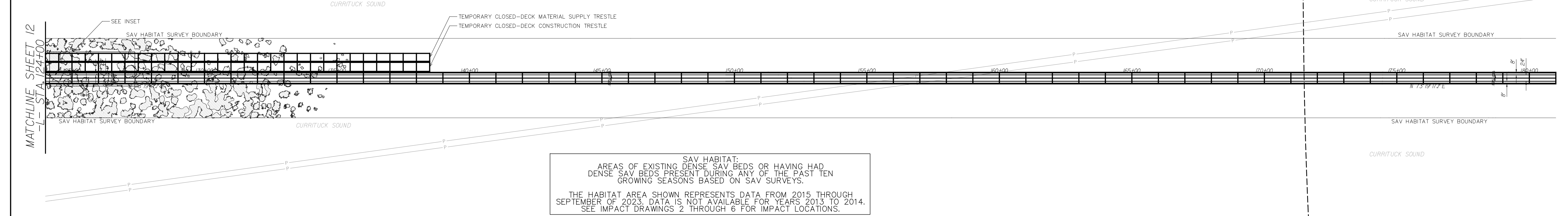

SAV HABITAT: AREAS OF EXISTING DENSE SAV BEDS OR HAVING HAD DENSE SAV BEDS PRESENT DURING ANY OF THE PAST TEN GROWING SEASONS BASED ON SAV SURVEYS. THE HABITAT AREA SHOWN REPRESENTS DATA FROM 2015 THROUGH SEPTEMBER OF 2023. DATA IS NOT AVAILABLE FOR YEARS 2013 TO 2014. SEE IMPACT DRAWINGS 2 THROUGH 6 FOR IMPACT LOCATIONS.

GRAPHIC SCALE
 100 50 0 100 200
 PLANS

LOCATION: _____
 TP NO. _____ COUNTY: _____
 DESIGNED BY: _____
 CHECKED BY: _____ DATE: _____

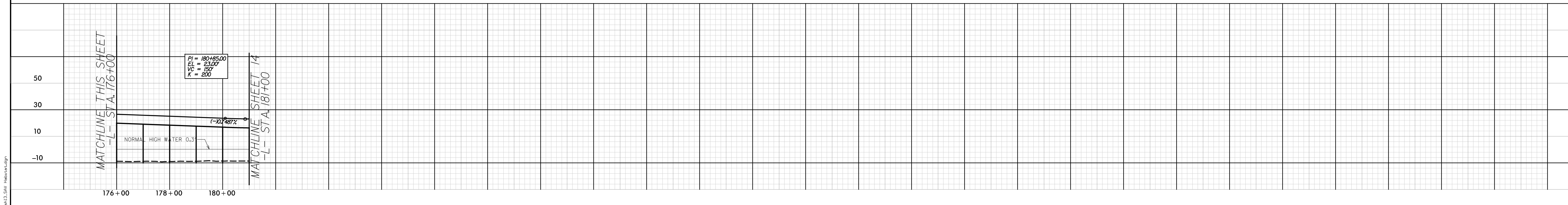
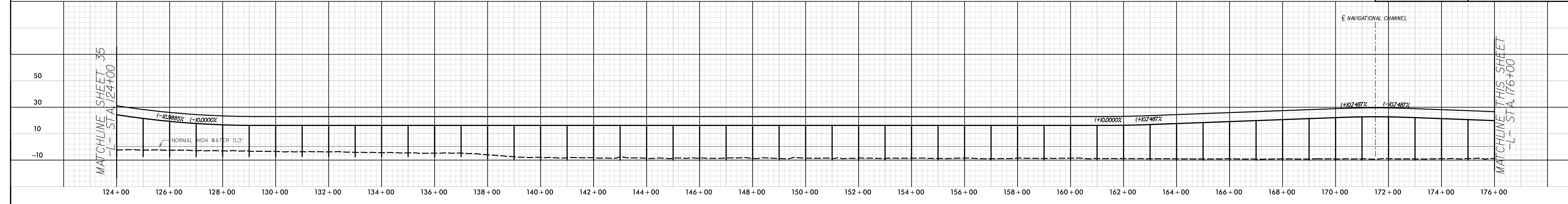

11/15/2023 10:31 AM SAV_HABITAT.dwg

REVISIONS

LEGEND

- EPB SAV HABITAT
- PERMANENT PILE IMPACTS
- TEMPORARY PILE IMPACTS

LOCHNER
 H. W. LOCHNER, INC.
 2840 PLAZA PLACE, SUITE 202
 RALEIGH, NC 27612
 (919) 571-7111

PROJECT REFERENCE NO. H-2576
 SHEET NO. 15

ROADWAY DESIGN ENGINEER
 HYDRAULICS ENGINEER

INCOMPLETE PLANS
 DO NOT USE FOR CONSTRUCTION

DOCUMENT NOT CONSIDERED FINAL
 UNLESS ALL SIGNATURES COMPLETED

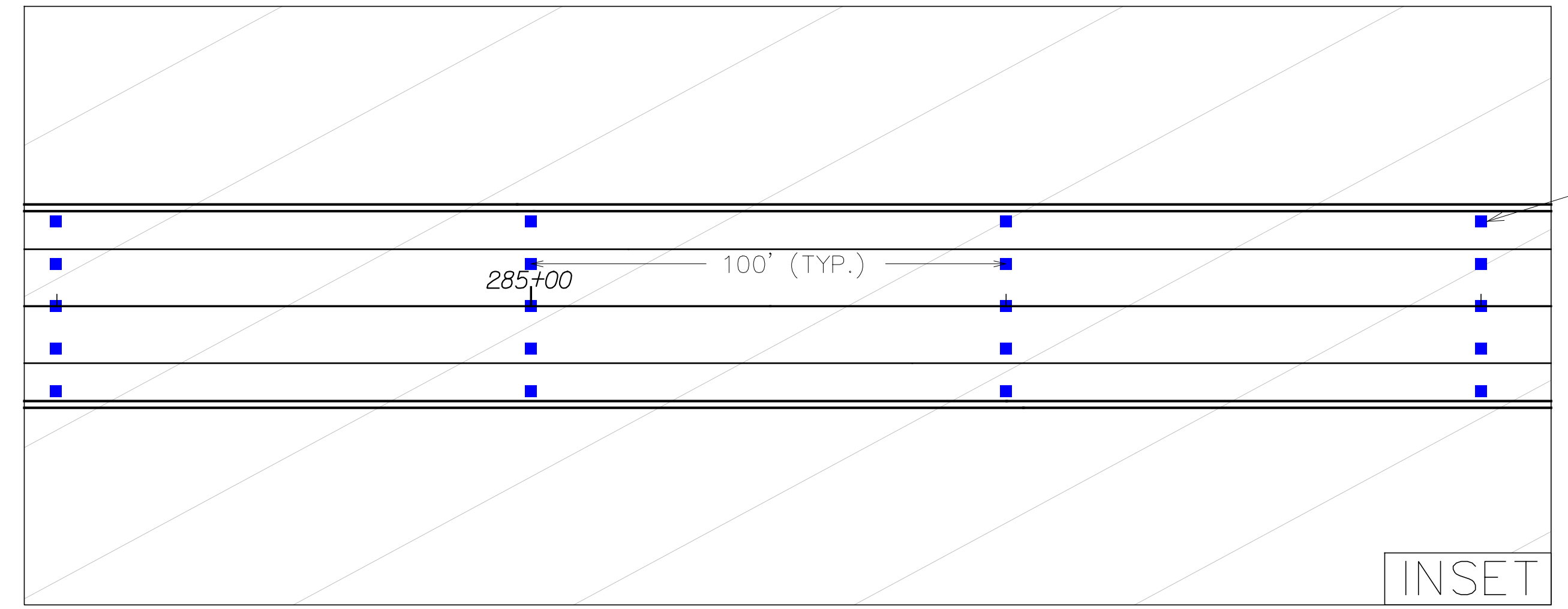

SAV IMPACT DRAWING 4 OF 11

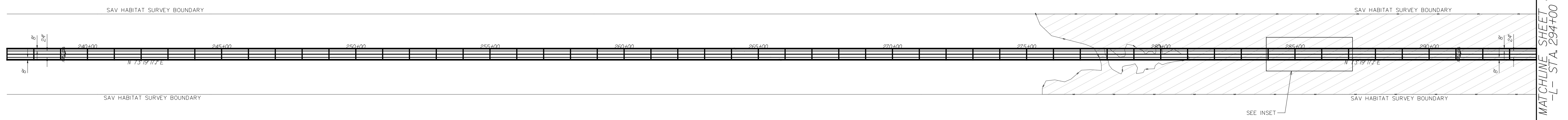

SAV HABITAT:
 AREAS OF EXISTING DENSE SAV BEDS OR HAVING HAD DENSE SAV BEDS PRESENT DURING ANY OF THE PAST TEN GROWING SEASONS BASED ON SAV SURVEYS.

THE HABITAT AREA SHOWN REPRESENTS DATA FROM 2015 THROUGH SEPTEMBER OF 2023. DATA IS NOT AVAILABLE FOR YEARS 2013 TO 2014. SEE IMPACT DRAWINGS 2 THROUGH 6 FOR IMPACT LOCATIONS.

GRAPHIC SCALE
 100 50 0 100 200
 PLANS

LOCATION: _____
 TIP NO.: _____ COUNTY: _____
 DESIGNED BY: _____
 CHECKED BY: _____ DATE: _____

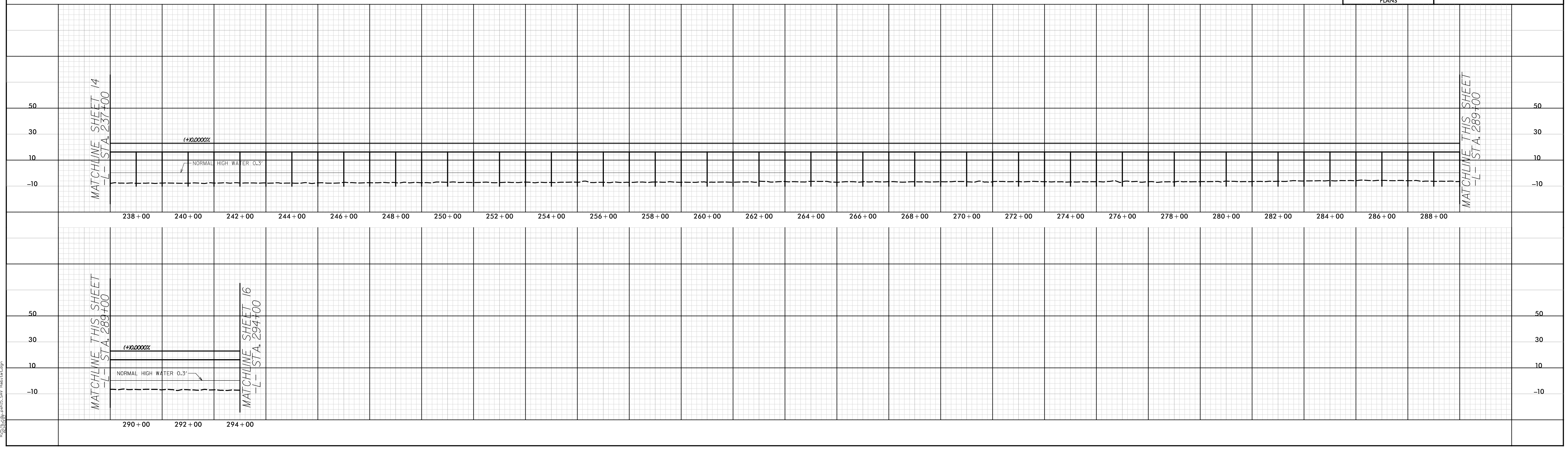

H:\Projects\2023\230000\230000_SAV_Habitat.dwg

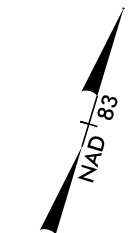

SAV IMPACT DRAWING 5 OF 11

REVISIONS

LEGEND

- EPB SAV HABITAT
- PERMANENT PILE IMPACTS
- TEMPORARY PILE IMPACTS

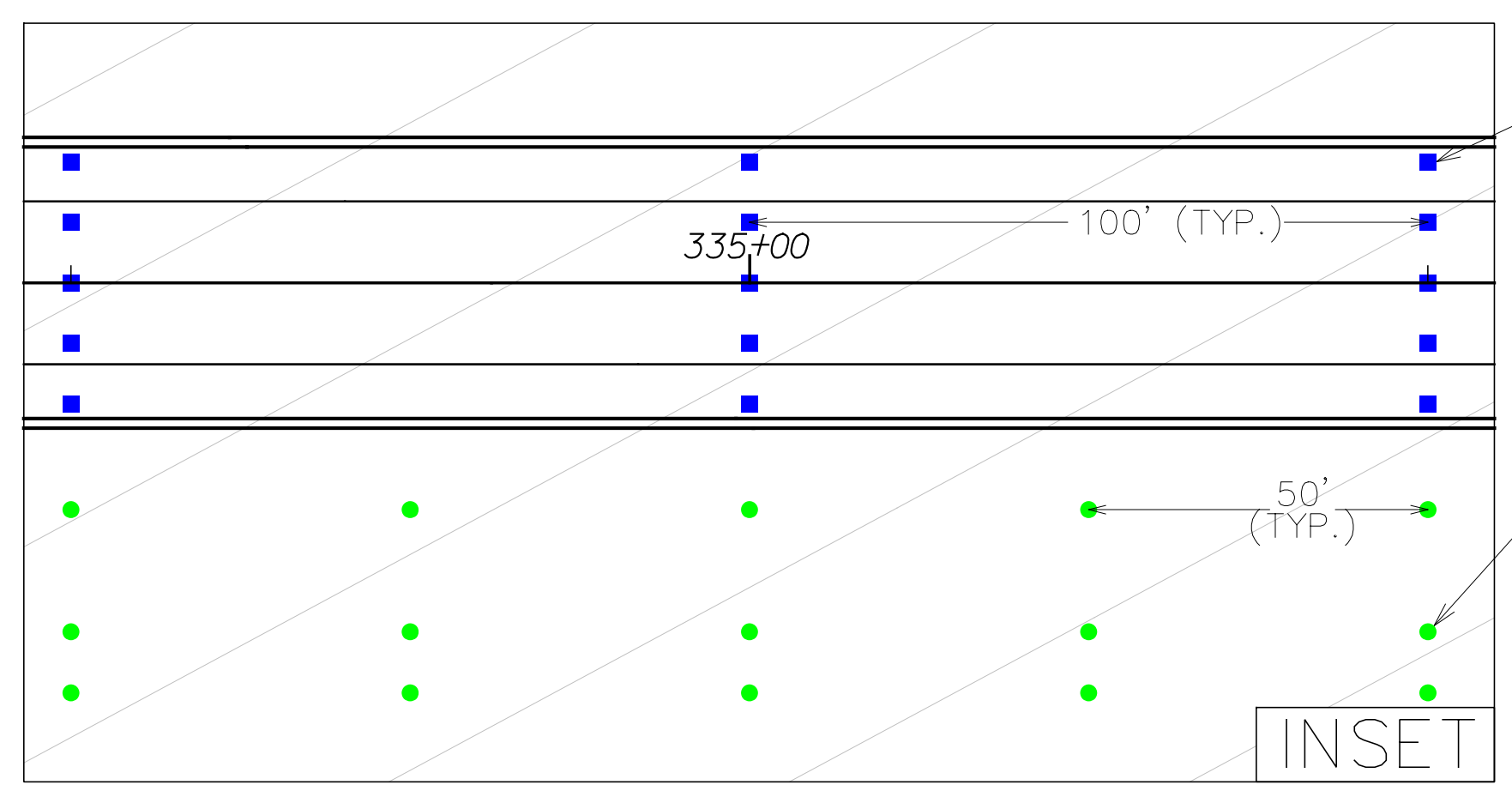

PERMANENT 30"x30" IMPACT (TYP.)

TEMPORARY 30" DIAMETER IMPACT FOR TRESTLE PILES (TYP.)

INSET

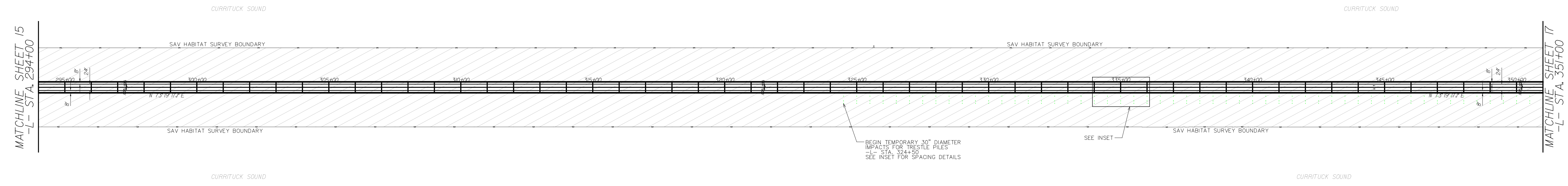

SAV HABITAT:
 AREAS OF EXISTING DENSE SAV BEDS OR HAVING HAD DENSE SAV BEDS PRESENT DURING ANY OF THE PAST TEN GROWING SEASONS BASED ON SAV SURVEYS.

THE HABITAT AREA SHOWN REPRESENTS DATA FROM 2015 THROUGH SEPTEMBER OF 2023. DATA IS NOT AVAILABLE FOR YEARS 2013 TO 2014. SEE IMPACT DRAWINGS 2 THROUGH 6 FOR IMPACT LOCATIONS.

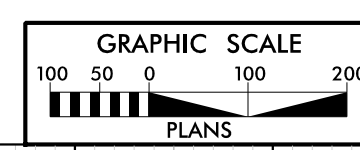

LOCATION:	
TIP NO.:	COUNTY:
DESIGNED BY:	
CHECKED BY:	DATE:

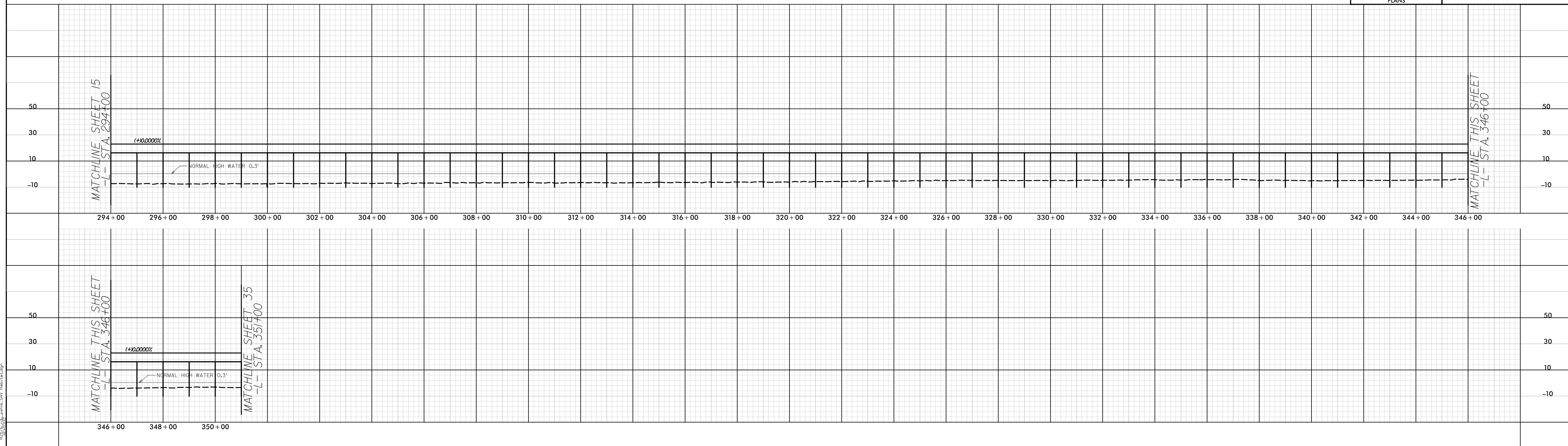

DATE PLOTTED: 10/20/23 10:58 AM

6/22/23

LOCHNER

H. W. LOCHNER, INC.
2840 PLAZA PLACE, SUITE 202
RALEIGH, NC 27612
(919) 571-7111

NC License
Number F-0159

PROJECT REFERENCE NO. R-2576	SHEET NO. 17
ROADWAY DESIGN ENGINEER	PAVEMENT DESIGN ENGINEER
INCOMPLETE PLANS DO NOT USE FOR R/W ACQUISITION	
DOCUMENT NOT CONSIDERED FINAL UNLESS ALL SIGNATURES COMPLETED	

SAV IMPACT DRAWING 6 OF 11

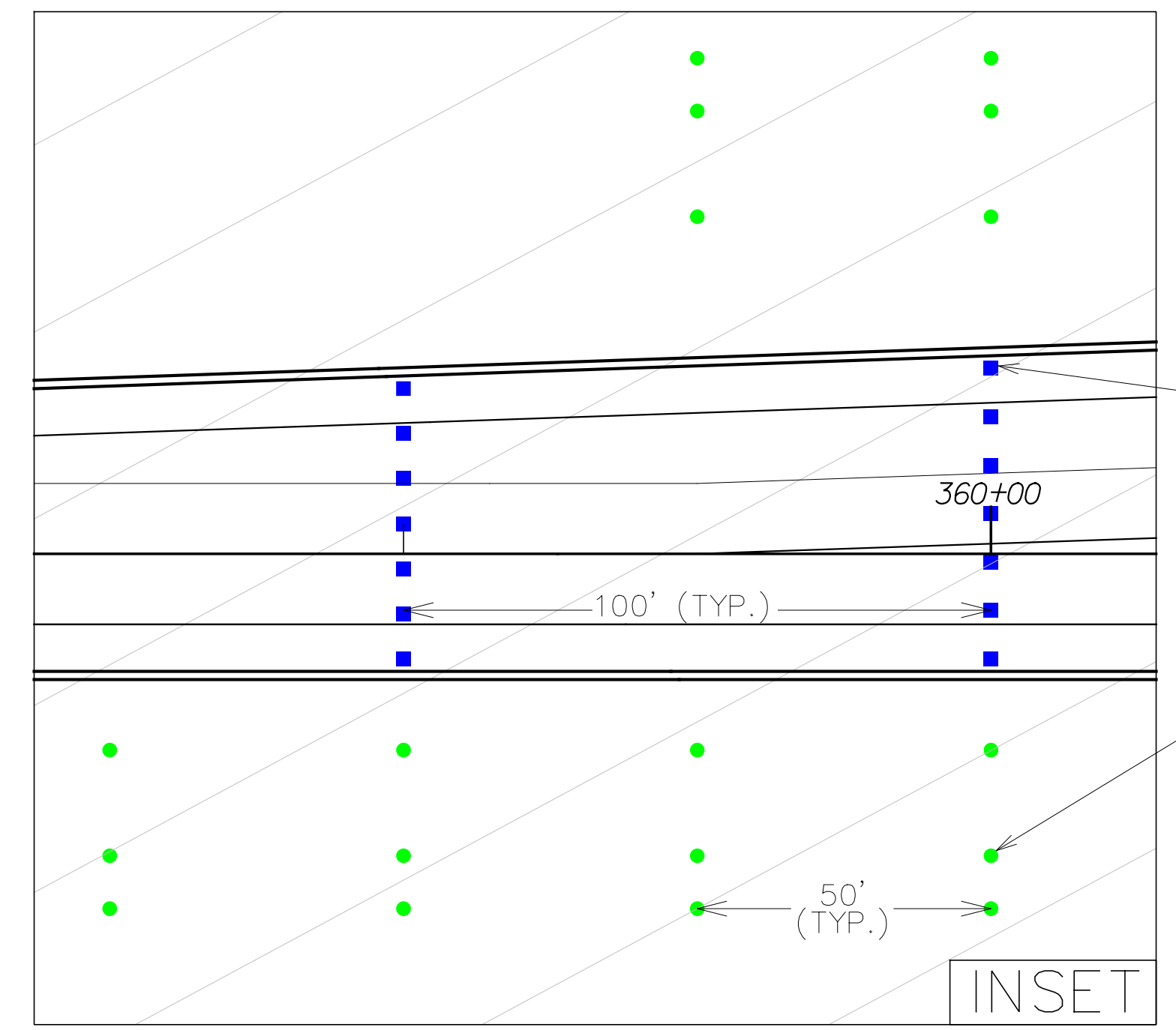
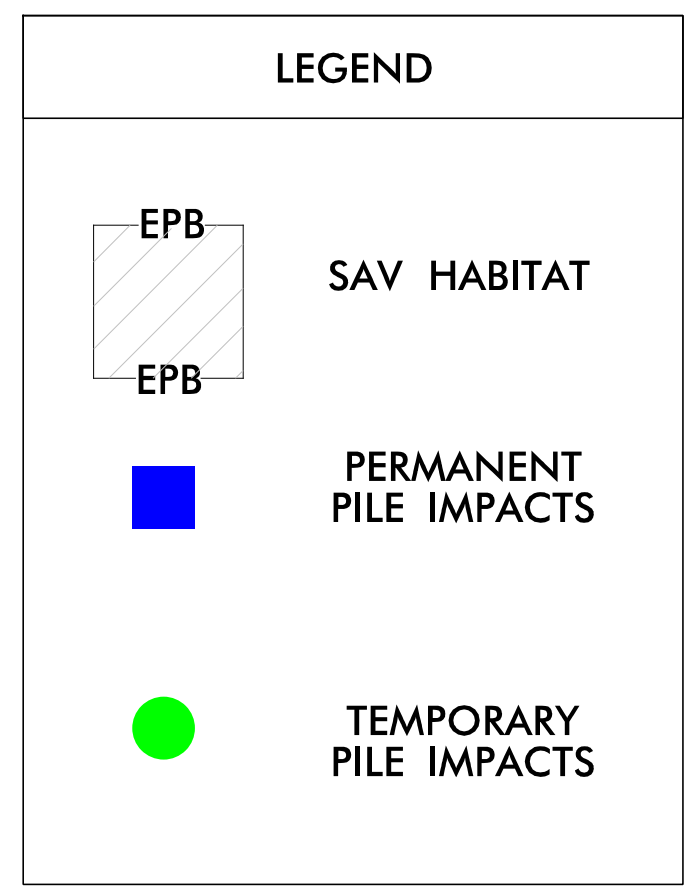

MATCHLINE SHEET 16
-L- STA. 351+00

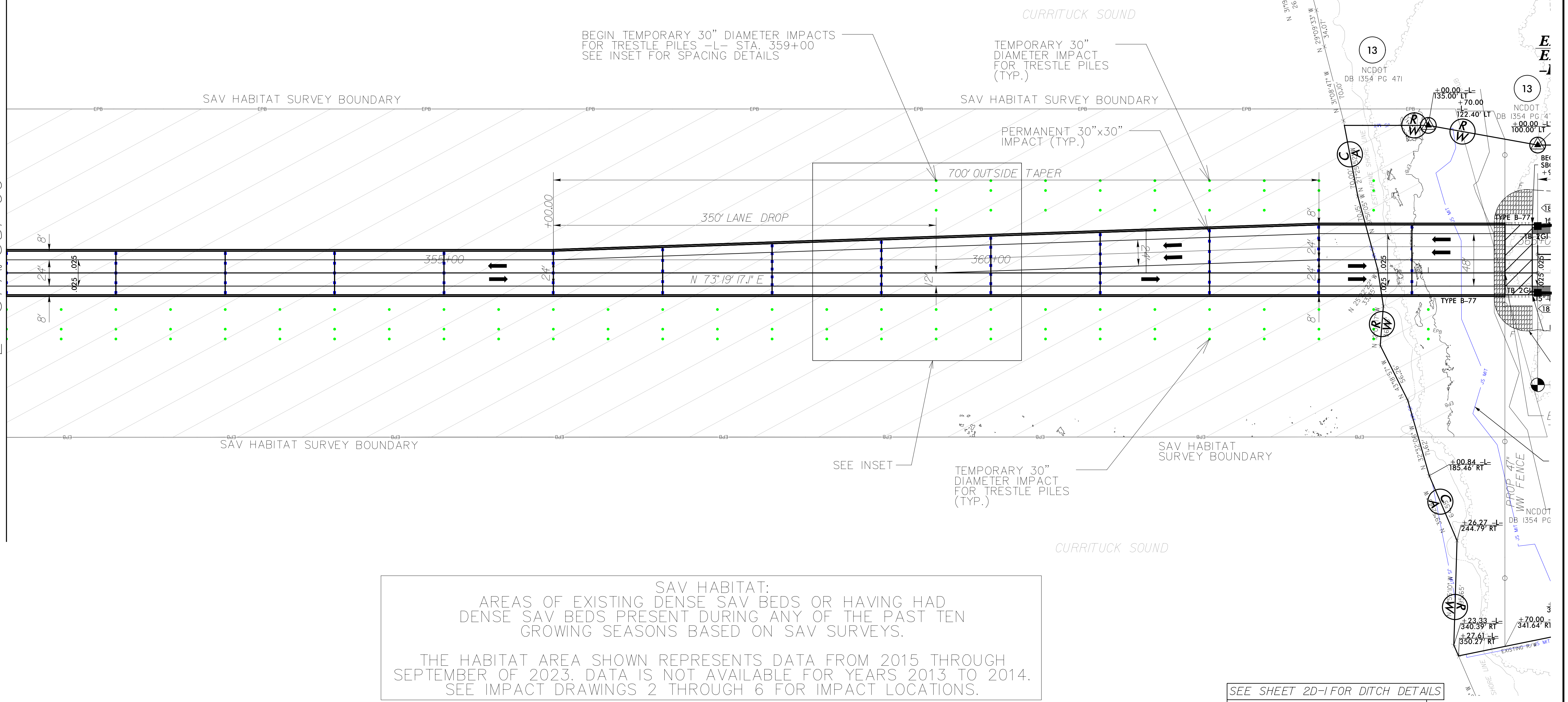

SAV HABITAT:
AREAS OF EXISTING DENSE SAV BEDS OR HAVING HAD DENSE SAV BEDS PRESENT DURING ANY OF THE PAST TEN GROWING SEASONS BASED ON SAV SURVEYS.

THE HABITAT AREA SHOWN REPRESENTS DATA FROM 2015 THROUGH SEPTEMBER OF 2023. DATA IS NOT AVAILABLE FOR YEARS 2013 TO 2014. SEE IMPACT DRAWINGS 2 THROUGH 6 FOR IMPACT LOCATIONS.

SEE SHEET 2D-I FOR DITCH DETAILS
SEE SHEET 35 FOR -L- PROFILE

R2/7/2023
R2576.dwg_psh17_SAV_Habitat.dgn
SACH010

TEMPORARY 30" DIAMETER IMPACT FOR TRESTLE PILES (TYP.)

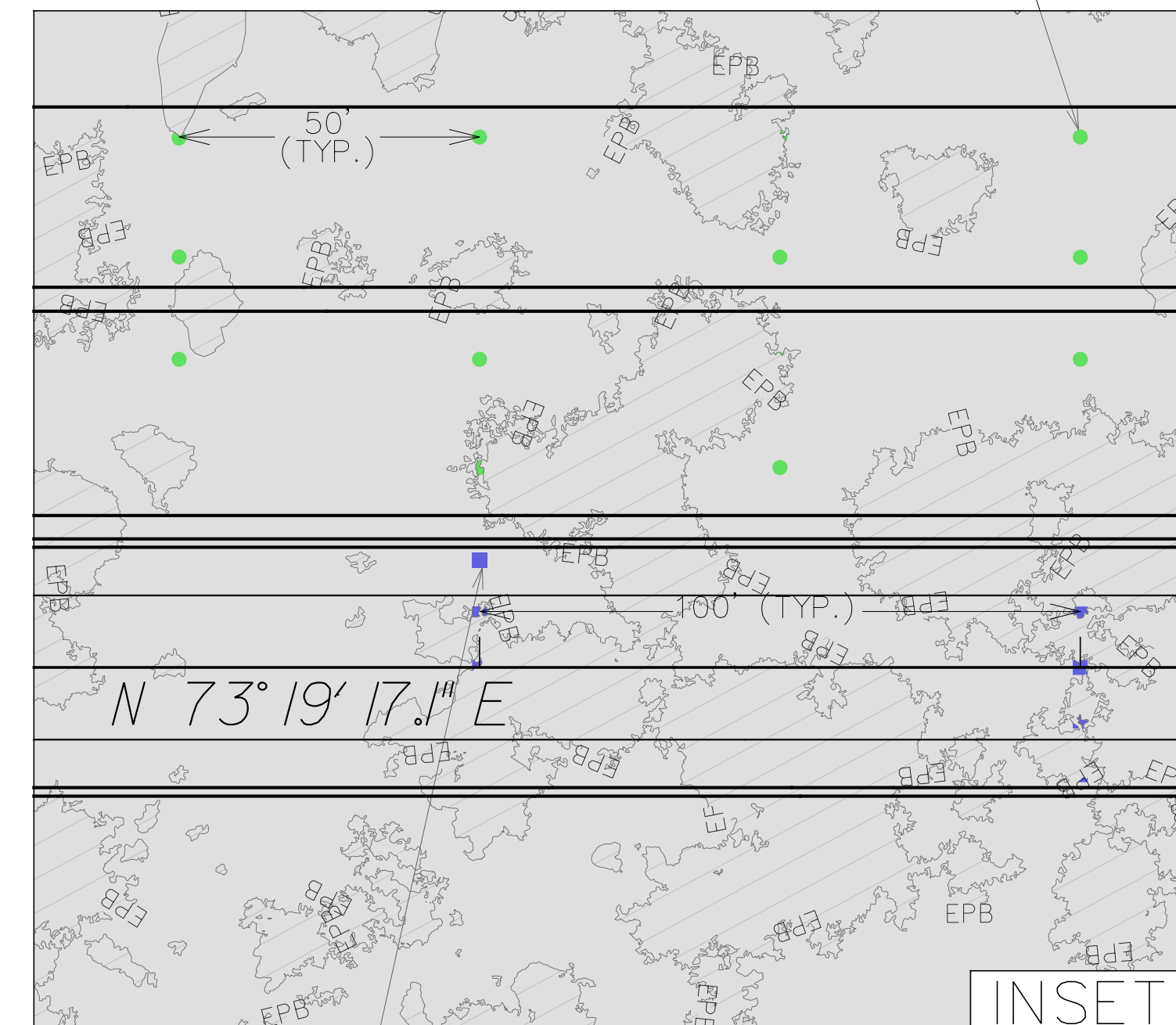

PERMANENT 30"x30" IMPACT (TYP.)

LEGEND	
	WATER DEPTH 6 FT OR LESS
	SAV HABITAT
	POTENTIAL PERMANENT PILE IMPACTS
	POTENTIAL TEMPORARY PILE IMPACTS

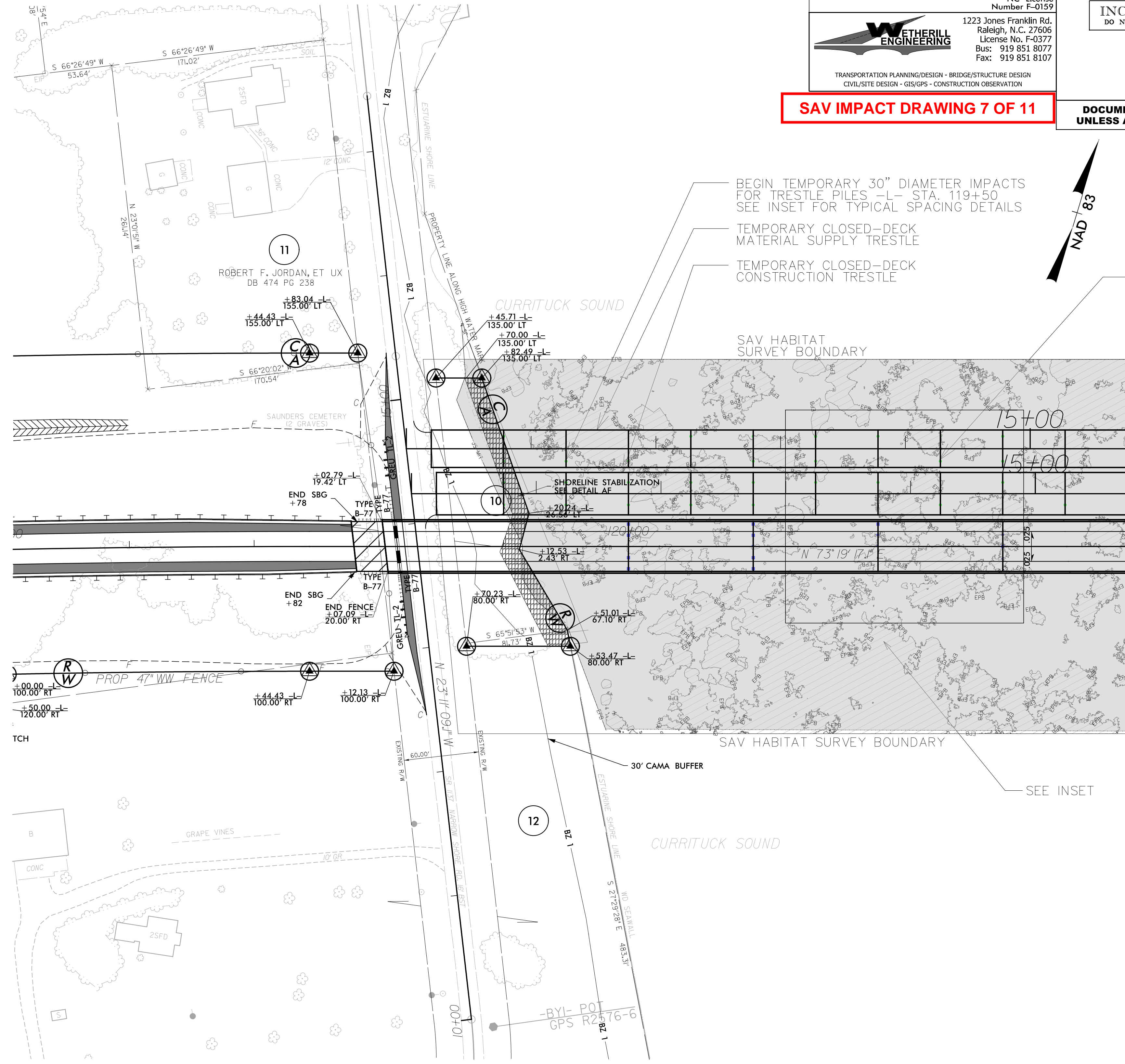

BEGIN TEMPORARY 30" DIAMETER IMPACTS FOR TRESTLE PILES -L- STA. 119+50
SEE INSET FOR TYPICAL SPACING DETAILS
TEMPORARY CLOSED-DECK MATERIAL SUPPLY TRESTLE
TEMPORARY CLOSED-DECK CONSTRUCTION TRESTLE

TEMPORARY 30" DIAMETER IMPACT FOR TRESTLE PILES (TYP.)

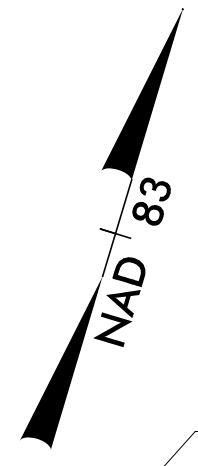



MATCHLINE SHEET 13
-L- STA. 124+00

POTENTIAL SAV HABITAT:

POTENTIAL SAV HABITAT IS PRESENT IN AREAS WITH WATER DEPTHS SIX FEET OR LESS AND HAVE SUITABLE SUBSTRATE TO SUPPORT SAV. IMPACT AREAS REPRESENT IMPACTS OUTSIDE OF THOSE ALREADY ACCOUNTED FOR AS SAV HABITAT. SEE IMPACT DRAWINGS 7 THROUGH 11 FOR IMPACT LOCATIONS.

SEE SHEET 2D-I FOR DITCH DETAILS
SEE SHEET 35 FOR -L- PROFILE
SEE SHEET 47 FOR -Y3- PROFILE

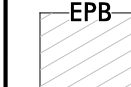
REVISIONS	

LEGEND	
	SAV HABITAT
	PERMANENT PILE IMPACTS
	TEMPORARY PILE IMPACTS

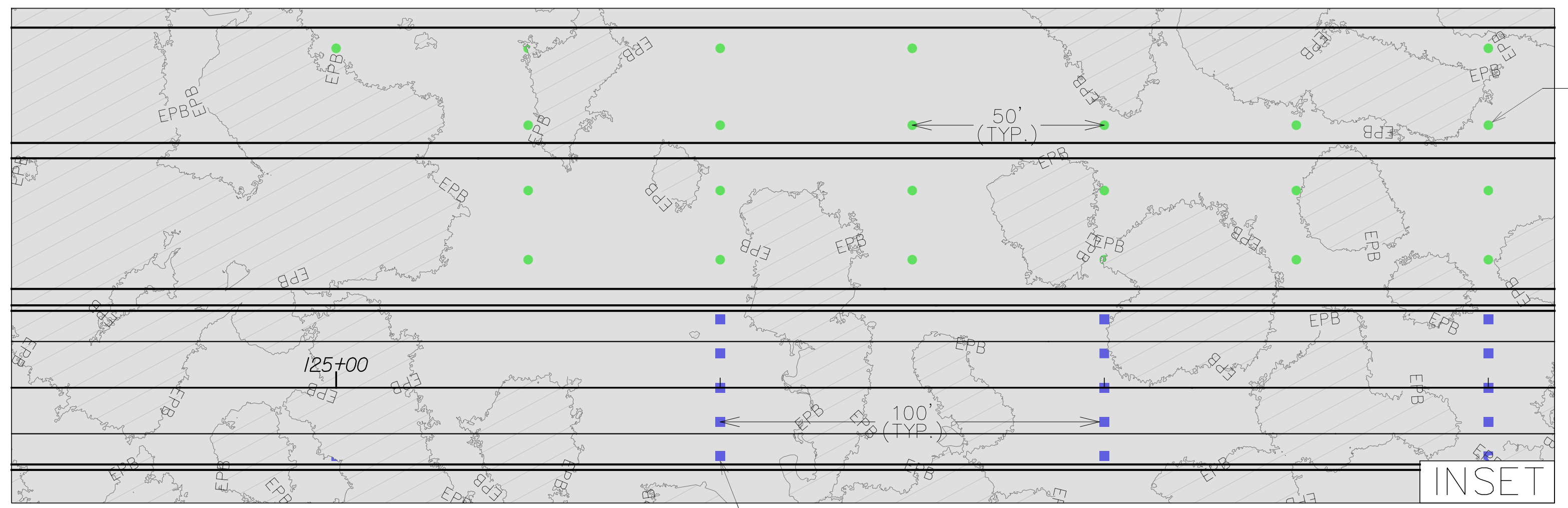

TEMPORARY 30" DIAMETER IMPACT FOR TRESTLE PILES (TYP.)

SAV IMPACT DRAWING 8 OF 11

LOCHNER
 H. W. LOCHNER, INC.
 2840 PARK PLACE SUITE 202
 RALEIGH, NC 27612
 (919) 571-7111

PROJECT REFERENCE NO. P-2576 SHEET NO. 15
 ROADWAY DESIGN ENGINEER HYDRAULICS ENGINEER
 NC License Number E-00322

INCOMPLETE PLANS
 DO NOT USE FOR V.P. ACQUISITION

DOCUMENT NOT CONSIDERED FINAL UNLESS ALL SIGNATURES COMPLETED

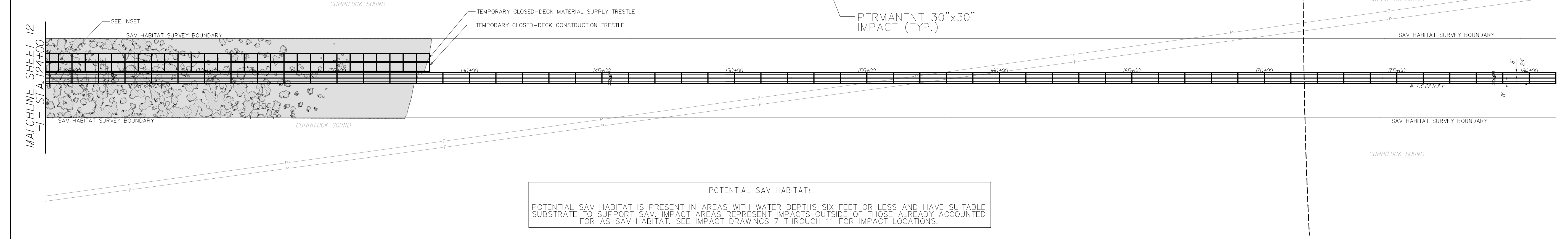

POTENTIAL SAV HABITAT:
 POTENTIAL SAV HABITAT IS PRESENT IN AREAS WITH WATER DEPTHS SIX FEET OR LESS AND HAVE SUITABLE SUBSTRATE TO SUPPORT SAV. IMPACT AREAS REPRESENT IMPACTS OUTSIDE OF THOSE ALREADY ACCOUNTED FOR AS SAV HABITAT. SEE IMPACT DRAWINGS 7 THROUGH 11 FOR IMPACT LOCATIONS.

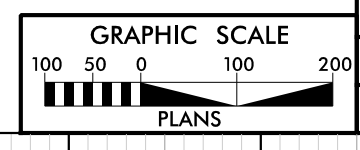

LOCATION:	
TP NO.:	COUNTY:
DESIGNED BY:	
CHECKED BY:	DATE:

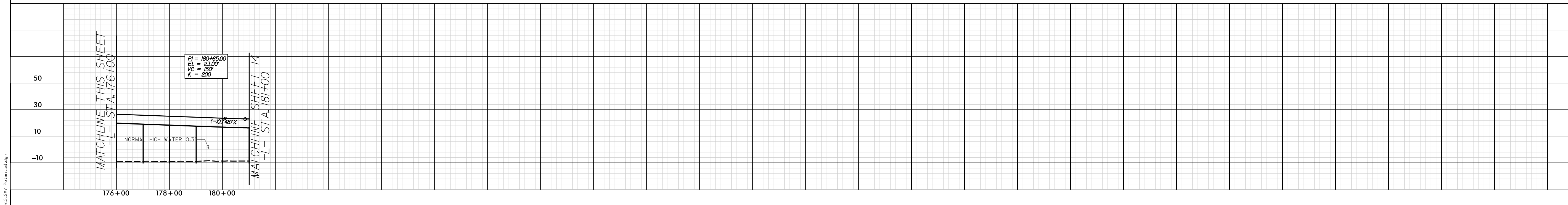
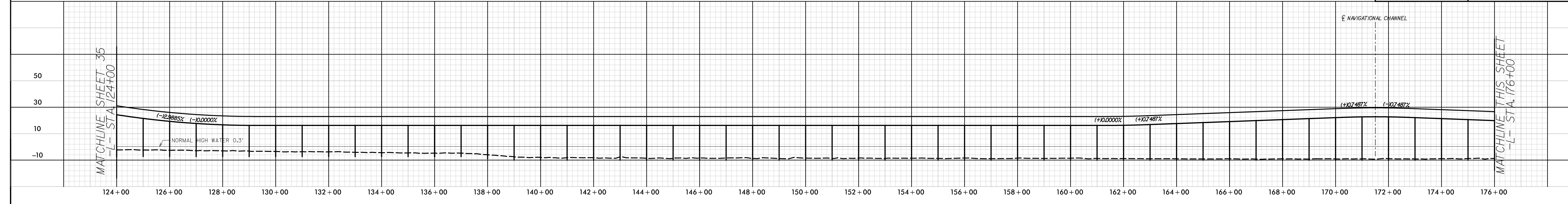

08/16/2023 10:43:33 AM SAV_Permit15.dwg

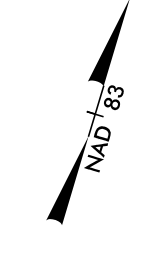

SAV IMPACT DRAWING 9 OF 11

REVISIONS

LEGEND

■ WATER DEPTH 6 FT OR LESS

▨ EPB SAV HABITAT

NOTE:
 NO PERMANENT NOR TEMPORARY
 POTENTIAL PILE IMPACTS ARE
 SHOWN ON THIS SHEET

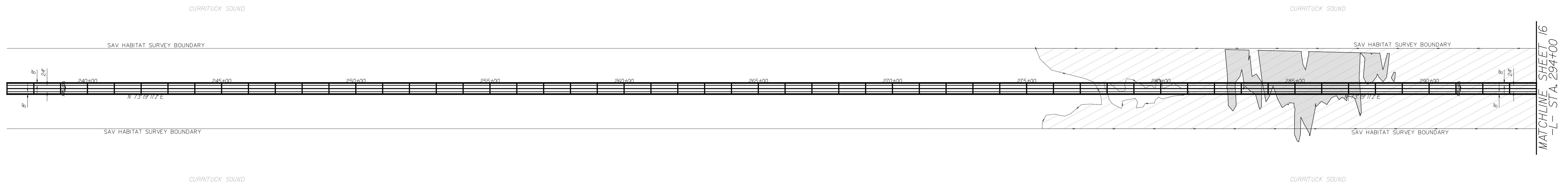

POTENTIAL SAV HABITAT:
 POTENTIAL SAV HABITAT IS PRESENT IN AREAS WITH WATER DEPTHS SIX FEET OR LESS AND HAVE SUITABLE SUBSTRATE TO SUPPORT SAV. IMPACT AREAS REPRESENT IMPACTS OUTSIDE OF THOSE ALREADY ACCOUNTED FOR AS SAV HABITAT. SEE IMPACT DRAWINGS 7 THROUGH 11 FOR IMPACT LOCATIONS.

GRAPHIC SCALE
 100 50 0 100 200
 PLANS

LOCATION: _____
 TIP NO.: _____ COUNTY: _____
 DESIGNED BY: _____
 CHECKED BY: _____ DATE: _____

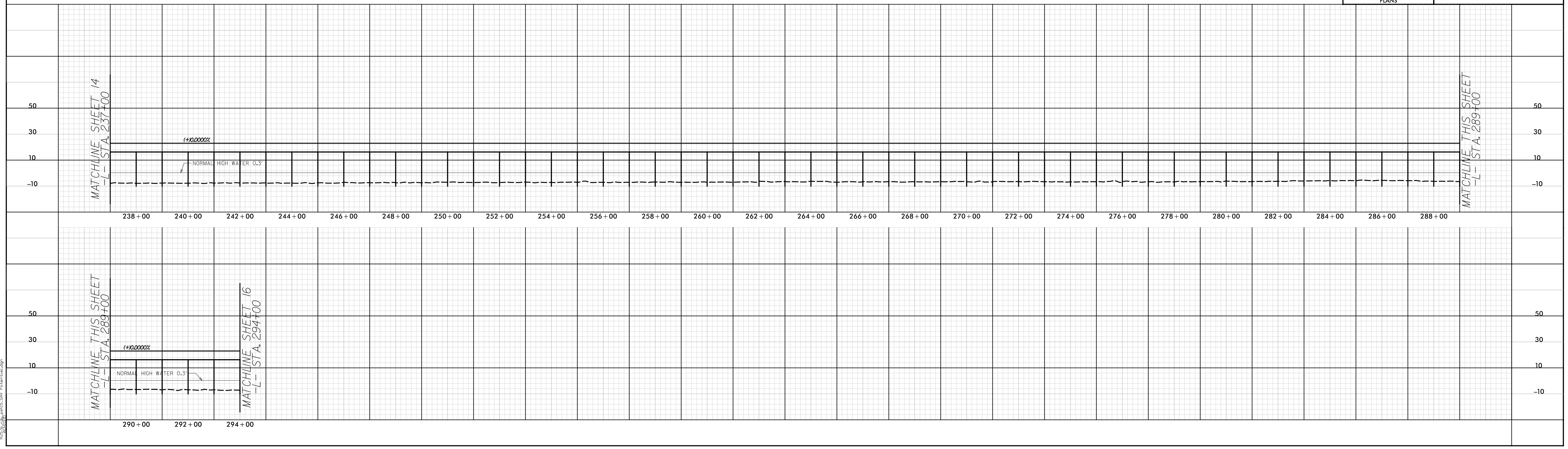

R:\Projects\2015\H-2576\Drawings\SAV_Potential.dwg

SAV IMPACT DRAWING 10 OF 11

REVISIONS

LEGEND

■ WATER DEPTH 6 FT OR LESS

▨ EPB SAV HABITAT

NOTE:
 NO PERMANENT NOR TEMPORARY
 POTENTIAL PILE IMPACTS ARE
 SHOWN ON THIS SHEET

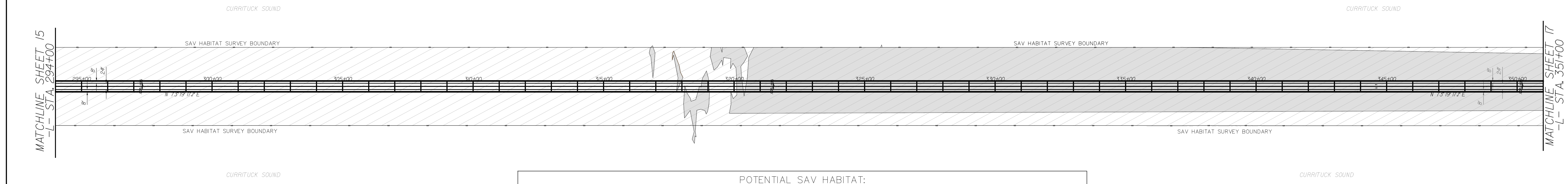

POTENTIAL SAV HABITAT:
 POTENTIAL SAV HABITAT IS PRESENT IN AREAS WITH WATER DEPTHS SIX FEET OR LESS AND HAVE SUITABLE SUBSTRATE TO SUPPORT SAV. IMPACT AREAS REPRESENT IMPACTS OUTSIDE OF THOSE ALREADY ACCOUNTED FOR AS SAV HABITAT. SEE IMPACT DRAWINGS 7 THROUGH 11 FOR IMPACT LOCATIONS.

GRAPHIC SCALE
 100 50 0 100 200
 PLANS

LOCATION: _____
 TIP NO.: _____ COUNTY: _____
 DESIGNED BY: _____
 CHECKED BY: _____ DATE: _____

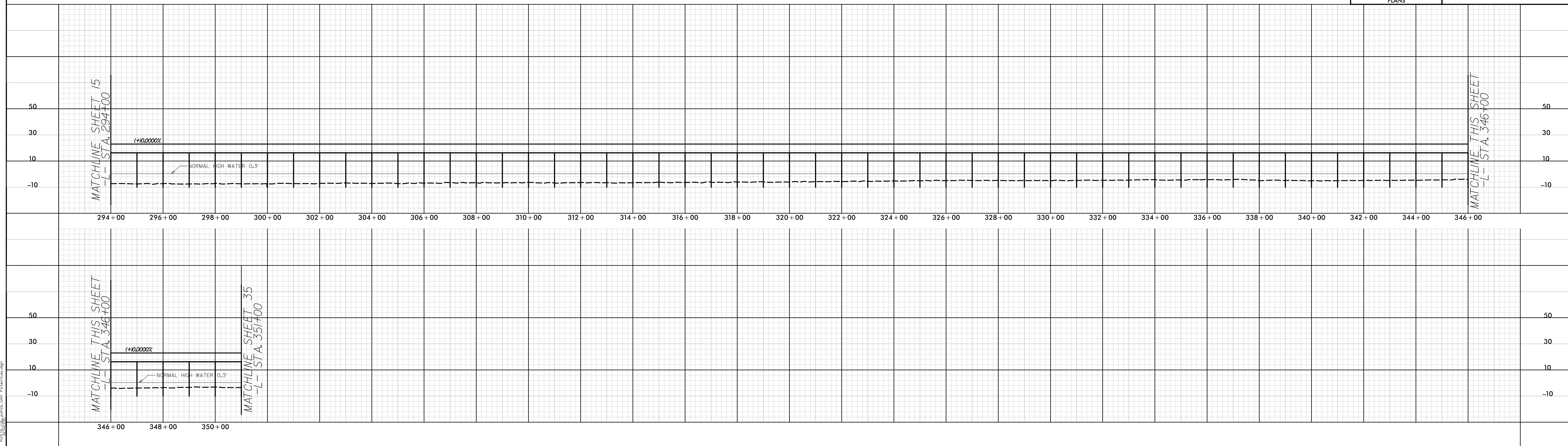

R:\Projects\2010\A-2576\Drawings\10 of 11 SAV Impact.dwg
 10/11/10
 H:\Users\jlochner\My Documents\10 of 11 SAV Impact.dwg

LEGEND

- WATER DEPTH 6 FT OR LESS
- SAV HABITAT
- POTENTIAL PERMANENT PILE IMPACTS
- POTENTIAL TEMPORARY PILE IMPACTS

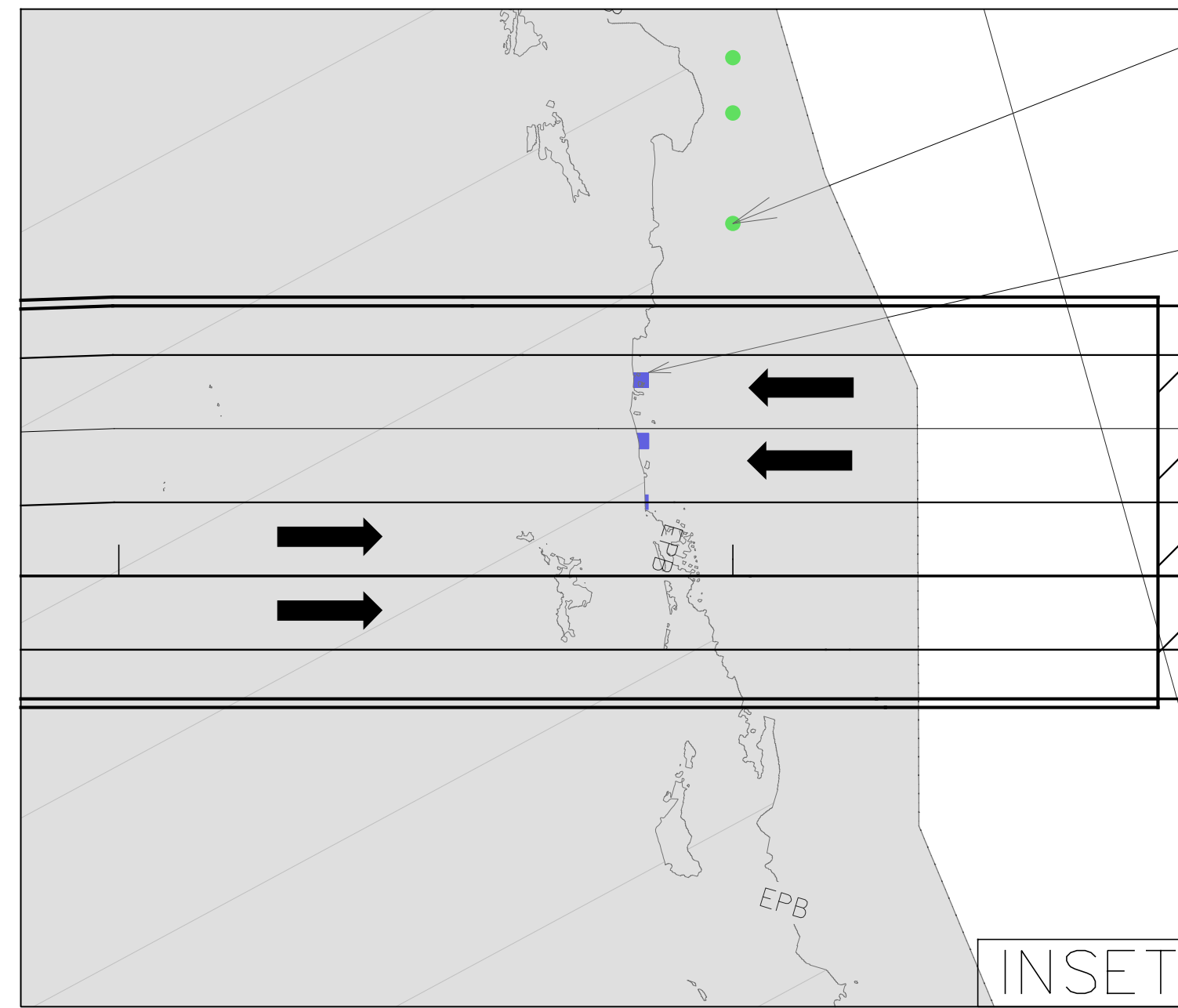

TEMPORARY 30" DIAMETER IMPACT FOR TRESTLE PILES (TYP.)

PERMANENT 30"x30" IMPACT (TYP.)

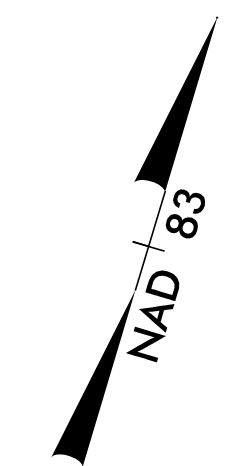

MATCHLINE SHEET 16
-L- STA. 351+00

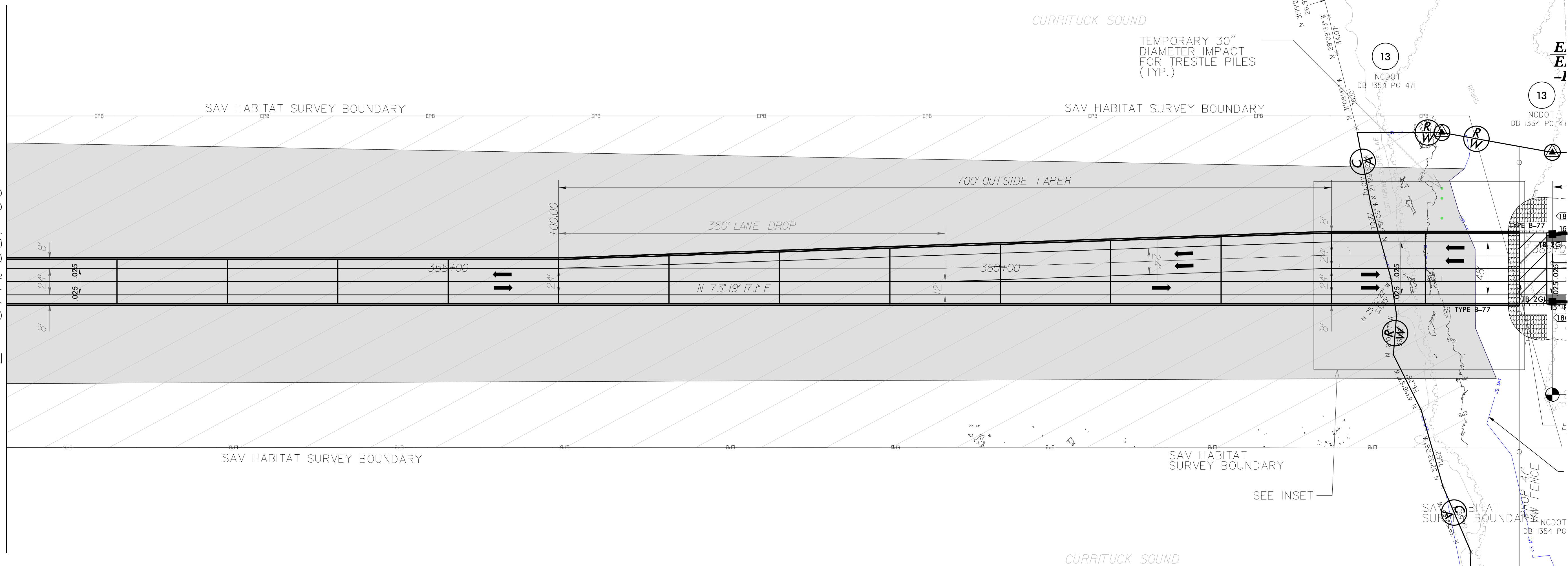

POTENTIAL SAV HABITAT:

POTENTIAL SAV HABITAT IS PRESENT IN AREAS WITH WATER DEPTHS SIX FEET OR LESS AND HAVE SUITABLE SUBSTRATE TO SUPPORT SAV. IMPACT AREAS REPRESENT IMPACTS OUTSIDE OF THOSE ALREADY ACCOUNTED FOR AS SAV HABITAT. SEE IMPACT DRAWINGS 7 THROUGH 11 FOR IMPACT LOCATIONS.

SEE SHEET 2D-I FOR DITCH DETAILS
SEE SHEET 35 FOR -L- PROFILE