

**LEGEND**

ROAD	TELEPHONE	CABLE
4 LANE UNDIVIDED HIGHWAY	RES. / PARK BLDG.	RESERVATION OR PARK BOUNDARY
DIVIDED HIGHWAY		INSET AREA
FULL CONTROL ACCESS		FREE OR TOLL FERRY
DETAILED HIGHWAY INTERCHANGE		CANAL
ROAD THROUGH MOUNTAIN PASS		NARROW STREAM
HIGHWAY BRIDGE		WIDE STREAM
UNDERPASS		DAM WITH LOCK
OVERPASS		DAM
DRAW SPAN ON BRIDGE		RESERVOIR, POND, OR LAKE
HIGHWAY TUNNEL		COUNTY SEAT
FORD		COMMUNITY AND TOWN CENTER
INTERSTATE HIGHWAY		TOWN HALL
U.S. NUMBERED HIGHWAY		SCHOOL
N.C. NUMBERED HIGHWAY		COLLEGE OR UNIVERSITY
U.S. NUMBERED BICYCLE ROUTE		HOSPITAL
N.C. NUMBERED BICYCLE ROUTE		CHURCH
INTERSTATE INTERCHANGE NUMBER		CHURCH WITH CEMETERY
SECONDARY ROAD NUMBER		CEMETERY
RAILROAD, ANY NUMBER OF TRACKS USED BY SINGLE OPERATING COMPANY		FARM/GROUND OR RACETRACK
RAILROAD, ANY NUMBER OF TRACKS USED BY MORE THAN ONE OPERATING COMPANY OR SAME OR ADJACENT RIGHTS-OF-WAY		POST OFFICE
RAILROAD STATION		POWER PLANT
GRADE CROSSING		POWER SUBSTATION
UNDERPASS		PATROL STATION
OVERPASS		CORRECTIONAL OR PENAL INSTN.
RAILROAD TUNNEL		HIGHWAY GARAGE OR MAINT. YARD
RAILROAD BRIDGE		HIGHWAY DIV. OR DIST. OFFICE
UNINCORPORATED CENSUS DESIGNATED PLACE		WEIGHT STATION
CITY LIMIT		SWAMP OR MARSH
COUNTY LINE		GRAVEL PIT OR QUARRY
STATE LINE		MONUMENT-SMALL HISTORICAL SITE
INCORPORATED CITY OR VILLAGE (GENERALIZED)		LIGHTHOUSE
		MOUNTAIN PEAK
		MINE
		REST AREA
		MUNICIPAL PARK
		TRIANGULATION STATION
		COAST GUARD STATION
		ARMORY
		FEDERAL GAME LAND
		MILITARY AIRFIELD
		COMMERCIAL OR MUNICIPAL FIELD
		HANGAR ON FIELD
		LANDING STRIP
		MARKED AUXILIARY FIELD
		WAREHOUSES OR MANUFACTURING PLANTS
		SHOPPING CENTERS

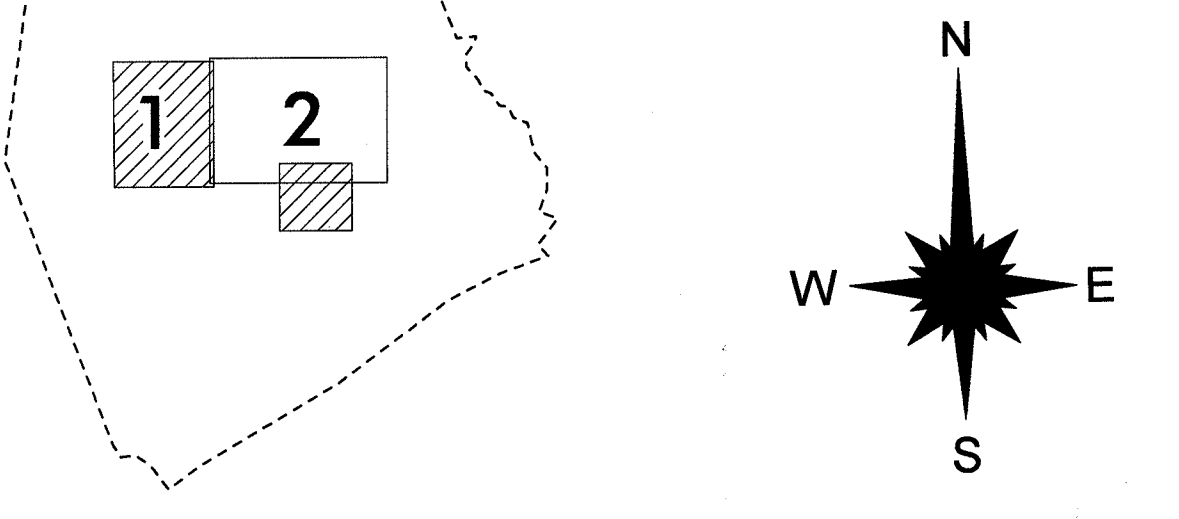

**SHEET KEY**

**2014 ANNUAL AVERAGE DAILY TRAFFIC**

GENERATED BY THE  
**TRAFFIC SURVEY GROUP**  
 TRANSPORTATION PLANNING BRANCH

**JACKSONVILLE**  
 INCLUDED IN  
 ONSLOW COUNTY  
**NORTH CAROLINA**

BASE MAPPING PREPARED BY  
 NORTH CAROLINA DEPARTMENT OF TRANSPORTATION  
 STATE ROAD MAINTENANCE UNIT  
 MAPPING & INFORMATION SECTION

IN COOPERATION WITH THE  
 U.S. DEPARTMENT OF TRANSPORTATION  
 FEDERAL HIGHWAY ADMINISTRATION

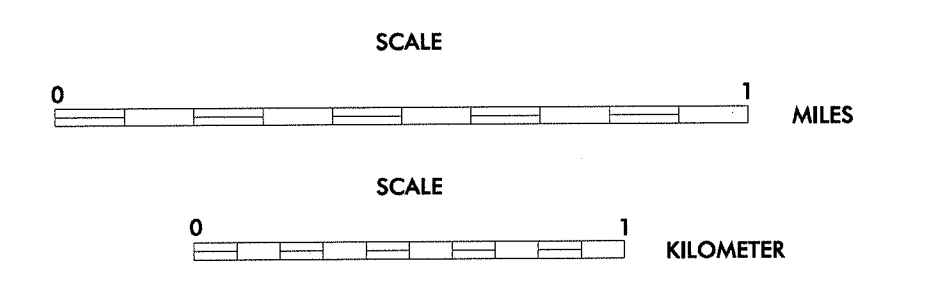





**LEGEND**

ROAD	TEL. TELETYPE	CABLE
4 LANE UNDIVIDED HIGHWAY	RES. / PARK BLDG.	RESERVATION OR PARK BOUNDARY
DIVIDED HIGHWAY		INSET AREA
F.C.A.		FREE OR TOLL FERRY
FULL CONTROL ACCESS		CANAL
DETAILED HIGHWAY INTERCHANGE		NARROW STREAM
ROAD THROUGH MOUNTAIN PASS		WIDE STREAM
HIGHWAY BRIDGE		DAM WITH LOCK
UNDERPASS		DAM
OVERPASS		RESERVOIR, POND, OR LAKE
DRAW SPAN ON BRIDGE		COUNTY SEAT
HIGHWAY TUNNEL		COMMUNITY AND TOWN CENTER
FORD		TOWN HALL
INTERSTATE HIGHWAY		SCHOOL
U.S. NUMBERED HIGHWAY		COLLEGE OR UNIVERSITY
N.C. NUMBERED HIGHWAY		HOSPITAL
U.S. NUMBERED BICYCLE ROUTE		CHURCH
N.C. NUMBERED BICYCLE ROUTE		CHURCH WITH CEMETERY
INTERSTATE INTERCHANGE NUMBER		CEMETERY
SECONDARY ROAD NUMBER		PARKING LOT OR RACETRACK
RAILROAD, ANY NUMBER OF TRACKS USED BY SINGLE OPERATING COMPANY		POST OFFICE
RAILROAD, ANY NUMBER OF TRACKS USED BY MORE THAN ONE OPERATING COMPANY ON SAME OR ADJACENT RIGHTS-OF-WAY		POWER SUBSTATION
RAILROAD STATION		PATROL STATION
GRADE CROSSING		CORRECTIONAL OR PENAL INSTN.
UNDERPASS		HIGHWAY GARAGE OR MAINT. YARD
OVERPASS		HIGHWAY DIV. OR DIST. OFFICE
RAILROAD TUNNEL		WEIGHT STATION
RAILROAD BRIDGE		SWAMP OR MARSH
UNINCORPORATED CENSUS DESIGNATED PLACE		GRAVEL PIT OR QUARRY
CITY LIMIT		MONUMENT-SMALL HISTORICAL SITE
COUNTY LINE		LIGHTHOUSE
STATE LINE		MOUNTAIN PEAK
INCORPORATED CITY OR VILLAGE, (GENERALIZED)		MINE
		REST AREA
		MUNICIPAL PARK
		TRIANGULATION STATION
		COAST GUARD STATION
		FEDERAL GAME LAND
		MILITARY AIRFIELD
		COMMERCIAL OR MUNICIPAL FIELD
		HANGAR ON FIELD
		LANDING STRIP
		MARKED AUXILIARY FIELD
		WAREHOUSES OR MANUFACTURING PLANTS
		SHOPPING CENTERS

SHEET KEY

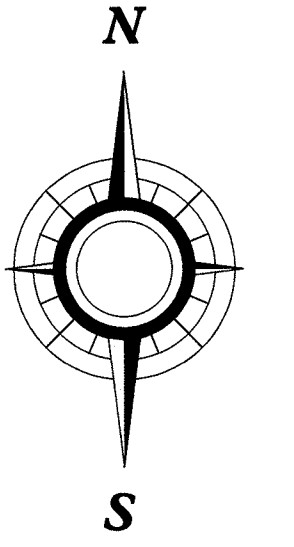
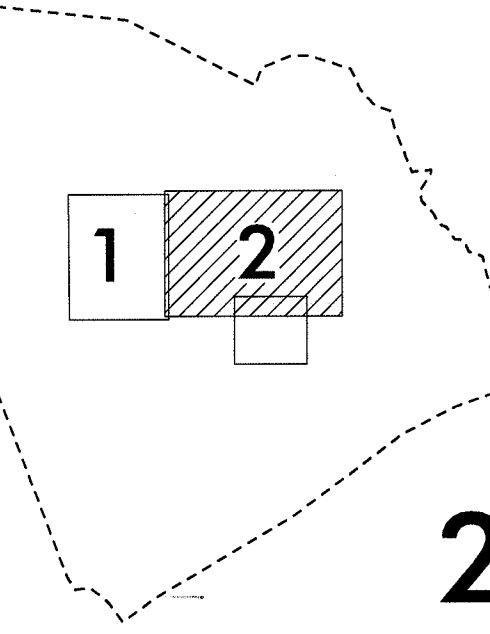

**2014**  
**ANNUAL AVERAGE**  
**DAILY TRAFFIC**  
 PREPARED BY  
**TRAFFIC SURVEY UNIT**  
**JACKSONVILLE**

INCLUDED IN  
 ONSLOW COUNTY

**NORTH CAROLINA**

PREPARED BY  
 NORTH CAROLINA DEPARTMENT OF TRANSPORTATION  
 DIVISION OF HIGHWAYS - GIS UNIT  
 IN COOPERATION WITH THE  
 U.S. DEPARTMENT OF TRANSPORTATION  
 FEDERAL HIGHWAY ADMINISTRATION

