

- ROAD  
4 LANE UNDIVIDED HIGHWAY  
DIVIDED HIGHWAY  
FCA  
FULL CONTROL ACCESS  
DETAILED HIGHWAY INTERCHANGE  
ROAD THROUGH MOUNTAIN PASS  
HIGHWAY BRIDGE  
UNDERPASS  
OVERPASS  
DRAW SPAN ON BRIDGE  
HIGHWAY TUNNEL  
FORD  
INTERSTATE HIGHWAY  
U.S. NUMBERED HIGHWAY  
N.C. NUMBERED HIGHWAY  
U.S. NUMBERED BICYCLE ROUTE  
N.C. NUMBERED BICYCLE ROUTE  
INTERSTATE INTERCHANGE NUMBER  
SECONDARY ROAD NUMBER  
RAILROAD ANY NUMBER OF TRACKS  
USED BY SINGLE OPERATING COMPANY  
RAILROAD ANY NUMBER OF TRACKS  
USED BY MORE THAN ONE OPERATION  
COMPANY ON SAME OR ADJACENT  
RIGHTS-OF-WAY  
RAILROAD STATION  
GRADE CROSSING  
UNDERPASS  
OVERPASS  
RAILROAD TUNNEL  
RAILROAD BRIDGE  
UNINCORPORATED CENSUS  
DESIGNATED PLACE  
CITY LIMIT  
COUNTY LINE  
STATE LINE  
INCORPORATED CITY OR VILLAGE,  
(GENERALIZED)
- LEGEND
- RESERVATION OR PARK BOUNDARY  
INSET AREA  
FREE OR TOLL FERRY  
CANAL  
NARROW STREAM  
WIDE STREAM  
DAM WITH LOCK  
DAM  
RESERVOIR, POND, OR LAKE  
COUNTY SEAT  
COMMUNITY AND TOWN CENTER  
TOWN HALL  
SCHOOL  
COLLEGE OR UNIVERSITY  
HOSPITAL  
CHURCH  
CHURCH WITH CEMETERY  
CEMETERY  
FAIRGROUND OR RACETRACK  
POST OFFICE  
POWER PLANT  
POWER SUBSTATION  
PATROL STATION  
CORRECTIONAL OR PENAL INSTN.  
HIGHWAY GARAGE OR MAINT. YARD  
HIGHWAY DIV. OR DIST. OFFICE  
WEIGHT STATION  
SWAMP OR MARSH  
GRAVEL PIT OR QUARRY  
MONUMENT-SMALL HISTORICAL SITE  
LIGHTHOUSE  
MOUNTAIN PEAK  
MINE  
REST AREA  
MUNICIPAL PARK  
TRIANGULATION STATION  
COAST GUARD STATION  
ARMORY  
FEDERAL GAME LAND  
MILITARY AIRFIELD  
COMMERCIAL OR MUNICIPAL FIELD  
HANGAR ON FIELD  
LANDING STRIP  
MARKED AUXILIARY FIELD  
WAREHOUSES OR MANUFACTURING  
PLANTS  
SHOPPING CENTERS

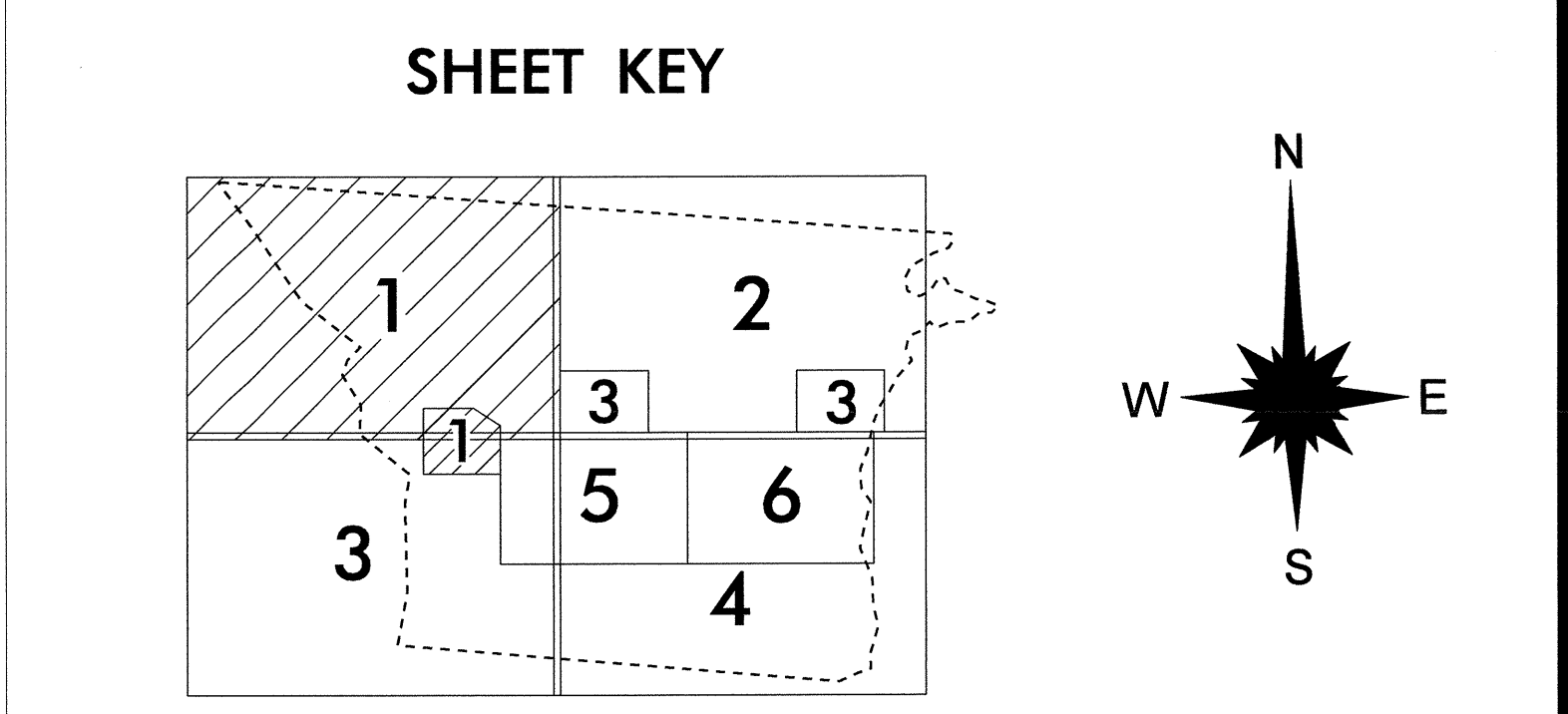

2012  
ANNUAL AVERAGE  
DAILY TRAFFIC  
GENERATED BY THE  
TRAFFIC SURVEY GROUP  
TRANSPORTATION PLANNING BRANCH  
**GASTONIA**  
INCLUDED IN  
GASTON COUNTY  
**NORTH CAROLINA**  
BASE MAPPING PREPARED BY  
NORTH CAROLINA DEPARTMENT OF TRANSPORTATION  
STATE ROAD MAINTENANCE UNIT  
MAPPING & INFORMATION SECTION  
IN COOPERATION WITH THE  
U.S. DEPARTMENT OF TRANSPORTATION  
FEDERAL HIGHWAY ADMINISTRATION

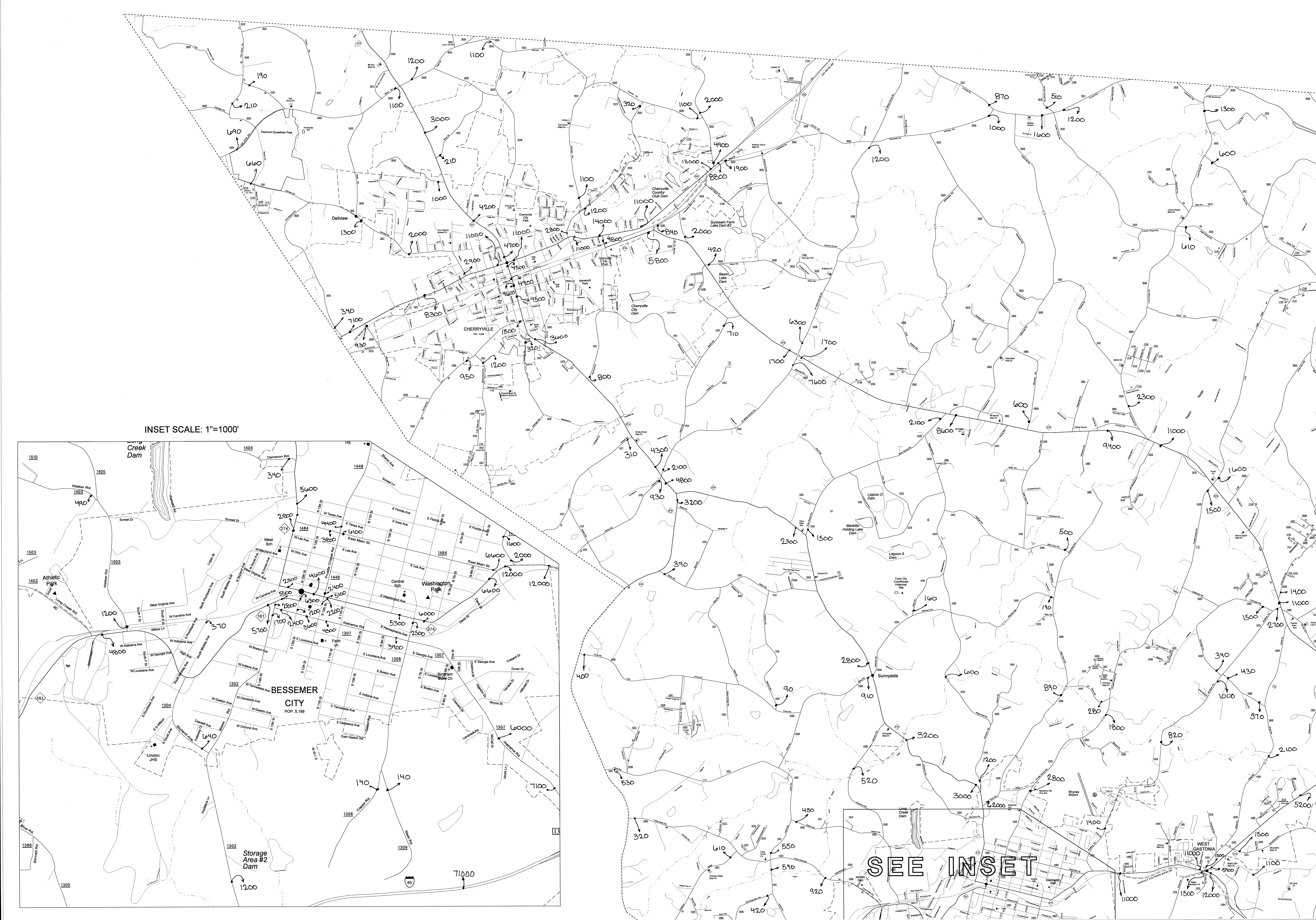
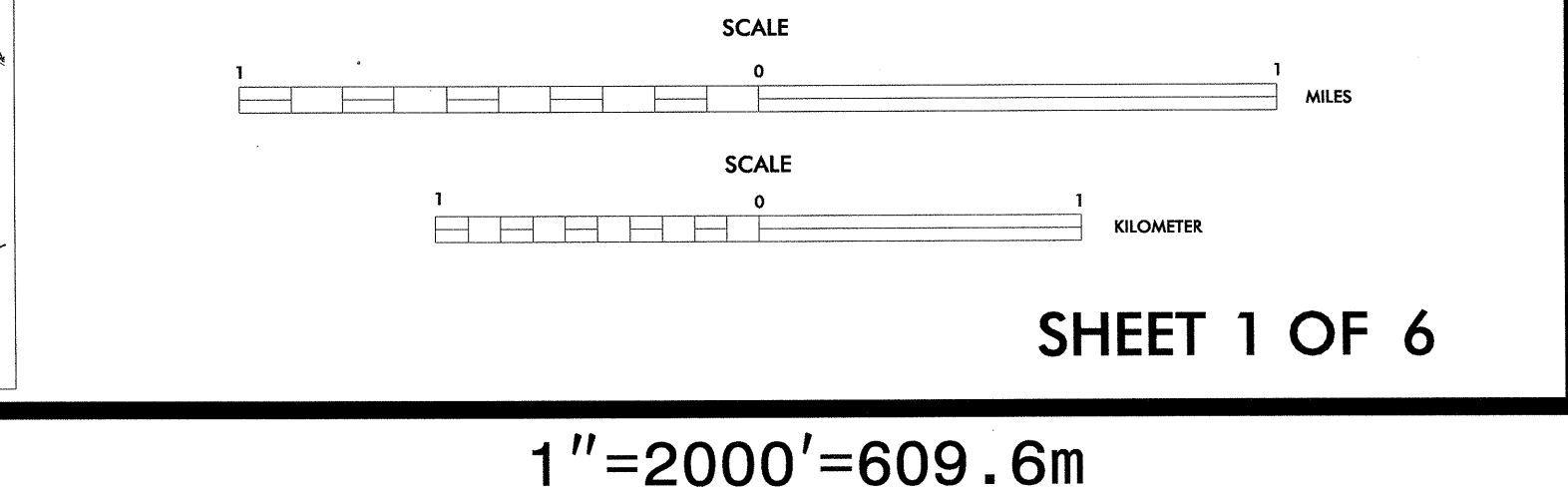

SHEET 1 OF 6  
BASE MAP  
REVISED  
MAY 2009

SEE INSET