

LEGEND

	ROAD		CABLE
	4 LANE UNDIVIDED HIGHWAY		RESERVATION OR PARK BOUNDARY
	DIVIDED HIGHWAY		INSET AREA
	FULL CONTROL ACCESS		FREE OR TOLL FERRY
	DETAILED HIGHWAY INTERCHANGE		CANAL
	ROAD THROUGH MOUNTAIN PASS		NARROW STREAM
	HIGHWAY BRIDGE		WIDE STREAM
	UNDERPASS		DAM WITH LOCK
	OVERPASS		DAM
	DRAW SPAN ON BRIDGE		RESERVOIR, POND, OR LAKE
	HIGHWAY TUNNEL		COUNTY SEAT
	FORD		COMMUNITY AND TOWN CENTER
	INTERSTATE HIGHWAY		TOWN HALL
	U.S. NUMBERED HIGHWAY		SCHOOL
	N.C. NUMBERED HIGHWAY		COLLEGE OR UNIVERSITY
	U.S. NUMBERED BICYCLE ROUTE		HOSPITAL
	N.C. NUMBERED BICYCLE ROUTE		CHURCH WITH CEMETERY
	INTERSTATE INTERCHANGE NUMBER		CEMETERY
	SECONDARY ROAD NUMBER		FAIRGROUND OR RACETRACK
	RAILROAD, ANY NUMBER OF TRACKS USED BY SINGLE OPERATING COMPANY		POST OFFICE
	RAILROAD, ANY NUMBER OF TRACKS USED BY MORE THAN ONE OPERATION COMPANY ON SAME OR ADJACENT RIGHTS-OF-WAY		POWER PLANT
	RAILROAD STATION		PATROL STATION
	GRADE CROSSING		CORRECTIONAL OR PENAL INSTN.
	UNDERPASS		HIGHWAY GARAGE OR MAINT. YARD
	OVERPASS		HIGHWAY DIV. OR DIST. OFFICE
	RAILROAD TUNNEL		WEIGHT STATION
	RAILROAD BRIDGE		SWAMP OR MARSH
	UNINCORPORATED CENSUS DESIGNATED PLACE		GRAVEL PIT OR QUARRY
	CITY LIMIT		MONUMENT-SMALL HISTORICAL SITE
	COUNTY LINE		LIGHTHOUSE
	STATE LINE		MOUNTAIN PEAK
	INCORPORATED CITY OR VILLAGE (GENERALIZED)		WINE
			REST AREA
			MUNICIPAL PARK
			TRIANGULATION STATION
			COAST GUARD STATION
			AIRFIELD
			FEDERAL GAME LAND
			MILITARY AIRFIELD
			COMMERCIAL OR MUNICIPAL FIELD
			HANGAR ON FIELD
			LANDING STRIP
			MARKED AUXILIARY FIELD
			WAREHOUSES OR MANUFACTURING PLANTS
			SHOPPING CENTERS

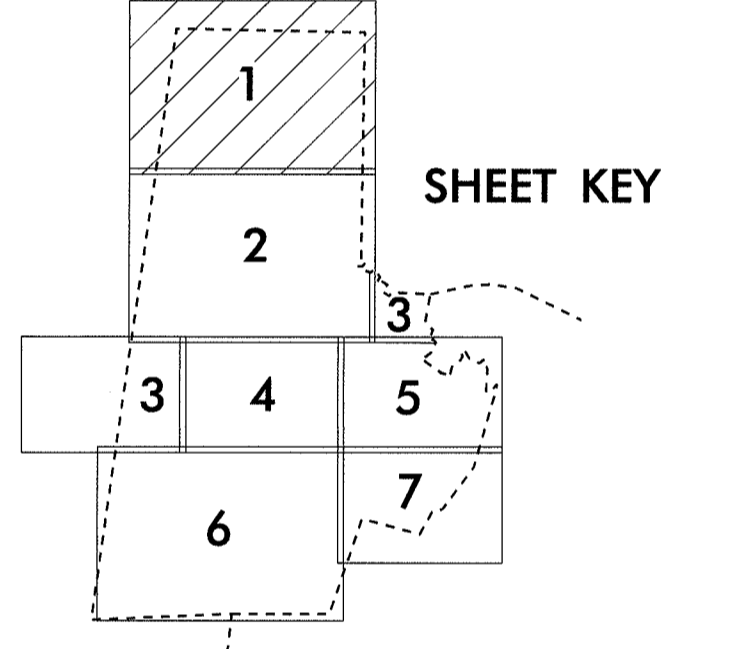

2013  
**ANNUAL AVERAGE  
 DAILY TRAFFIC**  
 GENERATED BY THE  
**TRAFFIC SURVEY GROUP**  
 TRANSPORTATION PLANNING BRANCH

**DURHAM**  
 INCLUDED IN  
 DURHAM COUNTY  
**NORTH CAROLINA**

BASE MAPPING PREPARED BY  
 NORTH CAROLINA DEPARTMENT OF TRANSPORTATION  
 STATE ROAD MAINTENANCE UNIT  
 MAPPING & INFORMATION SECTION

IN COOPERATION WITH THE  
 U.S. DEPARTMENT OF TRANSPORTATION  
 FEDERAL HIGHWAY ADMINISTRATION

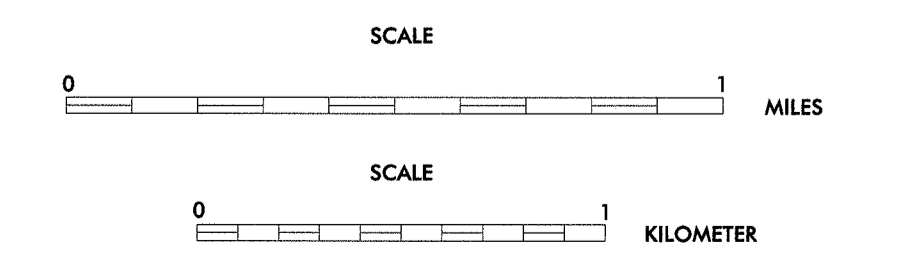

1" = 1500' = 457.2m

BASE MAP  
 REVISED  
 AUG 2009



LEGEND

ROAD	4 LANE UNDIVIDED HIGHWAY	DIVIDED HIGHWAY	FCA	FULL CONTROL ACCESS	DETAILED HIGHWAY INTERCHANGE	ROAD THROUGH MOUNTAIN PASS	HIGHWAY BRIDGE	OVERPASS	UNDERPASS	DRAW SPAN ON BRIDGE	HIGHWAY TUNNEL	FORD	INTERSTATE HIGHWAY	U.S. NUMBERED HIGHWAY	N.C. NUMBERED HIGHWAY	U.S. NUMBERED BICYCLE ROUTE	N.C. NUMBERED BICYCLE ROUTE	INTERSTATE INTERCHANGE NUMBER	SECONDARY ROAD NUMBER	RAILROAD, ANY NUMBER OF TRACKS USED BY SINGLE OPERATING COMPANY	RAILROAD, ANY NUMBER OF TRACKS USED BY MORE THAN ONE OPERATING COMPANY ON SAME OR ADJACENT RIGHTS-OF-WAY	RAILROAD STATION	GRADE CROSSING	UNDERPASS	OVERPASS	RAILROAD TUNNEL	RAILROAD BRIDGE	UNINCORPORATED CENSUS DESIGNATED PLACE	CITY LIMIT	COUNTY LINE	STATE LINE	UNINCORPORATED CITY OR VILLAGE, (GENERALIZED)	TELE/ELECT/PPE	RES./PARK BLDG.	CABLE	RESERVOIR OR PARK BOUNDARY	INSET AREA	FREE OR TOLL FERRY	CANAL	NARROW STREAM	WIDE STREAM	DAM WITH LOCK	DAM	RESERVOIR, POND, OR LAKE	COUNTY SEAT	COMMUNITY AND TOWN CENTER	TOWN HALL	SCHOOL	COLLEGE OR UNIVERSITY	HOSPITAL	CHURCH	CHURCH WITH CEMETERY	CEMETERY	FAIRGROUND OR RACETRACK	POST OFFICE	POWER PLANT	POWER SUBSTATION	PATROL STATION	CORRECTIONAL OR PENAL INSTN.	HIGHWAY GARAGE OR MAINT. YARD	HIGHWAY DIV. OR DIST. OFFICE	WEIGHT STATION	SWAMP OR MARSH	GRAVEL PIT OR QUARRY	MONUMENT-SMALL HISTORICAL SITE	LIGHTHOUSE	MOUNTAIN PEAK	MINE	REST AREA	MUNICIPAL PARK	TRIANGULATION STATION	COAST GUARD STATION	ARMORY	FEDERAL GAME LAND	MILITARY AIRFIELD	COMMERCIAL OR MUNICIPAL FIELD	HANGAR ON FIELD	LANDING STRIP	MARKED AUXILIARY FIELD	WAREHOUSES OR MANUFACTURING PLANTS	SHOPPING CENTERS
------	--------------------------	-----------------	-----	---------------------	------------------------------	----------------------------	----------------	----------	-----------	---------------------	----------------	------	--------------------	-----------------------	-----------------------	-----------------------------	-----------------------------	-------------------------------	-----------------------	---	--	------------------	----------------	-----------	----------	-----------------	-----------------	--	------------	-------------	------------	---	----------------	-----------------	-------	----------------------------	------------	--------------------	-------	---------------	-------------	---------------	-----	--------------------------	-------------	---------------------------	-----------	--------	-----------------------	----------	--------	----------------------	----------	-------------------------	-------------	-------------	------------------	----------------	------------------------------	-------------------------------	------------------------------	----------------	----------------	----------------------	--------------------------------	------------	---------------	------	-----------	----------------	-----------------------	---------------------	--------	-------------------	-------------------	-------------------------------	-----------------	---------------	------------------------	------------------------------------	------------------

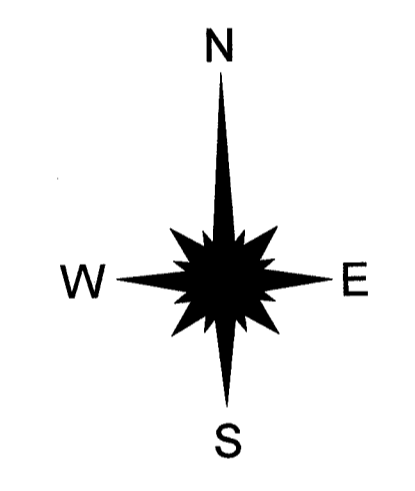
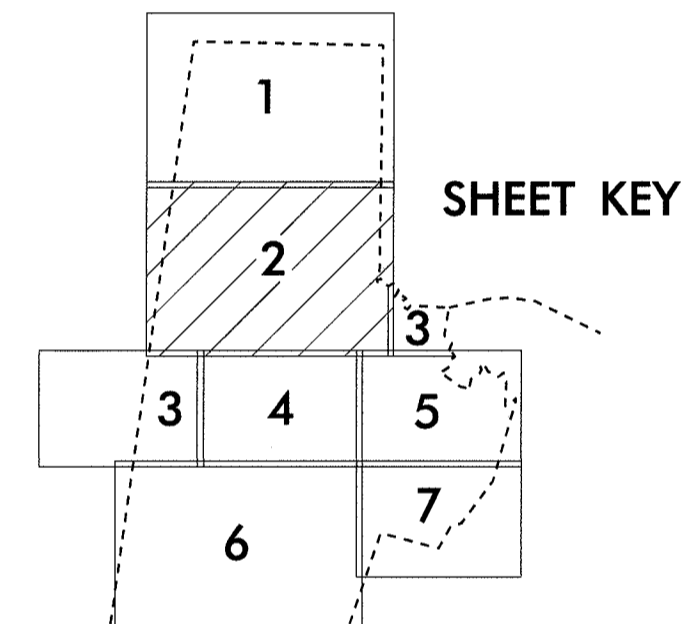

2013  
ANNUAL AVERAGE  
DAILY TRAFFIC  
GENERATED BY THE  
TRAFFIC SURVEY GROUP  
TRANSPORTATION PLANNING BRANCH  
**DURHAM**  
INCLUDED IN  
DURHAM COUNTY  
**NORTH CAROLINA**

BASE MAPPING PREPARED BY  
NORTH CAROLINA DEPARTMENT OF TRANSPORTATION  
STATE ROAD MAINTENANCE UNIT  
MAPPING & INFORMATION SECTION  
IN COOPERATION WITH THE  
U.S. DEPARTMENT OF TRANSPORTATION  
FEDERAL HIGHWAY ADMINISTRATION

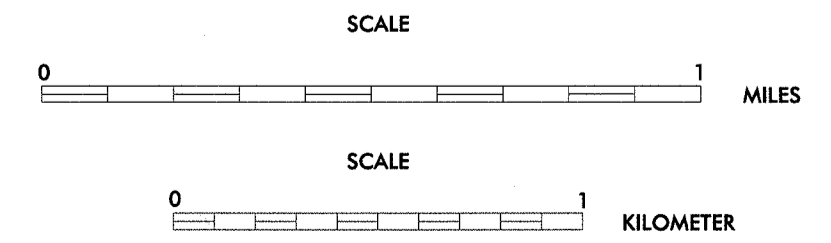

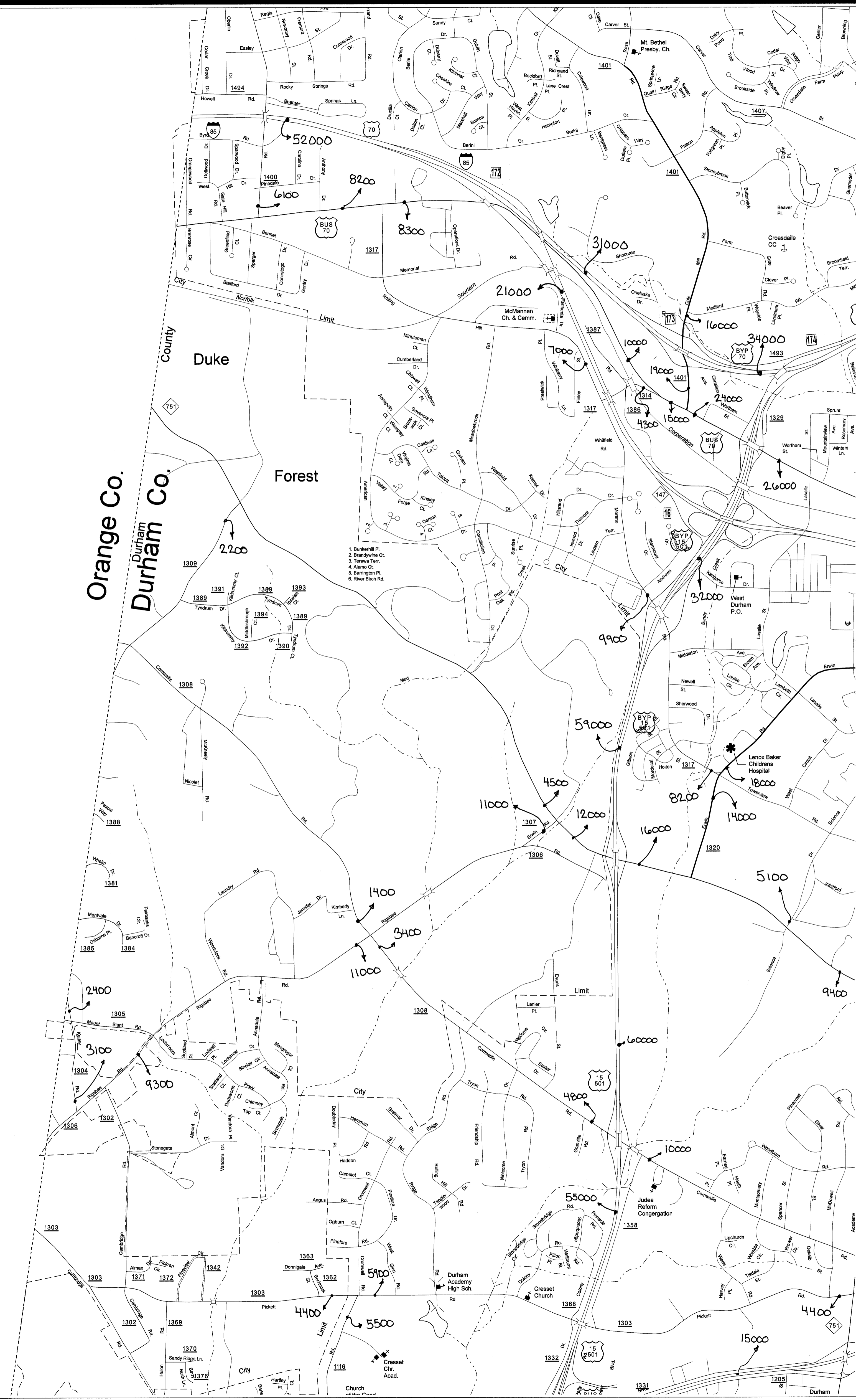
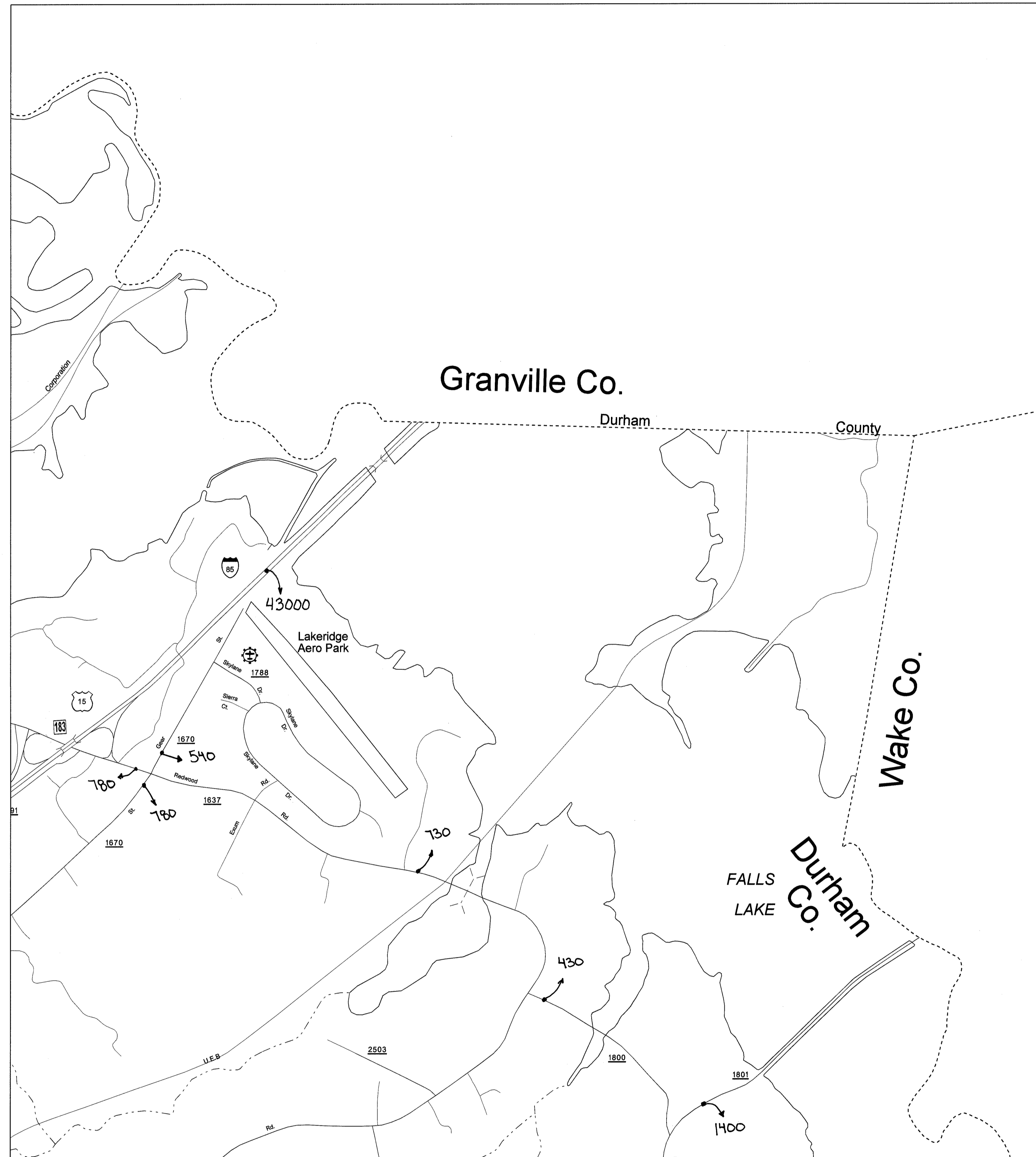

**LEGEND**

ROAD 4 LANE UNDIVIDED HIGHWAY	TELEPHONE/PPG RES. PARK BDL.	CABLE
DIVIDED HIGHWAY	RES. PARK BDL.	RESERVATION OR PARK BOUNDARY
FCA		INSET AREA
FULL CONTROL ACCESS		FREE OR TOLL FERRY
DETAILED HIGHWAY INTERCHANGE		CANAL
ROAD THROUGH MOUNTAIN PASS		NARROW STREAM
HIGHWAY BRIDGE		WIDE STREAM
UNDERPASS		DAM WITH LOCK
OVERPASS		DAM
DRAW SPAN ON BRIDGE		RESERVOIR, POND, OR LAKE
HIGHWAY TUNNEL		COUNTY SEAT
FORD		COMMUNITY AND TOWN CENTER
INTERSTATE HIGHWAY		TOWN HALL
U.S. NUMBERED HIGHWAY		SCHOOL
N.C. NUMBERED HIGHWAY		COLLEGE OR UNIVERSITY
U.S. NUMBERED BICYCLE ROUTE		HOSPITAL
N.C. NUMBERED BICYCLE ROUTE		CHURCH
INTERSTATE INTERCHANGE NUMBER		CHURCH WITH CEMETERY
SECONDARY ROAD NUMBER		CEMETERY
RAILROAD ANY NUMBER OF TRACKS USED BY MORE THAN ONE OPERATING COMPANY OR SAME OR ADJACENT RIGHTS-OF-WAY		FAIRGROUND OR RACETRACK
RAILROAD ANY NUMBER OF TRACKS USED BY MORE THAN ONE OPERATING COMPANY ON SAME OR ADJACENT RIGHTS-OF-WAY		POST OFFICE
RAILROAD STATION		POWER PLANT
GRADE CROSSING		POWER SUBSTATION
UNDERPASS		PATROL STATION
OVERPASS		CORRECTIONAL OR PENAL INSTN.
RAILROAD TUNNEL		HIGHWAY GARAGE OR MAINT. YARD
RAILROAD BRIDGE		HIGHWAY DIV. OR DIST. OFFICE
UNINCORPORATED CENSUS DESIGNATED PLACE		WEIGHT STATION
CITY LIMIT		SWAMP OR MARSH
COUNTY LINE		GRAVEL PIT OR QUARRY
STATE LINE		MONUMENT-SMALL HISTORICAL SITE
INCORPORATED CITY OR VILLAGE, (GENERALIZED)		LIGHTHOUSE
		MOUNTAIN PEAK
		MINE
		REST AREA
		MUNICIPAL PARK
		TRIANGULATION STATION
		COAST GUARD STATION
		ARMORY
		FEDERAL GAME LAND
		MILITARY AIRFIELD
		COMMERCIAL OR MUNICIPAL FIELD
		HANGAR ON FIELD
		LANDING STRIP
		MARKED AUXILIARY FIELD
		WAREHOUSES OR MANUFACTURING PLANTS
		SHOPPING CENTERS

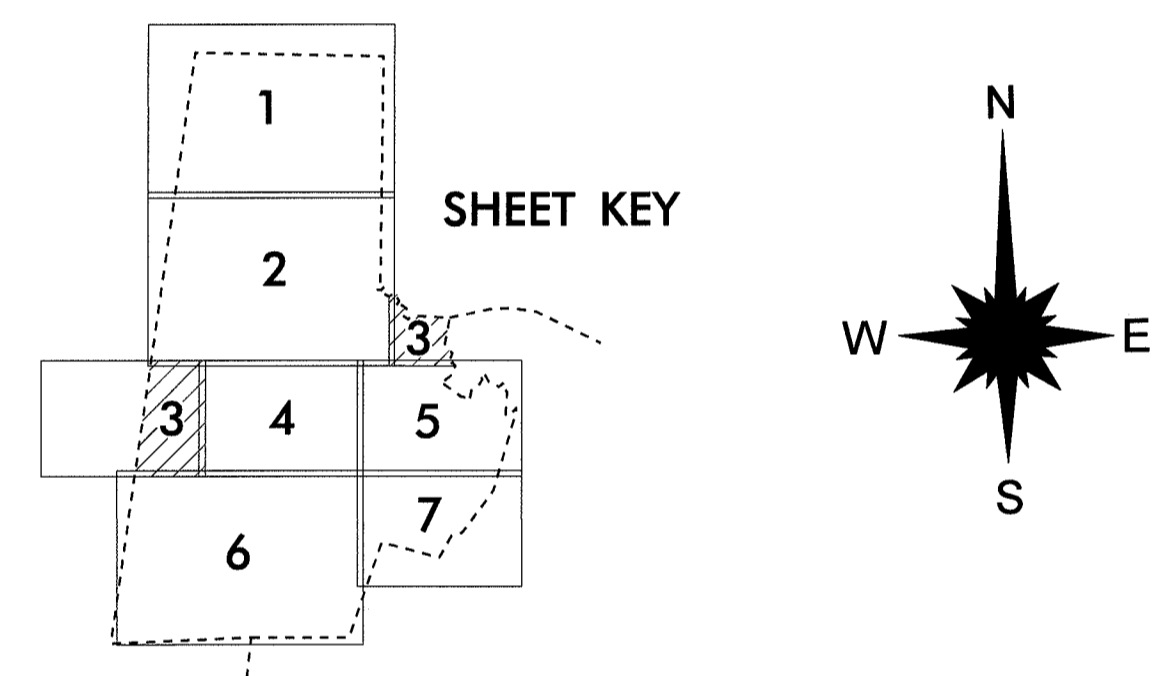

**2013  
ANNUAL AVERAGE  
DAILY TRAFFIC**  
GENERATED BY THE  
**TRAFFIC SURVEY GROUP**  
TRANSPORTATION PLANNING BRANCH  
**DURHAM**  
INCLUDED IN  
DURHAM COUNTY  
**NORTH CAROLINA**

BASE MAPPING PREPARED BY  
**NORTH CAROLINA DEPARTMENT OF TRANSPORTATION**  
STATE ROAD MAINTENANCE UNIT  
MAPPING & INFORMATION SECTION

IN COOPERATION WITH THE  
**U.S. DEPARTMENT OF TRANSPORTATION**  
FEDERAL HIGHWAY ADMINISTRATION

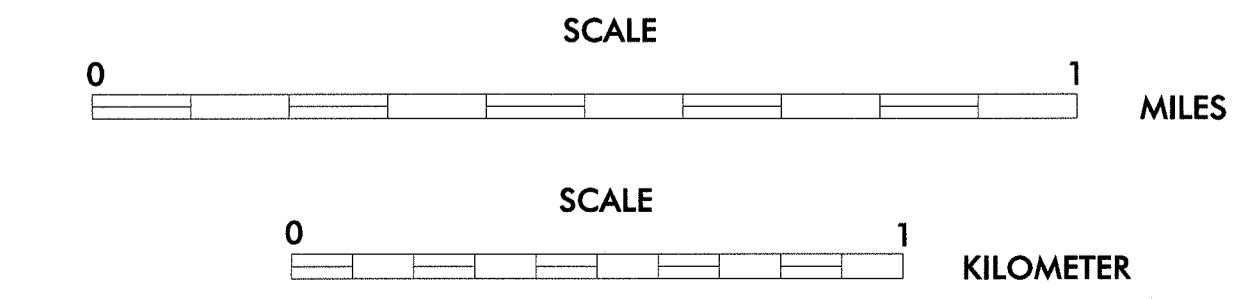



- LEGEND**
- ROAD
  - 4 LANE UNDIVIDED HIGHWAY
  - DIVIDED HIGHWAY
  - FCA
  - FULL CONTROL ACCESS
  - DETAILED HIGHWAY INTERCHANGE
  - ROAD THROUGH MOUNTAIN PASS
  - HIGHWAY BRIDGE
  - UNDERPASS
  - OVERPASS
  - DRAW SPAN ON BRIDGE
  - HIGHWAY TUNNEL
  - FORD
  - INTERSTATE HIGHWAY
  - U.S. NUMBERED HIGHWAY
  - N.C. NUMBERED HIGHWAY
  - N.C. NUMBERED BICYCLE ROUTE
  - INTERSTATE INTERCHANGE NUMBER
  - SECONDARY ROAD NUMBER
  - RAILROAD, ANY NUMBER OF TRACKS USED BY MORE THAN ONE OPERATION COMPANY ON SAME OR ADJACENT RIGHTS-OF-WAY
  - RAILROAD STATION
  - GRADE CROSSING
  - UNDERPASS
  - OVERPASS
  - RAILROAD TUNNEL
  - RAILROAD BRIDGE
  - UNINCORPORATED CENSUS DESIGNATED PLACE
  - CITY LIMIT
  - COUNTY LINE
  - STATE LINE
  - INCORPORATED CITY OR VILLAGE, (GENERALIZED)
  - TEL/ELECT/PIPE
  - RES. PIPES
  - CABLE
  - RESERVATION OR PARK BOUNDARY
  - INSET AREA
  - FREE OR TOLL FERRY
  - CANAL
  - NARROW STREAM
  - WIDE STREAM
  - DAM WITH LOCK
  - DAM
  - RESERVOIR, POND, OR LAKE
  - COUNTY SEAT
  - COMMUNITY AND TOWN CENTER
  - TOWN HALL
  - SCHOOL
  - COLLEGE OR UNIVERSITY
  - HOSPITAL
  - CHURCH
  - CHURCH WITH CEMETERY
  - CEMETERY
  - FARMLAND OR RACETRACK
  - POST OFFICE
  - POWER PLANT
  - PATROL STATION
  - CORRECTIONAL OR PENAL INSTN.
  - HIGHWAY GARAGE OR MAINT. YARD
  - HIGHWAY DIV. OR DIST. OFFICE
  - WEIGHT STATION
  - SWAMP OR MARSH
  - GRAVEL PIT OR QUARRY
  - MONUMENT-SMALL HISTORICAL SITE
  - LIGHTHOUSE
  - MOUNTAIN PEAK
  - MINE
  - REST AREA
  - MUNICIPAL PARK
  - TRIANGULATION STATION
  - COAST GUARD STATION
  - ARMORY
  - FEDERAL GAME LAND
  - MILITARY AIRFIELD
  - HANGAR OR MUNICIPAL FIELD
  - LANDING STRIP
  - STATE LINE
  - INCORPORATED CITY OR VILLAGE, (GENERALIZED)
  - WAREHOUSES OR MANUFACTURING PLANTS
  - SHOPPING CENTERS

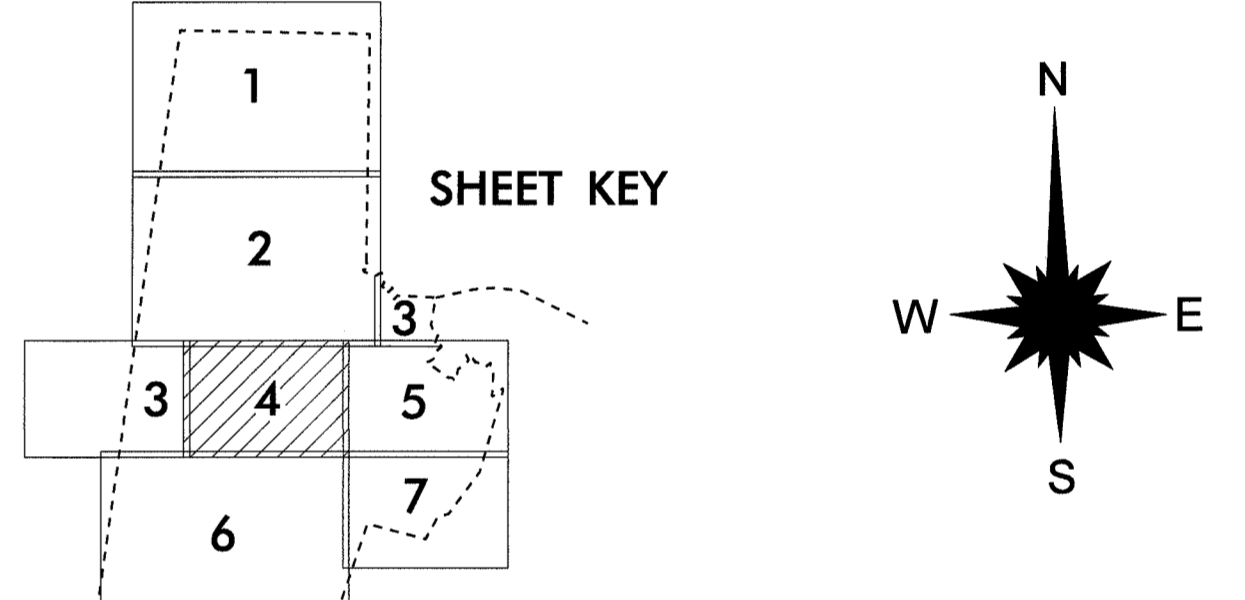

**2013 ANNUAL AVERAGE DAILY TRAFFIC**  
 GENERATED BY THE  
**TRAFFIC SURVEY GROUP**  
 TRANSPORTATION PLANNING BRANCH

# DURHAM

INCLUDED IN  
 DURHAM COUNTY  
**NORTH CAROLINA**

BASE MAPPING PREPARED BY  
**NORTH CAROLINA DEPARTMENT OF TRANSPORTATION**  
 STATE ROAD MAINTENANCE UNIT  
 MAPPING & INFORMATION SECTION

IN COOPERATION WITH THE  
**U.S. DEPARTMENT OF TRANSPORTATION**  
 FEDERAL HIGHWAY ADMINISTRATION

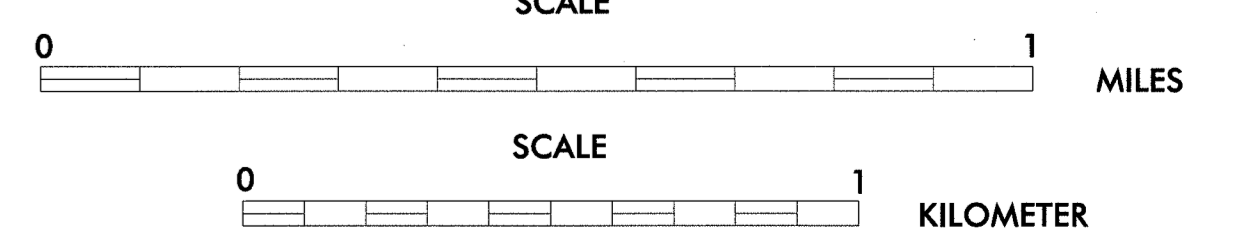

1"=1000'=304.8m

BASE MAP  
 REVISED  
 AUG 2009



**LEGEND**

ROAD	TEL/ELECT/PIPE	CABLE
4 LANE UNDIVIDED HIGHWAY	RES. PARK. BDL.	RESERVATION OR PARK BOUNDARY
DIVIDED HIGHWAY		INSET AREA
F.C.A.		FREE OR TOLL FERRY
Detailed Highway Interchange		CANAL
ROAD THROUGH MOUNTAIN PASS		NARROW STREAM
HIGHWAY BRIDGE		WIDE STREAM
UNDERPASS		DAM WITH LOCK
OVERPASS		DAM
DRAW SPAN ON BRIDGE		RESERVOIR, POND, OR LAKE
HIGHWAY TUNNEL		COUNTY SEAT
FORD		COMMUNITY AND TOWN CENTER
INTERSTATE HIGHWAY		TOWN HALL
U.S. NUMBERED HIGHWAY		SCHOOL
N.C. NUMBERED HIGHWAY		COLLEGE OR UNIVERSITY
U.S. NUMBERED BICYCLE ROUTE		HOSPITAL
N.C. NUMBERED BICYCLE ROUTE		CHURCH WITH CEMETERY
INTERSTATE INTERCHANGE NUMBER		CEMETERY
SECONDARY ROAD NUMBER		FAIRGROUND OR RACETRACK
RAILROAD ANY NUMBER OF TRACKS USED BY SINGLE OPERATING COMPANY		POST OFFICE
RAILROAD ANY NUMBER OF TRACKS USED BY MORE THAN ONE OPERATING COMPANY ON SAME OR ADJACENT RIGHTS-OF-WAY		POWER PLANT
RAILROAD STATION		PATROL STATION
GRADE CROSSING		CORRECTIONAL OR PENAL INSTN.
UNDERPASS		HIGHWAY GARAGE OR MAINT. YARD
OVERPASS		HIGHWAY DIV. OR DIST. OFFICE
RAILROAD TUNNEL		WEIGHT STATION
UNINCORPORATED CENSUS DESIGNATED PLACE		SWAMP OR MARSH
CITY LIMIT		GRAVEL PIT OR QUARRY
COUNTY LINE		MONUMENT-SMALL HISTORICAL SITE
STATE LINE		LIGHTHOUSE
INCORPORATED CITY OR VILLAGE (GENERALIZED)		MOUNTAIN PEAK
		MINE
		REST AREA
		MUNICIPAL PARK
		TRIANGULATION STATION
		COAST GUARD STATION
		AGENCY
		FEDERAL GAME LAND
		MILITARY AIRFIELD
		COMMERCIAL OR MUNICIPAL FIELD
		RANGERS ON FIELD
		LANDING STRIP
		MARKED AUXILIARY FIELD
		WAREHOUSES OR MANUFACTURING PLANTS
		SHOPPING CENTERS

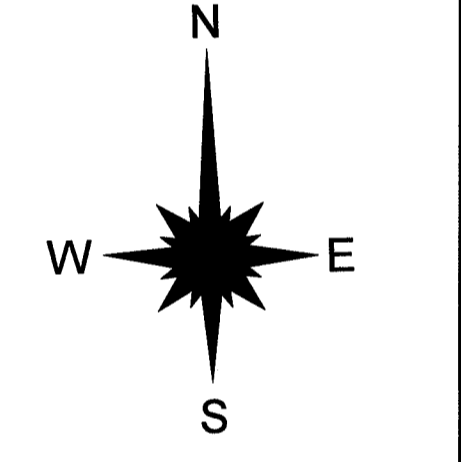
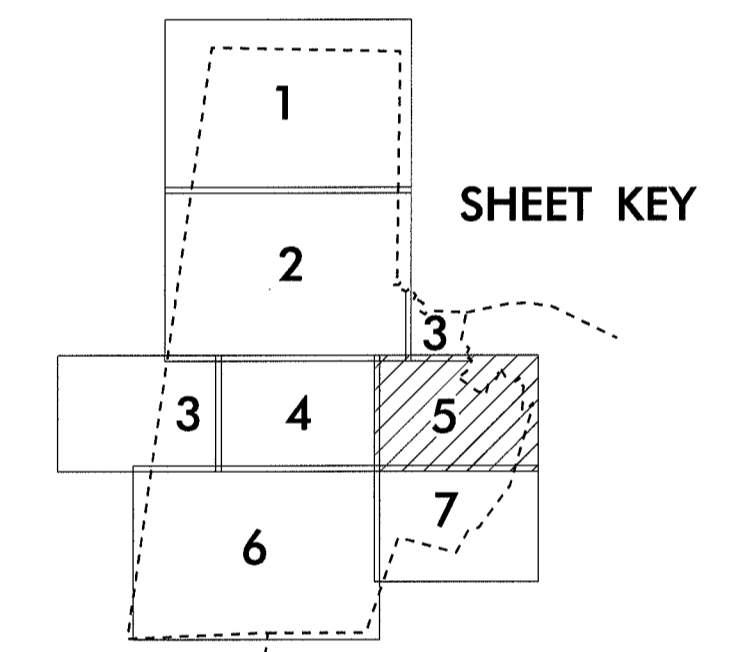

**2013**  
**ANNUAL AVERAGE**  
**DAILY TRAFFIC**  
 GENERATED BY THE  
**TRAFFIC SURVEY GROUP**  
**TRANSPORTATION PLANNING BRANCH**  
**DURHAM**  
 INCLUDED IN  
 DURHAM COUNTY  
**NORTH CAROLINA**

BASE MAPPING PREPARED BY  
**NORTH CAROLINA DEPARTMENT OF TRANSPORTATION**  
**STATE ROAD MAINTENANCE UNIT**  
**MAPPING & INFORMATION SECTION**

IN COOPERATION WITH THE  
**U.S. DEPARTMENT OF TRANSPORTATION**  
**FEDERAL HIGHWAY ADMINISTRATION**

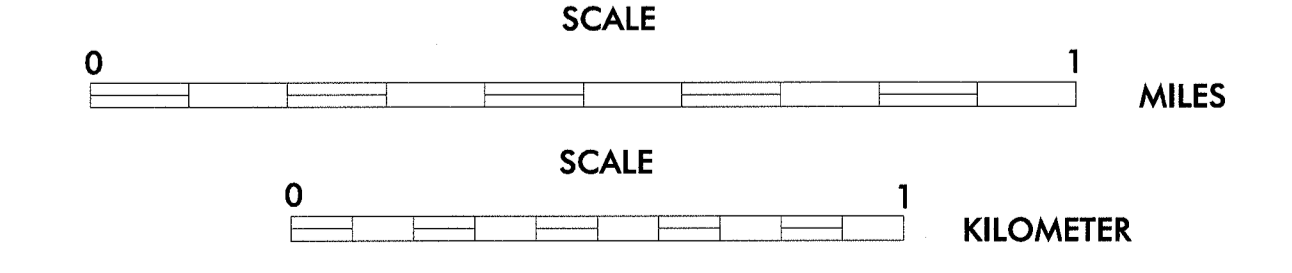

1" = 1000' = 304.8m

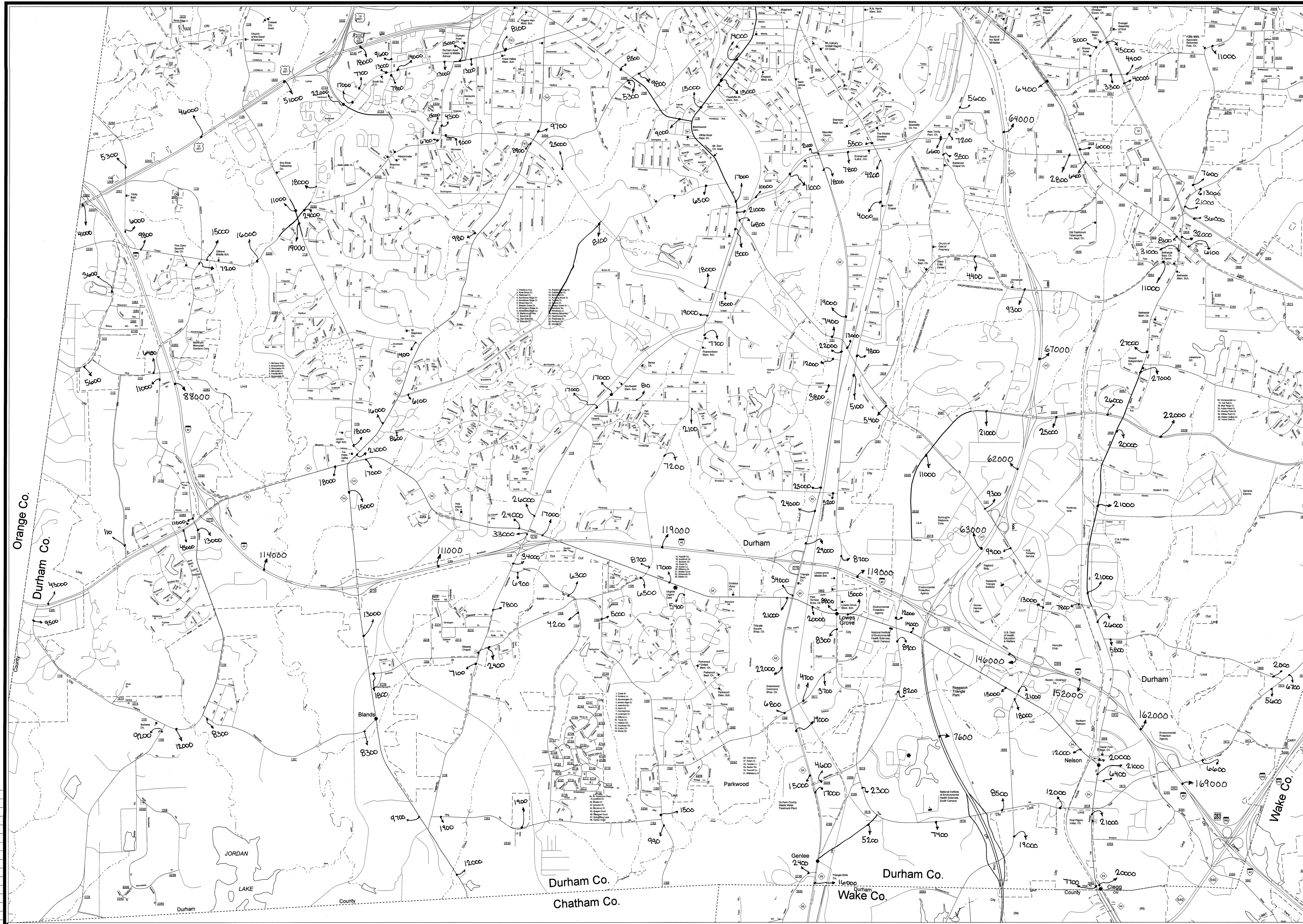

**LEGEND**

ROAD	4 LANE UNDIVIDED HIGHWAY	DIVIDED HIGHWAY	FCA	FULL CONTROL ACCESS	DETAILED HIGHWAY INTERCHANGE	ROAD THROUGH MOUNTAIN PASS	HIGHWAY BRIDGE	UNDERPASS	OVERPASS	DRAW SPAN ON BRIDGE	HIGHWAY TUNNEL	FORD	INTERSTATE HIGHWAY	U.S. NUMBERED HIGHWAY	N.C. NUMBERED HIGHWAY	U.S. NUMBERED BICYCLE ROUTE	N.C. NUMBERED BICYCLE ROUTE	INTERSTATE INTERCHANGE NUMBER	SECONDARY ROAD NUMBER	RAILROAD ANY NUMBER OF TRACKS USED BY SINGLE OPERATING COMPANY	RAILROAD ANY NUMBER OF TRACKS USED BY MORE THAN ONE OPERATING COMPANY ON SAME OR ADJACENT RIGHTS-OF-WAY	RAILROAD STATION	GRADE CROSSING	UNDERPASS	OVERPASS	RAILROAD TUNNEL	RAILROAD BRIDGE	UNINCORPORATED CENSUS DESIGNATED PLACE	CITY LIMIT	COUNTY LINE	STATE LINE	INCORPORATED CITY OR VILLAGE, (GENERALIZED)	CABLE	RESERVATION OR PARK BOUNDARY	INSET AREA	FREE OR TOLL FERRY	CANAL	NARROW STREAM	WIDE STREAM	DAM WITH LOCK	DAM	RESERVOIR, POND, OR LAKE	COUNTY SEAT	COMMUNITY AND TOWN CENTER	TOWN HALL	SCHOOL	COLLEGE OR UNIVERSITY	HOSPITAL	CHURCH	CHURCH WITH CEMETERY	FAIRGROUND OR RACETRACK	POST OFFICE	POWER PLANT	POWER SUBSTATION	PATROL STATION	CORRECTIONAL OR PENAL INSTN.	HIGHWAY GARAGE OR MAINT. YARD	HIGHWAY DIV. OR DIST. OFFICE	WEIGHT STATION	SWAMP OR MARSH	GRAVEL PIT OR QUARRY	MONUMENT-SMALL HISTORICAL SITE	LIGHTHOUSE	MOUNTAIN PEAK	MINE	REST AREA	MUNICIPAL PARK	TRIANGULATION STATION	COAST GUARD STATION	ARMORY	FEDERAL GAME LAND	MILITARY AIRFIELD	COMMERCIAL OR MUNICIPAL FIELD	HANGAR ON FIELD	LANDING STRIP	MARKED AUXILIARY FIELD	WAREHOUSES OR MANUFACTURING PLANTS	SHOPPING CENTERS
------	--------------------------	-----------------	-----	---------------------	------------------------------	----------------------------	----------------	-----------	----------	---------------------	----------------	------	--------------------	-----------------------	-----------------------	-----------------------------	-----------------------------	-------------------------------	-----------------------	--	---	------------------	----------------	-----------	----------	-----------------	-----------------	--	------------	-------------	------------	---	-------	------------------------------	------------	--------------------	-------	---------------	-------------	---------------	-----	--------------------------	-------------	---------------------------	-----------	--------	-----------------------	----------	--------	----------------------	-------------------------	-------------	-------------	------------------	----------------	------------------------------	-------------------------------	------------------------------	----------------	----------------	----------------------	--------------------------------	------------	---------------	------	-----------	----------------	-----------------------	---------------------	--------	-------------------	-------------------	-------------------------------	-----------------	---------------	------------------------	------------------------------------	------------------

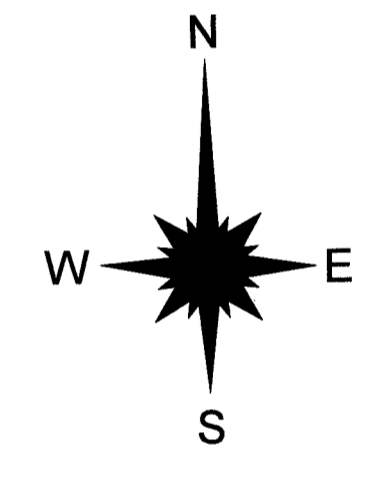
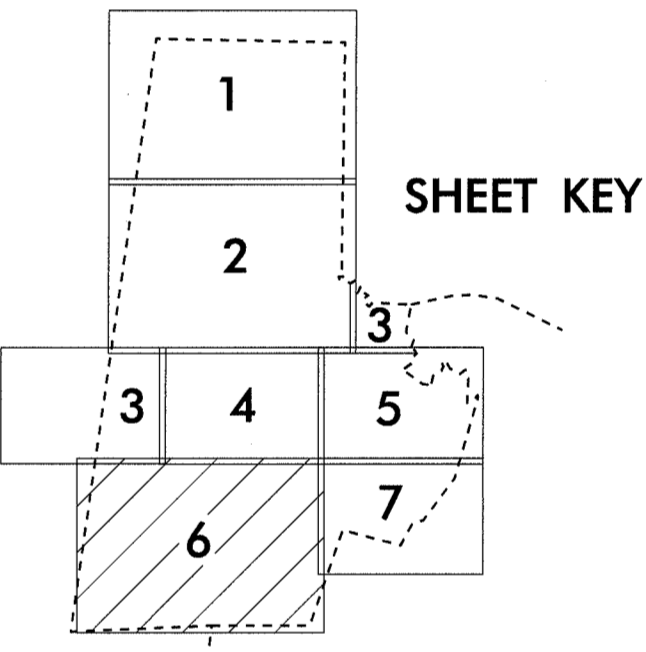

**2013 ANNUAL AVERAGE DAILY TRAFFIC**  
 GENERATED BY THE  
**TRAFFIC SURVEY GROUP**  
 TRANSPORTATION PLANNING BRANCH

**DURHAM**  
 INCLUDED IN  
 DURHAM COUNTY  
**NORTH CAROLINA**

BASE MAPPING PREPARED BY  
 NORTH CAROLINA DEPARTMENT OF TRANSPORTATION  
 STATE ROAD MAINTENANCE UNIT  
 MAPPING & INFORMATION SECTION

IN COOPERATION WITH THE  
 U.S. DEPARTMENT OF TRANSPORTATION  
 FEDERAL HIGHWAY ADMINISTRATION

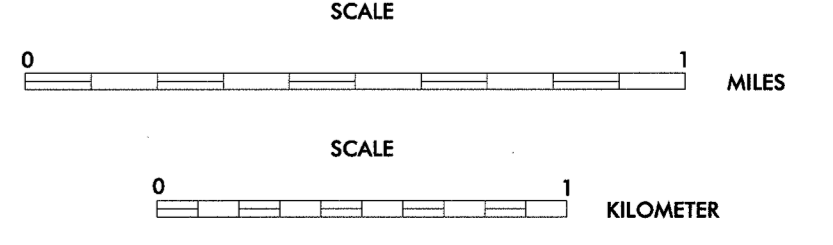

SHEET 6 OF 7

BASE MAP  
 REVISED  
 AUG 2009

SHEET 6 OF 7

1" = 1500' = 457.2m



LEGEND

ROAD 4 LANE UNDIVIDED HIGHWAY DIVIDED HIGHWAY	TELETYPE/PIPE RES. (PARK BRD.)	CABLE RESERVATION OR PARK BOUNDARY
FCA FULL CONTROL ACCESS	INSET AREA	FREE OR TOLL FERRY
DETAILED HIGHWAY INTERCHANGE	CANAL NARROW STREAM	WIDE STREAM
ROAD THROUGH MOUNTAIN PASS	DAM WITH LOCK	DAM
HIGHWAY BRIDGE	RESERVOIR, POND, OR LAKE	COUNTY SEAT COMMUNITY AND TOWN CENTER
UNDERPASS	SCHOOL COLLEGE OR UNIVERSITY	TOWN HALL
OVERPASS	HOSPITAL CHURCH	CHURCH WITH CEMETERY
DRAW SPAN ON BRIDGE	CEMETERY FAIRGROUND OR RACETRACK	POST OFFICE
HIGHWAY TUNNEL	POWER PLANT POWER SUBSTATION	PATROL STATION
FORD	CORRECTIONAL OR PENAL INSTN. HIGHWAY GARAGE OR MAINT. YARD	HIGHWAY DIV. OR DIST. OFFICE
INTERSTATE HIGHWAY	WEIGHT STATION SWAMP OR MARSH	GRAVEL PIT OR QUARRY
U.S. NUMBERED HIGHWAY	MONUMENT-SMALL HISTORICAL SITE	LIGHTHOUSE
N.C. NUMBERED HIGHWAY	MOUNTAIN PEAK	MINE
U.S. NUMBERED BICYCLE ROUTE	REST AREA MUNICIPAL PARK	MUNICIPAL PARK
N.C. NUMBERED BICYCLE ROUTE	TRANQUILIZATION STATION	COAST GUARD STATION
INTERSTATE INTERCHANGE NUMBER	ARMORY	FEDERAL GAME LAND
SECONDARY ROAD NUMBER	ARMORY	MILITARY AIRFIELD
RAILROAD, ANY NUMBER OF TRACKS USED BY SINGLE OPERATING COMPANY	ARMORY	DESIGNATED PLACE
RAILROAD, ANY NUMBER OF TRACKS USED BY MORE THAN ONE OPERATION COMPANY ON SAME OR ADJACENT RIGHTS-OF-WAY	ARMORY	CITY LIMIT
RAILROAD STATION	ARMORY	COUNTY LINE
GRADE CROSSING	ARMORY	STATE LINE
UNDERPASS	ARMORY	INCORPORATED CITY OR VILLAGE, (GENERALIZED)
OVERPASS	ARMORY	WAREHOUSES OR MANUFACTURING PLANTS
RAILROAD BRIDGE	ARMORY	SHOPPING CENTERS
UNINCORPORATED CENSUS DESIGNATED PLACE	ARMORY	
STATE LINE	ARMORY	
COUNTY LINE	ARMORY	
INCORPORATED CITY OR VILLAGE, (GENERALIZED)	ARMORY	

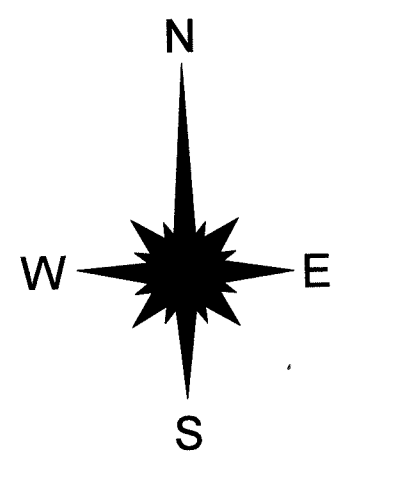
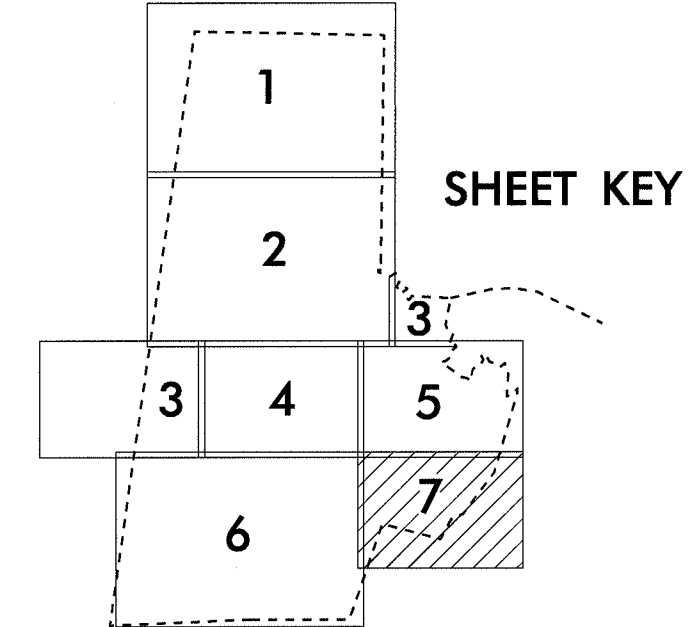

2013  
**ANNUAL AVERAGE  
 DAILY TRAFFIC**  
 GENERATED BY THE  
**TRAFFIC SURVEY GROUP**  
 TRANSPORTATION PLANNING BRANCH  
**DURHAM**  
 INCLUDED IN  
 DURHAM COUNTY  
**NORTH CAROLINA**

BASE MAPPING PREPARED BY  
**NORTH CAROLINA DEPARTMENT OF TRANSPORTATION**  
 STATE ROAD MAINTENANCE UNIT  
 MAPPING & INFORMATION SECTION

IN COOPERATION WITH THE  
**U.S. DEPARTMENT OF TRANSPORTATION**  
 FEDERAL HIGHWAY ADMINISTRATION  
 SCALE

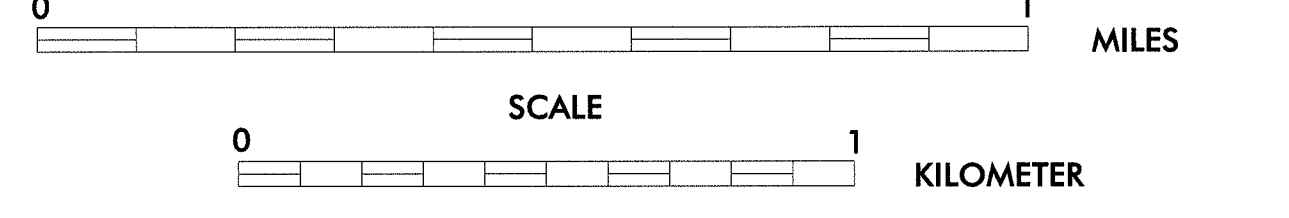

SHEET 7 OF 7

1" = 1000' = 304.8m

SHEET 7 OF 7

BASE MAP  
 REVISED  
 AUG 2009