

**LEGEND**

ROAD	TELEPHONE	CABLE
4 LANE UNDIVIDED HIGHWAY	RES. PARK. STR.	RESERVATION OR PARK BOUNDARY
DIVIDED HIGHWAY		INSET AREA
FCA		FREE OR TOLL FERRY
FULL CONTROL ACCESS		CANAL
DETAILED HIGHWAY INTERCHANGE		NARROW STREAM
ROAD THROUGH MOUNTAIN PASS		WIDE STREAM
HIGHWAY BRIDGE		DAM WITH LOCK
UNDERPASS		DAM
OVERPASS		RESERVOIR, POND, OR LAKE
DRAW SPAN ON BRIDGE		COUNTY SEAT
HIGHWAY TUNNEL		COMMUNITY AND TOWN CENTER
FORD		TOWN HALL
INTERSTATE HIGHWAY		SCHOOL
U.S. NUMBERED HIGHWAY		COLLEGE OR UNIVERSITY
N.C. NUMBERED HIGHWAY		CHURCH
U.S. NUMBERED BICYCLE ROUTE		CHURCH WITH CEMETERY
N.C. NUMBERED BICYCLE ROUTE		CEMETERY
INTERSTATE INTERCHANGE NUMBER		FAIRGROUND OR RACETRACK
SECONDARY ROAD NUMBER		POST OFFICE
RAILROAD, ANY NUMBER OF TRACKS USED BY SINGLE OPERATING COMPANY		POWER PLANT
RAILROAD, ANY NUMBER OF TRACKS USED BY MORE THAN ONE OPERATING COMPANY ON SAME OR ADJACENT RIGHTS-OF-WAY		PATROL STATION
RAILROAD STATION		CORRECTIONAL OR PENAL INSTN.
GRADE CROSSING		HIGHWAY GARAGE OR MAINT. YARD
UNDERPASS		HIGHWAY DIV. OR DIST. OFFICE
OVERPASS		WEIGHT STATION
RAILROAD TUNNEL		SWAMP OR MARSH
RAILROAD BRIDGE		GRAVEL PIT OR QUARRY
UNINCORPORATED CENSUS DESIGNATED PLACE		MONUMENT-SMALL HISTORICAL SITE
CITY LIMIT		LIGHTHOUSE
COUNTY LINE		MOUNTAIN PEAK
STATE LINE		MINE
INCORPORATED CITY OR VILLAGE, (GENERALIZED)		REST AREA
		MUNICIPAL PARK
		TRIANGULATION STATION
		COAST GUARD STATION
		ARMORY
		FEDERAL GAME LAND
		MILITARY AIRFIELD
		COMMERCIAL OR MUNICIPAL FIELD
		HANGAR ON FIELD
		LANDING STRIP
		MARKED AUXILIARY FIELD
		WAREHOUSES OR MANUFACTURING PLANTS
		SHOPPING CENTERS

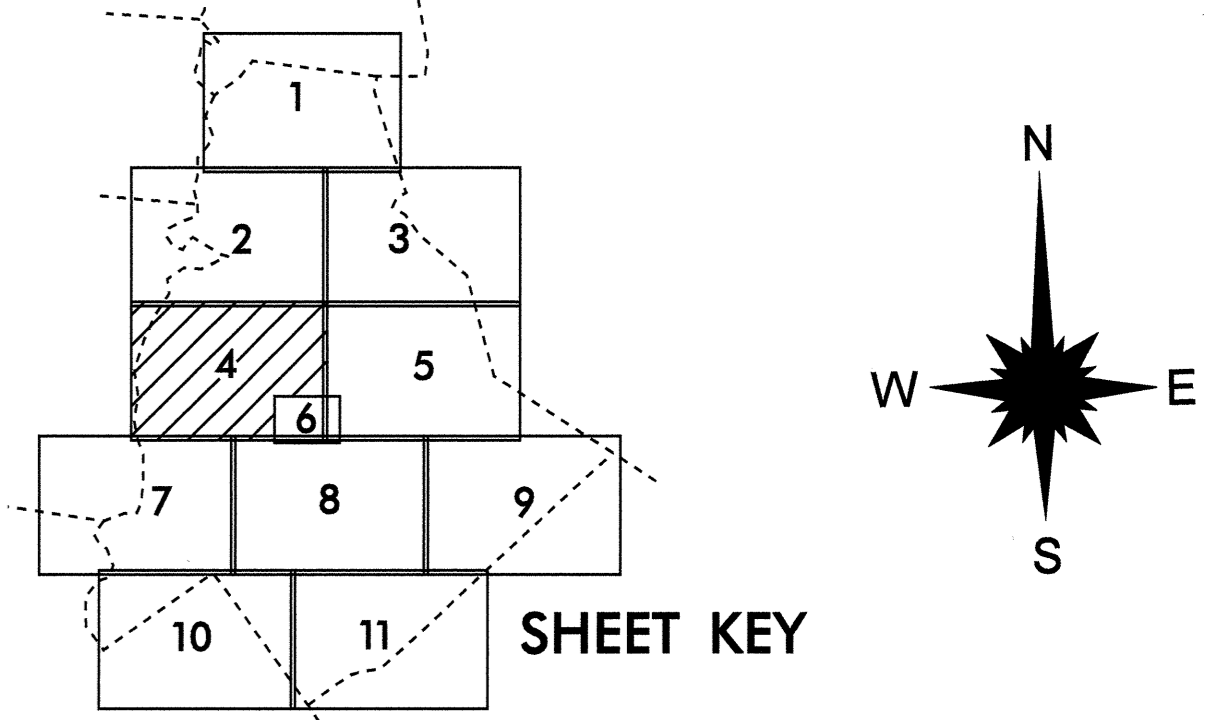

**2008 ANNUAL AVERAGE DAILY TRAFFIC**  
 GENERATED BY THE  
**TRAFFIC SURVEY GROUP**  
 TRANSPORTATION PLANNING BRANCH

**CHARLOTTE**  
 INCLUDED IN  
 MECKLENBURG COUNTY  
**NORTH CAROLINA**

BASE MAPPING PREPARED BY  
 NORTH CAROLINA DEPARTMENT OF TRANSPORTATION  
 STATE ROAD MAINTENANCE UNIT  
 MAPPING & INFORMATION SECTION

IN COOPERATION WITH THE  
 U.S. DEPARTMENT OF TRANSPORTATION  
 FEDERAL HIGHWAY ADMINISTRATION

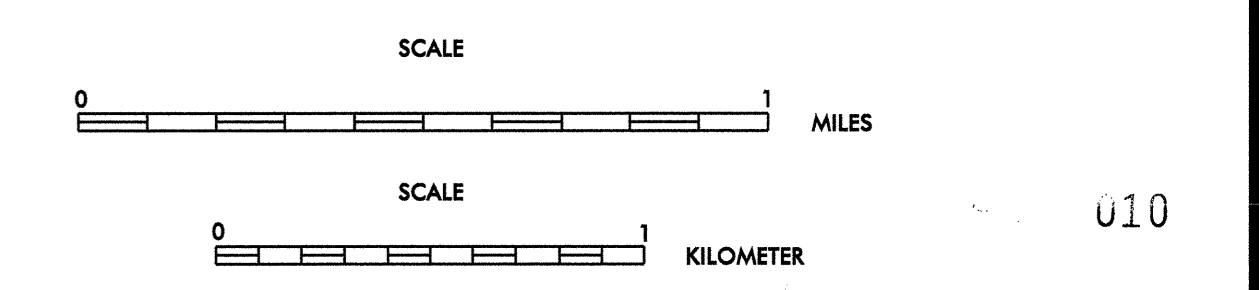

1" = 1500' = 457.2m

SHEET 4 OF 11

BASE MAP  
 REVISED  
 MAY 2009

SEE INSET  
 SHEET 6

SHEET 4 OF 11