

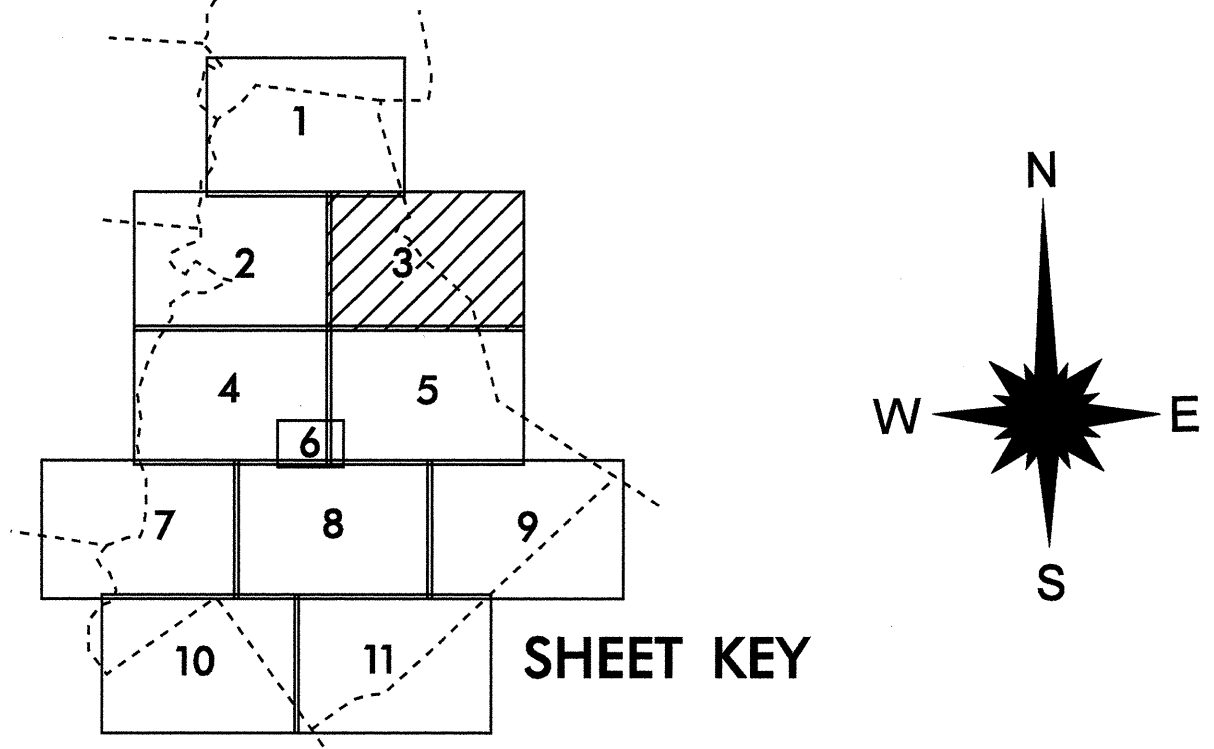

LEGEND

| | | |
|--|-----------------|------------------------------------|
| ROAD | TELEPHONE | CABLE |
| 4 LANE UNDIVIDED HIGHWAY | RES. PARK. STR. | RESERVOIR OR PARK BOUNDARY |
| DIVIDED HIGHWAY | | INSET AREA |
| FULL CONTROL ACCESS | | FREE OR TOLL FERRY |
| DETAILED HIGHWAY INTERCHANGE | | CANAL |
| ROAD THROUGH MOUNTAIN PASS | | NARROW STREAM |
| HIGHWAY BRIDGE | | WIDE STREAM |
| UNDERPASS | | DAM WITH LOCK |
| OVERPASS | | DAM |
| DRAW SPAN ON BRIDGE | | RESERVOIR, POND, OR LAKE |
| HIGHWAY TUNNEL | | COUNTY SEAT |
| FORD | | COMMUNITY AND TOWN CENTER |
| INTERSTATE HIGHWAY | | TOWN HALL |
| U.S. NUMBERED HIGHWAY | | SCHOOL |
| N.C. NUMBERED HIGHWAY | | COLLEGE OR UNIVERSITY |
| U.S. NUMBERED BICYCLE ROUTE | | HOSPITAL |
| N.C. NUMBERED BICYCLE ROUTE | | CHURCH |
| INTERSTATE INTERCHANGE NUMBER | | CHURCH WITH CEMETERY |
| SECONDARY ROAD NUMBER | | CEMETERY |
| RAILROAD, ANY NUMBER OF TRACKS USED BY SINGLE OPERATING COMPANY | | FAIRGROUND OR RACETRACK |
| RAILROAD, ANY NUMBER OF TRACKS USED BY MORE THAN ONE OPERATING COMPANY ON SAME OR ADJACENT RIGHTS-OF-WAY | | POST OFFICE |
| RAILROAD STATION | | POWER PLANT |
| GRADE CROSSING | | PATROL STATION |
| UNDERPASS | | CORRECTIONAL OR PENAL INSTN. |
| OVERPASS | | HIGHWAY GARAGE OR MAINT. YARD |
| RAILROAD TUNNEL | | HIGHWAY DIV. OR DIST. OFFICE |
| RAILROAD BRIDGE | | WEIGHT STATION |
| UNINCORPORATED CENSUS DESIGNATED PLACE | | SWAMP OR MARSH |
| CITY LIMIT | | GRAVEL PIT OR QUARRY |
| COUNTY LINE | | MONUMENT-SMALL HISTORICAL SITE |
| STATE LINE | | LIGHTHOUSE |
| INCORPORATED CITY OR VILLAGE, (GENERALIZED) | | MOUNTAIN PEAK |
| | | MINE |
| | | REST AREA |
| | | MUNICIPAL PARK |
| | | TRIANGULATION STATION |
| | | COAST GUARD STATION |
| | | FEDERAL GAME LAND |
| | | MILITARY AIRFIELD |
| | | COMMERCIAL OR MUNICIPAL FIELD |
| | | HANGAR ON FIELD |
| | | LANDING STRIP |
| | | MARKED AUXILIARY FIELD |
| | | WAREHOUSES OR MANUFACTURING PLANTS |
| | | SHOPPING CENTERS |



2008 ANNUAL AVERAGE DAILY TRAFFIC
 GENERATED BY THE
TRAFFIC SURVEY GROUP
 TRANSPORTATION PLANNING BRANCH

CHARLOTTE
 INCLUDED IN
 MECKLENBURG COUNTY
NORTH CAROLINA

BASE MAPPING PREPARED BY
 NORTH CAROLINA DEPARTMENT OF TRANSPORTATION
 STATE ROAD MAINTENANCE UNIT
 MAPPING & INFORMATION SECTION

IN COOPERATION WITH THE
 U.S. DEPARTMENT OF TRANSPORTATION
 FEDERAL HIGHWAY ADMINISTRATION

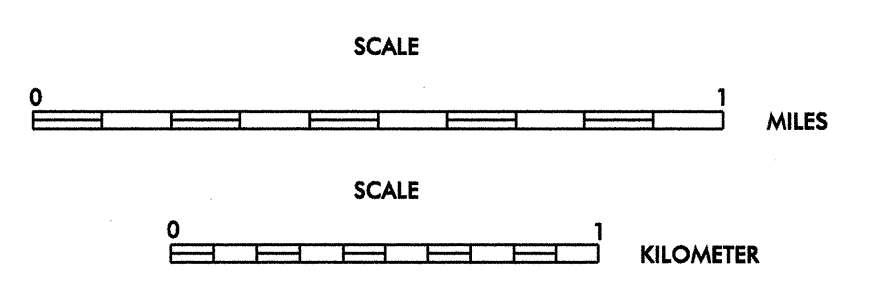

009

1" = 1500' = 457.2m

BASE MAP
 REVISED
 MAY 2009