

The MS&A's goal is to provide the most accurate and current information possible. Map data is compiled from a variety of sources, including aerial photography, ground surveys, and other data. The accuracy, currency and completeness of the data provided will vary. Map includes state-maintained roads and important non-system roads. MS&A's mapping section was last updated on September, 2015. For additional information, visit <http://www.ncdot.gov/transportation/mapping> and disk on Data Providers or contact us at (819) 835-8480.

COPIES OF THIS MAP ARE AVAILABLE
FOR PURCHASE AT NOMINAL COST.
ADDRESS:
N.C. DEPARTMENT OF TRANSPORTATION
MS&A - MAPPING SECTION
1000 BERRY LANE
RALEIGH, NC 27606

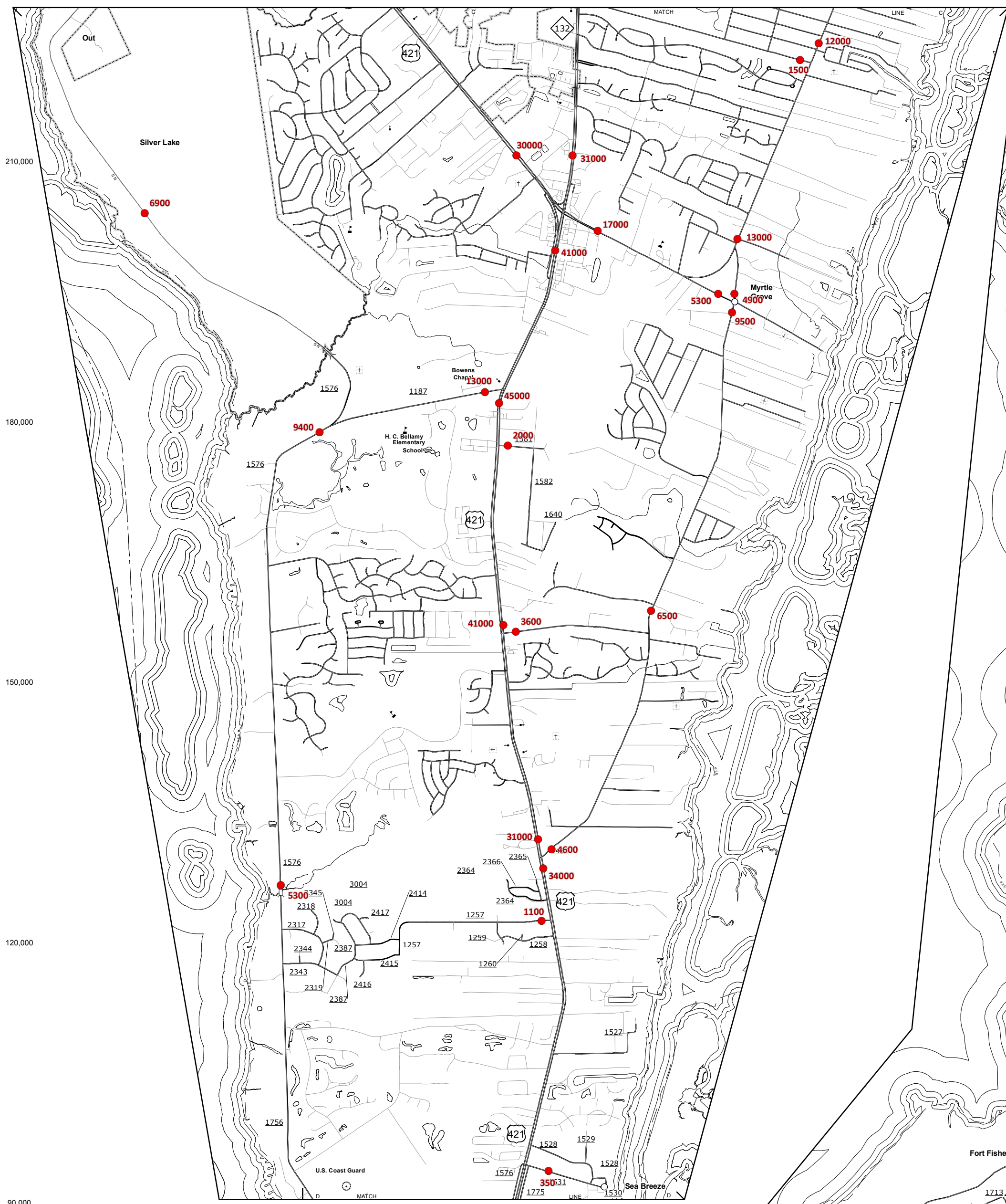

Silver Lake and Vicinity

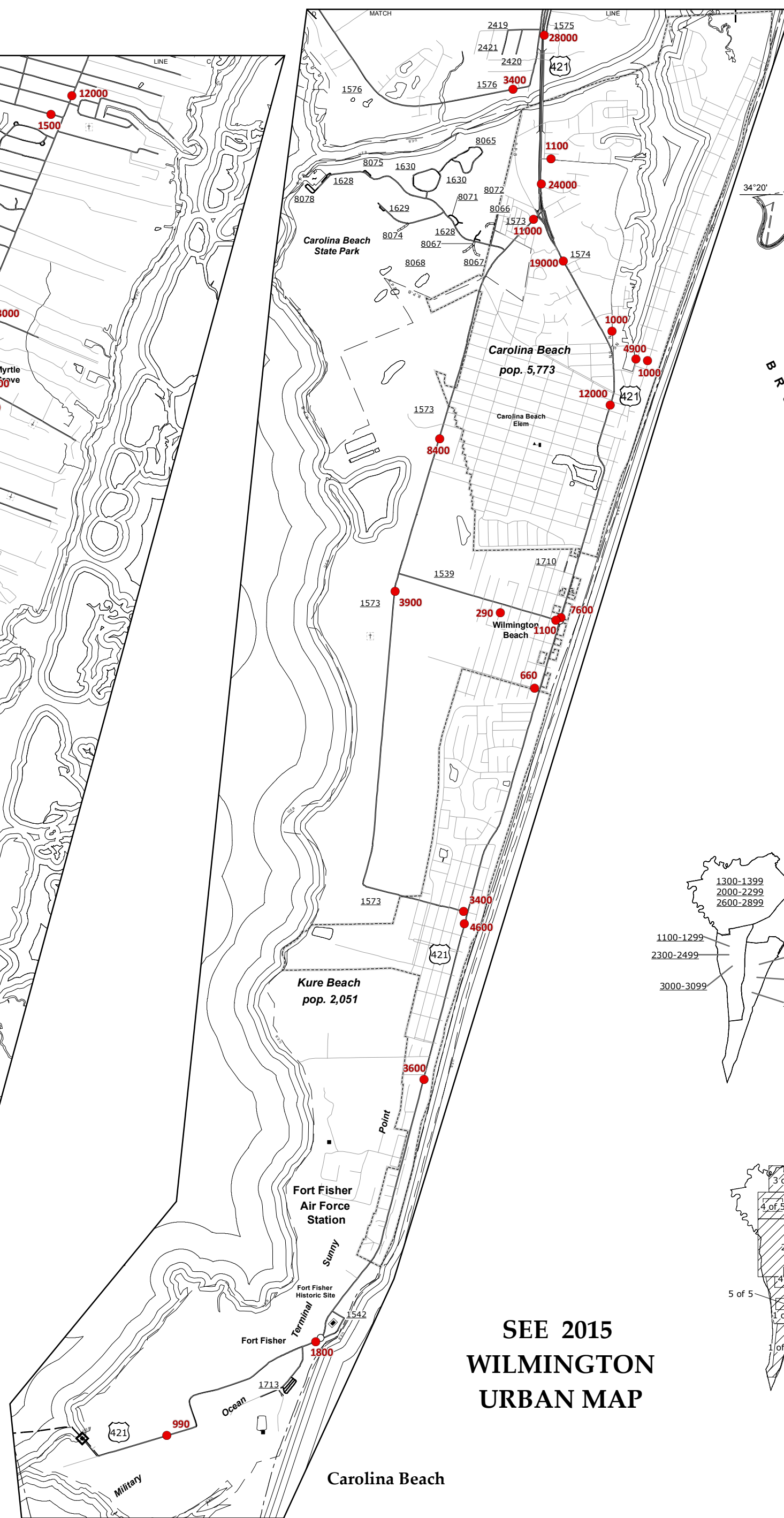

SEE 2015
WILMINGTON
URBAN MAP



- LEGEND**
- UNPAVED SURFACED ROAD
 - HARD SURFACED ROAD
 - 4 LANE UNDIVIDED HIGHWAY
 - DIVIDED HIGHWAY INSET
 - FULL CONTROL ACCESS
 - NON-SYSTEM ROADS
 - PROJECTED LOCATION
 - NATIONAL PARK ROAD
 - BLUE RIDGE PARKWAY
 - INTERSECTION DISTANCE
 - TRAFFIC CIRCLE
 - DETAILED HIGHWAY INTERCHANGE
 - ROAD THROUGH MOUNTAIN PASS
 - HIGHWAY BRIDGE
 - UNDERPASS
 - OVERPASS
 - DRAW SPAN ON BRIDGE
 - HIGHWAY TUNNEL
 - FORD
 - INTERSTATE HIGHWAY
 - U.S. NUMBERED HIGHWAY
 - N.C. NUMBERED HIGHWAY
 - N.C. NUMBERED BICYCLE ROUTE
 - N.C. NUMBERED BICYCLE ROUTE
 - INTERSTATE INTERCHANGE NUMBER
 - SECONDARY ROAD NUMBER
 - UTILITY LINES
 - RAILROAD
 - RAILROAD STATION
 - GRADE CROSSING
 - INSET AREA
 - URBAN EXTENSION LINE
 - NATIONAL FOREST BOUNDARY
 - RESERVATION OR PARK BOUNDARY
 - STATE FOREST BOUNDARY
 - STATE GAMELAND BOUNDARY
 - FEDERAL GAMELAND BOUNDARY
 - MILITARY RESERVATION BOUNDARY
 - STATE LINE
 - COUNTY LINE
 - CITY LIMIT
 - FERRY ROUTE
 - CANAL
 - NARROW CREEK OR STREAM
 - WIDE RIVER OR CREEK
 - RESERVOIR, POND OR LAKE W/ ISLAND
 - DAM OR DAM WITH LOCK
 - WATERFALL
 - SWAMP
 - COMMUNITY, TOWN OR CITY CENTER
 - COUNTY SEAT
 - STATE CAPITAL
 - SCHOOL
 - COLLEGE OR UNIVERSITY
 - HOSPITAL
 - COAST GUARD STATION
 - CHURCH
 - CHURCH WITH CEMETERY
 - CEMETERY
 - PARK STATION
 - CORRECTION OR PENAL INSTITUTION
 - QUARRY
 - MINE OR PIT
 - HIGHWAY GARAGE OR MAINT. YARD
 - HIGHWAY DIV. OR DIST. OFFICE
 - POST OFFICE
 - MILITARY POST
 - WILDLIFE REFUGE
 - WEIGH STATION
 - FAIRGROUNDS
 - HISTORICAL SITE
 - POINTS OF INTEREST
 - STATE FOREST
 - LIGHTHOUSE
 - MOUNTAIN GAP
 - MOUNTAIN SUMMIT
 - OVERLOOK
 - GEODETIC MARKER
 - REST AREA
 - VISITOR CENTER/REST AREA
 - WELCOME CENTER/REST AREA
 - MAJOR AIRPORT
 - AIRPORT
 - MILITARY AIRPORT
 - HELIPORT

2015 AADT
ANNUAL AVERAGE DAILY TRAFFIC
GENERATED BY THE
TRAFFIC SURVEY GROUP
TRANSPORTATION PLANNING BRANCH

NEW HANOVER COUNTY
NORTH CAROLINA

PREPARED BY THE
NORTH CAROLINA DEPARTMENT OF TRANSPORTATION
MANAGEMENTS SYSTEMS AND ASSESSMENT UNIT - MAPPING SECTION
IN COOPERATION WITH THE
U.S. DEPARTMENT OF TRANSPORTATION
FEDERAL HIGHWAY ADMINISTRATION

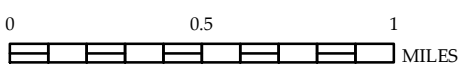
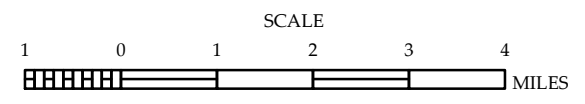

SCALE FOR ENLARGEMENTS

10,000 FOOT GRID BASED ON NORTH CAROLINA PLANE COORDINATE SYSTEM
LAMBERT CONFORMAL CONIC PROJECTION

COPIES OF THIS MAP ARE AVAILABLE
FOR PURCHASE AT NOMINAL COST.
ADDRESS:
N.C. DEPARTMENT OF TRANSPORTATION
MSAU - MAPPING SECTION
800 BERTY LEO
Raleigh, NC 27606

The MSAU's goal is to provide the most accurate and current information possible. Map data is compiled from a variety of sources, including aerial photography, ground surveys, and other data. The accuracy, currency and completeness of the data provided will vary. Map includes state maintenance roads and important non-system roads.
MSAU - Mapping Section
800 BERTY LEO
Raleigh, NC 27606
http://www.ncdot.gov/transportation/and disk on Data Providers or contact us at (919) 835-8460.

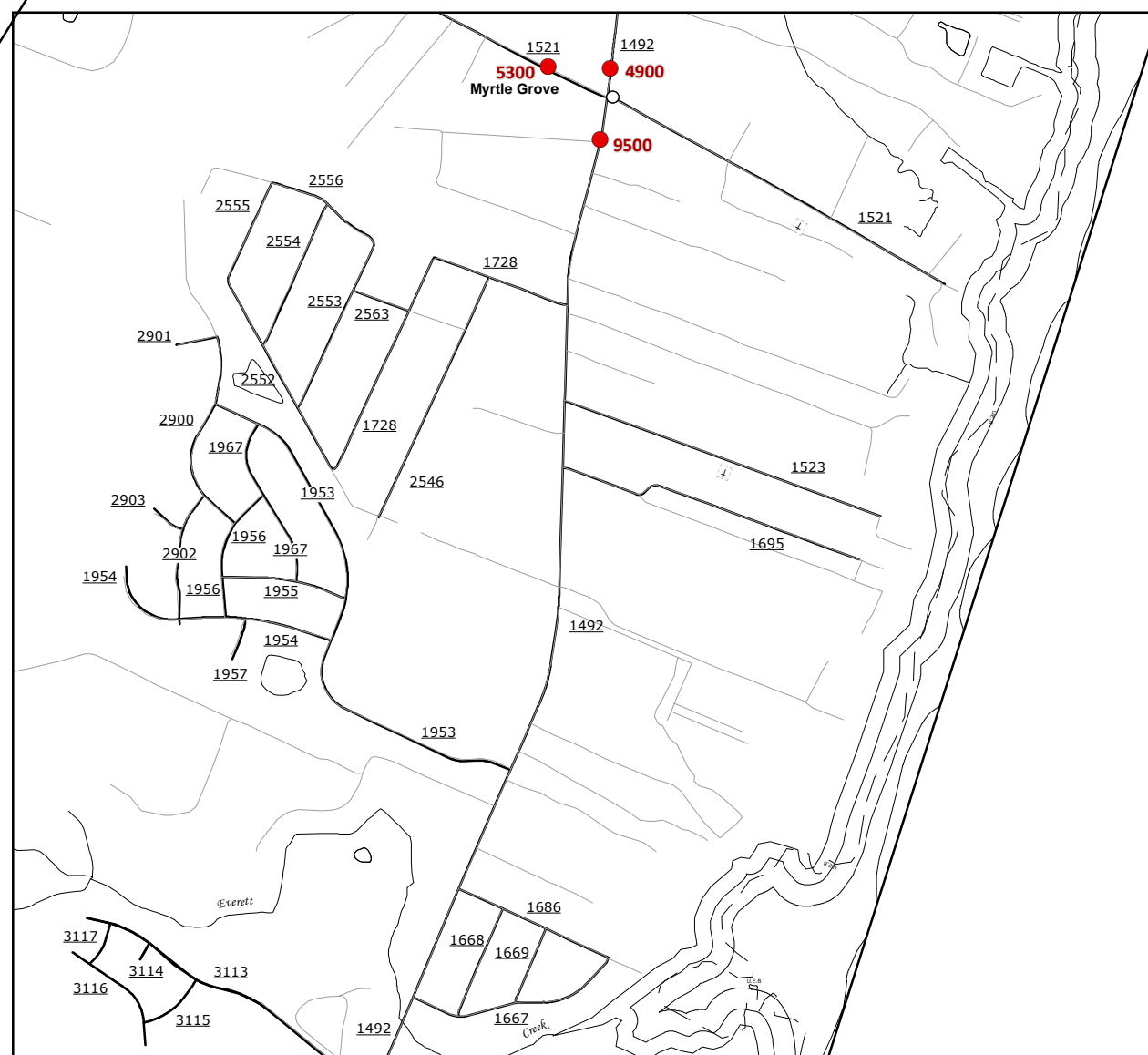
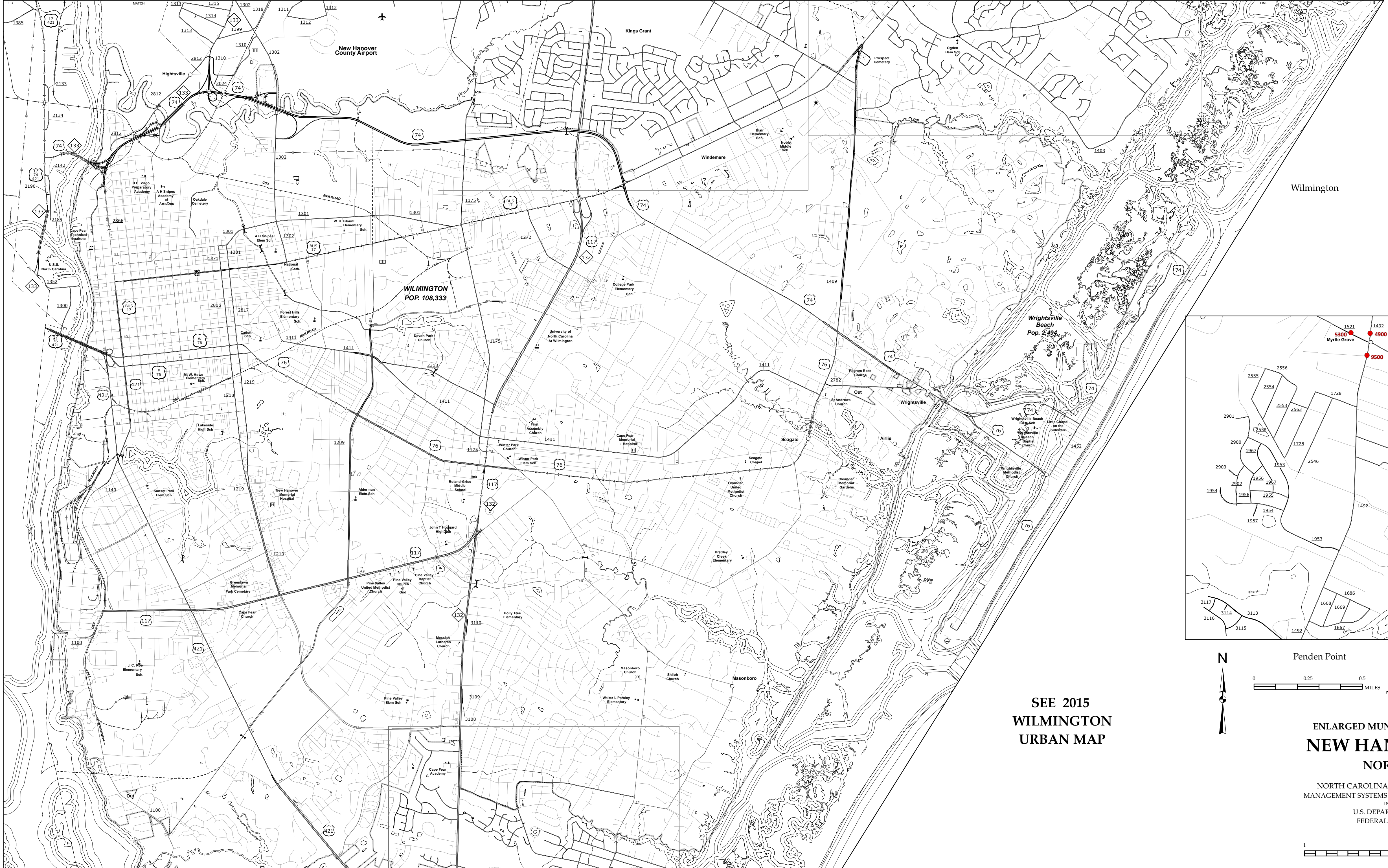

SEE 2015
WILMINGTON
URBAN MAP

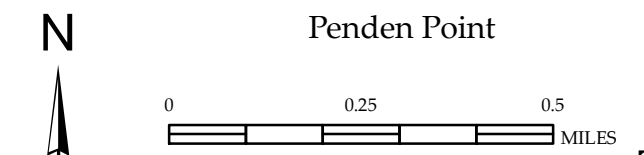

2015 AADT
ANNUAL AVERAGE DAILY TRAFFIC
GENERATED BY THE
TRAFFIC SURVEY GROUP
TRANSPORTATION PLANNING BRANCH
ENLARGED MUNICIPAL AND SUBURBAN AREAS
NEW HANOVER COUNTY
NORTH CAROLINA
PREPARED BY THE
NORTH CAROLINA DEPARTMENT OF TRANSPORTATION
MANAGEMENT SYSTEMS AND ASSESSMENT UNIT - MAPPING SECTION
IN COOPERATION WITH THE
U.S. DEPARTMENT OF TRANSPORTATION
FEDERAL HIGHWAY ADMINISTRATION

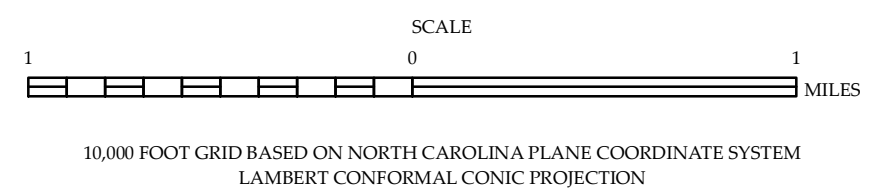



Kings Grant and Vicinity

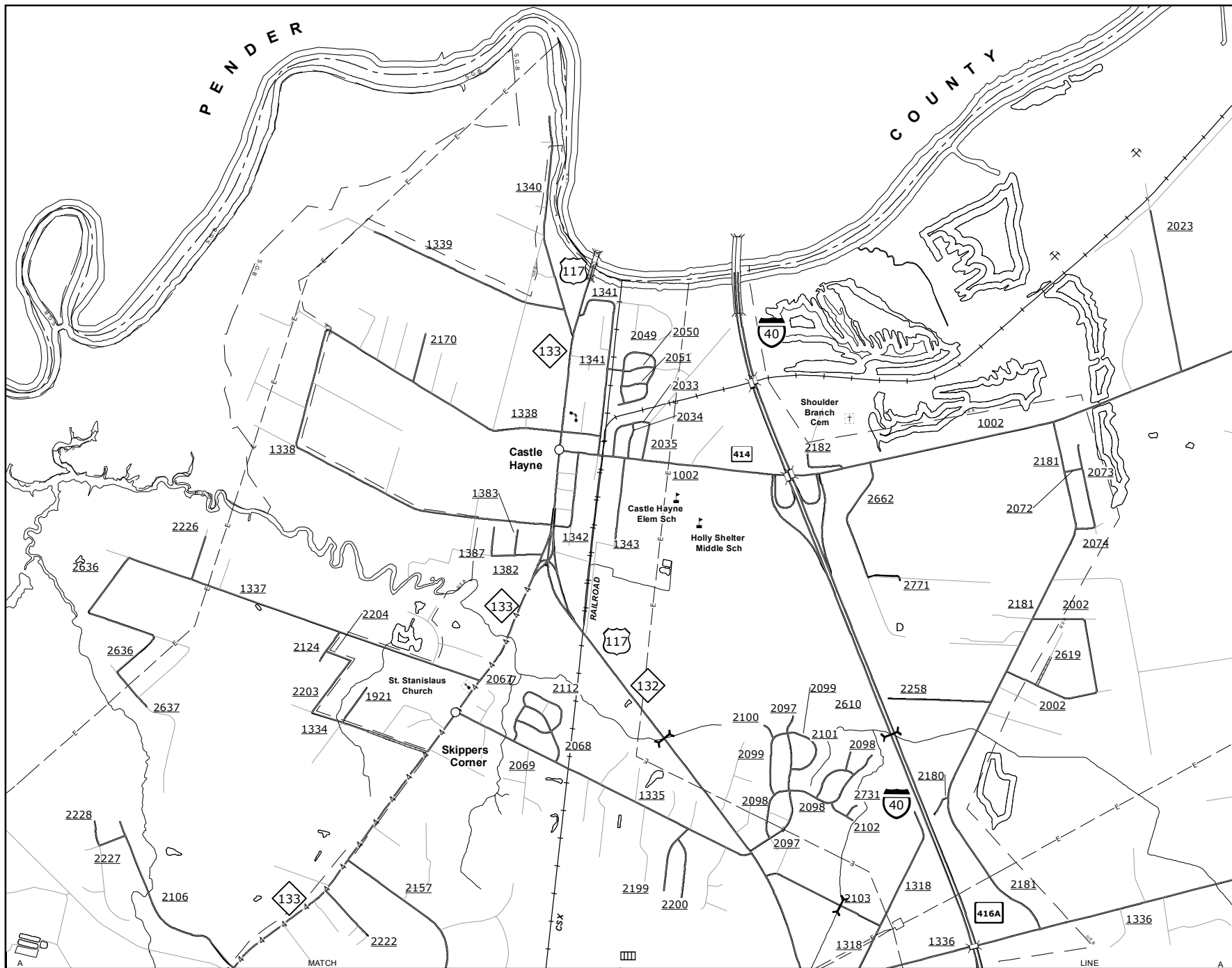

Castle Hayne

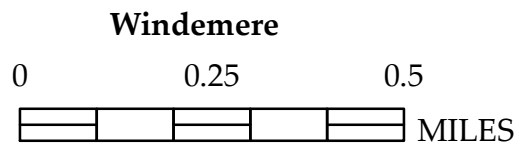
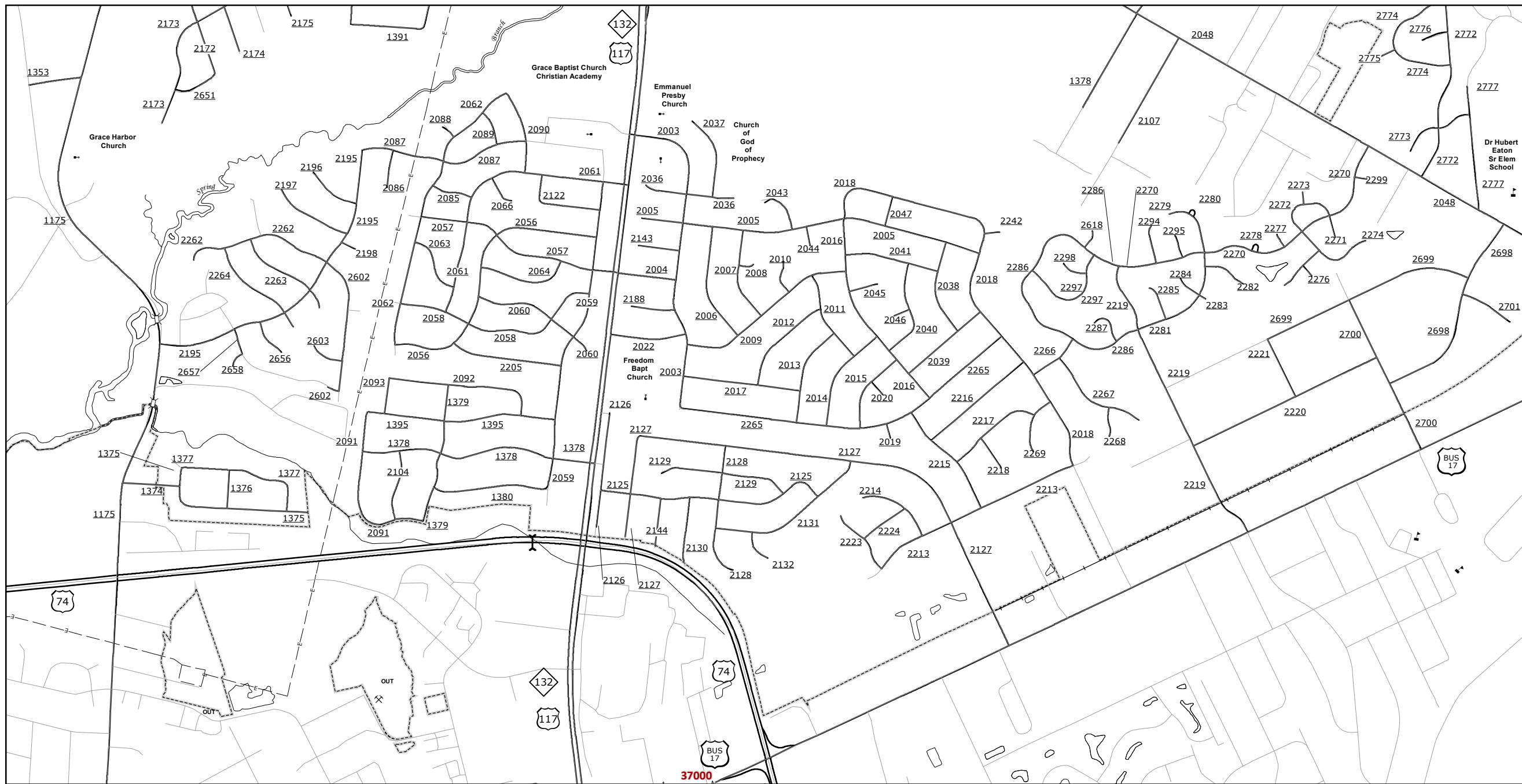

SEE 2015
WILMINGTON
URBAN MAP

2015 AADT
ANNUAL AVERAGE DAILY TRAFFIC
GENERATED BY THE
TRAFFIC SURVEY GROUP
TRANSPORTATION PLANNING BRANCH

ENLARGED MUNICIPAL AND SUBURBAN AREAS
NEW HANOVER COUNTY
NORTH CAROLINA

PREPARED BY THE
NORTH CAROLINA DEPARTMENT OF TRANSPORTATION
MANAGEMENT SYSTEMS AND ASSESSMENT UNIT - MAPPING SECTION
IN COOPERATION WITH THE
U.S. DEPARTMENT OF TRANSPORTATION
FEDERAL HIGHWAY ADMINISTRATION

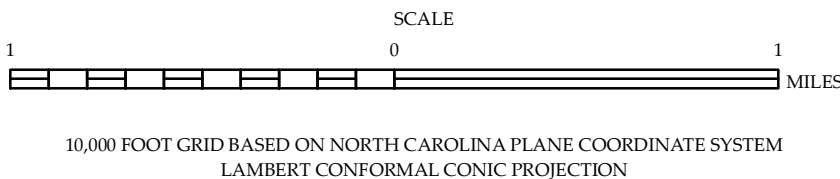

The MSA's goal is to provide the most accurate and current information possible. Map data is compiled from various sources and is not guaranteed to be 100% accurate. Accuracy, currency and completeness of the data provided will vary. Map includes state maintenance roads and important non-system roads. MSA's mapping section was last updated on September, 2016. For additional information, visit <http://www.ncdot.gov/transportation/mapping> and click on Data Providers or contact us at (819) 835-8440.

COPIES OF THIS MAP ARE AVAILABLE
FOR PURCHASE AT A FEE.
ADDRESS:
N.C. DEPARTMENT OF TRANSPORTATION
MSA - MAPPING SECTION
1000 BENTLEY RD
Raleigh, NC 27606

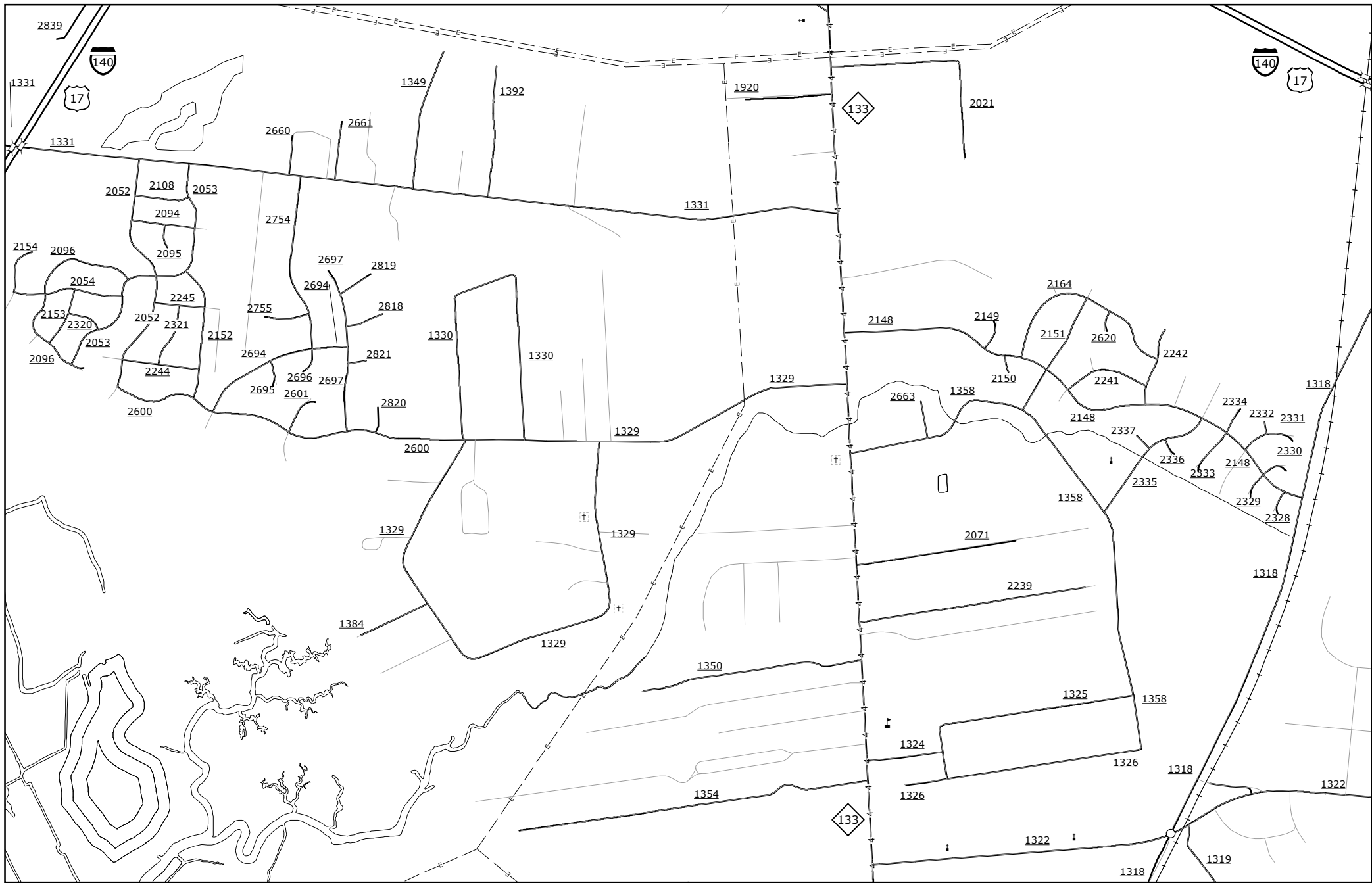

A detailed map of the Murrayville area, showing various lots and streets. Lot numbers include 2803, 2804, 2846, 2847, 2848, 2825, 2826, 2829, 2824, 2812, 2611, 2613, 2614, 2615, 2691, 2693, 2822, 2855, 2854, 2866, 2865, 2864, 2863, 2862, 2861, 2860, 2859, 2858, 2857, 2856, 2855, 2854, 2853, 2852, 2851, 2850, 2849, 2848, 2847, 2846, 2845, 2844, 2843, 2842, 2841, 2840, 2839, 2838, 2837, 2836, 2835, 2834, 2833, 2832, 2831, 2830, 2829, 2828, 2827, 2826, 2825, 2824, 2823, 2822, 2821, 2820, 2819, 2818, 2817, 2816, 2815, 2814, 2813, 2812, 2811, 2810, 2809, 2808, 2807, 2806, 2805, 2804, 2803. Street names include 'Murrayville', '1322', '1361', '1362', '2167', '2168', '2169', '2170', '2171', '2172', '2173', '2174', '2175', '2176', '2177', '2178', '2179', '2180', '2181', '2182', '2183', '2184', '2185', '2186', '2187', '2188', '2189', '2190', '2191', '2192', '2193', '2194', '2195', '2196', '2197', '2198', '2199', '2200'. A north arrow is located in the upper right corner.

MSAU - MAPPING SECTION
4809 BERYL RD
RALEIGH, NC 27606

PREPARED BY THE
NORTH CAROLINA DEPARTMENT OF TRANSPORTATION
MANAGEMENT SYSTEMS AND ASSESSMENT UNIT - MAPPING SECTION
IN COOPERATION WITH THE
U.S. DEPARTMENT OF TRANSPORTATION
FEDERAL HIGHWAY ADMINISTRATION

SCALE

0 0.25 0.5

MILES

SHEET 5 OF 5