

NOTE: Map includes only state maintained roads and important non-system roads. Map also includes roads shown on aerial photography. Road names, local agencies, and are shown in their approximate location. Information on this map is current up to June, 2015.

COPIES OF THIS MAP ARE AVAILABLE TO THE PUBLIC AT NO CHARGE. ADDRESS: N.C. DEPARTMENT OF TRANSPORTATION 4809 BERRY RD RALEIGH, NC 27606

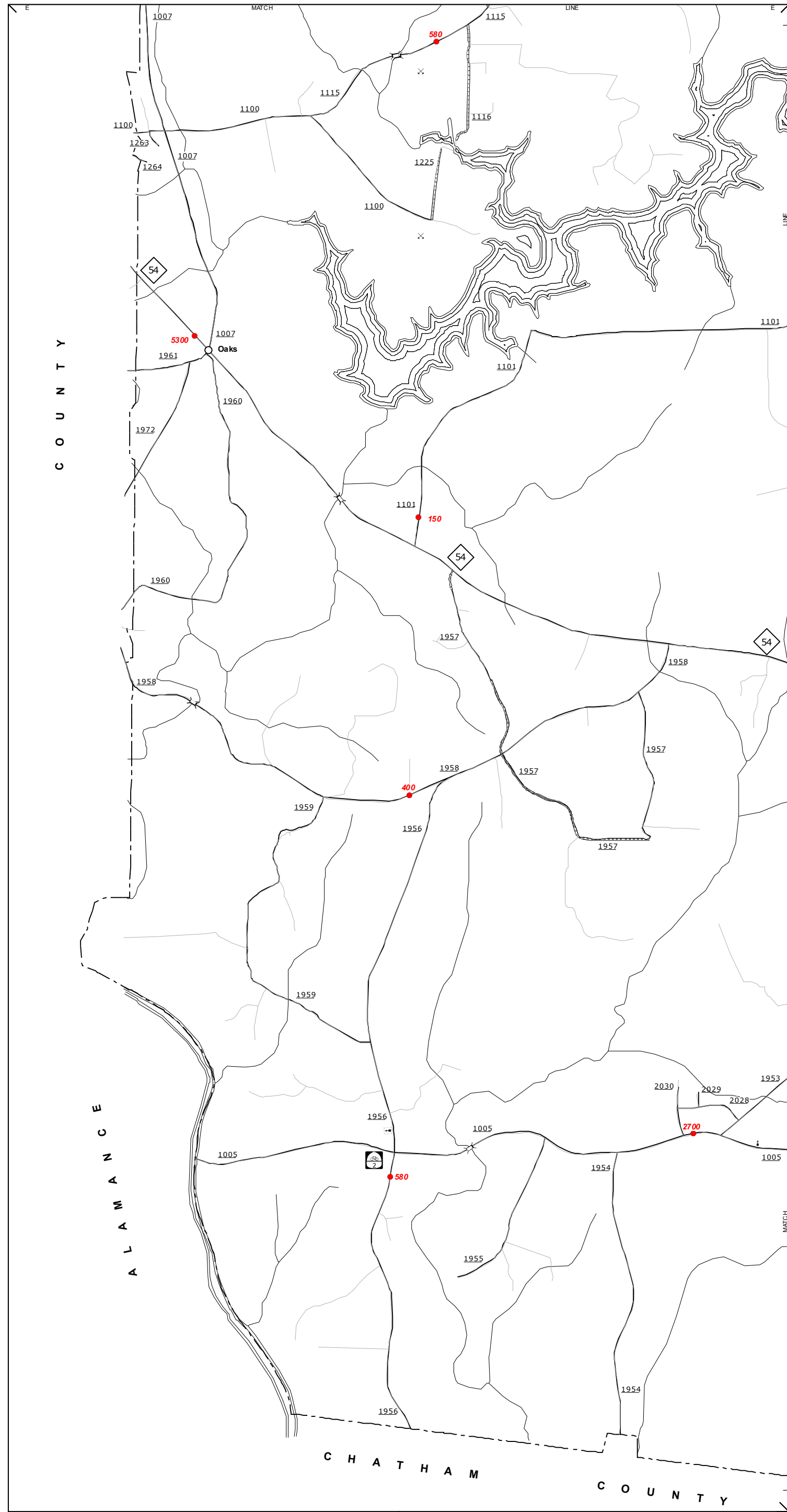

Oak and Vicinity

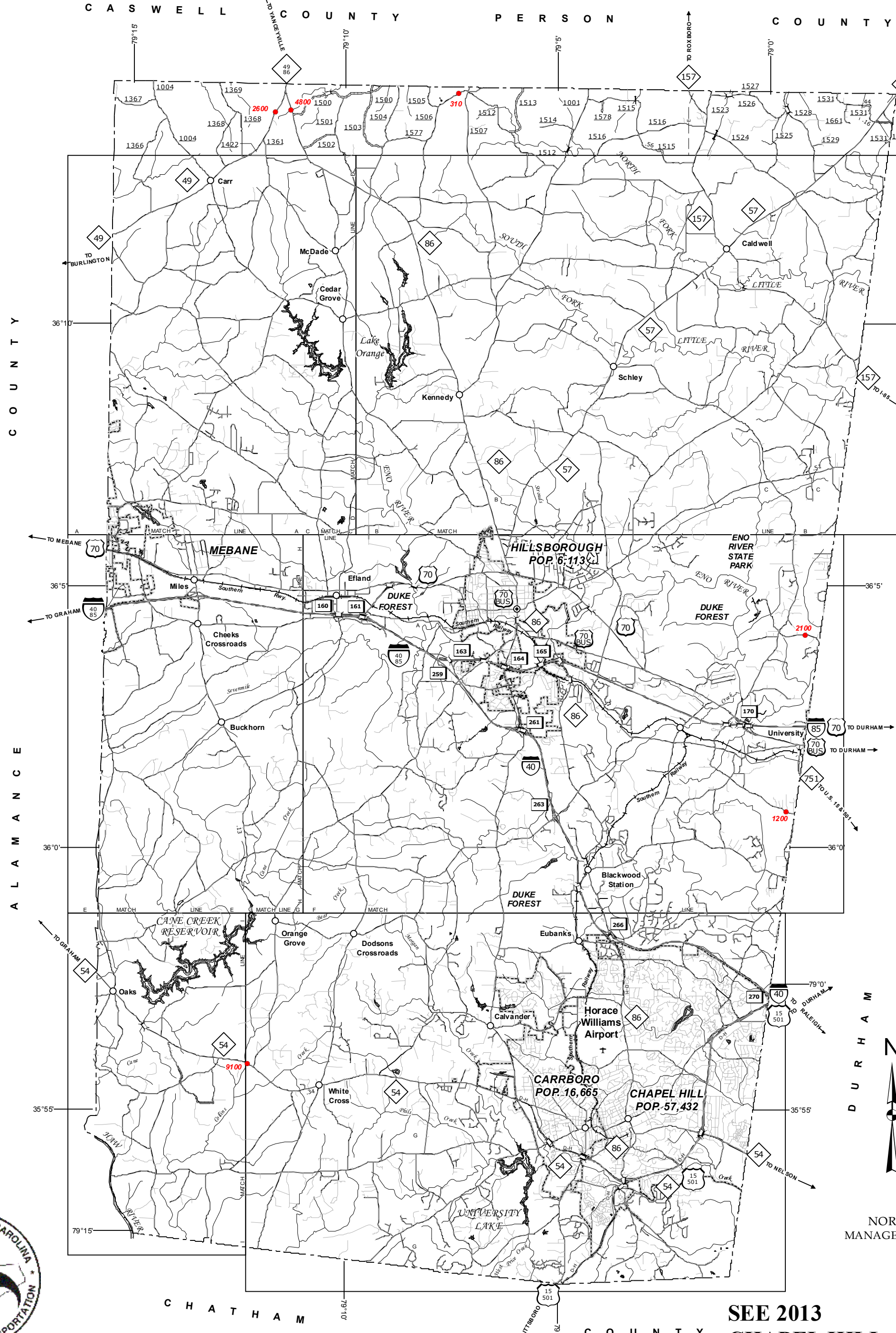
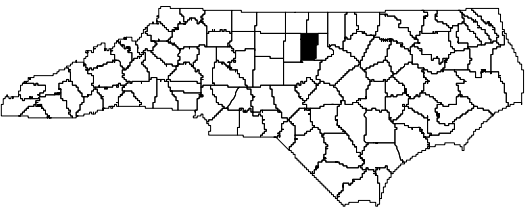
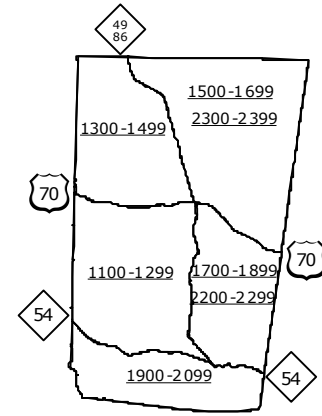
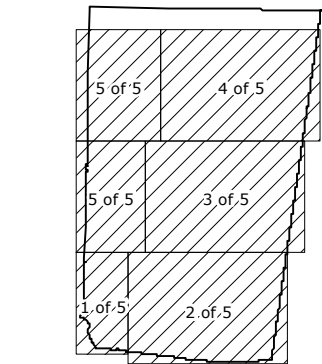

SEE 2013 CHAPEL HILL URBAN MAP

- LEGEND**
- UNPAVED SURFACED ROAD
 - HARD SURFACED ROAD
 - 4 LANE UNDIVIDED HIGHWAY
 - DIVIDED HIGHWAY INSET
 - FULL CONTROL ACCESS
 - NON-SYSTEM ROADS
 - PROJECTED LOCATION
 - NATIONAL PARK ROAD
 - BLUE RIDGE PARKWAY
 - INTERSECTION DISTANCE
 - TRAFFIC CIRCLE
 - DETAILED HIGHWAY INTERCHANGE
 - ROAD THROUGH MOUNTAIN PASS
 - HIGHWAY BRIDGE
 - UNDERPASS
 - OVERPASS
 - DRAW SPAN ON BRIDGE
 - HIGHWAY TUNNEL
 - FORD
 - INTERSTATE HIGHWAY
 - U.S. NUMBERED HIGHWAY
 - N.C. NUMBERED HIGHWAY
 - U.S. NUMBERED BICYCLE ROUTE
 - N.C. NUMBERED BICYCLE ROUTE
 - INTERSTATE INTERCHANGE NUMBER
 - SECONDARY ROAD NUMBER
 - UTILITY LINES
 - RAILROAD
 - RAILROAD STATION
 - GRADE CROSSING
 - INSET AREA
 - URBAN EXTENSION LINE
 - NATIONAL FOREST BOUNDARY
 - RESERVATION OR PARK BOUNDARY
 - STATE FOREST BOUNDARY
 - STATE GAZETTEER BOUNDARY
 - FEDERAL GAZETTEER BOUNDARY
 - MILITARY RESERVATION BOUNDARY
 - STATE LINE
 - COUNTY LINE
 - CITY LIMIT
 - FERRY ROUTE
 - CANAL
 - NARROW CREEK OR STREAM
 - WIDE RIVER OR CREEK
 - RESERVOIR, POND OR LAKE W/ ISLAND
 - DAM OR DAM WITH LOCK
 - WATERFALL
 - SWAMP
 - COMMUNITY, TOWN OR CITY CENTER
 - COUNTY SEAT
 - STATE CAPITAL
 - SCHOOL
 - HOSPITAL
 - COAST GUARD STATION
 - CHURCH
 - CHURCH WITH CEMETERY
 - CEMETERY
 - PATROL STATION
 - CORRECTION OR PENAL INSTITUTION
 - QUARRY
 - MINE OR PIT
 - HIGHWAY GARAGE OR MAINT. YARD
 - HIGHWAY DIV. OR DIST. OFFICE
 - POST OFFICE
 - MILITARY POST
 - WILDLIFE REFUGE
 - WEIGH STATION
 - FAIRGROUNDS
 - HISTORICAL SITE
 - POINTS OF INTEREST
 - STATE FOREST
 - LIGHTHOUSE
 - MOUNTAIN GAP
 - MOUNTAIN SUMMIT
 - OVERLOOK
 - GEODETIC MARKER
 - REST AREA
 - VISITOR CTR. REST AREA
 - WELCOME CTR. REST AREA
 - MAJOR AIRPORT
 - AIRPORT
 - MILITARY AIRPORT
 - HELIPORT

2014 AADT
ANNUAL AVERAGE DAILY TRAFFIC
GENERATED BY THE
TRAFFIC SURVEY GROUP
TRANSPORTATION PLANNING BRANCH

ORANGE COUNTY
NORTH CAROLINA

PREPARED BY THE
NORTH CAROLINA DEPARTMENT OF TRANSPORTATION
MANAGEMENT SYSTEMS AND ASSESSMENTS UNIT - MAPPING SECTION
IN COOPERATION WITH THE
U.S. DEPARTMENT OF TRANSPORTATION
FEDERAL HIGHWAY ADMINISTRATION

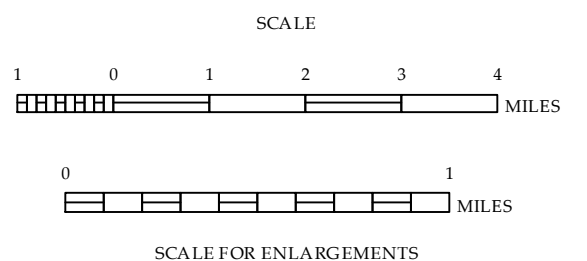

NOTE: Map includes only state-maintained roads and important non-state-maintained roads. Map also includes all roads shown on the 2013 Census of Public Use of Land and Buildings. All roads are shown in their approximate location. All roads are shown in their approximate location. Information on this map is current up to June, 2015.

COPIES OF THIS MAP ARE AVAILABLE TO THE PUBLIC AT NO CHARGE. ADDRESS: N.C. DEPARTMENT OF TRANSPORTATION MANAGEMENT SYSTEMS AND ASSESSMENTS UNIT - MAPPING SECTION 4809 BERRY RD. RALEIGH, NC 27606



Chapel Hill and Vicinity

SEE 2013 CHAPEL HILL URBAN MAP

2014 AADT
ANNUAL AVERAGE DAILY TRAFFIC
GENERATED BY THE
TRAFFIC SURVEY GROUP
TRANSPORTATION PLANNING BRANCH



ENLARGED MUNICIPAL AND SUBURBAN AREAS

ORANGE COUNTY NORTH CAROLINA

PREPARED BY THE
NORTH CAROLINA DEPARTMENT OF TRANSPORTATION
MANAGEMENT SYSTEMS AND ASSESSMENTS UNIT - MAPPING SECTION
IN COOPERATION WITH THE
U.S. DEPARTMENT OF TRANSPORTATION
FEDERAL HIGHWAY ADMINISTRATION

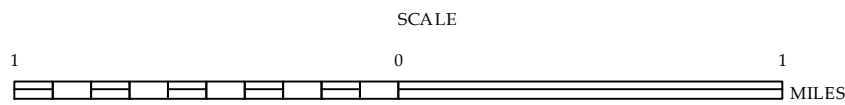

10,000 FOOT GRID BASED ON NORTH CAROLINA PLANE COORDINATE SYSTEM
LAMBERT CONFORMAL CONIC PROJECTION

NOTE: Map includes only state-maintained roads and important non-surface roads. Map also includes information on the location of the following facilities: fire stations, police stations, and other public facilities. Information on this map is current up to June, 2015.

COPIES OF THIS MAP ARE AVAILABLE TO THE PUBLIC AT NO CHARGE. TO THE PUBLICATIONS COST. ADDRESS: N.C. DEPARTMENT OF TRANSPORTATION MANAGEMENT SYSTEMS AND ASSESSMENTS UNIT - MAPPING SECTION 4809 BERRY RD. RALEIGH, NC 27606

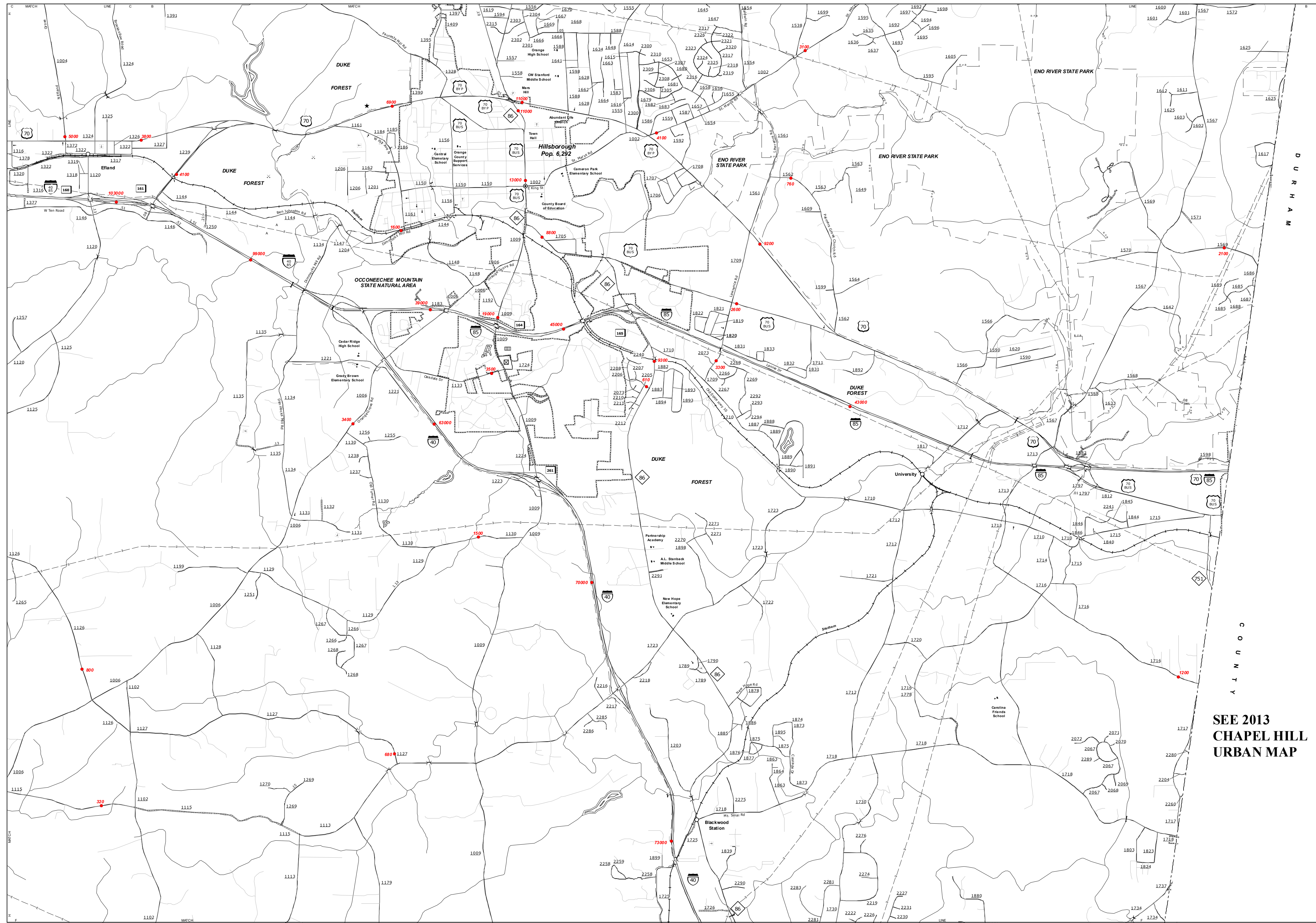

SEE 2013
CHAPEL HILL
URBAN MAP

Hillsborough and Vicinity

2014 AADT
ANNUAL AVERAGE DAILY TRAFFIC
GENERATED BY THE
TRAFFIC SURVEY GROUP
TRANSPORTATION PLANNING BRANCH

ENLARGED MUNICIPAL AND SUBURBAN AREAS

ORANGE COUNTY
NORTH CAROLINA

PREPARED BY THE
NORTH CAROLINA DEPARTMENT OF TRANSPORTATION
MANAGEMENT SYSTEMS AND ASSESSMENTS UNIT - MAPPING SECTION
IN COOPERATION WITH THE
U.S. DEPARTMENT OF TRANSPORTATION
FEDERAL HIGHWAY ADMINISTRATION

SCALE
1 0 1
MILES

10,000 FOOT GRID BASED ON NORTH CAROLINA PLANE COORDINATE SYSTEM
LAMBERT CONFORMAL CONIC PROJECTION

COPIES OF THIS MAP ARE AVAILABLE TO THE PUBLIC AT A NOMINAL COST. ADDRESS: N.C. DEPARTMENT OF TRANSPORTATION MANAGEMENT SYSTEMS AND ASSESSMENTS UNIT - MAPPING SECTION 4809 BERRY RD. RALEIGH, NC 27606

NOTE: Map includes only state-maintained roads and important non-state-maintained roads. Map also includes all roads shown on the 2014 AADT data. Road names, mileposts, and other information are shown in their approximate locations. Information on this map is current up to June, 2015.

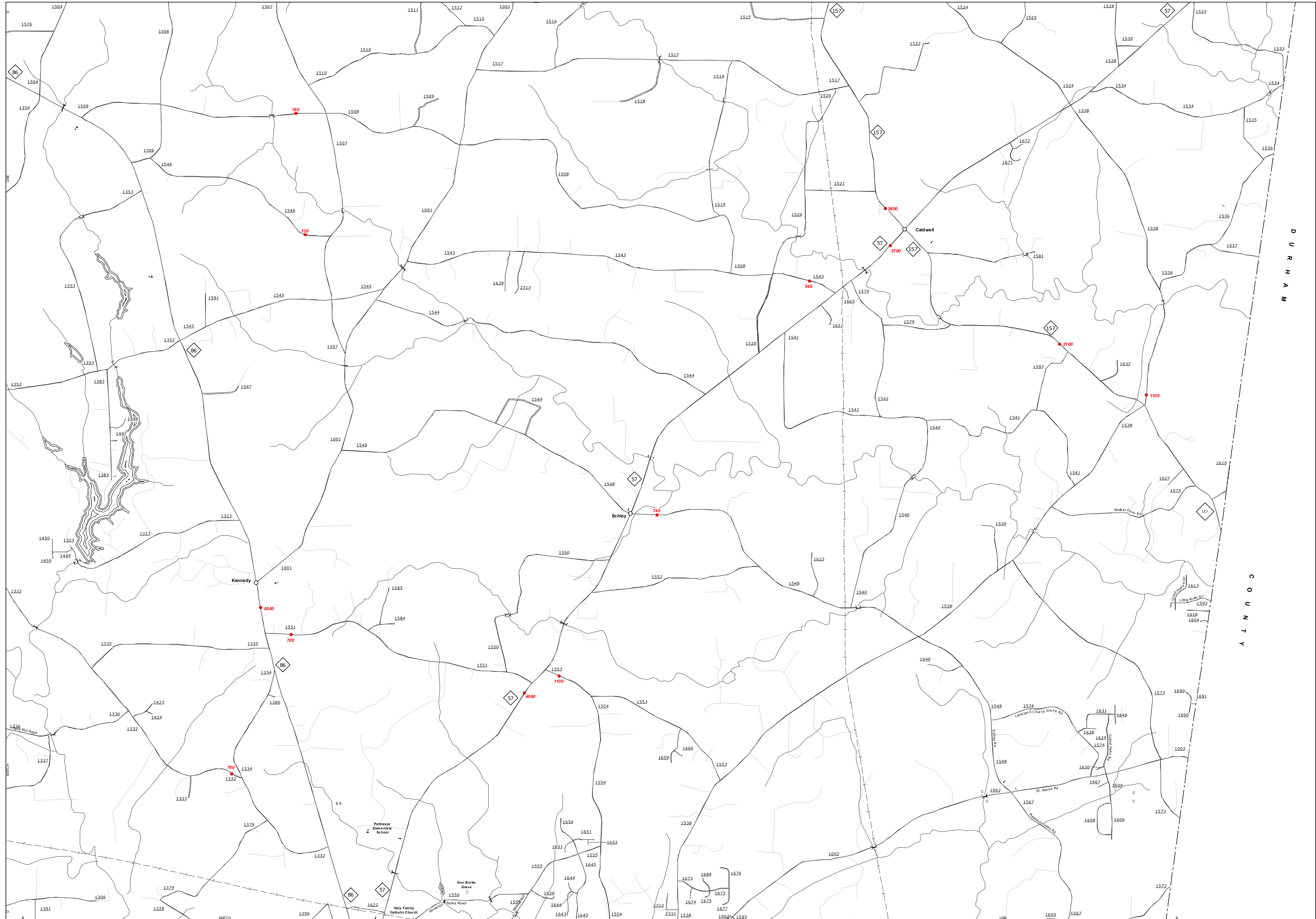

Caldwell, Kennedy, Schley and Vicinity

2014 AADT
ANNUAL AVERAGE DAILY TRAFFIC
GENERATED BY THE
TRAFFIC SURVEY GROUP
TRANSPORTATION PLANNING BRANCH

ENLARGED MUNICIPAL AND SUBURBAN AREAS

ORANGE COUNTY
NORTH CAROLINA

PREPARED BY THE
NORTH CAROLINA DEPARTMENT OF TRANSPORTATION
MANAGEMENT SYSTEMS AND ASSESSMENTS UNIT - MAPPING SECTION
IN COOPERATION WITH THE
U.S. DEPARTMENT OF TRANSPORTATION
FEDERAL HIGHWAY ADMINISTRATION

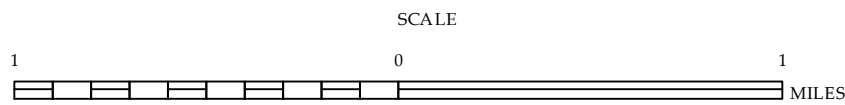

10,000 FOOT GRID BASED ON NORTH CAROLINA PLANE COORDINATE SYSTEM
LAMBERT CONFORMAL CONIC PROJECTION

This is a detailed topographic map of a section of Alameda County, California. The map shows a network of roads, including State Routes 99, 100, and 101, and various local roads. Elevation points are marked with red dots and numerical values (e.g., 2200, 1800, 1700, 1600, 1500). The map also depicts geographical features like the San Joaquin River and the town of Mebane. The title 'ALAMEDA COUNTY' is printed vertically on the left side.

The map displays a network of roads and land parcels. Key features include:

- Landmarks:** Mebane, Buckhorn, Cheeks Crossroads, Gravelly Hill Middle School.
- Roads:** US-70, US-85, SR-157, SR-114, SR-113, SR-112, SR-111, SR-110, SR-109, SR-108, SR-107, SR-106, SR-105, SR-104, SR-103, SR-102, SR-101, SR-100, SR-99, SR-98, SR-97, SR-96, SR-95, SR-94, SR-93, SR-92, SR-91, SR-90, SR-89, SR-88, SR-87, SR-86, SR-85, SR-84, SR-83, SR-82, SR-81, SR-80, SR-79, SR-78, SR-77, SR-76, SR-75, SR-74, SR-73, SR-72, SR-71, SR-70, SR-69, SR-68, SR-67, SR-66, SR-65, SR-64, SR-63, SR-62, SR-61, SR-60, SR-59, SR-58, SR-57, SR-56, SR-55, SR-54, SR-53, SR-52, SR-51, SR-50, SR-49, SR-48, SR-47, SR-46, SR-45, SR-44, SR-43, SR-42, SR-41, SR-40, SR-39, SR-38, SR-37, SR-36, SR-35, SR-34, SR-33, SR-32, SR-31, SR-30, SR-29, SR-28, SR-27, SR-26, SR-25, SR-24, SR-23, SR-22, SR-21, SR-20, SR-19, SR-18, SR-17, SR-16, SR-15, SR-14, SR-13, SR-12, SR-11, SR-10, SR-9, SR-8, SR-7, SR-6, SR-5, SR-4, SR-3, SR-2, SR-1.
- Text Overlay:** SEE 2013 BURLINGTON URBAN MAP
- Scale:** 0 to 1 mile.

PREPARED BY THE
NORTH CAROLINA DEPARTMENT OF TRANSPORTATION
MANAGEMENT SYSTEMS AND ASSESSMENTS UNIT - MAPPING SECTION
IN COOPERATION WITH THE
U.S. DEPARTMENT OF TRANSPORTATION
FEDERAL HIGHWAY ADMINISTRATION

SCALE

1 0 1

MILES

10,000 FOOT GRID BASED ON NORTH CAROLINA PLANE COORDINATE SYSTEM
LAMBERT CONFORMAL CONIC PROJECTION