

**2014 AADT**  
ANNUAL AVERAGE DAILY TRAFFIC  
GENERATED BY THE  
**TRAFFIC SURVEY GROUP**  
TRANSPORTATION PLANNING BRANCH

**CUMBERLAND COUNTY**  
**NORTH CAROLINA**

PREPARED BY THE  
NORTH CAROLINA DEPARTMENT OF TRANSPORTATION  
STATE ROAD MANAGEMENT UNIT - MAPPING SECTION  
IN COOPERATION WITH THE  
U.S. DEPARTMENT OF TRANSPORTATION  
FEDERAL HIGHWAY ADMINISTRATION

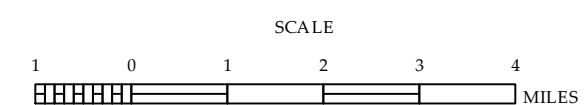

10,000 FOOT GRID BASED ON NORTH CAROLINA PLANE COORDINATE SYSTEM  
LAMBERT CONFORMAL CONIC PROJECTION



The NCA's goal is to provide the most accurate and current information possible. Map data is compiled from numerous sources with varying data of publication and map accuracy standards. As a result, the information shown on the map was last updated on June, 2015. For additional information, visit the NCA's website at [www.ncdot.gov](http://www.ncdot.gov). The information shown on the map was last updated on June, 2015. For additional information, visit the NCA's website at [www.ncdot.gov](http://www.ncdot.gov).

COPIES OF THIS MAP ARE AVAILABLE AT NO CHARGE. ADDRESS: N.C. DEPARTMENT OF TRANSPORTATION MS&U - MAPPING SECTION 1000 WESTERN BOULEVARD, SUITE 200B RALEIGH, NC 27603

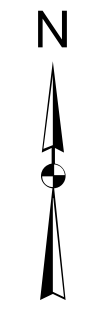
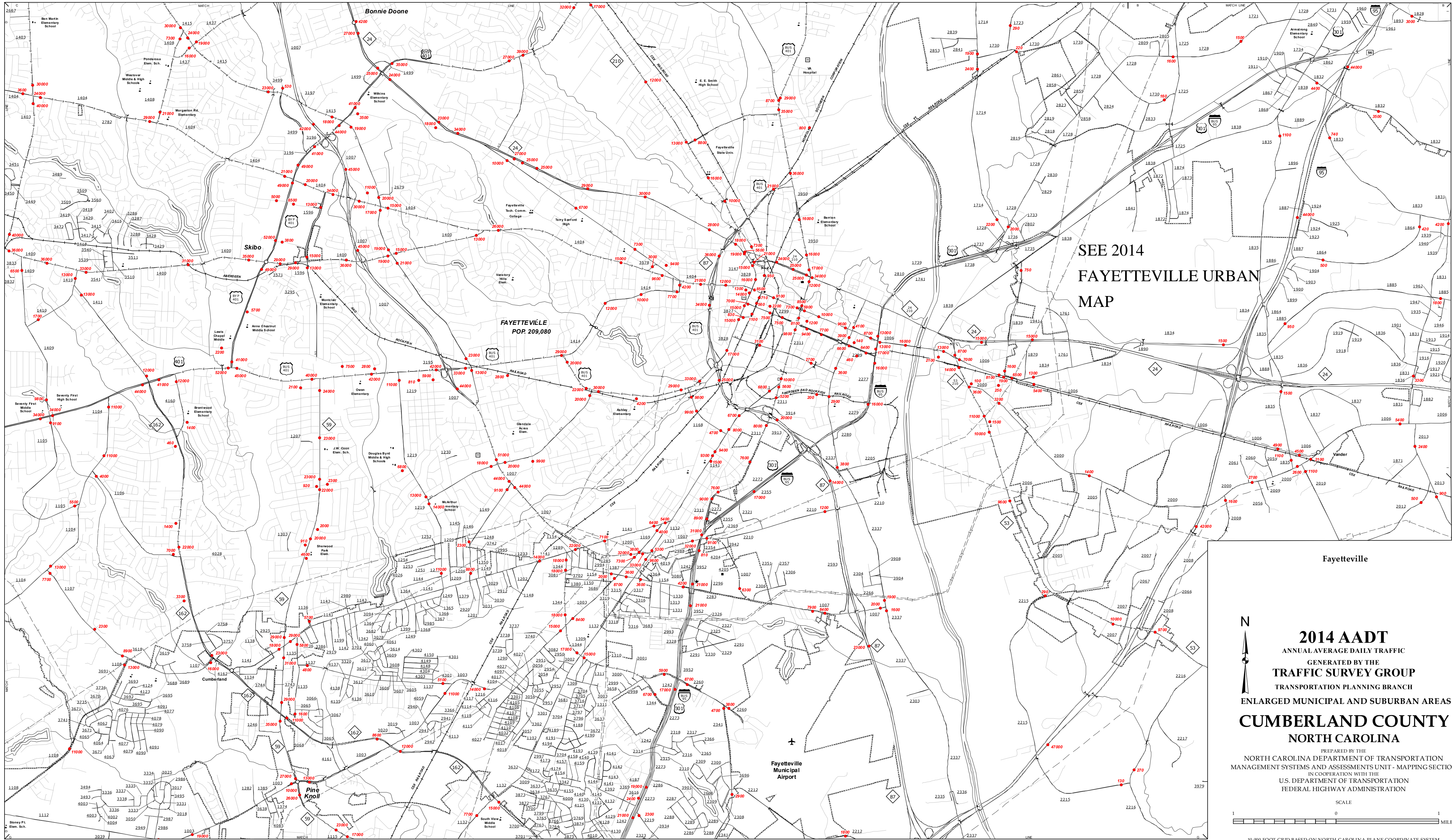

**2014 AADT**  
ANNUAL AVERAGE DAILY TRAFFIC  
GENERATED BY THE  
TRAFFIC SURVEY GROUP  
TRANSPORTATION PLANNING BRANCH  
ENLARGED MUNICIPAL AND SUBURBAN AREAS  
**CUMBERLAND COUNTY**  
NORTH CAROLINA  
PREPARED BY THE  
NORTH CAROLINA DEPARTMENT OF TRANSPORTATION  
MANAGEMENT SYSTEMS AND ASSESSMENTS UNIT - MAPPING SECTION  
IN COOPERATION WITH THE  
U.S. DEPARTMENT OF TRANSPORTATION  
FEDERAL HIGHWAY ADMINISTRATION

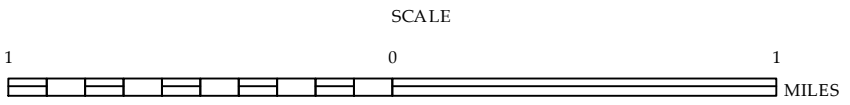

10,000 FOOT GRID BASED ON NORTH CAROLINA PLANE COORDINATE SYSTEM  
LAMBERT CONFORMAL CONIC PROJECTION



The NSAU's goal is to provide the most accurate and current information possible. Map data is compiled from numerous sources with varying dates of publication and map accuracy standards. As a result, the accuracy of the data provided will vary. Map focuses on major roads and important transportation corridors. The information shown on this map was last updated on June 2015. For additional information, visit <http://www.ncdot.gov>. **TRAFFIC SURVEY GROUP** are a unit of the Division of Transportation at 100 S.W. 10th St., Raleigh, NC 27601.

COPIES OF THIS MAP ARE AVAILABLE TO THE PUBLIC AT NO CHARGE. ADDRESS: N.C. DEPARTMENT OF TRANSPORTATION, 4809 BERRY RD, RALEIGH, NC 27606

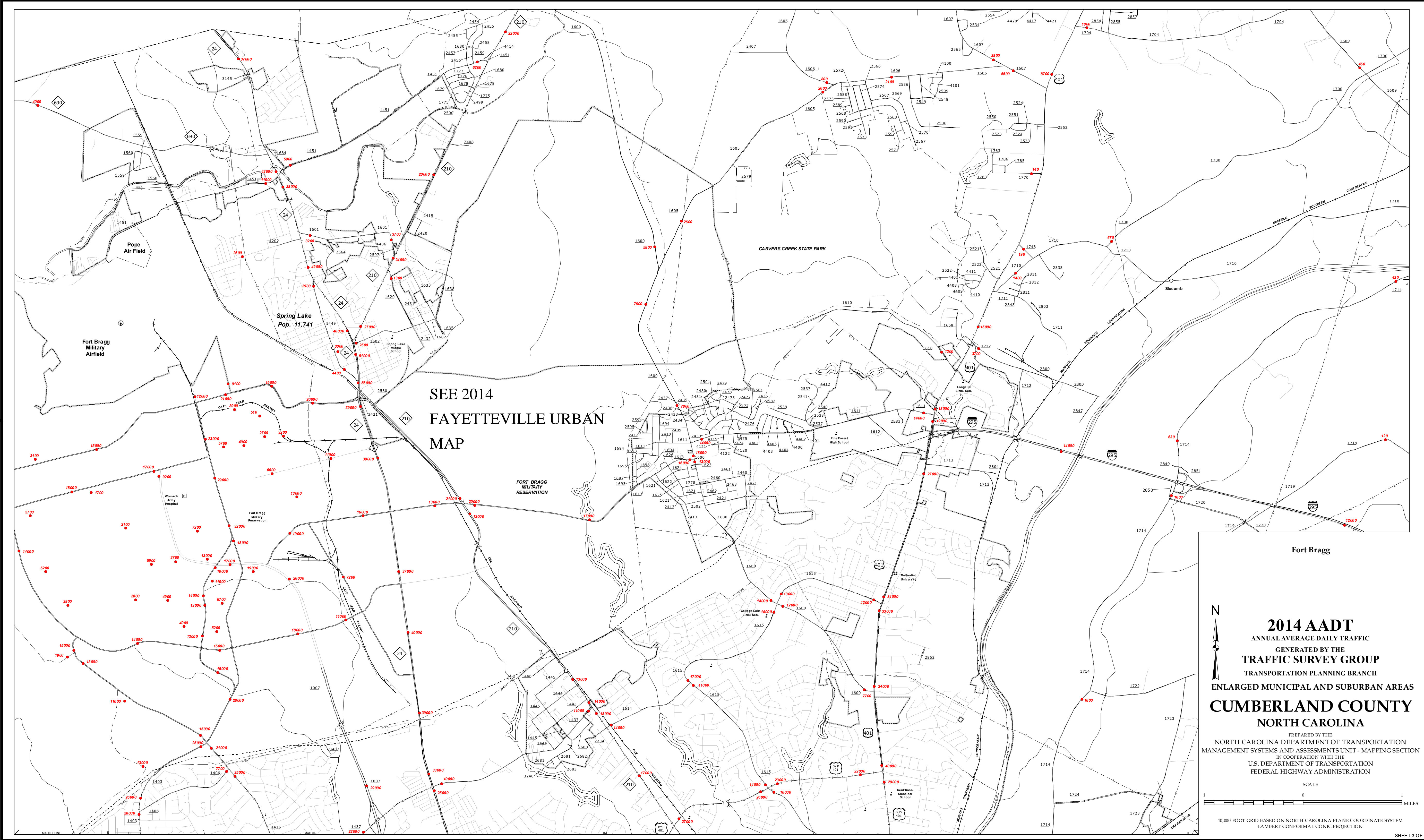



COPIES OF THIS MAP ARE AVAILABLE TO THE PUBLIC AT NO CHARGE. TO THE PUBLICATION OF THIS MAP, THE N.C. DEPARTMENT OF TRANSPORTATION HAS INCURRED A COST OF \$10,000.00. THE INFORMATION SHOWN ON THIS MAP WAS LAST UPDATED ON JUNE, 2015. FOR ADDITIONAL INFORMATION, VISIT THE WEBSITE: [www.ncdot.gov](http://www.ncdot.gov). THE INFORMATION SHOWN ON THIS MAP IS FOR GENERAL INFORMATION ONLY AND DOES NOT CONSTITUTE A WARRANTY OR GUARANTEE OF ANY KIND.

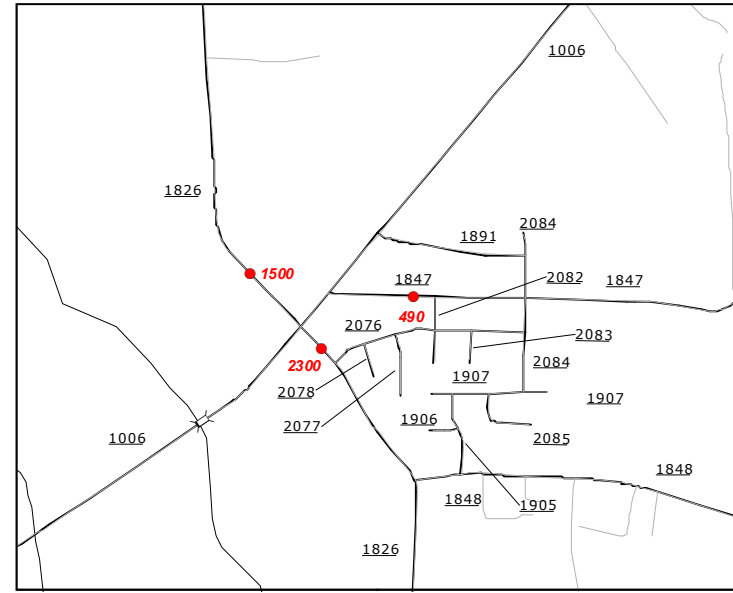
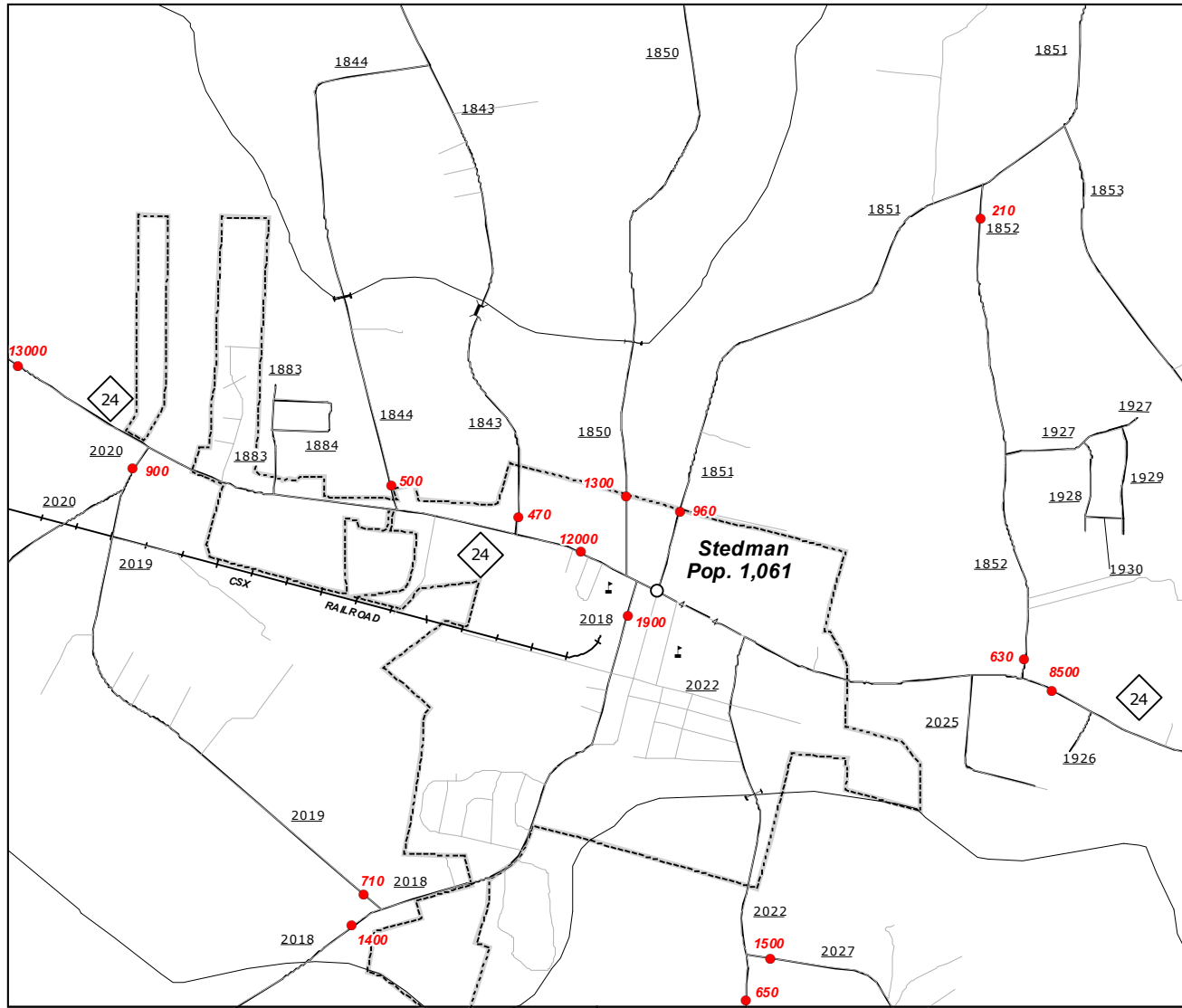
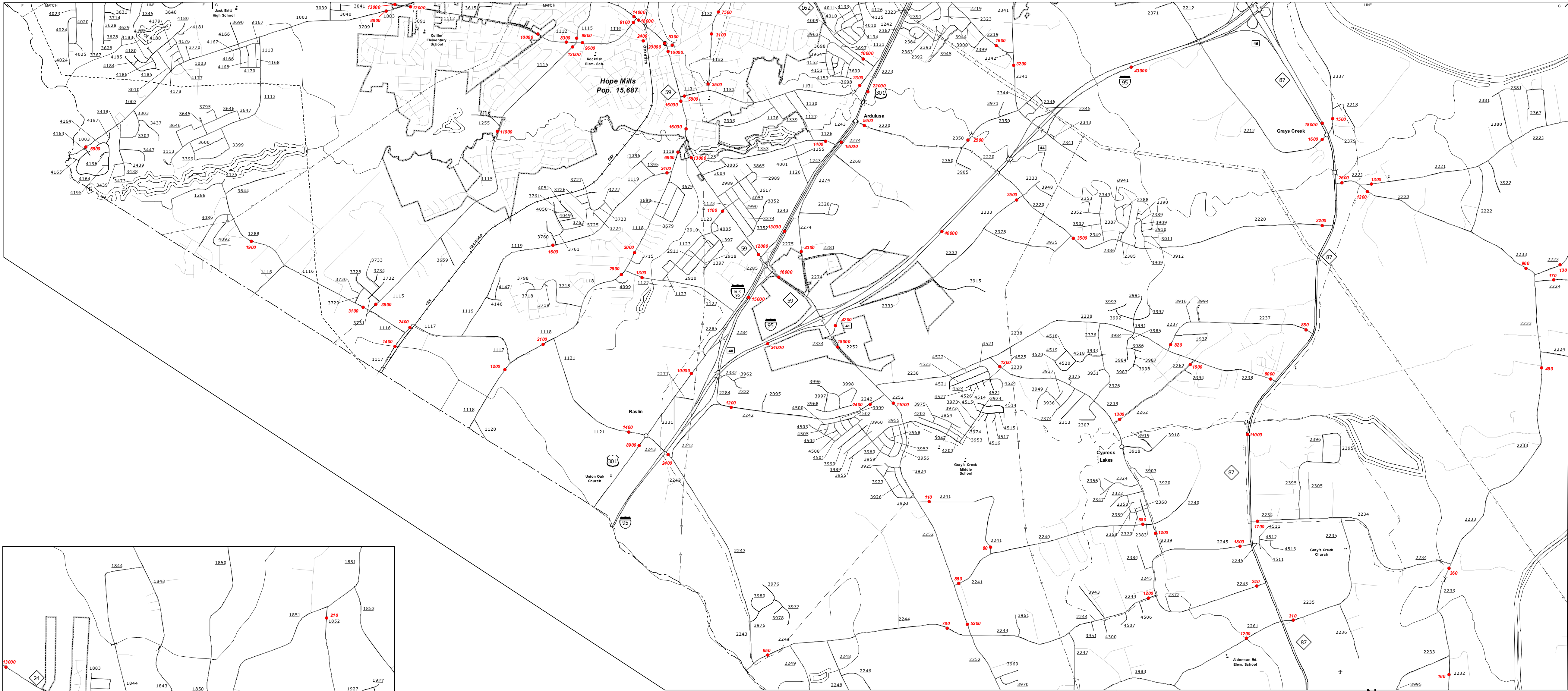

Inset 1

Hope Mills

Stedman



**2014 AADT**  
ANNUAL AVERAGE DAILY TRAFFIC  
GENERATED BY THE  
**TRAFFIC SURVEY GROUP**  
TRANSPORTATION PLANNING BRANCH  
ENLARGED MUNICIPAL AND SUBURBAN AREAS  
**CUMBERLAND COUNTY**  
NORTH CAROLINA  
PREPARED BY THE  
NORTH CAROLINA DEPARTMENT OF TRANSPORTATION  
MANAGEMENT SYSTEMS AND ASSESSMENTS UNIT - MAPPING SECTION  
IN COOPERATION WITH THE  
U.S. DEPARTMENT OF TRANSPORTATION  
FEDERAL HIGHWAY ADMINISTRATION

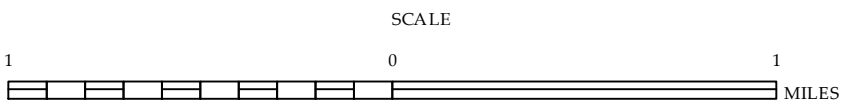

10,000 FOOT GRID BASED ON NORTH CAROLINA PLANE COORDINATE SYSTEM  
LAMBERT CONFORMAL CONIC PROJECTION



COPIES OF THIS MAP ARE AVAILABLE TO THE PUBLIC AT A NOMINAL COST. ADDRESS: N.C. DEPARTMENT OF TRANSPORTATION, 4809 BERRY RD, RALEIGH, NC 27606

The NCSU's goal is to provide the most accurate and current information possible. Map data is compiled from numerous sources with varying data of publication and map accuracy standards. As a result, the accuracy of the data provided will vary. Map features also include roads and important non-spatial features. The information shown on this map was last updated on June 2015. For additional information, visit <http://www.ncdot.gov> or call 1-800-368-3683.

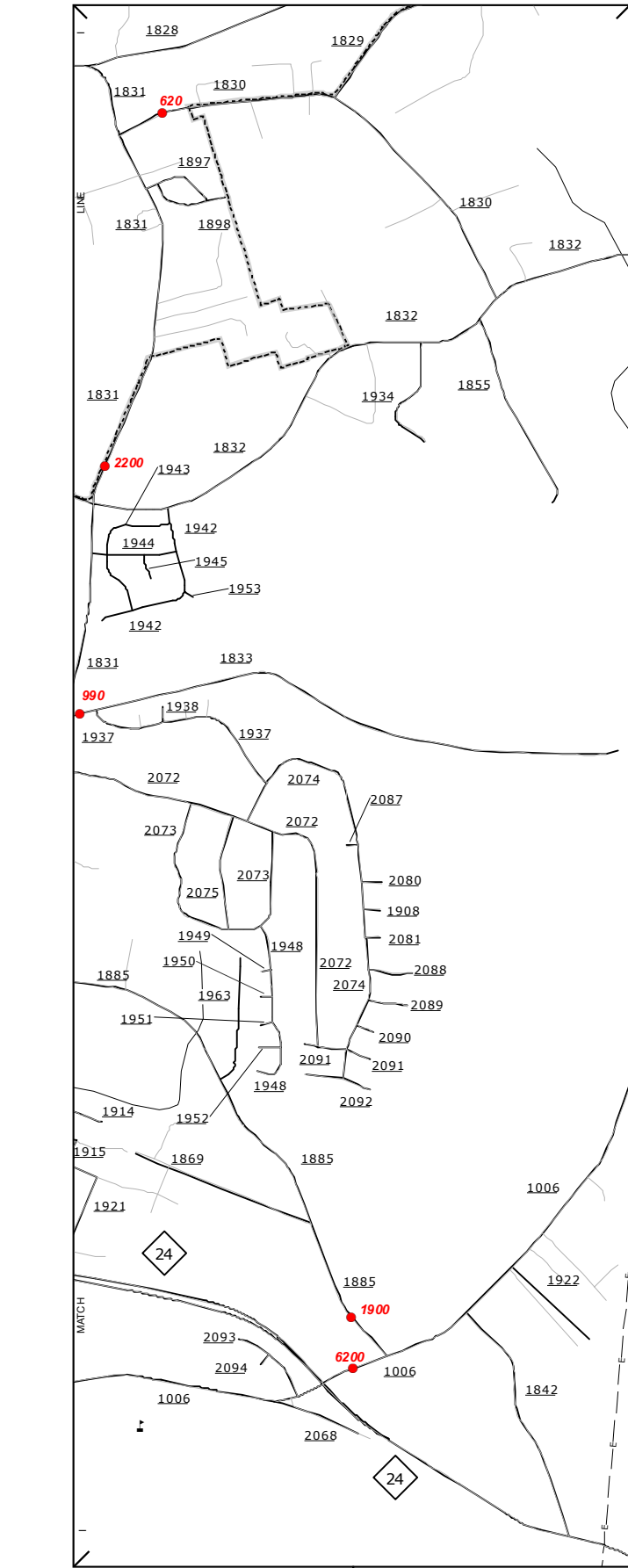

East Fayetteville

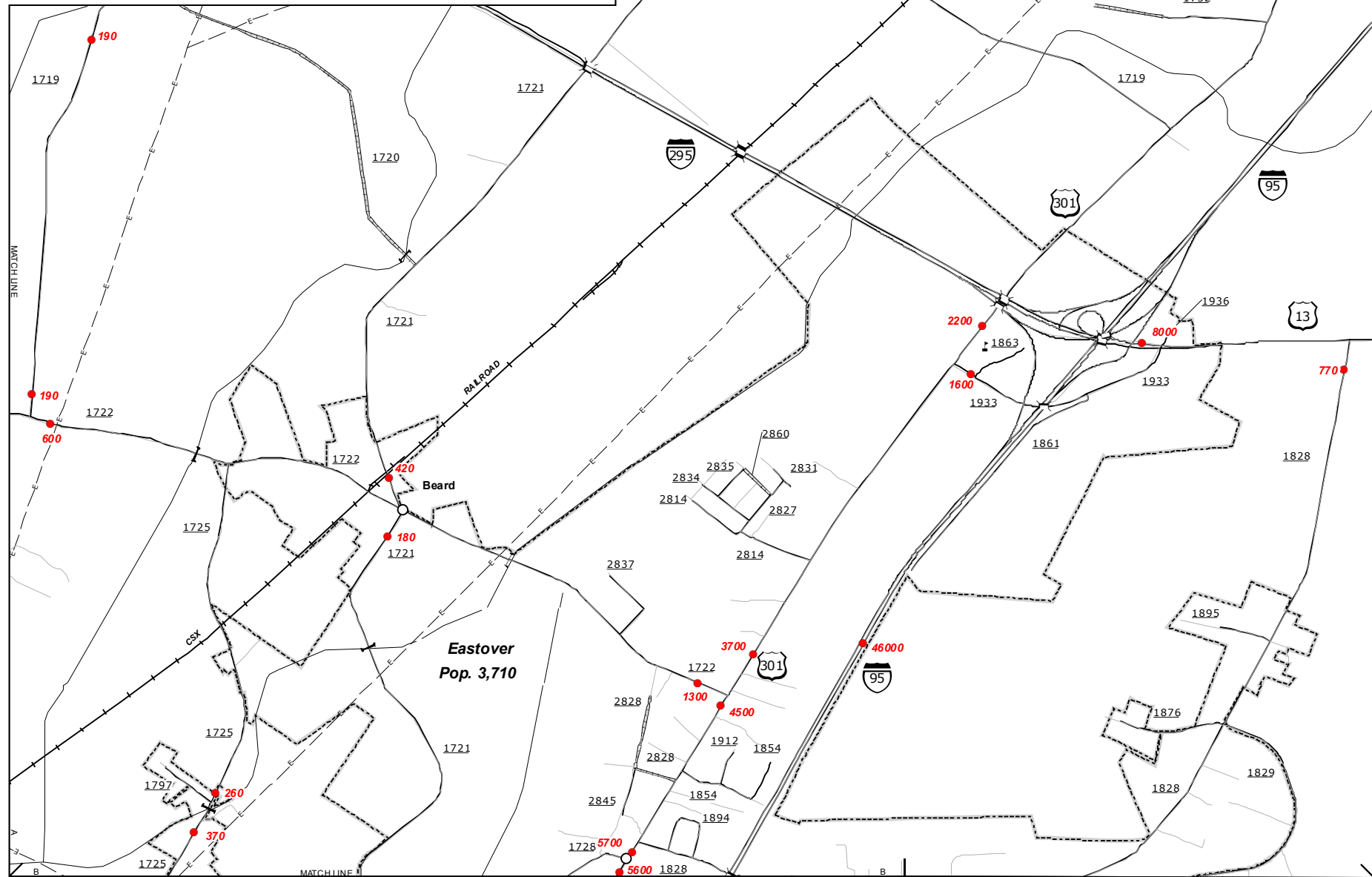

Eastover  
Pop. 3,710

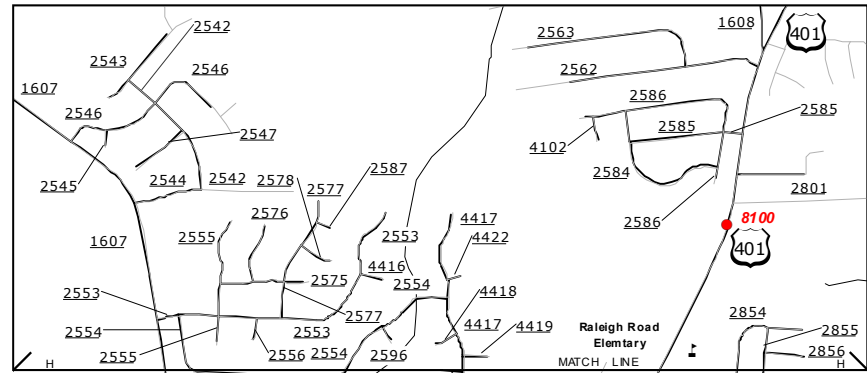

Inset 2

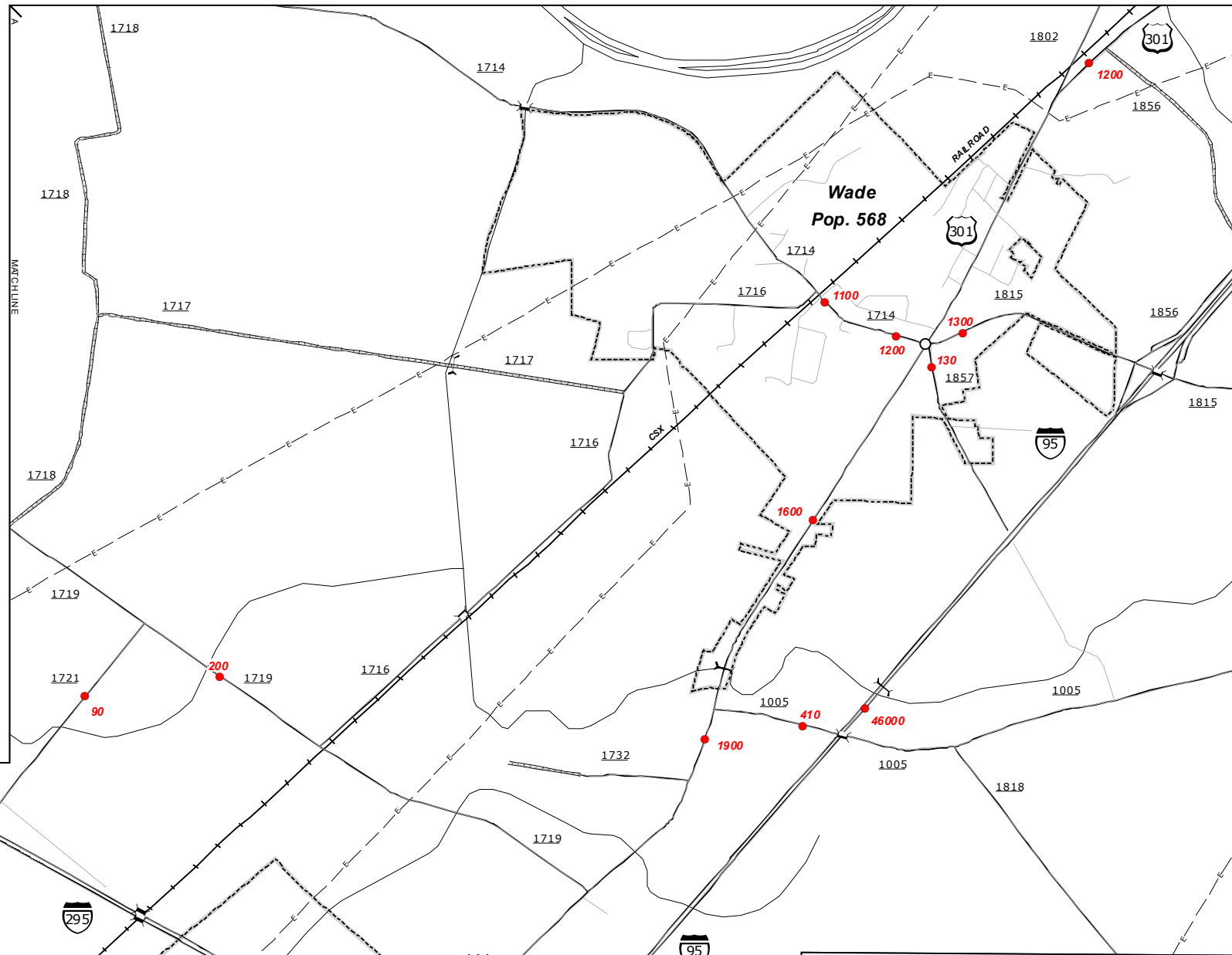

Wade  
Pop. 568

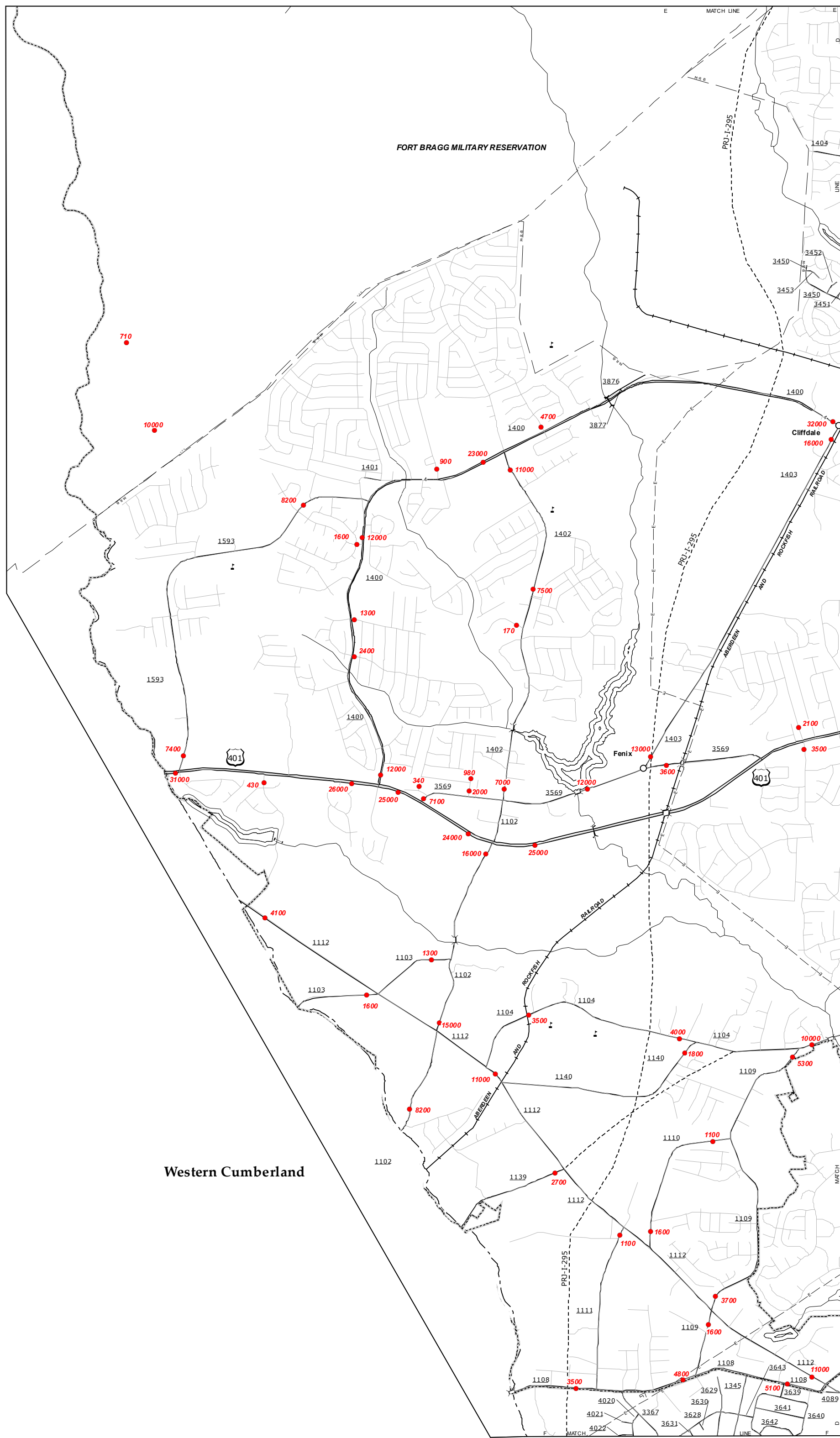

Western Cumberland

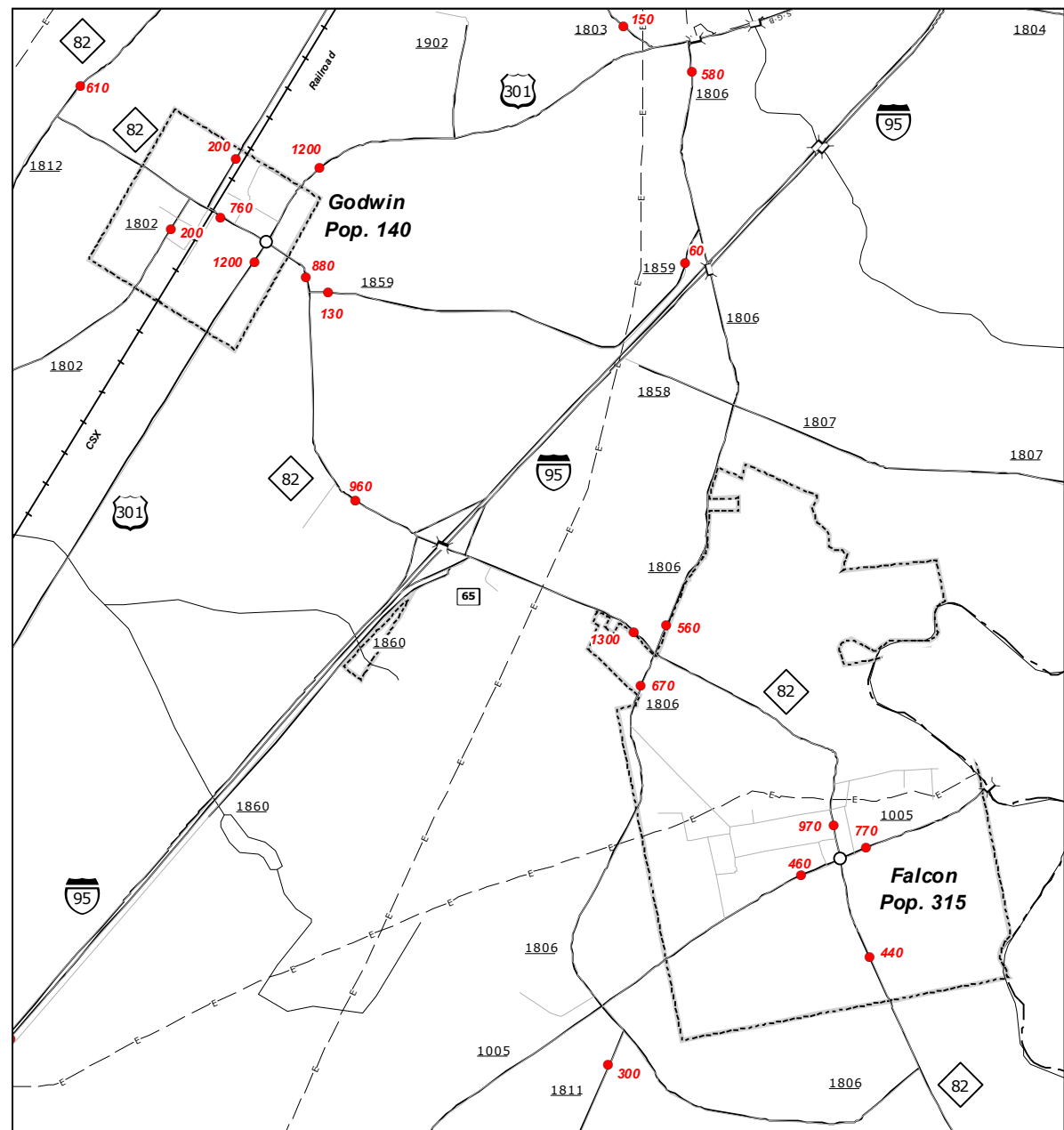

Falcon  
Pop. 140

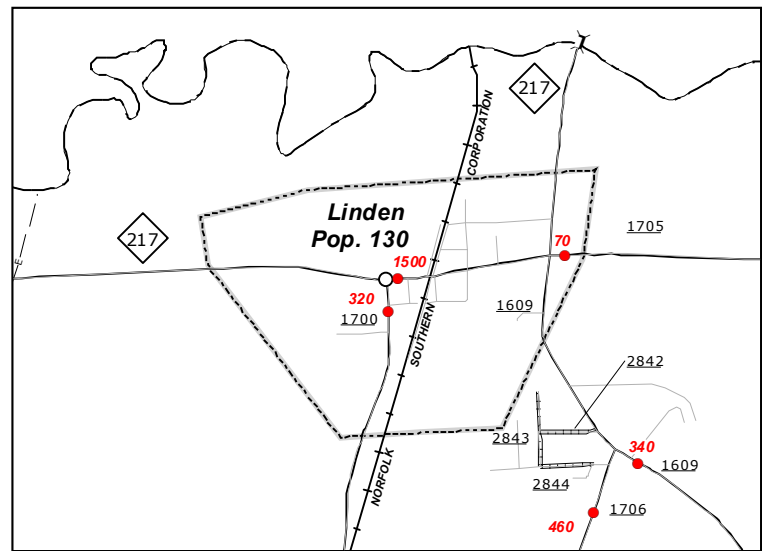

Linden  
Pop. 130



**2014 AADT**  
ANNUAL AVERAGE DAILY TRAFFIC  
GENERATED BY THE  
**TRAFFIC SURVEY GROUP**  
TRANSPORTATION PLANNING BRANCH  
ENLARGED MUNICIPAL AND SUBURBAN AREAS  
**CUMBERLAND COUNTY**  
NORTH CAROLINA

PREPARED BY THE  
NORTH CAROLINA DEPARTMENT OF TRANSPORTATION  
MANAGEMENT SYSTEMS AND ASSESSMENTS UNIT - MAPPING SECTION  
IN COOPERATION WITH THE  
U.S. DEPARTMENT OF TRANSPORTATION  
FEDERAL HIGHWAY ADMINISTRATION

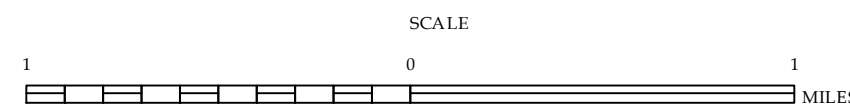

10,000 FOOT GRID BASED ON NORTH CAROLINA PLANE COORDINATE SYSTEM  
LAMBERT CONFORMAL CONIC PROJECTION