

WATAUGA
 SUP. 1
 CORNERS OF THIS MAP ARE AVAILABLE TO THE PUBLIC AT A NOMINAL COST.
 ADDRESS: NORTH CAROLINA DEPARTMENT OF TRANSPORTATION, STATE ROAD MAINTENANCE UNIT - MAPPING AND INFORMATION SECTION, 4501 STATE ROAD 100, SALEM, NORTH CAROLINA 27158-1000.

REVISED
6/21/00 JSH
12/31/01 JSH
6/18/02 JSH
11/13/03 JSH
10/20/04 JSH
08/04/05 JSH
6/26/06 BGS
11/30/06 BGS
4/23/07 BGS
2/27/08 BGS

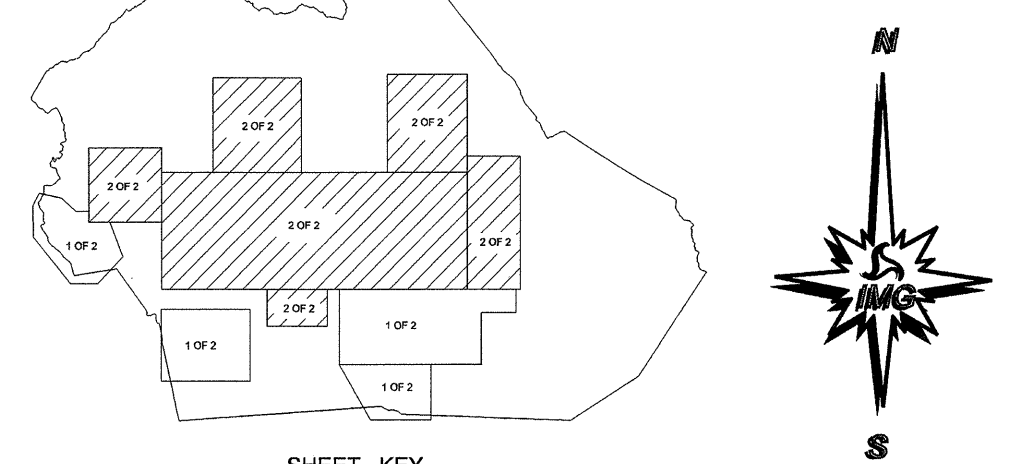

ENLARGED MUNICIPAL AND SUBURBAN AREAS
WATAUGA COUNTY
 NORTH CAROLINA
 PREPARED BY THE
 NORTH CAROLINA DEPARTMENT OF TRANSPORTATION
 STATE ROAD MAINTENANCE UNIT - MAPPING AND INFORMATION SECTION
 IN COOPERATION WITH THE
 U.S. DEPARTMENT OF TRANSPORTATION
 FEDERAL HIGHWAY ADMINISTRATION
 SCALE
 1" = 1 MILE
15000 FOOT GRID BASED ON NORTH CAROLINA PLANE COORDINATE SYSTEM
 POLYCONIC PROJECTION