

Disclaimer: The IMG Unit's goal is to provide the most accurate information as possible, the magnitude of the data prevents any guarantee of accuracy or completeness. If you find any information that is incorrect, please send your request to the IMG Unit.

COPIES OF THIS MAP ARE AVAILABLE TO THE PUBLIC AT A NOMINAL COST. NO CHARGE FOR TRANSPORTATION INFORMATION, MAPPING AND GRAPHICS. RALEIGH, N.C. 27601

REVISED
6/1/07 BCT
7/31/07 BCT
5/28/08 BCT
6/30/08 BCT
1/30/09 BCT
1/28/09 MCI
2/17/09 MCI
4/23/09 BDC
6/22/09 RLA
6/24/09 BDC
7/29/09 MCI
8/17/09 BDC
10/7/09 BDC
12/30/09 BDC

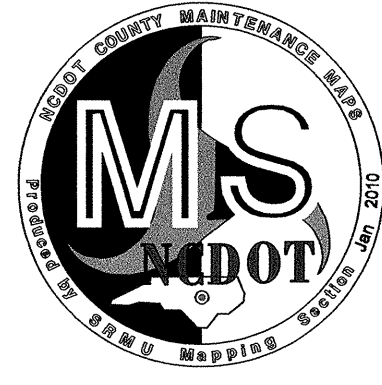
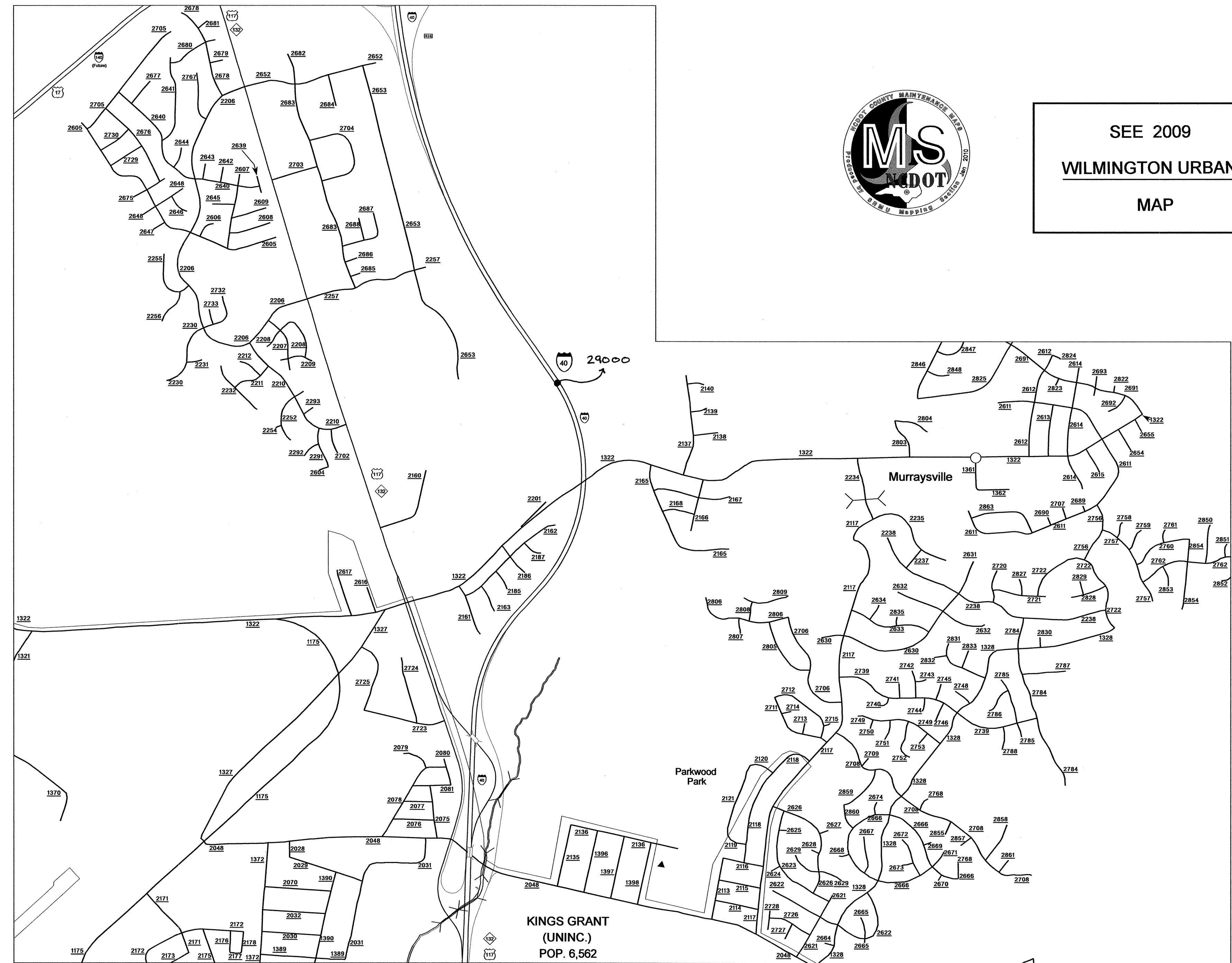

SEE 2009
WILMINGTON URBAN
MAP

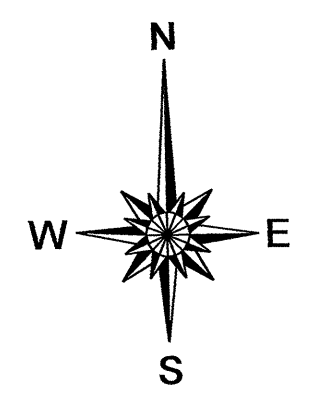
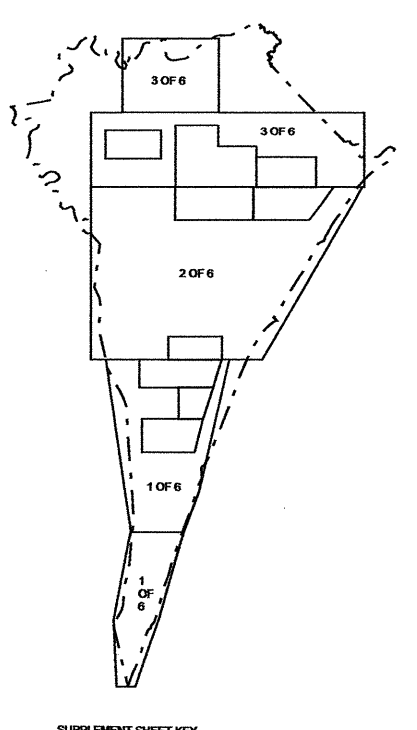
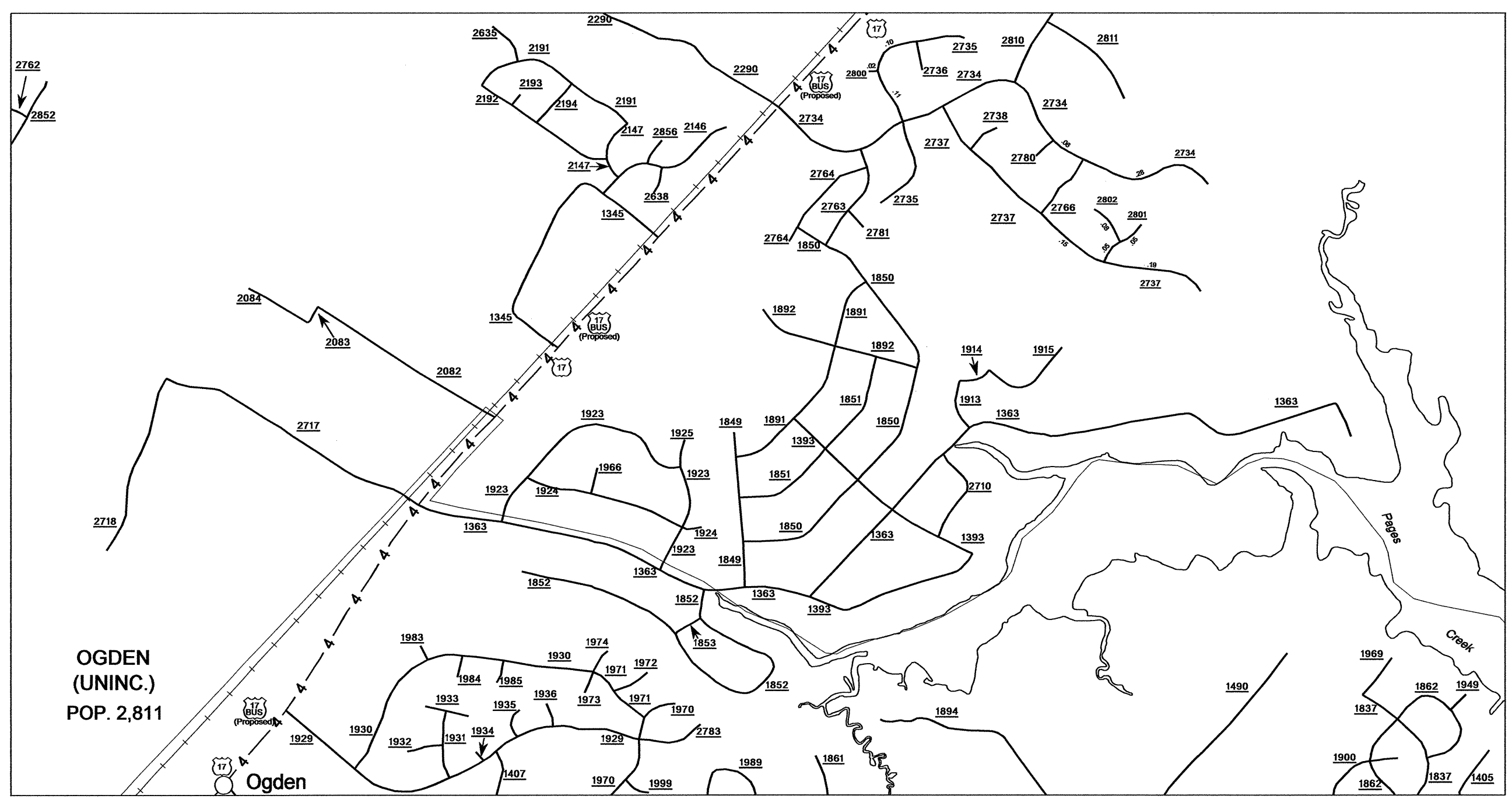
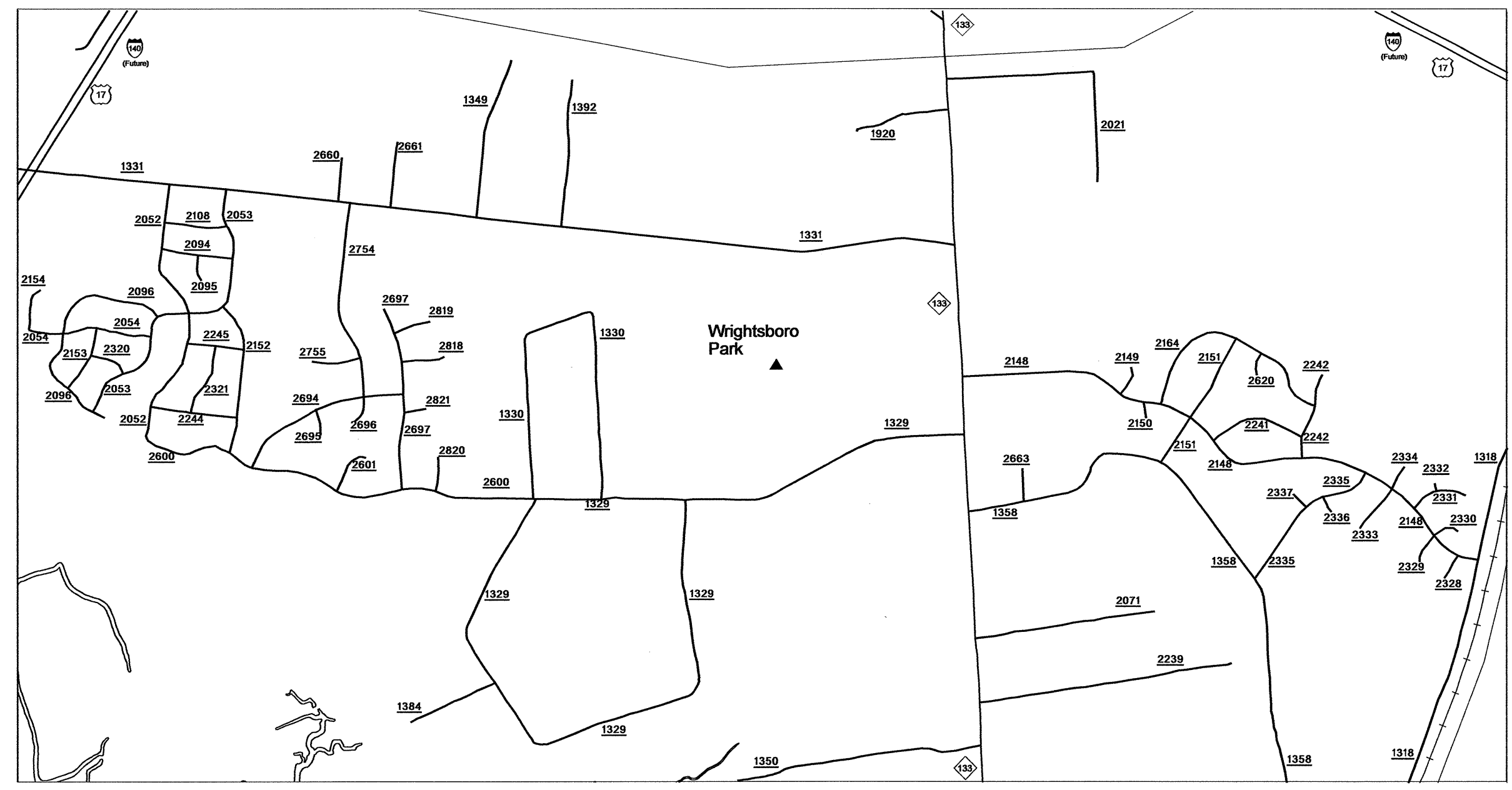

2009 AADT
ANNUAL AVERAGE DAILY TRAFFIC
NEW HANOVER COUNTY
NORTH CAROLINA
GENERATED BY THE
TRAFFIC SURVEY GROUP
TRANSPORTATION PLANNING BRANCH

BASE MAPPING PREPARED BY
NORTH CAROLINA DEPARTMENT OF TRANSPORTATION
STATE ROAD MAINTENANCE UNIT
MAPPING & INFORMATION SECTION
IN COOPERATION WITH THE
U.S. DEPARTMENT OF TRANSPORTATION
FEDERAL HIGHWAY ADMINISTRATION

