

Disclaimer: The MGS Unit's goal is to provide the most accurate information as possible. The magnitude of the data prevents any guarantee of accuracy or completeness. If you find any information that is incorrect, please send your request to the MGS Unit.

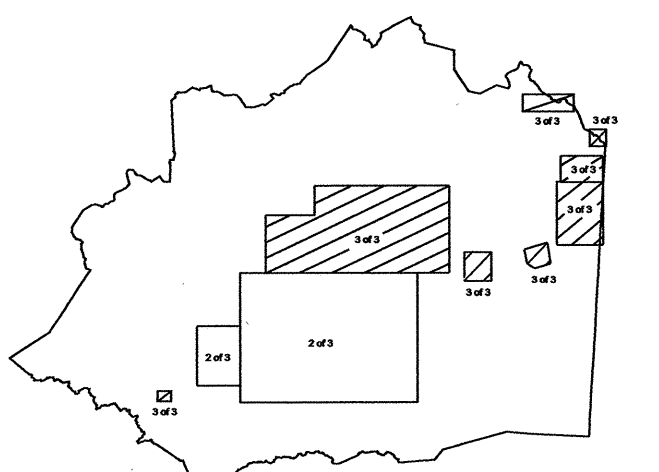
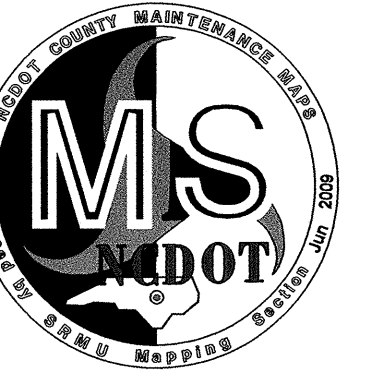
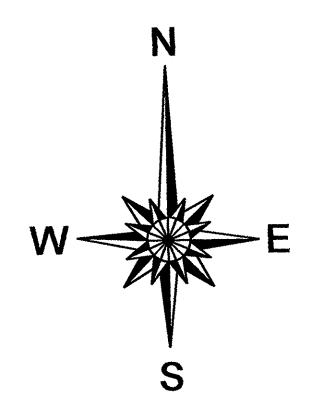
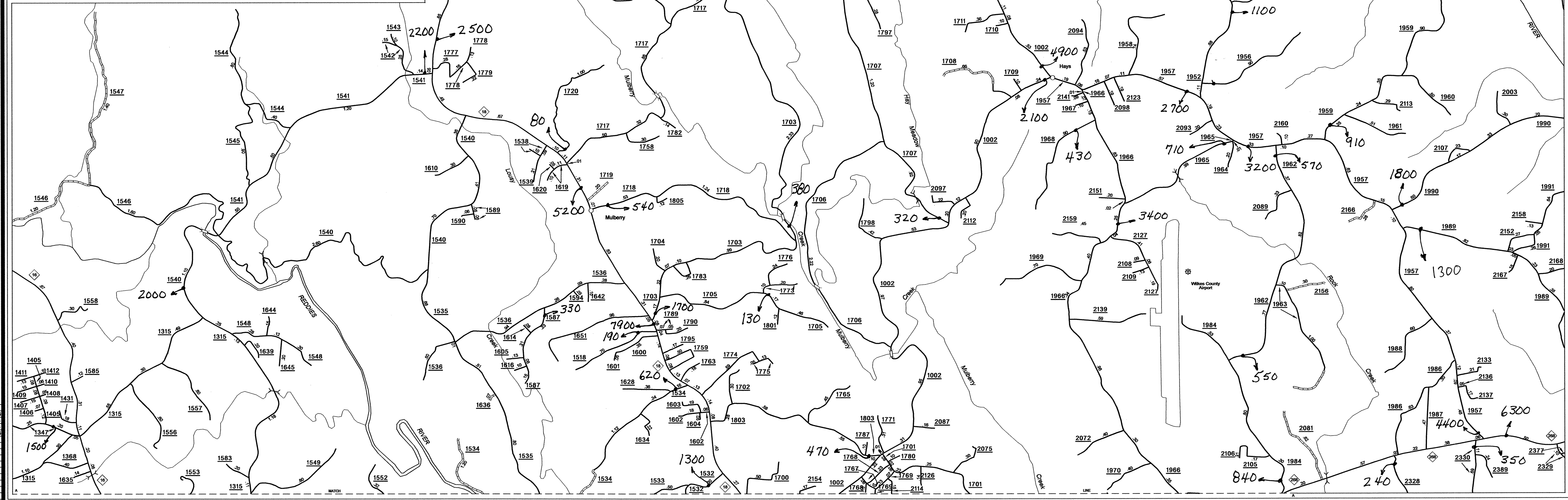
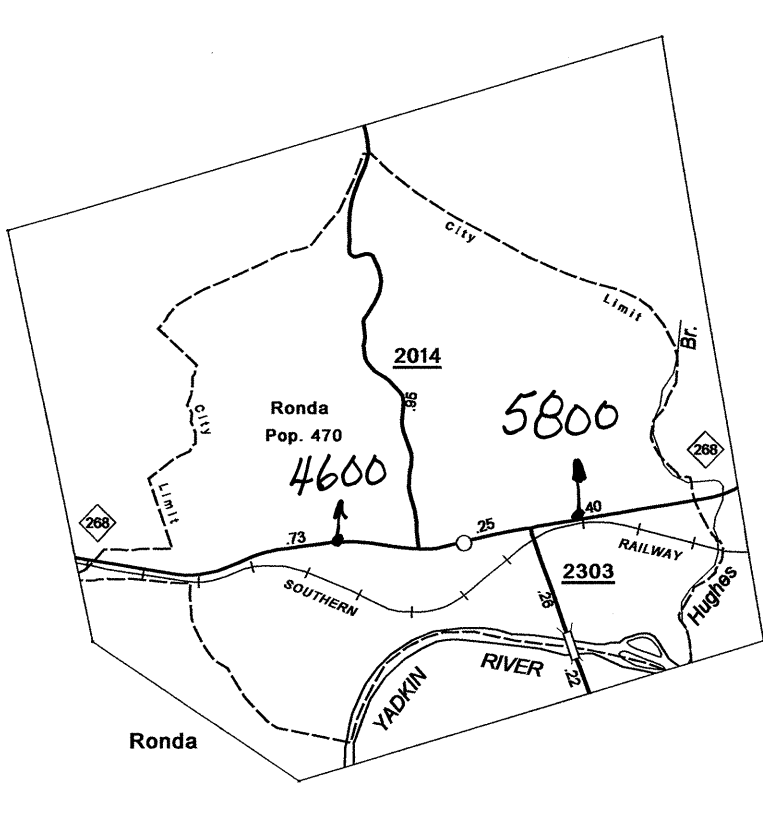
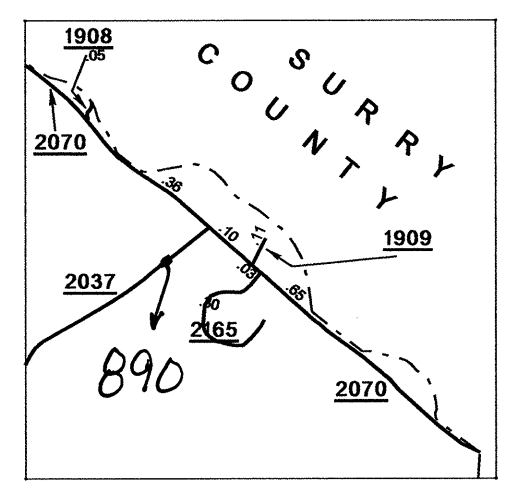
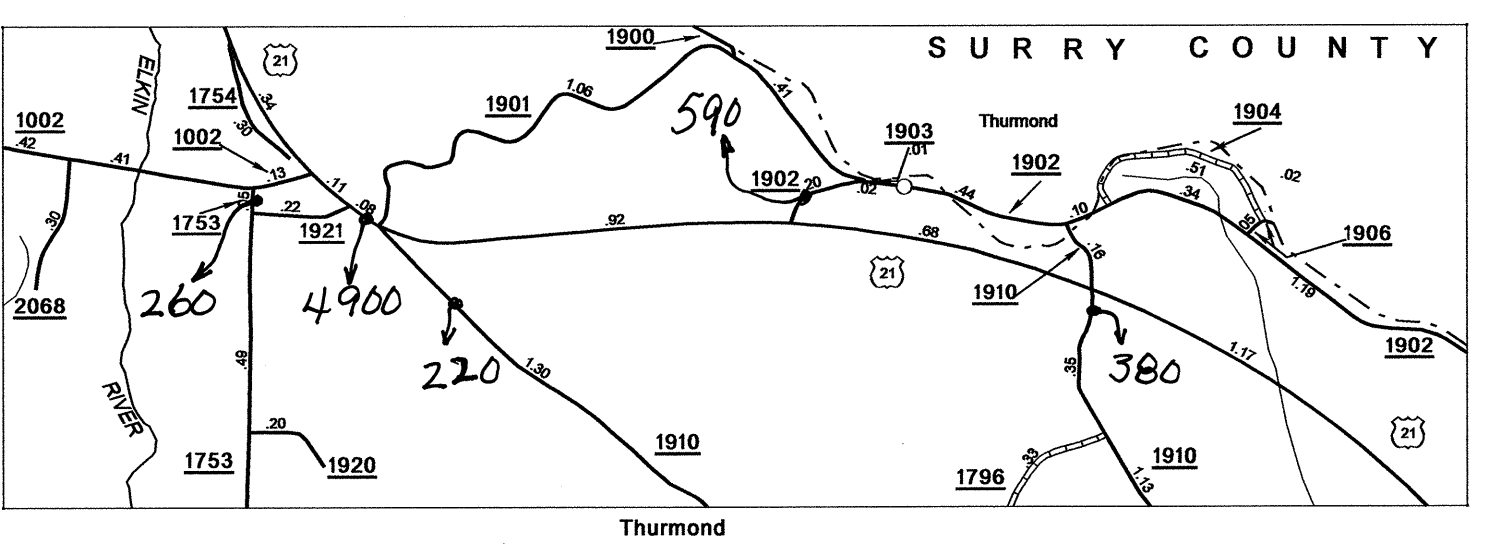
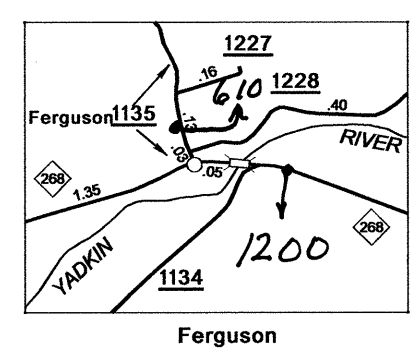
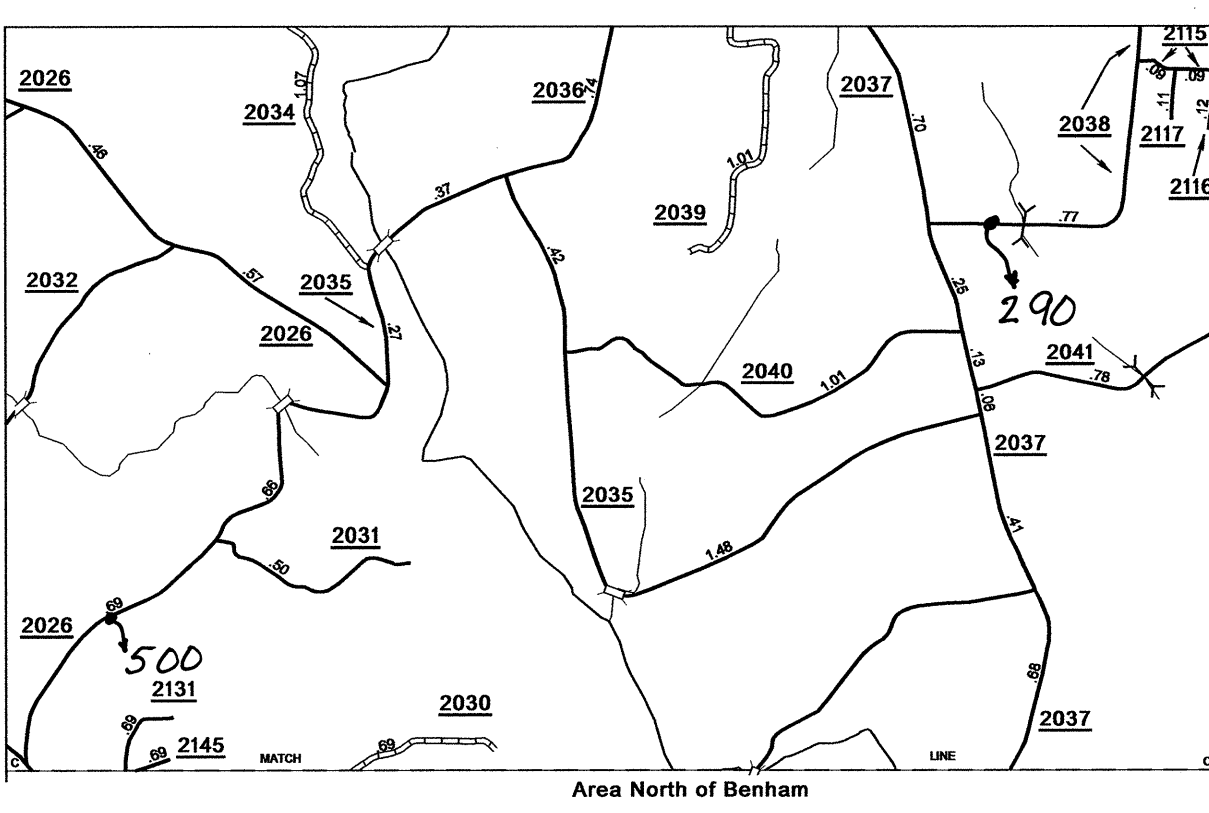
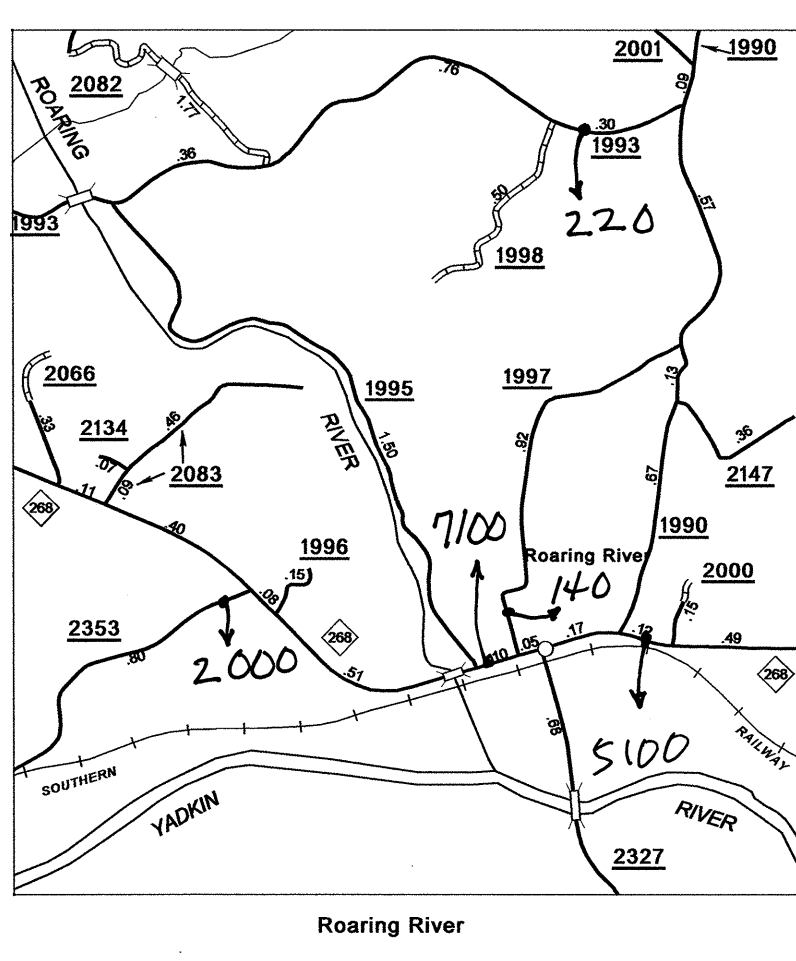
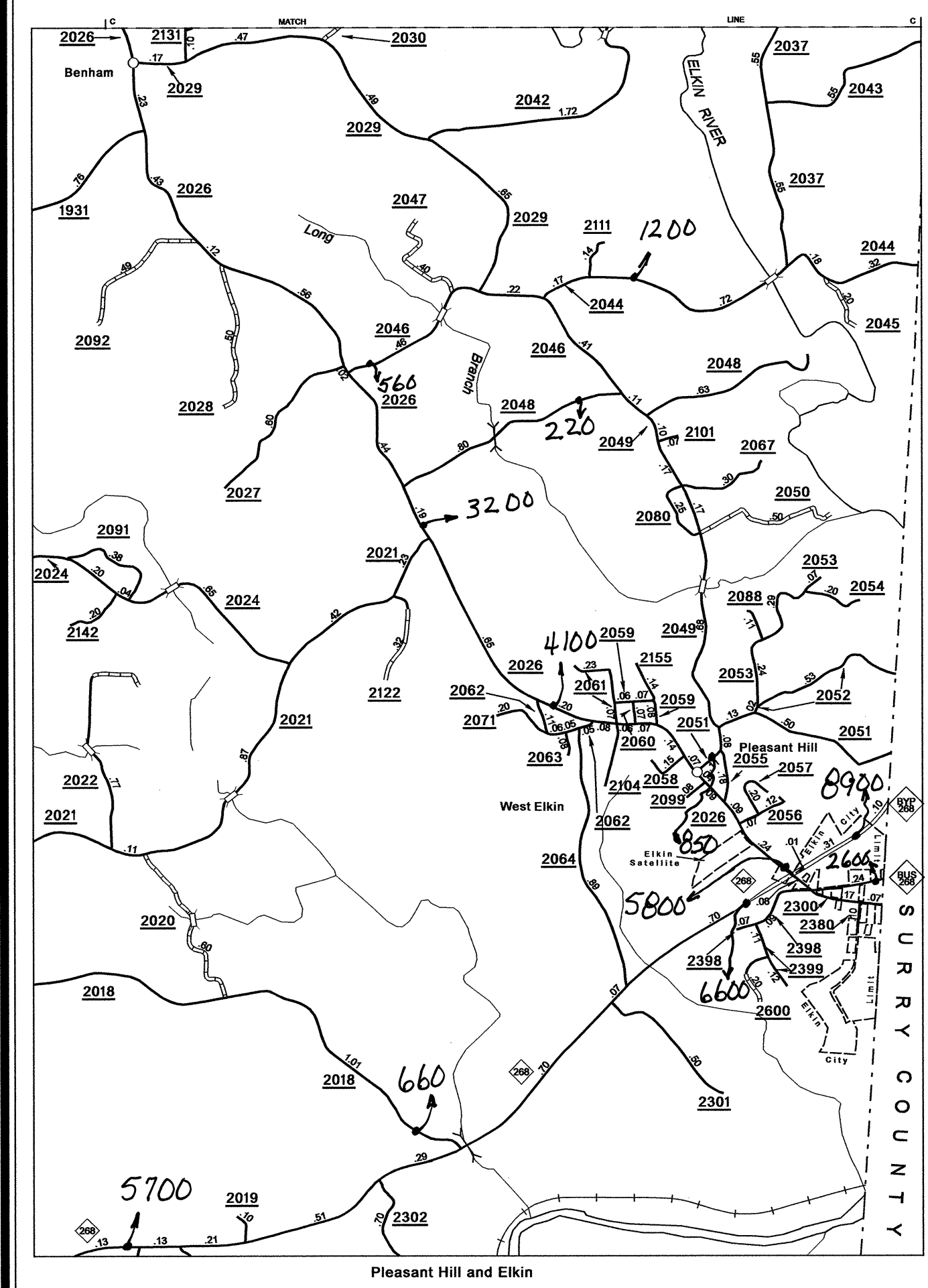

2008 AADT
ANNUAL AVERAGE DAILY TRAFFIC
WILKES COUNTY
NORTH CAROLINA
GENERATED BY THE
TRAFFIC SURVEY GROUP
TRANSPORTATION PLANNING BRANCH
BASE MAPPING PREPARED BY
NORTH CAROLINA DEPARTMENT OF TRANSPORTATION
STATE ROAD MAINTENANCE UNIT
MAPPING & INFORMATION SECTION
IN COOPERATION WITH THE
U.S. DEPARTMENT OF TRANSPORTATION
FEDERAL HIGHWAY ADMINISTRATION
SCALE
0 1 MILE
PROMETHEUS
SHEET 3 OF 3

COPIES OF THIS MAP ARE AVAILABLE
SUPERVISOR OF TRAFFIC SURVEY
ADDRESS: 1547 MAIL SERVICE CENTER
RALEIGH, N.C. 27699-1547
REVISED
11/18/07 BDC
01/10/08 BDC
02/09/08 BDC
12/06/08 BDC
4/20/09 BDC