

Disclaimer: The IMD units goal is to provide the most accurate information as possible, the magnitude of the data prevents any guarantee of accuracy or completeness. If you find any information that is incorrect, please send your request to the IMD Unit.

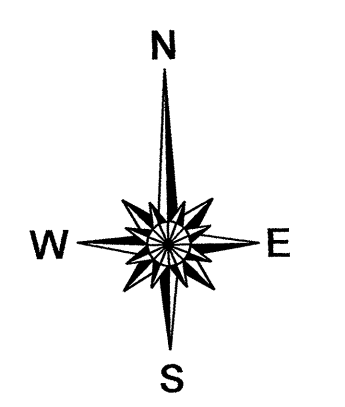

2008 AADT
ANNUAL AVERAGE DAILY TRAFFIC
DUPLIN COUNTY
NORTH CAROLINA

GENERATED BY THE
TRAFFIC SURVEY GROUP
TRANSPORTATION PLANNING BRANCH
BASE MAPPING PREPARED BY
NORTH CAROLINA DEPARTMENT OF TRANSPORTATION
STATE ROAD MAINTENANCE UNIT
MAPPING & INFORMATION SECTION
IN COOPERATION WITH THE
U.S. DEPARTMENT OF TRANSPORTATION
FEDERAL HIGHWAY ADMINISTRATION

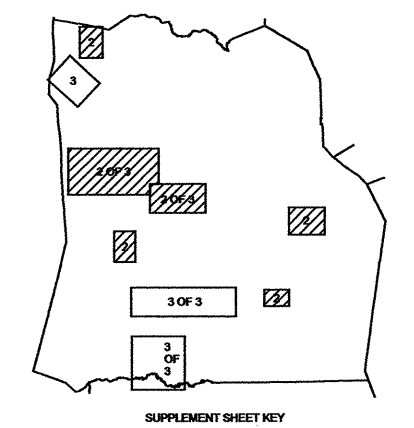
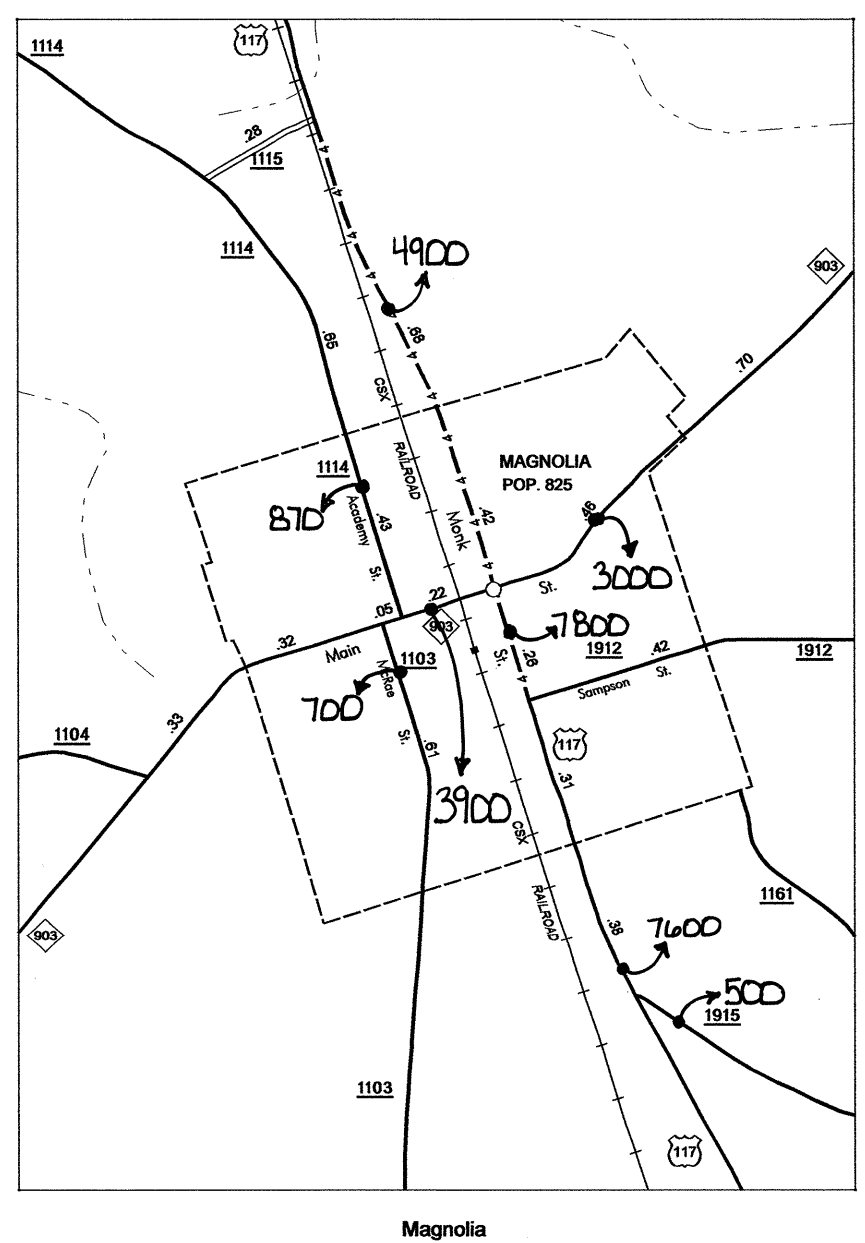
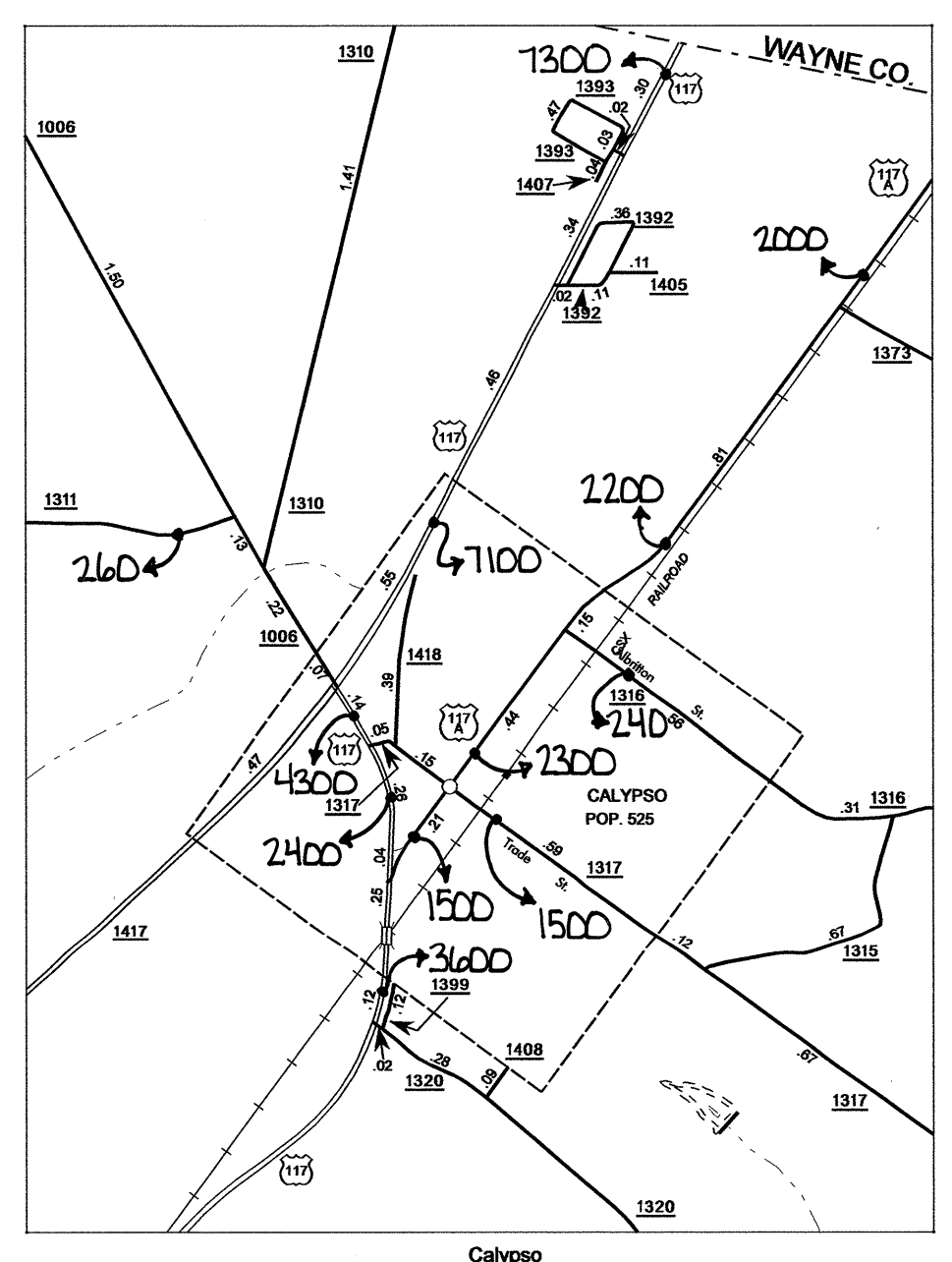
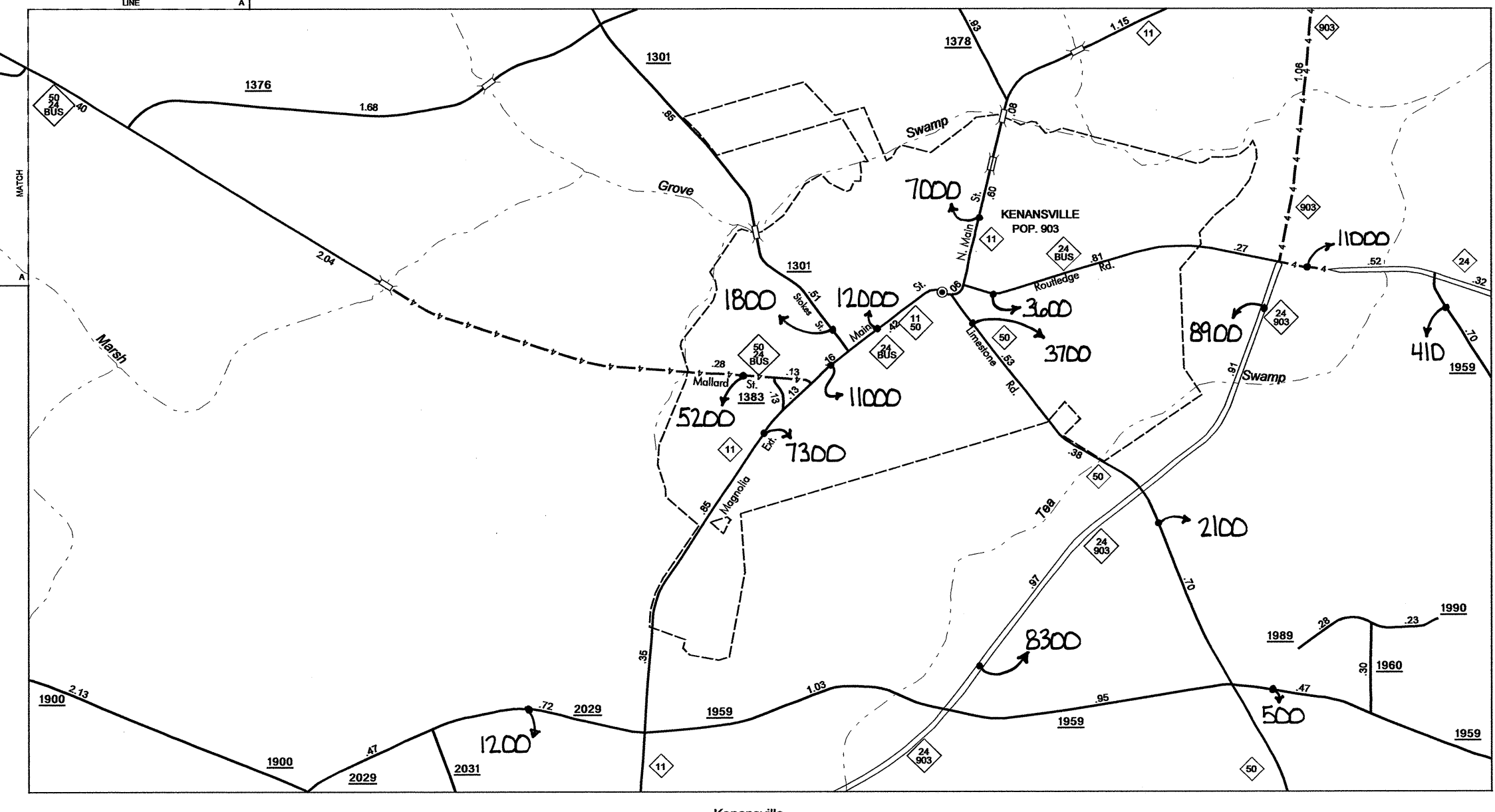
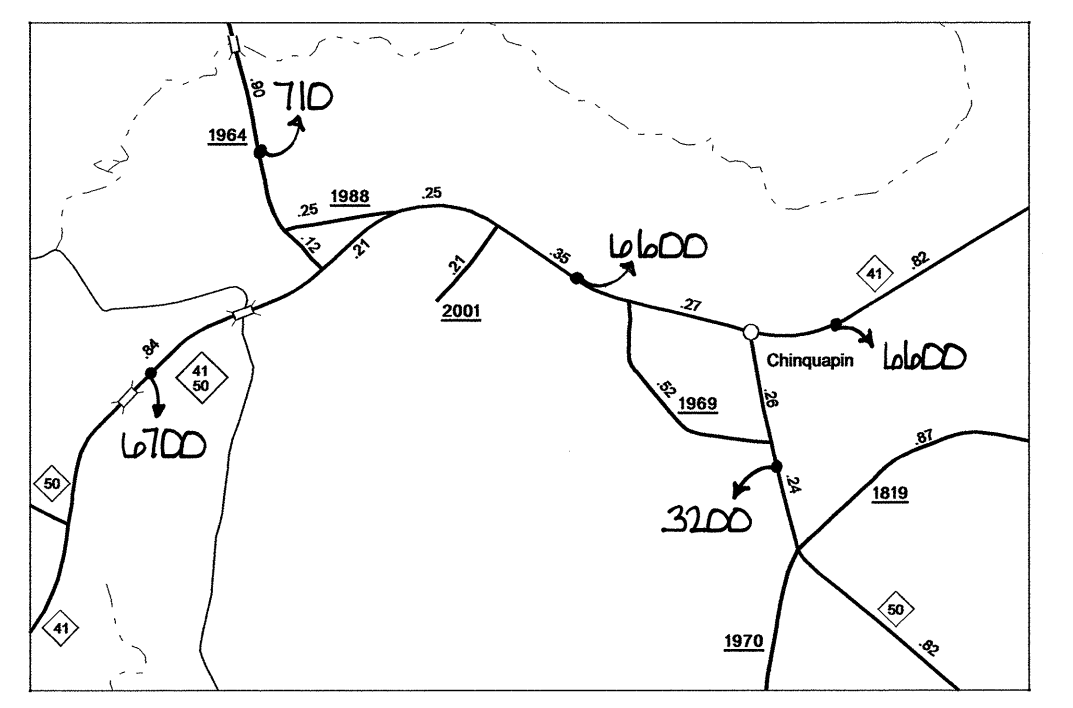
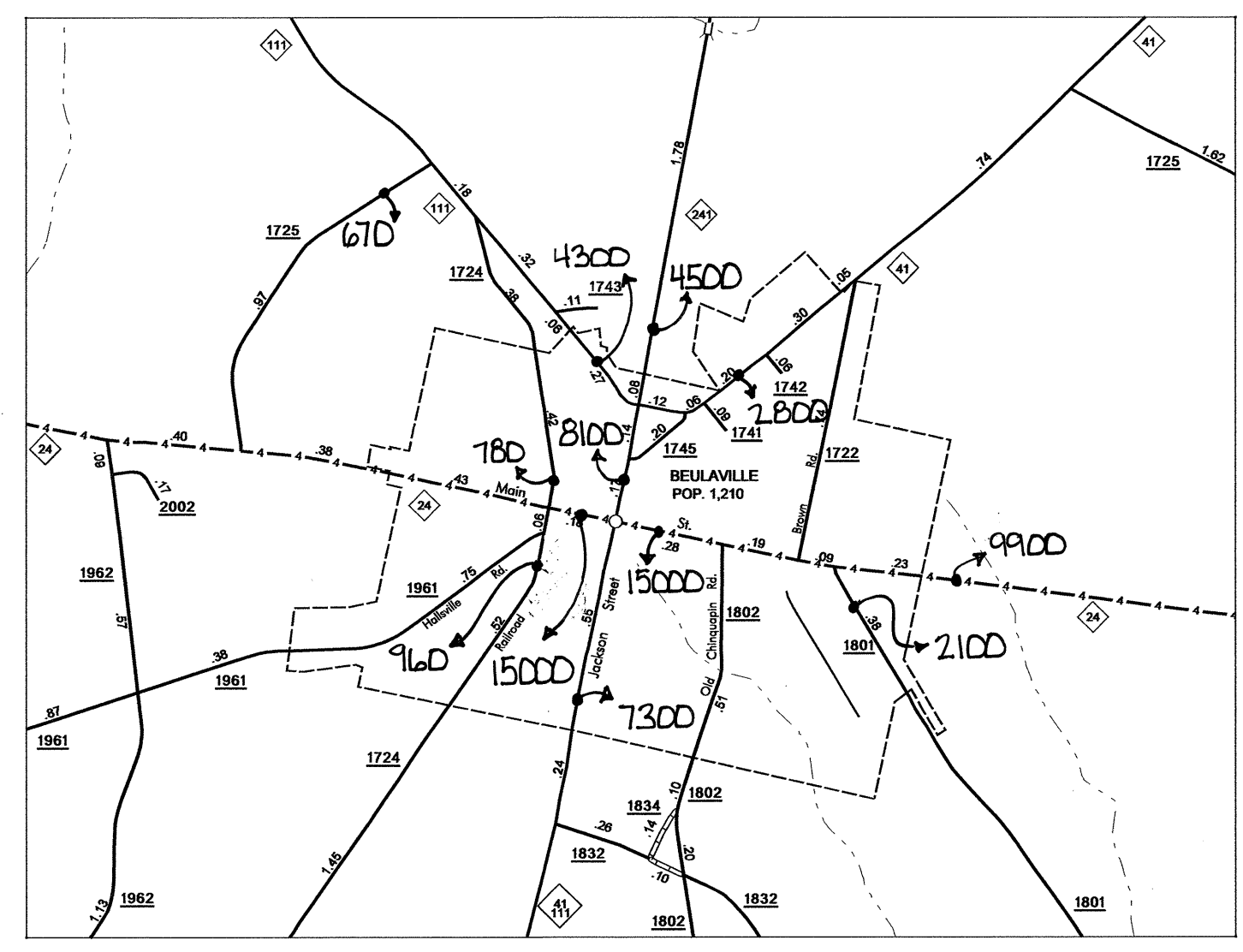
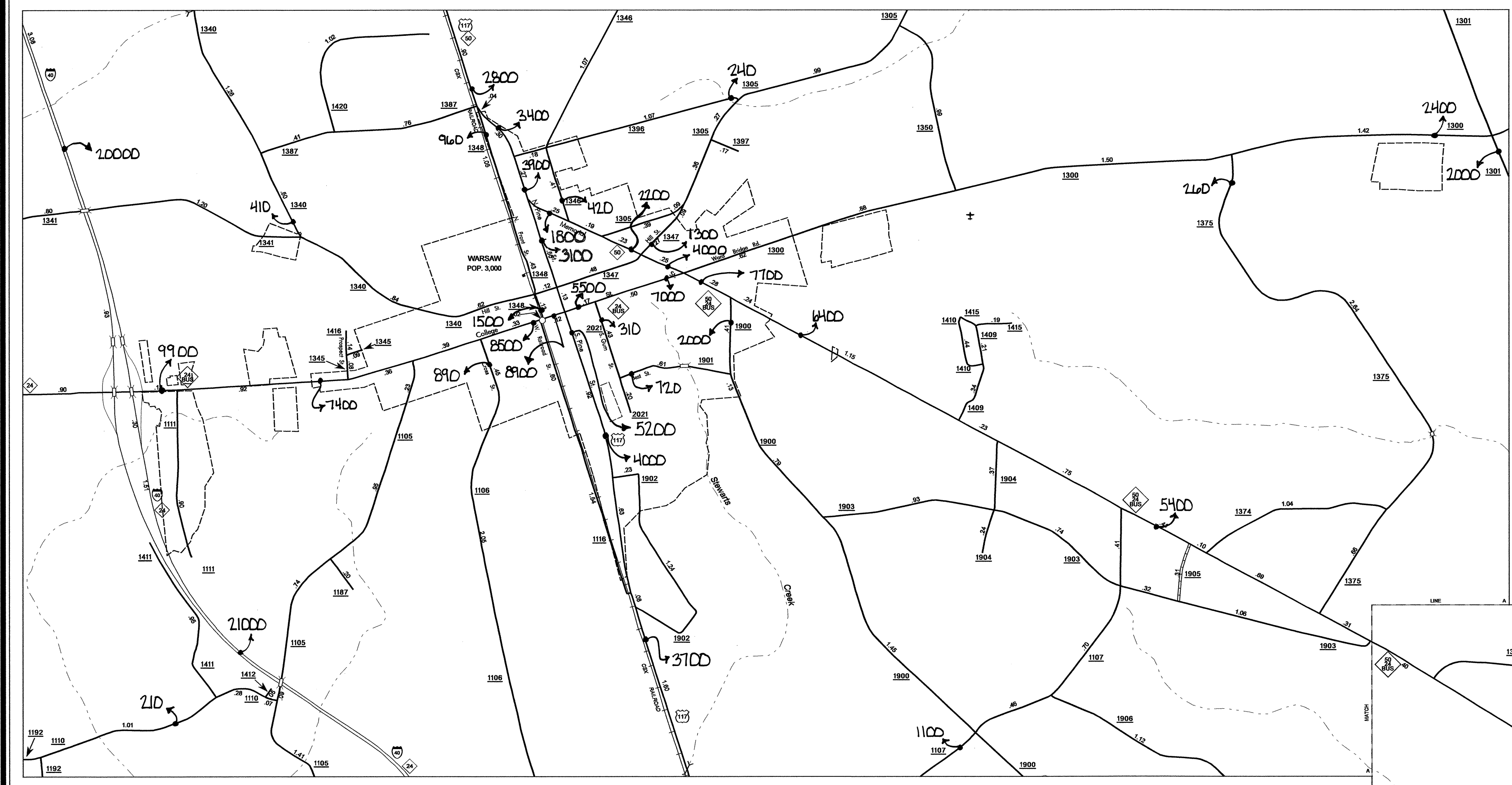
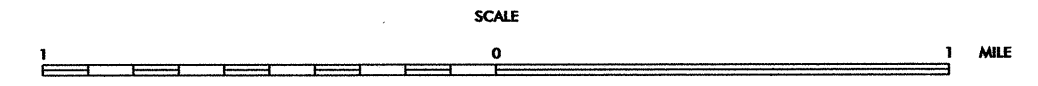
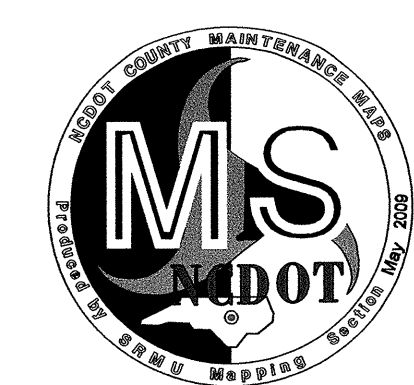

10,000 FOOT GRID BASED ON NORTH CAROLINA PLANE COORDINATE SYSTEM
POLYCONIC PROJECTION

092

COPIES OF THIS MAP ARE AVAILABLE
DUPLIN
SUP-1

REVISED
3/27/02 MEM
7/20/02 MEM
9/26/03 RLN
6/20/04 BCH
7/14/05 BCH
8/20/04 BCH
11/4/05 BCH
3/6/07 BCH
11/20/08 BCH
3/6/07 BCH
9/15/07 BCH
7/27/07 BCH
5/28/08 BCH