

Disclaimer: The IMG Unit's goal is to provide the most accurate information as possible, the magnitude of the data prevents any guarantee of accuracy or completeness. If you find any information that is incorrect, please send your request to the IMG Unit.

COPIES OF THIS MAP ARE AVAILABLE
 FROM THE N.C. DEPARTMENT OF TRANSPORTATION
 INFORMATION, IMPROVEMENT, AND OPERATIONS
 DIVISION
 1117 SOUTH TRYON STREET
 RALEIGH, N.C. 27619

REVISED	DATE	BY
81800	8/10/07	MEH
81801	8/10/07	BCH
81802	8/10/07	BCH
81803	8/10/07	BCH
81804	8/10/07	BCH
81805	8/10/07	BCH
81806	8/10/07	BCH
81807	8/10/07	BCH
81808	8/10/07	BCH
81809	8/10/07	BCH
81810	8/10/07	BCH
81811	8/10/07	BCH
81812	8/10/07	BCH

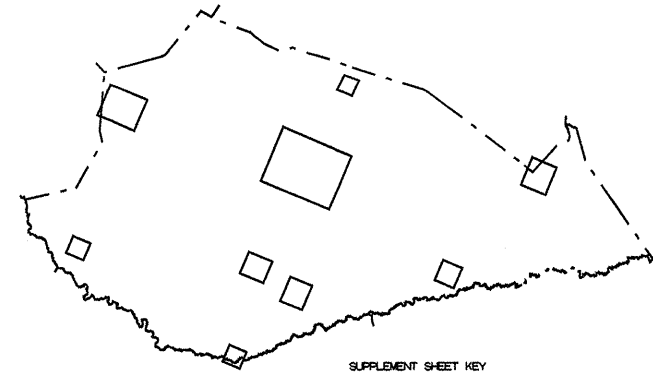
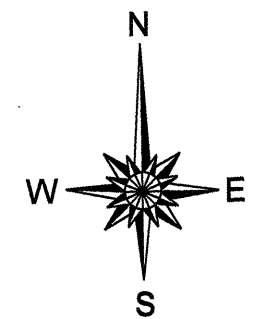
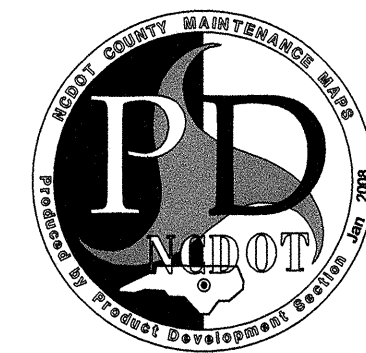
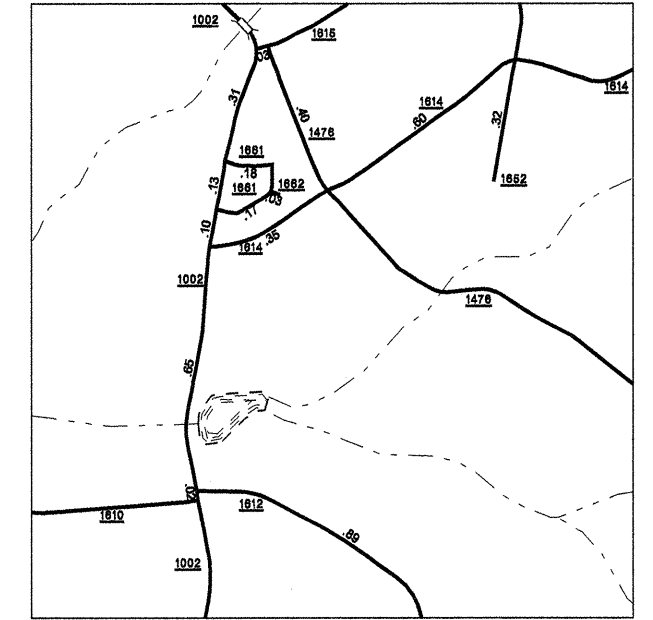
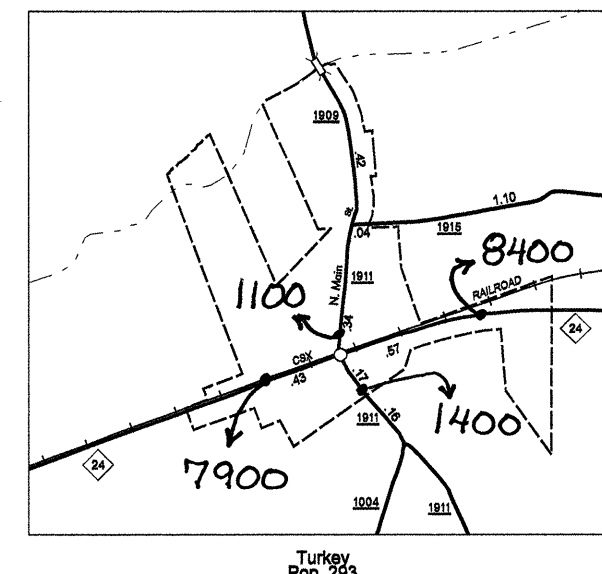
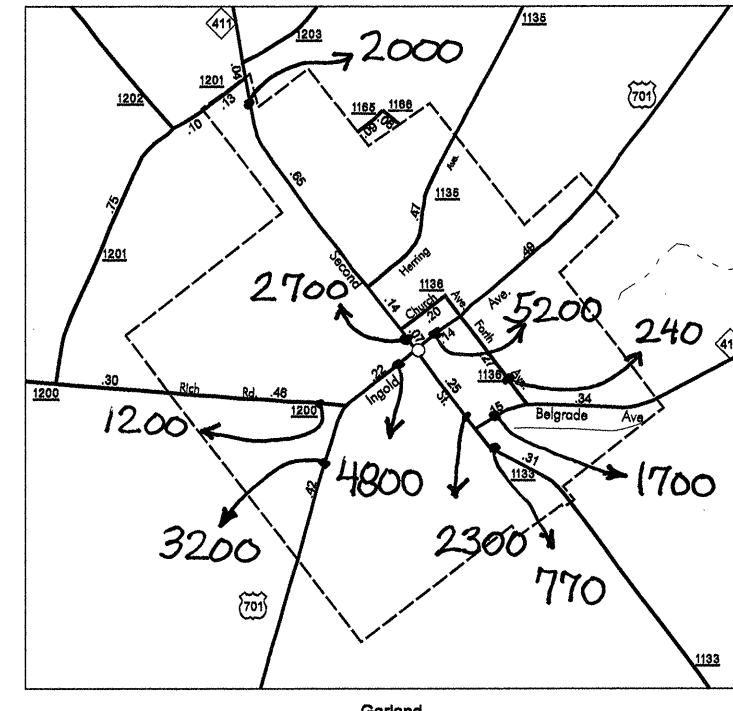
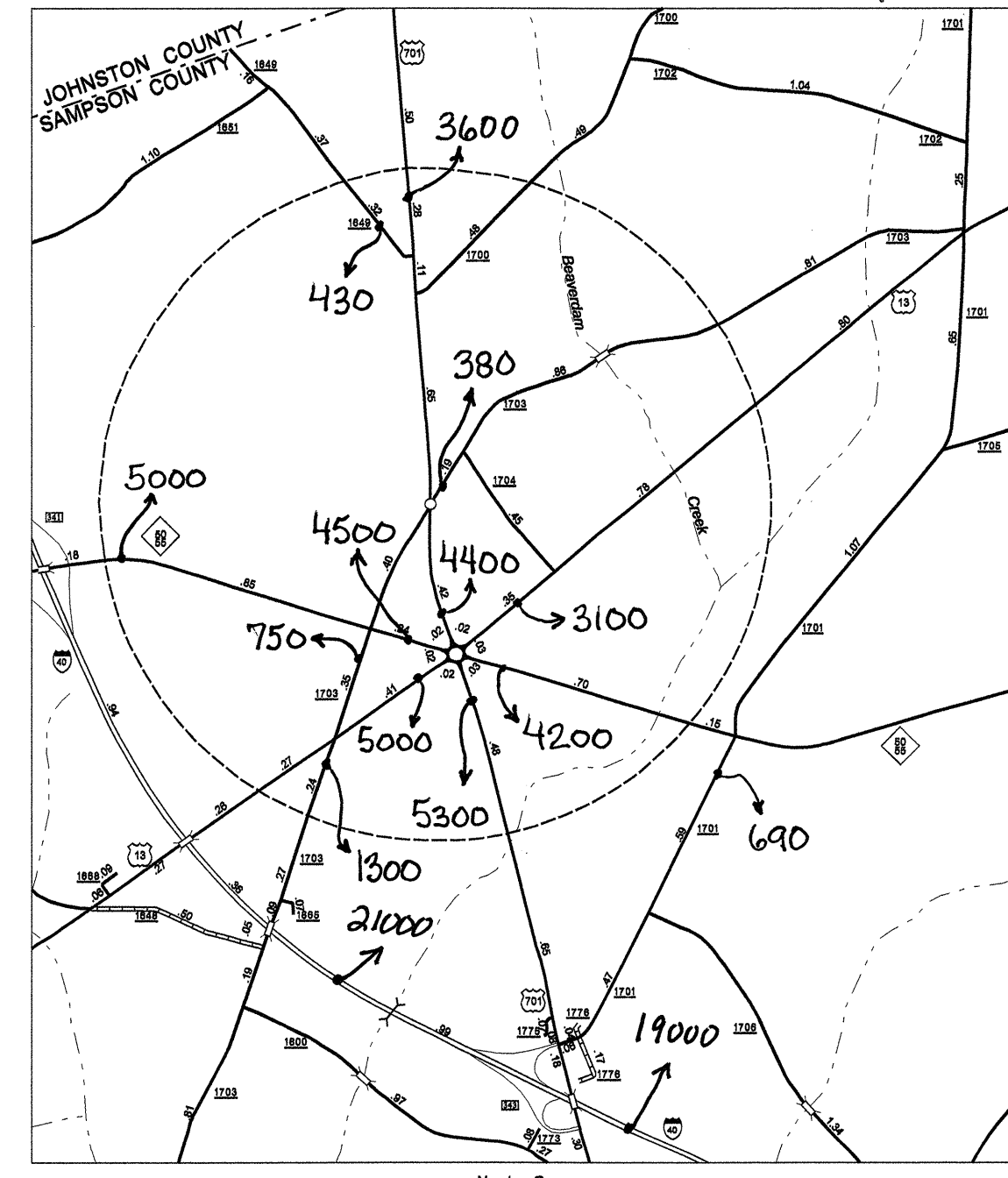
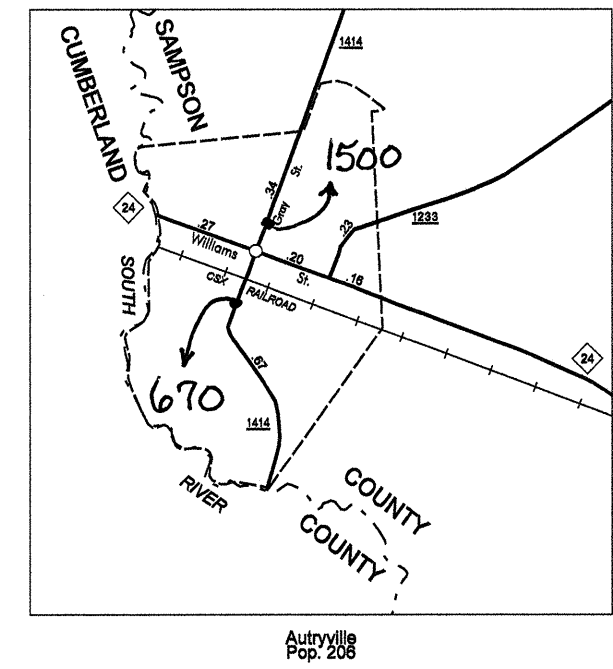
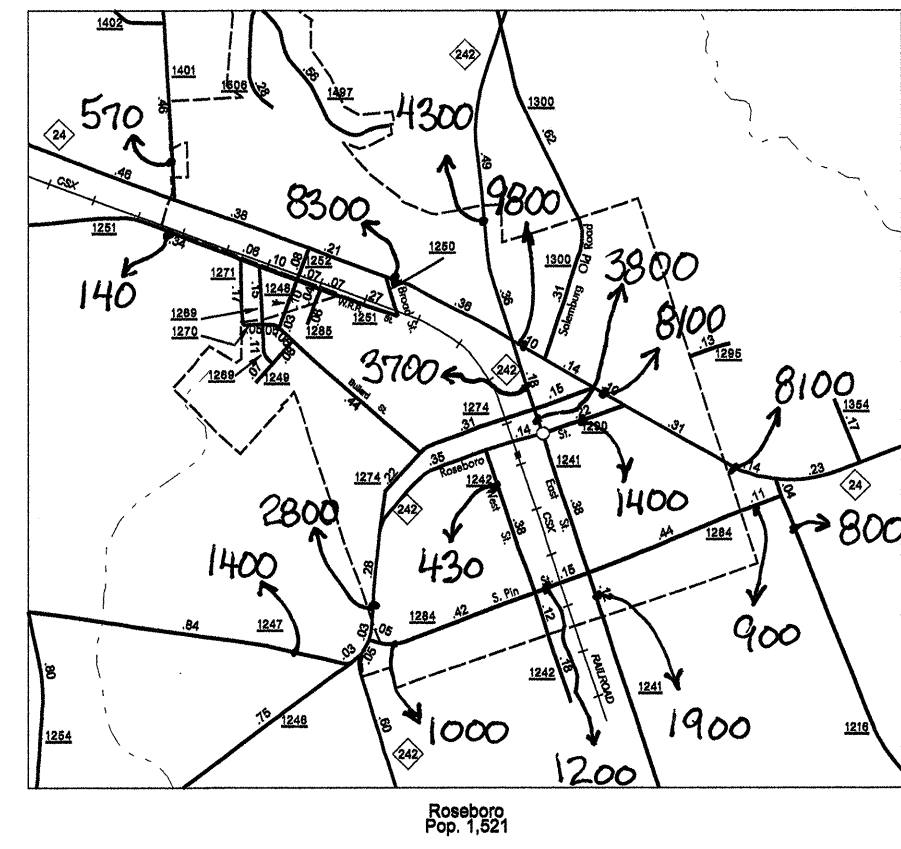
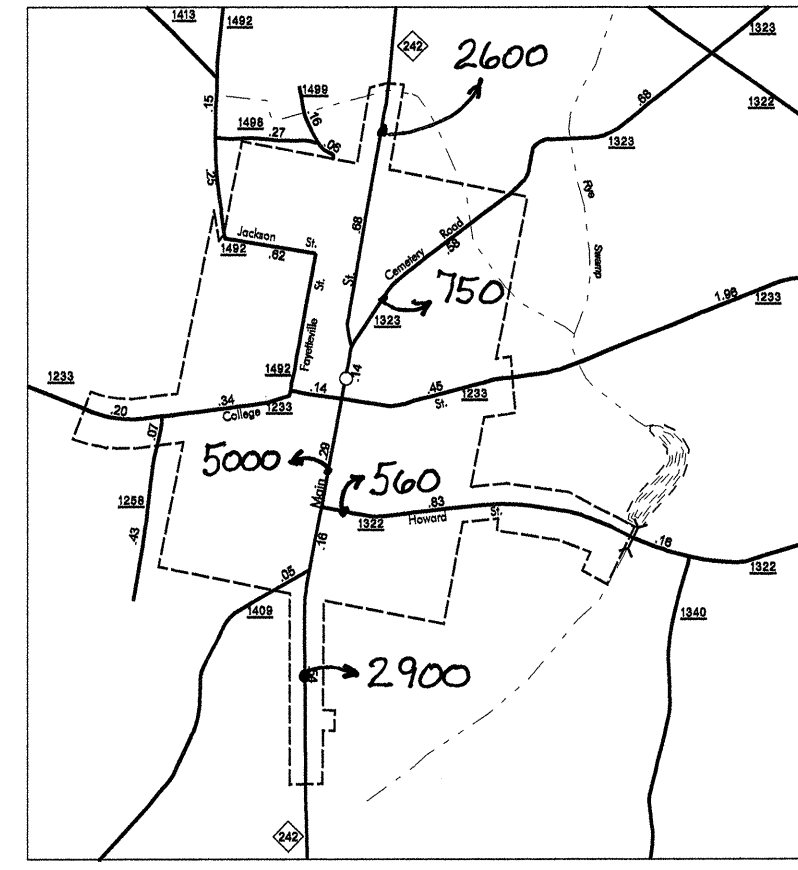
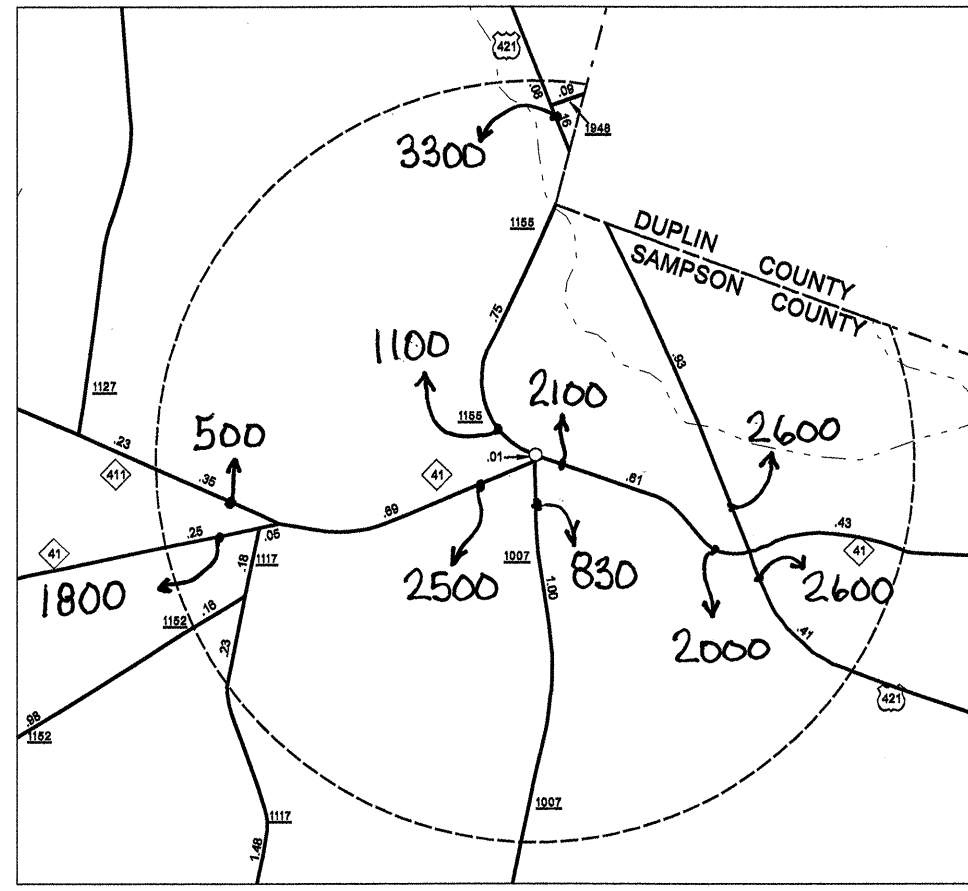
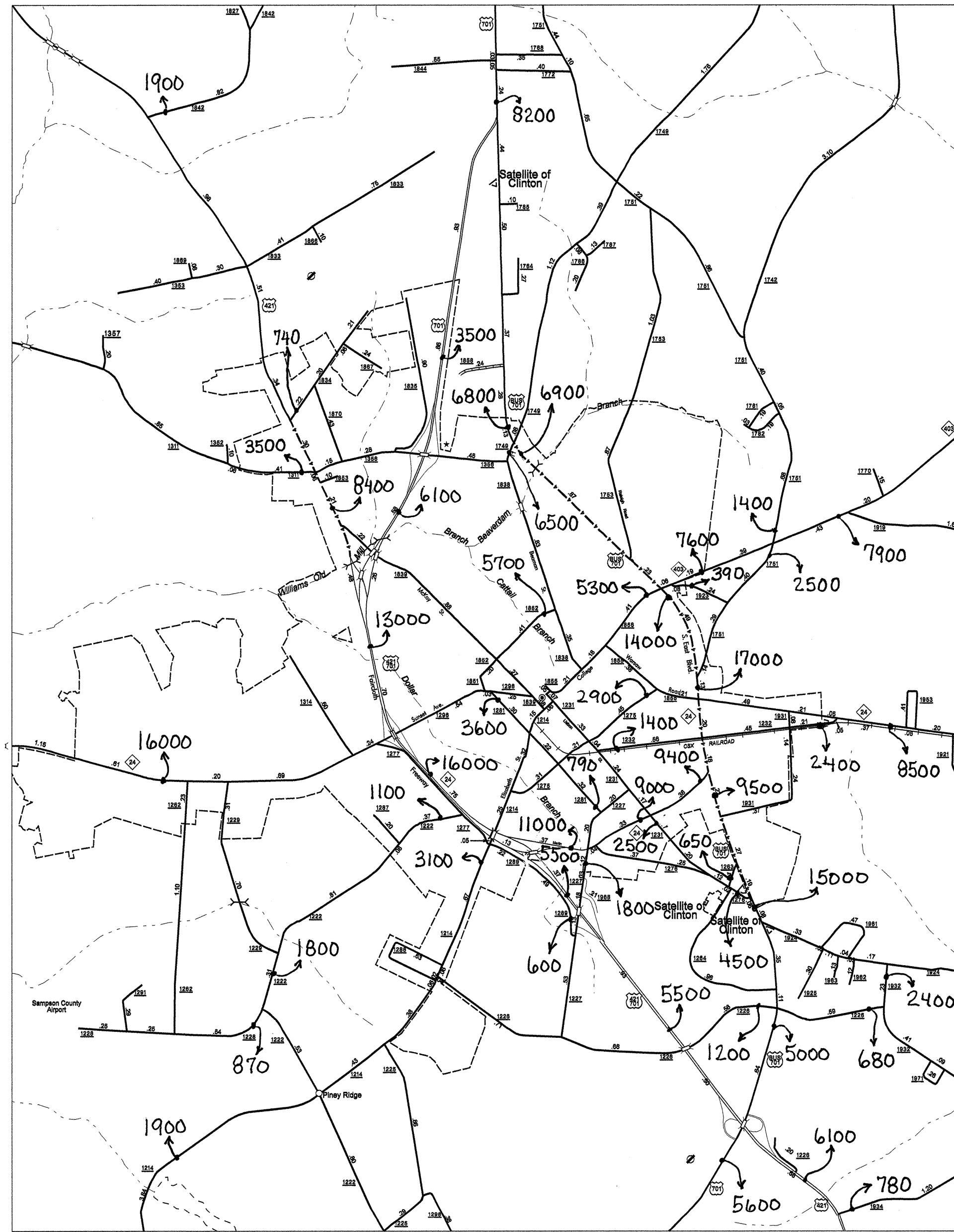

ENLARGED MUNICIPAL AND SUBURBAN AREAS
2007 AADT
 ANNUAL AVERAGE DAILY TRAFFIC
SAMPSON COUNTY
 NORTH CAROLINA
 GENERATED BY THE
TRAFFIC SURVEY GROUP
 TRANSPORTATION PLANNING BRANCH
 PREPARED BY THE
 NORTH CAROLINA DEPARTMENT OF TRANSPORTATION
 INFORMATION TECHNOLOGY - IMG UNIT
 IN COOPERATION WITH THE
 U.S. DEPARTMENT OF TRANSPORTATION
 FEDERAL HIGHWAY ADMINISTRATION

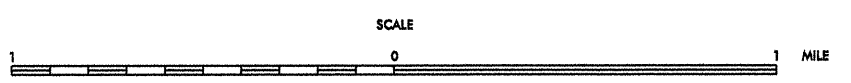

10,000 FOOT GRID BASED ON NORTH CAROLINA PLANE COORDINATE SYSTEM
 POLYCONIC PROJECTION