

Disclaimer: The IMG Unit's goal is to provide the most accurate information as possible, the magnitude of the data prevents any guarantee of accuracy or completeness. If you find any information that is incorrect, please send your request to the IMG Unit.

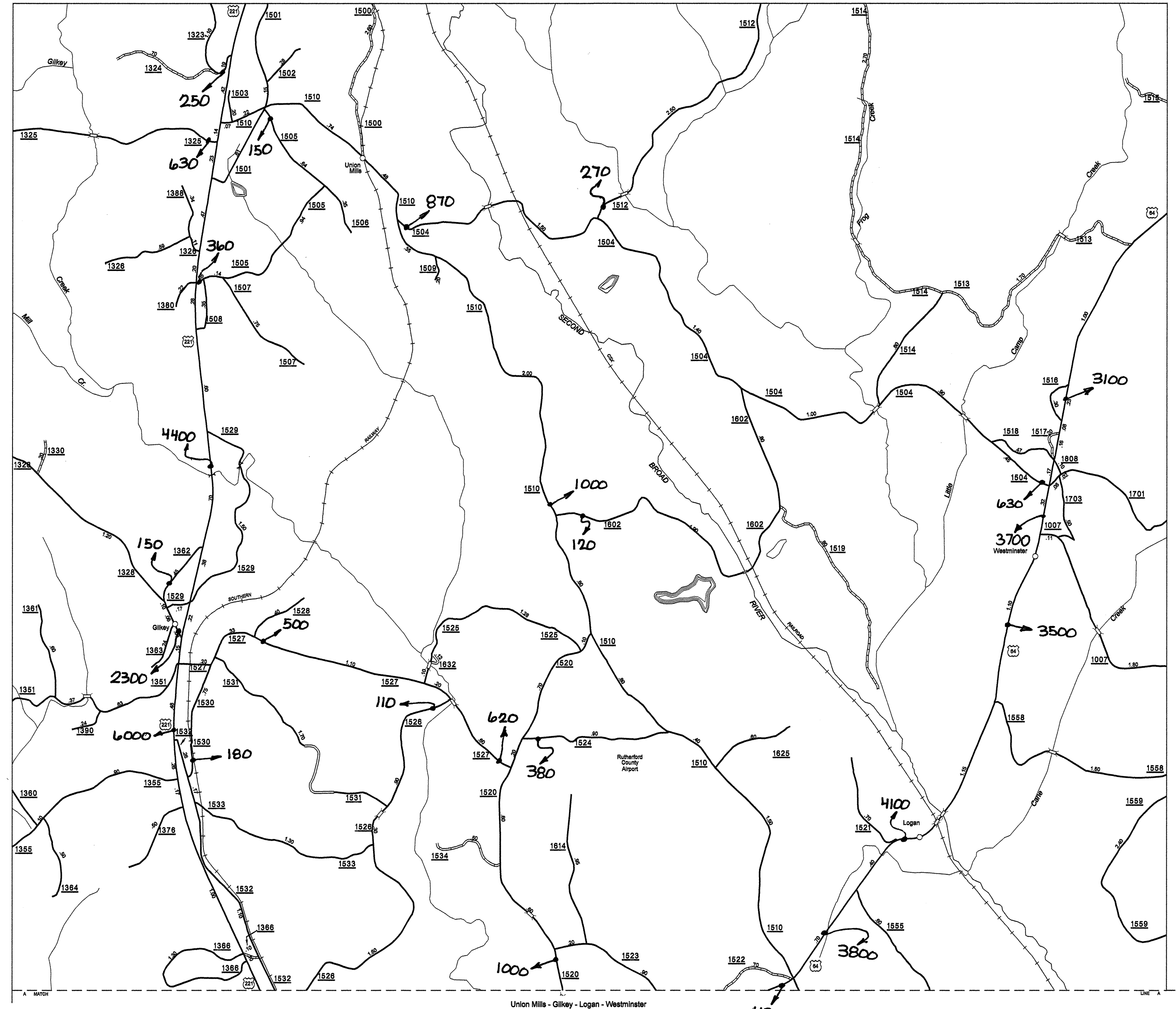

COPIES OF THIS MAP ARE AVAILABLE AT THE FOLLOWING ADDRESS:
 N.C. DEPARTMENT OF TRANSPORTATION
 INFORMATION, MAPPING, AND GRAPHICS UNIT
 1117 EAST 7TH STREET
 RALEIGH, N.C. 27601

REVISED	BY
4/12/01	BOB
6/29/01	BOB
7/18/01	BOB
8/23/02	BOB
7/22/02	BOB
3/28/03	LM
6/10/04	LM
6/30/05	LM
12/05/05	LM
8/22/06	MRC
11/29/06	MRC
01/03/07	MRC
8/23/07	MRC

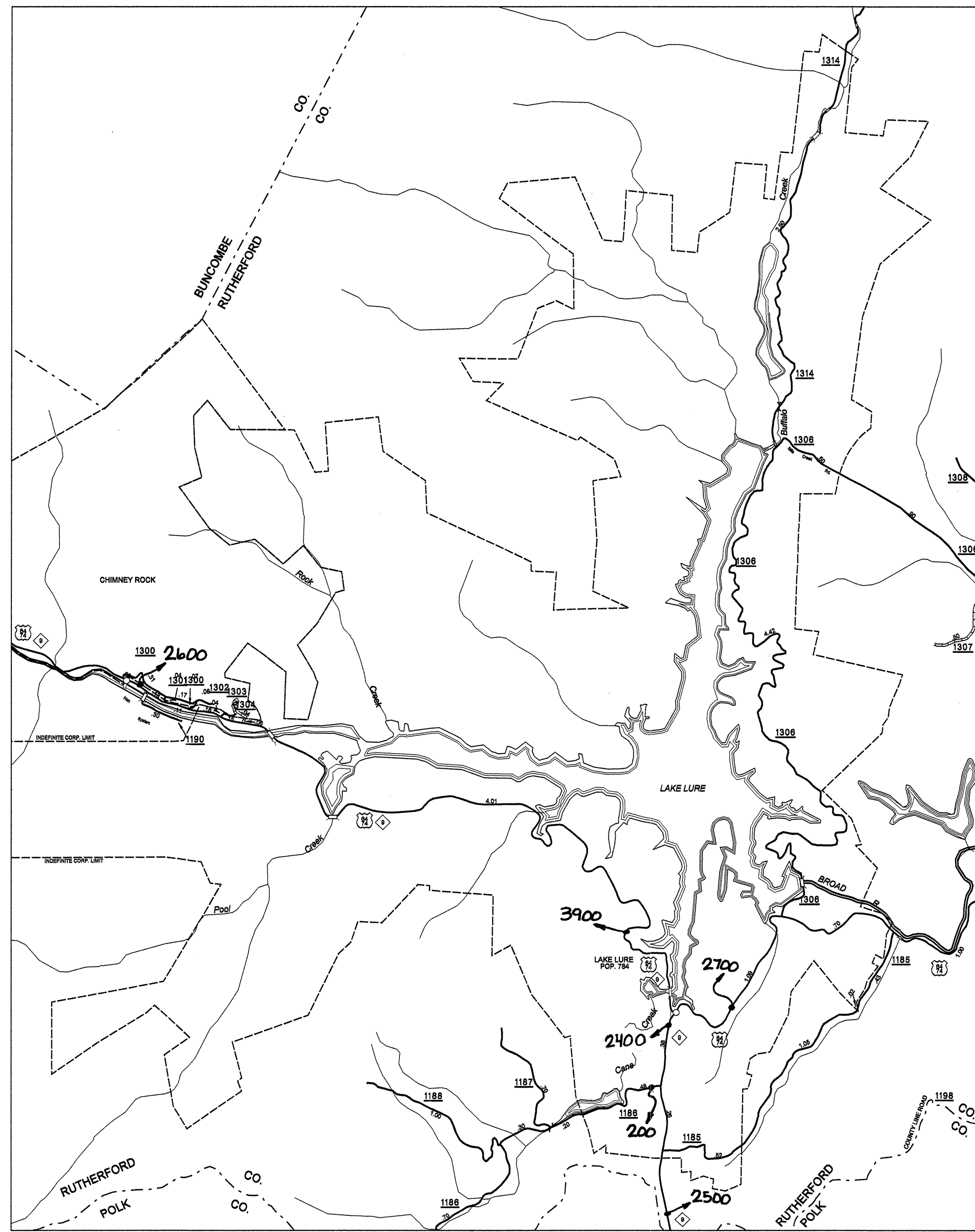
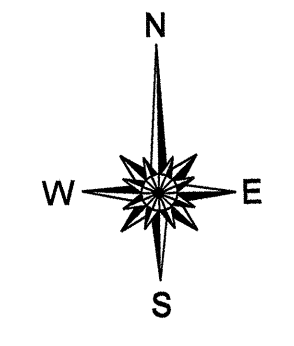
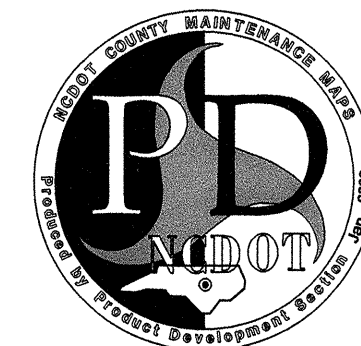

ENLARGED MUNICIPAL AND SUBURBAN AREAS
2007 AADT
 ANNUAL AVERAGE DAILY TRAFFIC
RUTHERFORD COUNTY
 NORTH CAROLINA
 GENERATED BY THE
TRAFFIC SURVEY GROUP
 TRANSPORTATION PLANNING BRANCH
 PREPARED BY THE
 NORTH CAROLINA DEPARTMENT OF TRANSPORTATION
 INFORMATION TECHNOLOGY - IMG UNIT
 IN COOPERATION WITH THE
 U.S. DEPARTMENT OF TRANSPORTATION
 FEDERAL HIGHWAY ADMINISTRATION

