

Disclaimer: The GIS Unit's goal is to provide the most accurate information as possible, the magnitude of the data prevents any guarantee of accuracy or completeness. If you find any information that is incorrect, please send your request to the GIS Unit.

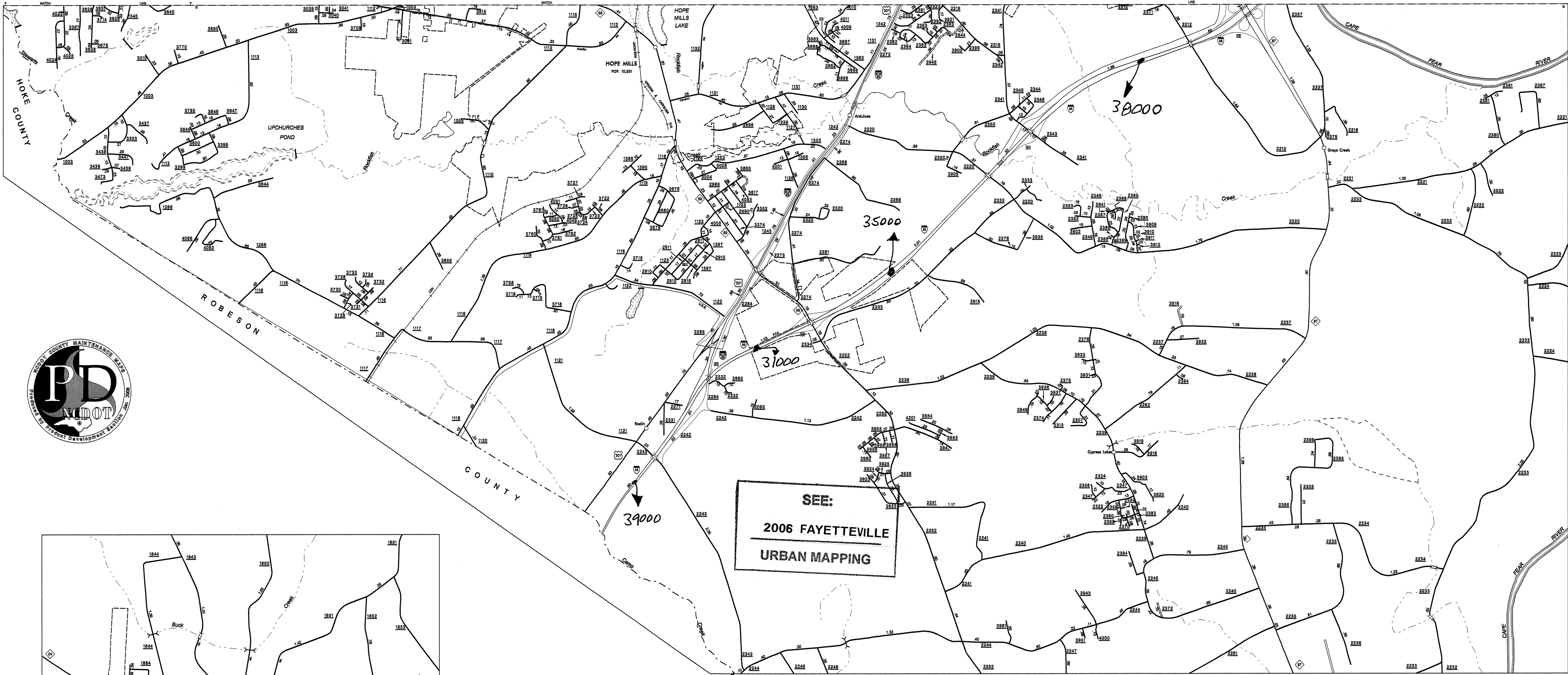

SEE:
2006 FAYETTEVILLE
URBAN MAPPING

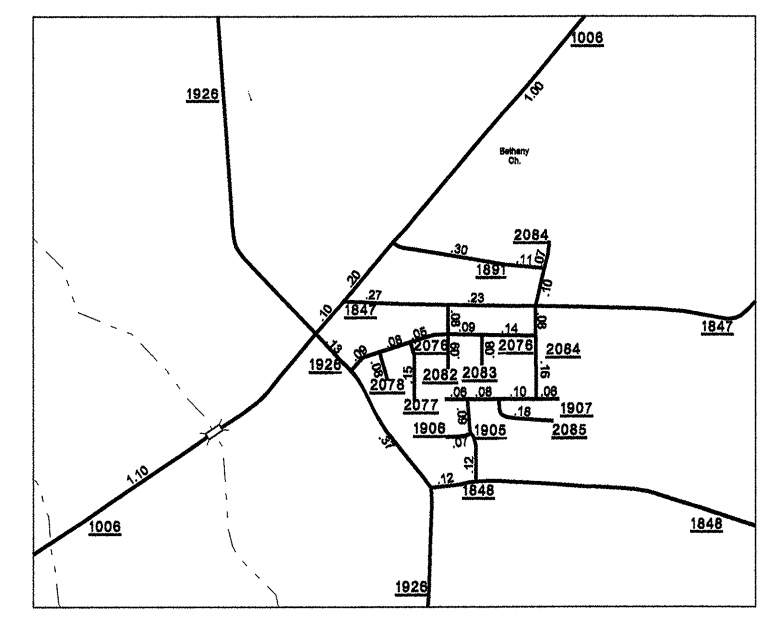
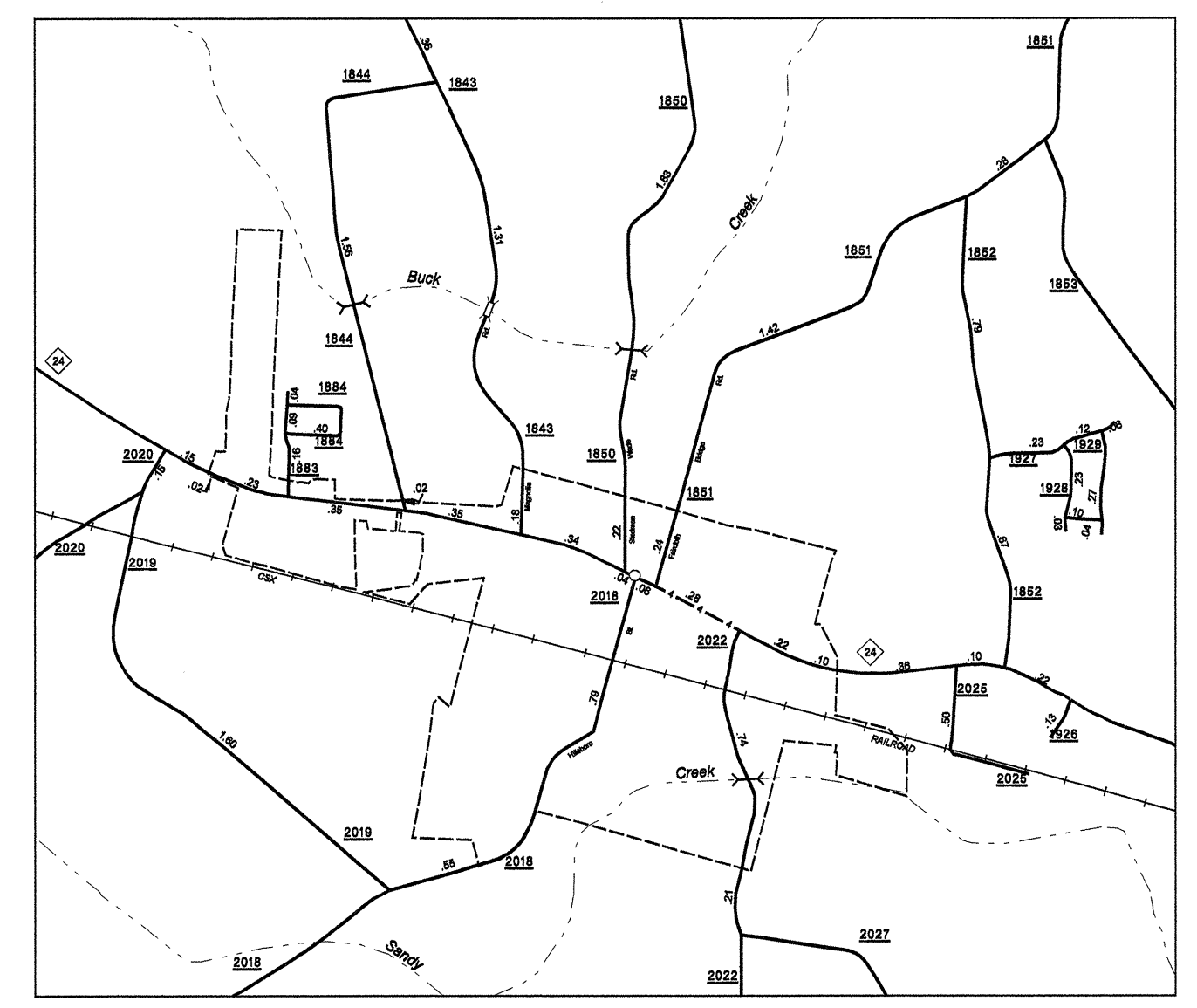

Hope Mills and Vicinity

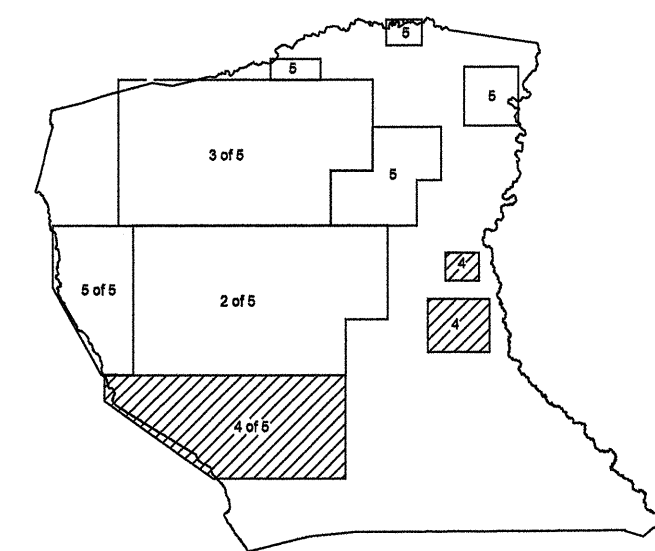

SUPPLEMENT KEY

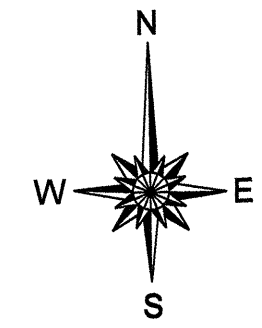

ENLARGED MUNICIPAL AND SUBURBAN AREAS
2007 AADT
 ANNUAL AVERAGE DAILY TRAFFIC
CUMBERLAND COUNTY
 NORTH CAROLINA
 GENERATED BY THE
TRAFFIC SURVEY GROUP
 TRANSPORTATION PLANNING BRANCH
 PREPARED BY THE
 NORTH CAROLINA DEPARTMENT OF TRANSPORTATION
 INFORMATION TECHNOLOGY - IMG UNIT
 IN COOPERATION WITH THE
 U.S. DEPARTMENT OF TRANSPORTATION
 FEDERAL HIGHWAY ADMINISTRATION
 SCALE
 0 1 2 MILES

074

CUMBERLAND COUNTY
 DIVISION 1
 SHEET 4 OF 6

REVISED	6/2006 MAG
8/2006 MFG	8/2006 MFG
8/2006 MFG	8/2006 MFG
8/2006 MFG	8/2006 MFG
8/2006 MFG	8/2006 MFG
8/2006 MFG	8/2006 MFG
8/2006 MFG	8/2006 MFG
8/2006 MFG	8/2006 MFG
8/2006 MFG	8/2006 MFG
8/2006 MFG	8/2006 MFG
8/2006 MFG	8/2006 MFG
8/2006 MFG	8/2006 MFG