

Disclaimer: The GIS Unit's goal is to provide the most accurate information as possible, the magnitude of the data prevents any guarantee of accuracy or completeness. If you find any information that is incorrect, please send your request to the GIS Unit.

COPIES OF THIS MAP ARE AVAILABLE  
 FROM THE N.C. DEPARTMENT OF TRANSPORTATION  
 INFORMATION, MAPPING, AND GRAPHICS  
 DIVISION  
 100 SOUTH TRYON STREET  
 RALEIGH, N.C. 27615

REVISED
12/20/06 PLAN
12/20/06 MISC
01/03/07 AIB
10/24/08 AIB
05/07/09 AIB
01/11/07 AIB
10/28/08 AIB

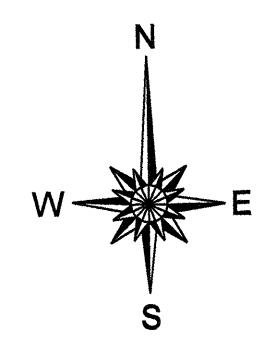
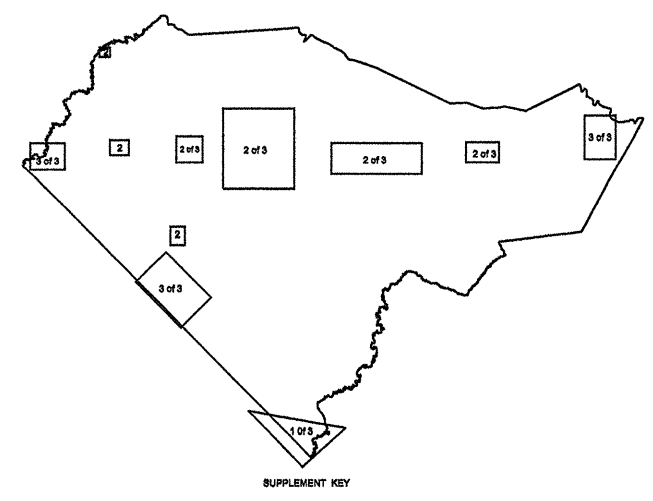
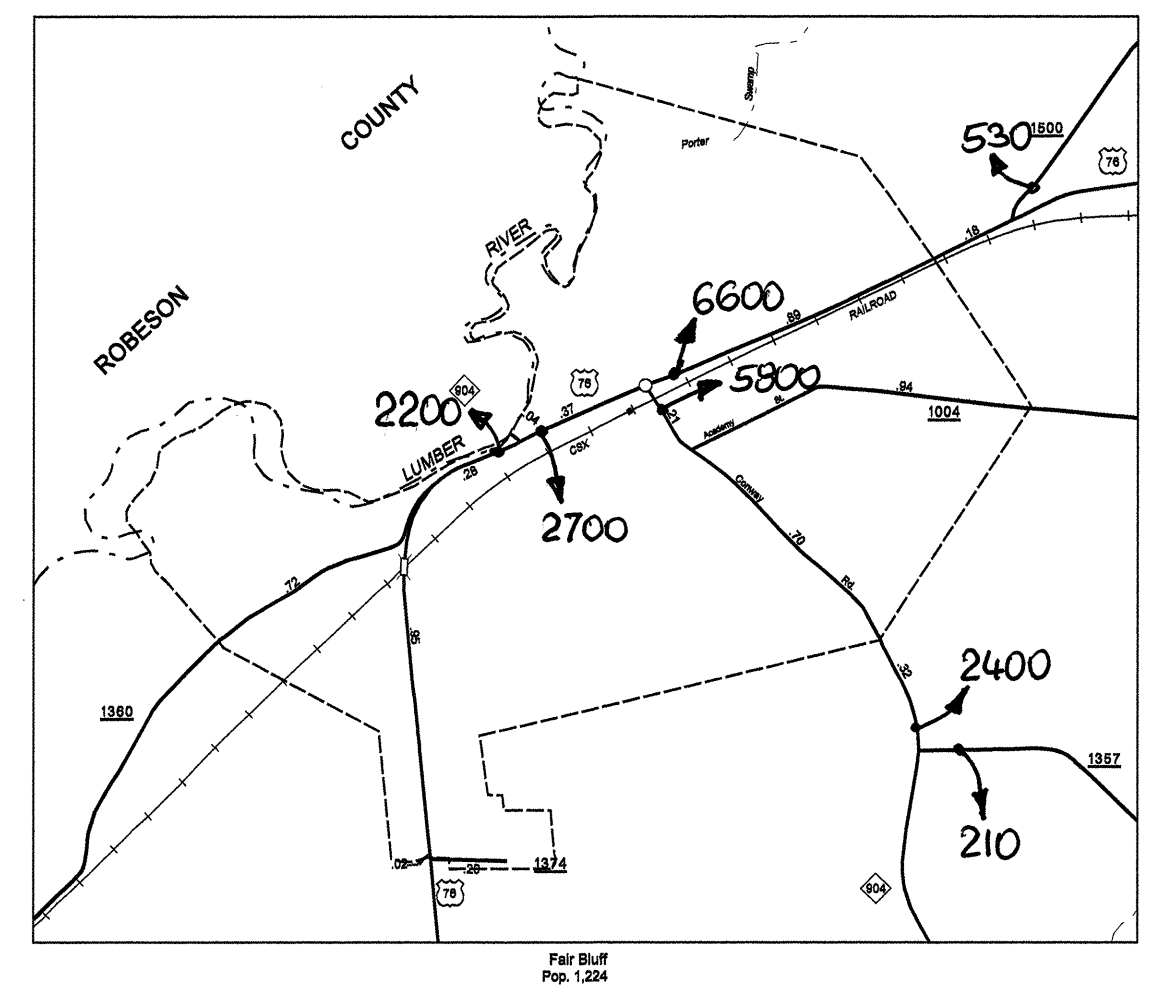
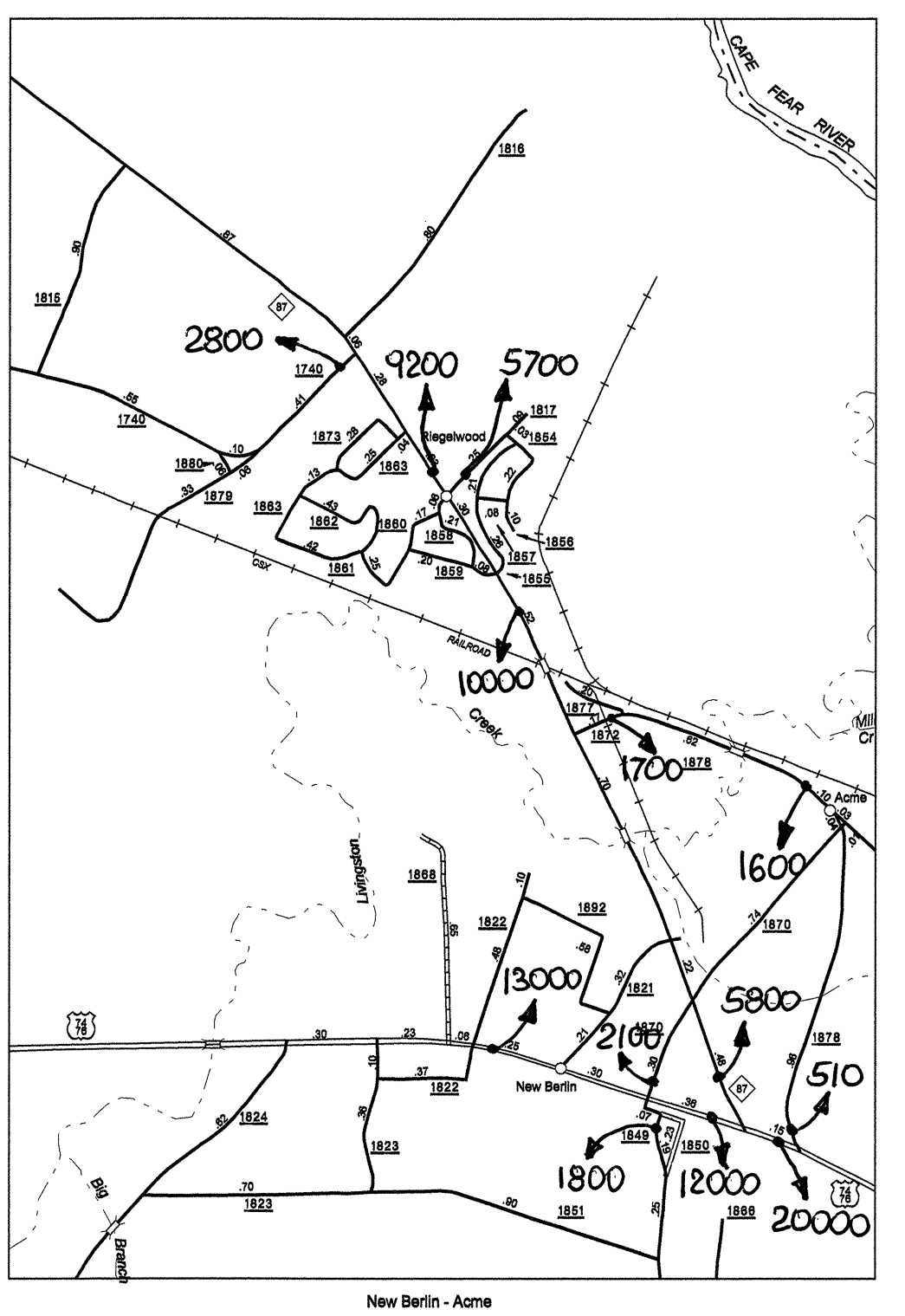
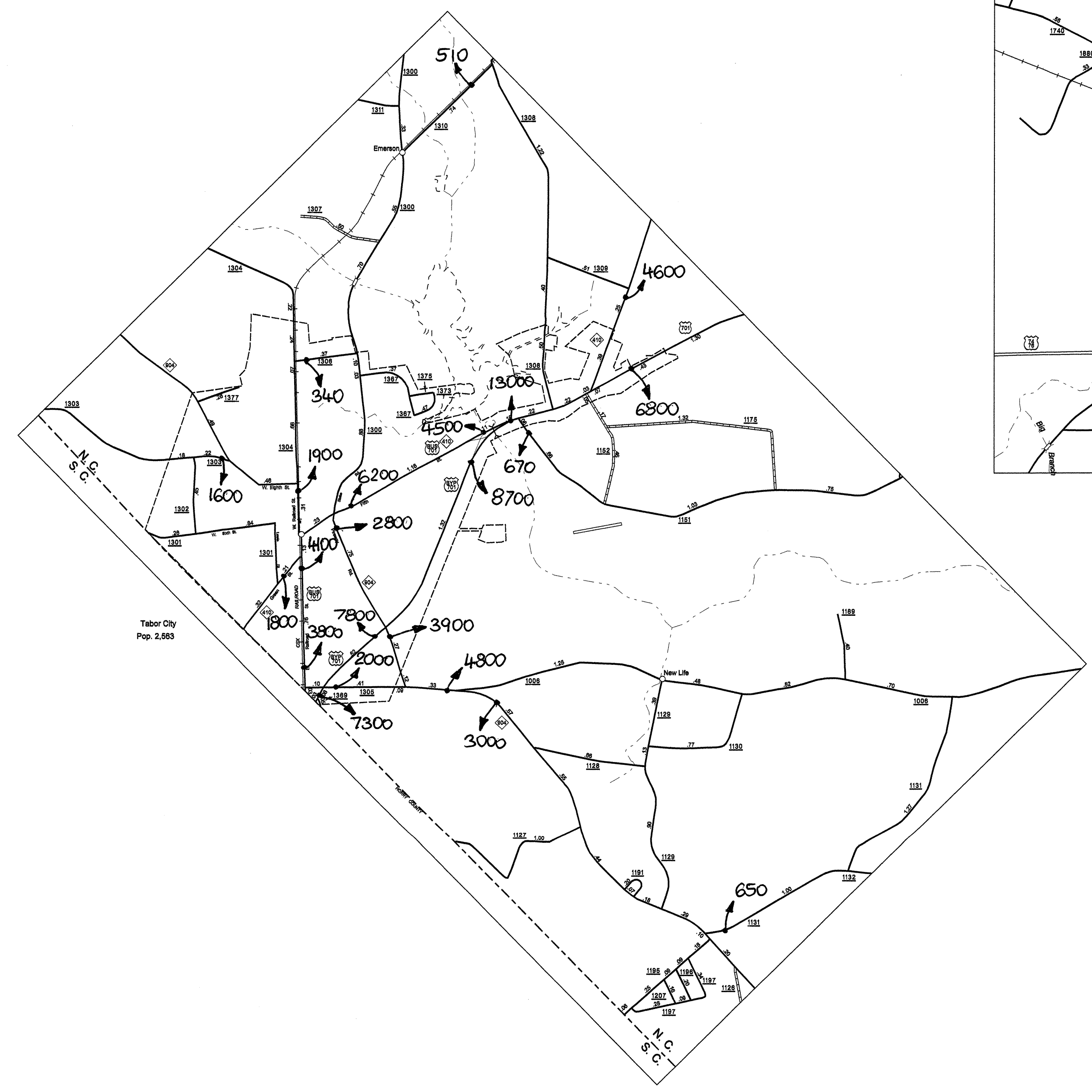

ENLARGED MUNICIPAL AND SUBURBAN AREAS  
**2007 AADT**  
 ANNUAL AVERAGE DAILY TRAFFIC  
**COLUMBUS COUNTY**  
 NORTH CAROLINA  
 GENERATED BY THE  
**TRAFFIC SURVEY GROUP**  
 TRANSPORTATION PLANNING BRANCH  
 PREPARED BY THE  
 NORTH CAROLINA DEPARTMENT OF TRANSPORTATION  
 INFORMATION TECHNOLOGY - IMG UNIT  
 IN COOPERATION WITH THE  
 U.S. DEPARTMENT OF TRANSPORTATION  
 FEDERAL HIGHWAY ADMINISTRATION

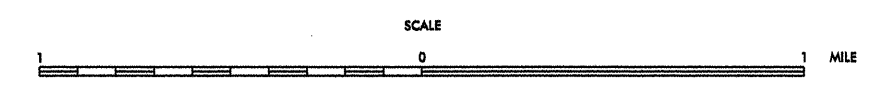

10,000 FOOT GRID BASED ON NORTH CAROLINA PLANE COORDINATE SYSTEM  
 POLYCONIC PROJECTION