

Disclaimer: The IMG Unit's goal is to provide the most accurate information as possible, the magnitude of the data prevents any guarantee of accuracy or completeness. If you find any information that is incorrect, please send your request to the IMG Unit.

COPIES OF THIS MAP ARE AVAILABLE  
FOR PURCHASE AT A NOMINAL COST.  
ADDRESS:  
N.C. DEPARTMENT OF TRANSPORTATION  
INFORMATION, MAPPING, AND GIS SERVICES  
100 SOUTH SAULSBURY AVENUE  
RALEIGH, N.C. 27603

REVISED  
7/27/08 TRP  
12/20/09 TRP

COUNTY  
GUILFORD

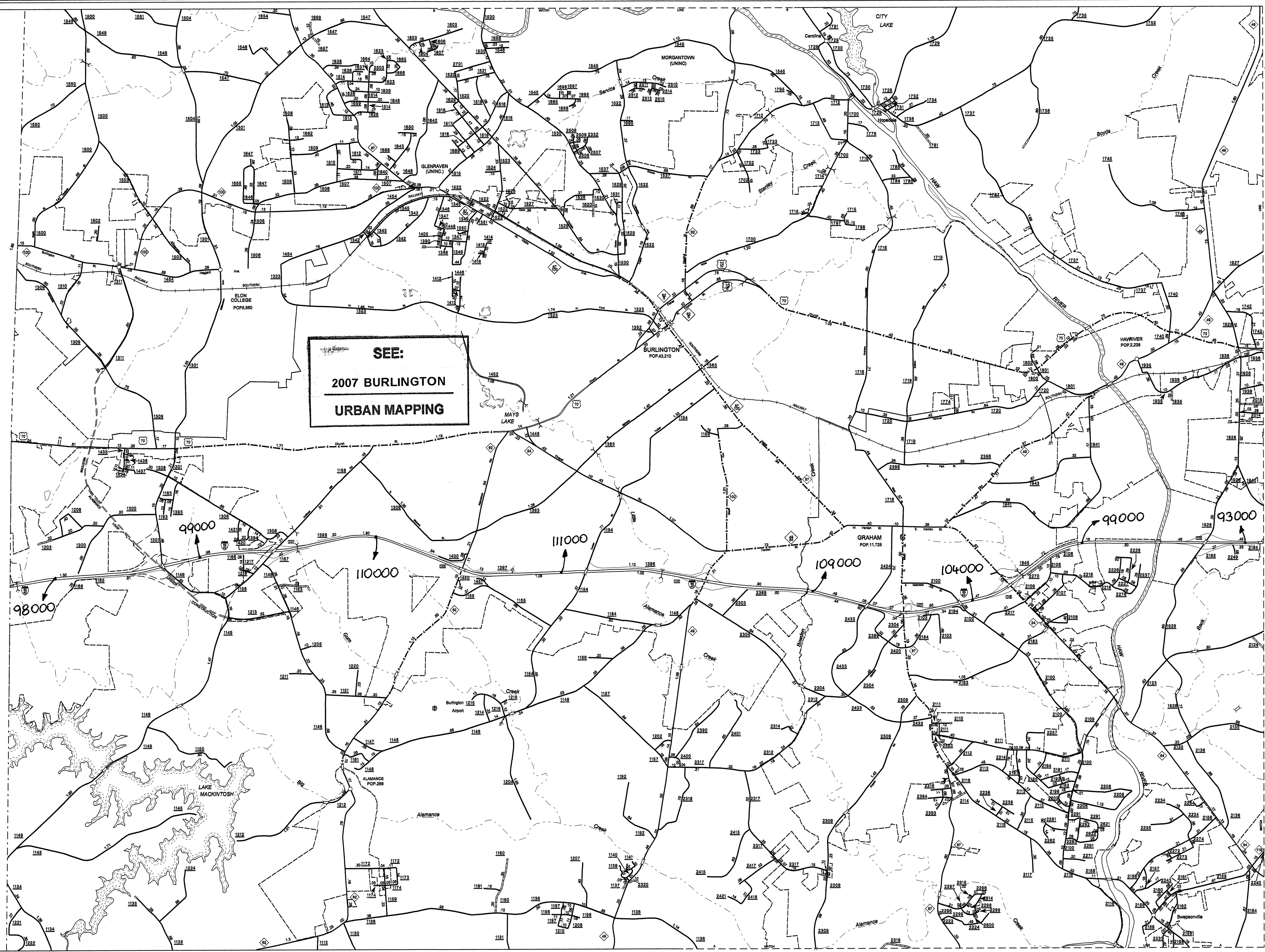

Burlington - Gibsonville - Graham vicinity

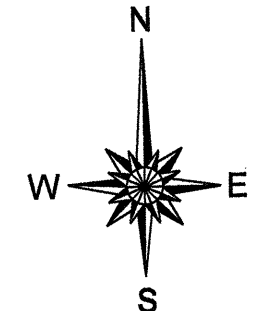
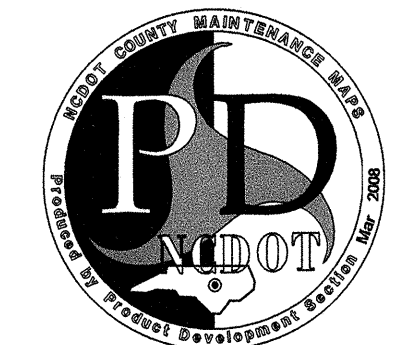
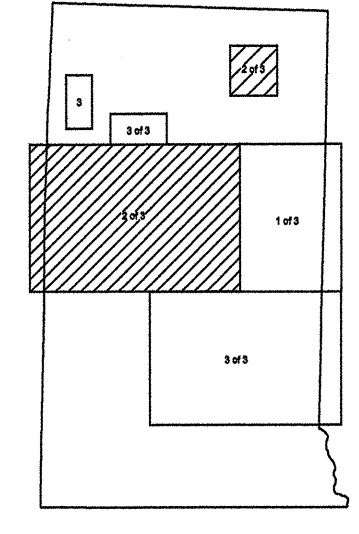
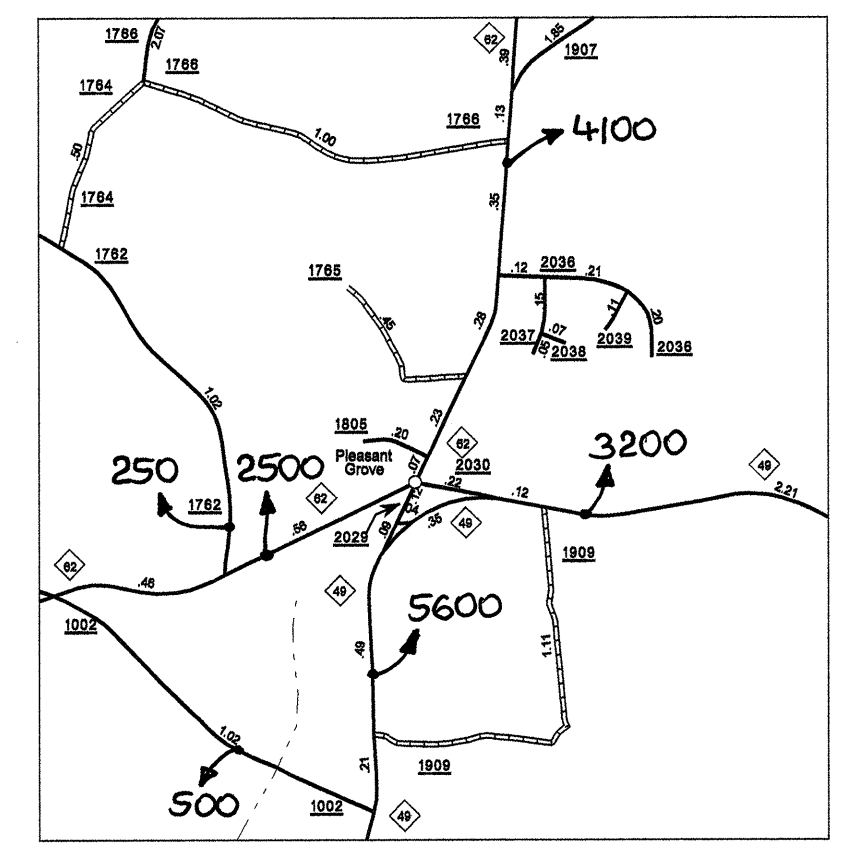

ENLARGED MUNICIPAL AND SUBURBAN AREAS  
**2007 AADT**  
ANNUAL AVERAGE DAILY TRAFFIC  
**ALAMANCE COUNTY**  
NORTH CAROLINA  
GENERATED BY THE  
**TRAFFIC SURVEY GROUP**  
TRANSPORTATION PLANNING BRANCH  
PREPARED BY THE  
NORTH CAROLINA DEPARTMENT OF TRANSPORTATION  
INFORMATION TECHNOLOGY - IMG UNIT  
IN COOPERATION WITH THE  
U.S. DEPARTMENT OF TRANSPORTATION  
FEDERAL HIGHWAY ADMINISTRATION

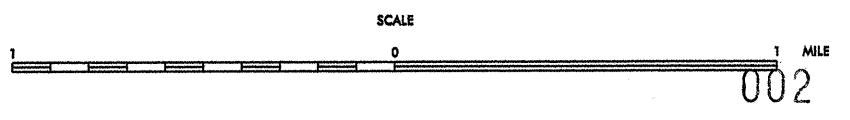

15,000 FOOT GRID BASED ON NORTH CAROLINA PLANE COORDINATE SYSTEM  
POLYCONIC PROJECTION