

N.C. Department of Transportation
 Statewide Planning Branch
 Traffic Survey Unit
 1554 Mail Service Center
 Raleigh, NC 27699-1554

2000
 ANNUAL AVERAGE
 DAILY TRAFFIC

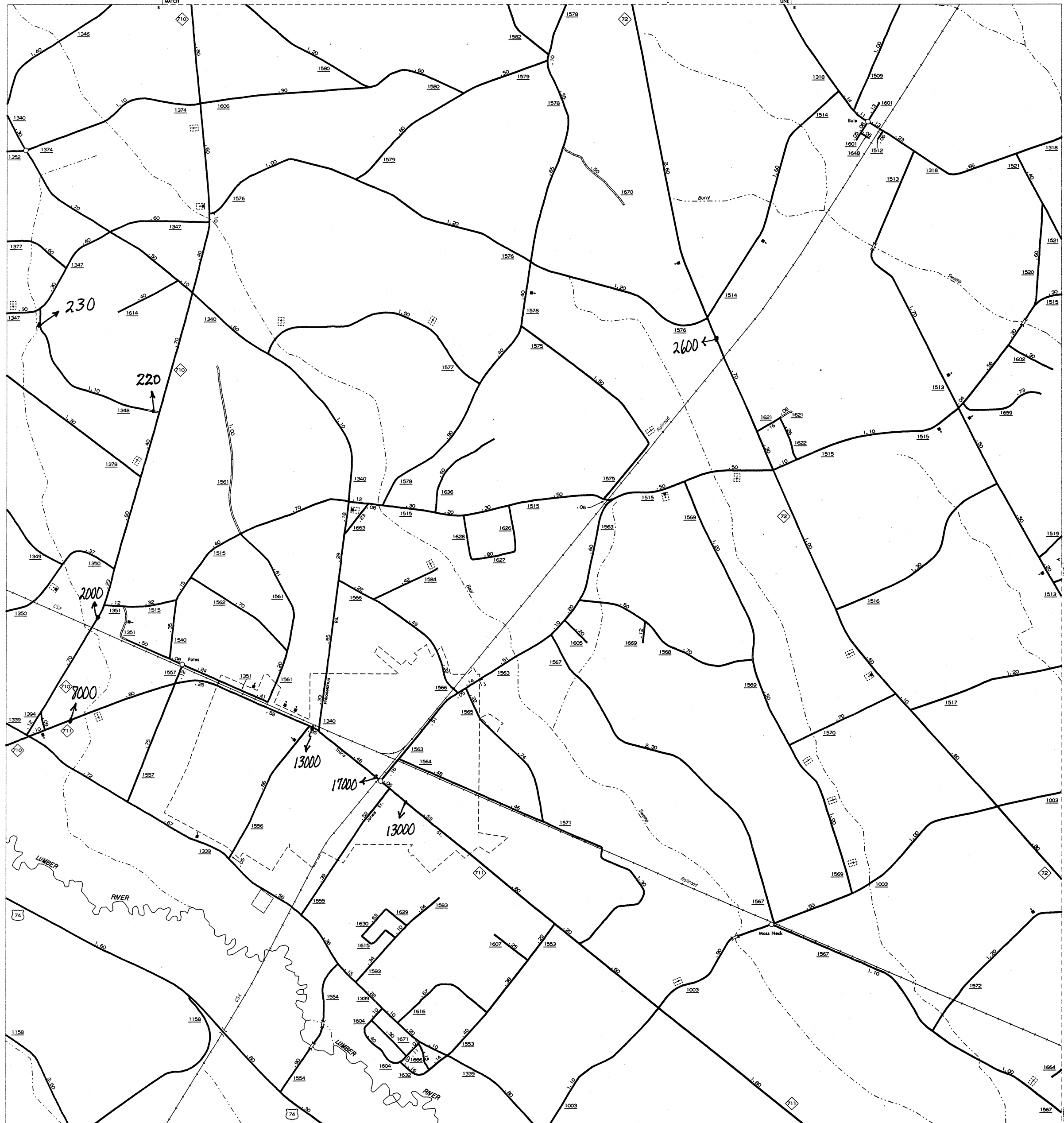

PEMBROKE
 POP. 2,487

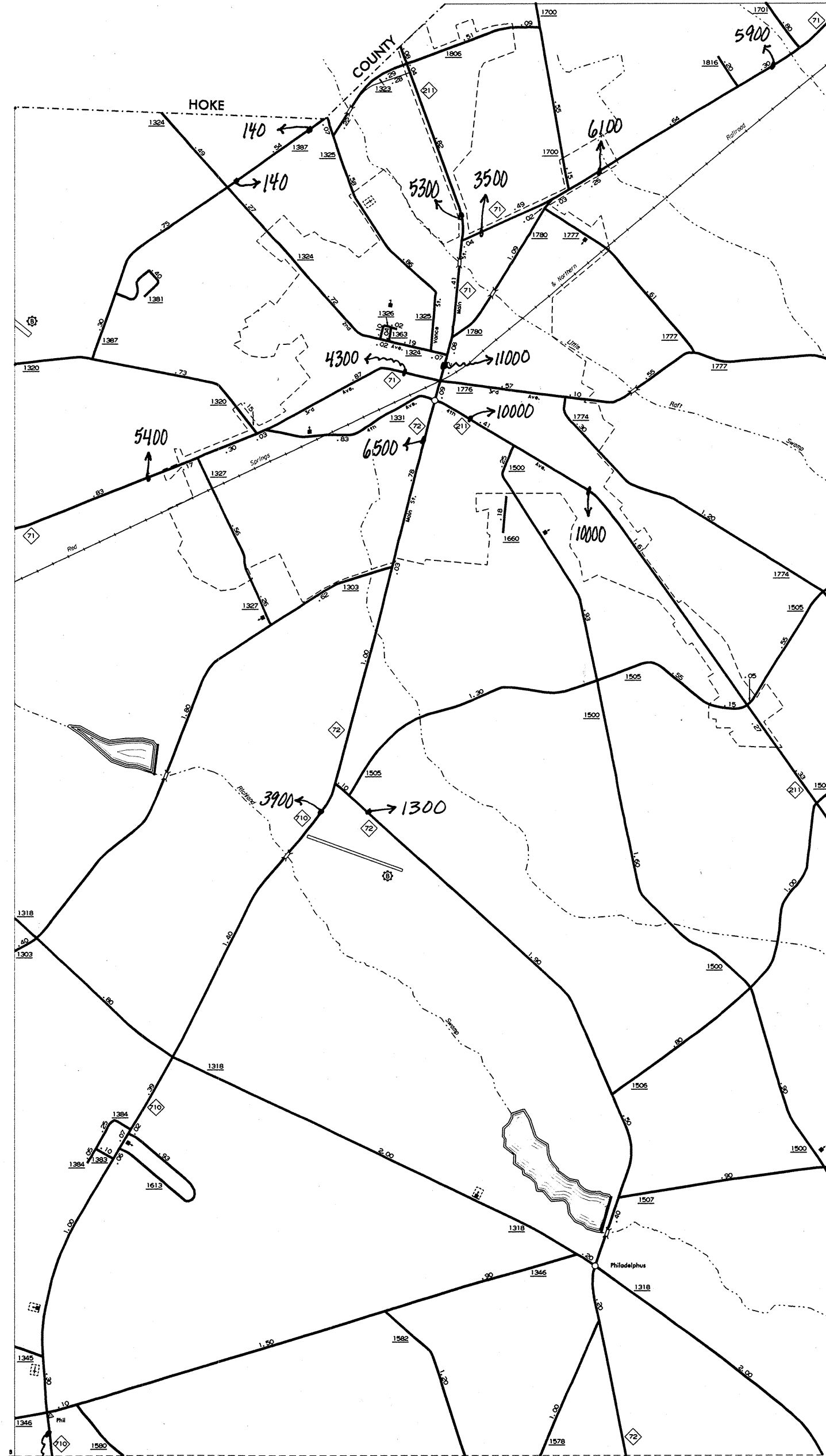

RED SPRINGS
 POP. 9,856

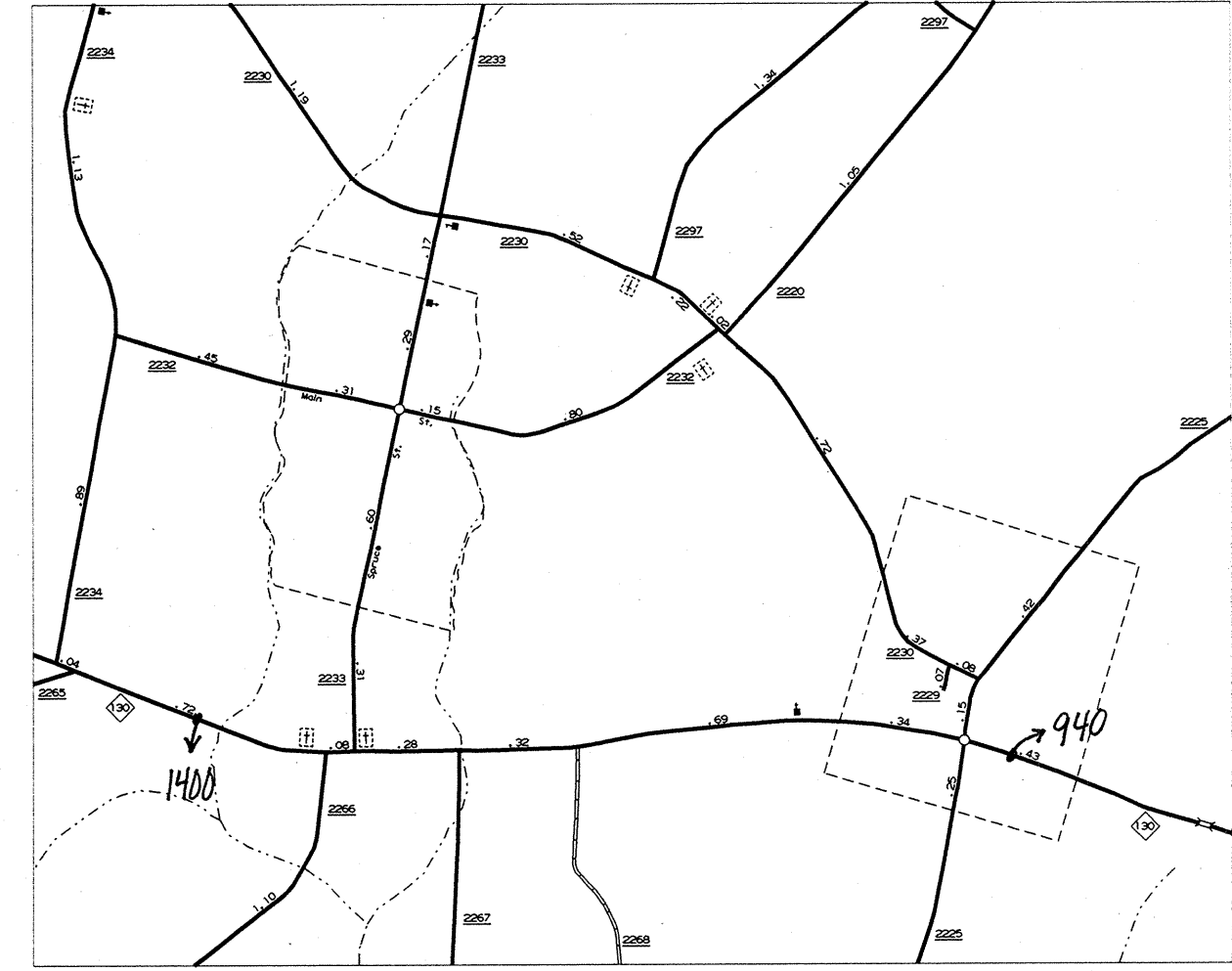

PROCTORVILLE
 POP. 173

ORRUM
 POP. 167

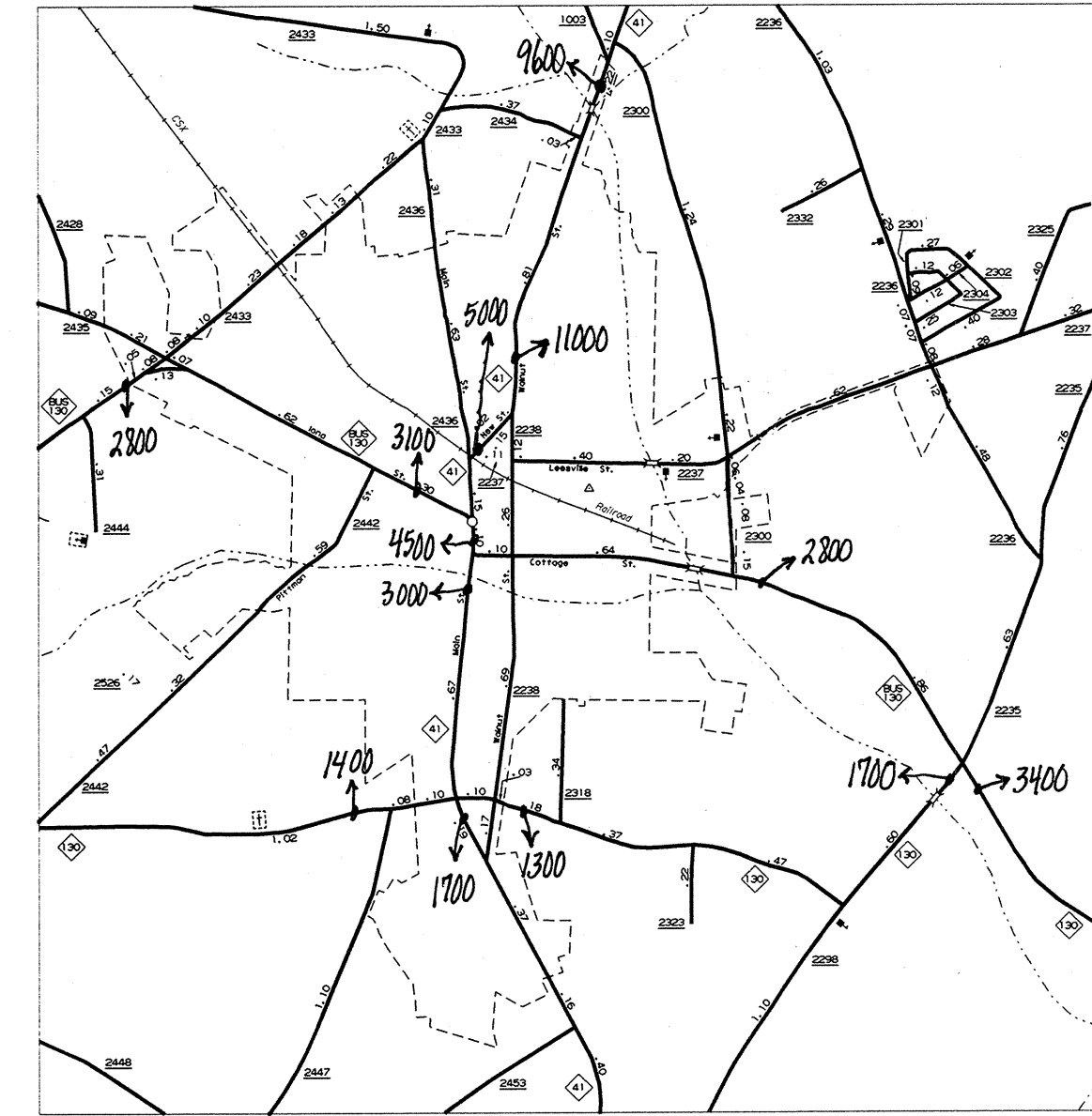

FAIRMONT
 POP. 2,855

ENLARGED MUNICIPAL AND SUBURBAN AREAS

ROBESON COUNTY

NORTH CAROLINA

PREPARED BY THE
 NORTH CAROLINA DEPARTMENT OF TRANSPORTATION
 DIVISION OF HIGHWAYS - GIS UNIT

IN COOPERATION WITH THE
 U.S. DEPARTMENT OF TRANSPORTATION
 FEDERAL HIGHWAY ADMINISTRATION

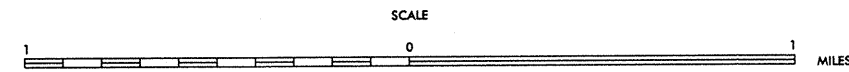
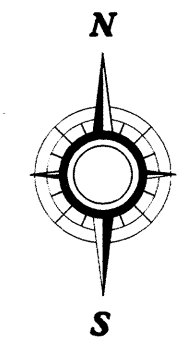

10,000 FOOT GRID BASED ON NORTH CAROLINA PLANE COORDINATE SYSTEM

COPIES OF THIS MAP ARE AVAILABLE TO THE PUBLIC AT A NOMINAL COST. MAKE N.C. DEPARTMENT OF TRANSPORTATION, 1554 MAIL SERVICE CENTER, RALEIGH, NORTH CAROLINA, 27699-1554.

REVISED	7-15-99	MM
	2-2-99	RLN
	9-9-99	RLN