

**2000**  
ANNUAL AVERAGE  
DAILY TRAFFIC

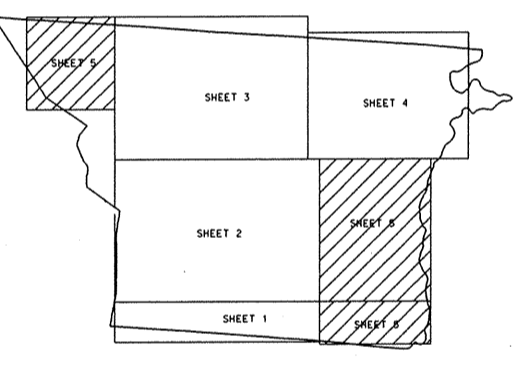

N.C. Department of Transportation  
Statewide Planning Branch  
Traffic Survey Unit  
1554 Mail Service Center  
Raleigh, NC 27699-1554

ENLARGED MUNICIPAL AND SUBURBAN AREAS

# GASTON COUNTY

NORTH CAROLINA

PREPARED BY THE  
NORTH CAROLINA DEPARTMENT OF TRANSPORTATION  
DIVISION OF HIGHWAYS - GIS UNIT

IN COOPERATION WITH THE  
U.S. DEPARTMENT OF TRANSPORTATION  
FEDERAL HIGHWAY ADMINISTRATION

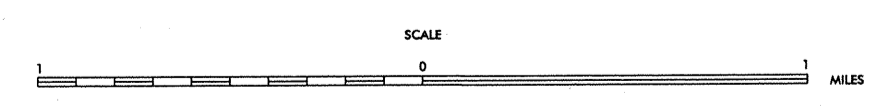

COPIES OF THIS MAP ARE AVAILABLE TO THE PUBLIC AT A NOMINAL COST. ADDRESS: DIVISION OF HIGHWAYS, 1554 MAIL SERVICE CENTER, RALEIGH, NORTH CAROLINA, 27699-1554  
 REVISED JMD 15494 ES 15499 JDT 10199  
 GASTON SHEET 4