

2000
ANNUAL AVERAGE
DAILY TRAFFIC



ENLARGED MUNICIPAL AND SUBURBAN AREAS

DAVIDSON COUNTY

NORTH CAROLINA

PREPARED BY THE
NORTH CAROLINA DEPARTMENT OF TRANSPORTATION
DIVISION OF HIGHWAYS - GIS UNIT

IN COOPERATION WITH THE
U.S. DEPARTMENT OF TRANSPORTATION
FEDERAL HIGHWAY ADMINISTRATION

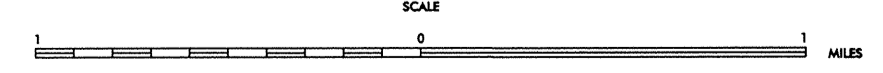
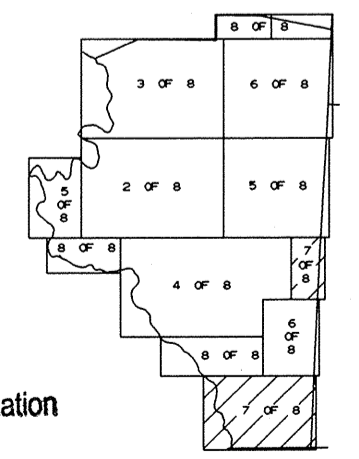

N.C. Department of Transportation
Statewide Planning Branch
Traffic Survey Unit
1554 Mail Service Center
Raleigh, NC 27699-1554

DAVIDSON - SHEET 6

REVISED
DOR #15-94
11-97
1-98
1-99
1-99
1-99
1-99

COPIES OF THIS MAP AVAILABLE
TO THE PUBLIC AT A NOMINAL COST:
ADDRESS: MAPS, N.C. DEPARTMENT OF TRANSPORTATION
DIVISION OF HIGHWAYS
1554 MAIL SERVICE CENTER
RALEIGH, NORTH CAROLINA, 27699