

DAVIDSON - SUP. 4
 COPIES OF THIS MAP ARE AVAILABLE TO THE PUBLIC AT A NOMINAL COST. ADDRESS: N.C. DEPARTMENT OF TRANSPORTATION, DIVISION OF HIGHWAYS - GIS UNIT, 1554 MAIL SERVICE CENTER, RALEIGH, NORTH CAROLINA, 27699

REVISED	DATE
1-1-99	1-1-99
1-1-99	1-1-99
1-1-99	1-1-99
1-1-99	1-1-99
1-1-99	1-1-99

N.C. Department of Transportation
 Statewide Planning Branch
 Traffic Survey Unit
 1554 Mail Service Center
 Raleigh, NC 27699-1554

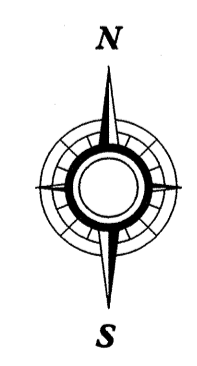
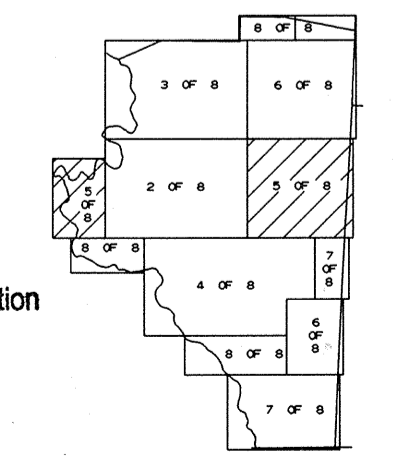

ENLARGED MUNICIPAL AND SUBURBAN AREAS
DAVIDSON COUNTY
 NORTH CAROLINA

PREPARED BY THE
 NORTH CAROLINA DEPARTMENT OF TRANSPORTATION
 DIVISION OF HIGHWAYS - GIS UNIT

IN COOPERATION WITH THE
 U.S. DEPARTMENT OF TRANSPORTATION
 FEDERAL HIGHWAY ADMINISTRATION

