

BEAUFORT  
 COPIES OF THIS MAP ARE AVAILABLE  
 FROM THE  
 N.C. DEPARTMENT OF TRANSPORTATION  
 DIVISION OF HIGHWAYS  
 1554 MAIL SERVICE CENTER  
 RALEIGH, NORTH CAROLINA, 27611

REVISED  
 1/79 PDR  
 10/87 PDR  
 1/98 PDR  
 12/98  
 9/00



**2000**  
 ANNUAL AVERAGE  
 DAILY TRAFFIC

N.C. Department of Transportation  
 Statewide Planning Branch  
 Traffic Survey Unit  
 1554 Mail Service Center  
 Raleigh, NC 27699-1554

Aurora and vicinity



Bath and vicinity

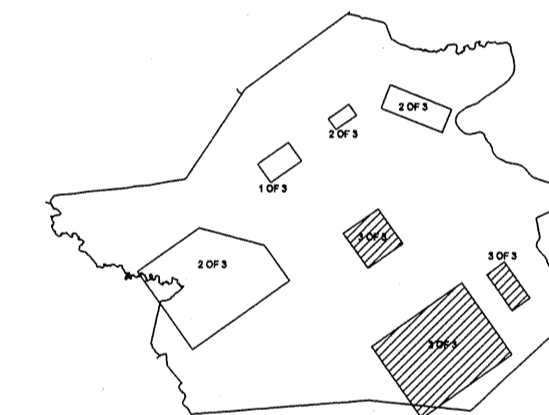
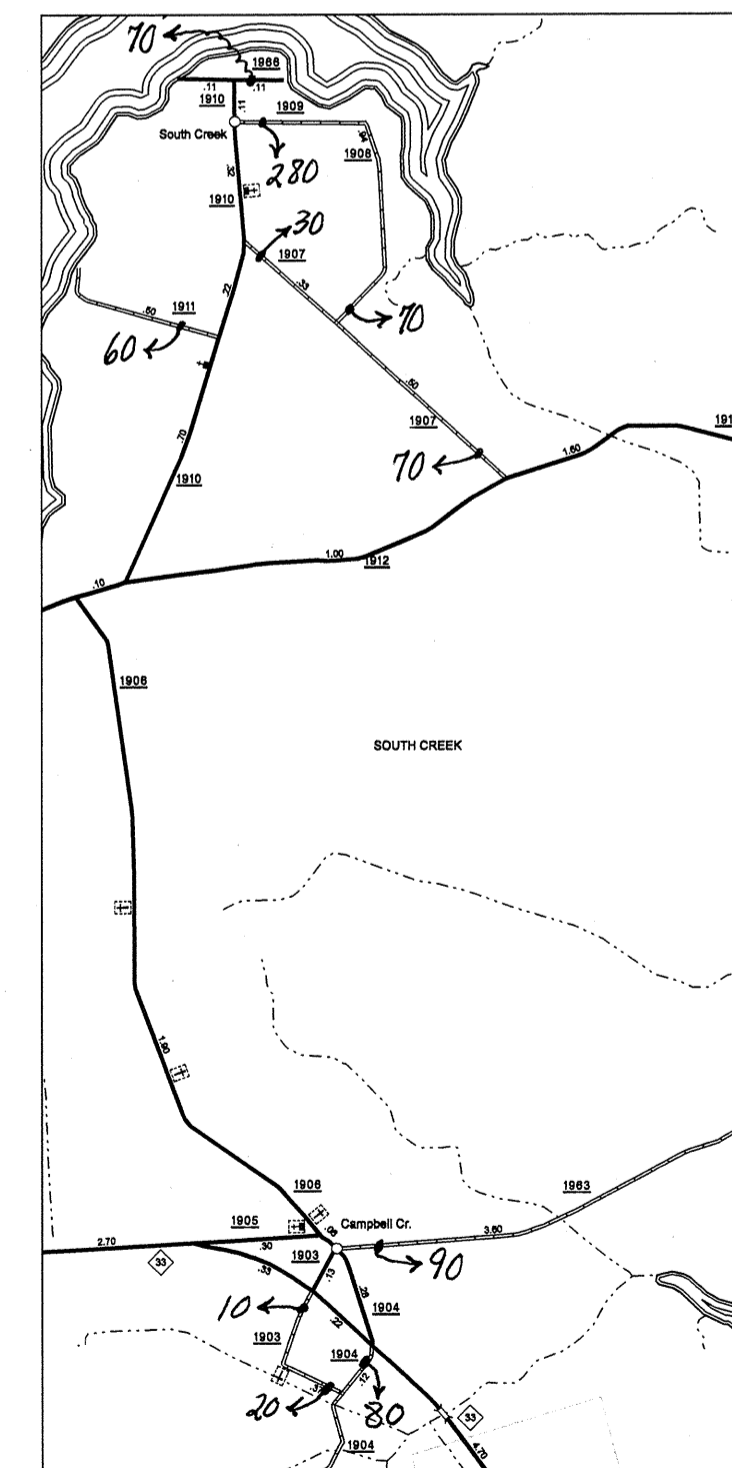

ENLARGED MUNICIPAL AND SUBURBAN AREAS  
**BEAUFORT COUNTY**  
 NORTH CAROLINA  
 PREPARED BY THE  
 NORTH CAROLINA DEPARTMENT OF TRANSPORTATION  
 DIVISION OF HIGHWAYS - GIS UNIT  
 IN COOPERATION WITH THE  
 U.S. DEPARTMENT OF TRANSPORTATION  
 FEDERAL HIGHWAY ADMINISTRATION

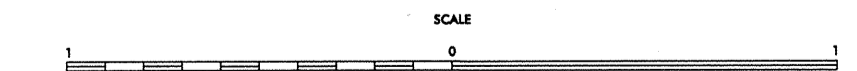

10,000 FOOT GRID BASED ON NORTH CAROLINA PLANE COORDINATE SYSTEM  
 POLYCONIC PROJECTION

14

SHEET 3 OF 3