

PEACHLAND
POP. 487

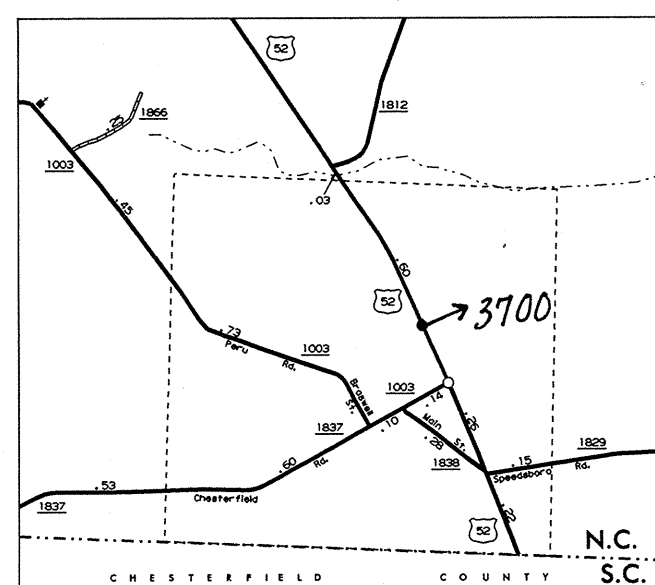

McFARLAN
POP. 90

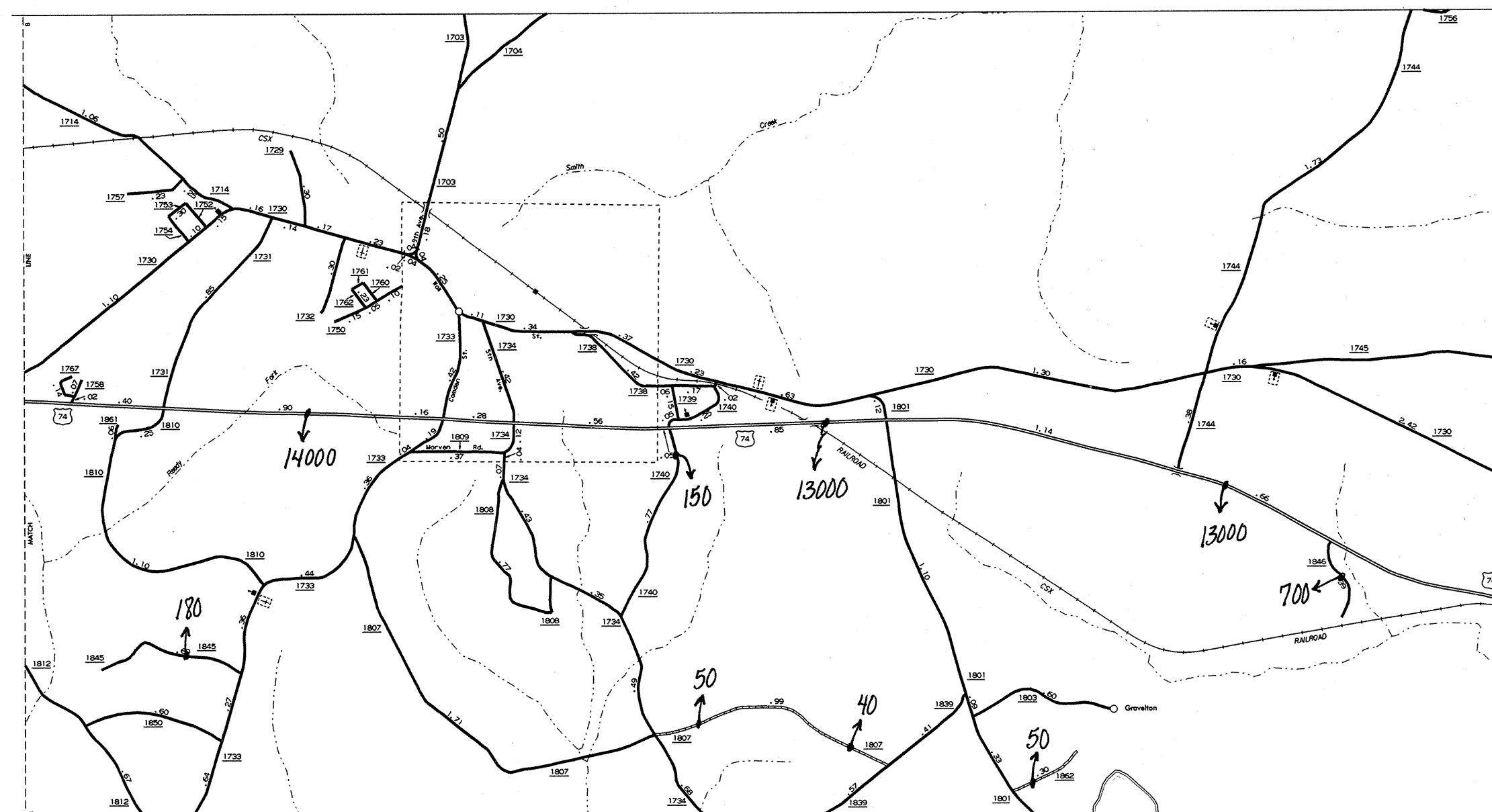

LILESVILLE
POP. 434

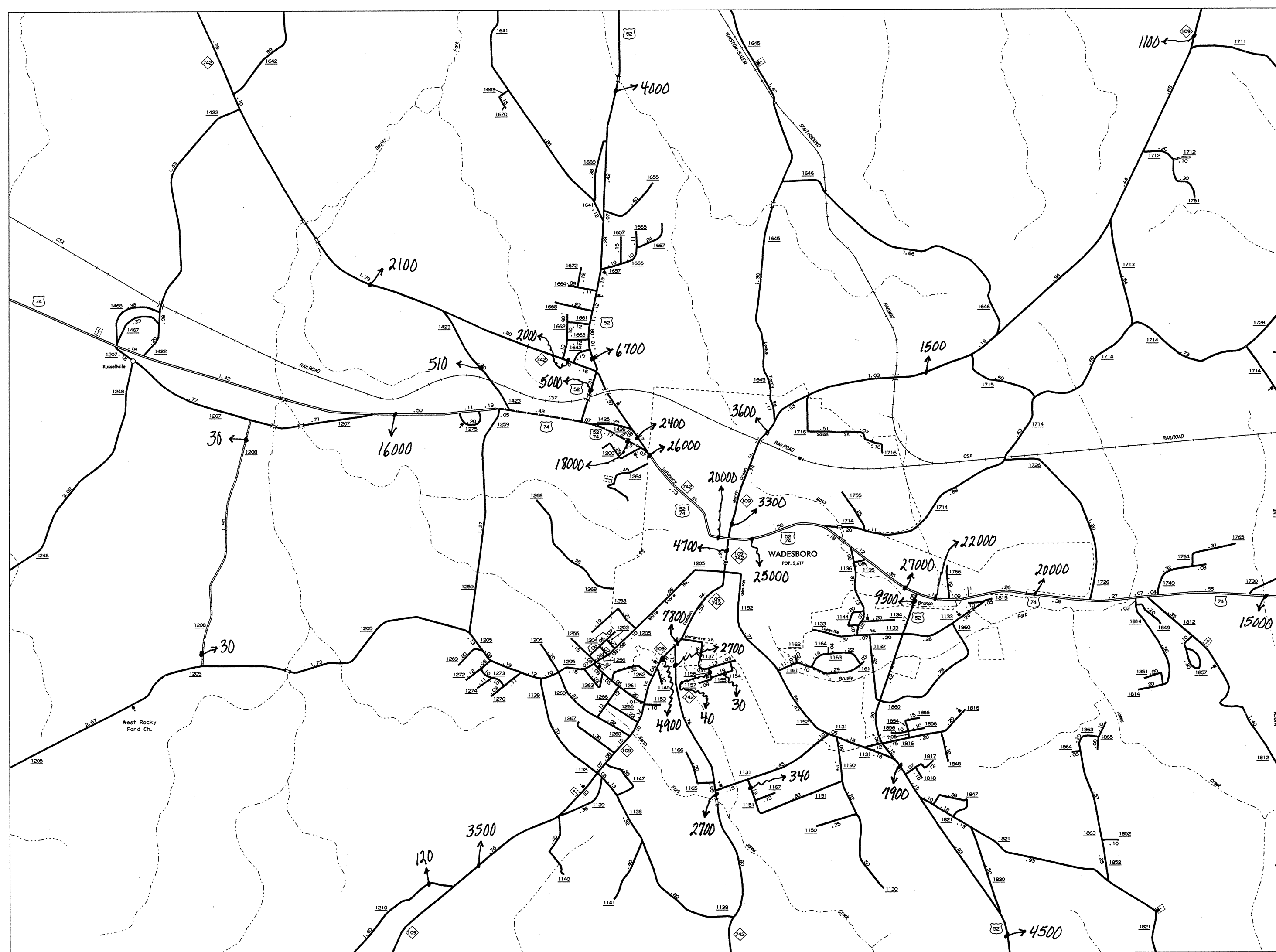

WADESBORO
POP. 3,817

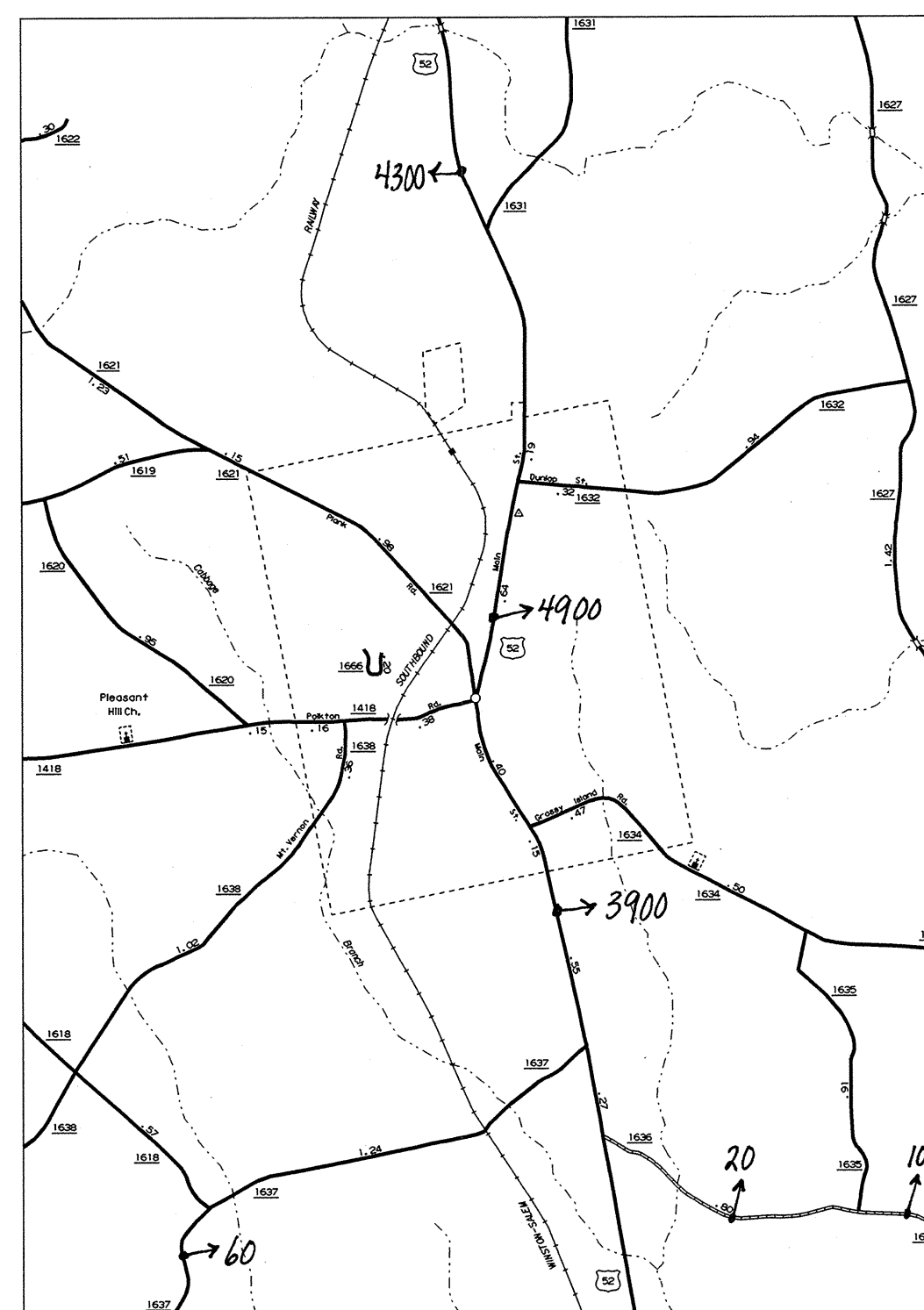

ANSONVILLE
POP. 609

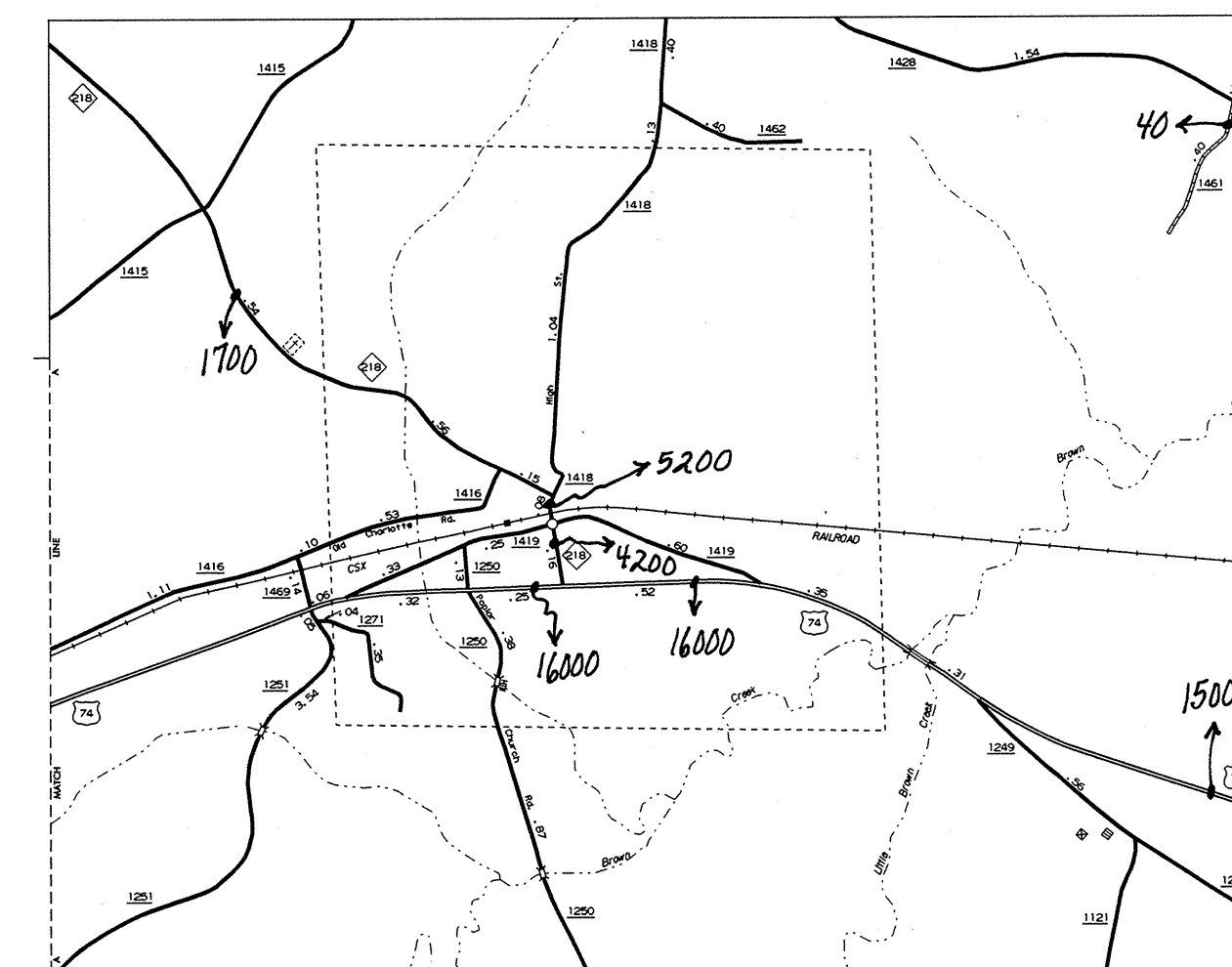

POLKTON
POP. 649

2000
ANNUAL AVERAGE
DAILY TRAFFIC

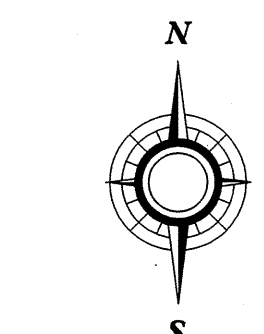

ENLARGED MUNICIPAL AND SUBURBAN AREAS
ANSON COUNTY
NORTH CAROLINA
PREPARED BY THE
NORTH CAROLINA DEPARTMENT OF TRANSPORTATION
DIVISION OF HIGHWAYS - GIS UNIT

N.C. Department of Transportation
Statewide Planning Branch
Traffic Survey Unit
1554 Mail Service Center
Raleigh, NC 27699-1554

IN COOPERATION WITH THE
U.S. DEPARTMENT OF TRANSPORTATION
FEDERAL HIGHWAY ADMINISTRATION

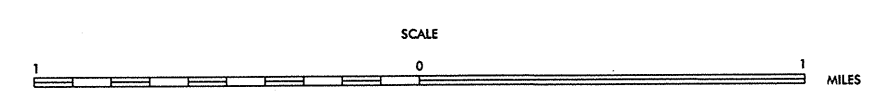

ANSON, SHEET 1
COPYRIGHT © 2000 BY THE STATE OF NORTH CAROLINA
ALL RIGHTS RESERVED
THIS MAP IS THE PROPERTY OF THE N.C. DEPARTMENT OF TRANSPORTATION
AND IS LOANED TO YOU. IT IS NOT TO BE REPRODUCED OR TRANSMITTED IN ANY FORM OR BY ANY MEANS
ELECTRONIC OR MECHANICAL, INCLUDING PHOTOCOPYING, RECORDING, OR BY ANY INFORMATION STORAGE
AND RETRIEVAL SYSTEM, WITHOUT PERMISSION IN WRITING FROM THE N.C. DEPARTMENT OF TRANSPORTATION
DIVISION OF HIGHWAYS
RALEIGH, NORTH CAROLINA 27699-1554

REVISED
BY: J. W. B. / J. W. B.
DATE: 10/20/00
BY: J. W. B. / J. W. B.
DATE: 10/20/00