

UNIONVILLE

**1999
ANNUAL AVERAGE
DAILY TRAFFIC**

N.C. Department of Transportation
Statewide Planning Branch
Traffic Survey Unit
1554 Mail Service Center
Raleigh, NC 27699-1554

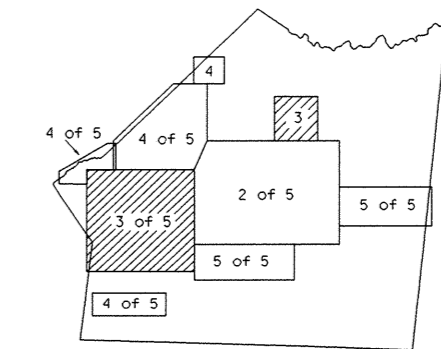

SHEET KEY

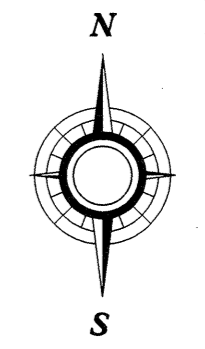

Some of the traffic estimates in this county were based on data collected after hurricane events in 1999. Contact the Traffic Survey Unit at (919) 733-9770 for information about a particular location or area.

ENLARGED MUNICIPAL AND SUBURBAN AREAS

**UNION COUNTY
NORTH CAROLINA**

PREPARED BY THE
NORTH CAROLINA DEPARTMENT OF TRANSPORTATION
DIVISION OF HIGHWAYS - GIS UNIT

IN COOPERATION WITH THE
U.S. DEPARTMENT OF TRANSPORTATION
FEDERAL HIGHWAY ADMINISTRATION

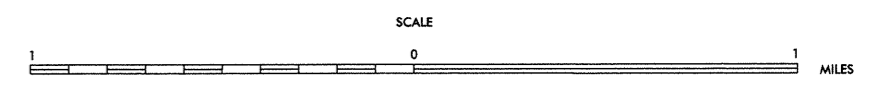

SCALE

WEDDINGTON AND WAXHAW

UNION
COPY OF THIS MAP MAY BE OBTAINED
TO THE PUBLIC AT A MINOR COST.
ADDRESS: MAPS, N.C. DEPARTMENT OF TRANSPORTATION
DIVISION OF HIGHWAYS
RALEIGH, NORTH CAROLINA 27611

REVISED
J.S. 8/94
A.B.R. 10/28/97
A.B.R. 3/2/98
EOR 4/97
LMI 7-31-97