

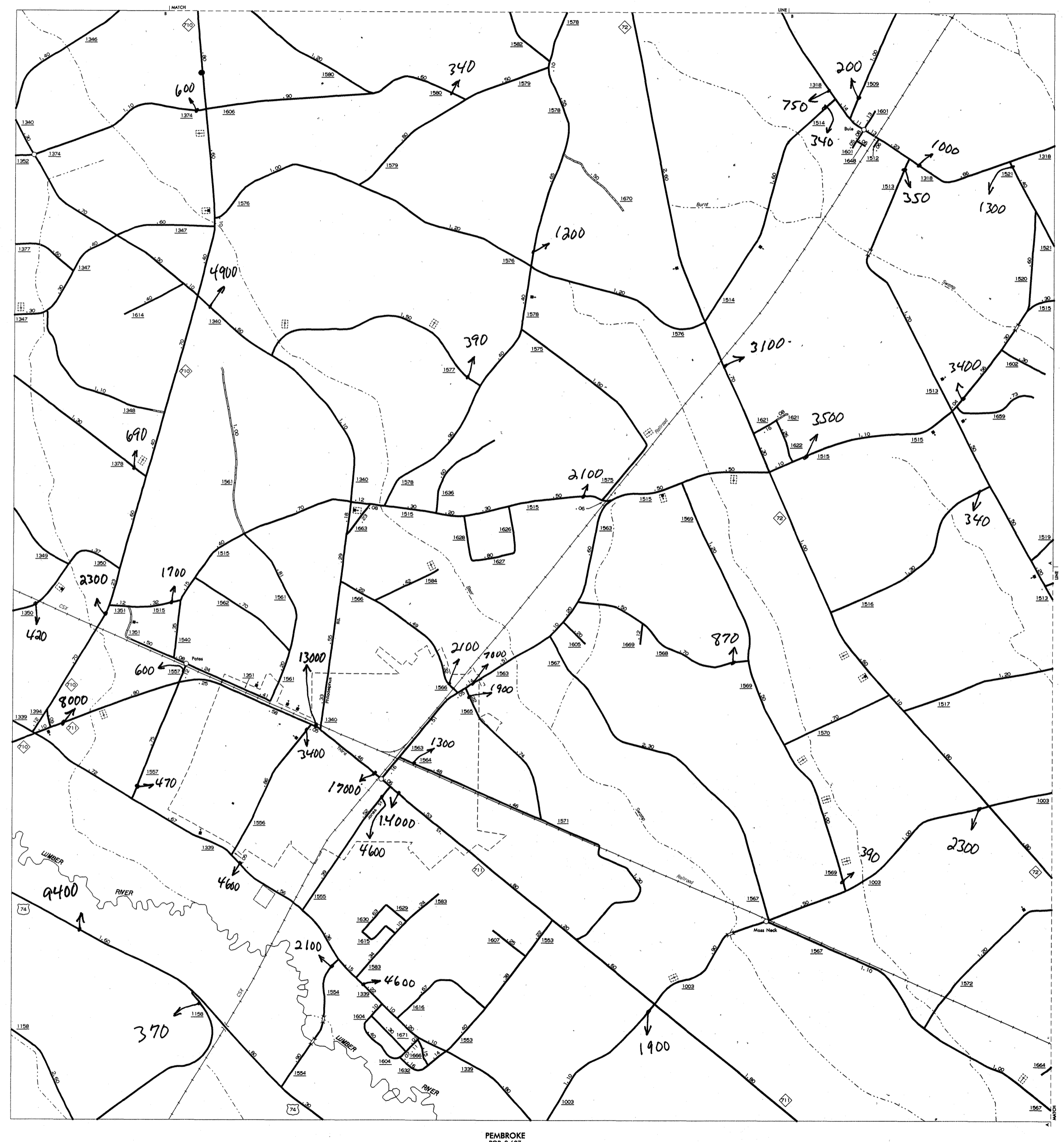

Some of the traffic estimates in this county were based on data collected after hurricane events in 1999. Contact the Traffic Survey Unit at (919) 733-9770 for information about a particular location or area.

N.C. Department of Transportation
Statewide Planning Branch
Traffic Survey Unit
1554 Mail Service Center
Raleigh, NC 27699-1554

1999 ANNUAL AVERAGE DAILY TRAFFIC



PEMBROKE
POP. 2,487

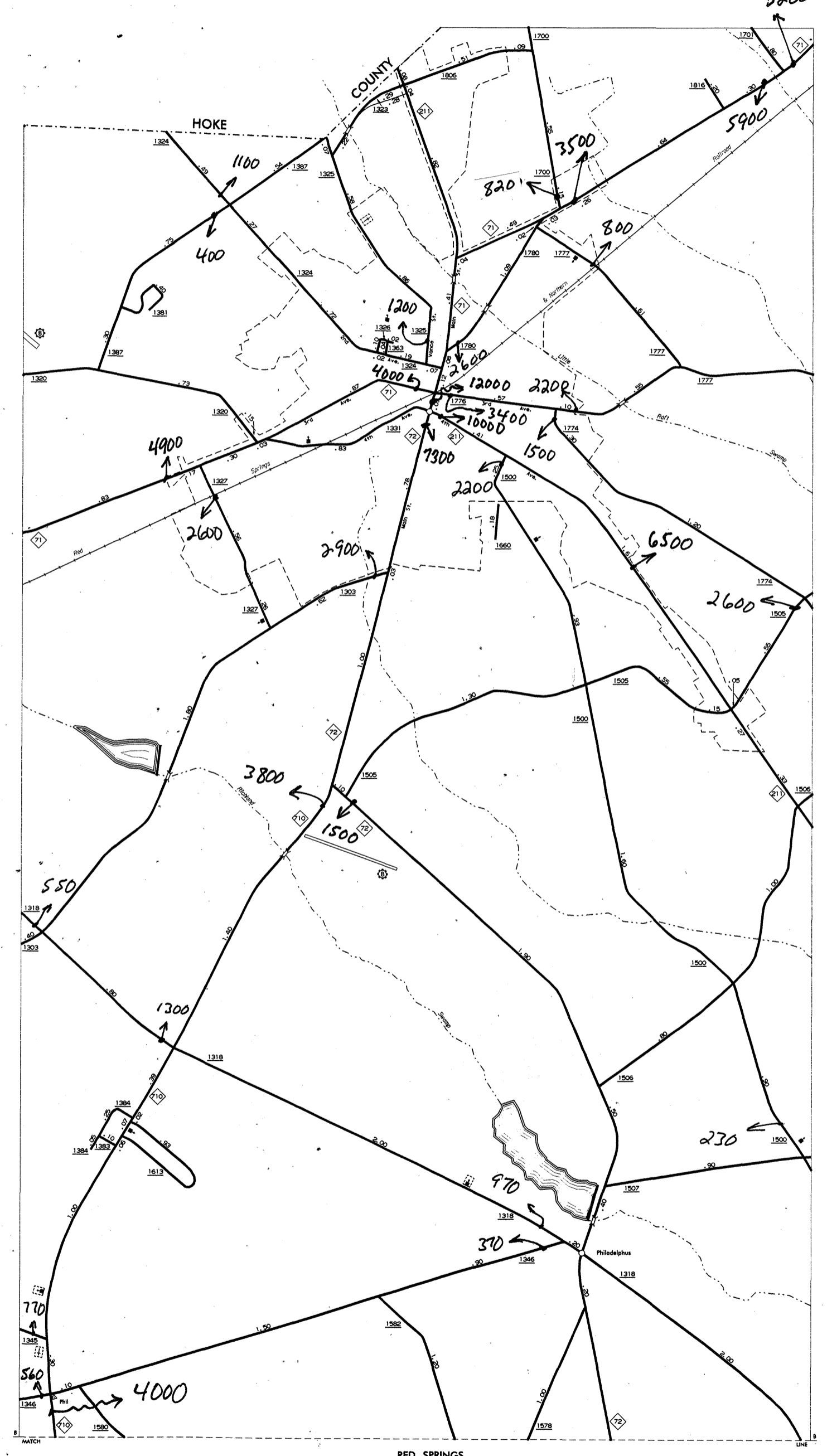

RED SPRINGS
POP. 3,886

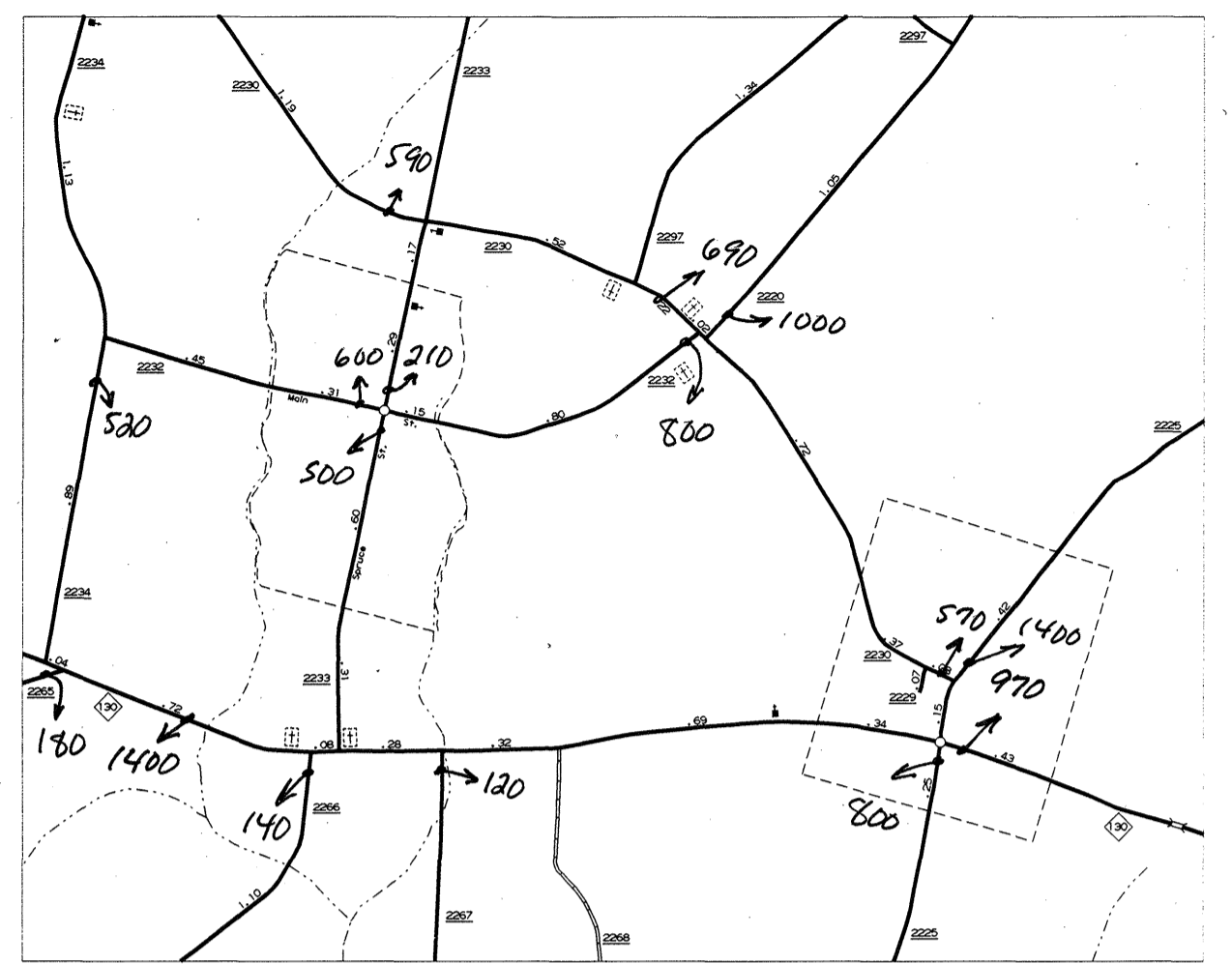

PROCTORVILLE
POP. 173

ORRUM
POP. 167

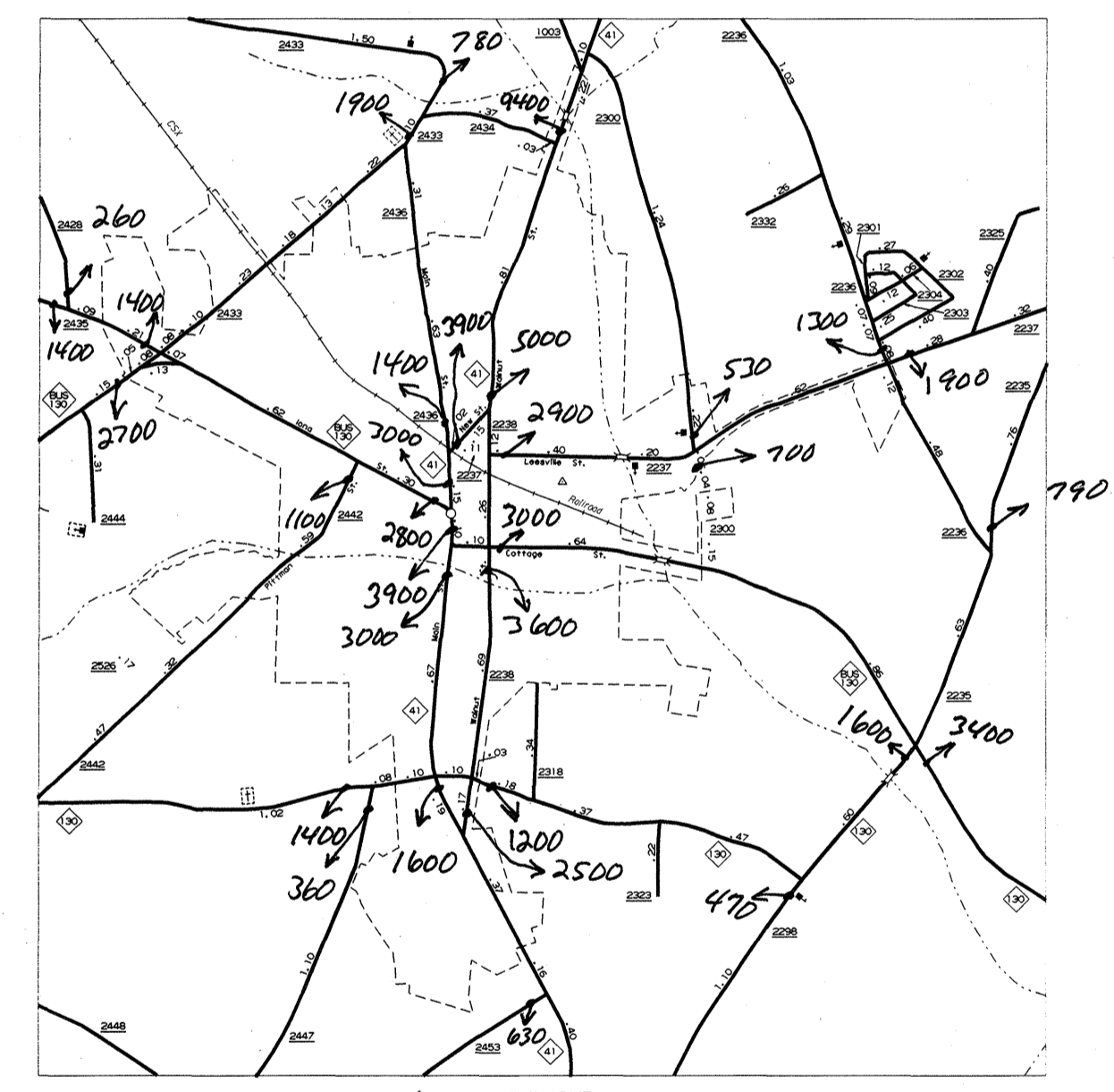

FAIRMONT
POP. 2,853

ENLARGED MUNICIPAL AND SUBURBAN AREAS

ROBESON COUNTY NORTH CAROLINA

PREPARED BY THE
NORTH CAROLINA DEPARTMENT OF TRANSPORTATION
DIVISION OF HIGHWAYS - GIS UNIT
IN COOPERATION WITH THE
U.S. DEPARTMENT OF TRANSPORTATION
FEDERAL HIGHWAY ADMINISTRATION

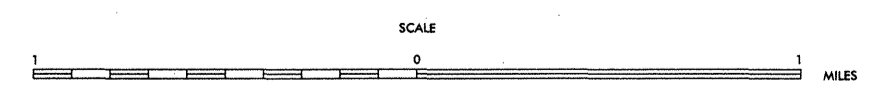
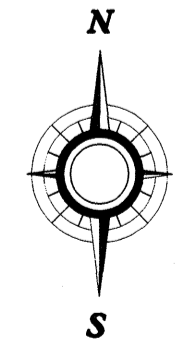

REVISIONS
7-1-97 RIN
2-2-99 RIN
5-2-99 RIN

10,000 FOOT GRID BASED ON NORTH CAROLINA PLANE COORDINATE SYSTEM
HISTORIC POSITION