

CAMERON AND VICINITY

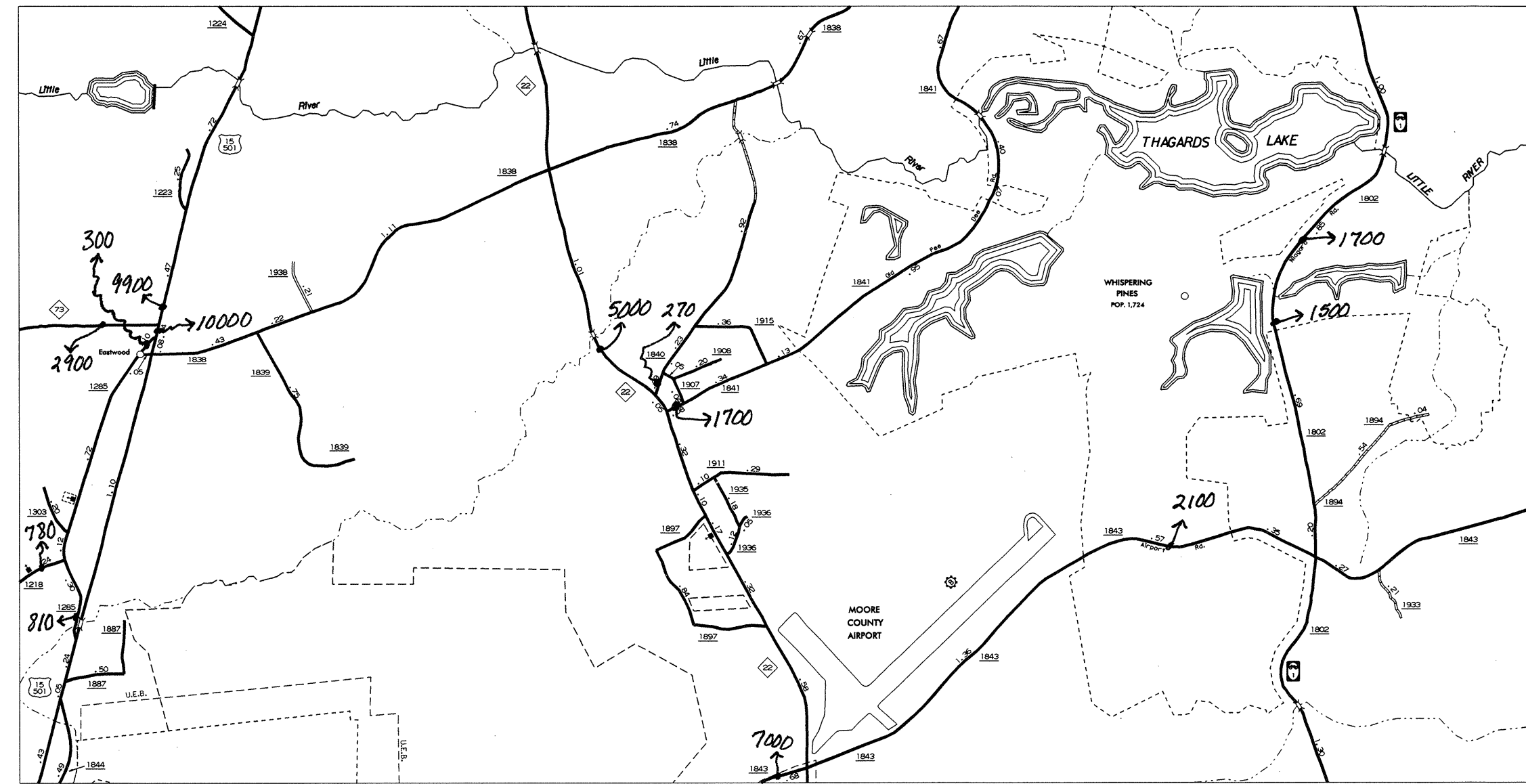

WHISPERING PINES



JACKSON SPRINGS AND FOXFIRE VILLAGE

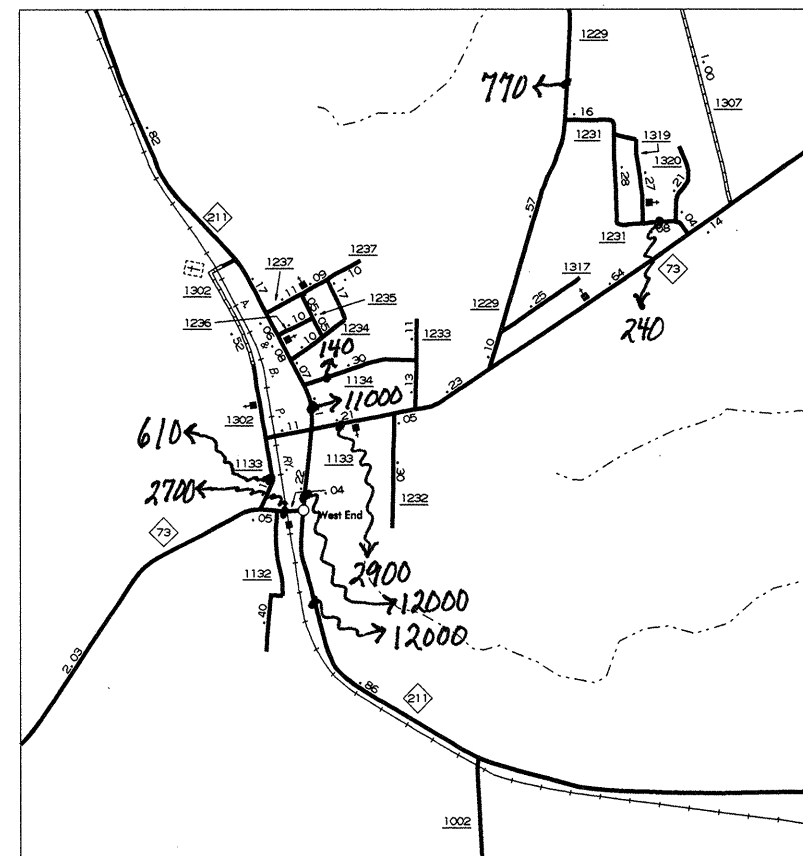

WEST END

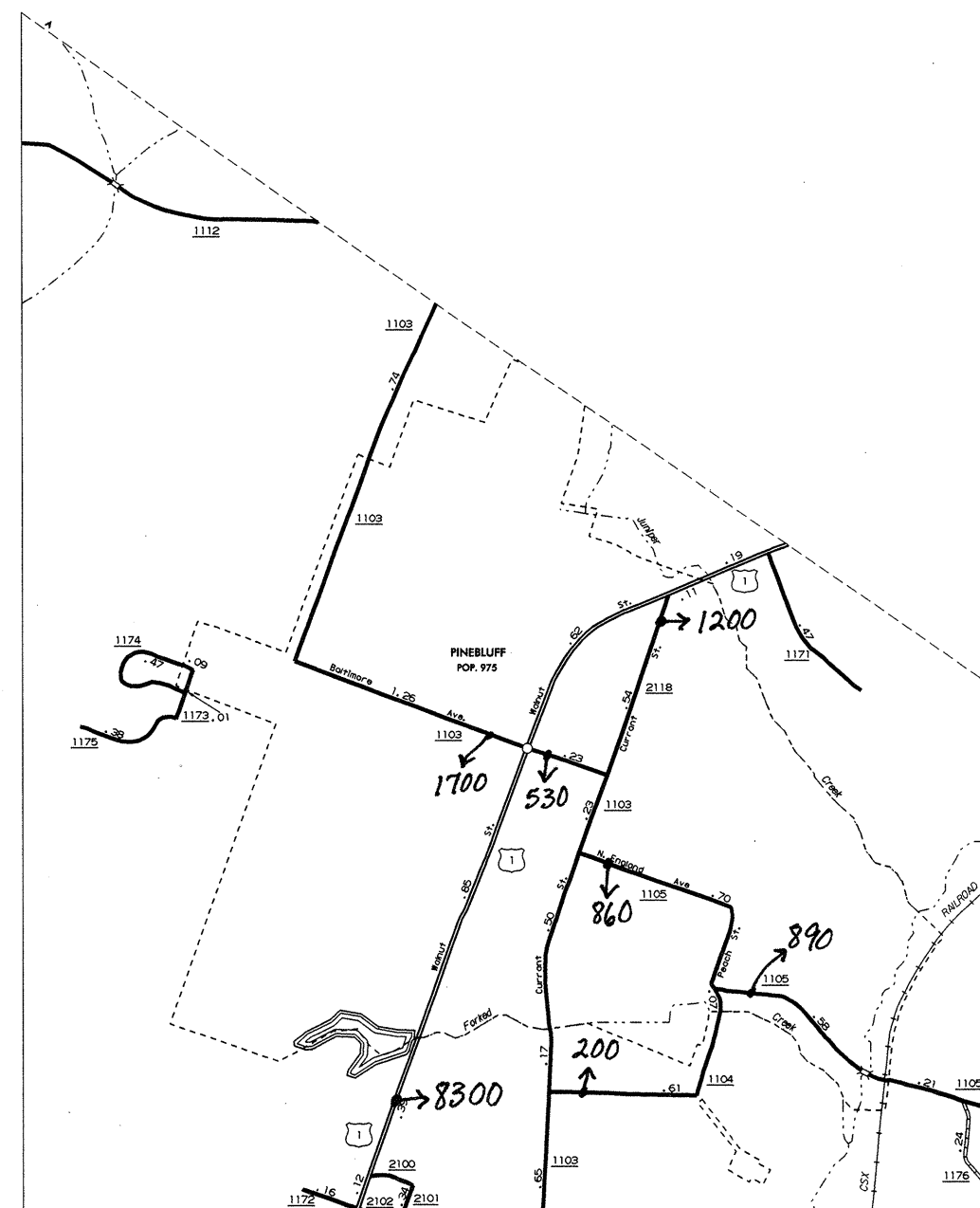

PINEBLUFF

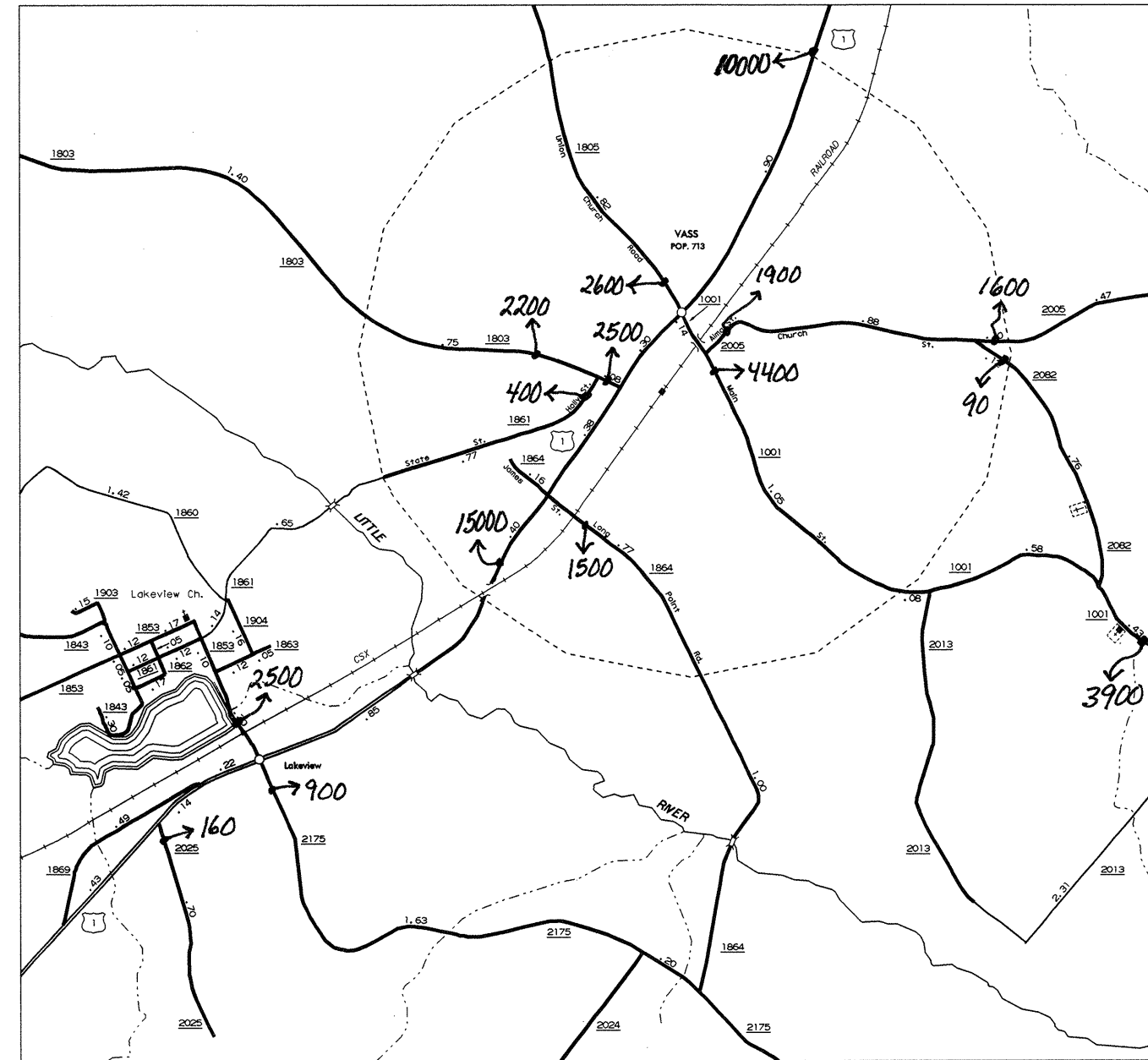

VASS - LAKEVIEW

1999
ANNUAL AVERAGE
DAILY TRAFFIC

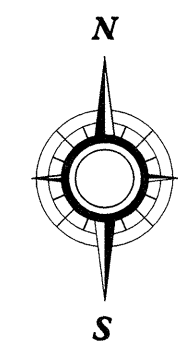

ENLARGED MUNICIPAL AND SUBURBAN AREAS
MOORE COUNTY
NORTH CAROLINA
PREPARED BY THE
NORTH CAROLINA DEPARTMENT OF TRANSPORTATION
DIVISION OF HIGHWAYS - GIS UNIT

IN COOPERATION WITH THE
U.S. DEPARTMENT OF TRANSPORTATION
FEDERAL HIGHWAY ADMINISTRATION

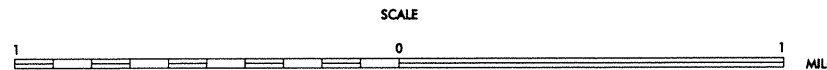

N.C. Department of Transportation
Statewide Planning Branch
Traffic Survey Unit
1554 Mail Service Center
Raleigh, NC 27699-1554

10,000 FOOT GRID BASED ON NORTH CAROLINA PLANE COORDINATE SYSTEM
NORTH CAROLINA

COPIES OF THIS MAP ARE AVAILABLE
FOR PURCHASE AT A NOMINAL COST.
NORTH CAROLINA DEPARTMENT OF TRANSPORTATION
DIVISION OF HIGHWAYS
RALEIGH, NORTH CAROLINA 27611

REVISED
MCH 1-1-99