

NEW BERLIN - ACME

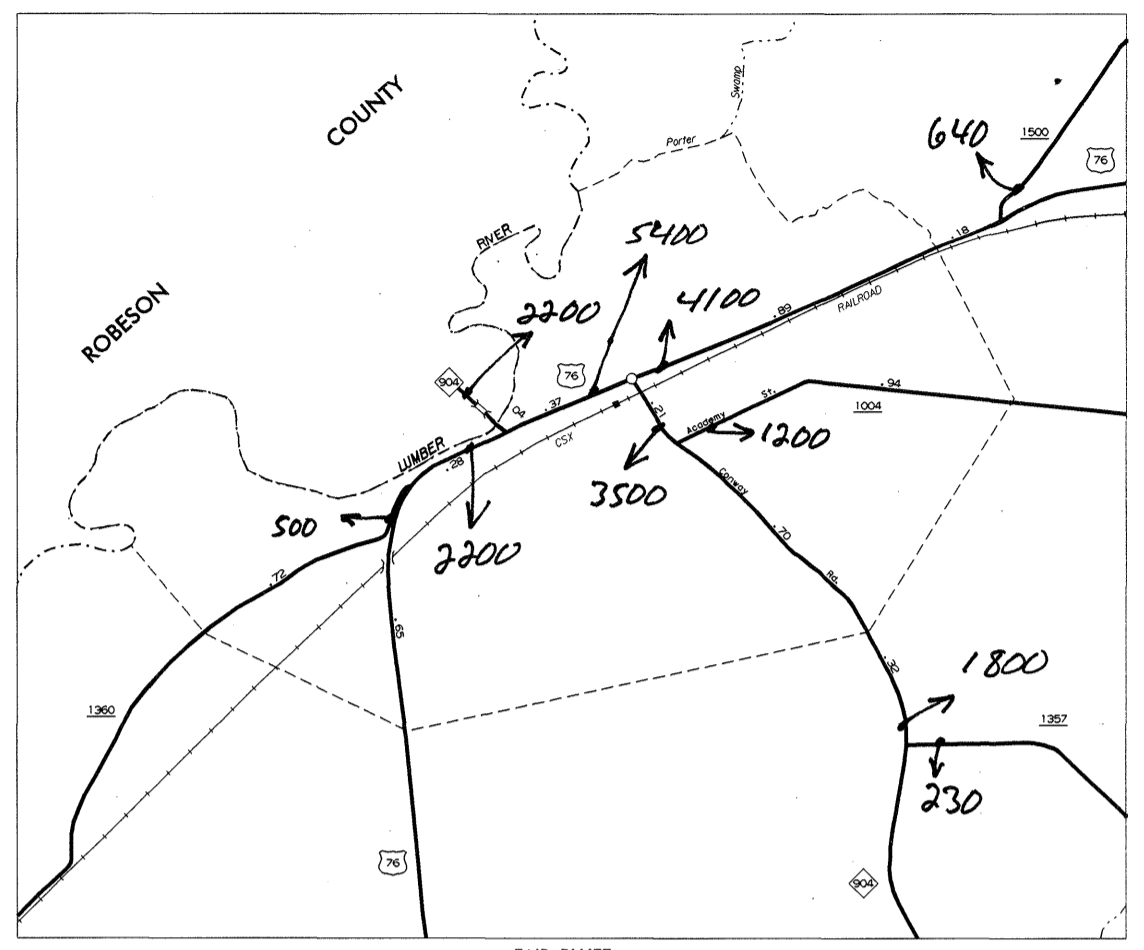

FAIR BLUFF
POP. 1,087

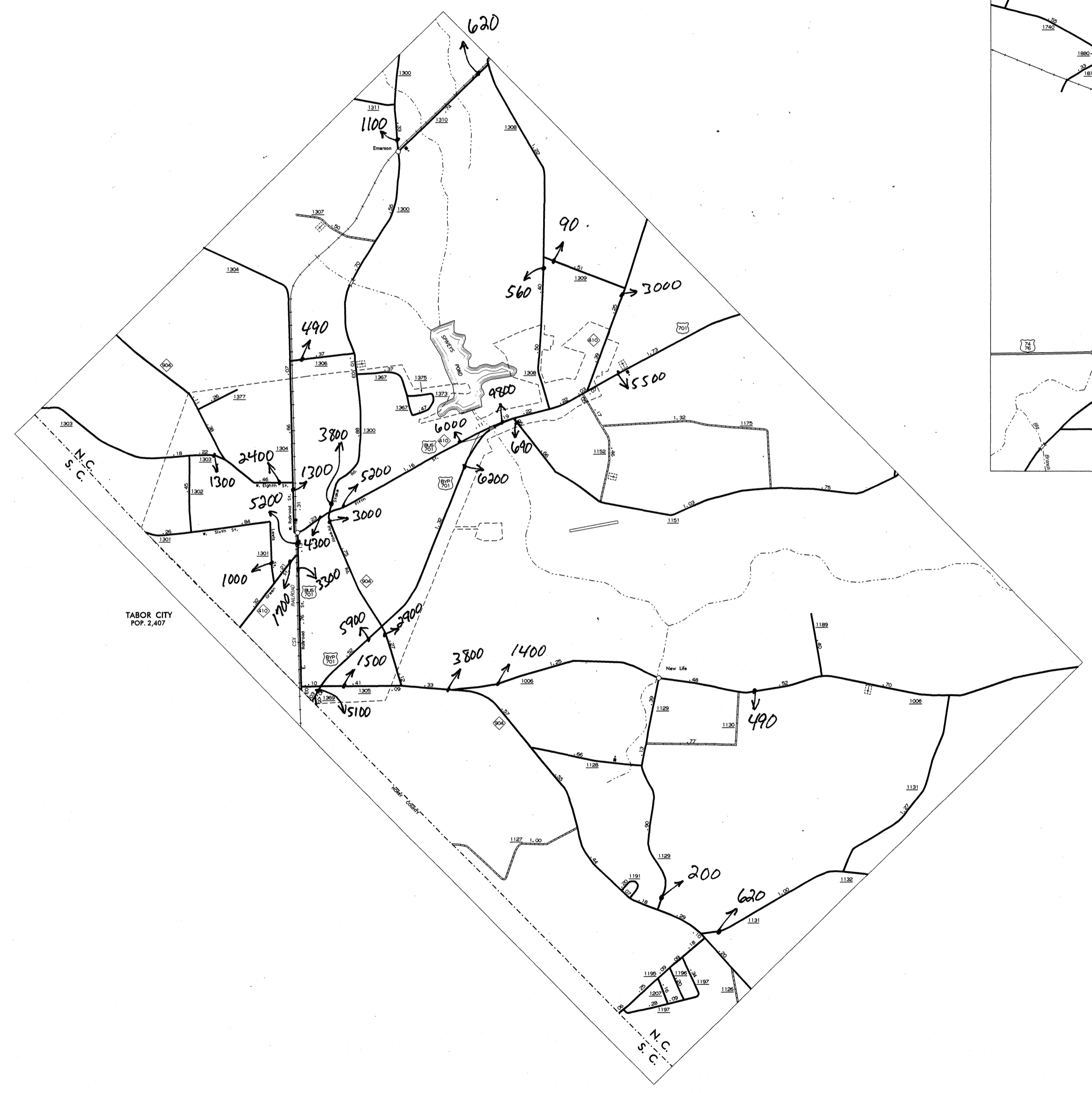

TABOR CITY
POP. 2,407

Some of the traffic estimates in this county were based on data collected after hurricane events in 1999. Contact the Traffic Survey Unit at (919) 733-9770 for information about a particular location or area.

N.C. Department of Transportation
Statewide Planning Branch
Traffic Survey Unit
1554 Mail Service Center
Raleigh, NC 27699-1554

1999
ANNUAL AVERAGE
DAILY TRAFFIC

ENLARGED MUNICIPAL AND SUBURBAN AREAS

COLUMBUS COUNTY
NORTH CAROLINA

PREPARED BY THE
NORTH CAROLINA DEPARTMENT OF TRANSPORTATION
DIVISION OF HIGHWAYS - GIS UNIT

IN COOPERATION WITH THE
U.S. DEPARTMENT OF TRANSPORTATION
FEDERAL HIGHWAY ADMINISTRATION

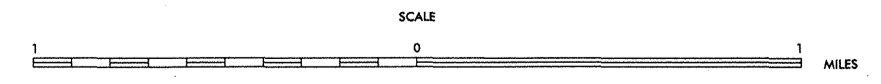
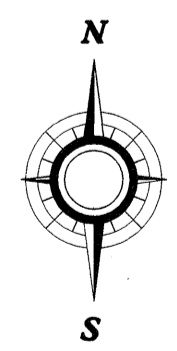

10,000 FOOT GRID BASED ON NORTH CAROLINA PLANE COORDINATE SYSTEM

COPIES OF THIS MAP ARE AVAILABLE
PUBLIC AT A NOMINAL COST
FROM THE N.C. DEPARTMENT OF TRANSPORTATION
ADDRESS:
RALEIGH, NORTH CAROLINA 27611

REVISED
1-1-98 DDR
12-3-97 RLN
4-8-99 RLN
9-3-99 RLN

COLUMBUS SUP 3